

Instruction Manual

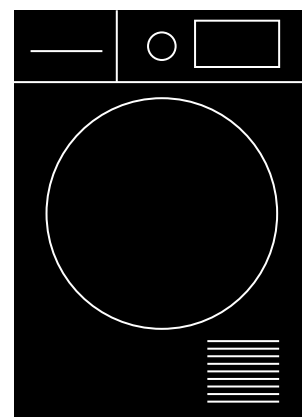

7.0kg
Condenser
Dryer

TCD70



Safety Notes	04
Your Appliance	07
Installing the Hose	08
Operating Instructions	08
Cleaning and Maintenance	11
Troubleshooting	13
Warranty	14

Peace
of Mind

Congratulations and thank you for purchasing a Teka appliance. You've chosen a product that features over 90 years of innovation and the very best of European engineering, with Teka founded in Germany in 1924. Intuitive and stylish, your Teka appliance has been designed with you in mind meaning that you'll get great results every time.

Welcome to the world of Teka.

Visit our website for our full range of Appliance solutions, product brochures and service information.

Teka is proudly distributed and represented by Residentia Group in Australia.

www.teka.com/au

Customer
Care

Teka recommends the use of original spare parts.

When contacting our customer service team, please ensure that you have the following information at hand (which can be found on your appliances' rating plate).

- Model Number; and,
- Serial Number.

P . 1300 11 4357

E. support@residentiagroup.com.au

Safety Notes

1. Conditions of use

This appliance is intended to be used in household and similar applications such as farm houses or by clients in serviced apartments, holiday apartments and other residential type environments.

2. Safety instructions

Before the installation and use of the appliance, carefully read the supplied instructions. The manufacturer is not responsible if an incorrect installation and use causes injuries and damages. Always keep the instructions with your appliance for future reference.

Warning! To prevent any damages to your and others' life or property, you have to follow the safety notes.

Warning! Caution, risk of fire!

2.1 Children & vulnerable people safety

Warning! Risk of suffocation, injury or permanent disability.

- This appliance can be used by children aged from 8 years and above and persons with reduced physical, sensory or mental capabilities or lack of experience and knowledge if they have been given supervision or instruction for the operation of the appliance by a person who is responsible for their safety.
- Do not let children play with the appliance.
- Keep all packaging away from children.
- Keep all detergents away from children.
- Keep children and pets away from the appliance door when it is open.
- Cleaning and user maintenance shall not be made by children without supervision.

2.2 Installation

- Remove all the packaging.
- Do not install or use a damaged appliance.
- Obey the installation instruction supplied with the appliance.
- Make sure that the floor where you install the appliance is flat, stable, heat resistant and clean.
- Do not install or use the appliance where the temperature is less than 5°C or higher than 35°C.
- Do not install the appliance behind a lockable door, a sliding door or a door with a hinge on the opposite side, where the appliance door can not be fully opened.
- Always be careful when you move the appliance because it is heavy. Always wear safety gloves.
- Always move the appliance vertically.
- The rear surface of the appliance must be put against the wall.
- Make sure that there is air circulation between the appliance and the floor.
- Make sure the carpet does not obstruct the ventilation openings in the base of the appliance (if applicable).
- Exhaust air must not be discharged into a flue which is used for exhausting fumes from appliances burning gas or other fuels.
- If the tumble dryer is put on top of a washing machine, use the stacking kit. The stacking kit, available from your authorized vendor, can be used only with the appliance specified in the instructions, supplied with the accessory. Read it carefully before installation (Refer to the Installation leaflet).
- Ensure you have good ventilation in the installation room to avoid the back flow of gases into the room from appliances burning other fuels, including open fires.
- The appliance can be installed as freestanding or below the kitchen counter with correct space (Refer to the Installation leaflet).
- When the appliance is put in its permanent position, check if it is fully level with the aid of a spirit level. If it is not, adjust the feet until it is.

Electrical Connection

Warning! Risk of fire and electrical shock.

- The appliance must be earthed.
- Make sure that the electrical information on the rating plate agrees with the power supply. If not, contact an electrician.
- Always use a correctly installed shockproof socket.
- Do not use multi-plug adapters and extension cables.
- Make sure not to cause damage to the mains plug and to the mains cable. Should the appliance power supply cable need to be replaced, this must be carried out by our Service Centre.
- Connect the mains plug to the mains socket only at the end of the installation. Make sure that there is access to the mains plug after the installation. Do not connect the appliance plug with a power connection board.
- Do not pull the mains cable to disconnect the appliance. Always pull the mains plug.
- Do not touch the mains cable or the mains plug with wet hands.
- This appliance complies with the E.E.C. Directives.













2.3 Appliance use

Warning! Risk of fire, explosion, electric shock or damage to the appliance.

- Use this appliance in a household only.
- Do not change the specification of this appliance.
- The final part of the drying cycle occurs without heat (cool down cycle) to ensure that the items will not be damaged. If you stop the appliance before the end of the drying cycle, immediately remove and spread out all items, so that the heat can dissipate.
- If you use fabric softener or similar products, obey the instructions on the packaging.
- Do not run the appliance without a filter. Clean the lint filter before or after each use.
- Wipe away lint that has accumulated around the appliance.
- Do not dry the damaged items which contain padding or fillings.
- Do not dry items such as foam rubber (latex foam), shower caps, waterproof textiles, rubber backed articles and clothes or pillows fitted with foam rubber pads.
- Before drying items that have been in contact with substances such as cooking oil, acetone, alcohol, petrol, kerosene, spot removers, turpentine, waxes and wax removers, wash them in hot water with an extra amount of detergent.
- Do not dry items in the appliance if industrial chemicals have been used for cleaning.
- Make sure that no gas lighters or matches have been left in the pockets of the clothing.
- Only dry fabrics which are applicable to dry in the tumble dryer. Follow the instructions on the fabric label.
- Do not dry not washed items in the appliance.
- If you have washed your laundry with a stain remover start an extra rinse cycle before you start the dryer.
- Do not drink or prepare food with the condensed water. It can cause health problems to people and pets.
- Do not sit or stand on the open door.
- Obey the maximum load volume of 7 kg (refer to the "Programme chart" chapter).
- Do not dry dripping wet clothes in the tumble dryer.
- Oil-affected items can ignite spontaneously, especially when exposed to heat sources such as in a tumble dryer. The items become warm, causing an oxidation reaction in the oil. Oxidation creates heat. If the heat cannot escape, the items can become hot enough to catch fire. Piling, stacking or storing oilaffected items can prevent heat from escaping and create a fire hazard.
- If it is unavoidable that fabrics that contain vegetable or cooking oil or have been contaminated by hair care products be placed in a tumble dryer they should first be washed in hot water with extra detergent- this will reduce, but not eliminate, the hazard.
- Ensure all objects are removed from clothing pockets such as lighters and matches.

Dry care symbols

Please pay attention to use the drying machine if the materials of your clothes can not be dried by it or contain the symbols as follows:

 Dry	 Normal	 Not tumble dry normal	 Do not dry
 Line dry / hang to dry	 Drip dry	 Dry flat	 In the shade
 Dry clean	 Do not dry clean	 Dry clean normal cycle with any solvent	 Dry clean normal cycle petroleum solvent only

2.4 Care and Cleaning

Warning! Risk of injury or damage to the appliance.

- Before maintenance, deactivate the appliance and disconnect the mains plug from the mains socket.
- Do not use water spray and steam to clean the appliance.
- Clean the appliance with a moist soft cloth. Only use neutral detergents. Do not use abrasive products, abrasive cleaning pads, solvents or metal objects.

2.5 Product Disposal

Warning! Risk of injury or suffocation.

- Disconnect the appliance from the mains supply.
- Cut off the mains cable and discard it.
- Remove the door catch to prevent children and pets to get closed in the appliance.

2.6 Transport

Always move the appliance cautiously. Do not use the machine door or the handle of the water container, to lift the appliance.

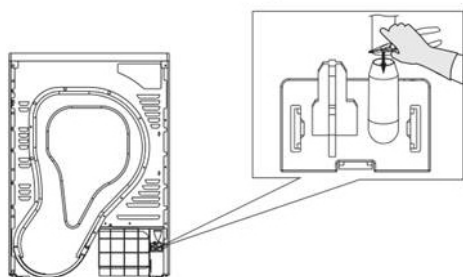
2.8—Step 1**2.7 Installation Positioning**

- Ensure that your appliance is installed on solid and flat ground, in a level position.
- Please do not place the appliance on a slope, soft carpet or wooden floor.
- Your appliance should only be installed within an internal environment. Do not install the appliance outdoors.

Level Adjusting

- If the floor is obviously uneven, your appliance feet need to be adjusted. If your appliance isn't level, it will cause your appliance to vibrate, and potentially move from its position.
- Use a screwdriver to adjust the height of four machine legs to adjust the level of your dryer.

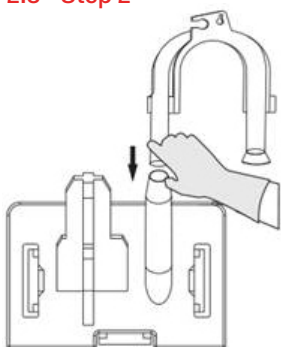
2.8—Step 2**2.8 Installing the Optional Bypass Hose**

1. Remove the existing drain hose from the hose connector using pliers
2. Insert the optional bypass hose (using pliers if required), ensuring it is securely in place

Your Appliance

Product Components

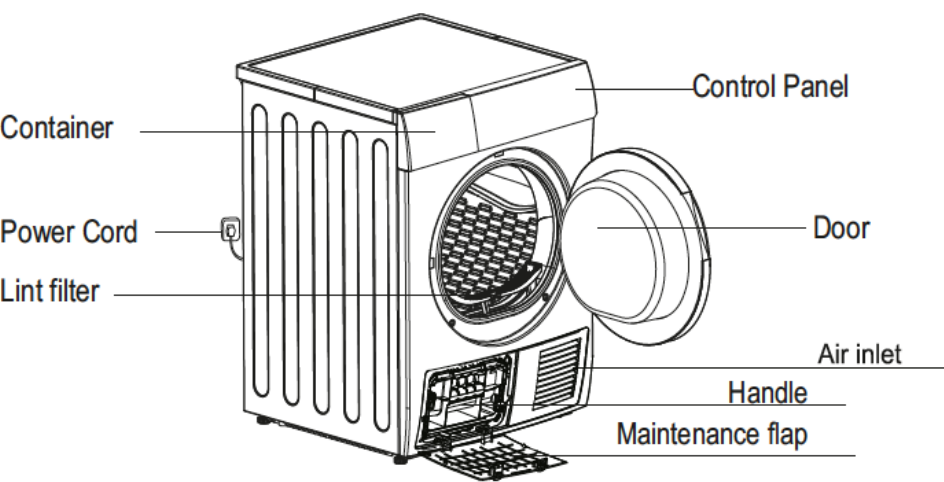

4. Control Panel

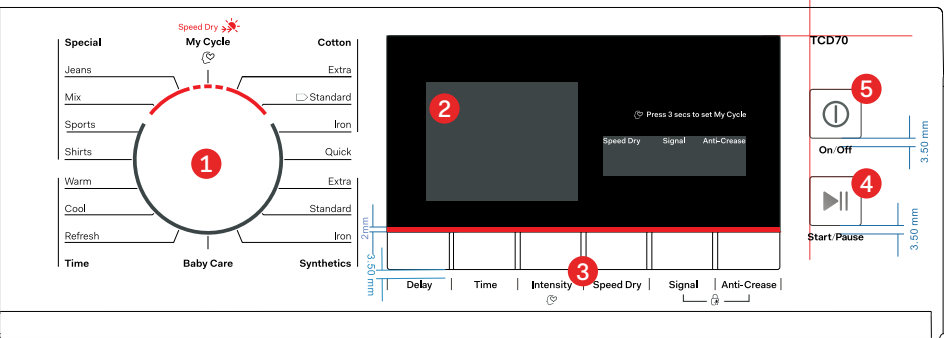

- 1 Programme selection dial
- 2 Display
- 3 Specialty function buttons
- 4 Start/Pause button
- 5 On/Off button

Display Icons

	Delay start
	Child lock
	Remaining Time indicator/Error message
	Cycle phase status
	Clean filter (warning)
	Empty water container (warning)
	Dryness level (four grades)
	Speed dry indicator
	Signal indicator
	Anti-crease mode

Operating Instructions

5. Quick Start

Follow the procedure below to operate your dryer.

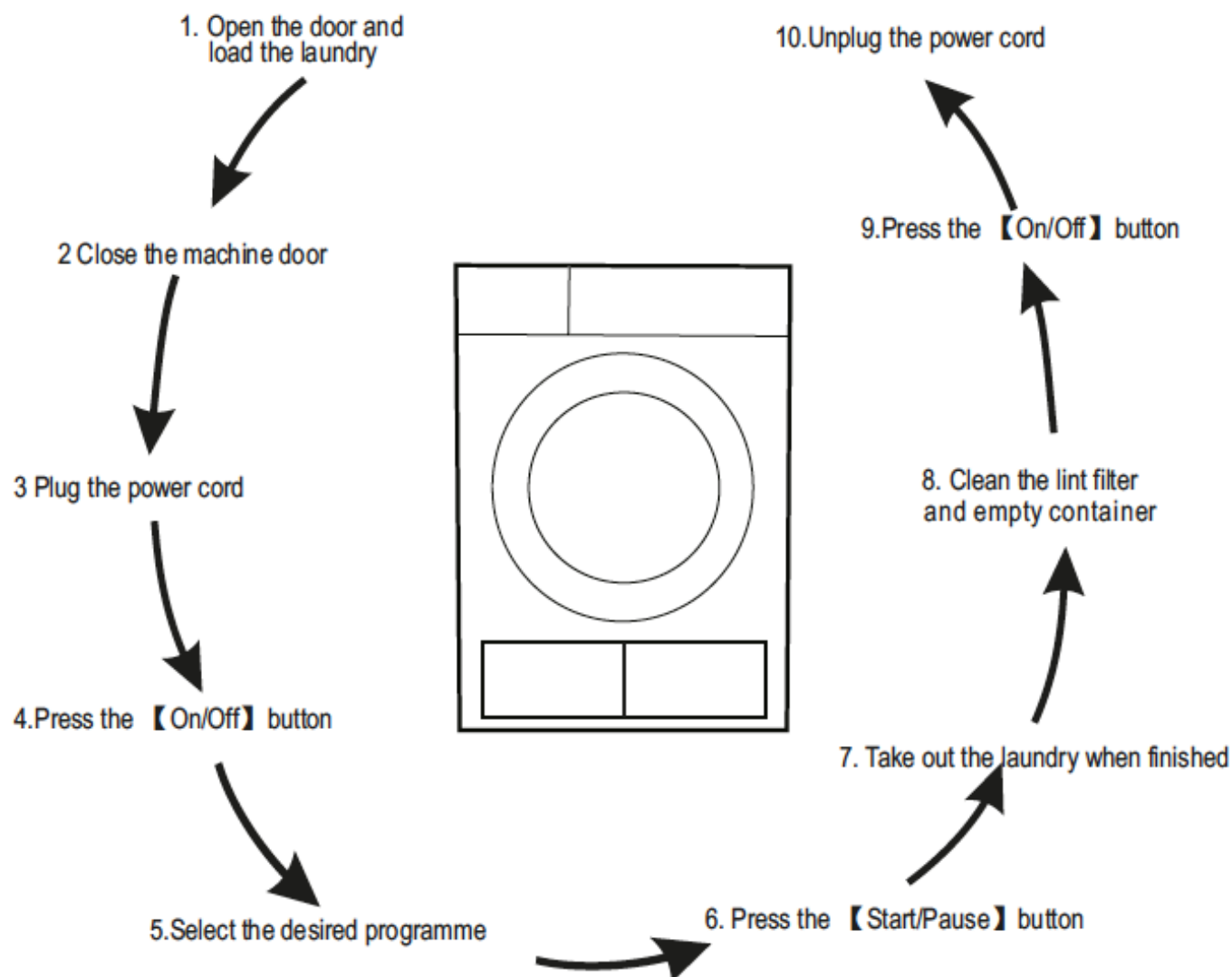

6. Programme Table

Programmes		Load Max	Application	Delay / Time
Cotton	<i>These programme options are designed for use with cotton fabrics.</i>			
	Extra	7.0kg	To dry cotton clothing. Drying level: Extra Dry	Y / N
	Standard	7.0kg	To dry cotton clothing. Drying level: Cupboard Dry	Y / N
	Iron	7.0kg	To dry cotton clothing. Drying level: Applicable for Ironing	Y / N
Quick	Quick	3.0kg	For washing which is to be dried quickly (i.e. articles made of acrylic fibres or for small individual items). Can also be use for subsequent drying.	Y / N
Synthetics	<i>These programme options are designed for use with synthetic and blended fabrics.</i>			
	Extra	3.5kg	To dry thick or multi-layered synthetic fabrics. Drying level: Extra Dry	Y / N
	Standard	3.5kg	To dry thin synthetic fabrics which are not ironed (i.e. easy care shirts, table linen, baby clothes, socks, etc).	Y / N
	Iron	3.5kg	To dry thin synthetic fabrics which are also to be ironed (i.e. knitwear, shirts, etc).	Y / N
Baby Care	Baby Care	1.0kg	To dry baby clothes.	Y / N
Special	Jeans	5.0kg	To dry jeans or leisure clothes that are spun at high speeds within the washing machine.	Y / N
	Mix	3.5kg	Designed for use when you cannot determine your clothing material.	Y / N
	Sports	3.0kg	To dry sportswear, thin fabrics and polyester items which are not to be ironed.	Y / N
	Shirts	1.0kg	To dry easy care clothes such as shirts and blouses. Use with the anti-crease option for minimum ironing effort. Once dried, hang your items on a clothes hanger.	Y / N
My Cycle	My Cycle	-	Define and save your favourite programme settings.	Y / -
Time	<i>With these programme options, you can use manual timing option and set your desired programme duration.</i>			
	Warm	-	To warm clothes from a minimum of 10 minutes to a maximum of 120 minutes. (10 minute increments)	Y / Y
	Cool	-	To air clothes without blowing hot air from a minimum of 10 minutes to a maximum of 30 minutes. (10 minute increments)	Y / Y
	Refresh	1.0kg	To refresh textiles that were in storage from a minimum of 20 minutes to a maximum of 150 minutes (10 minute increments)	Y / Y

Note:

- 1 The Maximum Weights refer to dry items.
- 2 Energy labelling program: Cotton Extra is the programme used for the AS/NZS 2442 MEPS energy rating.
- 3 The programmes above are only recommendations and users can choose the appropriate programme according to their personal requirements and habits. Thick fabrics (i.e. bed linen, jeans, jackets, etc) are not easy to dry and the Jeans drying programme along with the strongest intensity is strongly recommended.

7. Options

7.1 Delay Function

Use this delay function to delay the drying programme from 0 to 24 hours. The delay time means the programme will start after X hours. When the delay programme starts, the time starts to decrease on the display and the "Time" icon blinks on your appliance display.

To activate the delay function:

- Load your clothing articles into your appliance and close the door.
- Press the On/Off button and use the programme selector dial to select your desired drying program.
- You can select the "Anti-Crease" or "Signal" functions by pressing the corresponding buttons, according to your needs.
- Now press the "Delay" button.
- Continue to press the "Delay" button to set your desired delay time.
- Once your desired delay time is displayed, simply press the "Start/Pause" button and the dryer will automatically begin your selected drying programme at the completion of your set delay period.
- If you press the "Start/Pause" button once again, the delay function will be paused. To cancel the delay function, press the "On/Off" button.

7.2 Time Function

When the Warm, Cool or Refresh drying programmes are selected, the Time button can be used to adjust the drying time. Each press of the "Time" button will adjust the drying time in 10 minute increments.

7.3 Intensity Function

Your appliance features a drying intensity control, allowing you to adjust the dryness level of your laundry. The Intensity function has four levels, indicated by the icons below.



- The drying time increase by 3 minutes with each level.
- The Intensity function can only be activated before the drying programme is started.
- Press the Intensity button repeatedly to select the desired intensity (and drying time).
- The Intensity function can be used for all programmes except Cotton Iron, Quick, Synthetic Iron, Baby Care, Warm, Cool and Refresh.

7.4 My Cycle Function

The My Cycle function can be used to define and save your favourite drying programme for easier selection in the future (i.e. Use this function to save your most frequently used drying settings).

To set your My Cycle function:

- Use the programme selector dial to select your required programme and select any other drying functions.
- Press and hold the "Intensity" button for 3 seconds until the display flashes, indicating that your desired programme has been saved.
- To use your preset My Cycle, simply turn the programme selector dial to the My Cycle position and press the "Start/Pause" button to begin.
- If you wish to change your My Cycle settings, simply repeat the steps above at any time.

7.5 Speed Dry Function

The Speed Dry function can be used with the Cotton Extra, Cotton Standard, Jeans and Mix programmes, as indicated by the red section around the programme selector dial.

Use this function to reduce the drying time.

To activate the Speed Dry function:

- Select your desired drying programme.

- Press the “Speed Dry” button.
- Press the “Start/Pause” button to begin the programme.

7.6 Signal Function

This function allows you to turn the audible tone on or off, to indicate that your drying programme is complete. By default the audible signal is set to On.

When the Signal function is on, your appliance will make an audible tone when:

- The extra function buttons are pressed (i.e. Speed Dry, Anti-Crease, etc).
- If the dryer is operating and the programme selector knob is turned, the appliance will make an audible tone to alert the user that an invalid choice has been made.
- At the completion of a drying programme, an audible tone will sound.

7.7 Anti-Crease Function

At the end of a drying programme, the anti-crease operation time is 30 minutes (by default) or 120 minutes (if selected).

The “Anti-Crease” light shall illuminate when the function is selected. This function helps to prevent the laundry from creases. The laundry can be removed during the anti-crease phase. All programmes have the ability to use this function, except for Cool, Refresh and Baby Care.

7.8 Child Lock

Your appliance features a child lock, preventing children from pressing keys or changing the dryers operation.

To activate the child lock:

- When the appliance is in operation, press and hold the “Anti-Crease” and “Signal” buttons simultaneously for 3 seconds. Once activated, the display will show the Child Lock icon.
- Whilst the Child Lock is activated, pressing of buttons won't effect the dryer.
- To deactivate the Child Lock, simply press and hold the “Anti-Crease” and “Signal” buttons simultaneously for 3 seconds. The Child Lock indicator icon will switch off the display.

Cleaning & Maintenance

8. Cleaning Procedures

8.1 Lint Filter

As with all clothes dryers, your lint filter should be cleaned after each use.

Note:

- Lint accumulates on the lint filter and will block the air circulation. This effects the performance of your clothes dryer and will extend the required drying time.
- Always disconnect the power cord before cleaning!
- Do not operate the dryer without the lint filter installed!
- Clean the lint filter after each use .

To clean the lint filter:

- Ensure the dryer has cooled down after any recent operation.
- Un-plug the appliance.
- Open the appliance door.
- Take out the lint filter and wipe off any accumulated lint and fibres with your hand, or rinse the filter with water and dry thoroughly.
- Re-install the lint filter.

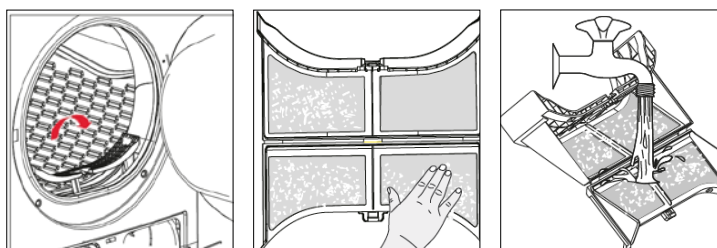

8.2 Cleaning the Condenser

If you frequently use your appliance, it is recommended to clean the condenser approximately once every three months. Be careful not to damage the air condenser. Only clean with water and never use hard or sharp objects.

Warning! Never operate the appliance without the air condenser installed.

Note:

During drying, water may collect between the window and the seal- this is normal and doesn't effect the function of your dryer.

- Ensure the dryer has cooled down after any recent operation.
- Unplug the appliance.
- Residual water may escape, so place an absorbent cloth under the maintenance flap.
- Unlock the maintenance flap and open completely.
- Screw both locking levers towards each other.
- Pull out the air condenser.
- Clean the air condenser completely and drain thoroughly.
- Clean the seals.
- Re-insert the air condenser and re-screw the locking levers.
- Close the maintenance flap until it locks into position.

8.3 Empty the water container

Warning! After each use, the water container should be emptied.

- Hold and pull out the water container using two hands.
- Tilt the water container, pouring out the condensed water in to a sink.
- Re-insert the water container into the appliance.

Note:

If the container requires emptying during operation, the programme will pause and the  icon will flash on the display. Follow the process above to empty the container and restart the programme by pressing the "Start/Pause" button.

Warning! — Do not drink the condenser water.

- Do not operate the dryer without the water container in place.

8.4 Error Alarms



Display	Reason	Solutions
 is on	Container is full	Empty container
	Water pump failure or water level sensor failure	Please contact your local service center if the problem persists
"E30"	Heater failure	
"E32"	Humidity sensor failure	
"E33"	Temperature sensor failure	

Troubleshooting

9. Troubleshooting

Warning! Only authorised technicians can carry out repairs.

Before contacting our customer service team, please refer to the table below to see if your fault can be fixed by yourself. Should a service technician visit be arranged and its found there are no faults with the appliance, a call out charge will apply.

Problem	Solution
Display isn't turning on.	<ul style="list-style-type: none"> — Check that the mains plug is inserted and switched on at the power point. — Check that a programme is selected on the programme selection dial. — Check that the relevant fuse hasn't blown.
 indicator is flashing	<ul style="list-style-type: none"> — Empty the water container as per the steps in 8.3 within this user manual.
 indicator is flashing	<ul style="list-style-type: none"> — Clean the air cooler. — Clean lint filter.
Dryer doesn't start	<ul style="list-style-type: none"> — Check the start button has selected. — Check the appliance door has closed. — Check that the programme has been set.
Water is running out of the dryer	<ul style="list-style-type: none"> — Align dryer horizontally. — Clear air condenser and door seals.
Door is opening by itself	<ul style="list-style-type: none"> — Press the door closed until it "clicks" into position. — Ensure that the dryer hasn't been overloaded with clothes.
Humidity within the room is increased significantly	<ul style="list-style-type: none"> — Ensure the room has adequate ventilation. — Clean the cool vent grill. — Ensure that the air condensor has been inserted.
Degree of dryness was not reached or drying time too long.	<ul style="list-style-type: none"> — Clean the lint filter and wash the condenser. — Empty the water container. — Clean the moisture sensors. — Try using a higher drying programme next time.

Note:

If the above steps don't resolve your issue or you cannot resolve the fault by yourself:

- Press the "On/Off" button,
- Switch off the appliance at the power outlet and remove the plug,
- Call our customer service team.

10. Technical Data

Power supply	220-240V ~50Hz
Rated input Power	2000W
Ambient temperature	+5°C - + 35°C
Dimensions	595 x 615 x 845 mm
Rated drying capacity	7.0kg
Net Weight	42kg

Note:

- The rated capacity is the maximum capacity of dry clothes. Refer to the Programme table for maximum loadings specific to each programme.
- Do not install the dryer in a room where there is a risk of a frost occurring. At temperatures around freezing point, the dryer may not be able to operate properly.
- There is a risk of damage if the condensed water is allowed to freeze in the pump, or water container.

Warranty

11. WARRANTY TERMS & CONDITIONS

—TEKA LAUNDRY APPLIANCES

This document sets out the terms and conditions of the product warranties for Residentia Group Appliances. It is an important document. Please keep it with your proof of purchase documents in a safe place for future reference should you require service for your Appliance.

1. IN THIS WARRANTY

- a) 'acceptable quality' as referred to in clause 10 of this warranty has the same meaning referred to in the ACL;
- b) 'ACL' means Trade Practices Amendment (Australian Consumer Law) Act (No.2) 2010;
- c) 'Appliance' means any Residentia Group product purchased by you accompanied by this document;
- d) 'ASR' means Residentia Group authorised service representative;
- e) 'Residentia Group' means Residentia Group Pty Ltd of 7/32 Wangaratta Street, Richmond, Victoria 3121, ACN 600 546 656 in respect of Appliances purchased in Australia;
- f) 'major failure' as referred to in clause 10 of this warranty has the same meaning referred to in the ACL and includes a situation when an Appliance cannot be repaired or it is uneconomic for Residentia Group, at its discretion, to repair an Appliance during the Warranty Period;
- g) 'Warranty Period' means:
 - i) where the Appliance is used for personal, domestic or household use (i.e. normal single family use) as set out in the instruction manual, the Appliance is warranted against manufacturing defects for 24 months, following the date of original purchase of the Appliance;
 - h) 'you' means the purchaser of the Appliance not having purchased the Appliance for re-sale, and 'your' has a corresponding meaning.

2. This warranty only applies to Appliances purchased and used in Australia and is in addition to (and does not exclude, restrict, or modify in any way) any non excludable statutory warranties in Australia.
3. During the Warranty Period Residentia Group or its ASR will, at no extra charge if your Appliance is readily accessible for service, without special equipment and subject to these terms and conditions, repair or replace any parts which it considers to be defective. Residentia Group or its ASR may use remanufactured parts to repair your Appliance. You agree that any replaced Appliances or parts become the property of Residentia Group. This warranty does not apply to light globes, batteries, filters or similar perishable parts.
4. Parts and Appliances not supplied by Residentia Group are not covered by this warranty.
5. You will bear the cost of transportation, travel and delivery of the Appliance to and from Residentia Group or its ASR. If you reside outside of the service area, you will bear the cost of:
 - a) travel of an authorised representative;
 - b) transportation and delivery of the Appliance to and from Residentia Group or its ASR, in all instances, unless the Appliance is transported by Residentia Group or its ASR, the Appliance is transported at the owner's cost and risk while in transit to and from Residentia Group or its ASR.
6. Proof of purchase is required before you can make a claim under this warranty.

7. You may not make a claim under this warranty unless the defect claimed is due to faulty or defective parts or workmanship. Residentia Group is not liable in the following situations (which are not exhaustive):
 - a) the Appliance is damaged by:
 - i) accident
 - ii) misuse or abuse, including failure to properly maintain or service
 - iii) normal wear and tear
 - iv) power surges, electrical storm damage or incorrect power supply
 - v) incomplete or improper installation
 - vi) incorrect, improper or inappropriate operation
 - vii) insect or vermin infestation
 - viii) failure to comply with any additional instructions supplied with the Appliance;
 - b) the Appliance is modified without authority from Residentia Group in writing;
 - c) the Appliance's serial number or warranty seal has been removed or defaced;
 - d) the Appliance was serviced or repaired by anyone other than Residentia Group, an authorised repairer or ASR.
8. This warranty, the contract to which it relates and the relationship between you and Residentia Group are governed by the law applicable where the Appliance was purchased.
9. To the extent permitted by law, Residentia Group excludes all warranties and liabilities (other than as contained in this document) including liability for any loss or damage whether direct or indirect arising from your purchase, use or non use of the Appliance.
10. For Appliances and services provided by Residentia Group in Australia, the Appliances come with a guarantee by Residentia Group that cannot be excluded under the Australian Consumer Law. You are entitled to a replacement or refund for a major failure and for compensation for any other reasonably foreseeable loss or damage. You are also entitled to have the Appliance repaired or replaced if the Appliance fails to be of acceptable quality and the failure does not amount to a major failure. The benefits to you given by this warranty are in addition to your other rights and remedies under a law in relation to the Appliances or services to which the warranty relates.
11. At all times during the Warranty Period, Residentia Group shall, at its discretion, determine whether repair, replacement or refund will apply if an Appliance has a valid warranty claim applicable to it.
12. To enquire about claiming under this warranty, please follow these steps:
 - a) carefully check the operating instructions, user manual and the terms of this warranty;
 - b) have the model and serial number of the Appliance available;
 - c) have the proof of purchase (e.g. an invoice) available;
 - d) telephone the numbers shown below.
13. You accept that if you make a warranty claim, Residentia Group and its ASR may exchange information in relation to you to enable Residentia Group to meet its obligations under this warranty.

IMPORTANT! Before calling for service, please ensure that the steps in point 12 have been followed.

Telephone contacts:	Service Centre:	1300 11 HELP (4357)
	Spare Parts:	1300 11 SPARE (7277)

The Australian Consumer Law requires the inclusion of the following statement with this warranty:
Our goods come with guarantees that cannot be excluded under the Australian Consumer Law. You are entitled to a replacement or refund for a major failure and for compensation for any other reasonably foreseeable loss or damage. You are also entitled to have the goods repaired or replaced if the goods fail to be of acceptable quality and the failure does not amount to a major failure.

