



**TURNER
HASTINGS**
EUROPEAN BATHWARE

16 McPherson Road, Smeaton Grange, NSW, 2567
PO Box 7412, Mount Annan, NSW, 2567
Phone 1300 00 2284
Fax 02 4647 5564
ABN 56 263 133 253
www.turnerhastings.com.au
info@turnerhastings.com.au

Butler Sink Installation Instructions

SINK CABINET REQUIREMENTS.

The Butler Sink requires a special sink cabinet with the front cut out to accommodate the APRON front of the sink. We recommend that an experienced cabinetmaker is responsible for all cabinet work. Ensure the cabinet will not foul the sink front apron or mounting flange.

CABINET FITMENT

We highly recommend that the actual sink to be installed is available for the cabinet maker during manufacture of cabinet and support frame.

SINK DIMENSIONS

Product dimensions will vary from one sink to the next. Accepted industry standards for accuracy of hand made products of this type is within 2%

FITTING THE SINK

Mount the sink on the shelf so it is flush with the top of the cabinet then seal the mating surface with silicone and install the counter/bench top.

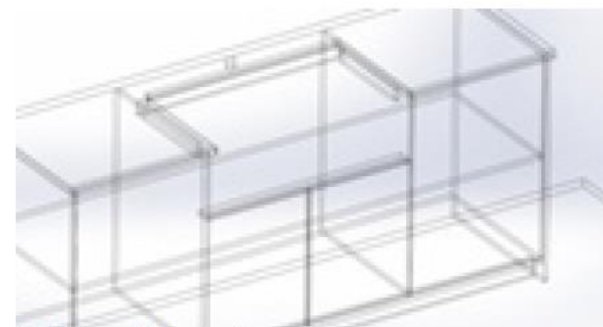

(Install wood bracing)

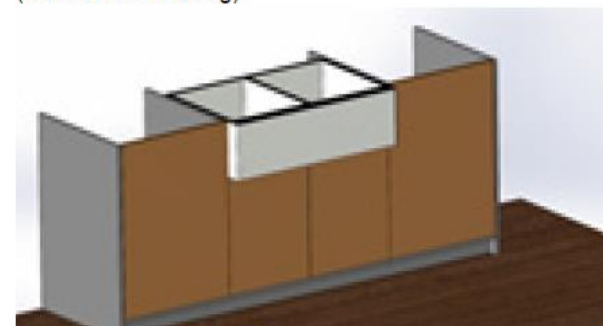

(Install butler sink)

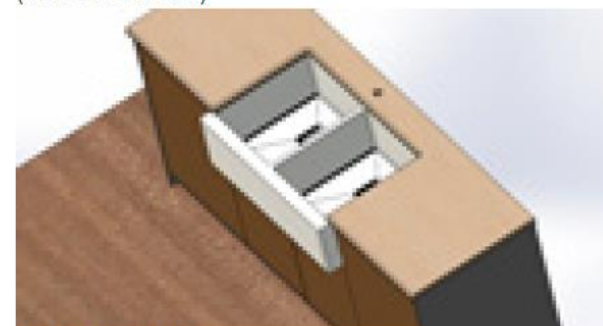

(Install counter top)