

## STH600X1 60CM TELESCOPIC RANGEHOOD



**EAN 9345025001948**

Finish	stainless steel fascia rail
Dimensions	175mmH x 598mmW x 280mmD closed 175mmH x 598mmW x 432mmD open
Installation	undermount
Motor	140 watt
Air extraction	<ul style="list-style-type: none"> <li>duct direct to atmosphere — 150mm diameter ducting required</li> <li>recirculate to kitchen — 125mm ducting required</li> </ul>
Capacity	440m <sup>3</sup> /hr intensive (IEC 61591: p=0) 420m <sup>3</sup> /hr intensive (IEC 61591: p=1)
Noise rating	54–67 dBA (full)
Illumination	2 x 1W LED
Speeds	two + intensive*
Current	0.583 amp
Power supply	220–240 volt, 50Hz connected 2.1m power cord with 3-pin 10 amp plug
Supplied	one-piece filter, 3-ply aluminium — removable, washable
Weight	8.33kg gross, 7.07kg net

p = 0	airflow direct out of motor housing
p = 1	airflow after 1m & 90° bend + 1m

**\*INTENSIVE:** the Intensive Speed function activates maximum air extraction for 10 minutes to meet the needs heavy-duty cooking, such as stir-fry.

# STH600X1 60CM TELESCOPIC RANGEHOOD

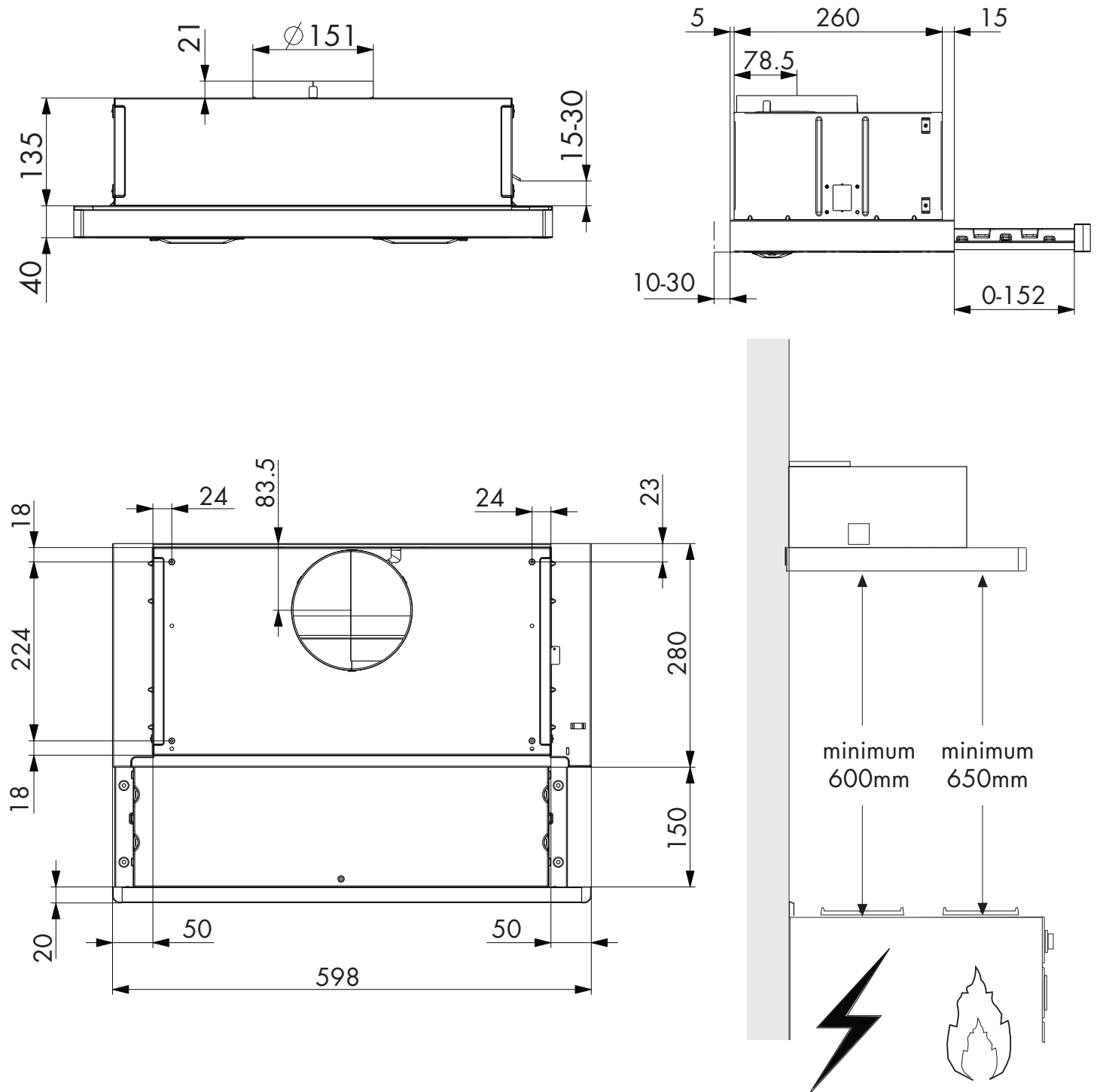

**NB: drawings are not to scale – they are to assist only**

WARNING: technical specifications and product sizes can be varied by the manufacturer without notice. Cutouts for appliances should only be by physical product measurements. The above information is indicative only.

ID190701