

# Operating instructions

for freezers for integrated use

**GB**



**7082 542-01**

IG 6er 5107

# The appliance at a glance

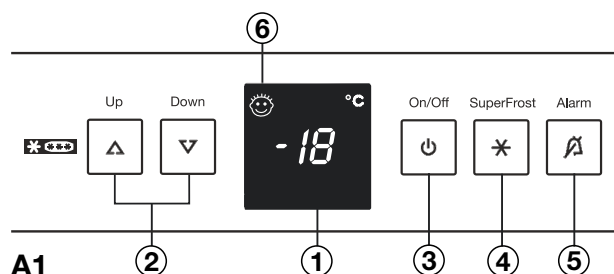

## Operating and control elements, fig. A1

- ① Temperature display and setting display, with nA FrostControl and power failure display with call-up function for highest temperature
- ② Temperature buttons:  
**UP = higher,**  
**DOWN = lower,**  
recommended setting: -18 °C
- ③ On/off button
- ④ SuperFrost button, lit = function activated.  
For fast freezing of large quantities of fresh food
  - Press the SuperFrost button ④ briefly so that it lights up.
  - Wait approx. 6 - 24 hours.
  - Place the fresh food in the top drawers. The SuperFrost function is **switched off as required**. The freezer will switch back automatically to normal operation.
- ⑤ Audible warning on/off button
- ⑥ Child-proof lock display, lit = function activated, prevents the appliance from being switched off accidentally. See 'Additional functions' for more information.

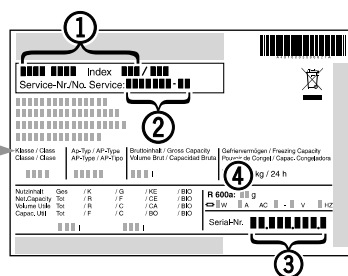

## Type/Data plate, fig. A2

- ① Type designation
- ② Service No.
- ③ Serial No.
- ④ Freezing capacity in kg/24 hours

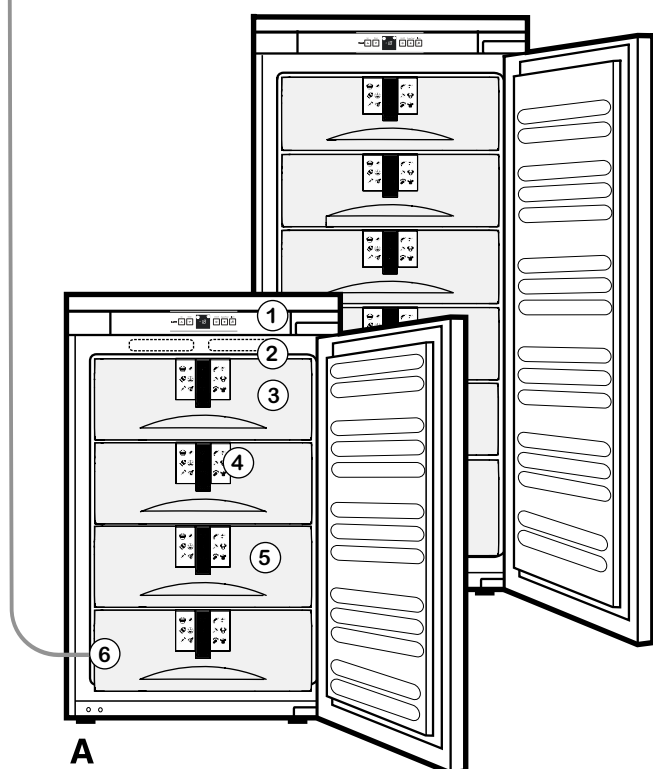

## Description of appliance and equipment

Fig. A

- ① Operating and control elements
- ② Cold-storage accumulator\*
- ③ Freezer tray\*
- ④ Drawers with information system\*
- ⑤ VarioSpace thanks to removable intervening shelves
- ⑥ Type plate

All types and models are subject to continuous improvement. Therefore please understand that we have to reserve the right to make design, equipment and technical modifications.

Keep these operating instructions in a safe place and pass them on to the next owner, where applicable.  
The operating instructions apply to several models. Differences may therefore occur.

## Contents Page

### Operating instructions

The appliance at a glance .....	8
Contents .....	9
Safety regulations .....	9
Notes on energy saving.....	9
Safety instructions and warnings .....	9
Disposal notes .....	9
Setting up .....	10
Connecting to the mains .....	10
Operation and control elements.....	10
Switching the appliance on and off.....	10
Setting the temperature.....	10
Temperature display.....	10
Audible warning signal .....	10
Power failure/FrostControl display .....	11
Additional functions - child-proof lock.....	11
Display brightness* .....	11
SuperFrost.....	11
Notes on freezing and storage .....	11
Equipment .....	12
Information system.....	12
Freezer tray .....	12
Cold-storage accumulators .....	12
VarioSpace* .....	12
Cleaning .....	13
Troubleshooting .....	13
Customer service and type plate.....	13

## Safety regulations §

- The appliance is designed to freeze and store food and to make ice. It is designed as a household appliance. We cannot guarantee that the appliance will work properly if it is used for another purpose.
- The appliance is set to operate within specific ambient temperature limits according to its climate rating. These temperature limits should not be exceeded. The correct climate rating for your appliance is indicated on the type plate. This is explained as follows:

Climate rating	for ambient temperature
SN, N	up to + 32 °C
ST	up to + 38 °C
T	up to + 43 °C

- The appliance will function properly in ambient temperatures of down to +5°C.
- The refrigerant circuit has been tested for leaks.
- The appliance complies with current safety regulations and EC directives 2006/95/EC and 2004/108/EC.

## Notes on energy saving

- Ensure that there is adequate space around the appliance! for ventilation and air extraction.
- Avoid keeping the door open for too long.
- Store food logically. Do not exceed the storage period specified.
- Keep all food properly packed and covered so as to avoid its frosting up on the outside.
- Always allow hot food to cool to room temperature before placing in the appliance.
- Defrost frozen food in the refrigerator.
- Keep the appliance door shut in the event of a breakdown. This will delay the cold loss and will help to maintain the quality of the frozen food for longer.

## Safety instructions and warnings

### Disposal notes

The packaging is made of recyclable materials.

- Corrugated board/board
- EPS moulded parts
- Polythene sheets
- Polypropylene straps

- **Keep packaging materials away from children - polythene sheets and bags can cause suffocation!**
- Please return the packaging to an official collection point.

**Your old appliance:** This contains some reusable materials and should be disposed of properly - not simply with unsorted household refuse.

- Discarded appliances should be disabled: Remove the plug, cut through the connection cable and render the catch unusable so that children cannot become trapped inside.
- Ensure that the refrigerant circuit is not damaged when the appliance that is no longer needed is taken away for disposal.
- Details of the refrigerant can be found on the type plate.
- Appliances which are no longer needed must be disposed of in a professional and appropriate way, in accordance with the current local regulations and laws.

### Technical safety

- To prevent injury or damage to the unit, the appliance should only be transported wrapped and set up by two people.
- The refrigerant R 600a is environmentally friendly but flammable.
- Do not damage the refrigerant circuit pipes. Splashes of refrigerant can harm your eyes or ignite.
- If refrigerant escapes, remove all naked flames or sources of ignition in the vicinity of the leak, disconnect the appliance from the mains and ventilate the area well.
- In the event that the appliance is damaged, contact the supplier immediately before connecting to the mains.
- To guarantee safe operation, ensure that the appliance is set up and connected as described in these operating instructions.
- Disconnect the appliance from the mains if any fault occurs. Pull out the plug (not by pulling on the mains cable) or switch off or remove the fuse.
- **Any repairs and work on the appliance should only be carried out by the customer service department, as unauthorised work could prove highly dangerous for the user.** The same applies to changing the mains power cable.

### Safety during use

- Do not store explosives or sprays using combustible propellants such as butane, propane, pentane, etc. in the appliance. Electrical components might cause leaking gas to ignite. You can identify such sprays by the printed contents or a flame symbol.
- Only store high-percentage alcohol in tightly sealed, upright containers.
- Do not allow naked flames or ignition sources to enter the appliance.
- Do not use electrical appliances inside the appliance (e.g. steam cleaners, heaters, ice makers, etc.).
- Do not stand on the plinth, drawers or doors or use them to support anything else.

- This appliance is not intended for use by persons (including children) with reduced physical, sensory or mental capabilities or lack of experience and knowledge unless they have been given initial supervision or instruction concerning use of the appliance by a person responsible for their safety. Children should be supervised to ensure that they do not play with the appliance.
- Avoid prolonged skin contact with cold surfaces or chilled/frozen food. This could cause pain, numbness and frostbite. In the case of prolonged skin contact, protective measures should be taken, e.g. gloves should be worn.
- Do not eat ice-cream, particularly ice lollies or ice-cubes, immediately after taking them from the freezer compartment as there is a risk of "burning" because of the very cold temperatures.
- Do not consume food which has been stored for too long, as it could cause food poisoning.

## Installation and ventilation information

- When setting up/fitting ensure that the refrigerant circuit pipes are not damaged.
- Avoid positioning in direct sunlight or next to an oven, radiator or similar.
- **Do not block the ventilation areas. Always ensure that there is good ventilation and that the outward flowing air is able to escape.**
- Standard EN 378 specifies that the room in which you install your appliance must have a volume of 1 m<sup>3</sup> per 8 g of R 600a refrigerant used in the appliance, so as to avoid the formation of inflammable gas/air mixtures in the room where the appliance is located in the event of a leak in the refrigerant circuit. The quantity of refrigerant used in your appliance is indicated on the type plate on the inside of the appliance.
- Fit the refrigerator/freezer in stable kitchen units only.
- Please follow the enclosed installation instructions.
- Remove all transportation safety components.

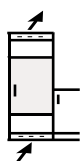

## Connecting to the mains

### Power supply (AC) and voltage

at the operating point must comply with the details on the type plate, which is located inside the appliance on the left, fig. A.

- **Connect the appliance with a properly earthed fused plug and socket only.**
- The socket must be fused with a 10 A fuse or higher, it must be away from the rear of the appliance and must be easily accessible.
- **Do not**
  - connect to stand-alone inverters\*,
  - operate with so-called energy-saving plugs - this can damage the electronic system.
  - connect to the supply with other equipment using an extension cable - risk of overheating.
- When removing the mains cable from the back of the appliance, remove the **cable holder** to prevent vibration noise!



## Operation and control elements

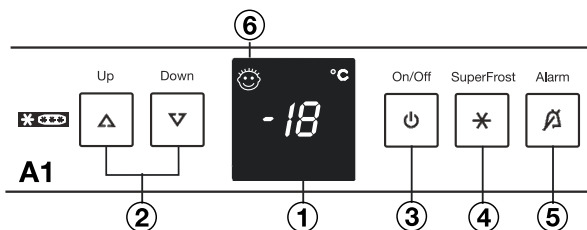

### Switching the appliance on and off

- **Switching on:** Press the on/off button ③ so that the temperature display lights up/flashes.
  - When the appliance is switched on for the first time and while it is still warm, the display will contain **dashes** until the temperature falls below 0°C.
- **Switching off:** Press the on/off button for approx. two seconds so that the temperature display goes out.

### Setting the temperature

The appliance is pre-set for normal operation. We recommend a temperature of -18°C.

- **To reduce the temperature:** Press the DOWN button ②.
- **To increase the temperature:** Press the UP button ②.
  - While you are entering the temperature, the **set temperature will flash** on the display.
  - When you press the temperature setting buttons for the first time, the **most recent setting** (known as the "**reference setting**") is displayed.
  - If the buttons are held down the temperature setting will change faster. You can change the settings in increments of 1°C by briefly pressing the buttons again.
  - The electronic controls will switch over automatically about 5 seconds after the last time you pressed the button, and the **actual** temperature in the freezer (known as the "**actual setting**") will be displayed.
  - The temperature can be set at between -14°C and -28°C /Australian model - 14 °C and - 26 °C. Whether you can obtain the lowest temperature depends on where the appliance is positioned (if it is located in an area with a high ambient temperature it will not reach the lowest temperature).

### Temperature display

The **highest temperature of the frozen food** ① is displayed in normal operating mode.

#### The display will flash:

- if you change the temperature or
- if the temperature rises by several degrees, indicating cold loss, e.g. if you place fresh, "warm" food in the freezer or if you remove or repack frozen food the temperature may rise for a short time due to warm air flowing into the freezer. Once you have finished loading or repacking, the electronics will automatically reset the temperature to the most recent setting. Short-term rises in temperature will not affect the frozen food.
- If "F 1" to "F 5" appears in the display, the appliance has a fault. Contact your customer service department and tell them that this visual warning is active, so that they can arrange for your appliance to be serviced accurately and quickly.

### Audible warning signal

The audible warning signal helps to protect frozen food and to save energy

- **The audible warning device is switched off** by pressing the audible warning button ⑤.
- It switches off automatically as soon as the temperature is low enough or the door is closed.

#### Audible door alarm

- This sounds when the door has been left open for longer than about 60 seconds. The sound switch-off function is active as long as the door is left open. The alarm automatically switches back to standby when the door is shut.

### Audible/visual temperature alarm

- It always sounds if the freezer temperature is not low enough (dependent on the temperature setting).
- The **temperature display flashes** at the same time.

This can be caused by:

- warm, fresh food being placed in the freezer,
- too much warm air from the outside entering when re-arranging or removing frozen food.

The temperature display will continue to **flash** until the cause of the alarm has been rectified. It will then stop flashing and light up continually. The audible warning signal is now automatically **reset**.

### Power failure/FrostControl display

If **nH** appears in the display, this means that the freezer temperature has risen too **high** during the last few hours or days due to a power failure.



- If you press the audible warning on/off button ⑤ while the display is reading **nH**, the **highest** temperature registered during the power failure will be displayed.
- Check the quality of the food and its suitability for consumption in case it has become too warm or even defrosted.
- The highest temperature will appear for approx. 1 minute. After that, the actual temperature in the freezer will re-appear. The display can be switched off by pressing the audible warning on/off button.

Once the power is re-instated, the appliance will continue to operate at the most recent temperature setting.

### Additional functions

In set-up mode you can set the **child-proof lock** and adjust the **brightness of the display**.\*

#### Activating set-up mode:

- Press SuperFrost button for approx. 5 secs - the SuperFrost button flashes - the display shows **c** for child-proof lock. Note: the value to be altered flashes.
- Select the required function by pressing the Up/Down button: **c** = **child-proof lock** or **h** = **brightness**.
- Now select/acknowledge function by pressing SuperFrost button briefly:
  - For **c** = **child-proof lock**, press the Up/Down button to select **c1** = child-proof lock **on** or **c0** = child-proof lock **off** and acknowledge with the SuperFrost button. When the symbol ⑥ is lit, the child-proof lock is activated.
  - For **h** = **brightness**, press Up/Down button to select **h1** = **minimum** to **h5** = **maximum** brightness and acknowledge with the SuperFrost button.



#### Exit set-up mode:

- To exit the set-up mode, press the On/Off button; after 2 mins. the electronic system switches over automatically. The normal operating mode is activated again.

## SuperFrost

### SuperFrost, Fig. A1

**Fresh** food should be frozen to the core as rapidly as possible. Frozen food can also be given a cold boost. This is provided by the SuperFrost facility and ensures that the nutritional value, appearance and flavour of the food remain intact.

- The maximum amount of food which can be frozen in 24 hours is shown on the type plate ("Freezing capacity... kg/24h", fig. **A2**, pos. ④). This amount varies according to the model and climate rating.

### Freezing with SuperFrost

- Press the SuperFrost button ④ briefly until it lights up; the lowest set temperature on the temperature display will also light up.

The freezer temperature will decrease and the appliance will switch to the lowest temperature.

- For small amounts of frozen food, it is normally sufficient to switch on SuperFrost 6 hours beforehand. For the **maximum** amount (see freezing capacity on the type plate) you will need to switch it on 24 hours beforehand.
- Then place the fresh food inside the freezer, preferably in the lower drawers.

For the **maximum** amount, freeze the packed food **without using** the drawers. Place it straight onto the floor of the freezer compartment and, once frozen, transfer it to the drawers!

- The SuperFrost function switches off **automatically**. Depending on the quantity of food placed in the freezer, this will normally be between 30 and max. 65 hours. The freezing process is now complete, the **SuperFrost button will go dark** - and the freezer will switch back to normal energy-saving operation.

SuperFrost



**Note:** When the SuperFrost function is activated the appliance will be running at full capacity, so the refrigeration unit will sound slightly louder for a while.

You should **not** switch on the SuperFrost function:

- when placing frozen food in the freezer;
- when freezing up to approx. 2 kg fresh food daily.

### Notes on freezing and storage

- **Items suitable for freezing:** meat, game, poultry, fresh fish, vegetables, fruit, dairy products, bread, baked goods, pre-cooked meals. **Not suitable:** lettuce, radishes, grapes, whole apples and pears, fatty meat.
- **Pack frozen food** in standard freezer bags or reusable plastic, metal or aluminium containers.
- Do not allow fresh food which is to be frozen to come into contact with food already frozen. Always keep packs dry in order to avoid them sticking together.
- Always write the date and contents on the pack and do not exceed the stated storage time for the food. This prevents any risk of quality impairment.
- Pack food which you are freezing yourself in quantities appropriate to your household. To ensure that the food freezes right through quickly, the following quantities should not be exceeded per package:
  - fruit, vegetables: up to 1 kg;
  - meat: up to 2.5 kg.
- Blanch **vegetables** after washing and cutting them. (Add to boiling water for 2-3 minutes, remove and quickly cool down in cold water. If you blanch with a steamer or microwave oven, please observe the relevant operating instructions.)
- Do not salt or season fresh food or blanched vegetables before freezing. Only lightly salt and season other food. Some spices can alter their flavour intensity.
- Do not freeze bottles and cans which contain carbonated drinks as they might burst. Drinks can be cooled down quickly, but take the bottles out of the freezer compartment after an hour at the most.

GB

- **Storage:** Each drawer and shelf can take up to 25 kg frozen food.
- If you want to use the maximum net capacity, you can remove the drawers and store items directly on the shelves.
- **Removing drawers:** Pull forward until the drawer stops and lift out.
- Always store identical food items together to avoid the door being open for unnecessarily long periods and to save energy.
- Do not exceed storage times given.

- **Thawing:** Only take out as much food as is immediately required for thawing.

Cook food which has been thawed as quickly as possible.

**Frozen food can be thawed in the following ways:**

- in a conventional or fan oven
- in a microwave oven
- at room temperature in the refrigerator: the cold given off by the frozen food is used for cooling the other food.
- Flat portions of meat or fish can be cooked when partially thawed.
- Vegetables can be cooked from frozen (in half the normal time).

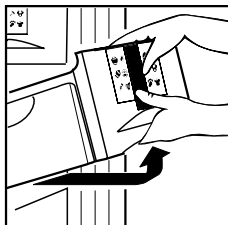

### Freezer tray\*

This is used for gently freezing berries, herbs, vegetables and other small items and prevents them from sticking together. Items being frozen will largely retain their shape, and it will be easier to remove exactly the right quantity later on.

- Spread the items out loosely on the tray.
- Freeze for 10 to 12 hours, then transfer to a freezer bag or container and put in a drawer.
- To defrost, spread the frozen items out loosely.

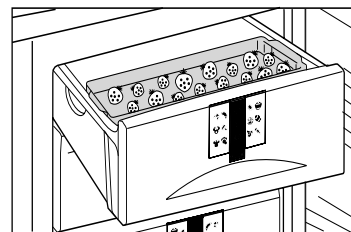

### Cold-storage accumulators\*

These prevent the temperature in the freezer from rising too quickly in the event of a power failure, thus preserving the quality of the food.

You can freeze and store the cold-storage accumulators either in the freezer tray or in the ceiling of the freezer compartment\*.

#### ● Inserting cold-storage accumulators:

Remove the top drawer. Slide the cold-storage accumulator to the top back of the freezer compartment ceiling and snap it into place at the front.

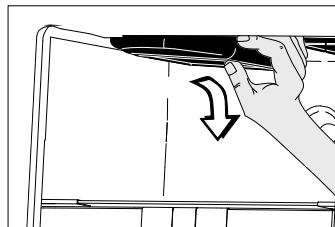
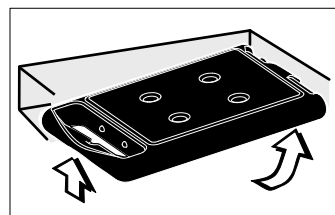

#### ● Removing cold-storage accumulators:

Remove the top drawer. Take hold of the cold-storage accumulator at the side and press it down for removal.

## Equipment

### Information system\*

Use frozen food within the recommended period.

The numbers between the symbols indicate the storage period in months for different kinds of frozen foods.

Storage times given are guide times for food frozen at home. Whether or not the lower or upper value is applicable depends on the food quality and how it was processed prior to freezing. The lower values always apply to food with a high fat content.

pre-cooked meals		2-6		sausages bread
ice-cream				mushrooms game
fish		4-8		poultry beef/veal
pork				
vegetables		6-12		
fruit				

### VarioSpace\*

- You can create a double-height space for **big items of frozen food** by removing a drawer and a shelf. This enables you to freeze such things as poultry or big pieces of meat without having to cut them up first, so they can be served "whole" afterwards, and to store other large items such as big gateaux or packs of ice.

- Depending on how much space you need, you can remove 1, 2, or all the drawers and shelves to use the entire interior. Please note however that the maximum load of a shelf is 25 kg.

- **Removing the drawer:** Pull forward until the drawer stops and lift out.

- **Removing the shelf:** Lift up at the front and pull out.
- To insert: simply push shelf in as far as it will go.

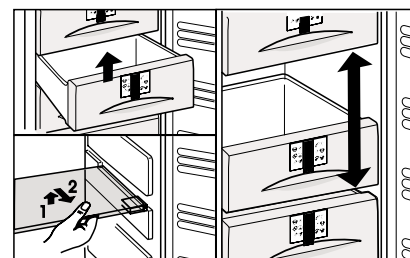



## Cleaning

### Notes on defrosting

After the appliance has been in operation for a lengthy period, a layer of frost or ice will form in the freezer compartment, depending on how often the door is opened and warm food is placed inside. This is completely normal. However, a thick layer of ice will increase the appliance's energy consumption. You should therefore defrost the appliance regularly:

- Switch on SuperFrost one day before defrosting. The frozen goods are provided with a "cold reserve".
- To defrost, switch off the appliance:
- Press the on/off button so that the temperature display goes out. If the display does not go out, the childproof lock is activated.
- Remove the plug.
- If possible, put the frozen goods in the freezer drawer, wrap in newspaper or a blanket and store in a cool place.
- To speed up the defrosting process put a saucepan of hot but not boiling water on one of the shelves. Do not use electric heaters or steam cleaners, defrosting sprays or naked flames for defrosting nor any metal objects for removing the ice. Risk of injury and damage!
- Leave the door of the appliance open while defrosting. Soak up residual defrost water with a cloth. Then clean the appliance and wipe dry.

### Cleaning

- **Always disable the appliance for cleaning. Disconnect from the mains or unscrew or switch off the fuse.**
- Clean the inside and equipment by hand with luke-warm water and a little detergent. Because of the risk of injury and damage to the appliance, steam cleaning equipment should not be used.
- We recommend using a soft cloth and an all-purpose cleaner with a neutral pH value. Only use food compatible cleaning and care agents on the inside of the appliance.
- Do not use abrasive sponges or scourers, do not use concentrated cleaning agents and never use cleaning agents containing sand, chloride or acid or chemical solvents, as these would damage the surfaces and could cause corrosion.
- Ensure that no cleaning water is allowed to penetrate into the electrical components or ventilation grilles. Dry the appliance.
- Do not damage or remove the type plate on the inside of the appliance as this is important for customer service.
- Then connect/switch on the appliance, switch on SuperFrost and start to insert the food to be frozen as the temperature drops.

If the appliance is to be **left switched off for any length of time** empty the appliance, disconnect from the mains, clean as described above and leave the door open so as to avoid odours.



## Troubleshooting

If a malfunction occurs during operation, check whether it is due to an operating error. Please note that even during the warranty period the resultant servicing costs in this case will have to be borne by the owner.

You may be able to rectify the following faults by checking the possible causes yourself:

**Malfunction** - Possible cause and remedy

### Appliance does not work, the display is off

- Is the appliance switched on properly?
- Is the mains plug properly inserted in the socket?
- Is the socket fuse intact?

### Loud running noise

- Is the appliance standing firmly on the floor, or does the compressor cause nearby items of furniture or objects to vibrate?

If necessary, move the appliance slightly, align by adjusting the adjustable feet, or move bottles and containers apart.

- **Bubbling noises** are normal. These are caused by the refrigerant flowing round the refrigerant circuit.

A short **clicking sound**: This will be heard whenever the refrigeration unit (the motor) switches on or off automatically.

**Motor noise**: This will be slightly louder for a brief period when the refrigeration unit switches on. The refrigerating capacity will increase when the SuperFrost function is activated, fresh food has just been placed in the appliance or the door has been left open for a while.

### The compressor will continue to run for a while

- On energy saving models, this is caused by the functions and is perfectly normal. When less refrigeration is required, the VCC compressor switches to a low speed. It will then be running almost constantly, but it does save energy.

### The audible warning signal sounds, the temperature is not cold enough

- Have you put too much fresh food into the freezer **without** activating SuperFrost? (See "SuperFrost")
- Does the door close properly?
- Is the appliance sufficiently well ventilated? Clear ventilation grilles if necessary.
- Is the ambient temperature too hot? (See "Safety regulations")
- Has the appliance been opened too often or left open too long?
- If applicable, wait until the appliance reaches the required temperature itself.

### **ERR** appears in the display

There has been a power failure; proceed as described in "Power failure/FrostControl display".

### Customer service and type plate

If none of the above causes apply and you cannot rectify the fault yourself, or if the temperature display reads "F 0" to "F 5", this means that there is a fault. Please contact your nearest customer service department (see enclosed list for addresses), indicating the **warning displayed**, together with the

**type designation** ①, **service No.** ②, **serial No.** ③

of the type plate. This will help us to provide you with a faster and more accurate service. The type plate is located inside the appliance on the left-hand side.

Leave the appliance shut until the customer service engineer arrives so as to prevent any further cold loss.

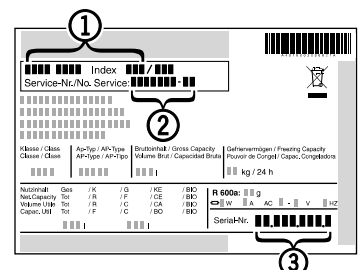

# Installation instructions

for refrigerators, BioFresh appliances, freezers, for integrated use  
with door-on-door system

GB

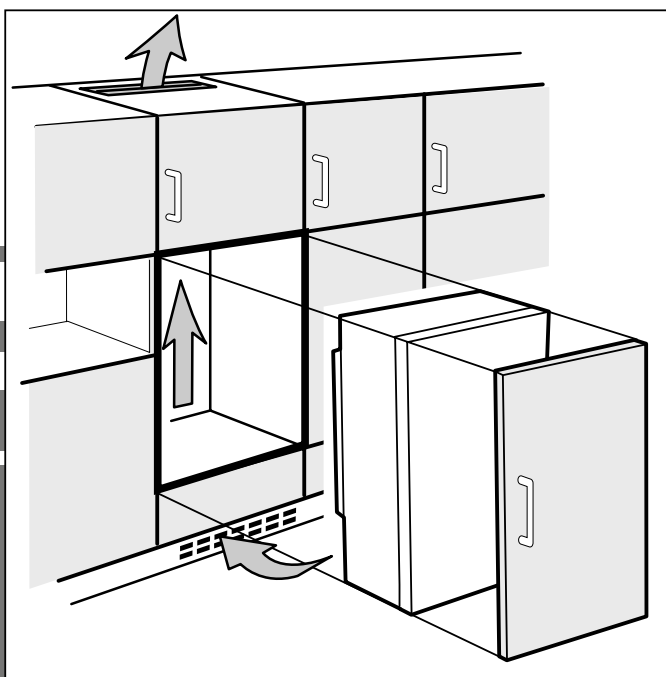

**7082 584-01**

IK/IKP/IKB/IG 1007



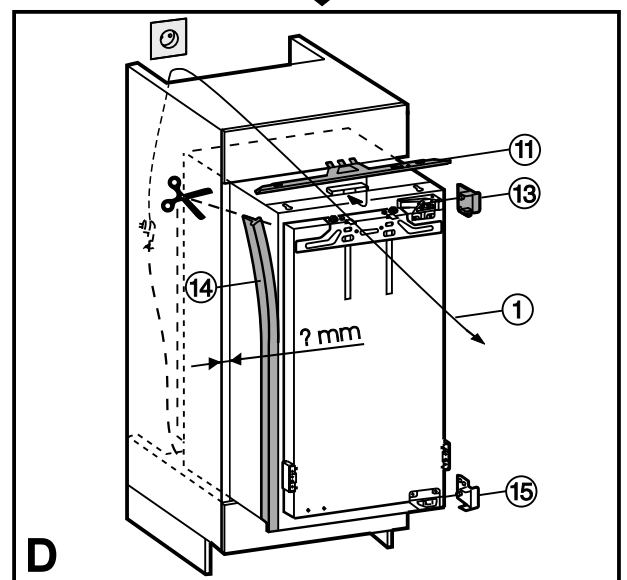
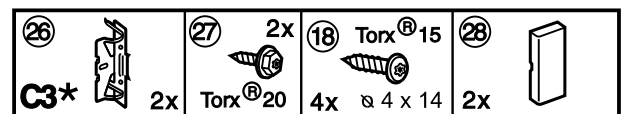
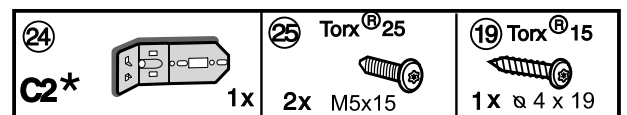
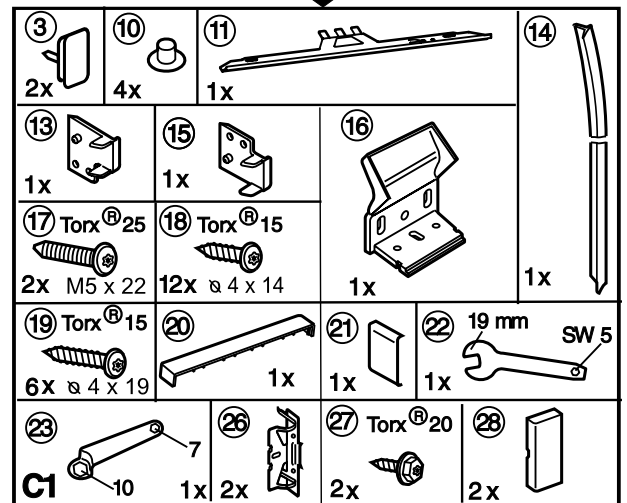
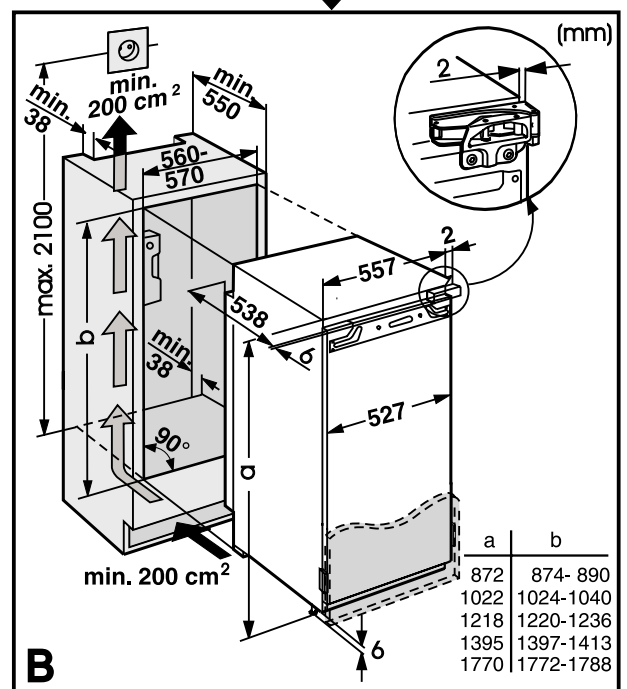
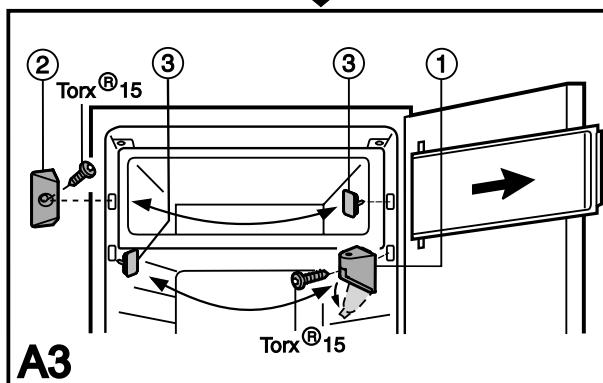
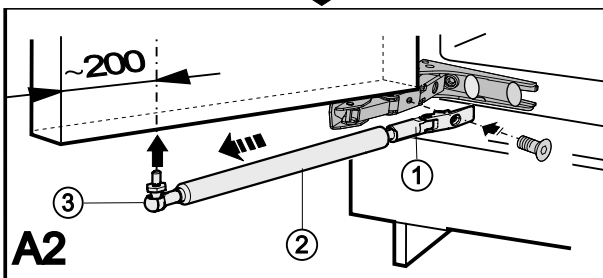
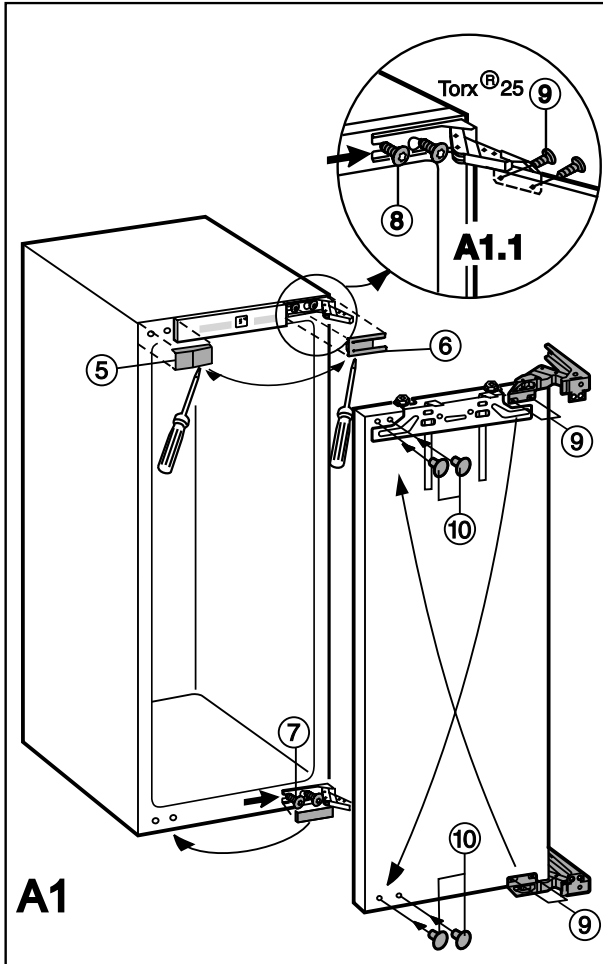
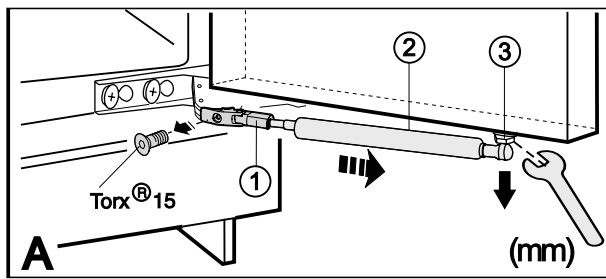

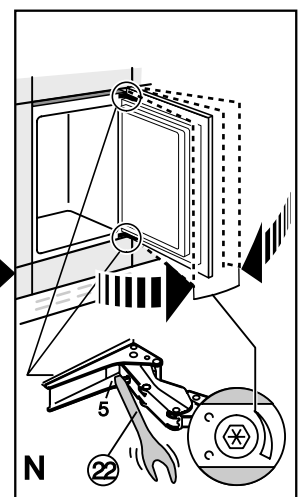
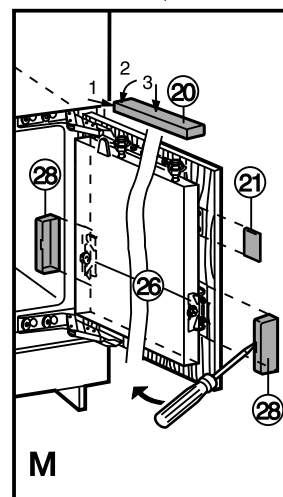
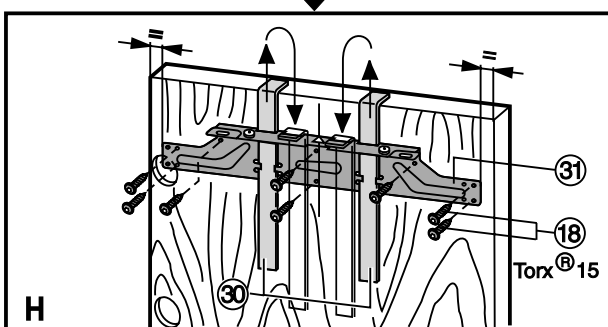
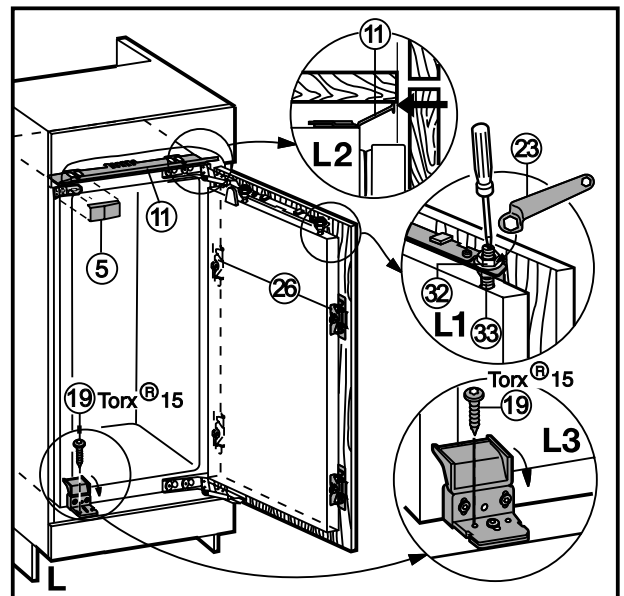
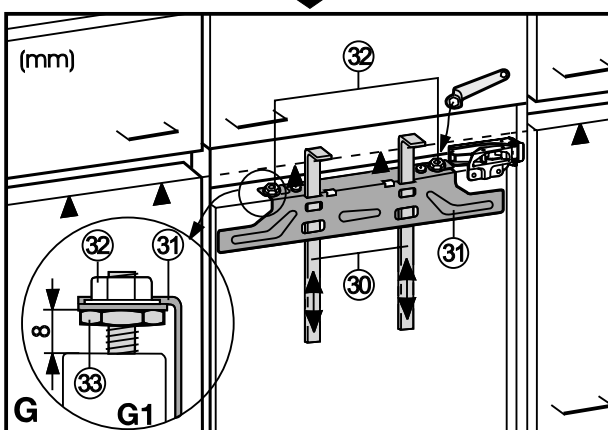
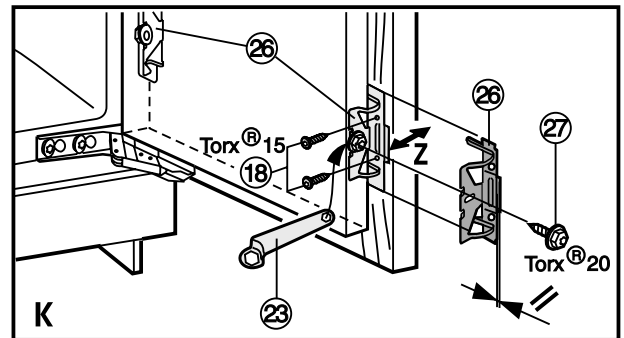
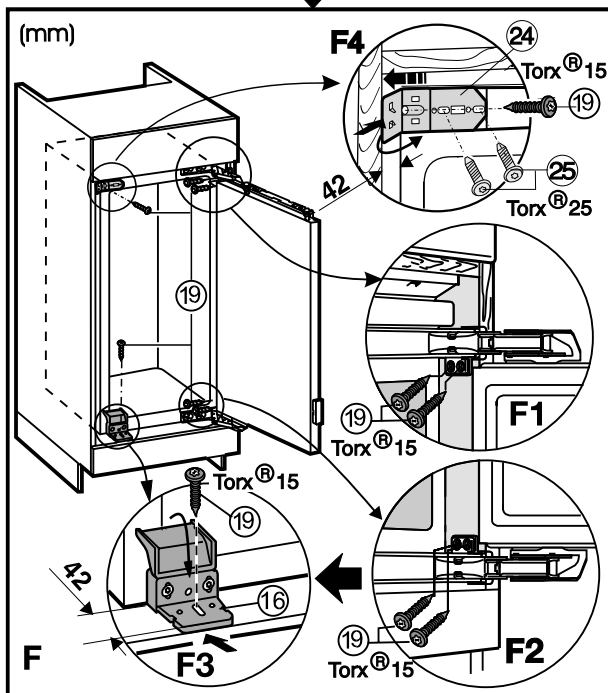
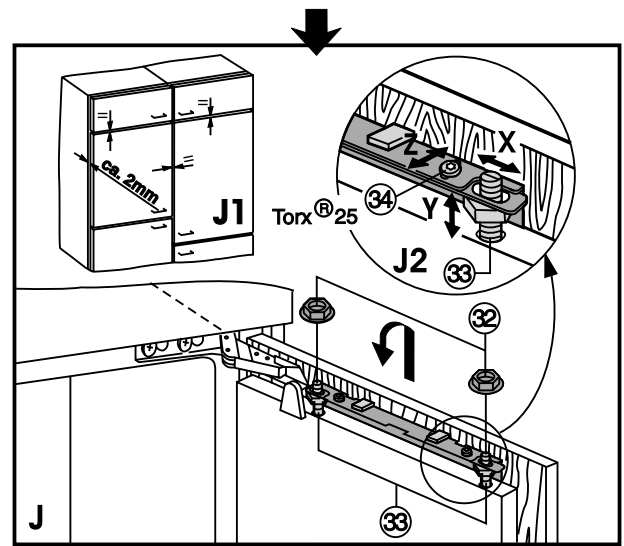
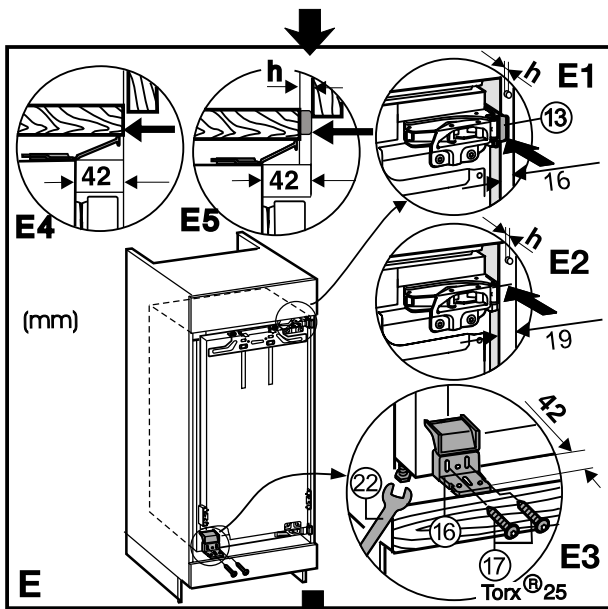

# Installation instructions

Keep the installation instructions in a safe place and pass them on to the next owner of your appliance where applicable.

The operating instructions apply to several models. Differences may therefore occur. Before reading, please fold out and refer to the illustrated front page.

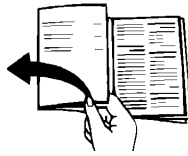

You additionally require the following tool for installation:  
Cordless screwdriver Torx®15, 20, 25, spanner 13.

## Changing over door hinges

Fig. A1 The door hinges can be changed from one side to the other if need be. Otherwise continue from "Installation information", fig. B.

- To simplify installation, slide the appliance three-quarters of the way into the recess. Open the door.

**For models with soft stop ② \*** proceed according to fig. A (otherwise continue according to fig. A1).

For appliances 870 mm high: remove the lower storage rack for easier installation.

- Fig. A: Remove the door closer:  
**Important:** When detached, the door closer will snap shut!
- Unscrew fastener ①
- Unscrew the ball pivot ③ together with the door closer from the door and put to one side.
- Fig. A1, lift off cover parts ⑤, ⑥ and ⑦ in a forward direction using a flat-blade screwdriver.
- Detail fig. A1.1: Loosen the attachment screws ⑧ on the top and bottom of the body of the appliance.
  - Pull the door outwards and remove.
- Transfer the attachment screws ⑧ to the other side and screw in a little way.
- Fig. A1: Unscrew the door attachment screws ⑨ and replace the hinges in the diagonally opposite corner.  
**NB:** Do not fold the hinges together - danger of injury!
- Use a cordless screwdriver to screw down the hinges - the screws ⑨ are self-tapping.
- Close the holes on the other side with the plugs ⑩.
- Suspend the appliance door in the ready inserted screws ⑧ and tighten screws.



**For models with soft stop ② \***

- Fig. A2: Re-attach the door closer ② \*:
- Screw on the fastener ①.
- Screw the ball pivot ② with the door closer into the new retaining hole.
- Fit all the cover parts back in place.

## Changing the compartment door

- Fig. A3: At the hinge ① fold away the cover. Unscrew the hinge ① and remove the compartment door with the hinge.
- Unscrew the closure ②.
- Close the holes with the plugs ③.
- Rotate the door and closure by 180° and replace on the other side: Insert the compartment door at the top, put the hinge ① in place at the bottom, screw down again and close the cover.

## Installation information

- This appliance can also be used to **replace an existing appliance**.  
In this case, remove the hinges on the unit door and in the recess. They are no longer needed as the unit door is fitted to the appliance door.
- Fig. B: Align the unit with a spirit level and an angle. If necessary, level out by building up from underneath. The shelf and side walls of the unit must be at right-angles to one another.
- Fit the refrigerator/freezer in stable kitchen units only.
- The following ventilation gaps must be observed:
  - The depth of the ventilation channel at the rear of the unit must be at least 38 mm.
  - There must be a ventilation space of at least 200 cm<sup>2</sup> underneath and at the top of the unit. the greater the area the more economically the appliance will run.
- Check installation dimensions in accordance with fig. B: Appliance height a, recess height b

## Connecting to the mains

### Power supply (AC) and voltage

at the operating point must comply with the details on the type plate. It is located inside the appliance on the left-hand side.

- The appliance must be connected with a properly installed fused socket.
- The fuse of the plug has to be 10 A or more, it must be situated away from the rear area of the appliance and be easily accessible.
- Do not
  - connect to stand-alone inverters,
  - operate with so-called energy-saving plugs - this can damage the electronic system.
  - connect together with other appliances using an extension cable - danger of overheating.
- When removing the mains cable from the back of the appliance, remove the cable holder to prevent vibration noise.

## Installation and fitting

Figs. C1-3: All installation components are supplied.

- Fig. D: Fit equaliser trim (1) centered on the appliance: slide into the channel and engage in the key holes.
- Route the mains cable with the aid of string (1) in such a way that the appliance can be easily connected after installation.
- Slide the appliance three-quarters of the way into the recess.
- Note the thickness of the unit walls:  
**For 16 mm unit wall** (568 mm recess):
- Fig. D: Stick sealing strip (14) onto the side of the appliance on the handle side flush with the front: remove the protective film and stick on; shorten to recess height if necessary.
- Clip spacers (13) and (15) onto the hinges.
- Fig. E: Slide appliance into the recess until the spacers make contact with the side of the units, Fig. E1.  
**For 19 mm unit wall** = 562 mm recess:
- Fig. E2: Slide the appliance into the recess until the fronts of the hinges are flush with the sides of the unit walls.
- Fig. E3: Level the appliance by adjusting the adjustable feet with the spanner provided (22). Align the body of the appliance parallel to the front edges of the side walls of the unit, Fig. E4.
- Screw plastic bracket (16) onto the handle side of the appliance with M5 screws (17).
- Make sure the front of the plastic bracket (16) is flush with the front edge of the floor of the unit.
- **Please note:** in the case of units with **door stop components** (knobs, sealing lips etc.), allow for the extra distance **h**!  
Draw the appliance forwards by the extra distance **h**, Fig. E5!  
Pay attention that the appliance is positioned in the recess so as to be parallel and at uniform depth all the way round. The distance between the front edge of the plastic bracket/spacers/hinges and the body of the appliance has to be 42 mm!
- Press the appliance on the hinge side against the wall of the unit
- Fig. F: Screw the appliance into the recess.
- Figs. F1/2: Screw in with long wood board screws (19) through the hinge plates at the top and bottom.
- Fig. F3: Screw in temporarily with a long screw (19) through the middle of the long slot on the plastic bracket (16). Fold up the cover on the plastic bracket.
- For appliances 1770 mm high: additionally loosely fix the mounting bracket (24) according to Fig. F4 with screws (25). Press the bracket against the side wall and tighten the screws (25). Align the front edge of the angle flap so that it is flush with the side wall; however in case of sealing lips/knobs allow it to protrude by the extra distance **h**, Fig. E5. Pay attention that the appliance is positioned in the recess so as to be parallel and at uniform depth all the way round (distance between front edge of mounting bracket/plastic bracket/spacers/hinges and the body of the appliance has to be 42 mm)! Tighten with screw (19), fold in the angle flap.

## Fitting the unit door

- Fig. G1: Check the 8 mm pre-setting (distance between appliance door and bottom edge of attachment strut).
- Fig. G: Slide the fitting aids (30) up level with the unit door, underside of stop edge ▲ of fitting aid = upper edge of unit door
- Fit the attachment strut (31) on the unit door:
- For this purpose, unscrew the strut by way of the counter-nuts (32) Fig. G

- Fig. H: Suspend the strut with the fitting aids (30) on the inside of the unit door and align centrally (draw a short line in the middle of the unit door, align the arrow on the strut with it keeping the same distance to outer edges on left and right).
- Fasten the attachment strut (31) in the centre:
- Fig. H: with at least 6 screws if the doors are made of wood board,
- with 4 screws round the edge in the case of panel doors.
- Lift the fitting aids (30) out to the top, turn round and insert into the adjacent openings.
- Fig. J: Suspend the unit door on the door of the appliance/ adjusting pins (33). Screw the counternuts (32) loosely onto the adjusting pins. Close the door.
- Fig. J1: Check the gap between the door and the surrounding unit doors.
- Fig. J2: Align the unit door flush with the surrounding unit fronts: align laterally (X) by sliding in the corresponding direction, adjust height (Y) and lateral tilt with the adjusting pins (33) using a screwdriver.
- Tighten counternuts (32).
- Fig. K: Secure the mounting bracket (26) to the pre-drilled holes in the appliance door using the hexagonal screw (27).
- Screw the appliance door onto the unit door with the attachment brackets (26):
- Ensure that both metal edges are flush (symbol //). Drill attachment holes (making a hole with a bradawl) and screw tight.
- Adjust the depth of the unit door (Z):
- Fig. J2: top: loosen screws (34),
- Fig. K: bottom: loosen the hexagonal screws (27) with the ring spanner (23) provided and adjust the door.
- Fig. J1: Allow an air gap of approx. 2 mm between the unit door and the body of the unit. Do not allow knobs and sealing lips to make contact with the appliance as this can have a detrimental effect on its function.
- Fig. L: If the unit door is large or divided into separate parts, attach another pair of attachment brackets (26) (accessories bag, fig. C3). Use the pre-drilled holes in the handle area of the appliance door.
- Check that the door is properly positioned, and readjust if necessary. Tighten all screws.
- Fig. L1: Tighten the counternuts (32) with the ring spanner (23) provided, holding the adjusting pins (33) in position with a screwdriver.
- Fig. L2: If necessary, align the equaliser trim (11) parallel with the floor of the unit. It must not project.
- Fig. L3: Fix the appliance in the round hole at the bottom with the second screw (19) through the plastic bracket.
- Snap cover (5) into place.
- Fig. M: Fit all the remaining covers:
- Place the top cover (20) in position and click into place.
- Place lateral cover (21) in position, slide it to the limit, then press on the cover until it audibly engages.
- Slide on cover (23) laterally, draw the cover forwards using a screwdriver according to fig. M so that it engages well into place.
- Fig. N: The opening resilience of the door can now be adjusted. Adjust using the no 5. Allen key provided.
- Turn clockwise for stronger resilience.
- Turn anticlockwise for = weaker resilience (factory setting).

The manufacturer works constantly on the further development of all the types and models. Therefore please understand that we have to reserve the right to make design, equipment and technical modifications.