



ECONOVA DATA SHEET

- ✓ High quality, efficient and energy saving
- ✓ Industry leading technology and innovation

ECON-330FREC-WR



BOOSTER
ELEMENT



Wi-Fi



ECONOVA

Model Specifications	ECON-330FREC-WR
Wi-Fi	Yes
1st Hour Delivery	>350 Litres
Tank Volume	330 Litres
Compressor Input Power	1020 Watts
Suitable for Rooms	3 to 7
Recovery Rate	99 Litres/Hour
Set Hot Water Temperature	68°C
Heat Pump Heating Capacity	4998 W
COP *	4.6 W/W
Booster Element Heating Capacity	4800 W
Fittings (Inlet & Outlet)	32mm / G1 ¼
Return Inlet	32mm / G1 ¼
Height	1756 mm
Width	620 mm
Heat Pump Height	610 mm
Heat Pump Width	840 mm
Heat Pump Depth	285 mm
Circuit Breaker Amps	32
Power Supply	220-240V/50Hz
Operating Temperature Range	-7°C ~+43°C
Refrigerant Type	R290
Protection Ranking Class	IPX4
Max. AMPS	28

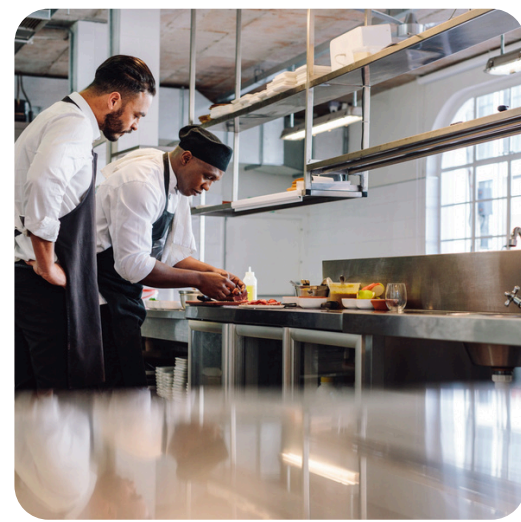

* All listed specifications are measured at inlet water temperature +14°C; Dry Bulb Temperature +19°C, wet bulb temperature 15°C, and hot water set point 55°C. Recovery rates vary with environmental conditions.

This water heater features fully welded enamel tank meeting the design requirements: AS/NZS 2712 and AS/NZS 60335.2.40. This water heater complies with AS 3498 and AS/NZS 1677.2

* Hot water temperature is limited to 68°C

** Note, commercial 330 litres model have reducer to 20mm / G ¾ available

Drawings

ECON-330FREC-WR

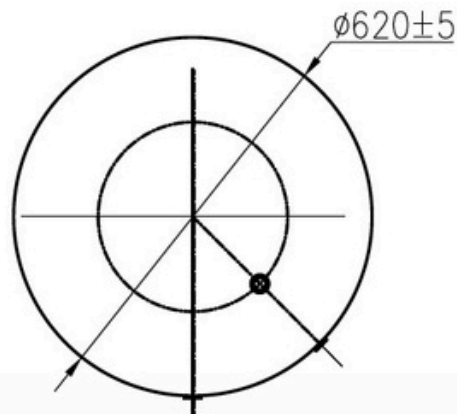
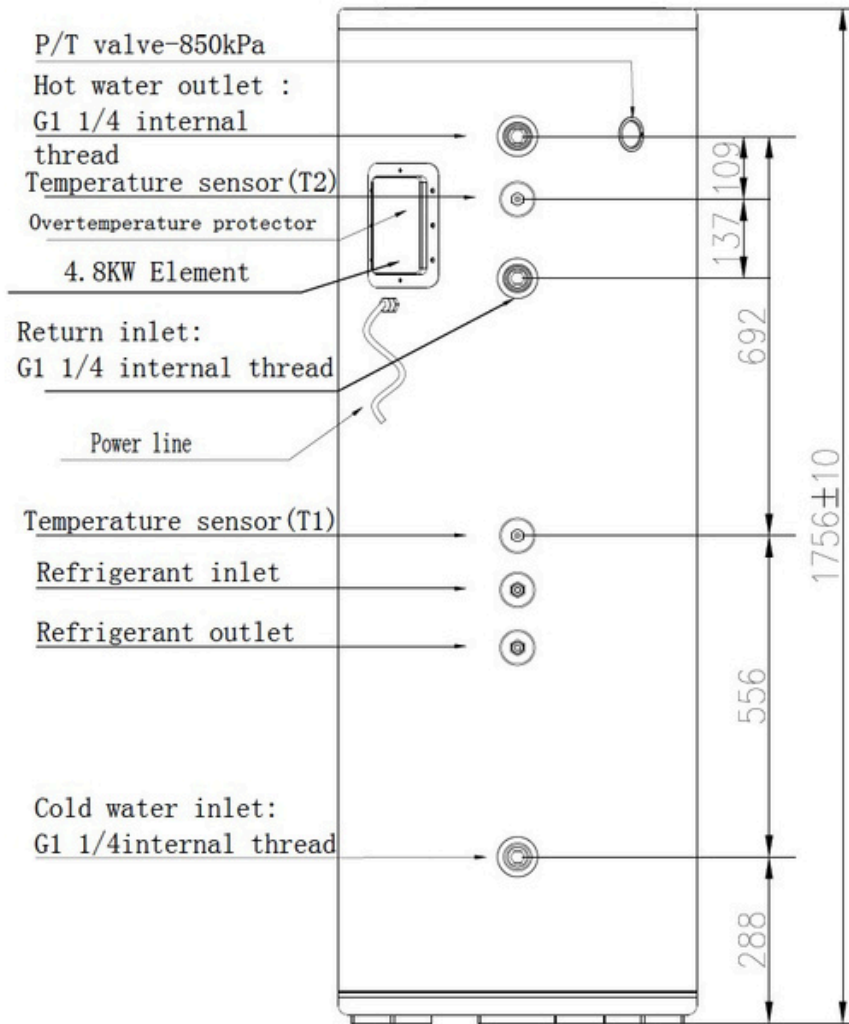

Drawings

ECON-330FREC-WR Exploded View

WARNING DO NOT OPEN
Only ECONOVA® or licensed tradesperson can open this unit.

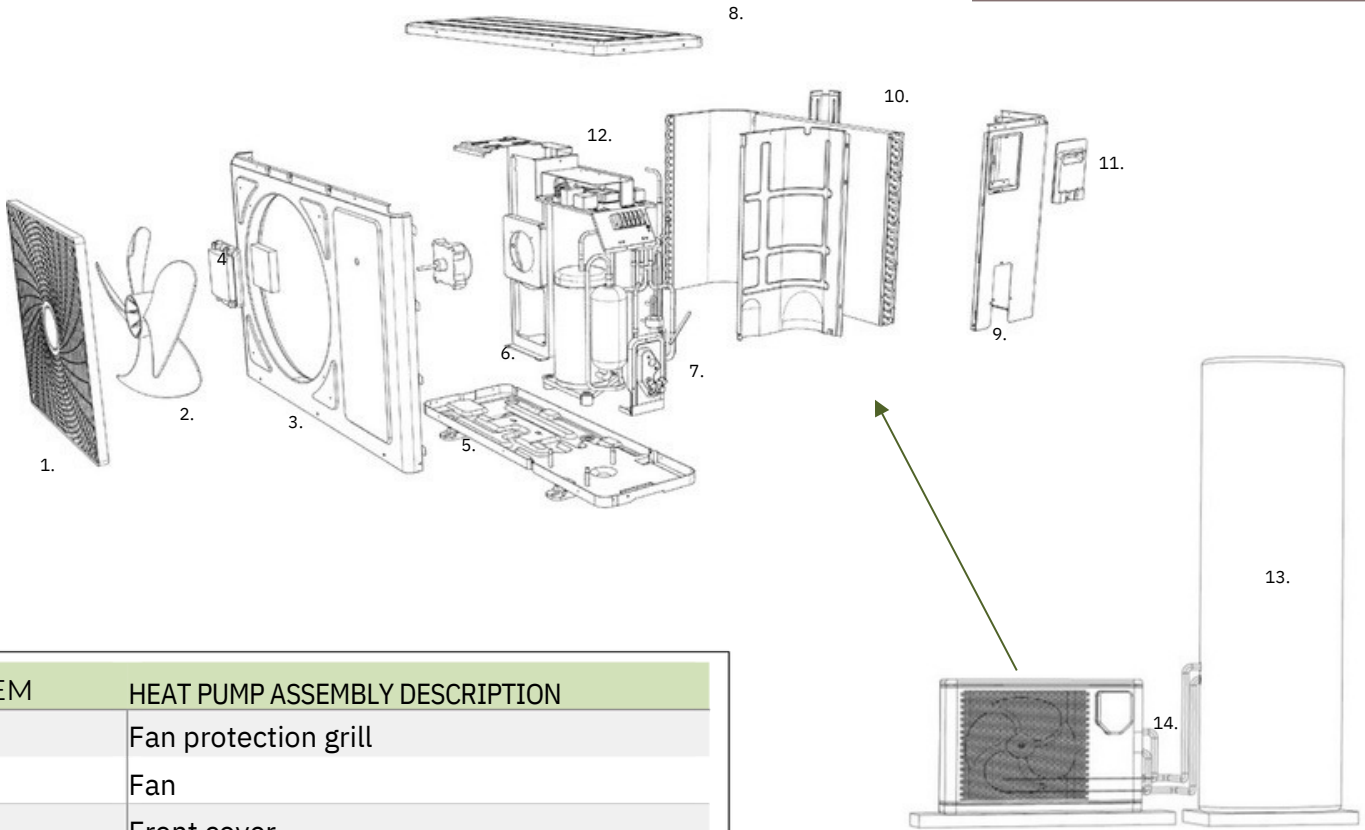

ITEM	HEAT PUMP ASSEMBLY DESCRIPTION
1	Fan protection grill
2	Fan
3	Front cover
4	Controller
5	Condensation drain
6	Compressor assembly
7	Schrader valve & Quick condenser connection
8	Top cover
9	Rear casing assembly
10	Evaporator
11	Power cable cover
12	Circuit board
13	Condenser tank
14	Condenser pipe (pair coil)

