

Model Code/s:
ETL95



Residentia

Model Code/s:
ETL95

Product:
**9.5kg Top Load
Washing Machine**

Document:
User Manual

Esatto





Contents







| | |
|--|----|
| Safety and precautions..... | 2 |
| Installation of the washer..... | 5 |
| Preparation before washing..... | 7 |
| Parts identification of the washer..... | 8 |
| Instruction of the washer operation panel..... | 9 |
| Quick start..... | 11 |
| The main wash..... | 12 |
| Special features..... | 13 |
| Cleaning and Maintenance of the washing machine..... | 15 |
| Identify usual trouble of washer..... | 16 |
| Malfunction display and solutions..... | 17 |
| Technical specifications..... | 18 |

Safety and precautions

Observe the following items in order to prevent from injuring yourself, others and the damage of property:

| | | |
|---|---------|--|
|  | Warning | This indicates serious injury or death to human being may be caused. |
|  | Caution | This will remind you that injury to people and damage to property may occur. |

Please observe following contents of graphics.

| | |
|---|---|
|  | This graphics represents(cause attention), and detailed cautions will be displayed inside the graphics.  |
|  | This graphics represents (operation prohibited), and detailed prohibitive items will be displayed inside the graphics.  |
|  | This graphic represents (forcible execution), and detailed forcible execution items will be displayed inside the graphics.  |
|  | This appliance is not intended for use by persons (including children) with reduced physical, sensory or mental capabilities, or lack of experience and knowledge, unless they have been given supervision or instruction concerning use of the appliance by a person responsible for their safety. Children should be supervised to ensure that they do not play with the appliance. |



Warning

Please do not disassembly and assembly the machine without authorization.



No dismantling

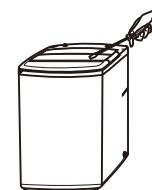

Please do not insert your hand and take out clothes inside the spin barrel before it is fully stopped.



No touching



Please do not install the machine in damp and raining environment to avoid electric shocking, catching fire, faults and distortion accidents.



No dampness



Please do not directly rinse the machine with water when cleaning.



No rinsing





Warning

Please do not let children climb the machine or peer into the rotating spin barrel to avoid accidents.



Prohibited

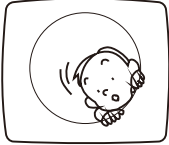

It is prohibited to wash the clothes touching with kerosene, gasoline, alcohol and other flammable materials.



Prohibited



Please do not damage power flexible cord and power plug to avoid electric shocking, short circuit and catching fire.



Prohibited

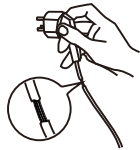

Regularly clean the power plug to remove dust and dirt to avoid contact failure.



Please pull out plug from the socket if the machine is not in use.



Pull out the plug

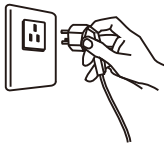

Please well connect the earth line of socket to avoid electric shocking by accidental leakage.

(earthing)



Earthing

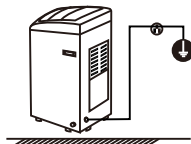

Please insert the power plug tightly.

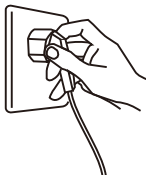

Please do not place on the washer burning candle, mosquito-repellent incense, cigarette and other flammable things, as well as electric stove, air heating fan and other heating sources.



Smoke and fire prohibited



Please use correct power source.



Please do not pull out or insert the plug with wet hands to avoid electric shocking.



Wet hands are prohibited

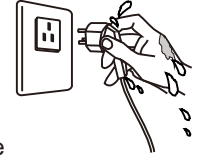

Caution

Please ensure that the water inlet pipe is connected and the tap is opened before washing clothes.

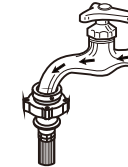

The water temperature shall not exceed 50°C when washing with warm water.



Prohibited



Customers are not allowed to change the power line without permission.



Prohibited



It is strictly prohibited to place children or lay weights on the washer.



Prohibited

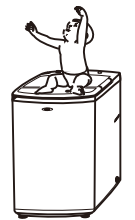

Please do not pull the electric cord when pulling out the plug.



Please do not wash down jacket, raincoat, fishing coat and similar clothes in the washer.



Prohibited



Installation of the washer

Remove package

- Remove package and take out the bottom board of the cabinet on the foam cover.
- Open the lid of washer's door and take out accessories.
- A trial operation or washing on the foamed cushion is strictly forbidden.

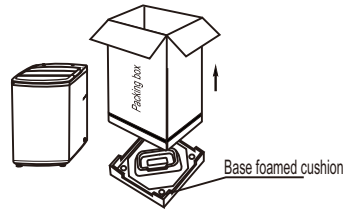

Installation of drain hose

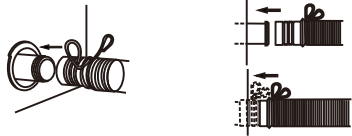

- Completely sleeve the drain hose over the sewer.
- Fix and tighten it with a hoop. (As shown in the figure)

Placement of water drain hose

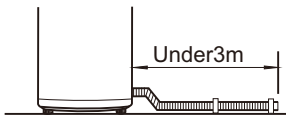

If the water drain hose shall be extended, its length shall not exceed 3 meters, otherwise it will affect the water discharging time.

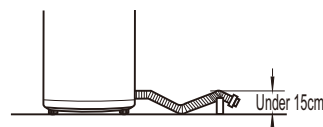

The placed height of water drain hose shall not exceed 15cm.



Do not bend the water drain hose and place it under the washer.

FOR LOWER DRAIN SYSTEM ONLY

Placement of upper water drain hose

- The height of drain hose ("a") should be between 86-100 cm.
- Diameter of "b" should not be less than 3 cm, and flow capacity not less than 40 L/Min.
- Before washing machine starts, user should hang up the drain pipe 86-100cm height from the floor.

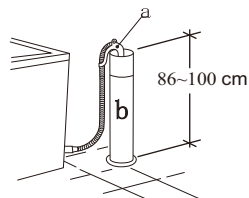

FOR UPPER DRAIN SYSTEM ONLY

Installation of water inlet pipe

- Put the water inlet pipe (which has metallic filtering bag) screw on to the tap.
- Tightly screw another end of water inlet hose on water inlet valve. (with rubber seal ring inside).

Note: When tightening the clamping nut, evenly apply the force and do not twist the water inlet valve to avoid breaking of water inlet valve joint.

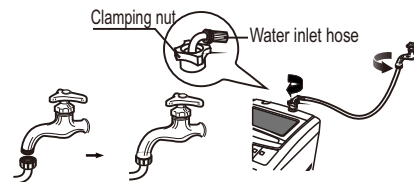

Only for model with double screw thread water inlet pipe

Installation of the washer

Installation of water inlet pipe

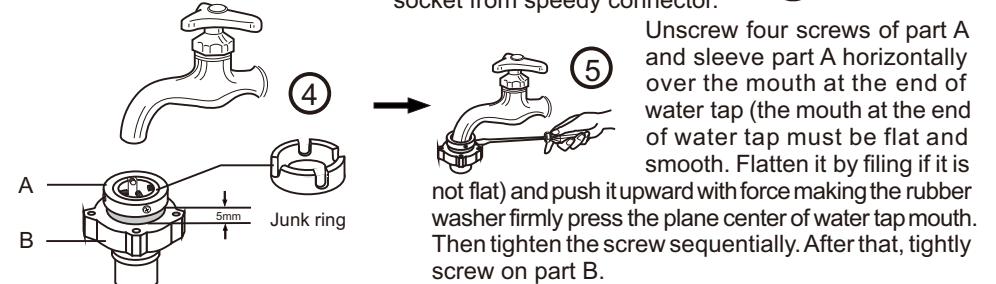
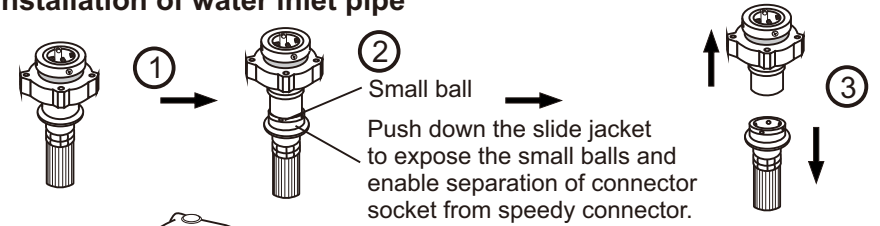

The connection socket consists of A and B two parts. Before installation, A and B two parts must be unscrewed about 5mm, or directly disconnected. If the bore of water tap is larger, remove the plastic junk ring of part A.



Connect

Connect: Push down the slide jacket of speedy connector (4 small balls must be exposed), insert it into the connection socket and then push upward. Release the connection of water tap with speedy connector completely. If it is required to feed water, simply open the water tap. Separate: Close the water tap, push down the slide jacket of speedy connector and pull out the speedy connector.

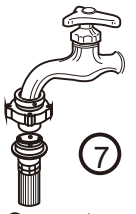

Separate

Tightly screw another end of water inlet hose on water inlet valve. (with rubber seal ring inside).

Note: When tightening the clamping nut, evenly apply the force and do not twist the water inlet valve to avoid breaking of water inlet valve joint.

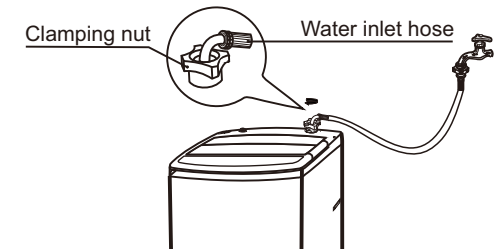

Only for model with single screw thread water inlet pipe



If the supply cord is damaged, it must be replaced by the manufacturer, its service agent or similarly qualified persons in order to avoid a hazard. The instructions for appliances connected to the water mains by detachable hose-sets shall state that the new hose-sets supplied with the appliance are to be used and that old hose-sets should not be reused. The openings must not be obstructed by a carpet. This appliance is for indoor use only.

Preparation before washing

1 Adjust the adjustable foot to make the washer be placed stable.

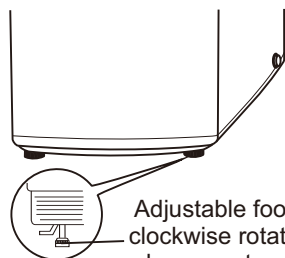

Adjustable foot (extend when clockwise rotating and shorten when counterclockwise rotating)
(Slightly incline the washer first and loosen the adjustable foot knob. Adjust the adjustable foot so as to ensure four corners of washer be steadily contacted with the ground. Then tighten the adjustable foot knob and lock it. If the ground is obviously not flat, correction should be made on the ground surface, otherwise the washer barrel will incline and knock the cabinet)

2 Install the water inlet hose.

For one inlet hose

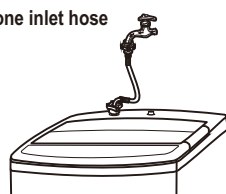

For two inlet hoses

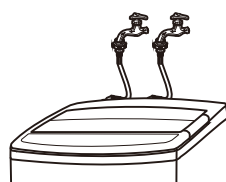

3 Connect with to power source.



4 Turn on the water supply.

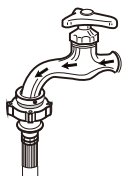

5 Put down the drain hose.

Gravity drain

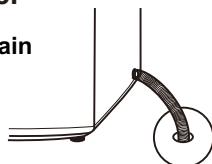

Upper drain

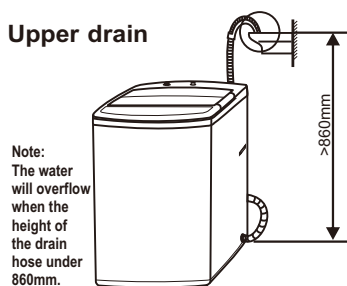

Note:
The water will overflow when the height of the drain hose under 860mm.

6 Put in clothes and suitable amount of washing powder.

NOTICE Before washing, please do take out coins, keys and other hard goods, and zip up clothes tightly to prevent them and barrel from damage.



Parts identification of the washer

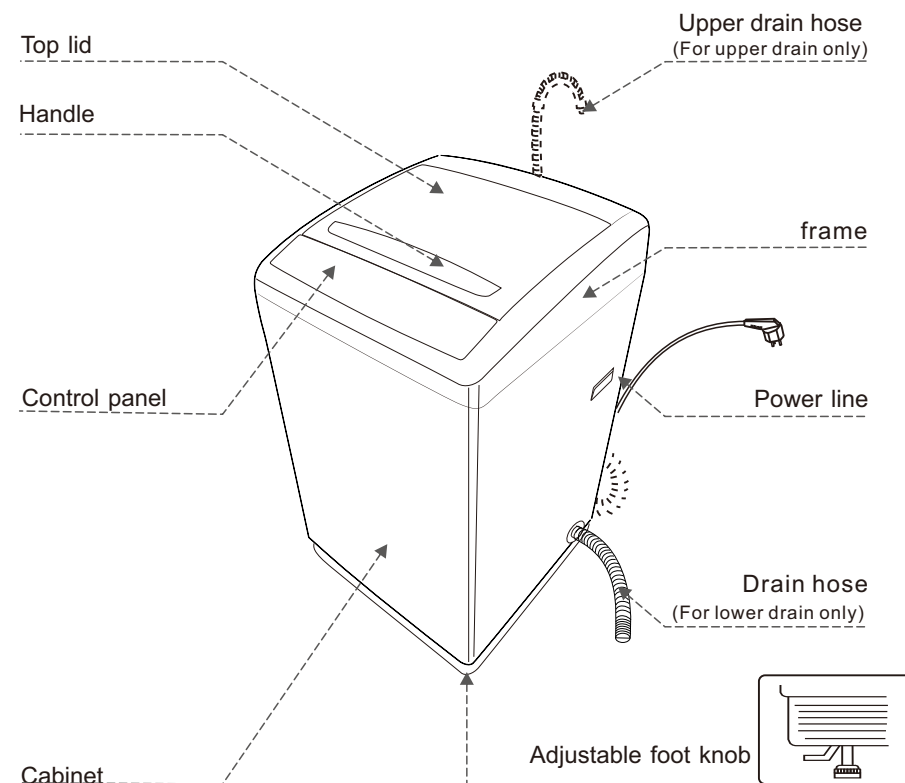

Accessories

Fixing ring (1) is used for the fixing in time of the installation of the lower drain hose.

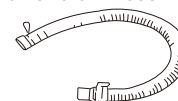

Only for lower drain hose



Universal connector

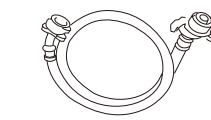

Water inlet hose assembly

Only for model with single screw thread water inlet pipe

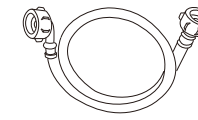

Water inlet hose assembly

Only for model with double screw thread water inlet pipe



Self-tapping screw

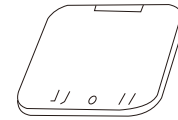

Base cover

Only for models including base cover

Please refer to the real material as the attachment

Instruction of the washer operation panel

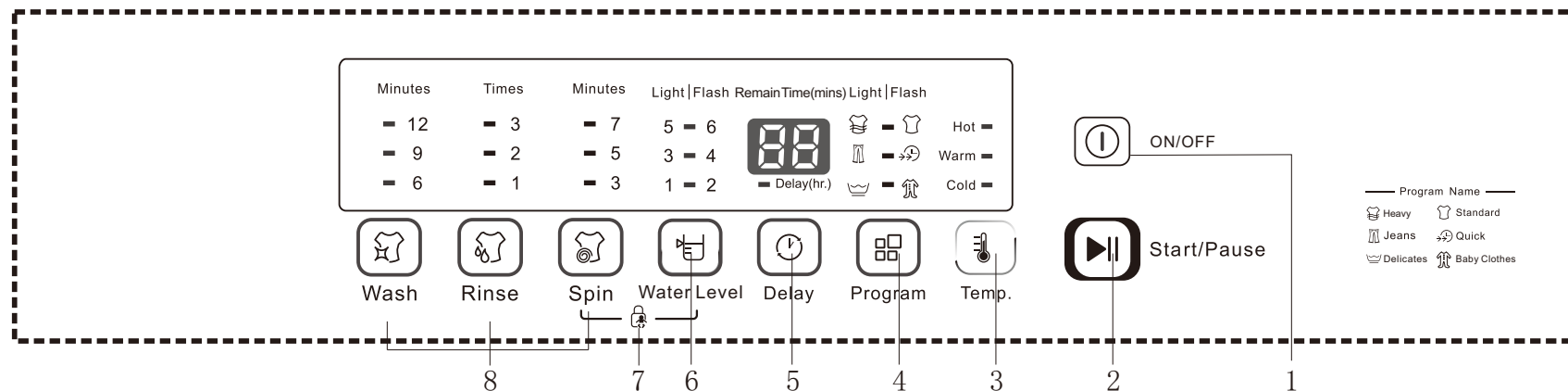

1.Power

On & off power
Automatic power

2.Start/Pause

After program selection, Press the button to start. Press the button to pause in the course of operation, press the button again the program continues till the program is finished.

3.Temperature

Press this button to select water temperature for washing.
Cold light only indicates Cold Water selection .
Warm light only indicates Warm Water selection .
Hot light only indicates Hot Water selection.

4.Program

Can select fully automatic program like:
Heavy(light) Standard(flash)
Jeans(light) Quick(flash)
Delicates(light) Baby Clothes(flash)

5.Delay

Press the button to preset delay time. Less than 24 hours each press the button, the delay-time is added an hour .
the preset indicator is come back origin status.
If always press the button, the delay time will automatically change.

6.Child lock

Press the "Water level" and "spin" at the same time to lock buttons on control panel.
Press the "Water level" and "spin" at the same time again to unlock buttons.

7.Water level

Press the button, by washing quantity select water level position in reason .The indicator lights move at each press on the button, and light and flash in turn.

8.Function

Press the wash button to select the time of wash .
Press the rinse button to select the time of rinse .
Press the spin button to select the time of spin .

⚠ * If the drawing is changed, no information anymore.
To protect the control panel, the interval time of power on and off should be not less than 30 seconds.

Quick start

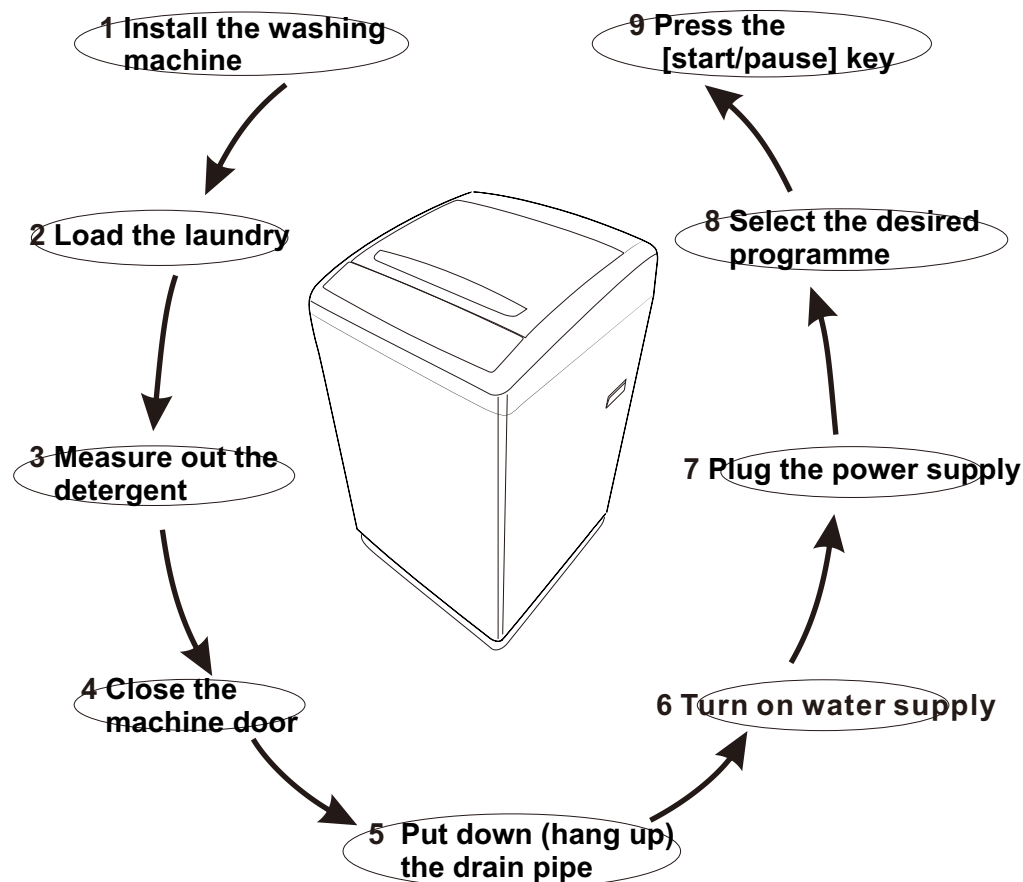

Program selection

- 1 Press the ON/OFF button.
- 2 Select the proper water level and other attached functions.
- 3 press the start/pause key.

The wash stops

- When the wash stops, the buzzer will buzz continuously for 6 times and then the power will be automatically cut off.
- Turn off the water tap.
- Although the power can be cut off automatically, the power plug must be pull out for the safety.

The main wash

Instruction of the STANDARD program

- 1.[Standard] wash program is the easiest, most convenient and most common washing program. When the user press the power switch and then press [Start/Pause] button, the standard washing program will start to work.
- 2.When the washer start to work, the digital tube show the remain time. The indicator light which stand for remaining time is flickering.

Steps in details

- 1.Press the ON/OFF switch.
- 2.According to the washing amount choose the proper water level.
- 3.Press START/PAUSE button.

Instruction to single wash procedure

- 1.User may freely select any single procedure, or any combination of procedures among WASH, RINSE and SPIN according to the actual requirements. It is only required to turn off any one or two of these three indicators that not needed by the user. And keep the indicator be on showing the process needed by the user.
- 2.Single wash -- after switching on the power, turn off RINSE and SPIN two indicators by pressing these two keys. The operation for single rinse and single spin is similar.
- 3.Single wash-spin -- after switching on the power, turn off RINSE indicator by pressing that key. The operation for single rinse-spin and single wash-rinse is similar.

Use the cleaning solution for twice

1. Put the laundry in the first batch and wash powder and press "wash" button to set single "wash" to run.
2. Take out the laundry in the first batch after hearing the buzzing sound.
3. put in the laundry in the second batch, and run "Wash", "Rinse", "Spin".
4. Take out the laundry in the second batch after hearing the buzzing sound.
5. Put in the laundry in the first batch and press "rinse", "spin" button to run "Rinse" and "Spin".

NOTICE

- 1.Close the lid of the door when machine is running, otherwise, it will automatically stop working during spin process and send out abnormal warning.
- 2.The washer will not work when the filled water does not reach the set water level.

Special features

Delay time program

Delay time means the preset beginning time of washing.

1. Switch on the power .
2. Open the tap and lay the drain hose.
3. Put in the laundry and detergent.
4. Select the proper water level according to the quantity of clothes.
5. Select the functions and programs.
6. Press "DELAY" button to select the beginning time of washing.
7. Close the lid and press "START/PAUSE" button.

RemainTime(mins)



Delay(hr.)

Confirmation of the delay and inspection

1. After the delay function is started, the corresponding delay light will flash, and other lights are turned off.
2. After the delay function is started, press "Delay" button continuously, you may inspect the preset program and function. Loosen the button, the program returns to delay status.

Cancel the delay time, or alternate the delay time

1. Press "Power" button to cancel the delay time.
2. To change the delay time, cancel the delay time first, and then press "Delay" button to reset.

Heavy :

Suitable to wash big size load such as curtain/bed sheet etc., There's 15mins additional movement soaking time during the washing process. (Movement soak can make the effect of soaking much better.)

Standard:

Standard fabric washing program, suitable to wash ramie cotton fabric. Wash for once, rinsing for twice, the spin time is a little long.

Jeans:

Suitable to wash heavy stained/wearable clothes.

Quick:

Suitable to wash light stained clothes and clothes in summer.

Delicates:

Mid/High/Low water level selection, the tempo is soft, slow washing and spinning speed, to make the lightest wear and deformation.

Baby Clothes:

Increase the rinsing times, to reduce the detergent residue on the clothes. Suitable to wash children's clothes.

Special features

Function of automatic power shut off

1. If the machine does not start to work within 10 minutes after powered on, it will power off automatically.
2. After end of operation and the buzzer sounding 6 times, it will power off automatically.

Function of adjusting for imbalance

1. If the laundry is placed uneven before spinning, it is likely to cause vibration during spinning. The washing machine has a function of adjusting imbalance. When working, the washing machine always inspects operation state automatically. If the spinning vibration is too great, the washing machine automatically starts the adjusting program to balance.
2. When the machine adjusts imbalance, rinse light will flash, and the machine will start to inject water to set water level. The machine adjusts imbalance automatically for about 1 minute, then drains water, returns to original spinning state. If the washing machine can adjust the imbalance twice. If the adjustment has no function, it will alarm.

Fuzzy control function

Standard procedures default implementation fuzzy control function. After startup, such as water level before starting the keys will be cancelled automatically according to the fuzzy control functions; In addition, the fuzzy measure before, if there is no water, tub fuzzy measurement, the water level directly as the default file namely 6 gear levels.

Fuzzy control function is at boot automatically after the determination of cloth is measured, decide the water level. In fuzzy testing process, water circulation flashing lights display, digital pipe display "--".

Power failure memory function

If the power supply becomes off suddenly during operation, the machine remembers the current operation state. When power is on, the machine returns to former operation state automatically.



Machine stop function of cover opening

Turn on the power, if open the door cover, all action of the machine ceases immediately, and the start-stop button is not optional; only shut the door cover can continue act, the start-stop button recovers to the optional state. If you open the door cover in the condition of dehydration, it would have alarm for the cover opening normally.

Energy efficiency test program:

During Standard washing program, it is identified as Efficiency Program .
The manufacturer declared that the water consumption of warm wash is not more than cold wash.

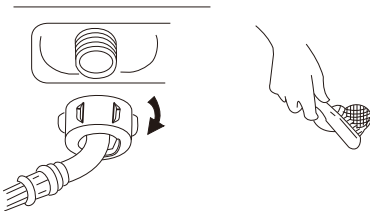
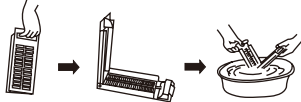
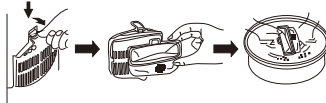
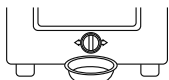
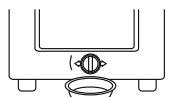
Cleaning and Maintenance of the washing machine

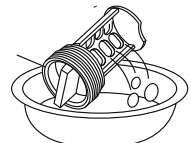
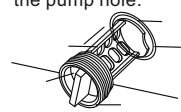
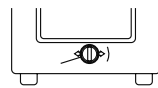
| End of program | Maintenance | |
|--|---|---|
| <ul style="list-style-type: none">• The washing machine will send off the sound of "dou-dou" at the end of any program operation to remind you to take out the laundry or operate it again.• After the sound ,the washing machine returns to its power-off state with no display and all lights off.• Please shut off the tap, pull out the plug when not in use to avoid water leakage or the fire accidents. | <p>Use gentle clothing to wipe off the water and dirt on the surface each time after using the washing machine. Detergent , propellant and other chemicals are not allowed to use so as to avoid any damage to the plastic accessories.</p>  | |
| Clean the water inlet | Clean Of the filter | |
| <p>After long time use, the water inlet mesh bag may be blocked with smudginess, and should be cleaned according to the following steps:</p> <ol style="list-style-type: none">1. Switch on the power, followed by shutting off the tap .2. Let the washer works for 5 seconds so that water flows into the tub through the water inlet hose.  | <p>After using the washing machine for a period, please clean it according to the following steps:</p> <ol style="list-style-type: none">1. Take out the lint filter.2. Open the filter and wash it clean in the water.3. Restore it and fix it.  <p>(only for magic filter)</p> <p>After using the washing machine for a period, clean it according to the following steps:</p> <ol style="list-style-type: none">1. Take off the lint filter.2. Turn over the mesh bag and wash it clean in the water.3. Restore and fix it.  <p>(only for normal filter)</p> | |
| Clean the lint filter in the drain pump (only for having drain filter) | | |
| <p>1. Drain the water out of the pump,under which use a container to collect.</p>  | <p>2. Loosen the pump cover anticlockwise.</p>  | <p>3. Take out the lint filter.</p>  |
| <p>4. Clean the filter.</p>  | <p>5. Restore it and adjust the convex place to align at the pump hole.</p>  | <p>6. Tighten the pump cover clockwise.</p>  |



Notes:

If the drain filter is not cleaned at proper time (every 10 times of use),Drain problem could be caused.

Identify usual trouble of washer

When the washer is in trouble, please contact local service office or the sales service department of our company and the customer should not dismantle the machine without permission.

If the washer can not work normally, or appear abnormality or alarms, please check and correct as follows.

List of faults and inspection

| Faults | Inspection Items |
|-------------------|---|
| No water flows in | <ul style="list-style-type: none"> If the power is off or the fuse is burned out. If the water supply is cut off or the water pressure is too low. If the inlet hose is properly connected and the water tap is opened. If the filtering screen of inlet valve is blocked by dirt. If the coil of inlet valve is damaged. (The slight electromagnetic sound is normal phenomenon when the inlet valve is switched on) If the "Start / Pause" button is pressed after the power switch is pressed. |
| No washing | <ul style="list-style-type: none"> If the power is off or the fuse is burned out. If the power supply voltage is too low. If the water amount reaches to the required water level. (The washer will not work if the water amount does not reach the required water level) If it is set to "Delay" washing mode. (It will only start to work until the reservation time reached) |
| Abnormal draining | <ul style="list-style-type: none"> If the water drain hose is placed very high. If the end of water drain hose is sealed in pond. If the internal rubber ring of drain valve is blocked by dirt. |
| Abnormal spin | <ul style="list-style-type: none"> If the door lid is closed. If all clothing piled largely at one side of barrel or the clothing is excessively placed. If the washer is not placed in stable condition or it is placed in inclination state. (The ground is not flat). If the motor belt is loosened. |

Note:

During the de spin process, if washing are piled at one side of the spin barrel, it will cause unbalance of spin barrel resulting in striking. At this moment, the computer inside the washer will feel this unbalance phenomenon and will automatically correct it (fill in water Washing). However, if unbalance situation is not removed after continuous three corrections, which means the computer auto-correction can not resolve the problem. Then the user has to manually and evenly place the clothing inside the barrel to solve the problem.

Malfunction display and solutions

When the washer is in trouble, please contact local service office or the sales service department of our company and the customer should not dismantle the machine without permission.
If the washer can not work normally, and the abnormal indication is shown in the nixie tube window or the machine alarms, please check and correct them as follows.

| Display | Causes | Solutions |
|---------|---|--|
| E1 | Alarm for abnormal water intaking. | Check the water tap is opened or not. |
| E2 | Alarm for water drain has not finished. | Check the water level sensor and drain pump. |
| E3 | Alarm for lid not closed before spin. | Closed the lid. |
| E4 | Alarm for washing stay at one side. | Manually balance clothes in the barrel by hands. |

Technical specifications

| | |
|-------------------------------------|------------------------|
| Overall dimensions (mm) | 601X625X1015 |
| Input power of motor | 600W |
| Rated power supply | 240V~/50Hz |
| Net weight | 45kg |
| Rated capacity of wash and spinning | 9.5kg (dry clothes) |
| Application water pressure | 0.1Mpa~0.6Mpa |

Warranty

WARRANTY TERMS AND CONDITIONS
LAUNDRY APPLIANCES

→ This document sets out the terms and conditions of the product warranties for Residentia Group Appliances. It is an important document. Please keep it with your proof of purchase documents in a safe place for future reference should you require service for your Appliance.

1. In this warranty
- (a) 'acceptable quality' as referred to in clause 10 of this warranty has the same meaning referred to in the ACL;

(b) 'ACL' means Trade Practices Amendment (Australian Consumer Law) Act (No.2) 2010;

(c) 'Appliance' means any Residentia Group product purchased by you accompanied by this document;

(d) 'ASR' means Residentia Group authorised service representative;

(e) 'Residentia Group' means Residentia Group Pty Ltd of 20 Yaltara Avenue, Bundoora Victoria 3083, ACN 600 546 656 in respect of Appliances purchased in Australia;

(f) 'major failure' as referred to in clause 10 of this warranty has the same meaning referred to in the ACL and includes a situation when an Appliance cannot be repaired or it is uneconomic for Residentia Group, at its discretion, to repair an Appliance during the Warranty Period;

(g) 'Warranty Period' means:

(i) where the Appliance is used for personal, domestic or household use (i.e. normal single family use) as set out in the instruction manual, the Appliance is warranted against manufacturing defects in Australia for 12 months following the date of original purchase of the Appliance;

(h) 'you' means the purchaser of the Appliance not having purchased the Appliance for re-sale, and 'your' has a corresponding meaning.
2. This warranty only applies to Appliances purchased and used in Australia and is in addition to (and does not exclude, restrict, or modify in any way) any non-excludable statutory warranties in Australia.
3. During the Warranty Period Residentia Group or its ASR will, at no extra charge if your Appliance is readily accessible for service, without special equipment and subject to these terms and conditions, repair or replace any parts which it considers to be defective. Residentia Group or its ASR may use remanufactured parts to repair your Appliance. You agree that any replaced Appliances or parts become the property of Residentia Group. This warranty does not apply to light globes, batteries, filters or similar perishable parts.
4. Parts and Appliances not supplied by Residentia Group are not covered by this warranty.
5. You will bear the cost of transportation, travel and delivery of the Appliance to and from Residentia Group or its ASR. If you reside outside of the service area, you will bear the cost of:

(a) travel of an authorised representative;

(b) transportation and delivery of the Appliance to and from Residentia Group or its ASR, in all instances, unless the Appliance is transported by Residentia Group or its ASR, the Appliance is transported at the owner's cost and risk while in transit to and from Residentia Group or its ASR.
6. Proof of purchase is required before you can make a claim under this warranty.

Continued over page →

Warranty continued

7. You may not make a claim under this warranty unless the defect claimed is due to faulty or defective parts or workmanship. Residentia Group is not liable in the following situations (which are not exhaustive):

(a) the Appliance is damaged by:

(i) accident

(ii) misuse or abuse, including failure to properly maintain or service

(iii) normal wear and tear

(iv) power surges, electrical storm damage or incorrect power supply

(v) incomplete or improper installation

(vi) incorrect, improper or inappropriate operation

(vii) insect or vermin infestation

(viii) failure to comply with any additional instructions supplied with the Appliance;

(b) the Appliance is modified without authority from Residentia Group in writing;

(c) the Appliance's serial number or warranty seal has been removed or defaced;

(d) the Appliance was serviced or repaired by anyone other than Residentia Group, an authorised repairer or ASR.
8. This warranty, the contract to which it relates and the relationship between you and Residentia Group are governed by the law applicable where the Appliance was purchased.
9. To the extent permitted by law, Residentia Group excludes all warranties and liabilities (other than as contained in this document) including liability for any loss or damage whether direct or indirect arising from your purchase, use or non use of the Appliance.
10. For Appliances and services provided by Residentia Group in Australia, the Appliances come with a guarantee by Residentia Group that cannot be excluded under the Australian Consumer Law. You are entitled to a replacement or refund for a major failure and for compensation for any other reasonably foreseeable loss or damage. You are also entitled to have the Appliance repaired or replaced if the Appliance fails to be of acceptable quality and the failure does not amount to a major failure. The benefits to you given by this warranty are in addition to your other rights and remedies under a law in relation to the Appliances or services to which the warranty relates.
11. At all times during the Warranty Period, Residentia Group shall, at its discretion, determine whether repair, replacement or refund will apply if an Appliance has a valid warranty claim applicable to it.
12. To enquire about claiming under this warranty, please follow these steps:

(a) carefully check the operating instructions, user manual and the terms of this warranty;

(b) have the model and serial number of the Appliance available;

(c) have the proof of purchase (e.g. an invoice) available;

(d) telephone the numbers shown below.
13. You accept that if you make a warranty claim, Residentia Group and its ASR may exchange information in relation to you to enable Residentia Group to meet its obligations under this warranty.

IMPORTANT Before calling for service, please ensure that the steps in point 12 have been followed.

Service: Please call 1300 11 HELP (4357)

Spare Parts: Please call 1300 11 SPARE (7727)

The Australian Consumer Law requires the inclusion of the following statement with this warranty:

Our goods come with guarantees that cannot be excluded under the Australian Consumer Law. You are entitled to a replacement or refund for a major failure and for compensation for any other reasonably foreseeable loss or damage. You are also entitled to have the goods repaired or replaced if the goods fail to be of acceptable quality and the failure does not amount to a major failure.

User Manual:

Esatto

Notes

[illegible][illegible]