

# Tonic

## by Rogerseller

### Dual Baton Shower

Installation  
Instructions

# Specification

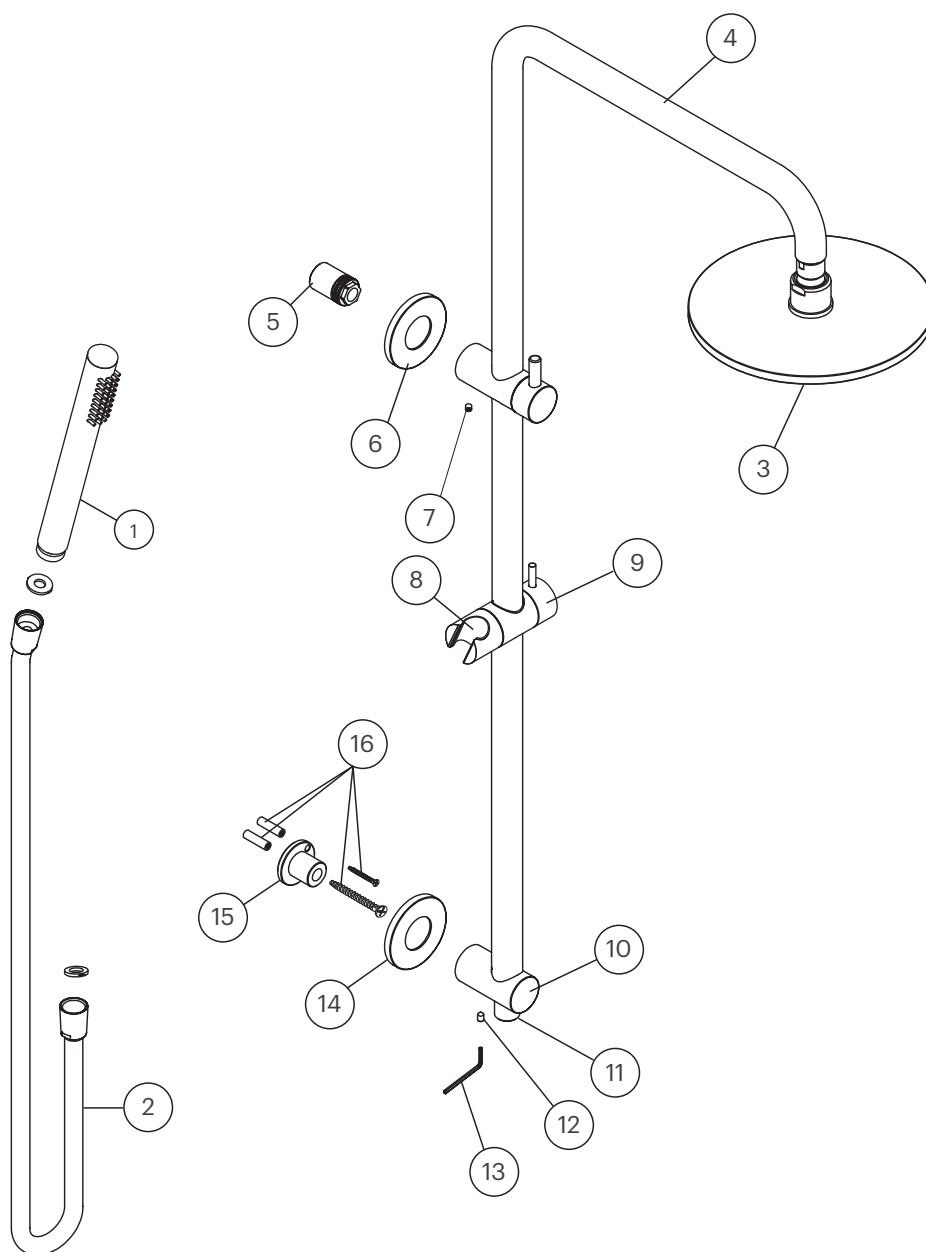

## Tonic by Rogerseller Dual Baton Shower

3506003801 — Chrome

**i** Other finishes available

## Parts List

- |                           |                                      |
|---------------------------|--------------------------------------|
| 1. Hand Shower            | 10. Adjustable Base                  |
| 2. Hose Assembly          | 11. Rail End                         |
| 3. Overhead Shower        | 12. M5 x 8 Set Screw                 |
| 4. Overhead Rail Assembly | 13. Allen Key                        |
| 5. Outlet Adaptor         | 14. Wall Plate                       |
| 6. Wall Plate             | 15. Mounting Insert                  |
| 7. M5 x 5 Set Screw       | 16. Wall Plugs and Screws (supplied) |
| 8. Saddle                 |                                      |
| 9. Holder                 |                                      |

# Installation

## Step 1

Apply a generous amount of thread tape or thread sealant to the wall outlet. Using the appropriate spanner and turning clockwise apply the outlet adaptor (A) to the outlet until flush against the finished wall.

Note: The outlet adaptor is pre-fitted with a flow controller.

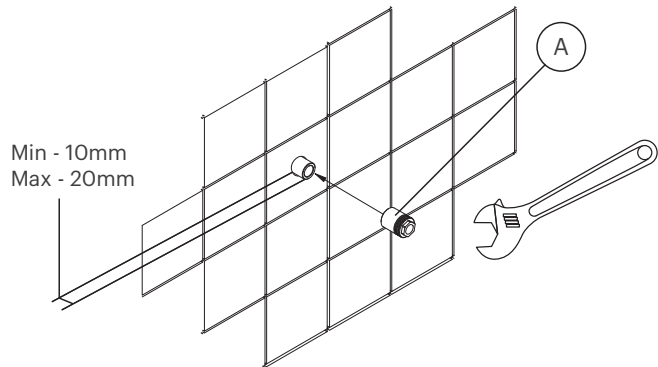

## Step 2

Referring to the fixing guide and the adjacent illustration, drill the required mounting insert holes ensuring it is vertically straight below the outlet and within the recommended distance range. Fix the insert in place using the appropriate hardware.

Note: Always be aware of inwall plumbing and wiring before drilling any holes.

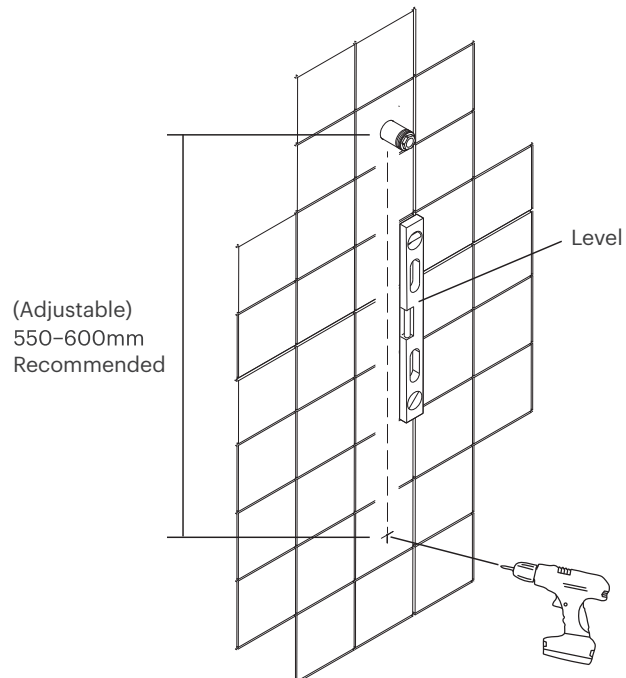

## Step 3

If not already done so, insert the lugged washer into the showerhead as shown in the illustration below. In a clockwise direction screw the shower head onto the overhead rail assembly by hand until it reaches the washer. Locating the appropriate spanner on the two flats of the shower head nipple torque another fraction of a turn until a seal is reached.

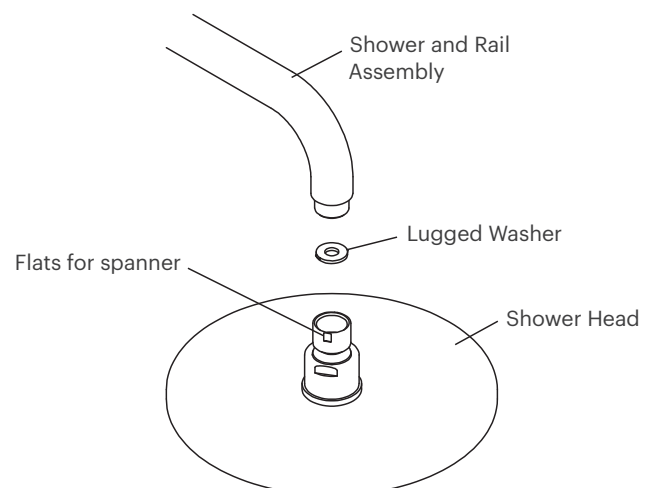

# Installation

## Step 4

Slide and tighten the holder to the shower rail, then carefully connect the overhead shower assembly and shower rail to the inlet / diverter and secure in place using allen key supplied.

Note: Wet the orings prior to insertion to lessen the friction between mating parts and prevent damage to the orings.

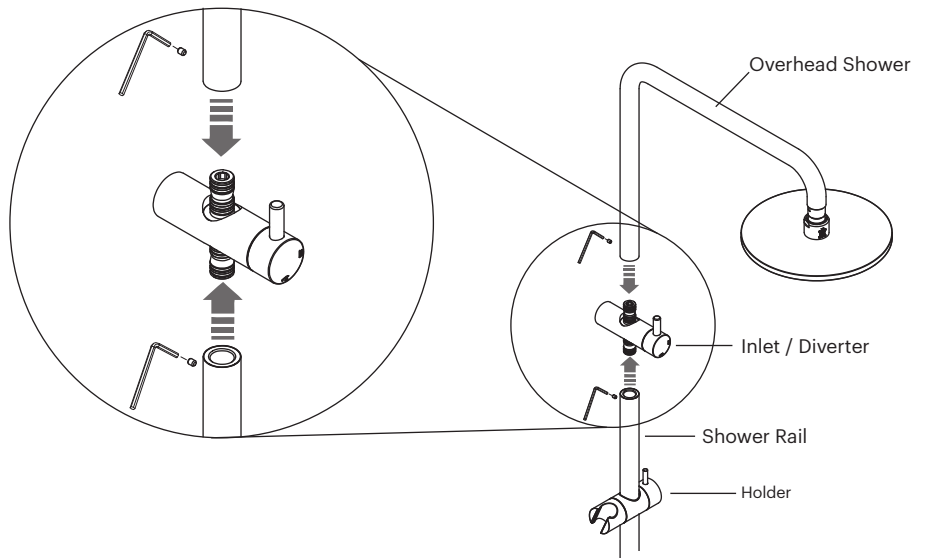

## Step 5

Carefully slide the adjustable base onto the shower rail then locate the wall plates.

While holding the wall plates in place on the shower and rail assembly, push the assembly onto the outlet adaptor and the mounting insert and firmly against the wall. Secure in place by tightening the M5 set screws using the allen key supplied.

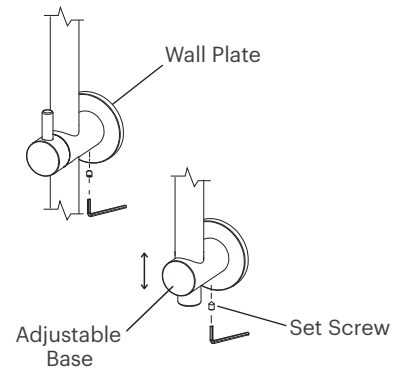
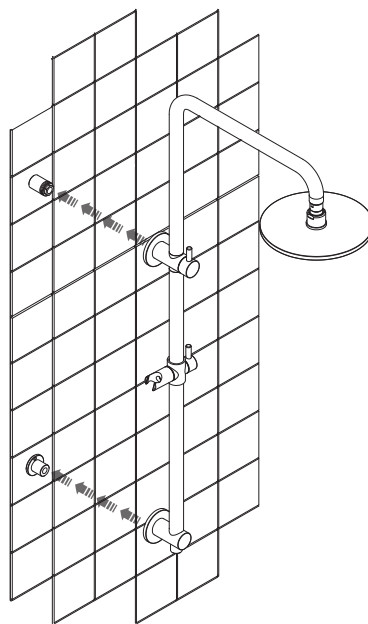

## Step 6

Insert the washers as per the illustration below. Connect the hose end with oring to the hand shower and the opposite hose end to the shower rail. Tighten using the appropriate spanner until watertight.

Place the hand shower into the saddle on the holder to complete the installation.

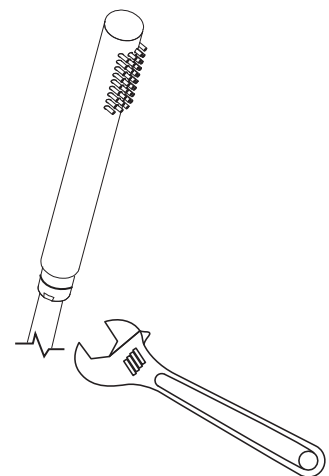
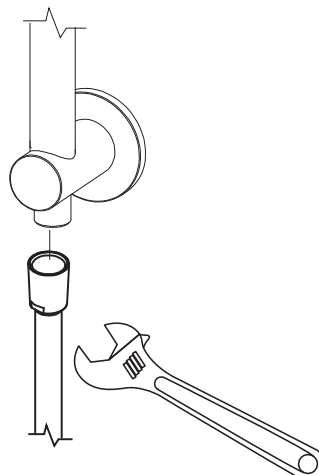
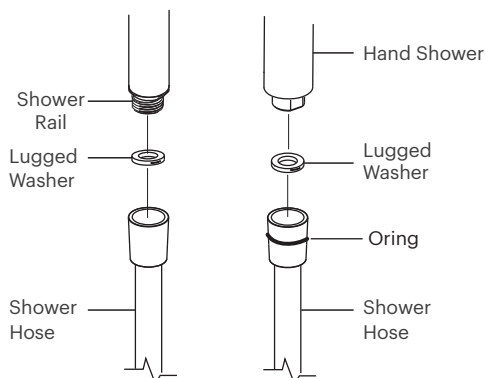

# Fixing Guide

## When Fixing to Timber

- In the short screw position drill a 2mm hole.
- In the long screw position drill a 3mm hole.
- Apply a small amount of neutral cure adhesive to the wall side of the mounting insert.
- Fix the mounting insert to the wall accordingly.

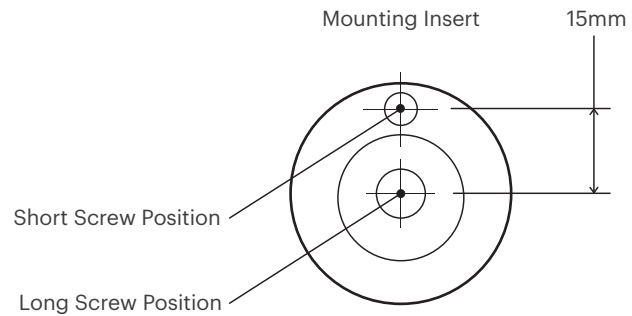

## When Fixing to Masonry

- Use wall plugs
- In both the short and long screw positions drill a 6.5mm hole 15mm apart as shown in the illustration.
- Using a soft hammer, carefully tap the wall plugs into the drilled holes until flush with the wall.
- Apply a small amount of neutral cure adhesive to the wall side of the mounting insert.
- Fix the mounting insert to the wall accordingly.

**NOTE:** CSK wood screws are supplied for fixing to Timber or Masonry (with wall plugs) only.

**CAUTION:** Always be aware of and avoid any in wall plumbing and wiring prior to drilling the hole locations for this product.

## Specifications

It is a requirement of state plumbing codes that licensed plumbers carry out all tapware installations. All installations must comply with the relevant requirements of AS/NZS3500 and local plumbing codes.

Where showers incorporate flow controllers, instructions that care be exercised during installation to ensure that the male connecting threads do not damage the flow controllers.

A backflow prevention / dual check device must be installed to the bottom of the rail between the rail end and the hose if the hand shower can reach the shower floor when installed.

## Pressure

Maximum Hydrostatic Pressure - 1000kpa

Recommended Maximum Hydrostatic Pressure - 500 kpa. (AS/NZS 3500)

Recommended Minimum Hydrostatic Pressure - 150 kpa.

Maximum Hydrostatic Pressure may be exceeded under test conditions only in accordance with AS/NZS 3500. Where hydrostatic pressure exceeds the maximum stated above, pressure limiting valves must be installed or warranty will be void.

## Temperature

Maximum Water Temperature - 80°C

For optimum performance, Hot and Cold inlet water pressure should be equal.

## Care and Maintenance

[1] Product should be inspected for surface damage prior to installation. [2] Cleaning and handling of all finishes must be performed carefully. [3] Clean products using a soft cloth with warm soapy water only. [4] Never use harsh detergents or abrasive cleaners as these will damage the product. [5] Water marks can be removed from Matt Finishes with an application of a carnauba wax based non-abrasive polish on a microfibre cloth. [6] Do not use undue pressure when cleaning and wipe in one direction only. [7] Contact with harsh chemicals such as hair dye, hair bleach etc will result in damage to the finish. [8] Tapware should never be installed using acetone silicones. [9] Avoid the use of wax based furniture creams as this can result in a build up of deposits which will detract from the appearance. [10] Damage to finishes arising from improper installation or post installation use or failure to observe the above care and cleaning instructions will void all warranty agreements.

Dimensions are approximate. Information in this installation instruction is representative of the product available at the time of printing. Due to our policy of continuous product development, the design and specifications depicted are subject to change without notice. Please confirm all particulars with your client advisor prior to purchase.

**rogerseller**