

MACCHINA DA CAFFÈ
COFFEE MAKER
MACHINE À CAFÉ
KAFFEE-/ESPRESSO-VOLLAUTOMAT
KOFFIEZETAPPARAAT
CAFETERA
MÁQUINA DE CAFÉ

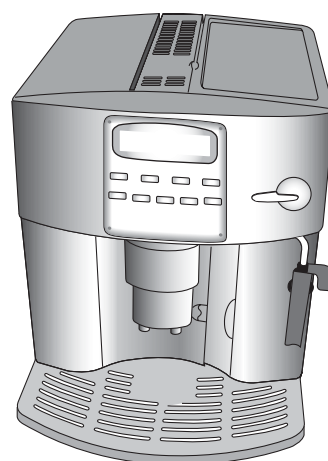

Istruzioni per l'uso
Instructions
Mode d'emploi
Bedienungsanleitung
Gebruiksaanwijzingen
Instrucciones para el uso
Instruções de utilização

ELECTRICAL CONNECTION (UK ONLY)

- A) If your appliance comes fitted with a plug, it will incorporate a 13 Amp fuse. If it does not fit your socket, the plug should be cut off from the mains lead, and an appropriate plug fitted, as below.

WARNING: Very carefully dispose of the cut off plug after removing the fuse: do not insert in a 13 Amp socket elsewhere in the house as this could cause a shock hazard.

With alternative plugs not incorporating a fuse, the circuit must be protected by a 15 Amp fuse.

WARNING - THIS APPLIANCE MUST BE EARTHED

IMPORTANT

The wires in the mains lead are coloured in accordance with the following code:

Green and yellow:	Earth
Blue:	Neutral
Brown:	Live



If the plug is a moulded-on type, the fuse cover must be re-fitted when changing the fuse using a 13 Amp Asta approved fuse to BS 1362. In the event of losing the fuse cover, the plug must NOT be used until a replacement fuse cover can be obtained from your nearest electrical dealer. The colour of the correct replacement fuse cover is that as marked on the base of the plug.

As the colours of the wires in the mains lead may not correspond with the coloured markings identifying the terminals in your plug, proceed as follows:

The green and yellow wire must be connected to the terminal in the plug marked with the letter E or the earth symbol  or coloured green or green and yellow.

The blue wire must be connected to the terminal marked with the letter N or coloured black.

The brown wire must be connected to the terminal marked with the letter L or coloured red.



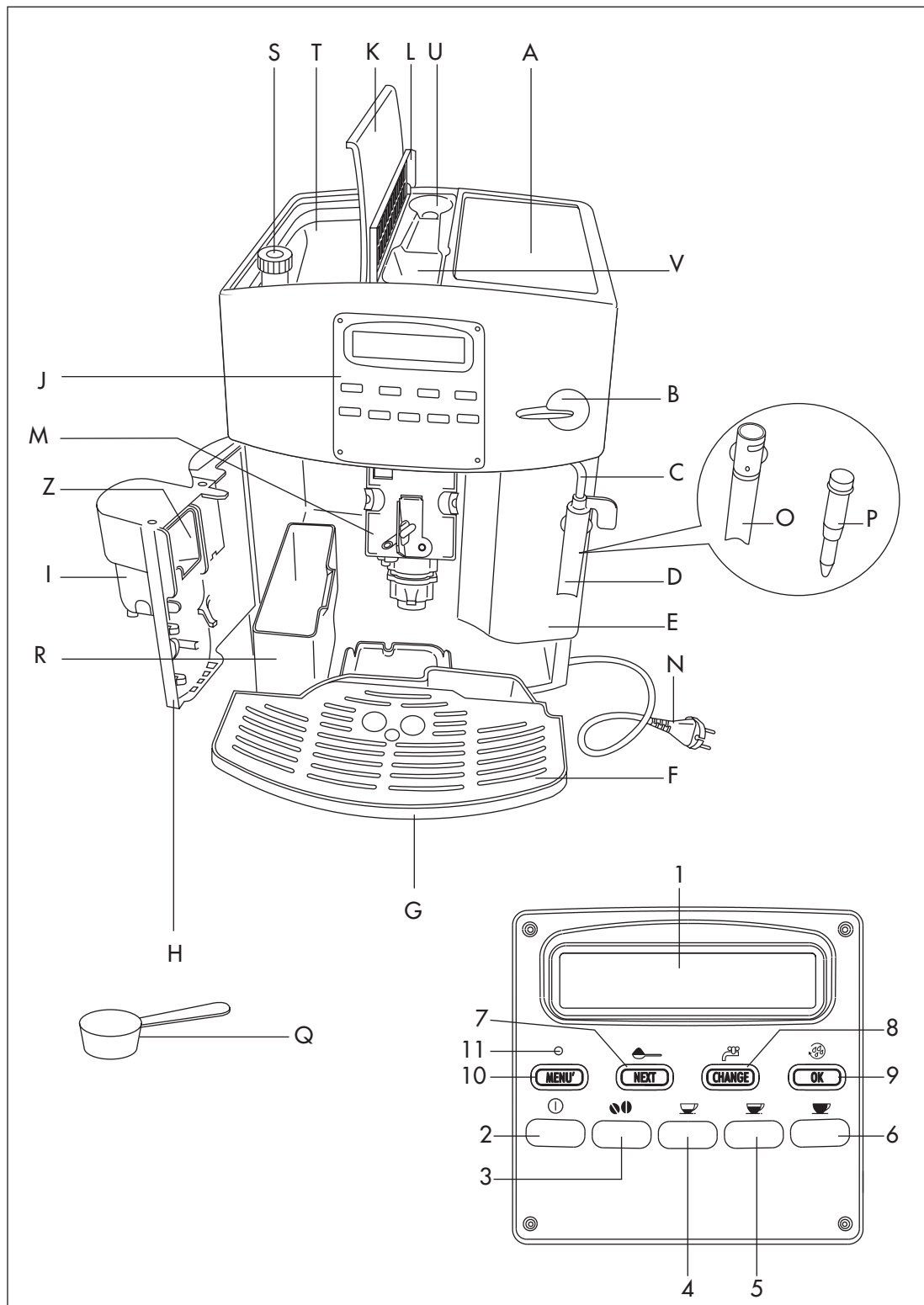

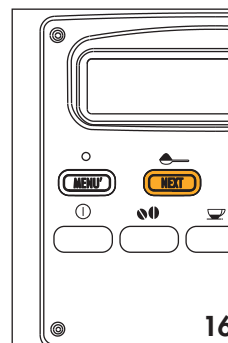
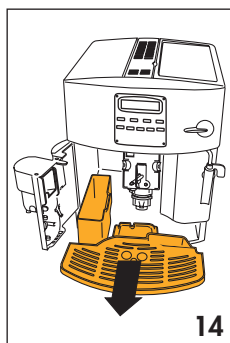
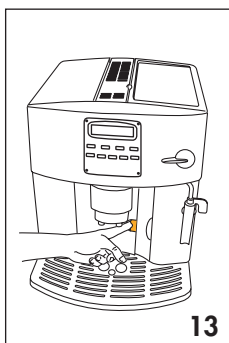
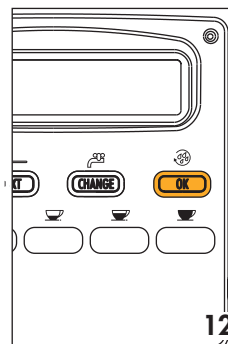
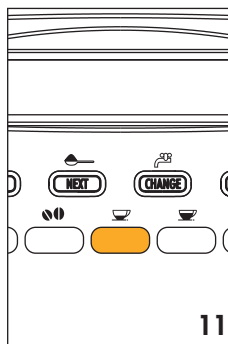
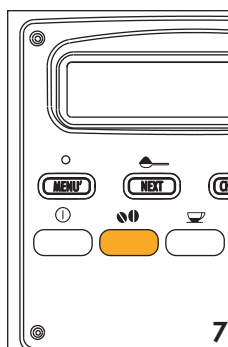
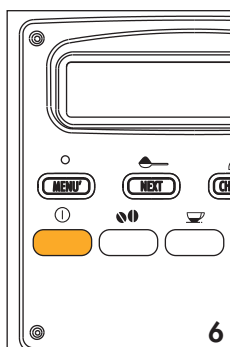
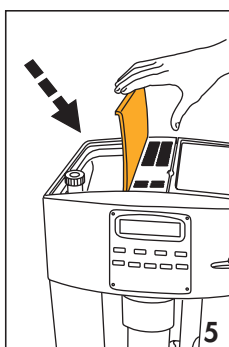
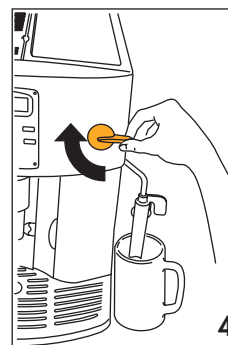
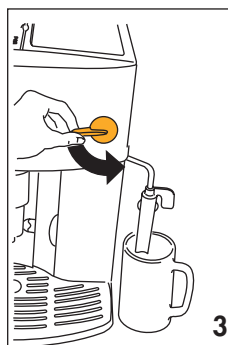
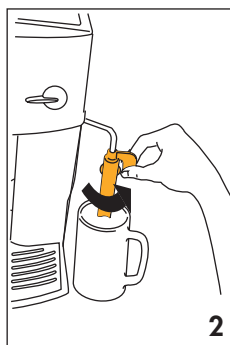
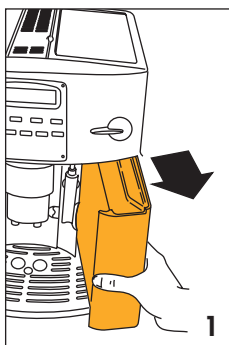

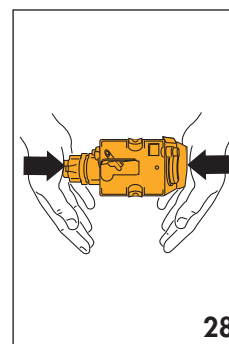
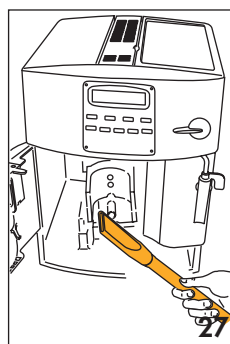
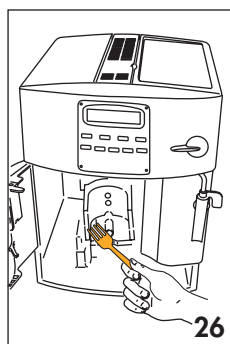
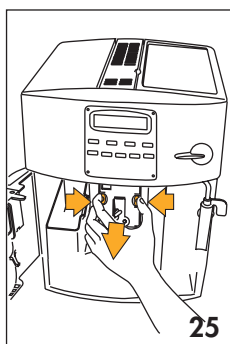
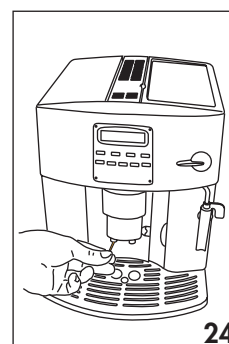
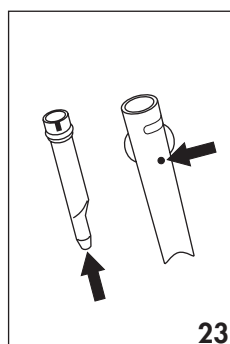
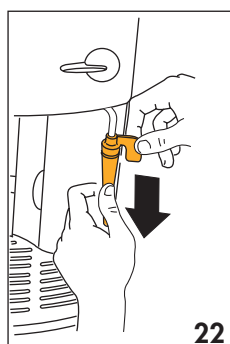
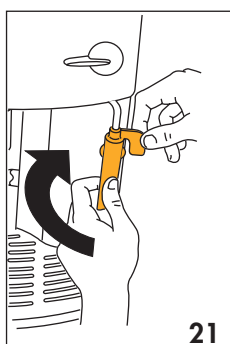
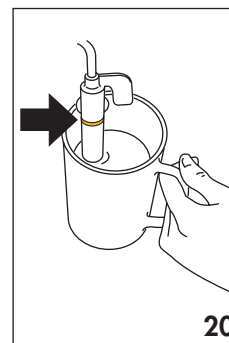
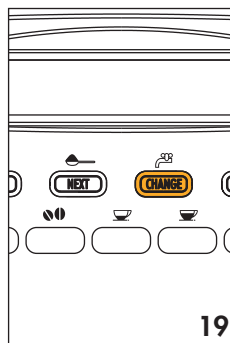
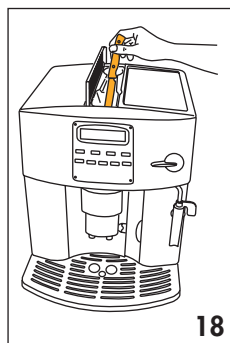
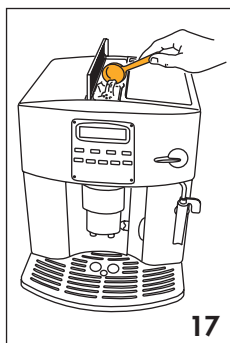

INDEX

1	DESCRIPTION (see page 3)	page. 23
2	SAFETY WARNINGS	page. 23
3	INSTALLATION	page. 24
4	USING FOR THE FIRST TIME	page. 24
5	PREPARING COFFEE (USING COFFEE BEANS)	page. 25
6	CHANGING THE QUANTITY OF COFFEE IN THE CUP	page. 27
7	REGULATING THE COFFEE MILL	page. 27
8	PREPARING ESPRESSO COFFEE USING GROUND COFFEE (INSTEAD OF BEANS)	page. 28
9	PRODUCING HOT WATER	page. 28
10	PREPARING CAPPUCCINOS (USING STEAM)	page. 29
11	CLEANING AND MAINTENANCE	page. 29
11.1	CLEANING THE COFFEE MAKER	page. 30
11.2	CLEANING THE INFUSER	page. 30
12	CHANGING AND SETTING THE MENU PARAMETERS	page. 31
12.1	SETTING THE CLOCK	page. 31
12.2	SETTING AUTO-START TIME	page. 31
12.3	DESCALING	page. 32
12.4	CHANGING COFFEE TEMPERATURE	page. 33
12.5	CHANGING THE LENGTH OF TIME THE APPLIANCE REMAINS ON	page. 33
12.6	SETTING WATER HARDNESS	page. 33
12.7	RESETTING FACTORY DEFAULT SETTINGS	page. 34
12.8	WASHING	page. 34
13	CHANGING THE LANGUAGE	page. 34
14	MEANING OF MESSAGES AND WHAT TO DO	page. 34
15	PROBLEMS TO BE RESOLVED BEFORE CALLING THE SERVICE CENTRE	page. 36

1 DESCRIPTION (SEE PAGE 3)

- A. Cup warmer tray
- B. Steam knob
- C. Steam spout
- D. Cappuccino maker
- E. Water tank (removable)
- F. Cup tray
- G. Drip tray (removable)
- H. Service door
- I. Coffee spout (adjustable in height)
- J. Control panel
- K. Bean container lid
- L. Central ground coffee lid
- M. Infuser
- N. Power cable
- O. Cappuccino maker (removable)
- P. Cappuccino maker nozzle (removable)
- Q. Measure for pre-ground coffee
- R. Coffee grounds container (removable)
- S. Grinding coarseness regulator
- T. Coffee beans container
- U. Compartment for measure
- V. Ground coffee funnel
- Z. Mobile drawer

Control Panel

- 1. Display;
- 2. Appliance ON/OFF button;
- 3. Coffee taste selection button;
- 4. One or two cups short coffee button;
- 5. One or two cups standard coffee button;
- 6. One or two cups long coffee button;
- 7. Button to select ground coffee or, if the MENU light is on, to display the next parameter on the menu;
- 8. Button to select hot water or, if the MENU light is on, to change the menu parameters;
- 9. Button to rinse the appliance or, if the MENU light is on, to confirm the menu parameters;
- 10. Button to activate or deactivate menu parameter setting mode;
- 11. MENU light;

2 SAFETY WARNINGS

READ THESE INSTRUCTIONS CAREFULLY AND KEEP FOR FUTURE CONSULTATION!

- This appliance is designed to "make espresso coffee" and "heat drinks". Use with care to avoid scalds from the water and steam jets or through incorrect use.
- This appliance is intended for domestic use only. Any other use is considered improper and thus dangerous.
- The manufacturer is not liable for damage caused by improper, incorrect or unreasonable use of the appliance.
- When using the appliance, do not touch the hot surfaces. Use the knobs or handles.
- Do not touch the appliance with damp hands or feet.
- Do not allow children or unfit persons to use the appliance unsupervised.
- Never allow children to play with the appliance.
- In the event of failure or malfunction, unplug the appliance from the mains and do not tamper with it in any way. If it requires repair, contact an authorised service centre only and ask for original spare parts to be used. Failure to respect the above could reduce the safety of the appliance.

3 INSTALLATION

- After removing the packaging, make sure the product is complete and undamaged. If in doubt, do not use the appliance and contact a qualified professional.
- Packing elements (plastic bags, polystyrene etc) must not be left within reach of children as they may represent a hazard.
- Place the appliance on a work surface far away from water taps, basins and sources of heat.
- After positioning the appliance on the work top, leave a space of at least 5 cm between the surfaces of the appliance and the side and rear walls and at least 20 cm above the coffee maker.
- Never install the appliance in environments where the temperature may reach 0°C or lower (the appliance may be damaged if the water freezes).
- Make sure the mains voltage corresponds to the voltage indicated on the appliance rating plate. Connect the appliance to an efficiently earthed socket with a minimum current rating of 10A only. The manufacturer may not be considered liable for possible incidents caused by the failure to adequately earth the mains.
- If the power socket does not match the plug on the appliance, have the socket replaced with a suitable type by a qualified professional.
- The power cable on this appliance must not be replaced by the user as this operation requires the use of special tools. If the cable is damaged or requires replacing, contact an authorised service centre only to avoid all risks.
- You should personalise water hardness as soon as possible following the instructions in paragraph 12.6.

To learn how to operate the appliance correctly, when you use it for the first time, follow the step-by-step instructions given in the following paragraphs.

4 USING FOR THE FIRST TIME

1. The first time you use the appliance, select the language.
To set English, plug the appliance into the mains socket and wait for the appliance to display:

PRESS OK TO INSTALL ENGLISH

Press the **OK** button for at least 3 seconds until the appliance displays:

ENGLISH INSTALLED

The appliance then displays the setting message in English.

2. After a few seconds, the appliance displays:

FILL TANK

To fill, remove the tank (fig. 1), rinse and fill with fresh water. Never exceed the MAX line.

(When removing the tank, the cappuccino maker must always be positioned towards the centre of the appliance, otherwise the tank cannot be removed).

Put the tank back and **push as far as it will go**.

3. The appliance now displays:

TURN THE STEAM KNOB

Move the cappuccino maker outwards (fig. 2) and place a cup underneath it.

Turn the steam knob anticlockwise as far as it will go (fig. 3).

After a few seconds, a little water runs out of the cappuccino maker. When the cup contains about 30cc of water, turn the steam knob clockwise (fig. 4) as far as it will go to stop the water running out.

4. The appliance now displays:

TURNING OFF PLEASE WAIT ...

and it goes off.

5. Fill the container with coffee beans (fig. 5).

IMPORTANT: to prevent malfunction, never fill with ground coffee, freeze dried coffee, caramelised beans or anything else which could damage the appliance.

6. Press the  (fig. 6), The appliance displays:

HEATING UP PLEASE WAIT ...

to indicate that preheating is underway.

7. When preheating is complete, the appliance displays:

RINSING COMPLETE PLEASE WAIT ...



and performs an automatic rinse cycle (a little hot water runs out of the spouts and is collected in the drip tray beneath).

Tip: if you want to make a short coffee (less than 60 cc), to make it hotter, fill the cup with this hot rinsing water first. Leave it for a few seconds then empty it to preheat the cup.

8. The appliance now displays the ready message:

READY STANDARD TASTE

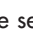
5 PREPARING COFFEE (USING COFFEE BEANS)

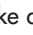
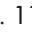
1. The appliance is preset to make coffee with a standard taste. You can also choose coffee with an extra-mild, mild, strong or extra-strong taste. To choose the required taste, press the  (fig. 7): The selected coffee taste will be displayed.
2. Place 1 cup under the spouts to make 1 coffee (fig. 8) or 2 cups for 2 coffees (fig. 9). For a creamier coffee, lower the spouts to bring them as close to the cups as possible (fig. 10).
3. Press the  button to make a short coffee (fig. 11), the  button for a standard coffee and the  button for a long coffee.

To make 2 coffees, press the button twice (within 2 seconds).

To change the quantity of coffee delivered automatically into the cup, follow the instructions in chapter 6.

(The appliance now grinds the beans and starts running off the coffee into the cup.

Once the desired quantity has been reached, the appliance automatically stops delivering the coffee and ejects the grounds into the special container).

4. After a few seconds, the ready message is displayed again and you can make another coffee.
5. To turn the appliance off, press the  button.
Before going off, the appliance performs an automatic rinse cycle (a little hot water runs out from the spouts and is collected in the drip tray beneath). Take care to avoid scalds.

NOTE 1: *If the coffee is delivered a drop at a time or not at all, turn the grinding coarseness regulator (fig. 15) one click clockwise (see chapter 7).*

Turn one click at a time until the coffee is delivered satisfactorily.



NOTE 2: *If the coffee is delivered too fast and is not creamy enough, turn the grinding coarseness regulator (fig. 15) one click anticlockwise (see chapter 7).*

Avoid turning the grinding coarseness regulator excessively otherwise when you select 2 cups, the coffee may run out in drips.

NOTE 3: *Tips to make hotter coffee:*

- **When you turn the appliance on**, if you want to make a short coffee (less than 60 cc), use the hot rinse-through water to preheat the cups.
If **2/3 minutes have passed**, since you last made coffee, before making coffee again you must preheat the infuser by pressing the  button (fig. 12).
Run off the water into the underlying drip tray or alternatively use this water to fill (and then empty) the cup to be used for the coffee, so as to preheat it.
- Unless preheated, do not use cups that are too thick, as they will absorb too much heat.
- Use cups that have been preheated by rinsing them with hot water or by leaving them for at least 20 minutes on the cup warmer tray on top of the appliance with the appliance on.

NOTE 4: while the appliance is making the coffee, **delivery can be stopped at any time** by pressing the ,  or  button as previously selected.

NOTE 5: as soon as delivery is complete, to **increase the quantity** of coffee, simply press and hold the ,  or  button as previously selected, until the desired quantity is reached (this operation must be performed within 3 seconds from when coffee delivery from the spouts ceases).

NOTE 6: *when the appliance displays:*

FILL TANK

the water tank must be refilled or the appliance will not make coffee.

(It is normal for there to be a little water left in the tank when the message is displayed).

NOTE 7: the appliance counts the number of coffees made.

Every 14 single coffees (or 7 doubles) the appliance displays:

EMPTY GROUNDS CONTAINER

indicating that the grounds container is full and must be emptied and cleaned. Until the grounds container has been cleaned, the appliance continues to display the message and cannot make coffee.

To clean, open the service door at the front by pulling the handle (fig. 13), remove the drip tray (fig. 14), empty and clean.

Empty the grounds container and clean thoroughly, making sure all residues deposited on the bottom are removed.

IMPORTANT: *when removing the drip tray, the grounds container **MUST** be emptied, even if it is not completely full. If this is not done, when next making coffee the grounds in the container may exceed the maximum level and block the appliance.*

NOTE 8: while the appliance is running off coffee, **never remove the water tank**. If it is removed, the appliance will not be able to make the coffee.

To reset the appliance, turn the steam knob anticlockwise as far as it will go and run off water from the cappuccino maker for a few seconds.

When using the appliance for the first time, 4-5 cups of coffee need to be made before the appliance starts to give satisfying results.

If the appliance malfunctions, do not contact the service centre straight away.

The problem can almost always be resolved by following the instructions indicated in paragraphs 14 and 15. If this is not the case, or for further explanations, contact the customer service by calling the number listed on page 2 of the enclosed sheet.

If your country is not listed on the sheet, call the number indicated on the warranty.

6 CHANGING THE QUANTITY OF COFFEE IN THE CUP

The appliance is factory preset to automatically deliver the following quantities of coffee:

- short (when the ☕ button is pressed);
- standard (when the ☕ button is pressed);
- long (when the ☕ button is pressed);

To change these quantities, proceed as follows:

- press the button corresponding to the quantity you want to change (☕ , ☕ or ☕) for at least 5 seconds until the message "PROGRAM QUANTITY" is displayed;
- when the coffee in the cup reaches the required level, press the same button again to memorise the new amount.

7 REGULATING THE COFFEE MILL

However, after making the first coffees, if you find that coffee delivery is either too fast or too slow (in drips), the grinding coarseness regulator can be adjusted (fig. 15).

Turning it 1 click (1 number) clockwise speeds up coffee delivery (without drips).

Turning it 1 click anticlockwise slows down delivery giving a creamier appearance to the coffee.

These adjustments will only be evident after at least 2 cups of coffee have been run off.

The grinding coarseness regulator must only be turned when the coffee mill is on.

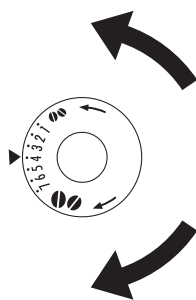

Turn anticlockwise to obtain finer ground coffee, slower delivery and a creamier appearance.



Turn clockwise for coarser ground coffee and faster delivery (not a drop at a time).

(Coffee has been used to factory test the appliance and it is therefore completely normal for there to be traces of coffee in the mill. This appliance is however guaranteed to be new).

8 PREPARING ESPRESSO COFFEE USING GROUND COFFEE (INSTEAD OF BEANS)

- Press the  (fig. 16) button (fig. 16) to select the ground coffee function. This disables the coffee mill function. The appliance displays

READY PRE-GROUND

- Lift the central lid, place one measure of ground coffee in the funnel (see fig. 17) and proceed as described in paragraph 5. NB: You can make just one coffee at a time by pressing the ,  or .

NOTE 1: Never add the ground coffee when the appliance is off to avoid it being dispersed inside the appliance.

NOTE 2: Never add more than 1 measure, otherwise either the appliance will not make the coffee and the ground coffee will be lost inside the appliance, dirtying it, or the coffee will run off in drips.



NOTE 3: When dosing the quantity of coffee to be added, use the measure supplied only.

NOTE 4: Use ground coffee for espresso coffee makers only. Do not use coffee beans, freeze-dried coffee or other materials that could damage the appliance.

NOTE 5: If you add more than one measure of ground coffee and the funnel clogs, use a knife to push the coffee down (fig. 18), then remove and clean the infuser and appliance as described in paragraph 11.2 "Cleaning the infuser".

- Once the coffee has been delivered, to go back to making coffee using beans, deactivate the ground coffee function by pressing the  button again (the light goes off and the coffee mill is enabled for operation again).

9 HOT WATER DELIVERY

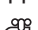
- Always make sure the appliance is ready.
- Turn the cappuccino maker towards the outside of the appliance and place a container under it (fig. 2).
- Press the  (fig. 19). The appliance displays:

READY HOT WATER

- Turn the steam knob half a turn anticlockwise as far as it will go (fig. 3). Hot water is run off from the cappuccino maker and starts to fill the container underneath. You should not run off hot water for more than 2 minutes at a time.
- To interrupt hot water delivery, turn the steam knob clockwise as far as it will go (fig. 4) and place the cappuccino maker in the original position near the centre of the appliance.
- To deactivate the hot water function, press the  (fig. 19).

10 PREPARING CAPPUCCINOS (USING STEAM)

- Move the cappuccino maker outwards (fig. 2).
- Place an empty container under the cappuccino maker. Turn the steam knob a half turn anticlockwise as far as it will go (fig. 3). The appliance displays:

STEAM

Allow the steam mixed with water to run off for a few seconds until steam only is given off.

- To interrupt steam delivery, rotate the knob clockwise as far as it will go (fig. 4).
- Empty the container then fill it with about 100 grams of milk for each cappuccino to be prepared. In choosing the size of the container, bear in mind that the milk doubles or triples in volume. You are recommended to use semi-skimmed milk at refrigerator temperature.
- Dip the cappuccino maker into the recipient containing the milk (fig. 2), taking care not to immerse the raised line on the cappuccino maker (indicated by the arrow in fig. 20). Turn the steam knob a half turn anticlockwise as far as it will go (beware of burns). Steam is discharged from the cappuccino maker, giving the milk a creamy frothy appearance. To obtain a creamier froth, dip the cappuccino maker into the milk and rotate the container with slow movements from the bottom upwards. (You should not discharge steam for more than two minutes at a time).
- Once the required temperature is reached, interrupt steam delivery by rotating the knob clockwise as far as it will go (fig. 4).
- Prepare the coffee as described above, using large enough cups, then fill with the frothed milk prepared previously. The cappuccino is ready. Sweeten to taste and, if desired, sprinkle the froth with a little cocoa powder.

IMPORTANT: always clean the cappuccino maker immediately after use. Proceed as follows:

- Discharge a little steam for a few seconds by rotating the steam knob. This empties any milk left inside the steam spout.
IMPORTANT: to guarantee hygiene, you are recommended to follow this procedure each time you make cappuccino to avoid milk stagnating in the milk circuit.
- Turn the steam knob clockwise as far as it will go.
- Wait a couple of minutes for the cappuccino maker to cool down then with one hand hold the cappuccino spout handle firm and with the other unscrew the cappuccino maker itself by rotating clockwise and extracting downwards (fig. 21).
- Remove the nozzle from the steam spout by pulling it downwards (fig. 22).
- Carefully wash the cappuccino maker and steam nozzle in warm water.
- Make sure the two holes shown in fig. 23 are not blocked. If necessary, clean with a pin.
- Replace the steam nozzle by inserting it and vigorously turning it upwards into the steam spout.
- Replace the cappuccino maker by pushing it upwards and turning it anticlockwise.

11 CLEANING AND MAINTENANCE

Before performing any cleaning operations, leave the appliance to cool down and unplug from the mains socket.

Never immerse the coffee maker in water. It is an electrical appliance.

Do not use solvents or abrasive cleaning products to clean the appliance. A soft damp cloth will suffice.

NEVER wash ANY of the components of the appliance in a dishwasher.

11.1 Cleaning the coffee maker

Clean the grounds container (as described in chapter 5, note 7) whenever it requires emptying.

The water tank should also be cleaned regularly.

The drip tray is fitted with a level indicator (red) showing the level of water it contains.

When the indicator starts to become visible (a few millimetres under the drip tray), the drip tray must be emptied and cleaned.

Check that the holes in the coffee spout are not blocked. To unblock them, scrape the dry coffee residues away with a needle (fig. 24).

11.2 Cleaning the infuser

The infuser must be cleaned regularly to avoid the build-up of coffee encrustations which could cause malfunction.

Proceed as follows:

- turn the appliance off by pressing the ① button (fig. 6) (do not unplug) and wait for the display to go off;
- open the service door (fig. 13);
- remove the drip tray and the grounds container (fig. 14) and clean;
- press the two red release buttons on the infuser sideways and towards the centre (fig. 25) and pull it out;
- **IMPORTANT: THE INFUSER CAN ONLY BE REMOVED WHEN THE APPLIANCE IS OFF. ATTEMPTING TO REMOVE THE INFUSER WITH THE APPLIANCE ON MAY CAUSE SERIOUS DAMAGE.**
- Wash the infuser under running water, without using detergents. Never wash the infuser in the dishwasher;
- clean the inside of the appliance thoroughly. To remove coffee encrustations from the inside of the appliance, scrape with a plastic or wooden fork (fig. 26) then vacuum up the residues with a vacuum cleaner (fig. 27);
- replace the infuser by sliding it onto the supports and pin at the bottom, then push the PUSH symbol fully in until it clicks into place.

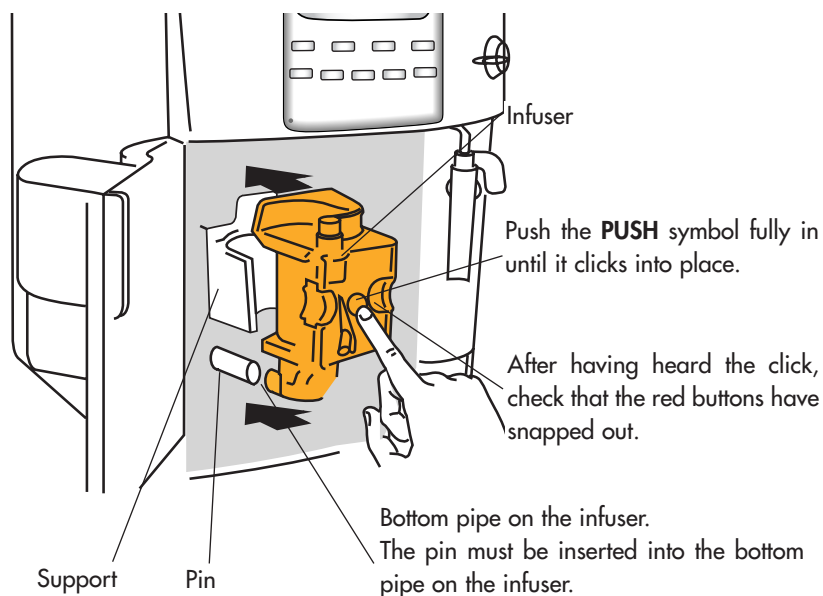

Check that the two red buttons have snapped out, otherwise the door cannot be closed.

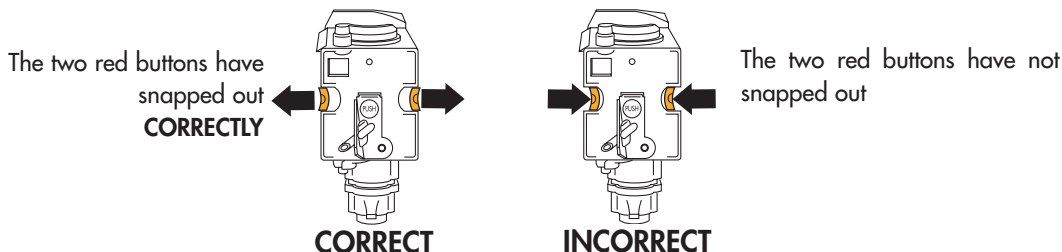

NOTE 1: If the infuser is not inserted correctly until it clicks into place and the two red buttons have not snapped out, the service door cannot be closed.

NOTE 2: If it is hard to insert the infuser, before inserting it squeeze it to the right size by pressing it forcefully from the top and bottom simultaneously, as shown in figure 28.

NOTE 3: If it is still hard to insert the infuser, leave it out of the appliance, close the service door, unplug from the mains then plug in again.

Wait for all the lights to go off, then open the door and replace the infuser.

- replace the drip tray, complete with the grounds container;
- close the service door.

12 CHANGING AND SETTING THE MENU PARAMETERS

The following menu parameters and functions can be changed by the user:

- Clock
- Auto-start time
- Descaling process
- Coffee temperature
- Length of time the appliance remains on
- Water hardness
- Factory default values
- Washing process

12.1 Setting the clock

To set the clock, proceed as follows:

- Press the **MENU'** (the light over the button comes on) then press the **NEXT** button repeatedly until the appliance displays

CLOCK 00:00

- Press the **CHANGE** button to set the clock. (If you hold the **CHANGE**, button down, the time is changed rapidly).
- Press the **OK** button to confirm the value;
- Press the **MENU'** button to exit programming mode or **NEXT** to change other parameters.

12.2 Setting auto-start time

This enables the time the appliance will come on automatically to be programmed.

- Make sure the clock on the appliance is set as described above.
- Press the **MENU'** button then press the **NEXT** button repeatedly until the appliance displays:

START TIME 00:00

- Press the **CHANGE** button to set the auto-start time. (If you hold the **CHANGE** , button down, the time is changed rapidly).
- Press the **OK** button to confirm the value,
- Press **NEXT** once and the appliance displays the message:

AUTO-START NO

Press the **CHANGE** button to modify the function (the appliance displays AUTO-START YES");

- Press the **OK** button to activate auto-start;
- Press the **MENU'** button to exit programming mode or the **NEXT** button to change other parameters.

12.3 Descaling

Over time, the continuous heating up of the water used to make the coffee leads to lime scale building up in the inner circuits of the appliance.

When the appliance displays the message:

DESCALE

you should perform the descale cycle.

Proceed as follows:

- make sure the appliance is ready.
- press the **MENU'** button (the light over the button comes on) then press the **NEXT** button repeatedly until the appliance displays:

DESCALE NO

- Press **CHANGE** and the appliance displays the message:

DESCALE YES

- Press the **OK** button to start the descale programme.
- Pour the contents of the bottle of descaler (0.5 litres) into the water tank and then add half a litre of water. For subsequent descaling, use descaler of the same type and brand as supplied (available from technical service centres authorised by the manufacturer).
- Place a container with a minimum capacity of 1.5 litres under the cappuccino maker (fig. 3);
- turn the steam knob half a turn anticlockwise (fig.3). The descaling solution will run out of the cappuccino maker and start to fill the container underneath
- the descale programme automatically performs a series of run offs and pauses to remove lime scale deposits from inside the coffee maker.
- After about 30 minutes, the appliance displays:

DESCAL. COMPLETE TURN KNOB

- Turn the steam knob a half turn clockwise as far as it will go (fig. 4).

The appliance must now be rinsed through to eliminate residues of descaling solution from inside the appliance. Proceed as follows:

- remove the water tank, rinse and fill with clean water.
- Reposition the tank.
- Empty the collection container (under the cappuccino maker) full of liquid and then put it back under the cappuccino maker.
- Turn the steam knob a half turn anticlockwise (fig. 3).
Hot water is run off from the cappuccino maker into the container below and the appliance displays:

RINSING

- When the water tank is empty, the appliance displays the message:

RINSE COMPLETE TURN KNOB

- turn the steam knob clockwise as far as it will go (fig. 4) and refill the water tank with clean water.
- The descale programme is now terminated and the appliance is ready to make coffee again.

NOTE: if the descaling cycle is interrupted before completion, the appliance continues to display the descale message and the programme must be started again from the beginning.

IMPORTANT: : FAILURE TO DESCALE THE APPLIANCE REGULARLY INVALIDATES THE GUARANTEE.

12.4 Changing coffee temperature

To change the temperature of the coffee, proceed as follows:

- Press the **MENU'** (labutton (the light over the button comes on) then press the **NEXT** button repeatedly until the appliance displays:

TEMPERATURE MEDIUM

- Press the **CHANGE** finchbutton until the appliance displays the required coffee temperature
- Press the **OK** button to confirm the temperature selected;
- Press the **MENU'** button to exit programming mode or **NEXT** to change other parameters.

12.5 Changing the length of time the appliance remains on

The appliance is factory preset to go off automatically one hour after the last coffee has been made.

The number of hours the appliance remains on can be increased as follows:

- Press the **MENU'** button (the light over the button comes on) then press the **NEXT** button repeatedly until the appliance displays:

OFF AFTER 1 HOUR

- Press the **CHANGE** button to change the number of hours the appliance remains on
- Press the **OK** button to confirm the value;
- Press the **MENU'** button to exit programming mode or **NEXT** to change other parameters.

12.6 Setting water hardness

The descale message is displayed after the appliance has been operated for a factory set period of time calculated on the basis of the maximum quantity of lime scale which may be contained in the water used. If necessary, this period of operation can be extended, making descaling less frequent, by programming the appliance based on the actual lime content in the water used. Proceed as follows:

- remove the "Total Hardness Test" strip (enclosed on page 2) from its packaging then dip it fully in the water for a few seconds, Remove it and wait around 30 seconds (until it changes colour and a number of red dots are formed);
- Turn the appliance on by pressing the **ⓘ** button (fig. 6).
- Press the **MENU'** button then press the **NEXT** button repeatedly until the appliance displays:

WATER HARDNESS 4

- Press the **CHANGE** button repeatedly until the number coincides with the number of red squares on the test strip (for example, if there are 3 red squares on the test strip, press the button until **WATER HARDNESS 3** is displayed).
- Press the **OK** button to confirm the value. The coffee maker is now programmed to provide the descaling warning when necessary, based on the actual hardness of the water.

12.7 Resetting factory default settings

If you change the original values, the factory default values can be reset as follows:

- Press the **MENU'** button then press the **NEXT** button repeatedly until the appliance displays:

RESET TO DEFAULT NO

- Press the **CHANGE** button and the appliance displays *"RESET TO DEFAULT YES"*;
- Press the **OK** button to reset the factory default values;
- Press the **MENU'** button to exit programming mode or **NEXT** to change other parameters

12.8 Washing

This function can be used by technical service personnel only.

13 CHANGING THE LANGUAGE

To change the language, proceed as follows:

- Press the **OK** button for at least 5 seconds until the appliance displays:

PRESS OK TO INSTALL ENGLISH

and press the **OK** button for at least 3 seconds to confirm. The appliance then displays the setting message in English.





14 MEANING OF MESSAGES AND WHAT TO DO



MESSAGE	MEANING	WHAT TO DO
<i>FILL TANK</i>	<ul style="list-style-type: none"> • The water tank is empty or is positioned incorrectly. • The tank is dirty or encrusted with lime scale. 	<ul style="list-style-type: none"> • Fill the water tank as described in chapter 5, note 6 and insert it fully. • Rinse or descale the tank.
<i>GROUND TOO FINE ADJUST MILL AND TURN THE STEAM KNOB</i>	<ul style="list-style-type: none"> • The appliance cannot make coffee • The coffee runs off too slowly. 	<ul style="list-style-type: none"> • Turn the steam knob anticlockwise (fig. 3) as described in chapter 5 note 10. • Turn the grinding regulator (fig. 15) one click clockwise (see chapter 7).
<i>EMPTY GROUNDS CONTAINER</i>	<ul style="list-style-type: none"> • The grounds container is full or missing. 	<ul style="list-style-type: none"> • Empty the grounds container and clean as described in chapter 5, note 7, then replace.
<i>INSERT GROUNDS CONTAINER</i>	<ul style="list-style-type: none"> • After cleaning, the grounds container has not been replaced. 	<ul style="list-style-type: none"> • Open the service door and insert the grounds container.

MESSAGE	MEANING	WHAT TO DO
<i>ADD PRE-GROUND COFFEE</i>	<ul style="list-style-type: none"> With the ground coffee function selected, ground coffee has not been poured into the funnel 	<ul style="list-style-type: none"> Add the ground coffee as described in chapter 8.
<i>FILL BEAN CONTAINER</i>	<ul style="list-style-type: none"> The coffee beans have run out. If the coffee grinder is very noisy, this means a small stone in the coffee beans has blocked the mill. 	<ul style="list-style-type: none"> Fill bean container Contact an authorised De'Longhi service centre.
<i>DESCALE</i>	<ul style="list-style-type: none"> This indicates the presence of lime scale in the appliance. + 	<ul style="list-style-type: none"> The descaling procedure, described in chapter 12.3, needs to be performed as soon as possible.
<i>PRESS NEXT+ CHANGE</i>	<ul style="list-style-type: none"> After cleaning, the infuser has probably been left out of the coffee maker 	<ul style="list-style-type: none"> Leave the service door closed and the infuser out of the appliance, then follow the instructions displayed.
<i>CLOSE DOOR</i>	<ul style="list-style-type: none"> The service door is open. 	<ul style="list-style-type: none"> If the service door cannot be closed, check that the infuser is inserted correctly (chapter 11.2 - note 1)
<i>INSERT INFUSER</i>	<ul style="list-style-type: none"> After cleaning, the infuser has probably been left out of the coffee maker. 	<ul style="list-style-type: none"> Insert the infuser, see chapter 11.2
<i>GENERAL ALARM</i>	<ul style="list-style-type: none"> The inside of the appliance is very dirty. 	<ul style="list-style-type: none"> Thoroughly clean the inside of the appliance, as described in chapter 11.2. If the message is still displayed after cleaning, contact a service centre.

15 PROBLEMS THAT CAN BE RESOLVED BEFORE CALLING THE SERVICE CENTRE

If the appliance is not working, the causes of the malfunction can be identified and resolved by referring to chapter 14. If, on the other hand, no message is displayed, run the following checks before calling the service

PROBLEM	CAUSE	SOLUTION
The coffee is not hot	<ul style="list-style-type: none"> The cups have not been preheated. The infuser is too cold 	<ul style="list-style-type: none"> Heat the cups by rinsing them in hot water or leaving them for at least 20 minutes on the cup warmer tray on the lid (see note 3, chapter 5). Heat the infuser by pressing the  button before making the coffee (fig. 12, see note 3, chapter 5).
The coffee is not creamy enough	<ul style="list-style-type: none"> The coffee is ground too coarsely Wrong type of coffee 	<ul style="list-style-type: none"> Turn the grinding regulator one click anticlockwise (see chapter 7). Use a type of coffee for espresso coffee makers.
The coffee runs out too slowly.	<ul style="list-style-type: none"> The coffee is ground too finely. 	<ul style="list-style-type: none"> Turn the grinding regulator one click anticlockwise (see chapter 7).
The coffee runs out too quickly.	<ul style="list-style-type: none"> The coffee is ground too coarsely. 	<ul style="list-style-type: none"> Turn the grinding regulator one click anticlockwise (see chapter 7).
The coffee does not come out of one of the spouts.	<ul style="list-style-type: none"> The spout holes are blocked. 	<ul style="list-style-type: none"> Scrape off the dry coffee residues with a needle (fig. 24).
When the steam knob is turned, no steam comes out of the cappuccino maker	<ul style="list-style-type: none"> The holes in the cappuccino maker and steam nozzle are clogged. 	<ul style="list-style-type: none"> Clean the holes in the cappuccino maker and the steam nozzle (see paragraph 10 - fig. 23).
When the  ,  or  button is pressed, the appliance does not deliver coffee, but only water.	<ul style="list-style-type: none"> The ground coffee may be blocked in the funnel.. 	<ul style="list-style-type: none"> Remove the ground coffee inside the funnel using a knife (see chapter 8 - note 5). Then clean the infuser and the inside of the appliance (see description in chapter 11.2)
When the  button is pressed, the appliance does not switch on.	<ul style="list-style-type: none"> The appliance is not plugged in. 	<ul style="list-style-type: none"> Check that the power cable is plugged into the mains socket
The infuser cannot be removed for cleaning.	<ul style="list-style-type: none"> The appliance is on. The infuser can only be removed if the appliance is off. 	<ul style="list-style-type: none"> Turn the appliance off and remove the infuser (see chapter 11.2). IMPORTANT: the infuser can only be removed if the appliance is off. Attempting to remove the infuser when the appliance is on may cause serious damage.

PROBLEM	CAUSE	SOLUTION
Ground coffee is being used (not beans) and the appliance does not deliver the coffee.	<ul style="list-style-type: none"> • Too much ground coffee has been added. • The  button has not been pressed and the appliance has used both the ground coffee added and the coffee ground by the mill • Ground coffee has been added when the appliance is off. 	<ul style="list-style-type: none"> • Remove the infuser and thoroughly clean the inside of the appliance, as described in chapter 11.2. Repeat the operation using a maximum of 1 measure of ground coffee. • Thoroughly clean the inside of the appliance, as described in chapter 11.2. Repeat the operation, first pressing the  button as described in chapter 8. • Remove the infuser and thoroughly clean the inside of the appliance, as described in chapter 11.2. Repeat the operation, but switch the appliance on first
The coffee does not run out from the spouts, but from around the service door.	<ul style="list-style-type: none"> • The holes in the spouts are clogged with dry coffee. • The mobile container inside the service door is blocked and cannot swing. 	<ul style="list-style-type: none"> • Scrape the holes with a needle (see chapter 11.1, Fig. 24). • Thoroughly clean the mobile container, particularly near the hinges to ensure they are free to swing smoothly.