

# vapour<sup>M3</sup>

## FLOOR STEAM CLEANER WITH ULTRA DRY STEAM

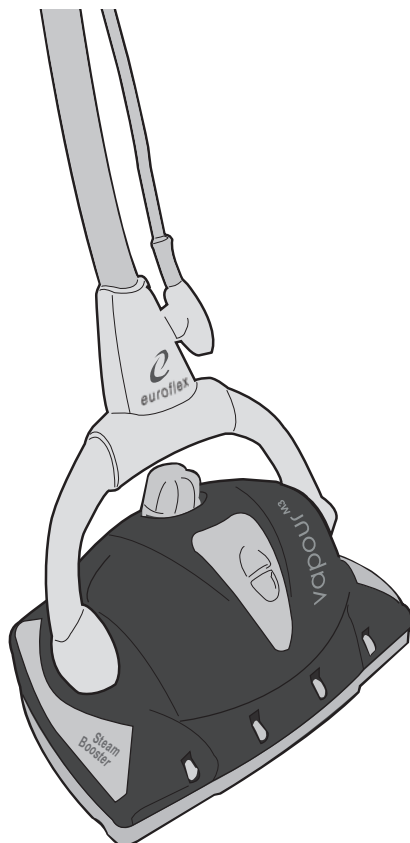

### Floor Steam Cleaner with Frontal Steam Jet

#### INSTRUCTION MANUAL

Before using this product, please read the instructions and keep it for future references

**CUSTOMER SERVICE:**  
**1800 663 866 (AUS) 0800 666 783 (NZ)**

Model #: SC1D1 AUS, NZ

# IMPORTANT SAFE T

SAVE THESE INSTRUCTIONS

**When using an electrical appliance, basic safety precautions should always be observed, including the following:**

**Read all instructions before using this appliance.**

**WARNING:** To reduce the risk of fire, electrical shock, or injury:

1. This appliance is authorized for household/domestic use only.
2. Do not charge or use outdoors or on wet surfaces. Do not immerse the floor steamer in water or other liquids.
3. Do not allow floor steamer to be used as a toy. Close attention is necessary when used by or near children. Do not leave Steamer unattended. Always unplug unit when not in use.
4. Use only as described and for the uses described in this manual. Use only manufacturer's approved and supplied parts and accessories. Use of other accessories is not recommended and will void the warranty.
5. Always make sure the Handle Assembly is in the upright "off" position before plugging in or unplugging. Keep cord away from heated surfaces (e.g., cooking surfaces), and sharp edges and corners.
6. Do not use if power cord or plug has been damaged, or if any part of appliance has been dropped, damaged, left outdoors, or dropped in water. Do not attempt to disassemble or repair appliance. Return it to the manufacturer or an authorized service center for examination or repair.
7. Do not wrap cord too tightly around appliance. Never carry by the cord or yank to disconnect from an outlet. To unplug, always grasp plug to remove from outlet – do not pull on cord.
8. Do not handle cord or appliance with wet hands or without shoes on.
9. Look closely at Steamer and follow all labels and marking instructions.
10. Do not put any objects into openings. Do not use with any opening blocked.
11. Before filling with water or emptying, always place Handle Assembly in upright "off" position, unplug Steamer and allow it to cool completely.
12. Turn the Boiler Cap slowly to open the boiler – this will allow any remaining steam to escape gradually.
13. Use caution while emptying the appliance. Contact with hot water or steam may cause burns.
14. Be sure Boiler Cap is (and remains) closed and do not open during use.
15. The Antibak Tank Cover should never be opened during use except to refill while Steamer is stationary.
16. Never use cleaning solutions, perfumes, oils, Antibak or substances other than tap or distilled/demineralized water in the Boiler. Use of any chemicals in Boiler may damage Steamer and will automatically void the warranty.
17. Antibak should ONLY be used in the Antibak Tank (as detailed on pages 9 and 10).
18. When in use, never turn the appliance on its side. Remove the plug from the socket-outlet before cleaning or maintaining the appliance. Do not direct steam at people, animals, plants or electrical equipment (i.e, inside an oven).
19. Do not operate around flammable or combustible liquids such as gasoline, or in areas where fumes may be present.
20. To reduce the likelihood of circuit overload, do not operate another high wattage appliance on the same circuit. Plug in to a standard (220-240V, 50/600Hz) electrical outlet.

**ATTENTION: This appliance is equipped with a 3-prong grounded power cord. Insert only into a 3-prong grounded electrical outlet. Do not try to remove the contacts of the grounded connection.**

# TY INSTRUCTIONS

SAVE THESE INSTRUCTIONS

21. Do not use extension cords or outlets with inadequate voltage.
22. Store appliance indoors in a cool, dry place.
23. If appliance or supply cord is damaged, it must be repaired by the manufacturer or an authorized service agent to avoid safety issues or risk of danger to the operator.
24. This appliance is not intended for use by persons (including children) with reduced physical, sensory or mental capabilities, or lack of experience and knowledge, unless they have been given supervision or instruction concerning use of appliance by a person responsible for their safety. Children should be supervised to ensure that they do not play with the appliance.
25. Do not use Antibak sanitizer on carpets or rugs (or any other soft furnishings such as mattresses or lounge). When using the Carpet Glide on carpets or rugs, do not pull the trigger on the Handle to dispense Antibak. The steam coming from the bottom of the Steamer is sufficient to refresh carpet or rugs.
26. Read and follow all important notices in this guide.

**Euroflex relieves itself of any liability for damages that shall be the result of improper use of the appliance, not in conformity with what's written in this instruction manual.**

## CAUTIONS

- *Do not use your Floor Steamer without a Hard Surface Pad or Carpet Glide & Pad attached to the system.*
- *Never leave your Floor Steamer in one spot on any surface for any period of time. Always place on the Parking Pad and make sure the Floor Steamer Handle Assembly is in the fully upright position when not in use - this turns the Steamer Off.*
- *DO NOT disassemble Floor Steamer after assembly. This will cause damage.*

## \*IMPORTANT\*

*Please read all of the instructions for use and Important Safety Instructions carefully. Remove and discard all packaging materials and keep them out of the reach of children.*

## Save your back

No need to press hard

The steamer does the work for you



## WARNING

THIS FLOOR STEAMER WAS DESIGNED TO USE **ANTIBAK** CLEANING SOLUTION **ONLY! DO NOT USE** ANY OTHER SOLUTION OR CLEANING AGENT OR YOU WILL HARM THE STEAMER AND VOID THE WARRANTY.

*Attention: the photographs and/or drawings in this document are for illustrative purposes only. Actual appliance and the accessories may vary due to product enhancement.*

**Safety Informations in Digital Format: [www.plastecs.it/warning](http://www.plastecs.it/warning)**

## One (1) Floor Steamer

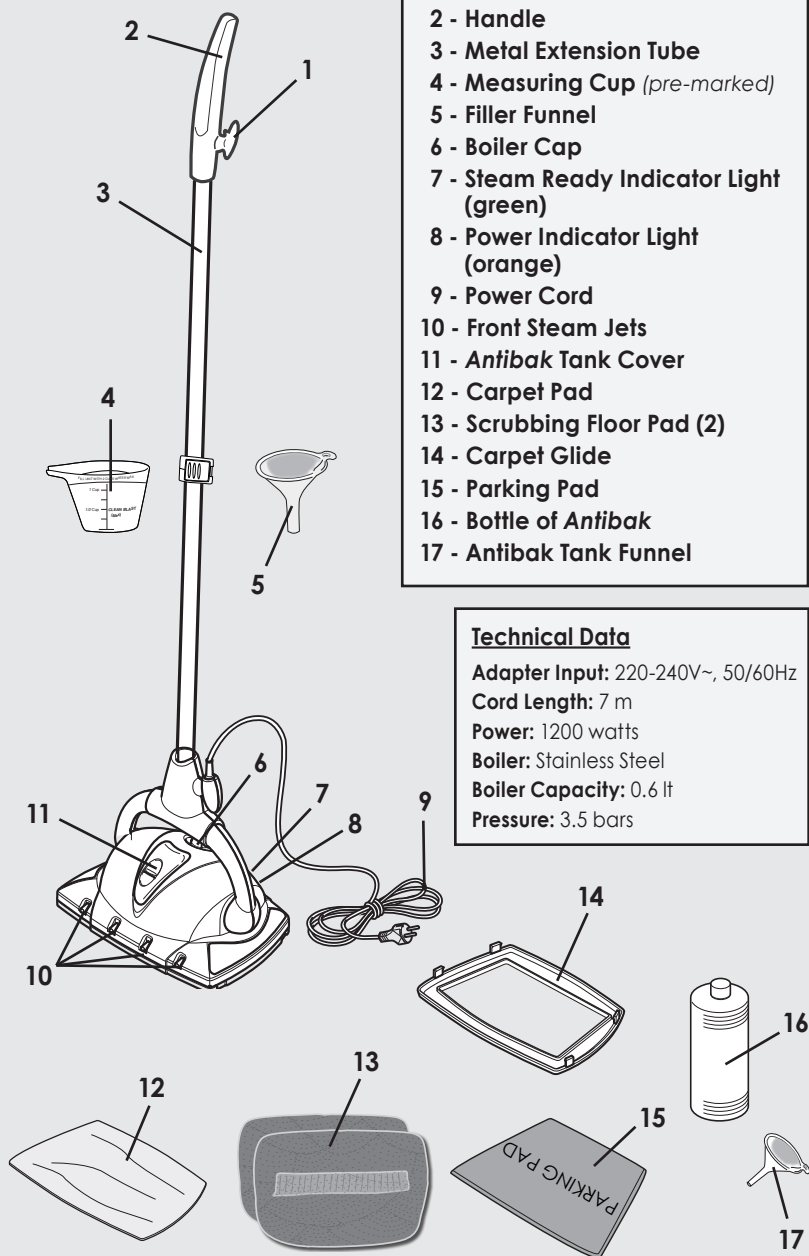

- 1 - Cord Winder
- 2 - Handle
- 3 - Metal Extension Tube
- 4 - Measuring Cup (*pre-marked*)
- 5 - Filler Funnel
- 6 - Boiler Cap
- 7 - Steam Ready Indicator Light (green)
- 8 - Power Indicator Light (orange)
- 9 - Power Cord
- 10 - Front Steam Jets
- 11 - *Antibak* Tank Cover
- 12 - Carpet Pad
- 13 - Scrubbing Floor Pad (2)
- 14 - Carpet Glide
- 15 - Parking Pad
- 16 - Bottle of *Antibak*
- 17 - *Antibak* Tank Funnel

### Technical Data

Adapter Input: 220-240V~, 50/60Hz

Cord Length: 7 m

Power: 1200 watts

Boiler: Stainless Steel

Boiler Capacity: 0.6 lt

Pressure: 3.5 bars

# 1 Assembly of Parts & Preparation of Steamer

Make sure all parts are in the box (see pg 4).

**IMPORTANT:** FOLLOW THESE INSTRUCTIONS CAREFULLY!

## A. Assemble Handle

After removing Handle Assembly from carton:

1. Pull Extension Tube apart until you see the lock opening (hole) on the Tube.

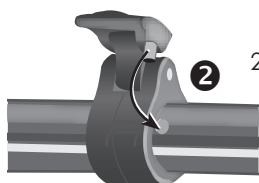
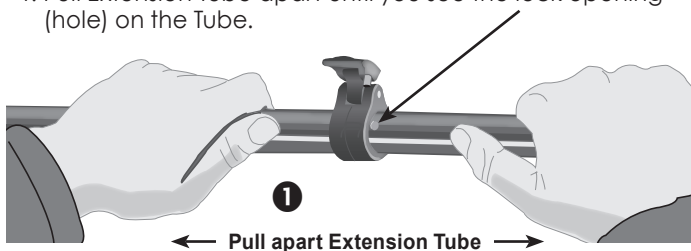

2. Line up the peg on Locking Clamp with the hole on Extension Tube and...

3. Snap the Locking Clamp closed, to lock the Extension Tube in position.

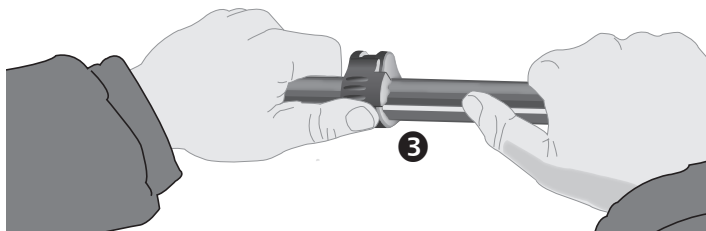

### \*IMPORTANT\*

Frontal steam can only be generated when Extension Tube is in the "Maximum Extension" position. **BE SURE EXTENSION TUBE IS FULLY EXTENDED AND LOCKED IN PLACE FOR OPTIMAL STEAM OPERATION.**

## B. Attach Handle to Steamer

- Before starting, remove the self-tapping screw from the bottom of Extension Tube.
- Insert the Handle Assembly into the Floor Steamer Base. Align Arrow on Handle with Arrow on Base (as shown in Fig. A).
- Once inserted, twist Handle Assembly 90° clockwise (as shown in Fig. B). Be sure Arrow on the Handle is aligned with Line/Lock Icon on Base.

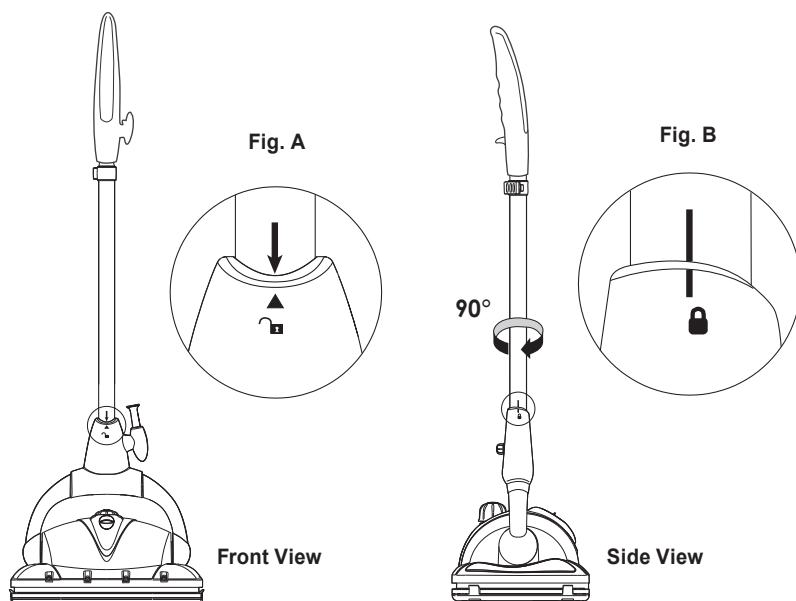
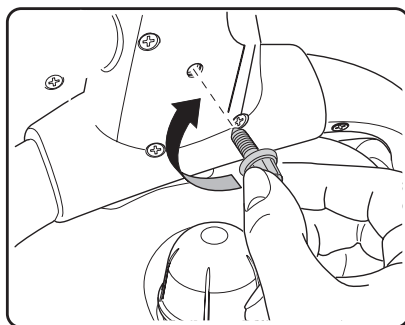

Fig. C



- Align the Handle Assembly screw hole with the opening in the steamer housing.

Secure the Handle assembly with self-tapping screw which was removed from bottom of Extension Tube (as shown in Fig. C).

## C. Attach Cleaning Pads to Steamer

**WARNING:** To prevent floor damage, ALWAYS attach either the Scrubbing Floor Pad or the Carpet Glide Accessory with Carpet Pad when using your Floor Steamer. NEVER USE WITHOUT EITHER OF THESE ATTACHMENTS AFFIXED TO THE MACHINE.

### ATTACHING SCRUBBING FLOOR PAD

**Scrubbing Floor Pad** – Place Scrubbing Floor Pad face down on the floor, wide side forward, with center Scrub Strip facing down (and positioned to match metal heat plate on bottom of Base-see “A”). Hold Floor Steamer about 2" above Pad and gently place Floor Steamer on the Pad. Firmly press down to assure Pad is adhered to the Floor Steamer.

**A - Heat Plate** on bottom of Base provides additional cleaning boost.

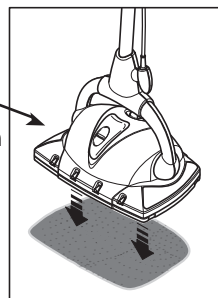
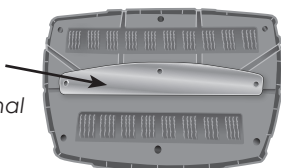

### ATTACHING CARPET GLIDE WITH CARPET PAD

Place Carpet Glide face up on floor. Center and place Carpet Pad on top of Carpet Glide. Hold Floor Steamer over Carpet Glide and gently lower the Steamer onto the Glide. Make sure the 4 clips on Glide are around the outside of the Steamer Base and using hands, attach the 4 clips of the Carpet Glide to the Steamer Base.

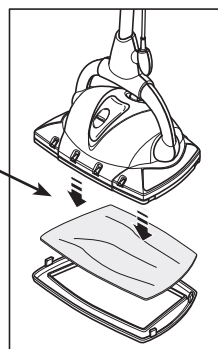

**USE ON HARDWOOD FLOORS** – For hardwood floors, use only on “sealed” hardwood surfaces. Move Steamer forward and backward while cleaning, carefully observing the amount of steam used, as too much water could cause damage.

### IMPORTANT NOTE ABOUT LINOLEUM FLOORING

*Steam can cause wax to be stripped from, and consequently damage, some varieties of linoleum flooring. ALWAYS test a small, inconspicuous portion of the floor BEFORE using steam to ensure that your linoleum floor does not have this issue. For some varieties of linoleum or vinyl floors the floor steamer is harder to push forward and back.*

**NOTE:** See “Maintenance & Cleaning” for care and cleaning instructions for Microfiber Pads.

## D. Filling Boiler with Water

### WARNINGS:

- Carefully read all instructions before removing Boiler Cap.
- Always unplug appliance before filling the Boiler.
- The appliance must be unplugged after use and before performing user maintenance on the appliance.

### \*IMPORTANT\*

**Use ordinary tap water. Distilled or demineralized water is recommended if tap water is too hard.** DO NOT add detergents, perfumes, oils, Antibak or other chemical substances to the Boiler. The product warranty will be null and void if anything other than water is added to the Boiler.

**Follow these instructions to avoid overfilling the Boiler.**

- Be sure appliance is unplugged from the electrical power outlet, and has **cooled for at least 5 minutes before filling with water.**
- **Make sure Handle Assembly is in the upright "off" position.** Remove Boiler Cap by turning it counterclockwise.

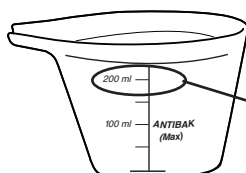
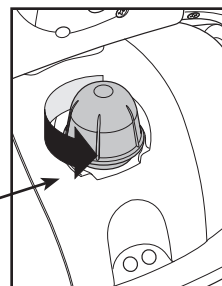

- Pour in 600 mls of water using the Measuring Cup and Filler Funnel provided – fill cup to the "200 ml" marking three times. **Be careful not to overfill the Boiler.** Please note that excess water will be flushed out during use if the Boiler is overfilled, resulting in wet floors.

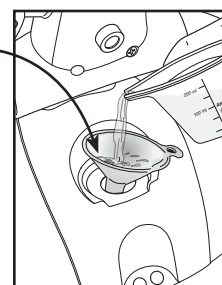

- Replace Boiler Cap by turning it clockwise. *Do not tighten Boiler Cap too much – finger tightening is sufficient to lock the steam in the Boiler.*

If using cold water, heating time is about 3-5 minutes. If using warm water, heating time is reduced.

### \*IMPORTANT\*

Do not overfill the Boiler as excess water will be flushed out of the Boiler before dry steam will emit. If re-filling the Boiler while Steamer has been in use, be sure to allow Steamer to cool for at least 5 minutes and loosen Boiler Cap slowly to allow any excess steam to escape before completely removing Cap. (See step 2D, "Refilling Boiler During Use" for detailed instructions.)



## E. The Antibak Sanitizing System

This Superclean Floor Steamer is equipped with a unique on-demand option designed to sanitize your non-porous hard floor surfaces (sealed wood, tile, marble, granite, linoleum, etc.).

Included in this package is a 200 ml bottle of “**Antibak**”, a special sanitizing agent that will quickly kill up to 99.9% of germs and bacteria.

The Antibak continues to work after it's used, by killing bacterial spores for up to 7 days following use. Be sure to use as directed.

### Adding Antibak Sanitizer

- Push Antibak Tank Cover in the upward direction (as shown in “A”) to reveal opening.
- Insert the small Antibak Tank Funnel in the Antibak Tank.
- Use provided Measuring Cup to fill the Antibak Tank (Figs. “B” and “C”). Pour Antibak into Measuring Cup up to the “Antibak (Max)” marking. We recommend tilting the Steamer back when filling the Antibak Tank. Be careful not to overfill.

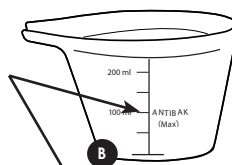
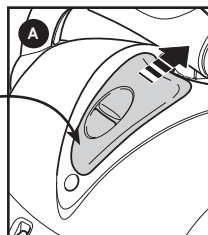

**REMEMBER: YOU CAN FILL THE ANTIBAK TANK WHEN THE STEAMER IS ON AND HOT. BUT NEVER FILL THE BOILER TANK WHILE THE STEAMER IS HOT!**

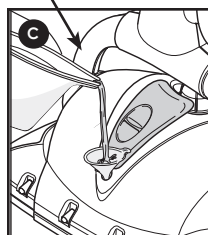

- Remove the small Antibak Tank Funnel from the Antibak Tank.

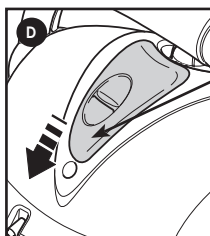

- Close the Antibak Tank Cover “D”.

- You can now sanitize on demand by pulling back the Trigger on the Handle “E”.

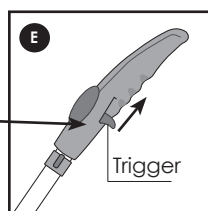

**WARNING:** Do not put Antibak sanitizer in the Boiler. This will damage the Steamer and it will void the warranty.

Continued on next page

## E. The Sanitizing System *(continued)*

- The sanitizer is delivered to the surface only through the front ports of the Steamer "F".

**WARNING:** Only use Antibak sanitizer in the Antibak Tank located on the front of Steamer.

The Steamer was designed to be used with Antibak only. Any other cleaning solution used may harm your Steamer and will void the warranty.

**HINT:** A little Antibak goes a long way – no need to soak your floor.

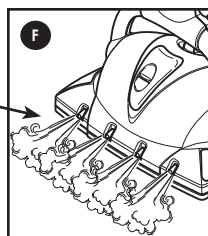

### \*IMPORTANT\*

*Do not use Antibak sanitizer on carpets or rugs (or any other soft furnishings such as mattresses or lounge). When using the Carpet Glide on carpets or rugs, do not pull the trigger on the Handle to dispense Antibak. The steam coming from the bottom of the Steamer is sufficient to refresh carpet or rugs.*

## 2 Using Your Floor Steamer

### A. Using the Parking Pad

#### \*IMPORTANT\*

*The Parking Pad is provided to prevent floor damage that can result from leaving a hot steamer resting on the same spot for too long. ALWAYS place Floor Steamer on the Parking Pad when not in use, or while it is cooling before storage.*

*You can use the Parking Pad if the Steamer is warm or hot.*

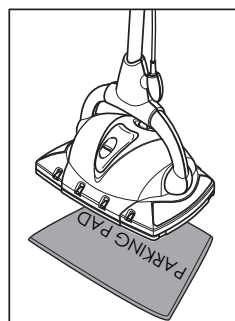

### B. Starting the Appliance

- Be sure Boiler is filled with water, Boiler Cap is securely in place and Antibak (if using) has been added to Antibak Tank.
- Insert the plug into a 3-prong grounded electrical outlet (orange Power Indicator Light will illuminate).
- Keep the Handle in the upright "off" position. Wait until the (green) Steam Ready Indicator Light illuminates.
- Once Boiler is filled and the green Steam Ready Indicator Light illuminates, the Floor Steamer is ready to clean.

**PLEASE NOTE:** The green Steam Ready Indicator Light will turn on and off during use. This is normal and not a fault.

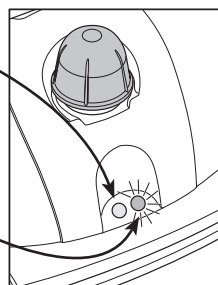

## C. Using Floor Steamer

- To start cleaning using the bottom steam ports, simply pull the Handle downward. Always use a Microfibre Pad.

You will find that your Floor Steamer can easily clean most hard floors using the underside steam alone.

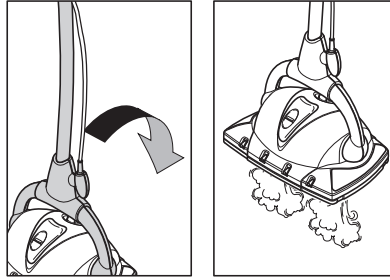

**NOTE:** Some water may be emitted when the Handle is first pulled down after filling or when trigger on the Handle is pulled. This is normal.

**To stop steam,** simply return Handle to the upright position.

**The Floor Steamer will stop producing steam when the Boiler is empty. When this happens, refill with water according to the instructions (see step 2D, "Refilling Boiler During Use").**

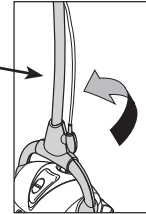

## To Use the Sanitizing System

The Superclean Steamer will sanitize non-porous hard floor surfaces by using a sanitizing agent called Antibak. The Antibak will also keep floors sanitized by stopping the growth of bacterial spores for 7 days after use.

**To sanitize** your floors using Antibak, follow the filling instructions on page 9 of this manual.

**To release** the Antibak onto the floor, pull the trigger on the Handle. The Antibak will mix into the steam as it exits from the 4 front steam jets. Push the steamer back and forth on the floor to spread the Antibak.

A small amount of Antibak goes a long way. One pull of the trigger will release enough Antibak to cover an area of 1 meter by 1 meter. The Antibak sanitizer that is mixed with the steam coming from the front jets will get under furniture and cabinets and disinfect to a distance of 30 cm.

Refill the Antibak Tank as needed. Once the Antibak runs out, replacement bottles can be purchased from the appliance retailer who sold you the Superclean Floor Steamer.

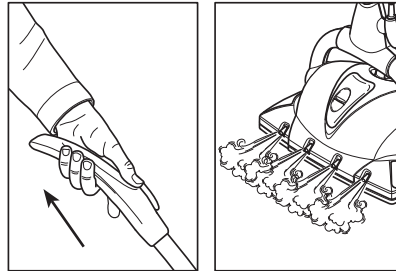

**REMINDER:** If Floor or Carpet Pad become too wet or too dirty, replace with a clean, dry Pad and continue cleaning.

### \*IMPORTANT\*

**Do not use Antibak sanitizer on carpets or rugs (or any other soft furnishings such as mattresses or lounge). When using the Carpet Glide on carpets or rugs, do not pull the trigger on the Handle to dispense Antibak. The steam coming from the bottom of the Steamer is sufficient to refresh carpet or rugs.**

## D. Refilling Boiler During Use

When the Floor Steamer has run out of water, there will be no more steam coming out of the unit. At this stage it is time to refill the Boiler. Follow the refilling instructions below.

### \*IMPORTANT\*

*The Floor Steamer has a Boiler that should not be overfilled. To avoid the potential for overfilling, only refill the Boiler when it is completely run out of water and only add 600ml. Always follow the practice of using the Floor Steamer until it has run out of water and then refill 600ml only.*

*If floor cleaning is completed and water remains in the Boiler, the Floor Steamer can be stored with the remaining water in the Boiler, there will be no harm done to the unit. At the next cleaning session simply heat up the unit and use the water already in the Boiler, then refill when empty.*

*Or alternatively at the next cleaning session, open the Boiler Cap when the unit is still cold and pour out the water and then refill (if this alternative method is used, it is recommended that only 500ml of water is added, because the unit will not completely drain when the water is poured out from the Boiler).*

**WARNING:** Let Steamer cool 5 minutes before opening Boiler Cap. Use care when opening Boiler Cap as it may still be hot and steam may escape, causing burns. If Boiler is still hot, water may spurt out during refilling which can also cause burns.

- **Unplug the appliance from the electrical power outlet. This will stop the Steamer from continuing to heat up.**
- Once unplugged from the power outlet, place Handle in the "On" position to release any residual steam and pressure from the Boiler.
- After all steam and pressure has been expressed from the Steamer, return the Handle to the upright "Off" position.
- Slowly turn Boiler Cap counterclockwise. This will allow remaining steam to escape.
- **Be sure Steamer has cooled 5 minutes before refilling with water.**

*The product warranty will be null and void if anything other than water is added to the Boiler.*

- Pour in 600 mls of water using the Measuring Cup and Filler Funnel provided – fill the Measuring Cup to the 200 ml marking 3 times. *Be careful not to overfill the Boiler.*
- Replace Boiler Cap by turning it clockwise. *Do not tighten Boiler Cap too much – finger tightening is sufficient to lock the steam in the Boiler.*
- Insert plug into 3-prong electrical outlet. Wait for green Steam Ready Indicator Light to turn on. Steamer is ready to use once again.

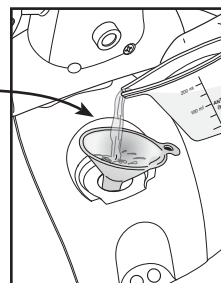

**REMINDERS**

- Always use ordinary tap water.
- If tap water is too hard, use distilled or demineralized water to avoid the risk of mineral deposits and sediment from forming.
- Do not add detergents, perfumes, oils or other chemical substances to the Boiler or Antibak Tank. This will damage the Steamer and void the warranty.
- The green Steam Ready Indicator Light may turn on and off during use. This is normal and not a fault.
- Only use Antibak sanitizer in the front Antibak Tank.

**\*IMPORTANT\***

Do not overfill the Boiler as excess water will be flushed out of the Boiler before dry steam will emit.

### 3 Cleaning the Floor Steamer

We recommend you periodically clean the Floor Steamer to prevent the accumulation of calcium, mineral deposits and other sediment caused by the use of tap water. After every 10-15 refills, fill the Boiler three-quarters full of hot tap water, shake several times and empty out the water into sink. Repeat several times to ensure that the Boiler is flushed of any calcium or mineral deposits. Wipe the Steamer base with a damp cloth and dry.

**NEVER HOLD THE STEAMER UNDER THE TAP TO FILL. Use the Measuring Cup and Funnel provided to fill the Boiler.**

**If distilled or demineralized water is regularly used in the Steamer, cleaning of the Boiler can be done less frequently. In some areas tap water is very hard, it is recommended that the Boiler is cleaned more frequently if hard water is used.**

***The cleaning of the Boiler and Steamer is the sole responsibility of the appliance owner. Calcium, mineral deposits and other sediment left to build up in the Floor Steamer causing the Steamer to fail and/or the steam pathways in the Steamer to block, is not covered by the product warranty. Users must follow the cleaning instructions above.***

If the Steamer and Boiler are not cleaned according to the instructions above and the product fails and/or the steam pathways are blocked, the appliance owner should send the product for servicing by contacting the Customer Support Line.

**The Superclean Floor Steamer is intended for domestic household use only. It is not intended for commercial use. Any use other than for domestic household purposes will void the product warranty.**

**\*IMPORTANT\***

*Do not add detergents, perfumes, oils, or other chemicals to the Boiler. The product warranty will be null and void if anything other than water is added to the Boiler.*

## Microfiber Pad Care & Cleaning

Your Microfiber Pads are designed for hundreds of uses. Clean Pads regularly, either by hand (using mild soap and warm water) or in your clothes washer on a delicate cycle, cool water. Never use fabric softener or bleach. We recommend letting Pads air dry to maintain maximum long term effectiveness.

Replacement pads are available at most retail outlets or by calling customer service.

### Microfiber washing instructions – ULTRA MICROFIBRE

SCRUBBING FLOOR PAD	CARPET PAD
75% Polyester / 25% Polyamide	80% Polyester / 20% Polyamide
Hand wash only	Hand wash only
Tumble dry low or air dry	Tumble dry low or air dry
No bleach / No fabric softener	No bleach / No fabric softener

Issues	Possible Causes	Solutions
Steam is not coming out of the Steam Nozzles.	Improper Handle assembly.	Call Customer Service to receive instructions to correct the problem.
The Scrubbing Floor Pad is not adhering to Steamer.	Not enough pressure was applied when attaching Pad.	Position Steamer about 2" above Pad and FIRMLY press it down onto the Pad.
	Floor Pad requires replacing due to age of the Floor Pad.	Replacement Floor Pads can be purchased at most electrical appliance retail outlets.
The Cleaning Pads are getting soaked (too wet). Why?	Boiler is overfilled.	Let Steamer run until excess water ceases. -OR- Remove some water from Boiler once the Boiler has cooled down completely.
	Green "Steam Ready Indicator Light" is not illuminated.	Wait for green "Steam Ready Indicator Light" to illuminate.
The steam seems to be making my floor too wet.	Front Steam Jets are being used too frequently.	Only use Front Steam Jets in short bursts for cleaning tougher stains or to clean hard to reach areas.
	Antibak Sanitizer Trigger is being used too often.	Pull the Trigger less frequently, use more sparingly.
	The Cleaning Pad is too wet (saturated with moisture)	Replace the wet Pad with a dry, clean Pad and continue cleaning.
The Antibak is running out quickly.	Trigger is being used too frequently.	Pull Trigger less frequently and use Antibak more sparingly.

## IMPORTANT QUESTION:

**Q: Do I always need to use a Microfiber Pad when cleaning with my Steamer?**

**A. YES!** It is critically important to ALWAYS use your Microfiber Pads. The Floor Steamer should NEVER be used without either a Hard Surface Floor Pad or Carpet Glide with Carpet Pad.

### **Customer Support**

Customers needing assistance with their Floor Steamer can call the Customer Support Line on the phone numbers listed below. Customers should also call the Customer Support Line if they require product warranty repair or post-warranty product servicing. Our friendly Customer Service Team can assist you with getting the best cleaning results from your Floor Steamer, they are full of helpful steam cleaning tips, too.

#### **Customer Support Line**

**AUSTRALIA** 1800 663 866  
**NEW ZEALAND** 0800 666 783

#### **Euroflex Australia Pty Ltd**

79 Furniss Road  
DARCH WA 6065  
AUSTRALIA  
TEL: 08 9302 2526  
Email: [admin@euroflex.com.au](mailto:admin@euroflex.com.au)  
Website: [www.euroflex.com.au](http://www.euroflex.com.au)

#### **Euroflex New Zealand Ltd**

c/- Dubins  
137 Glenfield Road  
Birkenhead Auckland 0626  
NEW ZEALAND  
TEL: 0800 666 783  
Email: [admin@euroflex.com.au](mailto:admin@euroflex.com.au)  
Website: [www.euroflex.com.au](http://www.euroflex.com.au)

#### **Plastecs SRL**

Via dei Colli, 59  
31058 Susegana (TV)  
ITALY  
Tel: +39 0438 453334  
Email: [info@plastecs.it](mailto:info@plastecs.it)  
Website: [www.euroflex-appliances.com](http://www.euroflex-appliances.com)

