

the Kinetix[®] To Go[™]

Instruction Book - BBL290

Breville[®]

BREVILLE RECOMMENDS SAFETY FIRST

At Breville we are very safety conscious. We design and manufacture consumer products with the safety of you, our valued customer, foremost in mind. In addition we ask that you exercise a degree of care when using any electrical appliance and adhere to the following precautions.

IMPORTANT SAFEGUARDS FOR ALL ELECTRICAL APPLIANCES

READ ALL INSTRUCTIONS
BEFORE USE AND SAVE
FOR FUTURE REFERENCE

- Remove and discard all packaging materials and stickers before first use.
- To avoid choking hazard for young children, remove and safely dispose the protective cover fitted on the power plug.

- This appliance is for household use only. Do not use it in moving vehicles or boats, do not use it outdoors, and do not use it for anything other than its intended use. Misuse can cause injury.
- This appliance should not be used by children. Keep the appliance and its cord out of reach of children. Cleaning and user maintenance shall not be made by children without supervision.
- Children shall not play with the appliance.
- This appliance can be used by persons with reduced physical, sensory or mental capabilities or lack of experience and knowledge if they have been given supervision and instruction concerning use of the appliance in a safe way and if they understand the hazards involved.
- Do not use the appliance near the edge of a countertop or table. Ensure the surface is level, clean and free of water and other substances. Please be aware that vibration during use may cause the appliance to move.
- Do not use the appliance on (or close to) a hot gas or electric burner, or where it could touch a heated oven or surface.
- Do not allow the cord to hang over the edge of a countertop, or to become knotted.
- To avoid electric shock, do not immerse the cord, plug or motor base in water (or other liquids).
- Installation of a residual current device (a standard safety switch on your wall socket) is recommended to provide additional safety protection when using appliances. It is advisable that a safety switch (with a rated residual operating current not more than 30mA) be installed in the electrical circuit supplying the appliance. Contact your electrician for further professional advice.
- In order to avoid the possible hazard of the blender starting by itself due to inadvertent resetting of the overload protector on the motor, do not attach an external switching device (such as a timer) or connect the blender to a circuit that can regularly switch the blender on and off.

- Do not operate appliance with a damaged cord or plug, or after appliance malfunctions, or if dropped or damaged in any way. Stop use immediately and contact Breville by phone or email for replacement or repair.
- All maintenance (other than cleaning) is to be done by an authorised Breville Service Centre.
- Authorised Breville Service Centres can be found on our website **www.Breville.com.au**. Alternatively, you can contact the Breville Customer Care Centre by phone on **1300 139 798** or email **AskUs@breville.com.au**

SAFEGUARDS FOR YOUR BLENDER

- Wash the blender jug, blending bottle, blades and lids with warm soapy water before first use.
- Use only the blender jug, blending bottle, blades and lids that are supplied with this blender. The use of attachments or accessories not manufactured or specified by Breville may cause the risk of fire, electrical shock, or injury.

- Always ensure the blender is assembled properly before using. Lid and blades must be firmly secured before operation to ensure internal contents do not escape, spray or overflow.
- Never attempt to operate or place the blade assembly onto the motor base without the blending bottle in place.
- Do not put any parts or accessories in a microwave.
- Do not blend carbonated liquids, as they will expand.
- Do not leave the blender unattended when in use.
- Keep hands, fingers, hair and clothing away from the blender during use. Always turn blender off and unplug at the wall before reaching inside. Avoid touching moving parts.
- Be careful when handling and cleaning blades, as they are very sharp. Mishandling of the blades may cause injury.
- Avoid putting the blending bottle on the motor base while the motor is still spinning.
- Do not remove the jug from the motor base while blender is in use.
- The blender is intended for food or drinks preparation. Do not use for anything other than food or drinks. Do not operate without any ingredients in the blender jug.
- Never attempt to operate with damaged blades, or with utensils, or any foreign objects inside the blender jug.
- To reduce the risk of severe injury to persons or damage to the blender, keep hands and utensils out of the jug while blending.
- Never blend hot liquids in the main jug. Allow ingredients and liquids to cool down to a warm state or to room temperature before putting into the jug for blending. Hot liquid can be ejected out of the appliance due to a sudden steaming.
- Never blend hot or even warm ingredients in the blending bottle. Hot or warm ingredients will expand and cause pressurisation.
- Under heavy load, the blender should not be operated for more than 30 seconds. Heavy load was defined as per the appliance safety standard specified load (bowl filled to its maximum indicated level with a mixture comprising two parts by mass of soaked carrots and three parts water). Any load equivalent to this or heavier should not be operated for more than 30 seconds.
- If the motor is straining under a heavy load, do not operate continuously for more than 10 seconds. Allow the motor to rest for 1 minute between uses on heavy loads. Note that none of the recipes in these instructions are considered a heavy load.
- Do not fill the blending bottle past the MAX level marking as this will cause the motor to strain under heavy load and may cause potential leakage. It will also reduce blending performance. Note that some mixtures increase in volume when blending.
- Do not put the blender jug in extremes of heat or cold, for example placing a cold jug into hot water, or vice versa.
- Before moving the blender, cleaning or putting it away for storage, always turn blender off and unplug at the wall.
- Always disconnect the appliance from the supply if it is left unattended and before assembling, disassembling.

SAVE THESE INSTRUCTIONS



Components

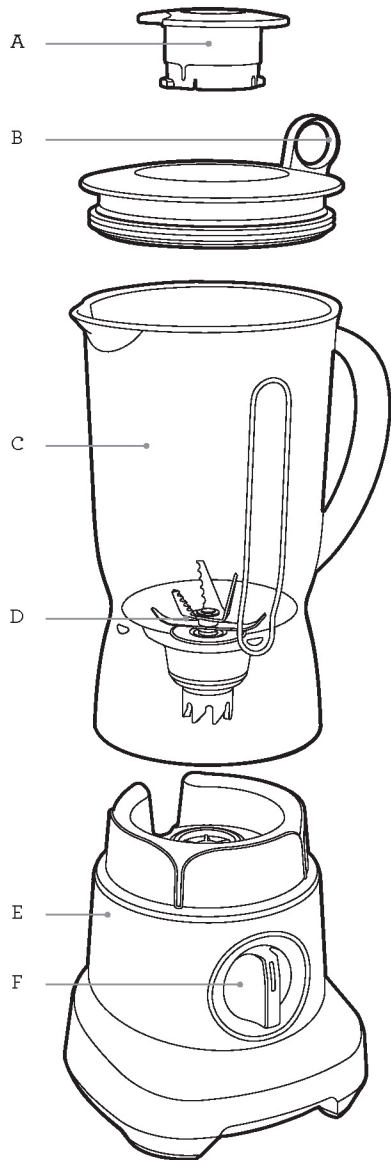

A. Inner measuring blending bottle
Remove to add ingredients while blending.

B. Breville Assist™ lid
Ring pull lid for easy removal.

C. BPA-free 1.5 litre jug

D. MiniKinetix® blade and bowl system
Contoured to the base of the jug so there are no food traps. Central blades are serrated for extra cutting performance, and the outer blades create the Kinetix motion.

E. Overload protection
Resettable thermal fuse for motor protection.

F. Speed control dial

BREVILLE ASSIST™ PLUG

Your Breville appliance comes with a unique Breville Assist™ Plug, conveniently designed with a finger hole to easy removal from the wall outlet.

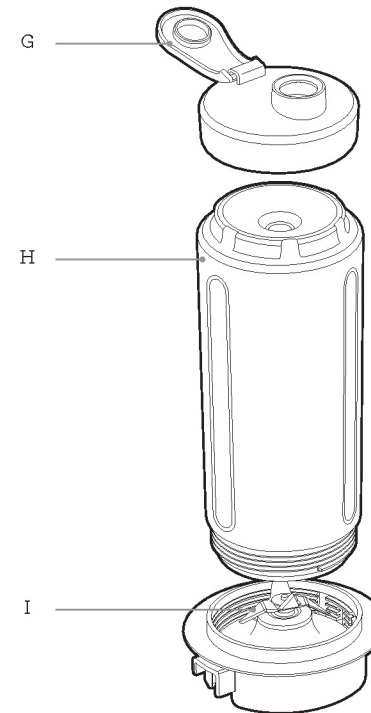

G. Portable lid

Remove the blades and put on the easy to drink lid, with a pop open cap, so you can take your smoothie on the go.

H. BPA-Free Tritan® Blending Bottle
Blend and drink from the same bottle at home or on the go.

I. Blending Bottle Blades
Removable blades for blending directly in the drinking bottle.

EASTMAN TRITAN™ COPOLYESTER

This blending bottle is made with Eastman Tritan™ copolyester, which is a tough, BPA - free polymer used to make housewares products that can stand up to extreme use and repeated dishwasher cleaning. Products made from Tritan™ are impact resistant and shatter resistant and stay clear and durable even after hundreds of cycles in the dishwasher.



Assembly

BEFORE FIRST USE

- Before using your blender for the first time, remove any packaging material and promotional labels.
- Be careful when handling the blades as they are extremely sharp.
- Wash the jug, bottle, lids, blade assembly and attachments in warm soapy water with a soft cloth. Rinse and dry thoroughly. All parts (except motor base) may be washed in the dishwasher, on the top shelf.

PORTABLE BOTTLE ASSEMBLY

1. Remove blades and position the bottle with opening facing up.
2. Add ingredients avoiding filling past the MAX line.
3. Fix the blade assembly securely in place by turning in the clockwise direction. Ensure the blade assembly collar is securely in place before inverting the bottle to blend.



Functions

MOTOR BASE SPEED CONTROL

Many recipes process best with a combination of speeds with occasional use of pulse.

PULSE

Momentary burst of high power.

CHOP

Low speed to combine more delicate foods with a folding motion, and is good for combining wet and dry ingredients.

BLEND

Medium speed and more control for creating batters or coarser textures.

LIQUIFY

High speed is ideal for breaking down ingredients to make ice based drinks and other finely blended mixtures.

BLENDING BOTTLE OPERATION

- The blender will only work when the blades and blending bottle are correctly assembled. This engages the safety interlock, and allows the motor to run.
- When the blending bottle and blade assembly is correctly assembled with ingredients inside, invert bottle, align and lock onto the motor base.
- Do not blend continuously for more than 60 seconds at a time. Allow the motor to rest for 2 minutes before continuing.
- Invert the bottle and allow the ingredients to run off the blades for a few seconds before unscrewing blades. Hold by the blade collar, and turn anti-clockwise to remove.



Tips

BLENDING JUG

- Run the blender only for the appropriate amount of time required. Do not over blend ingredients.
- Use the PULSE setting when food is too thick or coarse to circulate within the blender jug.
- Do not exceed the maximum mark.
- If any moisture or liquid appears on top of the motor base during blending, turn the blender off and unplug at the wall. Remove the blender jug, and wipe motor base immediately with a dry cloth or paper towel.
- The maximum amount of ice cubes that the blender can process is 8 cubes from a standard ice tray.

- Use the PULSE function for foods that only require short bursts of power, such as chopping nuts and crushing ice.
- When blending drinks with ice cubes or frozen fruit, use PULSE in short bursts.
- Thicker mixtures puree more efficiently if the jug is $\frac{3}{4}$ to $\frac{1}{2}$ full.
- Do not use metal utensils, as they may damage the blades or blender jug.
- Do not blend a heavy mixture for more than 10 seconds. For normal blending tasks, do not blend longer than 1 minutes at a time. If you need to blend longer, turn off the blender and stir ingredients before starting again. This rest will help protect the motor from wear and tear.
- The blender will not knead dough, or mash potatoes.
- When blending warm ingredients, do not put more than 2 blending bottles at a time in.
- Do not blend hot or boiling ingredients. Allow food to cool down to a warm state before placing in the blender. This is to safeguard against sudden bursts of steam that could cause the lid to dislodge.
- If blending warm ingredients, place a tea towel over the lid and hold down firmly.

BLENDING BOTTLE

- **IMPORTANT:** Never blend hot (or even warm) ingredients. Never blend carbonated drinks. The blades form a seal with the blending bottle, and there is no venting for steam to be released.
- We recommend blending no more than 1 minute at a time. Ingredients in the blending bottle may become warm and cause internal pressure on the seals making it difficult to open or splatter ingredients when opened. Allow to cool and take care when opening.
- Always blend with liquid. If the blending action is not causing the ingredients to circulate, try adding more liquid.
- If the results are lumpy, try reducing the ingredients, add more liquid or blending in batches.

- Blend only for the appropriate amount of time required – do not over blend ingredients.
- If foods are thick, pulse the ingredients to help them circulate.
- Do not exceed the maximum mark.
- The maximum amount of ice cubes the blending bottle can blend is 3 from a standard ice tray. This also applies to frozen fruit. Cut fruit into pieces of a similar size to an ice cube before freezing.

OVERLOAD PROTECTION SYSTEM

- The blender is equipped with an internal self resetting overload protector to protect the motor from damage under heavy or continuous loads. If the blender suddenly stops during use, this protector may have tripped.
- Remove the jug or bottle, unplug and leave it to cool for at least 30 minutes. Do not replace the jug or bottle assembly while cooling as the protector may reset causing it to start unexpectedly.
- Tripping the protector indicates that the blender is being loaded too heavily, or with excessive continuous use. Reduce the amount of ingredients used or allow more time in between blending to prevent it from happening again, which will help preserve the life of the motor.
- The MAX line is usually a good indicator to prevent overly heavy loading, however some especially dense combinations of ingredients may still strain the motor. If the motor seems to be straining or running slowly, only operate for 10 seconds at a time, or reduce the amount of ingredients used. Adding more liquid can also help to loosen dense mixtures.



Blending Chart

VESSEL	FOOD	PREPARATION	QUANTITY	FUNCTIONS	TIME
Bottle	Smoothie	Milk, fruit, yoghurt, ice cream	Max 600ml	BLEND or LIQUIFY	30-60 secs
Bottle	Ice or frozen fruit	Frozen no larger than standard ice cube tray size	Max 3 pieces	PULSE or LIQUIFY (blend with liquid)	50-60 secs
Jug	Smoothie	Milk, fruit, yoghurt, ice cream	Max 800ml	BLEND or LIQUIFY	60 secs
Jug	Ice or frozen fruit	Frozen no larger than standard ice tray	Max 8 pieces	PULSE or LIQUIFY	60 secs
Jug	Nuts	Remove shells	200g	CHOP	10-30 secs
Jug	Biscuits	Halved	125g	PULSE	60 secs
Jug	Blended soups	Cool to room temp	800ml	BLEND	50-60 secs

NOTE: This blending chart should be used as a guide only.



Troubleshooting

Motor doesn't start or blade doesn't rotate	<ul style="list-style-type: none"> Check that the power plug is properly inserted into the power outlet. Motor Overload Protection may have operated (see Overload Protection System section).
Food is lumpy or unevenly chopped	<ul style="list-style-type: none"> This can happen when too much food is being blended at one time. Try a smaller amount, and work in batches if necessary. The ingredients may be too large. Try cutting into smaller pieces. For best results, ingredients should be in pieces no larger than 2cm.
Food is chopped too fine or is watery	<ul style="list-style-type: none"> Try blending for shorter period of time. Use PULSE for better control.
Food sticks to blade and jug	<ul style="list-style-type: none"> The mixture may be too thick. Try adding more liquid, pulsing, and/or using a slower speed for blending.
Blender stopped suddenly while in use	<ul style="list-style-type: none"> This blender has overload protection to prevent damage to the motor. Unplug and allow the blender to cool down for 15 minutes. Once cooled, you will be able to use the blender as usual again. We recommend blending in smaller batches, or cutting ingredients into smaller batches.



Care & Cleaning

Unplug the power cord from the power outlet after use for safety reasons.

Jug, bottle, blades and lids

Avoid allowing food residue to dry on. Follow these steps as soon as possible after use:

- Rinse most of the residue off the jug, blending bottle, blades and lids.
- Hand wash in warm, soapy water using a mild liquid detergent and non-abrasive sponge.

Motor base

To clean the motor base, wipe with a soft, damp cloth then dry thoroughly. Wipe any excess food particles from the power cord.

Cleaning agents

Do not use abrasive scouring pads or cleaners on either the motor base or any part of the blender, as they may scratch the surface. Use only warm soapy water with a soft cloth.

Pressurisation

The blending bottle may be rinsed by adding cold water, attaching blades, and either blending or shaking by hand for 10 seconds.

IMPORTANT: There is a risk of pressurisation from hot water and/or detergent.

When rinsing by attaching blades and blending/shaking, never add hot or even warm water, as the steam produced can create dangerous pressurisation of steam.

Do not add detergent, as the foam produced will expand and may cause pressurisation.

Dishwasher

The jug, blending bottle, lids and blade assembly may be washed in the dishwasher on the top shelf only.

Stubborn food stains and odours

Strong smelling foods such as cumin and coriander, and some vegetables such as carrots may leave an odour or stain.

To remove, pour warm soapy water and fill to the MAX mark. Set aside to soak for 5 minutes. Then wash with a mild detergent and warm water, rinse well and dry thoroughly. Store blending bottle and jug with lids off.

Citrus in the blending bottle

Exposure to citrus oil may affect the clarity and longevity of the Tritan bottle.

After washing in detergent, rinse with plain water thoroughly, and allow to dry immediately.

Do not soak if citrus has been blended.

Storage

Store your blender upright with the blender jug assembled on the motor base, or beside it. Do not place anything on top. To allow air to circulate, keep the lid off.

Breville Customer Service Centre

Australian Customers

Mail: PO Box 22
Botany NSW 2019
AUSTRALIA

Phone: 1300 139 798

Fax: (02) 9384 9601

Email: Customer Service:
askus@breville.com.au

Web: www.breville.com.au

New Zealand Customers

Mail: Private Bag 94411
Botany Manukau 2163
Auckland NEW ZEALAND

Phone: 0800 273 845

Fax: 0800 288 513

Email: Customer Service:
askus@breville.co.nz

Web: www.breville.co.nz

Breville
Thought for food

Breville is a registered trademark of Breville Pty. Ltd. A.B.N. 98 000 092 928.
Copyright Breville Pty. Ltd. 2015.

Due to continued product improvement, the products illustrated/photographed
in this brochure may vary slightly from the actual product.