

the Kitchen Wizz™ 9

Instruction Book - BFP610



Breville®



Contents

- 2 Breville Recommends Safety First
- 8 Components
- 11 Assembly
- 14 Functions
- 15 Tips
- 17 Care & Cleaning
- 18 Troubleshooting

BREVILLE® RECOMMENDS SAFETY FIRST

At Breville we are very safety conscious. We design and manufacture consumer products with the safety of you, our valued customer, foremost in mind. In addition, we ask that you exercise a degree of care when using any electrical appliance and adhere to the following precautions.

IMPORTANT SAFEGUARDS

**READ ALL INSTRUCTIONS
BEFORE USE AND SAVE
FOR FUTURE REFERENCE**

- Remove any packaging material and promotional labels before using the food processor for the first time.
- Do not place the food processor near the edge of a bench or table or on a sink drain board during operation. Ensure the surface is level, clean and free of water, flour, etc. Vibration during operation may cause the appliance to move.
- Handle the food processor and attachments with care - remember the blades and discs are razor-sharp and should be kept out of reach from children.
- Care shall be taken when handling the sharp cutting blades, emptying the bowl and during cleaning.

- Always make sure the food processor is completely assembled, with the processing lid securely in position before operating. The appliance will not operate unless properly assembled.
- Ensure the OFF button has been pressed, and the food processor is switched off and unplugged from the power outlet before attaching or removing the blades, discs or processing lid.
- To unplug, grasp the plug and pull from the outlet. Never pull from the power cord.
- Always secure the processing bowl onto the motor base before attaching the blades or discs.
- Do not push food into the feed chute with your fingers or other utensils. Always use the food pusher provided.
- Keep hands, knives and other utensils away from moving blades or discs.
- Do not place hands or fingers in the bowl of the food processor unless the motor, blades or discs have come to a complete stop.
- To reduce the risk of fire, electric shock, or injury, do not use attachments other than those provided with the food processor.
- Do not attempt to operate the food processor by any method other than those described in this booklet.
- Ensure the motor, blades or discs have completely stopped before disassembling.
- Ensure the OFF button has been pressed and unplugged from the power outlet when not in use, if left unattended and cleaning, or storing.
- Care should be taken when removing the food from the processing bowl by ensuring the motor, blades or discs, have completely stopped before disassembling. The processing bowl

should then be unlocked from the motor body and the blade or disc carefully removed before attempting to remove the processed food.

- Please do not crush ICE in the processing bowl. This will cause damage to the blades. We recommend that you use a blender for ice crushing.
- Some stiff mixtures, such as dough may cause the processing blade to rotate more slowly than normal. If this happens, do not process for longer than 1 minute. Allow the appliance to cool down before next use.
- Do not process hot or boiling liquids - allow liquids to cool before placing into the processing bowl. Hot liquid can be ejected to cause injury due to sudden steaming.
- Do not move the food processor whilst in operation.
- Do not leave the food processor unattended when in use.
- Do not place any part of the food processor in the microwave oven.
- Do not place on or near a hot gas or electric burner or in a heated oven
- Do not fill the processing bowl above the marked maximum fill line for each type of the ingredients. Always add drier or thicker ingredients to the processing bowl prior to adding fluids. Failing to follow this instruction may cause product malfunction, product damage or personal injury due to damage to the cover or bowl.
- Keep the appliance clean. Follow the cleaning instructions provided in this book.

IMPORTANT SAFEGUARDS FOR ALL ELECTRICAL APPLIANCES

- Fully unwind the power cord before use.
- Do not let the power cord hang over the edge of a table, counter, touch hot surfaces or become knotted.
- This appliance shall not be used by children. Keep the appliance and its cord out of reach of children. Appliances can be used by persons with reduced physical, sensory or mental capabilities or lack of experience and knowledge if they have been given supervision or instruction concerning use of the appliance in a safe way and if they understand the hazards involved.
- Children should be supervised to ensure they do not play with the appliance.
- It is recommended to regularly inspect the

appliance. Do not use the appliance if power supply cord, plug or appliance becomes damaged in any way. Return the entire appliance to the nearest authorised Breville Service Centre for examination and /or repair.

- Any maintenance other than cleaning should be performed at an authorised Breville Service Centre, or contact the Breville Customer Care Centre by phone on 1300 273 845 or email **AskUs@breville.com.au**
- This appliance is for household use only. Do not use this appliance for anything other than its intended use. Do not use in moving vehicles or boats. Do not use outdoors. Misuse may cause injury.
- The processing blades and discs are extremely sharp, handle with care at all times. Avoid contact with moving parts

during operation. Keep hands, hair, clothing, spatulas and other utensils out of food processor feed chute to prevent personal injury or damage to the appliance. Always use the food pusher to push the food down the feed chute.

- Cleaning and user maintenance shall not be made by children without supervision.
- To avoid a hazard due to inadvertent resetting of the thermal cut-out, this appliance must not be supplied through an external switching device, such as a timer, or connected to a circuit that is regularly switched on and off by the utility.

- The installation of a residual current device (safety switch) is recommended to provide additional safety protection when using electrical appliances. It is advisable that a safety switch with a rated residual operating current not exceeding 30mA be installed in the electrical circuit supplying the appliance. See your electrician for professional advice.



WARNING

To avoid possible malfunction of the processing bowl's auto switch, do not place the processing lid in the locked position when the appliance is not in use.

 To protect against electric shock or fire, do not immerse the power cord, power plug or appliance in water or any other liquid.

 The symbol shown indicates that this appliance should not be disposed of in normal household waste. It should be taken to a local authority waste collection centre designated for this purpose or to a dealer providing this service. For more information, please contact your local council office.

**FOR HOUSEHOLD USE ONLY
SAVE THESE INSTRUCTIONS**



Components

A. Small pusher cap

The small pusher cap functions as a cover of the smaller feed chute.

B. Small food pusher

For improved processing control of smaller ingredients. It also doubles as a measuring cup. The food processor will run continually whether the small pusher is in or out.

C. Large food pusher

For pushing food down the feed chute. The food processor will not start unless the large pusher is correctly in place.

D. Feed chute safety system

Prevents the motor from operating unless the bowl and lid are correctly locked in position, and large feed pusher is inserted.

E. Processing Lid with silicone seal

Locks onto the processing bowl.

F. Main bowl with handle

The bowl locks onto the motor base.

G. POWER button

H. PULSE button

Press down and hold briefly for short bursts of power. The motor will automatically stop after the PULSE button has been released.

I. PLAY | STOP button

Press to start and stop operation of the motor.

J. Powerful induction motor base

Induction motor with safety braking system.

K. Non-skid rubber feet

For added safety and stability.

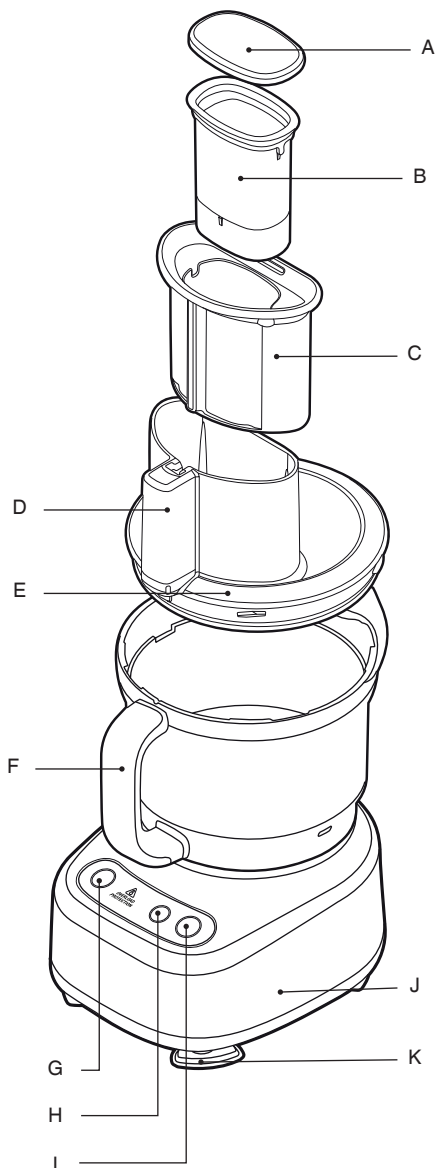

1. Main Spindle

Attaches to blade or discs.

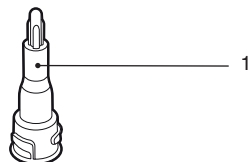

2. Reversible Shredder

Use one side of this disc for fine shredding and the other side for coarse shredding.

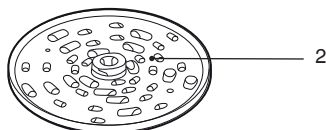

3. Adjustable Slicer

Use this disc for slicing ingredients. Able to slice from 0.3 mm – 5.0 mm thick.

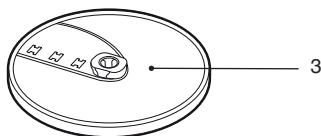

4. S Blade™

For swiftly chopping, mixing, and blending a variety of ingredients.



5. Dough blade

Soft material blade for kneading dough.



6. Caddy

To store all accessories.

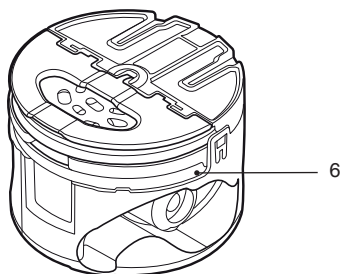

TIP

How to remove the caddy from the bowl?

With the lid removed from the bowl, grasp the caddy by the handle and lift it up and out of the bowl to access the accessories.

DETACHMENT OF ACCESSORIES

- Accessories all have a place in the caddy which has been color coordinated.
- All accessories can be accessed independently of each other.

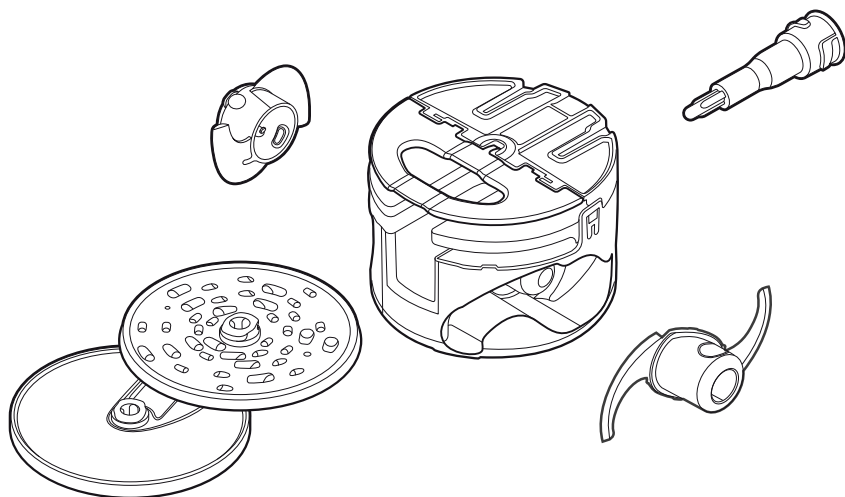



Assembly

BEFORE FIRST USE

- Before using your food processor for the first time, remove any packaging material and promotional labels. Ensure the POWER button is OFF and the food processor is unplugged.
- Be careful when handling the blades and discs as they are extremely sharp.
- When first using your food processor, you may notice an odour coming from the motor.
- This is normal and will dissipate with use.
- Always use the food processor on a dry, level work surface.
- Wash the processing bowl, processing lid and all attachments in warm soapy water with a soft cloth. Rinse and dry thoroughly.

ASSEMBLY

Motor Base and Bowl

1. Position the processing bowl onto the motor base with the handle in line with the ALIGN HANDLE graphic on the motor base.

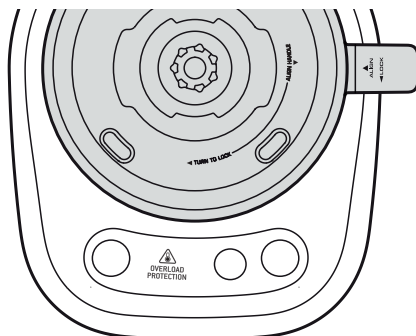

2. Turn the bowl clockwise until the handle locks to the front. The processing bowl should now be securely locked into position. The food processor will not operate unless the bowl is locked into position correctly.

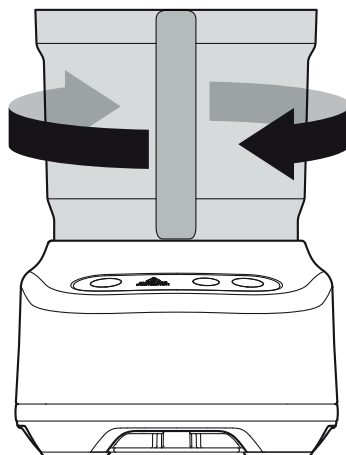

Spindle and Blades



WARNING

Do not touch the Blades. They are extremely sharp.



First, is to assemble your chosen attachment (S blade or Dough blade) over the spindle and place them in position over the coupling in the centre of the processing bowl; then, place the lid onto the processing bowl.

**S blade
to spindle**

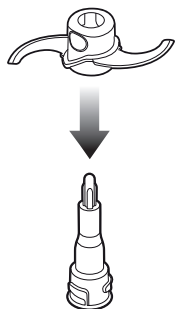

**Dough blade
to spindle**

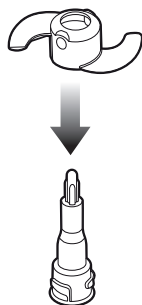

Spindle and S Blade

1. Carefully insert the S blade into the spindle and turn clockwise until it is firmly locked in place.
2. Place the assembled spindle and S blade over the coupling in the centre of the bowl with caution. Avoid touching the blades.

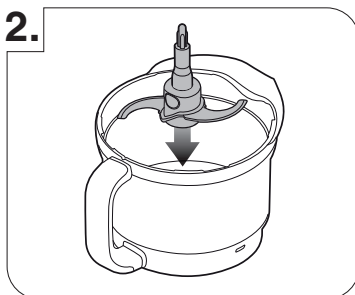
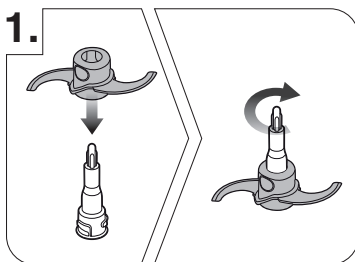

Spindle and Dough Blade

1. Insert the dough blade into the spindle and turn clockwise until it is firmly locked in place.
2. Place the assembled spindle and dough blade over the coupling in the centre of the bowl.

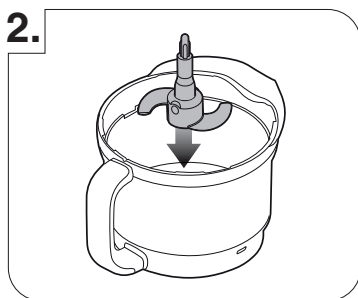
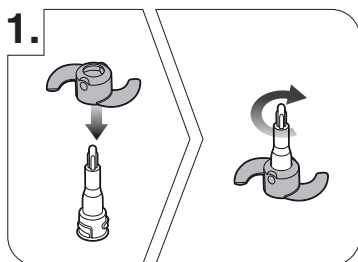

Lid

Place lid onto the processing bowl. To LOCK the lid, hold the chute and turn clockwise so that the handle parts align. Locking the lid correctly will engage the interlocking safety catch on.

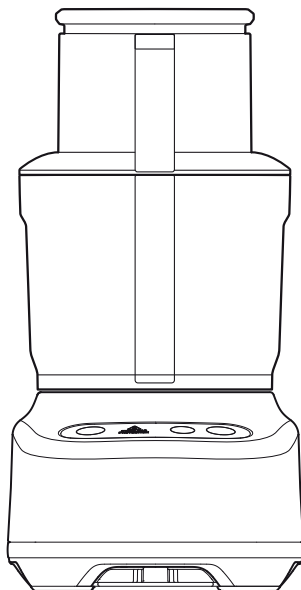



Functions

OPERATION

Getting started

The food processor will only operate when the processing bowl, lid and large pusher are correctly assembled. This engages the safety interlock, and allows the motor to run.

The chute has a CHUTE FILL MAX graphic to indicate the maximum volume of food that can be placed in the chute for the pusher to activate the safety locking catch.

Control Panel

When the machine is connected to power, and the POWER button is pressed; the buttons will illuminate and the food processor will be ready to operate.

Pressing the POWER button at this stage will turn the unit off.

Pressing the PLAY | STOP button will start the motor running continuously.

Press PLAY | STOP again while processing and the motor will stop.

Press PLAY | STOP to continue processing or press POWER to return to standby.

Removing the large pusher during processing will stop the motor. Ingredients can be added into the lid chute, and when the large pusher is re-inserted, the unit will continue to process.

Pressing the PULSE button will cause the motor to operate only while the button is held down.

Use a combination of the PULSE and PLAY | STOP buttons for more control when processing ingredients.

After Processing

Wait until the blades or discs have stopped moving before unlocking the lid. Ensure that the unit has been turned off using the POWER button and unplug from the power outlet before handling the blades.

When removing the blades or discs, carefully grip the plastic hub area at the centre to lift the part.

Overload Protection System

The food processor has an overload protection system to prevent damage to the motor – this will cause the food processor to go into standby mode.



Unplug the food processor and allow to cool for 30 minutes.

If the blades or discs stall while processing, immediately stop the machine, then unplug from the power outlet before clearing the wedge ingredients. If this happens more than once, the bowl may be overloaded. Try processing in smaller batches.



Tips

Tips listed below are suggestions only. For more detailed instructions, refer to specific recipes provided online at sageappliances.com

ACCESSORY	ACTION	TYPES OF INGREDIENTS / DISHES	TIPS
S Blade™	Chop	<ul style="list-style-type: none"> • Raw fruits and vegetables • Raw or cooked meats and fish • Fresh herbs • Breadcrumbs • Nuts • Dried fruits 	<ul style="list-style-type: none"> • Trim and cut food, if necessary, into 2.5cm cubes before processing.
	Mince / Ground Meat	<ul style="list-style-type: none"> • Raw and cooked proteins 	<div>  WARNING </div> <ul style="list-style-type: none"> • Motor should run for no more than 1 minute at a time. • Trim and cut food into 2.5 cm cubes before processing. • For best results, freeze meat for 30 minutes. • Trim excess fats and sinew.
	Puree / Blend	<ul style="list-style-type: none"> • Cooked fruit and vegetables 	<ul style="list-style-type: none"> • Allow food to cool before pureeing or blending.
	Mix	<ul style="list-style-type: none"> • Sauces • Batters • Pesto • Compound butters 	<ul style="list-style-type: none"> • For batters, use PULSE button until mixed evenly. Do not over process.
Dough Blade	Knead	<ul style="list-style-type: none"> • Bread and pizza doughs 	<ul style="list-style-type: none"> • Add liquid through small feed chute whilst the motor is running to incorporate. • Recommended Recipe <ul style="list-style-type: none"> - 375 g flour - 7 g salt - 8 g yeast - 235 g of water - 10 g sugar • Maximum flour quantity = 575 g
Adjustable Slicer Disc	Slice	<ul style="list-style-type: none"> • Raw foods and vegetables • Salami and deli meats 	<ul style="list-style-type: none"> • Place ingredients vertically on the left side of appropriate sized feed chute to minimize tilting. • For deli meats like salami or pepperoni, trim one end and process one at a time.
Reversible Shredding Disc	Coarse and Fine Shred	<ul style="list-style-type: none"> • Cheeses • Fruits and vegetables such as apples, potatoes, and cabbage 	<ul style="list-style-type: none"> • For best results, freeze softer cheeses for 45 minutes before grating. <div>  NOTE </div> <p>Grating soft white cheeses such as fresh mozzarella is not recommended.</p> <ul style="list-style-type: none"> • Remove the rind from hard cheeses before grating.



IMPORTANT NOTES

For optimal results, use the chute size appropriate to the food to be processed. Position food in the chute and use the pusher to push food with light downward force prior to starting the food processor.

Smaller Ingredients

For long thin foods such as carrots, cucumbers, zucchini, etc., use the small or medium feed chute. This will avoid the ingredient from tipping over, during slicing.

Larger Ingredients

The wide feed chute is 14 cm wide and can fit ingredients up to this size. The food should fit snugly so it is supported in an upright position in the chute, but not so tight that it could prevent the food from moving down the chute. Ensure not to overfill the chute, as the pusher will not activate the interlock safety catch if the chute is too full. Do not fill over the MAX indicator.

Pressure

When processing, never force the food down the chute as this can damage the discs. Apply light, even pressure for soft foods such as tomatoes and bananas. Apply medium, even pressure for firmer foods such as potatoes, cheese, deli meats and apples.



NOTE

If foods do get stuck inside the chute, remove the pusher, remove the lid from the bowl, and while the chute is away from the bowl and away from the blades; dislodge the food stuck inside the chute by hand.



Care & Cleaning

Remove the power cord from the power outlet after use for safety reasons.

Processing bowl and lid

Due to the interlock components, we do not recommend immersing the bowl and lid in water for long periods.

To keep your bowl and lid clean, and to avoid food drying on, follow these steps as soon as possible after use:

- Rinse most of the ingredients off the bowl and lid.
- Hand wash in clean warm, soapy water using a mild liquid detergent and non-abrasive sponge.
- The processing bowl and lid may occasionally be washed in the dishwasher (top shelf only), however washing in the dishwasher is not recommended on a regular basis, as prolonged exposure to harsh detergents, hot water and pressure will damage and shorten the life of the plastic and the interlock components.



WARNING

Oils in citrus rind can damage the material of your food processor bowl if being exposed to it for a longer period. Always clean your processing bowl immediately after processing citrus rind.



WARNING

Do not touch the blades. They are extremely sharp.

Blades and discs

- Blades and discs are razor sharp, do not touch. Always use a spatula or brush to remove food or when cleaning blades.
- Blades and discs can be washed in the dishwasher.

Motor base

To clean the motor base, wipe with a soft, damp cloth then dry thoroughly. Wipe any excess food particles from the power cord.

Cleaning agents

Do not use abrasive scouring pads or cleansers on either the motor base or the bowls, as they may scratch the surface. Use only warm soap water with a soft cloth. Stubborn food stains and odours

Strong smelling foods such as garlic, fish and some vegetables such as carrots may leave an odour or stain the bowl or lid. To remove, pour warm soapy water (do not overfill). Set aside to soak for 5 minutes, without immersing the whole bowl. Then wash with a mild detergent and warm water, rinse well and dry thoroughly. Store the bowl with the lid off.



Troubleshooting

PROBLEM	EASY SOLUTION
Food is unevenly processed	<ul style="list-style-type: none">• Ingredients should be cut evenly into 2.5 cm pieces before processing.• Ingredients should be processed in batches to avoid overloading.
Slices are slanted or uneven	<ul style="list-style-type: none">• Apply even pressure on the pusher.
Food falls over in the feed chute	<ul style="list-style-type: none">• Food sliced tall and thick, use the large feed chute. The large feed chute must be packed full for best results. Use a smaller feed chute where possible, and depending on the food size.
Some food remains on top of the disc after processing	<ul style="list-style-type: none">• It is normal for small pieces to remain after processing.
Motor slows down when kneading dough	<ul style="list-style-type: none">• Amount of dough must not exceed maximum recommended quantity on the recipe. Remove half and process in two batches.• Dough may be too dry. If motor speeds up, continue processing. If not, add more water, 1 tablespoon at a time until the motor speeds up. Process until dough cleans the side of the processing bowl.
Dough doesn't clear inside of the processing bowl	<ul style="list-style-type: none">• Amount of dough may exceed food processor maximum capacity. Remove half and process in two batches.• Dough may be too dry.
Dough nub forms on top of dough blade and dough does not become uniformly kneaded	<ul style="list-style-type: none">• Stop machine, carefully remove dough, divide it into 3 pieces and redistribute them evenly in the processing bowl.
Dough feels tough after kneading	<ul style="list-style-type: none">• Divide dough into 2 or 3 pieces and redistribute evenly in processing bowl. Process 10 seconds or until uniformly soft and pliable. Allowing dough to rest allows the gluten strands to relax and become more pliable.
Dough is too dry	<ul style="list-style-type: none">• While machine is running, add water through the small feed chute, 1 tablespoon at a time until dough clears the inside of the processing bowl.
Dough is too wet	<ul style="list-style-type: none">• While machine is running, add flour through the small feed chute, 1 tablespoon at a time until dough clears the inside of the processing bowl.
The motor does not start	<ul style="list-style-type: none">• There is a safety interlock switch to prevent the motor from starting if it is not properly assembled. Make sure the processing bowl and lid and large pusher are securely locked into position.• The food content in the feed chute should be below the maximum fill line.• If the motor still will not start, check the power cord and power outlet.
The food processor shuts off during operation	<ul style="list-style-type: none">• The lid may have become unlocked; check to make sure it is securely in position.• If the motor overloads, the 'OVERLOAD PROTECTION' icon in the screen will start to flash. Switch off by pressing the POWER button and unplug the power cord. Allow the food processor to cool for 30 minutes before resuming.

PROBLEM

EASY SOLUTION

The motor slowed down during operation

- This is normal as some heavier loads (e.g. slicing / shredding cheese) may require the motor to work harder. Reposition the food in the feed chute and cut the food into smaller sizes and process using a smaller pusher and continue processing.
- The maximum load capacity may have been exceeded.
Remove some of the ingredients and continue processing.

The food processor vibrates / moves during processing

- Make sure the rubber feet at the bottom of the unit are clean and dry.
Also make sure that the maximum load capacity is not being exceeded.
 - This is normal as some heavier loads may require the motor to work harder.
 - Turn the unit off and clear any ingredients that may be caught on the disc, before continuing.
 - If this occurs while mixing dough – then turn unit off and redistribute the dough mixture more evenly around the bowl before continuing.
 - Process hard and fibrous foods such as carrots, through the small chute.
-

ATTACHMENT OF CADDY COMPONENTS

Attachment of caddy only after all the accessories have been removed.

Refer to this instructions for:

If dropped and fallen apart.

ATTACHMENT

Blade Clips

1. Locate correct side of caddy (dough blade or chopping blade) and correct blade clip.
2. Insert blade clip spigot onto caddy base peg - maintaining correct alignment of blade clip legs
3. Push blade clip further until blade clip legs have flexed into caddy base holes. Ensure all three legs have engaged with caddy base.



WARNING

Do not touch the blades of the Dicing Grid and Dicing Blade. They are extremely sharp.

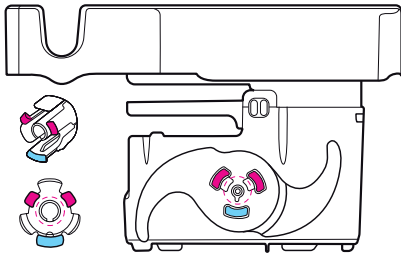

S Blade Clip
Right Side View

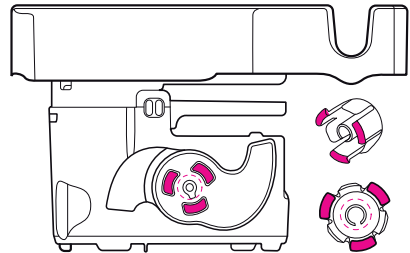

Dough Blade Clip
Left Side View

ATTACHMENT

Spindle Sheath

1. Remove all accessories and flip caddy upside-down (**WARNING!** Blades are sharp).
2. Slide sheath downwards into guide ribs.
Press further until clip is locked into position.

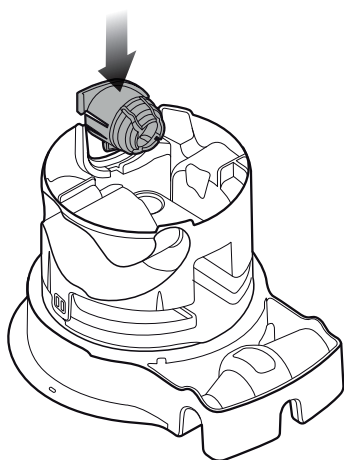

Breville Service Centre

Australian Customers

Phone: 1300 139 798

Web: www.breville.com

New Zealand Customers

Phone: 0800 273 845

Web: www.breville.com

Breville®

Master Every Moment™

Breville, the Breville Logo, are trademarks of Breville Pty Ltd ("Breville") and Breville's products are distributed in Australia and New Zealand under license.

Copyright Breville Pty. Ltd. 2023.

Due to continued product improvement, the products illustrated/photographed in this brochure may vary slightly from the actual product.