

ENDLINE ISODRIVE® 1350 SILENT RANGEHOOD MOTOR SOLUTION

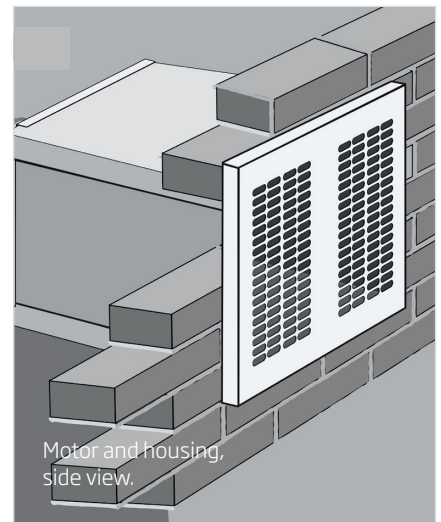

- Powerful 'in-wall' **Silent Rangehood Motor Solution**, ideal for apartments, double storey buildings and a broad range of building applications
- German engineered Silent Isodrive® 1350m³/h motor with patented Australian venting system
- Extracts smoke, steam and airborne grease, fat and oil particles in one complete process
- Unique motor design resulting in minimal external obstruction
- Modern, colourbond grill designed to maximise airflow - paintable in any colour to match building's colour scheme
- Motor is accessible from both ends of the housing for convenient maintenance
- Suitable for use with all Schweigen **Silent** wallmount, undermount and island rangehoods
- 3 times more efficient when compared to a traditional internally motored rangehood



ENDLINE ISODRIVE® 1350 SILENT RANGEHOOD MOTOR SOLUTION

DESCRIPTION

- Endline Isodrive® motor with mounting system
- Patented anti-water intrusion, weather protection system (IPX4 rated)
- Super quiet, long vane, backward curved centrifugal fan
- Motor can be mounted 4 to 6 metres from the rangehood
- Mounts in external wall
- Ducting kit included

TECHNICAL DATA

Isodrive® 1350

- Fan Module
- Grill
- Weather Deflector
- Bell Mouth Adaptor
- Flexible Ducting (6m), 200mm
- Back Draught Shutter System
- Instruction Manual

Optional Accessories:

- Fire Ember Guard
- Rear support clamp assembly
- Support Installation Plate

MOTOR POWER

- **Single motor** - 1350m³/hr extraction power
- 10 Year Warranty on Motor

For more information



Removable Internal Motor Assembly

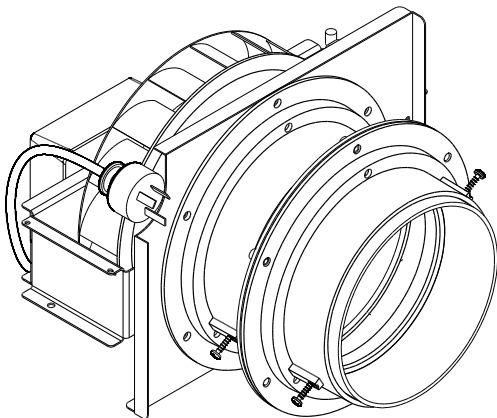

Mounting System

