

**Serie | 6, washing machine, front loader, 8 kg, 1400 rpm
WAT28620AU**



Optional accessories

WMZ2200 :
WMZ2381 :

The smarter way to cleaner laundry is 100% accurate detergent-dosing everytime with iDoS Automatic Dosing technology

- **i-DOS:** automatically measures the precise amount of liquid detergent and water.
- **Automatic program:** adjust the wash for the fabric type and degree of soiling.
- **EcoSilence Drive™:** quiet and energy-efficient drive, with a 10-year warranty.
- **AllergyPlus:** developed for allergy sufferers and people with sensitive skin.
- **SpeedPerfect:** perfectly clean in up to 65% less time*.

Technical Data

Built-in / Free-standing : Freestanding
Door hinge : Left
Color / Material body : White
Length electrical supply cord : 160 cm
Height for building under : 848.00 mm
Height of the product : 848 mm
Dimensions of the product : 848 x 598 x 590 mm
Wheels : No
Net weight : 72.354 kg
Drum volume : 63 l
Main colour of product : White
Door Frame : silver-black grey
Noise level washing : 48 dB(A) re 1 pW
Connection Rating : 2300 W
Fuse protection : 10 A
Voltage : 220-240 V
Frequency : 50 Hz
Total annual energy consumption : 200.0 kWh
Energy Star Qualified : Yes
Cord Included : No
Plug type : AU plug
Length of drain hose (in) : 59.05
Length of supply hose (in) : 59.05
Appliance Dimensions (h x w x d) (inches) : x x
Dimensions of the packed product : 34.25 x 24.99 x 26.57
Net weight : 160.000 lbs
Gross weight : 162.000 lbs
Length of drain hose : 150.00 cm
Length of supply hose : 150.00 cm
Dimensions of the packed product (HxWxD) : 870 x 675 x 635 mm
Gross weight : 73.3 kg
Connection Rating : 2300 W
Fuse protection : 10 A
Voltage : 220-240 V
Frequency : 50 Hz
Approval certificates : CE, VDE
Water consumption : 58 l
Total annual energy consumption : 200.0 kWh
Water protection system : AquaSecure
Number of Options : 14
Maximum spin speed : 1400 rpm
Spin speed options : Variable
Digital countdown indicator : Yes



4 242005 083664

Serie | 6, washing machine, front loader, 8 kg, 1400 rpm WAT28620AU

The smarter way to cleaner laundry is 100% accurate detergent-dosing everytime with iDoS Automatic Dosing technology

Capacity

- Capacity: 8 kg

Consumption rates

- 5 Star energy rating
- 5 Star water rating (WELS)
- 58 litres water consumption per wash and 200 kWh energy consumption per year, based on the Cotton Eco program with 60°C temperature setting, 1400 spin speed, and a cold water connection

Programs

- Standard programs:
 - Cottons: hard-wearing items made from cotton, linen or blended fabrics
 - Cotton Eco: energy-saving program
 - Easy care: items made from synthetic or blended fabrics
 - Delicate/Silk: Delicate, washable items made from Silk, viscose and synthetics
 - Wool: hand or machine washable items that are made from wool or contain wool
- Additional specialty programs:
 - AllergyPlus/Hygienic: suits items that need to be hygienically clean such as towels, bed sheets or pillow cases
 - Automatic: the degree of soiling and the type of fabric are automatically detected and the washing process is adapted
 - Drum Clean: cleaning and care program for the drum with reminder function
 - Jeans/Dark Wash: dark coloured cottons and dark coloured easy care fabrics
 - Shirts/Blouses: non-iron shirts and blouses made from cotton, linen, or blended fabrics
 - Mixed: lightly soiled items made from cotton, linen, or blended fabrics
 - Sportswear: sports and leisure items made from synthetic fibres, microfibre or fleece
 - Super 15'/30': short program for small lightly soiled items
 - Rinse/Spin: rinses and then spins the laundry, and then drains the water

Performance

- i-DOS automatic dosing system uses special sensors to determine the laundry's weight and type of textiles to dispense liquid detergents and fabric softener with maximum precision
- EcoSilence Drive™ friction-free motor minimises wear and tear for a long-lasting performance, quiet operation and perfect wash results.
- VarioDrum's breakthrough wave-droplet design provides a thorough yet gentle clean for fine textiles
- Spin speed 400 - 1400 rpm

Design

- Large LED display for program status, temperature, spin speed, energy/water consumption, and time remaining
- Anti-Vibration Side Panels helps reduce vibrations and noise levels, making it extremely quiet during the spin cycle

Convenience

- Touch control option settings include:
 - Child safety control lock
 - Easy Iron: reduces creasing thanks to a special spin sequence
 - i-DOS: activate or deactivate automatic dosing for liquid detergent and fabric softeners for each program
 - Favourite (memory program): set your favourite combination of wash program and options and store it on the favourite button for future quick use
 - Prewash options for stubborn stains and heavily soiled garments
 - Rinse Stop: cancels the final spin cycle to prevent creasing if items will not be taken out immediately after the cycle has ended
 - Rinse Plus: Adds more rinse cycles, suited for highly soiled clothing
 - Soaking: items remain in water for longer before the main wash cycle to help remove stubborn soiling
 - SpeedPerfect: allows you to reduce the wash program time
 - Spin Speed: manually adjust the spin speed
 - Start/Pause with Reload function: allows you to add a forgotten garment even after the wash cycle has started
 - Finish in (delayed start): delay the start of the program by up to 24 hours
 - Temperature selection: manually adjust the temperature
- Reload function to pause machine or add a forgotten laundry item
- Self cleaning detergent drawer to remove detergent residue to remove detergent residue
- Drum Clean reminder function: the LED indicator will flash when a drum clean is required
- Consumption Indication: Information about energy and water consumption for program selected
- SpeedPerfect: allows you to reduce cleaning time by up to 65%
- Large porthole, 171° swing door for easy loading/unloading of clothes

Safety

- AquaSecure anti-flood protection with self-sealing hose, minimises the risk of flooding
- Child lock for door and buttons

Technical Information

- Dimensions (H x W x D): 84.8 cm x 59.8 cm x 59.0 cm (63.2 cm with door frame)
- Operating noise level (based on Cotton 60°C program): wash 48 / spin 72 dB(A)

**Serie | 6, washing machine, front loader, 8
kg, 1400 rpm
WAT28620AU**

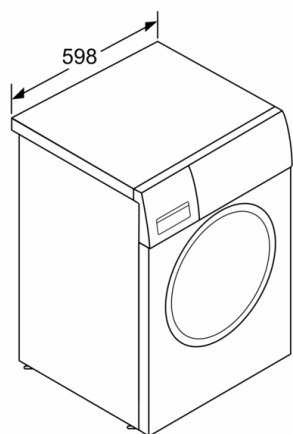

measurements in mm

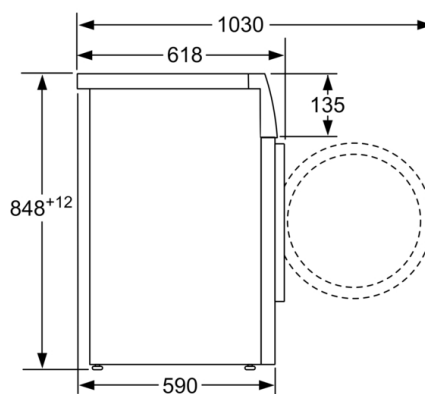

measurements in mm