

BBQ Rangehood

Installation instructions

Model No's CL7271, CL7272, CL7272S, CL7275

Thank you for purchasing your new Schweigen BBQ rangehood.

To get the maximum out of this unit, please read through this operating manual before use. The operating manual contains important information on the correct use and maintenance of the unit as well as important safety notes. This will ensure your personal safety and the lasting value of your BBQ rangehood.

We trust that you will enjoy your new Schweigen BBQ rangehood.

Your Schweigen BBQ rangehood comes with a 3 year warranty. Please always retain your proof of purchase to aid in any warranty queries.



WARNING:

- Test this unit before installing
- Any faulty unit installed will not be replaced

WARNINGS AND SAFETY MEASURES

- Damaged appliances must not be installed under any circumstances. Once a faulty rangehood has been installed, it will not be replaced under warranty as it is no longer in the same condition as when it was delivered. Please insist that the installer plug in and test the unit before attempting to install it.
- All electrical installations should be made by a qualified electrician. Installation by unauthorized individuals may cause damage to the product, lowers the performance and voids all manufactures warranties. **NOTE: YOUR EXTRACTOR IS DESIGNED TO OPERATE ON A MAINS VOLTAGE OF 50 HZ 220/240 V.**
- The Power supply cable should not be subjected to any squeezing or crushing during installation.
- The unit contains a power supply cord with an earthed plug. This cord must be connected with a corresponding earthed plug.
- As a precautionary measure please ensure that the plug is easily accessible in order to disconnect the power from the product.
- **Warnings:**
 - Never operate the apparatus on a power supply other than mains power voltage
 - Ensure that the plug at the end of the mains cable is plugged into an earthed socket with proper voltage and current.
- Do not operate the rangehood's extractors without the grease filter. So that the grease collected in the rangehood's filter does not cause a fire, it is not recommended to cook with a very high flame under the extractor.
- It is recommended that you have a fire blanket next to your cooktop at all times.
- Please ensure all plastic protective covering is removed from the rangehood, flue covers and filters before first use.
- Please be sure to clean the rangehood's filters regularly and change when required. Filters that are not cleaned regularly pose a risk of fire due to the accumulated oil in the filters.
- Only use filters supplied with the rangehood.
- In the instants that flaming in or near the rangehood, cut the power to the exhaust fan and cooking devices immediately and cover the flame with a fire blanket.
- Be careful when the cleaning of your extractor. If cleaning is not performed in accordance with this operation manual at appropriate intervals, risk of burning your extractor may occur.
- While the extractor is operating, do not leave the cook top operational without cooking being underway. The direct heat rising from the cooktop without anything on it may cause failure to the unit by deforming some parts of the extractor.
- In order to clear odour from the kitchen or cooking area, operate the extractor for some time after cooking and frying is completing. Also ensure that the kitchen has adequate ventilation.
- In case of failure, contact an authorised service agent. Do not allow unauthorised persons to service your equipment. Remember that unauthorised work may cause further failures in the equipment and void the manufacturers warranties.

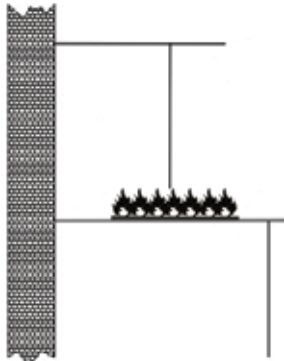

Outdoor Use

The recommended distance between the barbeque and the extractor should be between 800 to 1000mm.

OPERATING THE UNIT FOR THE FIRST TIME

Before operating the appliance for the first time, please pay attention to the following notes:

- The appliance must be installed and connected by a qualified installer before operation.
- Read this manual thoroughly before operating the appliance for the first time.
- Remove the packaging from the appliance and dispose of it properly! Be aware that there can be accessories in the packaging!
- Before operating the appliance, check that the power lead is firmly connected and inserted correctly.
- Please remove all plastic protective covering from the rangehood, flue covers and filters.

USAGE

- Schveigen rangehood's have been designed for household kitchen use and for regular cooking. Using the unit for any other purpose may cause an accident and will void the warranty.
- In the event of a malfunction, first of all check the household fuses and the power cord connection. If the problem has nothing to do with the power supply, please contact your dealer for after sales service.

OPERATION (FOR MODELS CL7271, CL7272 AND CL7275)



From left to right.

- Off button** : Turns off all functions
- High speed** : Frying and grills
- Medium speed** : Cooking
- Slow speed** : Sight ventilation
- Light button** : To switch on or off the lights

The high, medium and slow speed fan and lamp buttons will also turn the indicated function off if pressed again.

OPERATION (FOR MODEL CL7272S)



Press + to switch on the fan. The timer will only operate when the fan is switch on.

- button** : Press - to decrease the fan speed
- + button** : Press + to increase the fan speed
- Light button** : To switch on or off the lights
- Timer button** : Up to 15 minutes timer setting and fully adjustable. When you press the timer button the digital display will change to "00" timer mode. You can adjust your timer mode by pressing "-" or "+" .

PRODUCT INTRODUCTION

Before installation please ensure that you insert the Back Draft Fins¹ on to the Reducers² attached to the top of the motors. These will prevent wind, bugs and dust fall into the motors.



INSTALLATION AND OPERATIONS

For installation of your Isodrive motor please read the installation manual provided with the Isodrive motor. *This applies to model CL7272S only.*

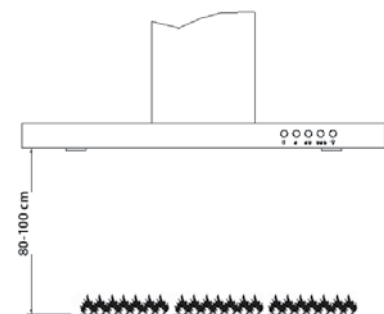

Install the hood centrally over the cooktop. Mount the hood bottom between 800 to 1000mm above the cooktop. Mark the position for drilling of the fixing bolts.

Diagram: Installation of the Flue Cover

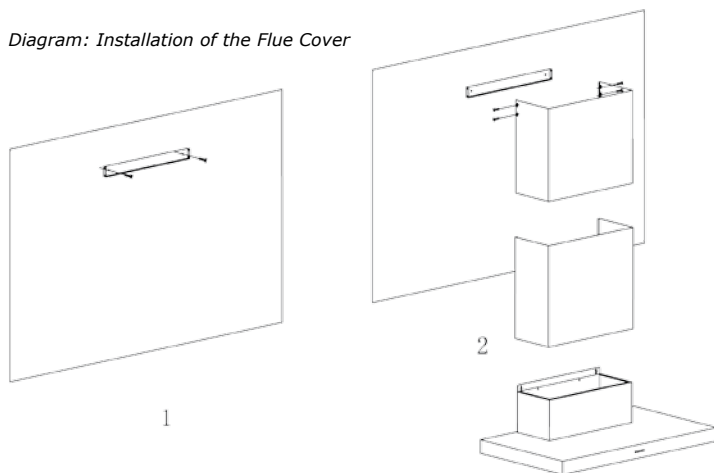

MAINTENANCE

- Before cleaning, you must turn off all power supply for personal safety.
 - Clean inside and outside of the cabinet surface with hot water, neutral detergent and polish with cotton cloth. Do not use steel wool or abrasive materials as rough surfaces will damage the rangehood's finish. When scouring the internal surface, use of gloves while removing grease. Clean at least once a month.
- III. **WARNING: INSTALLING WET OR DAMP FILTERS AND OPERATING THE UNIT MAY CAUSE PROBLEMS TO THE SYSTEM. THIS MAY CAUSE FIRE BY SHORT CIRCULATING THE ELECTRICAL SYSTEM OR ELECTRIC CONTACTS.**

REPLACING THE GLOBES

Please ensure lights have been switched off for some time and that the power source has been disconnected before replacing globes as they do remain hot shortly after they have been switched off.



Step 1 : Turn anti-clockwise to open.

Step 2 : Take the existing globe out.

Step 3 : Insert a new globe and turn clockwise in lock position.

CAUTIONS

- i. Do not attempt to install this appliance yourself without appropriate electrical and technical certification and knowledge.
- ii. When maintaining this appliance or changing bulbs, please be sure that the power supply is off.
- iii. When cleaning the interior of rangehood, be careful to not let debris into the machine.
- iv. **Warning:**
 - Do not light naked flame under the range hood.
 - There is a fire risk if cleaning is not carried out according with the instructions.
 - This appliance is not intended for use by children persons unless they are adequately supervised by an adult to ensure that the appliance used safely.
 - There should be adequate ventilation of the room when the range hood is used at the same time as an appliance burning gas or other fuels.
 - The air must not be discharged into a flue that is used for exhausting fumes from appliances burning gas and other fuels.
 - If the power supply cord is damaged, it must be replaced by the manufacturer, authorised service agent or qualified person in order to avoid hazard.
- v. Before touching the lamp, you must cut off all power supply.
- vi. The minimum distance between the supporting surface for the cooking vessels on the hob and the lowest part of the range hood, when the range hood is located above a gas appliance, should be at least 65cm. If the instructions for installation for the gas hob specify a greater distance, this has to be taken into account.
- vii. Local regulations concerning the discharge of air have to be fulfilled. Check with your local governing body.
- viii. For service enquiries, please call **1300 881 693**.

PROBLEMS AND SERVICE

- Disconnect the appliance from the mains before having any repairs carried out.
- In the event of malfunctions, first of all check the household fuses.
- If the power supply is in proper working order, but the appliance is nevertheless not functioning, then contact your dealer or authorise service agent. Ensure to specify the appliance type or model number (see rating plate).
- Repairs must only be carried out by authorised service agents, thus ensuring the safety of the appliance. Improper tampering will render all warranties claims null and void.
- For service enquiries, please call **1300 881 693**.

EXTRACTOR DOES NOT WORK

- Check that the unit is connected to a power source; check whether other electrical appliances operate properly in that power point. If there is not any problem with this, then in the following order.
- Check the power supply connection of the extractor. The mains voltage should be 220-240V and it should be connected to an earthed socket.
- The motor switch should be in ON position.

EXTRACTOR LIGHT IS NOT LIT

- Check the power supply connection of the extractor.
- The lamp switch should be in ON position.
- Check if the power is on at the plug.
- Check whether the bulbs are functioning. Replace them if they are blown.

AIR SUCTION OF THE EXTRACTOR IS POOR

- Check whether the air pores on the aluminium cassette filters are blocked and if necessary clean them. The aluminium cassette filters should normally be cleaned at least once a month.
- Check that the ducting pipe above the rangehood is clear and pulled taught. If the pipe is left crumpled or squashed this will restrict airflow significantly.
- Please note: should a service agent discover the problem is as a result of installation, you will be responsible for the payment, as **faulty installation is not covered by warranty**.

IMPORTANT EXPLANATION:

- If you have performed the above steps and the problems still persist, contact the nearest AUTHORISED SERVICE operator.
- Warranty covers a manufacturer fault or defect.
- Warranty does not cover incorrect installation and any faults that may result.