

## ARTÉS 1200 CEILING / WALL MOUNTED

Installation Guide



!

Please handle with care and wear gloves at all times during assembly and installation to avoid damaging components.

## TECHNICAL

**Bulb Holder**  
integrated LED - dimmable

**Wattage**  
32w - 2700k

**Weight**  
8kg (17.6lbs)

## PARTS &amp; COMPONENTS

- A. 1 x Artés 1200 Wall  
B. 1 x Mounting plate  
C. 2 x Brass masking plates  
D. 2 x Steel button head screws, 4 x Brass countersunk screws

Additional parts for US installation only:

- E. Covering Plate  
F. US Adapter plate

A.

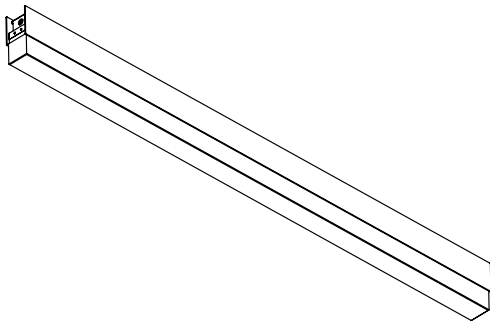

B.

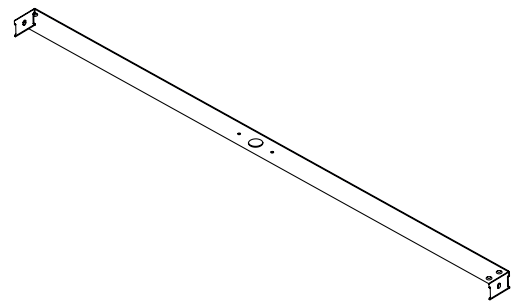

C.

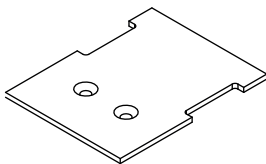

D.



E.

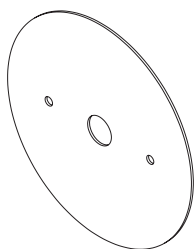

F.

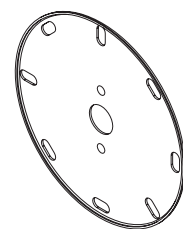

- All nuts and bolts required for the installation will be included in the delivery.



## BEFORE INSTALLATION

- Check that you have all components before starting the installation.
  - Installation must be carried out by a qualified electrician.
  - A minimum of two people is required to install a pendant light.
- Check that the ceiling or wall fixings are suitable and strong enough to support the weight of the light fixture.
  - You will need the below specific tools for a successful installation.

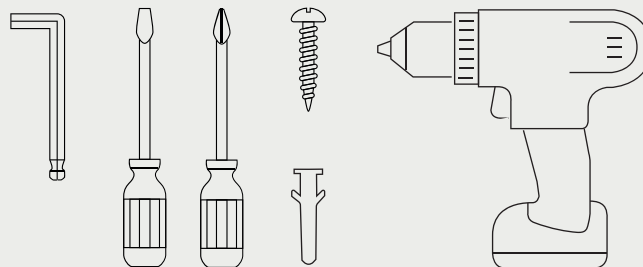

1. Securely fix the mounting plate to the wall in the correct position using fixings suitable for the surface you are mounting to (not supplied).

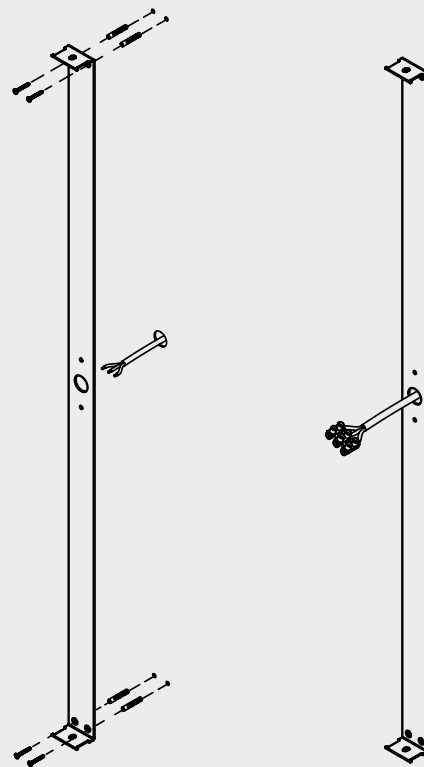

1. 110V

Securely fix the US adapter plate to junction box ensuring that the three central holes are vertically positioned (1).

Attach the mounting plate and covering plate to the Adapter plate using the 2 screws provided (2) to securely attach the wall plate to the junction box (3).

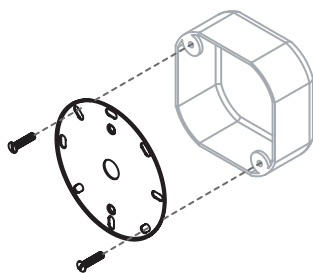

1.

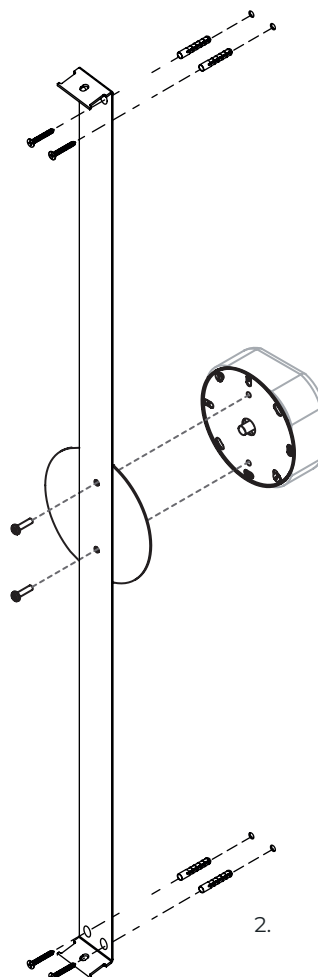

2.

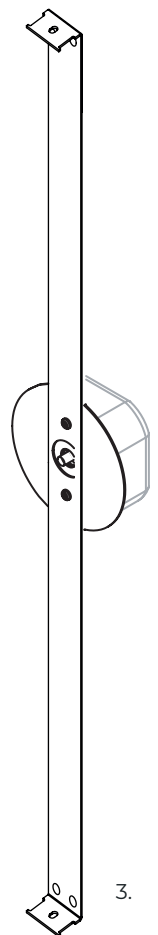

3.

2. Raise the fitting and make the electrical connections ensuring all wires are colour matched and the fitting is earthed correctly.

Bring the fitting up to the mounted plate and secure with the 2 x button head screws.

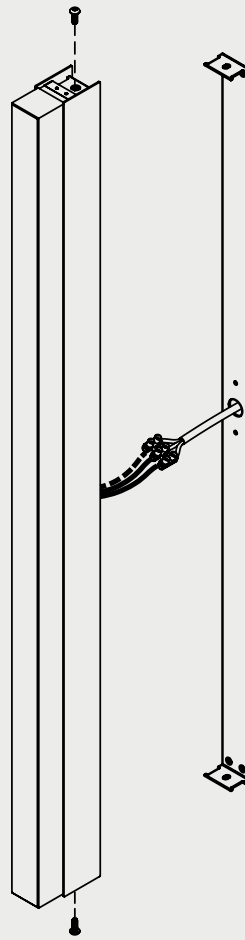

3. With the fitting securely fixed, fit the brass masking plates with the 4 x brass screws.

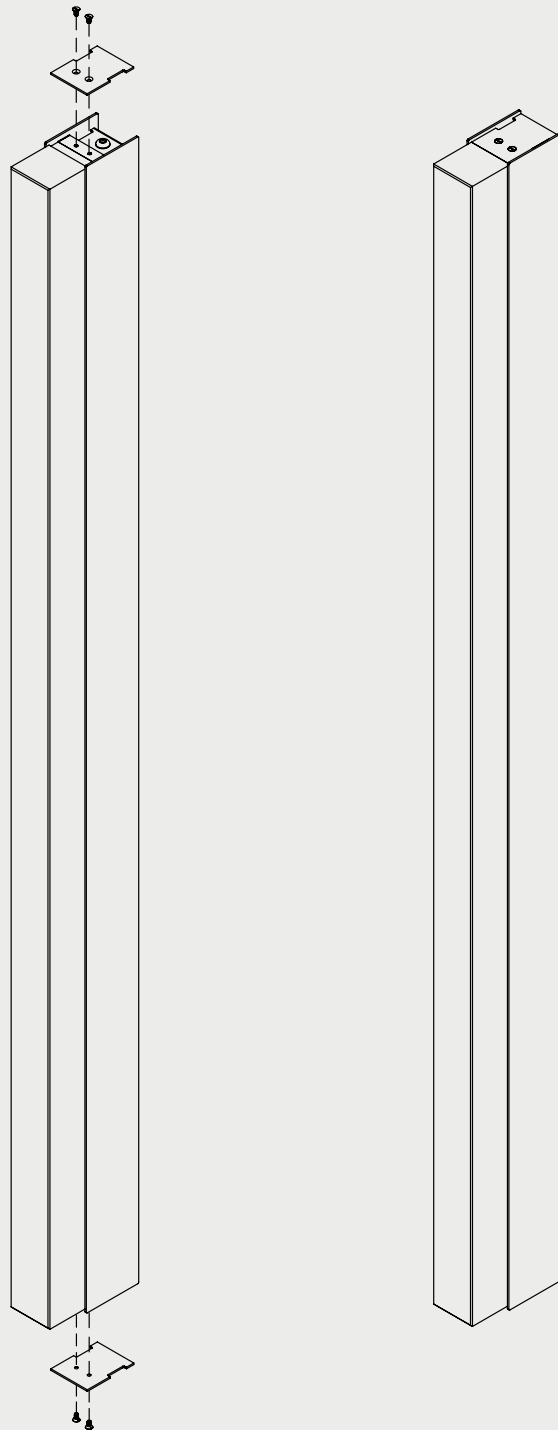

## MAINTENANCE

### Cleaning

Dust using a dry lint-free cloth weekly or as required

### Repairs

Contact  
CTO Lighting

### Warranty

Please visit  
[www.ctolighting.co.uk/  
pages/f-a-q](http://www.ctolighting.co.uk/pages/f-a-q)  
for CTO warranty policy

### Certification

