



## 800W BLENDER INSTRUCTION MANUAL

220~240V

800W

WHBL01SS



# CONTENTS

## SAFETY INFORMATION

Important Safety Instructions .....	1 - 2
Electrical Requirements .....	3

## SETUP AND USE

Installation Guide .....	3
Parts and Features .....	4
Blender assembly and operation .....	5
Chopping guide .....	6

CLEANING AND CARE .....	6
-------------------------	---

TROUBLESHOOTING.....	7
----------------------	---

WARRANTY .....	8 - 9
----------------	-------

Figures and illustrations in this User Manual are provided for reference only and may differ from the actual product appearance.

Product design and specifications may be changed without notice.

# IMPORTANT SAFETY INSTRUCTIONS

 <b>DANGER</b> <b>DANGER</b> - Immediate hazards which <b>WILL</b> result in severe personal injury or death.	 <b>WARNING</b> <b>WARNING</b> - Hazards or unsafe practices which <b>COULD</b> result in severe personal injury or death.	 <b>CAUTION</b> <b>CAUTION</b> - Hazards or unsafe practices which <b>COULD</b> result in minor personal injury.
---	--	--

## \*\*\*WARNING\*\*\*

Keep hair, hands, fingers and other body parts away from the blender blades whilst in operation.

1. Read all instructions carefully before using your new blender.
2. Always turn the power off at the power outlet before you remove or insert the power plug. Remove by grasping the plug - do not pull on the cord.
3. Hold jug handle, jug lid and rotary dial only as some surfaces may become warm whilst the blender is in use.
4. Do not operate the blender if:
  - i) the cord or plug is split, melted or damaged.
  - ii) the blender has malfunctioned.
  - iii) the blender has been damaged in any manner.

If any of the above incidents occur, return your blender to the nearest authorised service center for examination, repair or adjustment.
5. This blender is not intended to be operated by means of an external timer or separate remote-control system.
6. Close supervision is necessary when any appliance is used by or near children.
7. Any appliance that has been dropped or damaged should not be used until examined by an authorised service center.
8. Do not permit the mains supply cord or plug to touch hot objects or allow the power cord to lay across the blender.
9. If the mains supply cord is damaged, it must be replaced by the manufacturer, its service agent or a similarly qualified person in order to avoid a hazard.
10. This appliance is deemed for use indoors only.
11. Never plug the appliance into the power outlet if the cutting blades are exposed. Blades should be housed within the jug.
12. Do not under any circumstances immerse the power cord, mains plug or blender body in water or any other liquid.
13. Do not at any time, insert hands or other body parts into the jug.

## IMPORTANT SAFETY INSTRUCTIONS

13. This blender can be used by children aged from 12 years old and above and by persons with reduced physical, sensory or mental capabilities or lack of experience and knowledge if they have been given supervision or instruction concerning use of the blender in a safe way and understand the hazards involved.
14. Children should not play with the blender.
15. Keep the blender and its cord out of reach of children less than 12 years old.
16. Your blender should not be unattended while in use.
17. This blender should not be used in a commercial environment such as a restaurant, hotel or hostel dining room.
18. Always use this blender with a power outlet of the voltage (A.C. only) marked on the back of the blender.
19. Do not use the blender for any purpose other than its intended use.
20. Do not place your blender on or near a hot gas flame, electric element, heated oven or any hot surface.
21. Do not place the blender on top of any other appliance.
22. Do not allow the power cord of this blender to hang over the edge of a table or bench top.
23. Keep hands, fingers and utensils out of jug while blending to reduce the risk of severe injury. A scraper may be used but must only be used when the blender is not running.
24. This appliance is intended to be used in household and similar applications such as:
  - staff kitchen areas in shops, offices and other working environments;
  - farm houses;
  - by clients in hotels, motels and other residential type environments;
  - bed and breakfast type environments.
25. ⚠ **WARNING:** Do not blend hot liquids.
26. ⚠ **WARNING:** The blades are very sharp, handle with care particularly when cleaning the blades.
27. ⚠ **WARNING:** Do not operate the appliance continuously for longer than two minutes as the appliance may overheat.
28. ⚠ **WARNING:** Misuse may cause potential injury.

# ELECTRICAL REQUIREMENTS

## POWER SUPPLY CORD

1. Do not attempt to modify the power cord or plug in any way.
2. A short power supply cord is provided to reduce the risk of the user becoming entangled in or tripping over a longer cord.
3. If the power supply cord is too short, do not use an extension cord. Have a qualified electrician or serviceman install an outlet near the appliance.

NOTE: Neither Westinghouse nor the retailer can accept any liability for damage to the product or personal injury resulting due to failure to observe the electrical connection procedures.

# INSTALLATION GUIDE

1. Carefully unpack your electric blender.
2. Carefully remove packaging around the blender and power cord. Do not remove warning labels.
3. Wash Jug, Lid and accessories before use.

**WARNING:** ⚠ Do not under any circumstances immerse the blender body, mains cord or mains plug in water or any other liquid.

## PARTS AND FEATURES

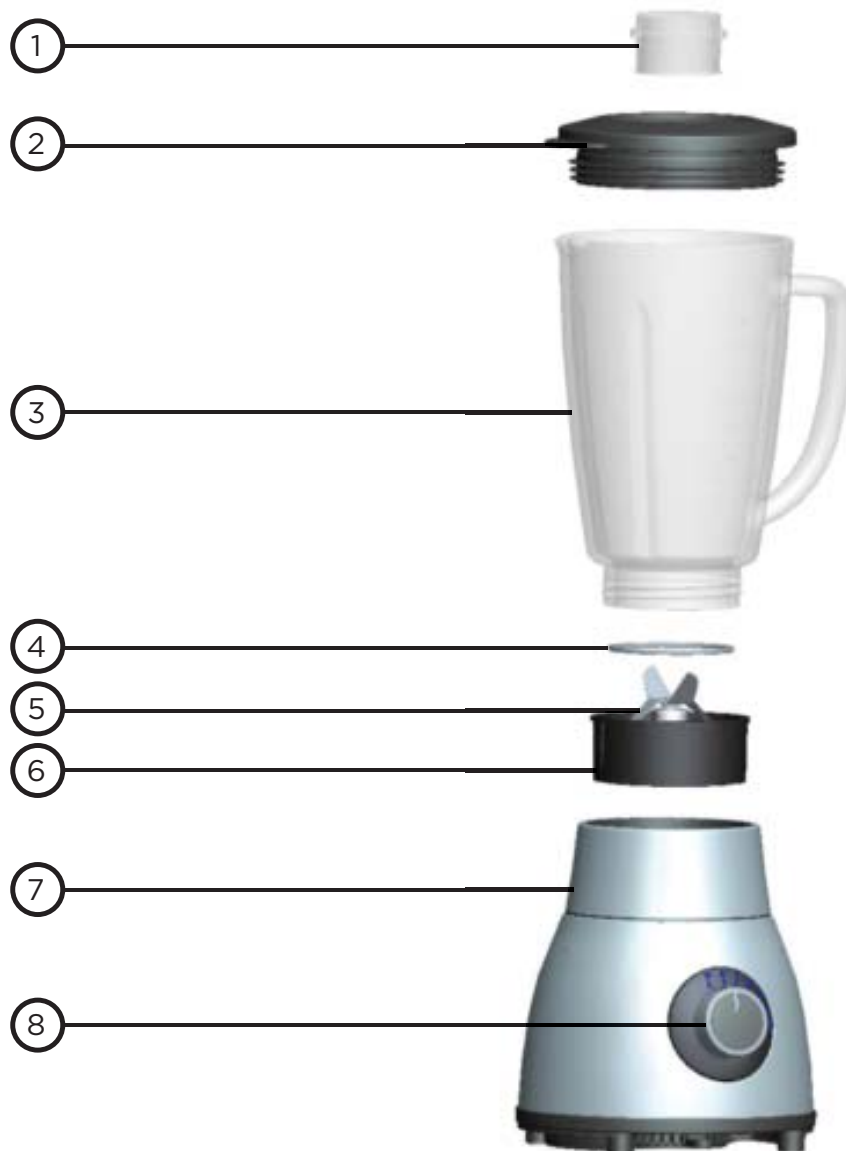

### DESCRIPTION:

- |                    |                    |                              |
|--------------------|--------------------|------------------------------|
| 1. Lid cap.        | 4. Sealing ring.   | 7. Blender body.             |
| 2. Jug lid.        | 5. Chopping blade. | 8. Rotary dial/Power switch. |
| 3. 1.8L Glass jug. | 6. Jug base.       |                              |

# BLENDER ASSEMBLY & OPERATION

1. Before first use, the jug, lid, lid cap and jug base must be cleaned. Wash with hot water and mild detergent. Rinse with fresh water and dry thoroughly.
2. **Assembling the jug:**
  - i. Place the rubber sealing ring (4) into the inner edge of the jug base (6).
  - ii. Place the jug (3) onto the jug base (6) and turn jug base in a clockwise direction until sufficiently tightened.
  - iii. Insert the lid cap (1) onto the jug lid (2).
  - iv. Place the jug lid (2) onto the Jug (3) and press down to seal.
3. **Inserting the jar into the blender body:**
  - i. Ensure blender is switched off at A/C outlet and rotary dial (8) is set to 0.
  - ii. Place assembled jug onto the blender body (7) with jug handle facing towards the rear of the blender body. Rotate the jug in a clockwise direction until the jug base slots into the blender body. The blender is now ready for use.
4. **Blender operation:**
  - i. Place the foods you wish to process into the jug.
  - ii. Place the lid onto the jug and close securely. Place the lid cap (1) into the hole in the lid and turn clockwise to lock.
  - iii. Turn A/C power on at wall socket.
  - iv. Place one hand on the lid to keep unit stable and use the rotary dial to select desired setting. The blender will now begin the blending process.
4. **Speed settings:**

1-4	For light usage with liquids.
5	For more solid consistency – for mixing liquids and solid foodstuffs.
0	Stop operation.
P	(PULSE) For ice crushing & short, powerful impulse movements.

(The switch does not permanently engage in the 'PULSE' setting. You have to hold the the rotary dial onto the 'PULSE' setting or turn it repeatedly on and off.



## Useful Tips:

- To achieve the best results when pureeing solid ingredients, place small portions into the glass jar one by one instead of placing a large quantity all at once.
- If you are processing solid ingredients, cut them into small pieces (1-1.5cm) first.
- When mixing solid ingredients start off first with a small amount of liquid. Gradually add more and more liquid through the opening in the lid.
- For stirring solid or very thick liquid ingredients we recommend that you use the blender in pulse mode to prevent the blades from becoming stuck and potentially burning out the electric motor.

## CHOPPING GUIDE

FOOD	MAXIMUM	OPERATION TIME
Meat 2.5cm Cubes	<b>250g</b>	<b>15 sec.</b>
Herbs	<b>50g</b>	<b>10 sec.</b>
Nuts, Almonds	<b>150g</b>	<b>15 sec.</b>
Cheese 2.5cm Cubes	<b>100g</b>	<b>10 sec.</b>
Bread	<b>80g</b>	<b>10 sec.</b>
Onions Chopped into 1/4	<b>200g</b>	<b>10 sec.</b>
Biscuits	<b>150g</b>	<b>10 sec.</b>
Soft Fruit	<b>200g</b>	<b>10 sec.</b>

## CLEANING AND CARE

1.  **WARNING:** Do not under any circumstances immerse the power cord, mains plug or blender body in water or any other liquid.
2.  **WARNING:** Do not attempt to clean the unit whilst it is still plugged into the electrical power outlet. Always unplug the unit before cleaning.
3. Do not use harsh or abrasive cleaning agents. The outside surface may be wiped clean with a soft, damp cloth and dried thoroughly. If necessary, a mild dishwashing detergent may be applied to the cloth but not directly applied to the blender.
4. Soaking the jug, lid, jug base and lid cap accessories in water will assist in the removal of sticky or tough to remove substances. In most instances, running hot water over the accessories is sufficient to remove most substances.
5. When washing, non-abrasive cloths and plastic bristle kitchen brushes may be used to remove stubborn food particles from the Jug and accessories. Do not use abraasive cloths and cleaning materials as they will damage the surface.
6. Ensure the blender and all accessories are dried thoroughly after cleaning.
7. Store in a dry place away from steam and humidity where possible.



# TROUBLESHOOTING

## BEFORE CALLING FOR SERVICE

If the blender fails to operate:

1. Check to make sure the blender is plugged in correctly and securely. If it is not, remove the plug from the outlet, wait 10 seconds and plug it back in securely.
2. Check for a blown or tripped circuit breaker in your home. If these seem to be working correctly, test another appliance in the same outlet to ensure the outlet is working correctly.

**IF NONE OF THE ABOVE SOLVES THE PROBLEM, DO NOT TRY TO ADJUST OR REPAIR THE BLENDER YOURSELF.**

## CUSTOMER SERVICE

In the event you believe your blender to be defective, please return it along with your sales receipt to the place of purchase for resolution.

For any enquiries, please call our service center on: Tel: 1300 883 109

## TROUBLESHOOTING

Troubleshoot your problem by using the chart below. If the blender still does not operate correctly, it may be defective.

TROUBLE	POSSIBLE CAUSE	POSSIBLE REMEDY
Blender does not turn on.	Blender is not plugged in.	Check that blender is plugged into a working power outlet and turned on.
Chopper blade not turning.	Possibly too much food in the jug.	Reduce quantity of food in the jug and try again.
Unit is hot and will no longer function.	Unit has overheated.	Allow unit to cool for one hour and try again.
Jug is leaking from the bottom.	Jug base not tightened properly or sealing ring is not in place.	Check seal is in place and re-tighten.
Motor slowing down and appears to be struggling while in use.	Foods are too dense or too much food in the jug.	Reduce quantity of food and try again. Check speed level is correct for your ingredients. Refer page 5.

## LIMITED WARRANTY

1. Nothing in this warranty affects the consumers rights under the Australian Consumer law. The benefits to the Consumer under this Warranty are in addition to the rights and remedies of the buyer under any Consumer Guarantees. The Australian Consumer Law requires that we confirm that:  
  
Our goods come with guarantees that cannot be excluded under the Australian Consumer Law. You are entitled to a replacement or refund for a major failure and for compensation for any other reasonably foreseeable loss or damage. You are also entitled to have the goods repaired or replaced if the goods fail to be of acceptable quality and the failure does not amount to a major failure.
2. Subject to Clause 1, the Seller warrants that Westinghouse branded products will be free of manufacturing defects and will perform to the Seller's specifications subject to the following clauses.
3. The benefit of this Warranty extends only to the owner of the property in which the Products manufactured or supplied by the Seller are installed and used by the owner for the duration of the Warranty Period.
4. The Warranty commences on the date of the purchase of the product and continues for the benefit of the Owner for the Warranty Period. If within the Warranty Period a manufacturing defect is discovered in the Product, or the Product fails to perform to the Seller's specifications as a result of some defect in material or workmanship in the Product, then the Seller will at its own discretion:
  - a.) Repair or replace the Product at the cost of the Seller, including but not limited to labour and travel costs. Goods repaired or replaced under this Warranty will be warranted for the remaining period of the Warranty.
  - b.) Refund the purchase price paid by the consumer.
5. The Warranty does not apply to Product that:
  - a.) Has failed due to excessive wear and tear beyond what is considered to be reasonable.
  - b.) Has been misused or neglected.
  - c.) Has been damaged accidentally or by acts of God including fire and flooding.
  - d.) Has been used or operated contrary to operating or maintenance instructions.
  - e.) Has been damaged by the Consumer or a third party authorised to act for the consumer in transit from the Sellers store to the Consumer.
6. In order to make a claim under the Warranty, the Owner must, where possible return the goods to the Seller's store at the Owner's cost. Proof of purchase must be supplied in all cases.
7. The seller will examine any returned Products and if the Seller determines that there is an apparent defect through no fault of the Owner, the Seller will:
  - a.) Make note of the Owner's contact details including the Owner's telephone number which the owner can be contacted during business hours, postal address and e-mail address.

- b.) Make note of the defects reported by the Owner.
- c.) Take back the defective goods from the owner and determine within a reasonable time through dialogue with the Seller whether the goods are defective.
- d.) Advise the owner within a reasonable time frame whether it accepts or rejects the Product claim.
- e.) If the Seller accepts the return of the Product, the Seller must arrange to have
  - i) The Product repaired or,
  - ii) Replace the damaged or faulty Product or,
  - iii) Refund the purchase price.
- 8. The Seller will not accept any returned Product which has not been returned strictly in accordance with this Warranty.
- 9. For the purpose of this Warranty:
  - a.) Australian Consumer Law means the law as set out in Schedule 2 of the Competition and Consumer Act 2010 (Cth).
  - b.) Consumer means the Purchaser of goods from the seller.
  - c.) Consumer means a Consumer as that term is set out in section 3 of the Australian Consumer Law.
  - d.) Consumer Guarantees means the guarantees under the Australian Consumer Law.
  - e.) Implied terms means any guarantees, conditions, warranties or other terms implied by any Australian Commonwealth, State or Territory laws, (excluding the Australian Consumer Law) or the law of any other jurisdiction.
  - f.) Owner has the meaning set out in clause 3.
  - g.) Warranty means this warranty.
  - h.) Product means the Product/s bought by the Owner from the Seller that fall under this warranty.
  - i.) Warranty Period means:
 

i) In relation to Cast Iron Cookware:	3 Year Limited Warranty.
ii) In relation to Non-Stick Cookware:	3 Year Limited Warranty
iii) In relation to Cooking Utensils:	3 Year Limited Warranty
iv) In relation to Knives/Knife Block Sets:	3 Year Limited Warranty
v) In relation to Stainless Steel Cookware:	10 Year Limited Warranty
vi) In relation to Chopping boards:	1 Year Limited Warranty
vii) In relation to Small Appliances:	1 Year Limited Warranty



# Westinghouse

INNOVATION YOU CAN BE SURE OF

## CUSTOMER SERVICE - 1300 883 109

IMPORTED AND DISTRIBUTED BY RVM AUSTRALIA PTY LTD.  
11 Tamara Drive, Cockburn Central, WA 6164  
MADE IN CHINA

© 2017 RVM AUSTRALIA PTY LTD. ALL RIGHTS RESERVED.

® , WESTINGHOUSE, and INNOVATION YOU CAN BE SURE OF  
are trademarks of Westinghouse Electric Corporation.  
Used under license by RVM AUSTRALIA PTY LTD. ALL RIGHTS RESERVED.