

CONTROL PANEL



Fan On/Off



Mid Speed



High Speed



Delay Switch



Light On/Off

Delay switch - Fan will remain on at low, mid or high speed for 5 mins. before switching off automatically.

LIGHT REPLACEMENT

- Switch off the power to rangehood.
- Use a small bladed screwdriver to prise off the light cover.
- Use a cloth to remove the bulb. Do not touch the bulb with fingers.
- Replace with a new bulb using a cloth. Do not touch the bulb with fingers. "Snap" the cover back in place.
- Halogen bulb 12Volt/20Watt required.

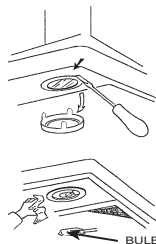

For other accessories, parts or service, please contact your local supplier (Refer to the Warranty Certificate).

WARNINGS

- Care should be taken when removing filters in order to prevent the filter falling and causing damage to the hob top.
- Remove transport tape from the lights and filters before use.
- This appliance is not intended for use by young children or infirm persons without supervision.
- Young children should be supervised to ensure that they do not play with the appliance.
- Upon installation the appliance must be positioned so that the plug is accessible.
- There should be adequate ventilation of the room when the rangehood is used at the same time as appliances burning gas or other fuels.
- You must read the details concerning the method and frequency of cleaning.
- There is a fire risk if cleaning is not carried out in accordance with the instructions.
- Do not flambé under the rangehood.
- Exhaust air must not be discharged into an existing flue used for exhausting fumes from appliances burning gas or other fuels.
- The recommended minimum distance between the hob surface and the lowest part of the rangehood is 610mm (24"). This should be increased to at least 660mm (26") (preferably 685mm (27")) if installed over a gas hob.
- Attention should be given to ensure that any applicable regulations concerning the discharge of exhaust air is fulfilled.
- If the supply cord of this equipment is damaged, it must only be replaced by the manufacturer or it's service agent, or a similarly qualified person in order to avoid a hazard.
- Care should be taken when servicing the light panel due to a short switch wire.

MANUFACTURED FOR

Fisher & Paykel

BY:

ROBINHOOD LIMITED
6 ZELANIAN DRIVE, EAST TAMAKI
AUCKLAND, NEW ZEALAND
ISO9001 Certified

Electrical Rating:
346W (1.44A)
Max at 230 - 240V 50Hz

104735 issue E
ECN: 04 101

Fisher & Paykel

INSTALLATION INSTRUCTION

Titan Canopy

88795 (UK)	RH361
88796 (UK)	RH361M
87978 (NZ/AUS)	RH361
87979 (NZ/AUS)	RH361M

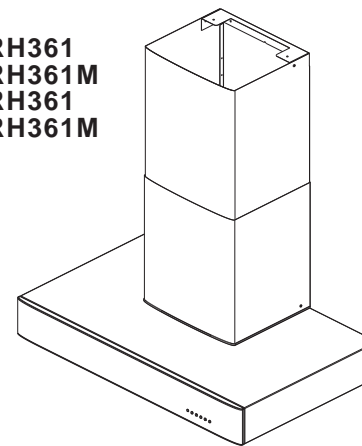

PLEASE READ THE ENTIRE INSTRUCTIONS BEFORE INSTALLING THE CANOPY

PRODUCT DIMENSIONS

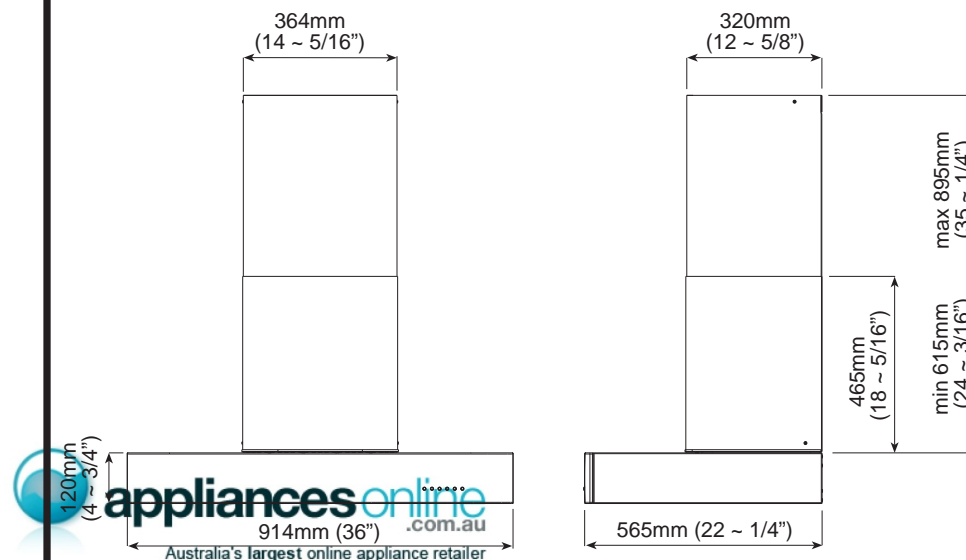

PRE-INSTALLATION

Thank you for purchasing a quality stainless or iridium canopy rangehood. We have a high standard of quality control and each rangehood is tested and approved before it leaves the factory.

IMPORTANT : Please read prior to installation and operation.

- Always switch the power off prior to installing, servicing or cleaning the appliance.
- Remove transport tape from the lights and filters before use.
- Never use the appliance without the filters.
- Please read the notes on general cleaning, especially the filters.
- Exhaust air must not be discharged into a heating flue or wall cavity, unless the cavity is designed for that purpose.
- Areas where the rangehood is installed that also have gas, oil or coal fired heaters, must be well ventilated to prevent a partial vacuum in the room. This includes gas hobs. (A partial vacuum in the room could result in too high a concentration of gas in the air).

WARNING



All electrical work must be done in accordance with local and/or national electrical codes as applicable. For safety, this product must be earthed. If you are unfamiliar with methods of installing electrical wiring, employ the services of a qualified electrician.

Turn off power at service entrance before installing wiring or servicing this product.



The canopy is heavy, overall weight 65 lbs (29kg). Please ensure adequate care when installing the canopy to prevent personal injury.

The canopy must be installed onto a solid wall or solid studs.



INSTALLATION OF UNIT

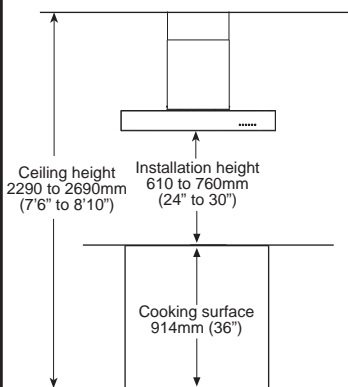

NOTE: Stainless steel and iridium is very easily damaged during installation if abraided or knocked by tools.

Read the instructions before starting the assembly. Remove the filters to allow access to wall mounting holes.

The unit is designed for 2290 to 2690mm (7' 6" to 8' 10") high ceilings. The chimney is telescopic and is designed for 615 to 895mm (24~3/16" to 35~1/4") adjustment.

Ascertain the desired installation height of the canopy. **NOTE:** Installation height ranges from 610 to 760mm (24" to 30").

DUCTING: Ducting accessories are not supplied. The air outlet from the motor requires 150mm (6") round ducting which requires 160mm (6~5/16") diameter hole in the ceiling.

This appliance must be positioned so that the electrical plug is accessible.

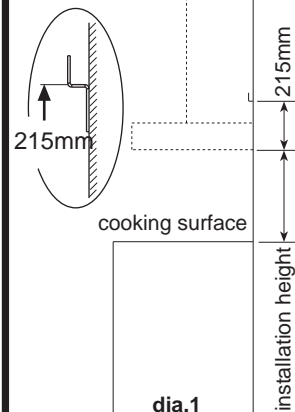

INSTALLING MOUNTING BRACKET

Align the centre of the installation bracket with the centre of the cooking surface (recommend to use plumb bob). Place the flat/horizontal surface of the mounting bracket 215mm (8~1/2") above the installation height (dia.1). Ensuring the mounting bracket is level, mark and drill the holes in the wall.

Use the screws and plugs provided to attach bracket.

INSTALLING CHIMNEY BRACKETS

Cut cornice to suit the chimney cover.

Align the centre of the chimney bracket with the centre of the cooking surface.

Mark and drill the holes in the wall and ceiling.

Use appropriate mounting screws or anchors.

INSTALLING THE CHIMNEY

A rubber extrusion has been provided to hide any irregularities between the chimney and the canopy/ceiling, it is fitted by simply pushing it over the top and bottom visible edges of the chimney. This steel edge may be sharp so care must be taken to avoid damage to fingers. If desired this extrusion may be omitted from the assembly.

Remove the protective plastic film from the chimney. Prior to mounting the chimney, determine the height required on the chimney. The height can be adjusted by changing the screw on the back lip (dia.2). Do not tighten the screws because the chimney needs to slide up when installing the canopy. Mount the chimney to the ceiling bracket using the screws provided.

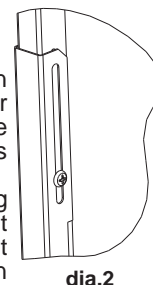

INSTALLING THE CANOPY

Ensure the filters are removed from the canopy.

Hang the canopy onto the installation bracket.

Align the canopy so it is central to the cooking surface and lines up with the chimney cover.

Mark out the position of the two safety screw holes located on the back panel.

Remove canopy, drill the safety screw holes and fit wall plugs.

Refit the canopy to the wall and secure using the appropriate mounting screws (dia.3).

Remove protective plastic film from the canopy and filters. Refit the filters to the canopy.

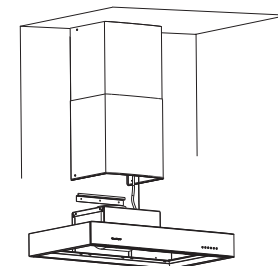

CANOPY OPERATION

Care and attention should always be taken when cooking with oils, alcohol, etc, which give off flammable vapours. Pre-used oil is especially dangerous in this respect. Do not use an uncovered electrical grill.

Particular care must be taken with grease filters which must be periodically cleaned, at least every two months. Remove the grease filters and wash them in a dishwasher using mild detergent.

Use lukewarm water and mild detergent to clean stainless steel/iridium components. In high humidity and coastal environments, cleaning should be carried out frequently. **CAUTION:** Never use abrasive or oil based liquid cleaners.



appliancesonline.com.au

Appliances Online is the largest online appliance retailer