

GLEM GAS **EMILIA**

USER MANUAL

T BAR CANOPY RANGEHOOD

MODEL CK90CTF

PLEASE READ THE USER MANUAL CAREFULLY BEFORE USING THE RANGEHOOD.

Don't install the rangehood if it is damaged. Call 1300 307 917 for assistance

Dear Customer,

Thank you for choosing our product. This manual is designed to guide you through the proper operation of your appliance, helping you achieve optimal performance and take full advantage of its features. For your safety and the safety of others, please carefully review the included safety instructions and warnings. We recommend keeping this manual in a secure location for future reference.

This appliance is intended solely for the preparation of food in a domestic (household) setting. Any other use is considered unsafe and inappropriate. The manufacturer cannot be held responsible for any issues resulting from improper use, misuse, or incorrect installation.
Glem Gas Australasia Pty Ltd

Please ensure you read this manual fully before you call for service or a full call out fee could be applied.

Record your model and serial number here:

Model number.....

Serial number

Date and place of purchase

.....

Product Specification & Technical Parameters

Model CK90CTF

Rated Voltage 230V

Rated Power Frequency 50Hz

Light Power 1x10W MAX

Motor Power 230W

Total Power 240W

Motor Single

Maximum Extraction Rate 800 cubic metres/hour

Diameter of Outlet Adapter 150mm

Dimension(mm) W898 X D498 X H560min/1040max

Safety Warnings –

Applicable Safety Standard AS/NZS 60335.2.31:2020

The appliance is not intended for use by persons (including children) with reduced physical, sensory or mental capabilities, or lack of experience and knowledge, unless they have been given supervised or instruction concerning use of the appliance by a responsible person for their safety.

Young children should be supervised to ensure that they do not play with the appliance.

If the supply cord is damaged, it must be replaced by the manufacturer or its service agent or a similarly qualified person in order to avoid a hazard.

Range Hoods and other cooking fume extractors may adversely affect the safe operation of appliances burning gas or other fuels (including those in other rooms) due to lack of back flow of combustible gases. These gases can potentially result in carbon monoxide poisoning. After installation of a range hood or other cooking fume extractor, the operation of flued gas appliances should be tested by a competent person to ensure that back flow of combustion gases do not occur.

There is a risk of fire if cleaning is not carried out in accordance with the instructions.

Caution: Accessible parts may become hot when used with a cooking appliance.

Do not flambé under the range hood.

The exhaust air must not be discharged into a flue which is used for exhausting fumes from other appliances burning gas or other fuels. (Not applicable for appliances which only discharge air back into the room)

The minimum distance between the supporting surface for the cooking vessels of the hob and the lowest part of the range hood shall be at least 60cm for electric cooktops and 650mm for gas cooktops. If the instructions for installation specify a greater distance, this has to be taken into account.

Regulations concerning the discharge of air have to be fulfilled.

Warning: Failure to install the screws or fixing devices in accordance with the instructions may result in an electrical hazard.

For LED lamp replacement please contact manufacturer or associated service agent

IMPORTANT INSTALLATION INFORMATION

The manufacturer is not responsible for any damage resulting from incorrect or improper installation. Please read this manual thoroughly before installing and using your range hood. Retain it in a safe place for future reference.

Installation and servicing must be carried out only by a qualified and trained service technician. Ensure that the main voltage matches the value indicated on the rating plate located inside the hood.

If the hood is used alongside non-electrical appliances (e.g., gas stoves), adequate ventilation must be provided to prevent the backflow of exhaust gases. The kitchen must have a direct opening to the outdoors to ensure a fresh air supply.

According to Australian safety standards, the minimum clearance is 650mm above gas cooktops and 600mm above electric cooktops. For optimal performance, we recommend installing the range hood 750mm above a gas cooktop and 650mm above an electric cooktop.

For queries regarding installation height, please contact 1 300 307 917.

MAINTENANCE

Proper maintenance is essential for the efficient operation of your range hood. Always disconnect the appliance from the power supply before performing any maintenance.

Clean or replace aluminum grease filters and activated charcoal filters at the intervals recommended in this manual.

Clean the hood using a damp cloth and a mild, neutral detergent.

DISPOSAL: Do not dispose of this product with regular household waste. It must be collected separately for proper environmental treatment.

WARNING

Electrical appliances can pose hazards under certain conditions. Please observe the following safety precautions:

- Do not inspect or remove filters while hood operation.
- Never disconnect the appliance with wet hands.
- Avoid open flames beneath the hood, as this may damage the filters.
- Monitor frying carefully to prevent overheating oil, which may cause a fire.
- Always unplug the appliance before conducting any maintenance or servicing.

TO REDUCE THE RISK OF FIRE, ELECTRIC SHOCK, OR INJURY TO PERSONS, OBSERVE THE FOLLOWING:

All installation work and electrical wiring must be carried out by qualified personnel, in full compliance with relevant codes, standards, and fire-rated construction requirements.

Proper ventilation is essential to ensure safe combustion and the effective discharge of gases through the flue (chimney), preventing the risk of backdrafts.

Take care when cutting or drilling into walls or ceilings to avoid damaging concealed electrical wiring or other hidden utilities.

Ducted ventilation systems must always be vented directly to the outdoors.

This product is intended for indoor use only; do not use it outdoors.

Adequate ventilation must be ensured when the range hood is operated simultaneously with gas or fuel-burning appliances to avoid the accumulation of hazardous fumes.

Failure to clean the appliance in accordance with the provided instructions may pose a fire hazard.

DIMENSIONS

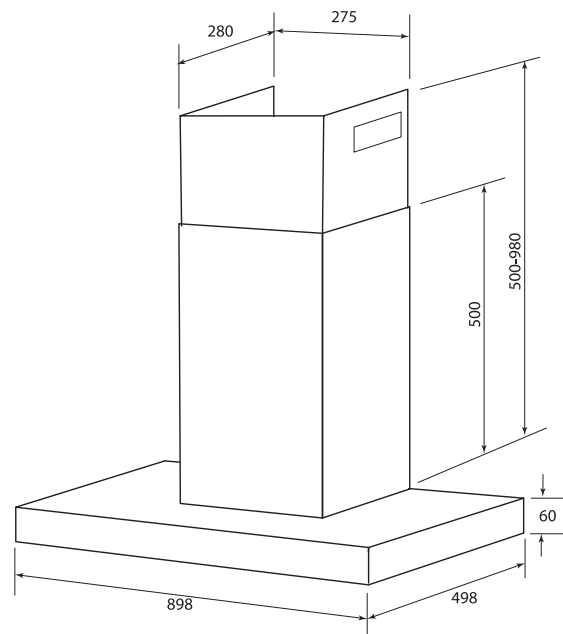

INSTALLATION & USE

OPERATION OF CONTROLS

This innovative rangehood features hand gesture controls for adjusting fan speeds and lighting. This touch-free functionality helps keep the surface clean, even when your hands are messy during cooking.

CONTROL PANEL

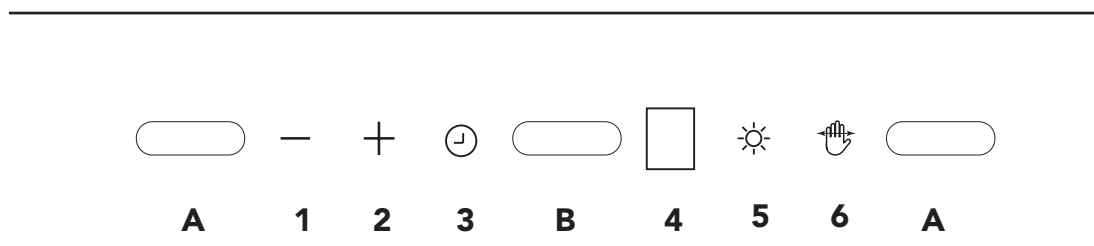

- A Gesture sensors for fan speed
- B Gesture sensors for turning light on/off
- 1 Reduce fan speed sensor
- 2 Increase fan speed sensor
- 3 Delay function
- 4 Screen
- 5 Light function sensor
- 6 Gesture control on/off sensor

The range hood is operated via a touch control panel. The "+" and "-" buttons adjust the fan speed across three levels: Low, Medium, and High. The display screen shows the current speed setting as 0, 1, 2, or 3. The timer icon activates a 15-minute auto shut-off function. The light icon toggles the range hood's light on and off. The gesture icon enables the gesture control feature.

USING GESTURE CONTROLS

FAN SPEED

To increase the fan speed, wave your hand in front of the control panel from left to right. The motor speed will cycle through 0 - 1 - 2 - 3, with the display updating accordingly.

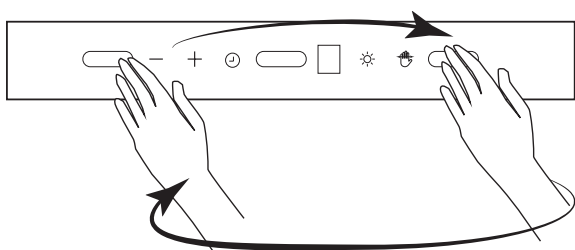

To decrease the fan speed, wave your hand from right to left, reducing the speed from 3 - 2 - 1 - 0. The current speed setting will be shown on the screen.

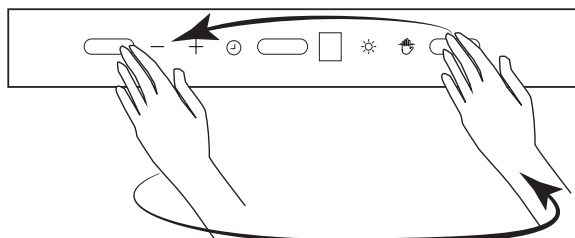

LIGHT

To turn on the light, hold your hand in front of the center sensor (labelled B) for approximately 2 seconds. The corresponding icon will appear, and the rangehood light will switch one.

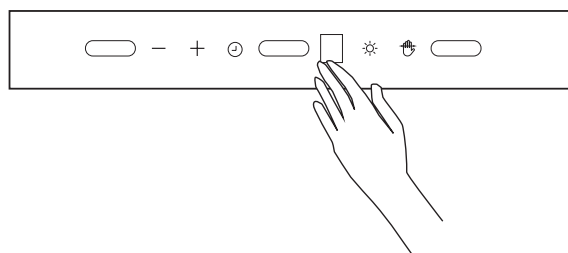

GREASE FILTERS

Grease filters should be cleaned regularly to maintain optimal performance. Use a warm water and mild detergent solution for manual cleaning.

The filters are also dishwasher-safe and may be cleaned using a light wash cycle. Note: Discoloration may occur over time but does not affect filter performance.

For removal and installation instructions, refer to the "INSTALL FILTERS" section of this manual.

INSTALLING THE DUCTWORK

Ducting Guidelines and Safety Precautions

Caution: To minimize the risk of fire, always use metal or fire-resistant ducting materials.

The duct outlet has a diameter of 150mm. Reducing this diameter may significantly increase noise levels during operation.

Plan the ductwork path from the range hood to the exterior of the building. For optimal performance, use a short and straight duct run wherever possible.

Avoid long duct runs, multiple elbows, or transitions, as these will decrease the efficiency of the range hood. For longer runs, larger diameter ducting is recommended to maintain airflow and reduce noise.

Do not discharge air into a flue that is used for venting combustion fumes from gas or fuel-burning appliances. All air discharge must comply with applicable regulations.

Install a wall cap on the exterior wall. Connect round metal ducting to the cap and work back toward the hood. Use duct tape to securely seal all joints between duct sections to ensure airtight connections.

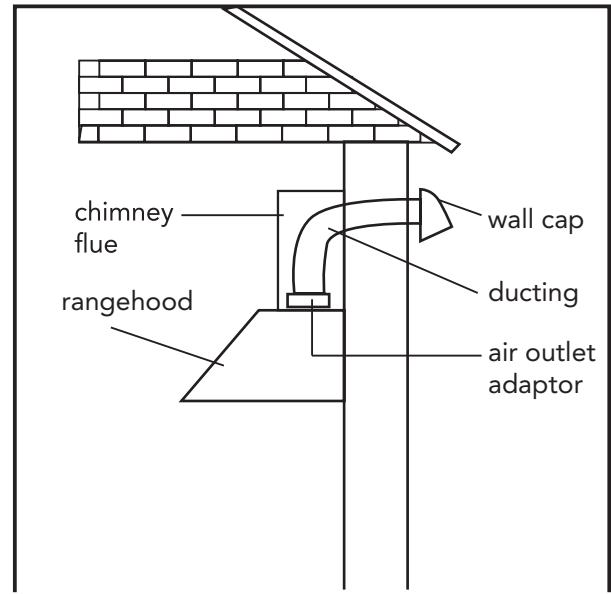

ELECTRICAL INSTALLATION

Electrical wiring must be done by a qualified person(s) in accordance with all applicable codes and standards. This range hood must be properly earthed. Turn off electrical power at power board before wiring.

If the supply cord is damaged, it must be replaced by the manufacturer, its service agent or similarly qualified persons in order to avoid a hazard.

INSTALLING THE RANGE HOOD

Before final installation, carefully remove all protective plastic film from the exterior surfaces of the hood and chimney.

Note: Installation requires at least two people for safe and proper mounting.

Mounting Height Above Cooktop **H**

According to Australian Standard AS/NZS 5601.1:2013, the minimum clearance between the cooktop and range hood must be:

650mm above gas cooktops

600mm above electric or induction cooktops

We recommend installing the hood at a height of 750mm above the cooktop for optimal performance. Heights above 750mm are at the installer's and user's discretion, though this may reduce extraction efficiency.

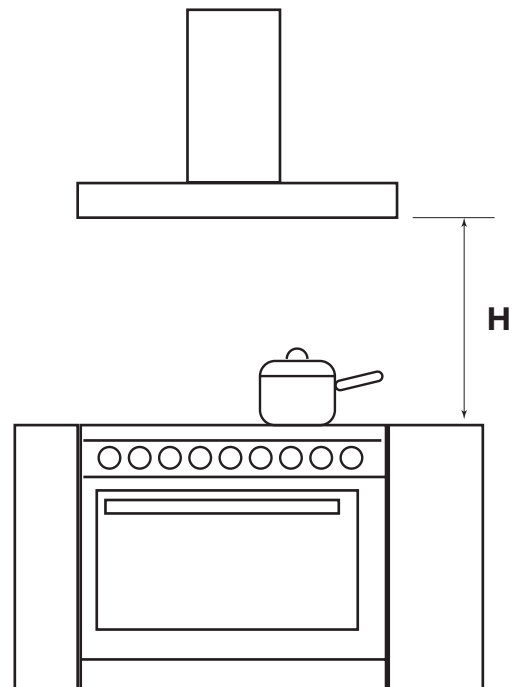

RANGEHOOD INSTALLATION ONTO THE WALL

Secure the hood mounting bracket to the wall using three (3) ST 5×45mm screws and appropriate wall anchors suited to the wall type.

Attach the Hood Body:

Align the hood body with the bracket and gently lower it until it is securely seated on the bracket.

Install the Discharge Collar: Attach the discharge collar firmly to the air outlet adapter.

Connect the Ducting: Attach a suitable length of 150mm round ducting to the outlet adapter.

Note: Reducing the duct diameter may increase operational noise.

Assemble the Chimney: Slide the top flue piece down inside the decorative bottom flue piece.

Carefully fit the bottom flue section into the recessed area on top of the hood body.

Mount the top flue bracket: Secure the top flue mounting bracket to the wall using two (2) ST 2.9×14mm screws and appropriate wall anchors.

Secure the Top Flue: Raise the top flue until its mounting holes align with those on the top flue mounting bracket.

Ensure the hood is level, then fasten the top flue to the bracket using two screws.

Secure the Bottom Flue: From inside the hood body, fasten the bottom flue section using three (3) screws.

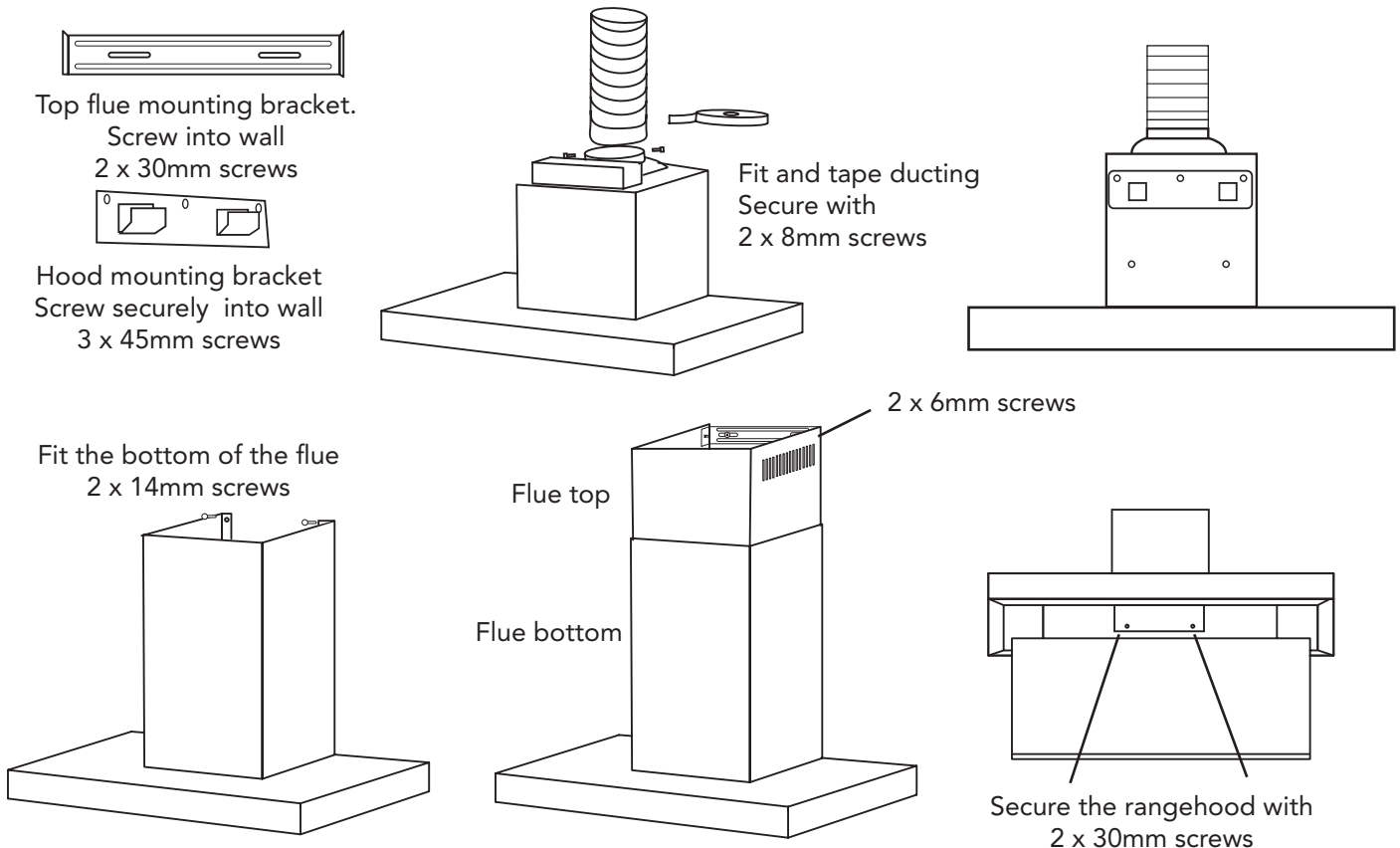

INSTALL FILTERS

To remove the grease filter, push in on the metal latch tab. This will disengage the filter from the hood.

Tilt the filter forward and remove.

To install the grease filter, align rear filter tabs with slots in the hood. Push in the metal latch tab, push filter into position and release. Make sure the filter is securely engaged after assembly.

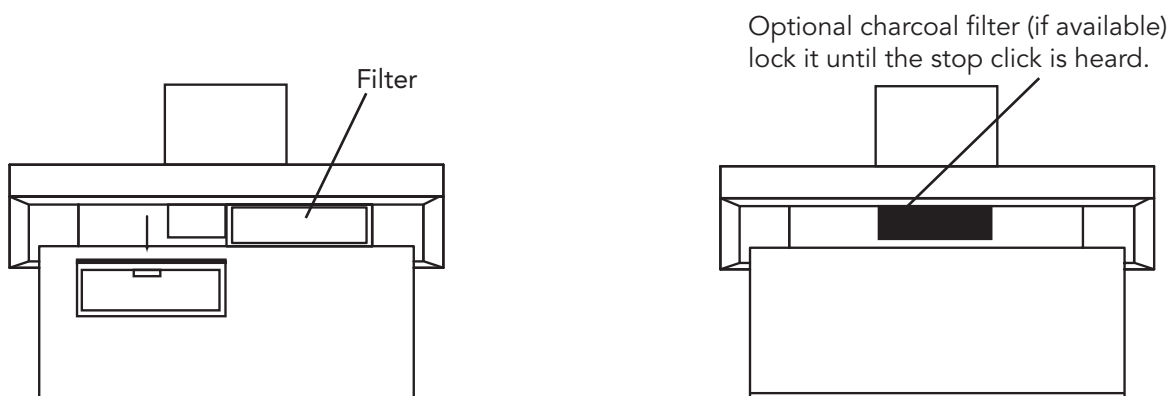

PRODUCT WARRANTY

Thank you for choosing Glem Gas and Emilia Appliances. The purchase of this appliance is an important investment in your home and so to protect your investment we urge you to complete the registration card attached and then please return it immediately. A WARRANTY REQUIREMENT IS THAT PROOF OF PURCHASE BE PROVIDED PRIOR TO REQUESTING A SERVICE CALL. THIS WARRANTY SHALL NOT APPLY IF THE APPLIANCE WAS NOT INSTALLED BY A LICENSED TECHNICIAN AND PROOF OF AUTHORISED INSTALLATION IS NOT SUPPLIED.

The benefits conferred by this warranty are in addition to all other conditions and warranties in respect of this product which the consumer may have under the Trade Practices Act 1874 of the Commonwealth of Australia and/or similar State or Territory Laws. Our goods come with guarantees that cannot be excluded under the Australian Consumer Law. You are entitled to a replacement or refund for a major failure and for compensation for any other reasonably foreseeable loss or damage. You are also entitled to have the goods repaired or replaced if the goods fail to be of acceptable quality and the failure does not amount to a major failure.

Glem Gas Australasia Pty Ltd warrants, this appliance to be free from defects in workmanship and materials for a period of:

a) Where the appliance is intended to be used and is used for

DOMESTIC USE – 24 MONTHS FROM DATE OF DELIVERY TO THE ORIGINAL PURCHASER.

b) Where the appliance is intended to be used and is used for

COMMERCIAL USE – 90 DAYS FROM DATE OF DELIVERY TO THE ORIGINAL PURCHASER.

NOTE: We do not recommend this appliance as being suitable for commercial application.

Glem Gas Australasia Pty Ltd, during the period of warranty, will at its option, and subject to the terms and conditions stated below, repair or replace free of charge this appliance or any component part, which upon examination by Glem Gas Australasia Pty Ltd is found to be defective.

THIS WARRANTY SHALL NOT APPLY:

If the rating plate has been removed or the serial number or other details on it have been removed or rendered illegible.

If the appliance is connected to any voltage other than shown on rating plate.

If the appliance has been subjected to misuse, abuse accident or want of care.

If the appliance has been installed, used, or maintained contrary to the instructions supplied by Glem Gas Australasia Pty Ltd.

If any defect or failure is due to connection to an inadequate power supply.

If damage is caused by foreign objects on the appliance or due to its use for purposes other than that for which it was delivered.

If a repair has been made or attempted by the purchaser.

Where the appliance is installed outside an 80km radius from the GPO of any Australian Capital City. Freight and travel costs beyond that radius will not be covered.

THIS WARRANTY DOES NOT COVER ANY GLASS DAMAGE.

This Warranty is given by Glem Gas Australasia Pty Ltd, and no other person or organisation is authorised to vary its provisions and conditions.

Please complete the section below and return to:

Glem Gas Australasia Pty. Ltd, PO Box 63 Blaxcell PO South Granville or email to info@glemgas.com.au (image off phone is easy)

APPLIANCE AND CUSTOMER DETAILS	
Model Number – found on the data plate	
Serial number – found on the data plate	
Place of purchase – retailer name and address	
Date of purchase	
Customer name	
Customer address	
Customer email address	
Customer telephone number	
INSTALLATION DETAILS	
Installers name	
Date of installation	
Installers telephone number	
Installers signature	

Glem Gas Australasia Pty Ltd
48 Percy Street Auburn NSW 2144
PO Box 63 Blaxcell PO South Granville NSW 2142
Website: www.glemgas.com.au
Email: info@glemgas.com.au
Telephone: 1300 307 917