

RANGEHOOD

INSTALLATION INSTRUCTION

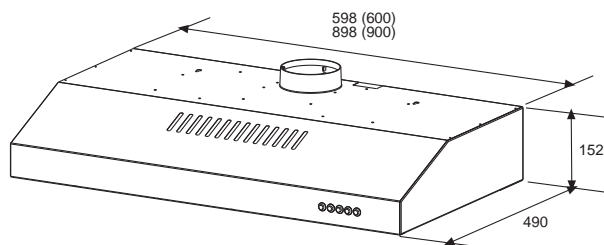

Note: Generic model is shown.
Actual product may differ.

ALL DIMENSIONS IN MM

PLEASE READ THE ENTIRE INSTRUCTION BEFORE INSTALLING THE RANGEHOOD

MOUNTING OPTIONS

WALL MOUNTING

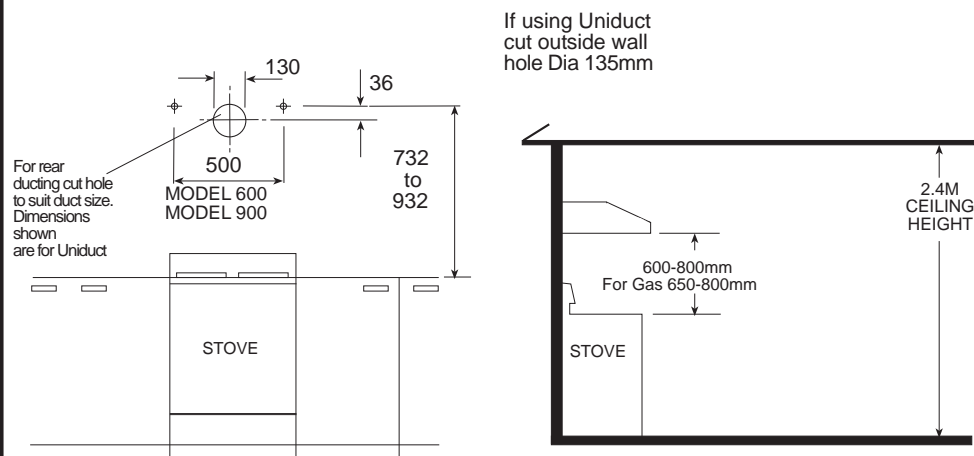

MOUNTING TO REAR WALL

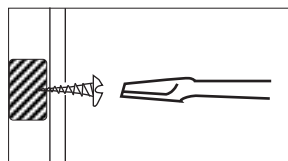

DRILL HOLES AND MOUNT TWO TOP SCREWS AS SHOWN
REFER WALL MOUNTING DETAIL

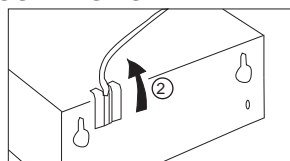

SWIVEL POWER OUTLET TO TOP

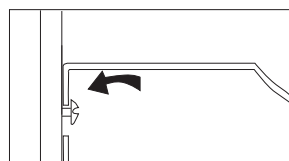

HOOK RANGEHOOD ONTO THE SCREWS. FIT THE TWO BOTTOM SCREWS THROUGH THE HOLES INTO THE PREDRILLED HOLES.

UNDERCUPBOARD MOUNTING

For top ducting cut hole to suit duct size.
Dimensions shown are for Uniduct

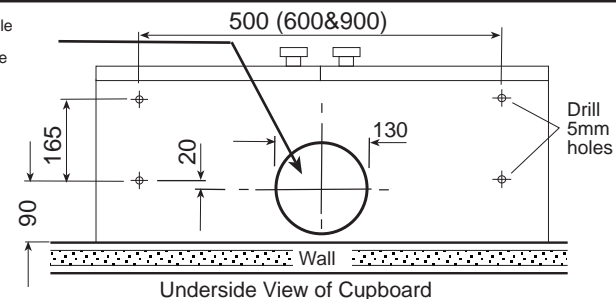

MOUNTING UNDER CUPBOARDS

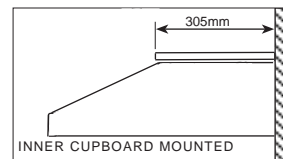

DRILL FOUR HOLES AT POSITIONS INDICATED, REFER UNDER CUPBOARD MOUNTING

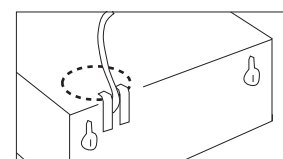

SWIVEL POWER OUTLET TO TOP.
CUT HOLE IN CABINET TO SUIT

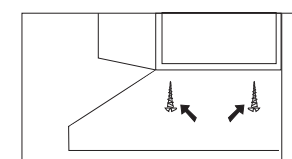

FIT THE TWO REAR SCREWS.
FIT THE UNIT OVER THE SCREWS
FIT THE TWO FRONT SCREWS

WALL MOUNTING DETAILS

FOR INSTALLATION OF PLUGS FOR WALL MOUNTING

1. Mark location of holes as per installation instructions.
2. Drill 8mm hole.
Note: Do not use a screw driver to punch a hole in the base material.
3. Insert Plastic Toggle and tap with a hammer to ensure it is flush with the base material.
4. Place supplied screw into toggle and tighten.

**NOT FOR USE
IN SOLID WALLS**

**FOR SOLID WALLS
USE APPROPRIATE
WALL PLUGS**

SIDE WALL MOUNTING

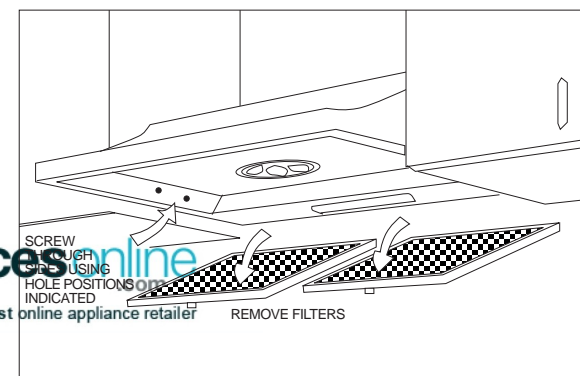

appliancesonline

Australia's largest online appliance retailer

DUCTING OPTIONS

RECIRCULATING

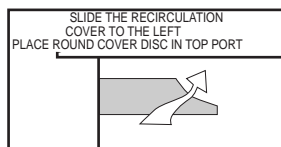

REAR DUCTED

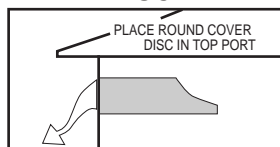

FLEXIBLE DUCT FOR SIDE DUCTING

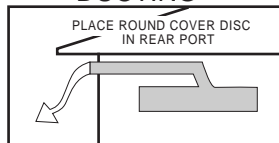

TOP DUCTED THROUGH ROOF

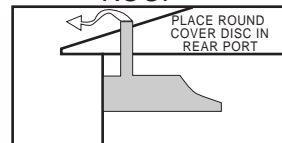

NOTE: when ducting

Exhaust air must not be discharged into any chimney or flue which may carry combustion products from other sources. In addition, exhaust air must not be discharged into a wall cavity, unless designed for the purpose.

OPERATION & CLEANING

OPERATION

After your Rangehood is fixed in position:

1. Check that the light and the diffuser are in place.
2. This unit is fitted with a recirculating duct. If the unit is rear or top ducted this cover should be in the left hand position (slots closed). If the unit is in recirculating mode it should be in the right hand side (slots open). To adjust this cover, remove the filters and the two screws attaching the cover to the recirculating duct, arrow 1. Slide the cover towards the left hand side of the rangehood, allowing the slots to open. Reattach the cover the the screws on the right hand side of the recirculation duct.
3. Remove protective plastic covering from the filters. See that the filters are correctly positioned.
4. Plug into 230-240V outlet. Keep cord clear of stove elements or hot utensils. Permanent wiring to house supply, or modifications to plug or wire should be carried out by a registered electrician.

DUCTED OR RECIRCULATION

To adjust this unit to the required airflow direction proceed as follows.

1. Remove the filters and look up at the bottom of the unit. A view similar to the sketch is seen.
2. The unit should be factory set in the ducted position shown. Should a recirculation mode be required, rotate both levers to the symbol representing recirculation.
3. Remove the screw holding the vent cover and slide the cover open, re secure the vent cover using in screws.
4. Replace the filters.

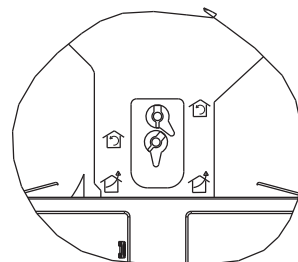

BOTTOM VIEW

1

VENT COVER
FIXING SCREWS

CLEANING

1. Disconnect the Rangehood from power supply.
2. Wash aluminium filters every 2 or 3 months, depending on usage, with hot soapy water or in the dishwasher.
3. Charcoal filters should be replaced every three to six months depending on use.
4. Clean the external and internal surfaces, using a damp cloth and mild detergent. Do not use any powder or abrasive cleaners.

LAMP REPLACEMENT

1. Disconnect the Rangehood from power supply.
2. Insert small screwdriver or slim knife as shown, ease catch to side and slip out the diffuser.
3. Replace lamp (40 watt max).
4. Slide diffuser back into aperture and 'click' into place.

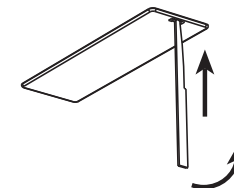

WARNING

- This appliance is not intended for use by young children or infirm persons without supervision.
- Young children should be supervised to ensure that they do not play with the appliance.
- There shall be adequate ventilation of the room when the rangehood is used at the same time as appliances burning gas or other fuels.
- You must read the details concerning the method and frequency of cleaning.
- There is a fire risk if cleaning is not carried out in accordance with the instructions.
- Do not flambé under the rangehood.
- Exhaust air must not be discharged into an existing flue which is used for exhausting fumes from appliances burning gas or other fuels.
- The minimum distance between the hob surface and the lowest part of the rangehood is 600mm. This distance shall be at least 650mm, if the rangehood is installed over a gas hob. (We recommend 700mm)
- Attention should be given to ensure that any applicable regulations concerning the discharge of exhaust air are fulfilled
- If the supply cord of this equipment is damaged, it must only be replaced by the manufacturer or its service agent or similarly qualified person in order to avoid a hazard.



appliancesonline.com.au

UNIDUCT
RANGEHOOD DUCTING

RECOMMENDED UNIDUCT DUCTING
SYSTEMS FOR RANGEHOODS

MANUFACTURED IN NEW ZEALAND BY:
ne appliance retailer **ROBINHOOD LTD.**
P.O. BOX 51 201, PAKURANGA, AUCKLAND, N.Z.
TEL: +64 9 272 5129 • FAX: +64 9 272 5148
ISO9001 Certified

Electrical Rating:
280W (1.16A)
Max. at 230-240V 50Hz

111007 Issue A
ECN:3127

