

## H 7840 BMX

Handleless speed oven

with a seamless design, Automatic programmes and food probe.



- Large touch display with movement sensor – M Touch + MotionReact
- Easy cleaning – compartment with PerfectClean and linen structure
- Faster and more consistent results – Quick & Gentle
- Network-enabled WiFi appliance – Miele@home
- Get what you want in 1 easy step – Quick MW and Popcorn button

EAN: 4002516901952 / Material number: 12802190

Construction type and design	
Appliance colour	Pearl Beige
Built-in speed oven	•
ArtLine	•
Handleless	•
User convenience	
3-in-1	Oven, Microwave, Oven with microwave function
Convenience features	
Quick & Gentle	•
Rapid Heat-up	•
Pre-heating	•
Food probe	With cable
Keeping warm	•
Crisp function	•
Operating modes	
Fan Plus	•
Conventional Heat	•
Microwave	•
Microwave + Fan Plus	•
Microwave + Grill	•
Microwave + Fan Grill	•
Microwave with Auto Roast	•
Intensive Bake	•
Auto Roast	•
Fan Grill	•
Grill	•
Bottom Heat	•
Low temperature cooking	•
Eco Fan Heat	•
Defrosting	•
Automatic programmes	•
Country-specific Automatic programmes	•
Special applications	•
User convenience	
Networking with Miele@home	•
Display	•
MotionReact proximity sensor	•
MotionReact: light comes on when movement is detected	•
MotionReact: display comes on when movement is detected	•
MotionReact: audible signal is acknowledged when movement is detected	•
MotionReact: detection of cabinet fronts	•
SoftOpen	•
MultiLingua	•
MyMiele	•
Help function	•
Popcorn function	•
Polyphonic buzzers	•
Time of day display	•

## H 7840 BMX

Handleless speed oven

with a seamless design, Automatic programmes and food probe.



EAN: 4002516901952 / Material number: 12802190

Clock synchronisation	•
Date display	•
Minute minder	•
Programmable start of cooking duration	•
Programmable end of cooking duration	•
Programmable cooking duration	•
Actual temperature display	•
Target temperature display	•
Buzzer when desired temperature is reached	•
Recommended temperature	•
Suggestion microwave power	•
Quick microwave	•
User programmes	•
Sabbath programme	•
Individual settings	•
<b>Efficiency and sustainability</b>	
Automatic residual heat utilisation	•
<b>Cleaning convenience</b>	
Stainless steel oven interior with linen structure and PerfectClean	•
Hinged grill element	•
CleanGlass door	•
<b>Safety</b>	
Appliance cooling system and touch-cool front	•
Safety switch-off	•
System lock	•
Sensor lock	•
<b>Technical data</b>	
Oven interior volume in l	43
No. of shelf levels	3
Oven light	1 LED spot
Temperatures in °C	30–250
Electronically controlled microwave power	•
Microwave power levels in W	80 / 150 / 300 / 450 / 600 / 850 / 1000
Niche width min. in mm	560
Niche width max. in mm	568
Niche height min. in mm	450
Niche height max. in mm	452
Niche depth min. in mm	550
Appliance width in mm	595
Appliance height in mm	456
Appliance depth in mm	562
Weight in kg	38.0
Total rated load in kW	3.20
Voltage in V	220-240
Frequency in Hz	50
Fuse rating in A	16
Number of phases	1
Length of supply lead in m	2.00
Replacing lamps	Customer Service

## H 7840 BMX

Handleless speed oven

with a seamless design, Automatic programmes and food probe.



EAN: 4002516901952 / Material number: 12802190

Accessories supplied	
Baking and roasting rack with PerfectClean	1
Wired food probe	1
Glass tray	2
Available display languages	
Available display languages via MultiLingua	bahasa malaysia, dansk, deutsch, english, español, français, hrvatski, italiano, magyar, nederlands, norsk, polski, português, русский, română, slovenčina, slovenščina, srpski, suomi, svenska, türkçe, українська, čeština, ελληνικ, 中文, 日本語, 繁體中文, 한국어

## H 7840 BMX Installation diagrams

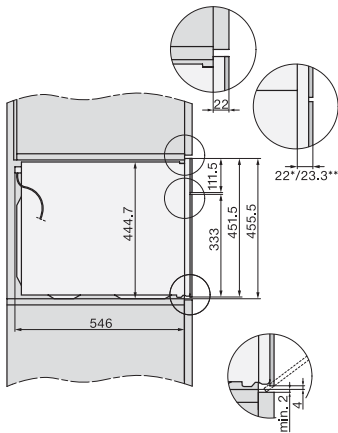

Side view, installation drawings

22 mm – glass

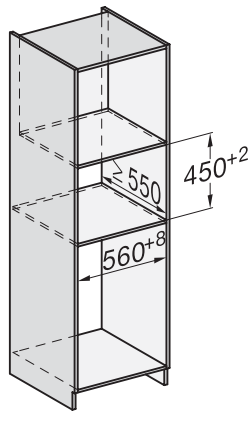

Built-in, installation drawing

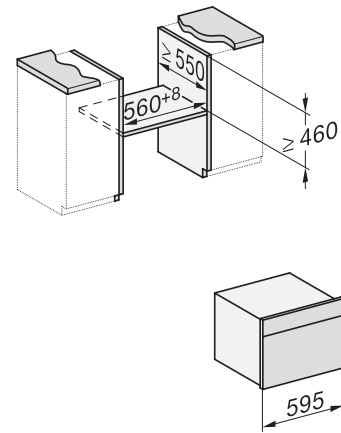

Built-in, installation drawings

If the oven is to be installed under a hob, follow the instructions for installing the hob and the height of the hob.

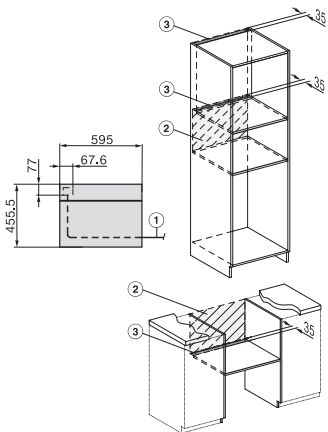

Installation, installation drawing

1) Mains connection cable, L=2000 mm,  
2) No connection in this area, 3) Ventilation cut-out min. 150 cm<sup>2</sup>.

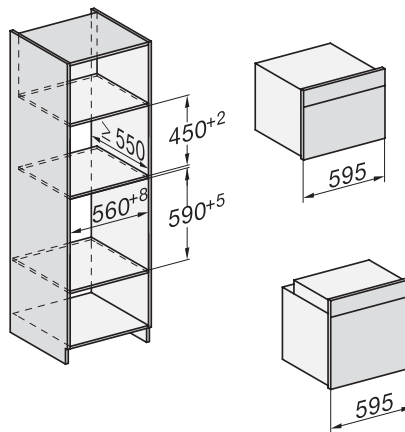

Installation, with H 7000 BP, installation drawings

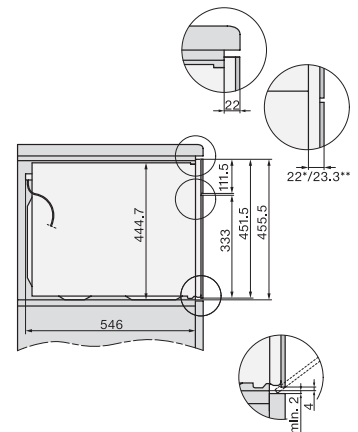

Side view, under bench, installation drawings

22 mm – glass

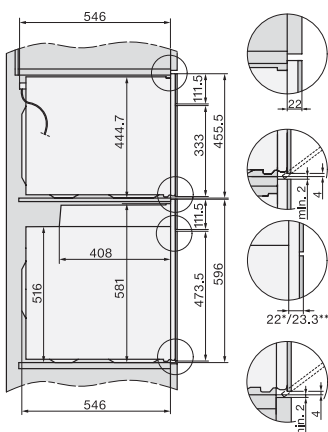

Side view, with H 7000 BP, installation drawings

22 mm – glass

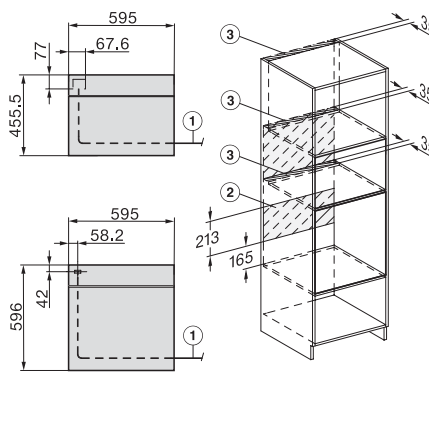

Installation with a H 7000 BP, installation drawings

1) Mains connection cable, H 7000 BM L=2000 mm, H 7000 BP L=1500 mm, 2) No connection in this area, 3) Ventilation cut-out min. 150 cm<sup>2</sup>.