

BEDIENUNG UND INSTALLATION  
OPERATION AND INSTALLATION  
UTILISATION ET INSTALLATION  
BEDIENING EN INSTALLATIE  
OBSŁUGA I INSTALACJA  
OBSLUHA A INSTALACE  
ЭКСПЛУАТАЦИЯ И МОНТАЖ  
HASZNÁLATI ÉS TELEPÍTÉSI ÚTMUTATÓ  
UPRAVLJANJE IN NAMESTITEV

WANDKONVEKTOR | WALL MOUNTED CONVECTOR HEATER | CONVECTEUR MURAL |  
WANDCONVECTOR | KONWEKTOR WISZĄCY | NÁSTĚNNÝ KONVEKTOR | НАСТЕННЫЙ  
КОНВЕКТОР | FALI KONVEKTOR | STENSKI KONVEKTOR

- » CNS 50 S
- » CNS 75 S
- » CNS 100 S
- » CNS 125 S
- » CNS 150 S
- » CNS 175 S
- » CNS 200 S
- » CNS 250 S
- » CNS 300 S
  
- » CNS 50 U
- » CNS 75 U
- » CNS 100 U
- » CNS 125 U
- » CNS 150 U
- » CNS 175 U
- » CNS 200 U
- » CNS 250 U
- » CNS 300 U

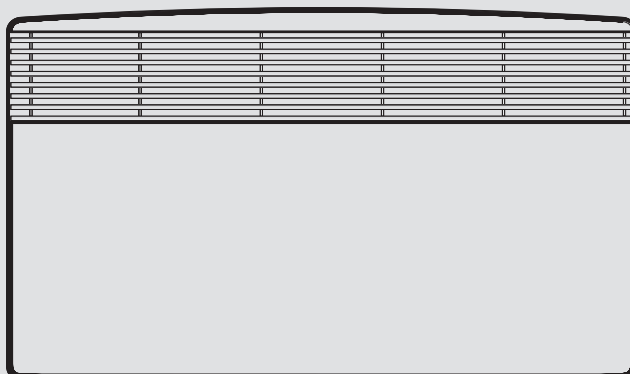

**STIEBEL ELTRON**

## SPECIAL INFORMATION

### OPERATION

<b>1. General information</b>	<b>13</b>
1.1 Safety instructions	13
1.2 Other symbols in this documentation	13
1.3 Information on the appliance	13
1.4 Units of measurement	13
<b>2. Safety</b>	<b>13</b>
2.1 Intended use	13
2.2 General safety instructions	14
2.3 Test symbols	14
<b>3. Appliance description</b>	<b>14</b>
3.1 Series CNS-S	14
3.2 Series CNS-U	14
<b>4. Operation</b>	<b>14</b>
4.1 Description of the user interface	14
4.2 Frost protection	15
4.3 Limiting the temperature controller	15
4.4 Shutdown	15
<b>5. Cleaning, care and maintenance</b>	<b>15</b>
<b>6. What to do if...</b>	<b>15</b>

### INSTALLATION

<b>7. Safety</b>	<b>16</b>
7.1 General safety instructions	16
7.2 Instructions, standards and regulations	16
<b>8. Appliance description</b>	<b>16</b>
8.1 Standard delivery	16
<b>9. Installation</b>	<b>16</b>
9.1 Minimum clearances	16
9.2 Installing the wall mounting bracket	16
9.3 Appliance installation	17
9.4 Removing the appliance	17
9.5 Power supply	17
<b>10. Troubleshooting</b>	<b>17</b>
<b>11. Appliance handover</b>	<b>17</b>
<b>12. Specification</b>	<b>18</b>
12.1 Dimensions and connections	18
12.2 Data table	18

### GUARANTEE

### ENVIRONMENT AND RECYCLING

## SPECIAL INFORMATION

- Keep children under the age of 3 away from the appliance if constant supervision cannot be guaranteed.
- Children from the age of 3 to 7 may switch the appliance on and off, provided they are supervised or have been instructed in the safe operation of the appliance and understand any risks that may result. This is subject to the appliance having been installed as described. Children from the age of 3 to 7 must not plug the power cable into its socket nor regulate the appliance.
- The appliance may be used by children aged 8 and older and persons with reduced physical, sensory or mental capabilities or a lack of experience and know-how, provided that they are supervised or they have been instructed on how to use the appliance safely and have understood the resulting risks.
- Children must never play with the appliance. Children must never clean the appliance or perform user maintenance unless they are supervised.
- Parts of the appliance can get very hot and may cause burns. Particular caution is advised when children or vulnerable persons are present.
- In order to avoid overheating, do not cover the heater.
- Never install the appliance directly below a wall socket.
- Install the appliance in such a way that the control equipment cannot be touched by a person in the bath or shower.
- Ensure the appliance can be separated from the power supply by an isolator that disconnects all poles with at least 3 mm contact separation.

- The power cable may only be replaced (for example if damaged) by a qualified contractor authorised by the manufacturer, using an original spare part.
- Secure the appliance as described in chapter "Installation / Installation".

## OPERATION

### 1. General information

The chapters "Special Information" and "Operation" are intended for both the user and qualified contractors.

The chapter "Installation" is intended for qualified contractors.



#### Note

Read these instructions carefully before using the appliance and retain them for future reference. Pass on the instructions to a new user if required.

#### 1.1 Safety instructions

##### 1.1.1 Structure of safety instructions



#### KEYWORD Type of risk

Here, possible consequences are listed that may result from failure to observe the safety instructions.

► Steps to prevent the risk are listed.

##### 1.1.2 Symbols, type of risk

Symbol	Type of risk
	Injury
	Electrocution
	Burns (burns, scalding)

##### 1.1.3 Keywords

KEYWORD	Meaning
DANGER	Failure to observe this information will result in serious injury or death.
WARNING	Failure to observe this information may result in serious injury or death.
CAUTION	Failure to observe this information may result in non-serious or minor injury.

#### 1.2 Other symbols in this documentation



#### Note

General information is identified by the adjacent symbol.

► Read these texts carefully.

Symbol	Meaning
	Material losses (appliance damage, consequential losses and environmental pollution)
	Appliance disposal

► This symbol indicates that you have to do something. The action you need to take is described step by step.

#### 1.3 Information on the appliance

Symbol	Meaning
	Never cover the appliance

#### 1.4 Units of measurement



#### Note

All measurements are given in mm unless stated otherwise.

## 2. Safety

### 2.1 Intended use

This appliance is designed to heat living areas.

This appliance is intended for domestic use. It can be used safely by untrained persons. The appliance can also be used in a non-domestic environment, e.g. in a small business, as long as it is used in the same way.

Any other use beyond that described shall be deemed inappropriate. Observation of these instructions and of instructions for any accessories used is also part of the correct use of this appliance.

### 2.2 General safety instructions

Operate the appliance only when fully installed and with all safety equipment fitted.



#### WARNING Injury

- Keep children under the age of 3 away from the appliance if constant supervision cannot be guaranteed.
- Children from the age of 3 to 7 may switch the appliance on and off, provided they are supervised or have been instructed in the safe operation of the appliance and understand any risks that may result. This is subject to the appliance having been installed as described. Children from the age of 3 to 7 must not plug the power cable into its socket nor regulate the appliance.
- The appliance may be used by children aged 8 and older and persons with reduced physical, sensory or mental capabilities or a lack of experience and know-how, provided that they are supervised or they have been instructed on how to use the appliance safely and have understood the resulting risks.
- Children must never play with the appliance. Children must never clean the appliance or perform user maintenance unless they are supervised.



#### WARNING Burns

Never operate this appliance...

- in rooms where the appliance is at risk of fire or explosion as a result of chemicals, dust, gases or vapours.
- in the direct proximity of pipes or receptacles that carry or contain flammable or explosive materials.
- if work such as laying cables, grinding or sealing is carried out in the installation room.
- if sprays, floor polish or similar products containing napsan are used. Vent the room sufficiently before heating.
- if the minimum clearances to adjacent object surfaces are not maintained, for example to furniture, net curtains, curtains, textiles or other flammable materials.
- if an appliance component is damaged, the appliance has fallen over or already had a fault.



#### WARNING Burns

Never place any flammable, combustible or insulating objects or materials, such as laundry, blankets, magazines, containers with floor polish or napsan, spray cans or similar on the appliance or in direct proximity to it.



#### WARNING Burns

Parts of the appliance can get very hot and may cause burns. Particular caution is advised when children or vulnerable persons are present.



#### WARNING Overheating

In order to avoid overheating, do not cover the heater.



#### Material losses

Never step on the appliance.

### 2.3 Test symbols

See type plate located on the right on the exterior of the appliance.

## 3. Appliance description

The appliance is a wall mounted electric direct heater.

The appliance is suitable as a full heating system in bathrooms, for example, or for use between seasons and as a booster heater in smaller rooms, such as hobby and guest rooms.

The air in the appliance is heated by a heating element and expelled via natural convection through the air outlet grille at the top. Cool room air flows in through the apertures at the bottom of the appliance.

### 3.1 Series CNS-S

After mounting the appliance on the wall and making the electrical connection using a mains plug, the appliance is ready for operation.

### 3.2 Series CNS-U

After mounting the appliance on the wall and making the electrical connection using a permanent power supply via an appliance socket, the appliance is ready for operation.

## 4. Operation

### 4.1 Description of the user interface

- Switch the appliance ON via the switch on the r.h. side of the appliance.
- Set the required room temperature via the continuously variable temperature selector (for temperatures see specification chapter).

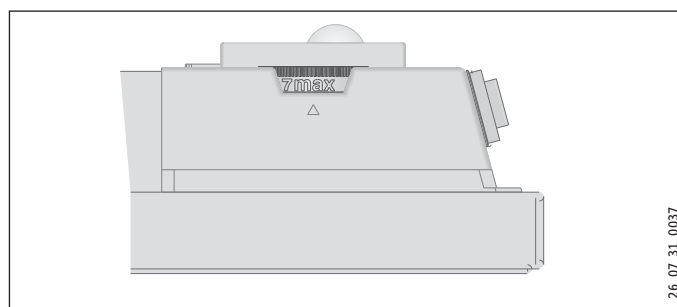

As soon as the selected room temperature is reached, it is constantly maintained at this selected temperature through periodic heating (the output of the appliance must correspond at least to the required heat demand of the room).

If several appliances are installed in a single room, the setting at the temperature selector on each appliance can be different.



#### Note

To avoid excessive power consumption when windows are open, switch the appliance off while airing.

### 4.2 Frost protection

- Turn the temperature selector as far to the right as possible. In this position, the temperature controller switches on the heating element automatically if the room temperature drops below the frost protection temperature.

### 4.3 Limiting the temperature controller

Using the two pins fitted to the back of the control casing, you can fix the temperature controller at a certain setting or limit the temperature setting range.

- Break out the pins.
- To fix the selected temperature, push a pin into the hole opposite (see diagram).

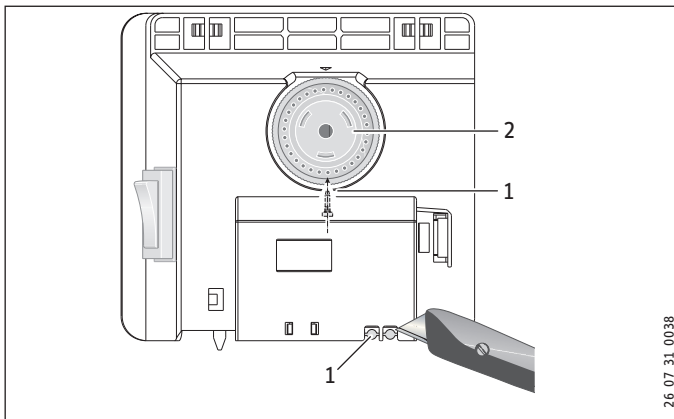

- 1 Pin
- 2 Temperature selector

- To limit the temperature setting range, set the minimum and maximum values at the temperature selector, and push a pin for each into the slightly offset hole opposite (see diagram).

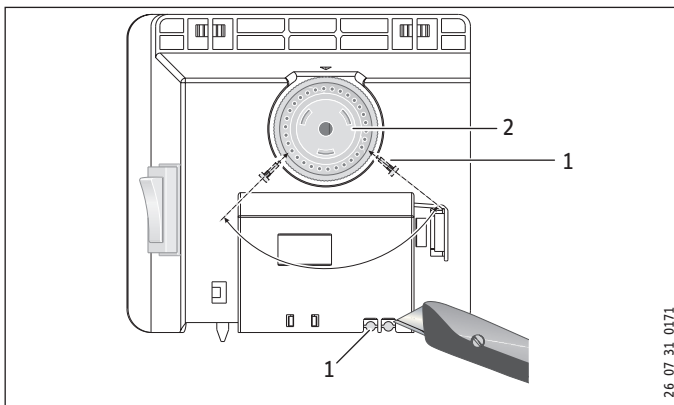

- 1 Pin
- 2 Temperature selector

### 4.4 Shutdown

- Move the switch on the right of the appliance to OFF.

## 5. Cleaning, care and maintenance



#### CAUTION Burns

Never spray cleaning spray into the air slot. Ensure that no moisture can enter the appliance.

- If a pale brownish discolouration appears on the appliance casing, wipe it off with a damp cloth.

Clean the appliance when cold with ordinary cleaning products. Avoid abrasive or corrosive cleaning products.



#### Note

As part of regular maintenance, we recommend also having the control components checked. The safety and control components should be checked by a contractor no more than ten years after commissioning.

## 6. What to do if...

... the appliance does not heat up:

- Check the temperature set at the appliance and the MCB/fuse in your fuse box.

The appliance has a safety temperature controller that shuts the appliance down if it overheats. After the cause has been removed (for example air outlet or inlet apertures covered) and the appliance has cooled down for a few minutes, operation starts again.

If you cannot remedy the fault, contact your contractor. To facilitate and speed up your enquiry, please provide the number on the type plate (no. XXXXXX - XXXX - XXXXXX).

# INSTALLATION

## 7. Safety

Only a qualified contractor should carry out installation, commissioning, maintenance and repair of the appliance.

### 7.1 General safety instructions

We guarantee trouble-free function and operational reliability only if original accessories and spare parts intended for the appliance are used.



#### WARNING Electrocutation

Install the appliance in such a way that control equipment cannot be touched by a person in the bath or shower.



#### Material losses

- Only fit the wall mounted appliance to a vertical wall that is temperature-resistant to at least 85 °C.
- Maintain the minimum clearances to adjacent object surfaces.
- Never install the appliance directly below a wall socket.
- Ensure that the power cable is not in contact with any appliance components.

### 7.2 Instructions, standards and regulations



#### Note

Observe all applicable national and regional regulations and instructions.

## 8. Appliance description

### 8.1 Standard delivery

The following are delivered with the appliance:

- Wall mounting bracket (hooked into the appliance)

## 9. Installation

### 9.1 Minimum clearances

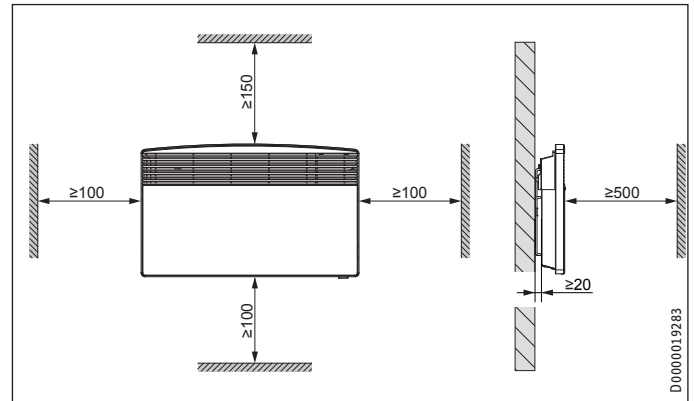

### 9.2 Installing the wall mounting bracket



#### Note

You can use the wall mounting bracket as a template for wall mounting; this ensures the required floor clearance.

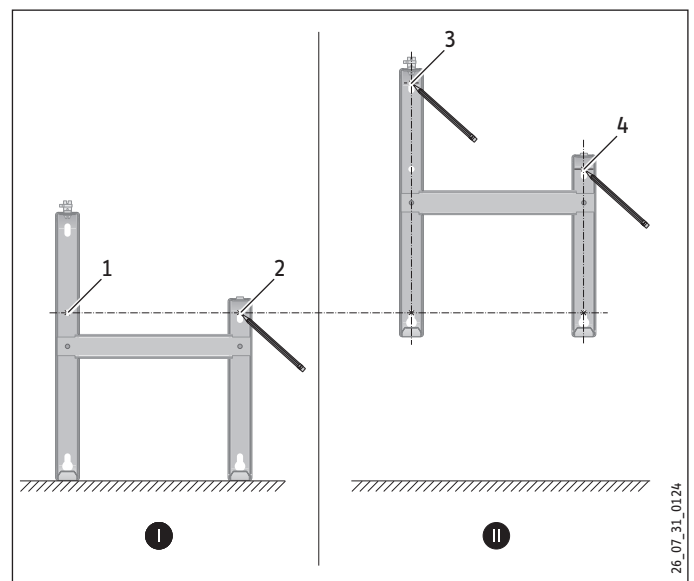

- Unhook the wall mounting bracket.
- Place the centred wall mounting bracket level on the ground and mark holes 1 and 2.
- Lift up the wall mounting bracket so that its lower holes match up with the markings you have just made on the installation wall.
- Mark holes 3 and 4 on the installation wall.
- Drill holes at all four markings. Secure the wall mounting bracket with suitable materials (screws, rawl plugs) depending on the type of wall. With the vertical slots, you can compensate for an offset fixing hole.

# INSTALLATION

## Troubleshooting

### 9.3 Appliance installation

- ▶ Hook the appliance by its slots in the back of the appliance on to all four tabs of the wall mounting bracket simultaneously.
- ▶ Push the appliance to latch it in position.

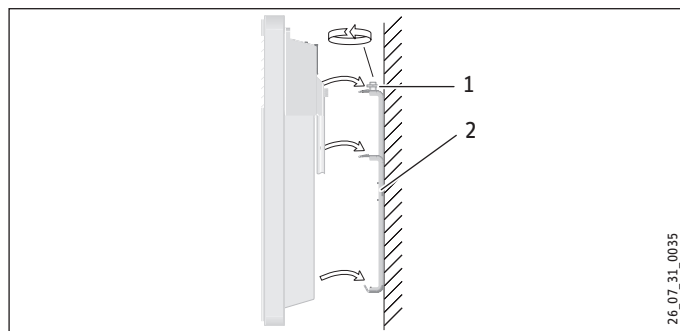

- 1 Locking bolt
- 2 Wall mounting bracket

- ▶ Turn the locking bolt in the wall mounting bracket fully clockwise; this locks the appliance in place.

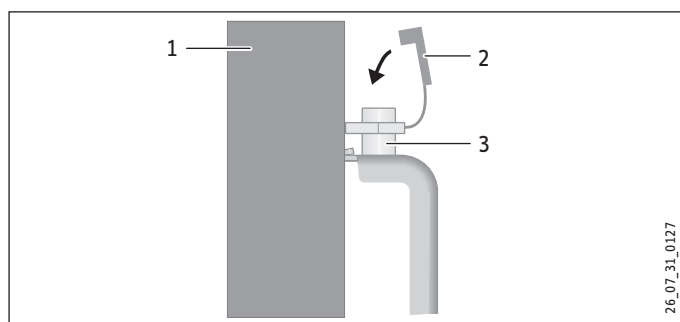

- 1 Appliance
- 2 Safety cap
- 3 Locking bolt

- ▶ Push the safety cap onto the locking bolt to prevent it from loosening.

### 9.4 Removing the appliance

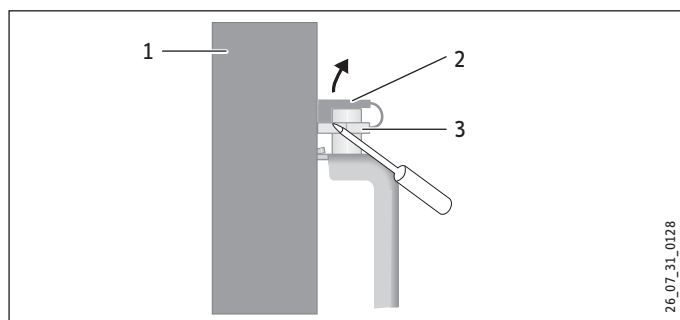

- 1 Appliance
- 2 Safety cap
- 3 Locking bolt

- ▶ Remove the safety cap from the locking bolt.
- ▶ Undo the locking bolt on the wall mounting bracket.
- ▶ Lift the appliance up slightly and pull it forwards and away from the wall mounting bracket.

### 9.5 Power supply

- ▶ Ensure the on-site supply cable has an adequate cross-section.
- ▶ When connecting the appliance via a standard socket, ensure that the socket is easily accessible once the appliance has been installed.



#### WARNING Electrocution

- Carry out all electrical connection and installation work in accordance with relevant regulations.
- Ensure the appliance can be separated from the power supply by an isolator that disconnects all poles with at least 3 mm contact separation.
- Do not install the appliance with a fixed power cable.



#### Note

Observe the type plate. The specified voltage must match the mains voltage.

## 10. Troubleshooting

The power cable must only be replaced by a contractor using our original spare parts.

## 11. Appliance handover

Explain the functions of the appliance to the user. Draw special attention to the safety instructions. Hand over the operating and installation instructions to the user.

## 12. Specification

### 12.1 Dimensions and connections

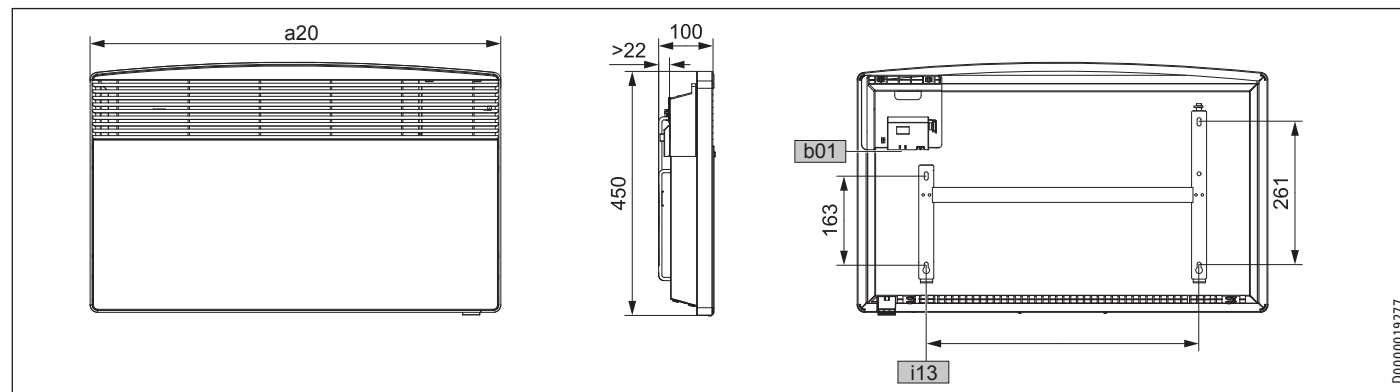

				CNS 50 S/U	CNS 75 S/U	CNS 100 S/U	CNS 125 S/U	CNS 150 S/U	CNS 175 S/U	CNS 200 S/U	CNS 250 S/U	CNS 300 S/U
a20	Appliance	Width	mm	370	445	445	590	590	740	740	890	1040
b01	Electrical cable grommet											
i13	Wall mounting bracket	Hole spacing	mm	121	195	195	343	343	491	491	639	787

### 12.2 Data table

#### CNS 50-300 S

		CNS 50 S	CNS 75 S	CNS 100 S	CNS 125 S	CNS 150 S	CNS 175 S	CNS 200 S	CNS 250 S	CNS 300 S
		220716	220717	220718	220719	220720	220721	220722	220723	220724
Electrical data										
Connected load	kW	0.5	0.75	1.0	1.25	1.5	1.75	2.0	2.5	3.0
Power supply		1/N ~ 230 V	1/N ~ 230 V	1/N ~ 230 V	1/N ~ 230 V	1/N ~ 230 V	1/N ~ 230 V	1/N ~ 230 V	1/N ~ 230 V	1/N ~ 230 V
Dimensions										
Height	mm	450	450	450	450	450	450	450	450	450
Width	mm	370	445	445	590	590	740	740	890	1040
Depth	mm	100	100	100	100	100	100	100	100	100
Weights										
Weight	kg	3.8	4.4	4.4	5.7	5.7	6.8	6.8	8.1	9.4
Versions										
Frost protection setting	°C	7	7	7	7	7	7	7	7	7
IP rating		IP24	IP24	IP24	IP24	IP24	IP24	IP24	IP24	IP24
Protection class		II	II	II	II	II	II	II	II	II
Colour		Alpine white	Alpine white	Alpine white	Alpine white	Alpine white	Alpine white	Alpine white	Alpine white	Alpine white
Values										
Setting range	°C	7-30	7-30	7-30	7-30	7-30	7-30	7-30	7-30	7-30



# INSTALLATION Specification

## CNS 50-300 U

		CNS 50 U	CNS 75 U	CNS 100 U	CNS 125 U	CNS 150 U	CNS 175 U	CNS 200 U	CNS 250 U	CNS 300 U
		220725	220726	220727	220728	220729	220730	220731	220732	220733
Electrical data										
Connected load	kW	0.5	0.75	1.0	1.25	1.5	1.75	2.0	2.5	3.0
Power supply		1/N ~ 230 V	1/N ~ 230 V	1/N ~ 230 V	1/N ~ 230 V	1/N ~ 230 V	1/N ~ 230 V	1/N ~ 230 V	1/N ~ 230 V	1/N ~ 230 V
Dimensions										
Height	mm	450	450	450	450	450	450	450	450	450
Width	mm	370	445	445	590	590	740	740	890	1040
Depth	mm	100	100	100	100	100	100	100	100	100
Weights										
Weight	kg	3.3	4	4	5.2	5.2	6.3	6.3	7.7	8.9
Versions										
Frost protection setting	°C	7	7	7	7	7	7	7	7	7
IP rating		IP24	IP24	IP24	IP24	IP24	IP24	IP24	IP24	IP24
Protection class		II	II	II	II	II	II	II	II	II
Colour		Alpine white	Alpine white	Alpine white	Alpine white	Alpine white	Alpine white	Alpine white	Alpine white	Alpine white
Values										
Setting range	°C	7-30	7-30	7-30	7-30	7-30	7-30	7-30	7-30	7-30

ENGLISH

## Guarantee

The guarantee conditions of our German companies do not apply to appliances acquired outside of Germany. In countries where our subsidiaries sell our products a guarantee can only be issued by those subsidiaries. Such guarantee is only granted if the subsidiary has issued its own terms of guarantee. No other guarantee will be granted.

We shall not provide any guarantee for appliances acquired in countries where we have no subsidiary to sell our products. This will not affect warranties issued by any importers.

## Environment and recycling

We would ask you to help protect the environment. After use, dispose of the various materials in accordance with national regulations.