

90 cm Dual Fuel Range Cooker



HSB738156A	
Alternative colors available	Stainless steel(HSB738156A)
Characteristics	<ul style="list-style-type: none">- Stainless steel- Cavity volume: 98 l- Multi-function oven with 8 heating methods: Fan forced hot air, Top/bottom heating, Bottom heating, Fan assisted top/bottom heating, Hot air grilling, Grill - large area, Grill - small area, Defrost- 6 burners including 1 wok burner- Cooking zone front left: WOK burner 15.8 Mj/h- Cooking zone rear left: Economy burner 3.9 Mj/h- Cooking zone front centre: Economy burner 3.9 Mj/h- Cooking zone rear centre: Standard burner 7.5 Mj/h- Cooking zone front right: Standard burner 7.5 Mj/h- Cooking zone rear right: High-speed burner 12 Mj/h- One-hand electronic ignition- Electronic clock/timer- Number of oven lights: 2 PC- Height adjustable legs by: 35 mm- Storage compartment- Catalytic side walls- Double glazed door- Flame failure device fitted to each individual burner- Cooling fan- Included accessories: 1 x WOK attachment ring, 1 x enamel baking tray, 2 x wire rack, 1 x cross support for espresso

Technical Data



BOSCH

Invented for Life

HSB738156A

Characteristics

Built-in / Free-standing : Free-standing
 Color / Material Front : Stainless steel
 Dimensions of the product (mm) : 878 x 898 x 600
 Length electrical supply cord (cm) : 120.0
 Net weight (kg) : 80.000
 Gross weight (kg) : 88.000

Consumption and connection features

Electrical connection rating (W) : 3000
 Current (A) : 16
 Voltage (V) : 220-240
 Frequency (Hz) : 50-60
 Plug type : AU plug

2013-01-17

Included accessories

1 x WOK attachment ring
 1 x enamel baking tray
 2 x grill shelf
 1 x cross support for espresso

EAN code

4242002731858

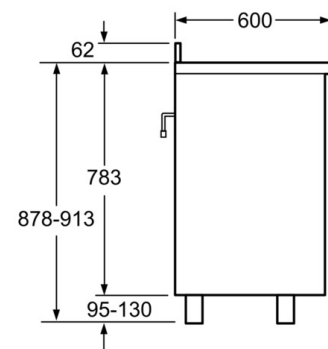

measurements in mm

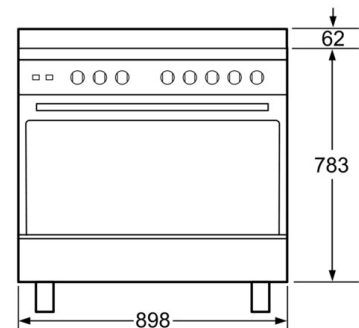

measurements in mm

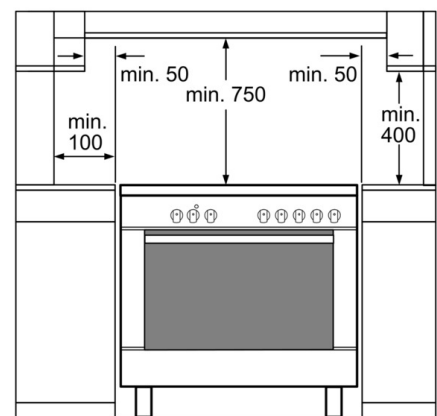

measurements in mm

Technical Data

HSB738156A

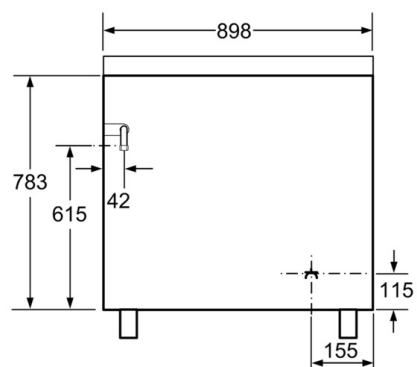

measurements in mm