

Tonic

by Rogerseller

Wall Top Assembly

Installation
Instructions

Specification

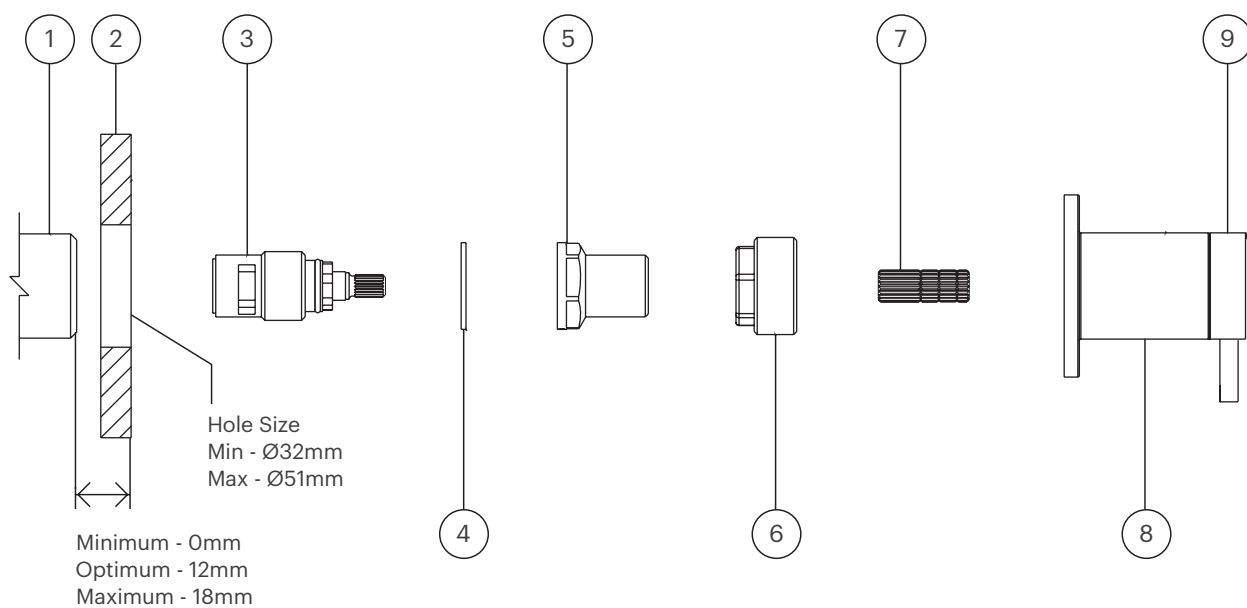

Tonic by Rogerseller Wall Top Assembly

3606013501 — Chrome

i Other finishes available

Parts List

1. Tap Body (not supplied)
2. Finished Wall
3. Ceramic Cartridge
4. Fibre Washer
5. Lock Nut
6. Adaptor
7. Spline
8. Flange
9. Handle

Installation

Notes Before Installation

- Please flush out new pipe work prior to connecting the new tap.
- This tap is suitable for high pressure applications where both hot and cold water supply pressures are at 150kPa or above.
- Ramtaps lever style sets are supplied with one counter-rotation ceramic valve. See adjacent diagram for recommended installation.

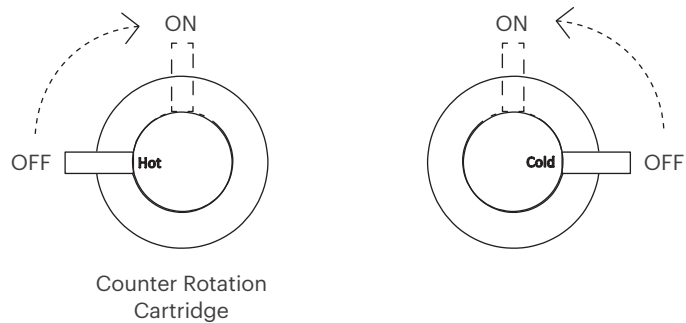

Ceramic Valve

1. Separate the cartridge and the locknut. Screw the cartridge into the tap body by hand until it contacts the tap seat. Grip the cartridge on the hex (use 15mm ring or tube spanner) and turn until it comes to a firm stop. Do not over tighten. Do not use the end of the spindle to tighten the cartridge.
2. Fit the fibre washer over the cartridge and against the face of the tap body.
3. Fit the locknut by hand onto the cartridge up to the face of the tap body.
4. Tighten to a similar tension as a conventional jumper valve headwork's (use 1" or 25mm ring or tube spanner).

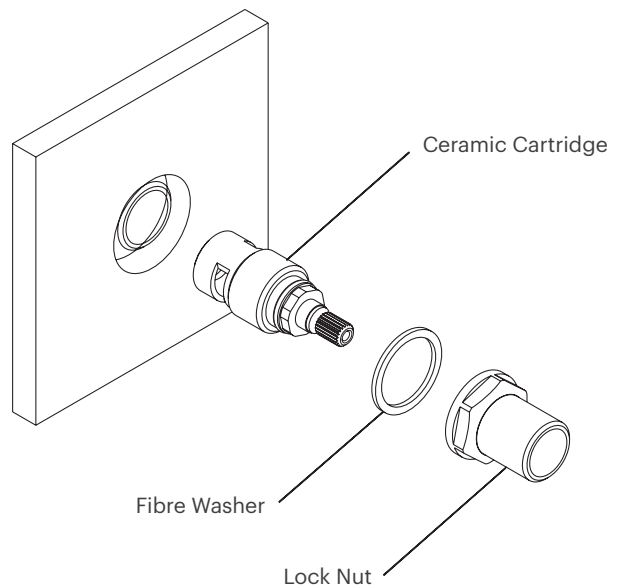

Spline

1. Place the spline extension on the ceramic valves making sure that the internal spline has correctly engaged the ceramic valves.
2. The spline extension may need to be cut depending on the position of the tap body.
3. Measure 38-40mm from the finished wall and cut through the nearest spline extension groove towards the finished wall as shown in diagram.

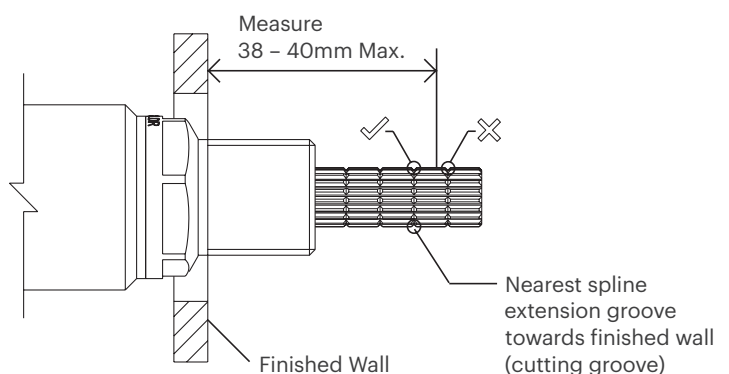

Installation

Dry Fitting for Checking Correct Orientation

1. With the valves in the off position, fit the pre cut spline extension to the splined valve stem.
2. Locate and fit the handle assemblies over the valve, ensuring that the handles are aligned in the desired position, with the splines engaged.
3. If the handle orientation is not aligned then remove the handle assemblies and mark anywhere on the splines with marker.
4. Follow below any one of the methods:
 - Reposition the splines rotating by one tooth at a time.
 - Reposition the splines rotating by 90 degrees.
 - Reposition the splines rotating by 180 degrees.
5. After achieving correct handle orientation, leave the splines in the same places and remove handle assemblies.

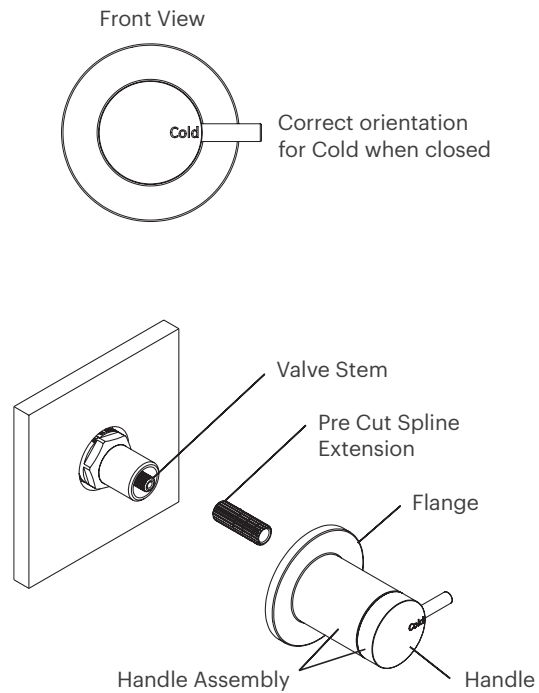

Handle

1. Fit the adaptor to the lock nut. This adaptor can be fitted either way to accommodate deep or protruding tap bodies. Screw the adaptor onto to the lock nut.
2. Locate and fit the handle assemblies over the valve, ensuring that the handles are aligned in the recommended position.
3. With the spline engaged, use one hand to hold the handle and the other to screw the flange onto the adaptor clockwise until firmly against the wall.

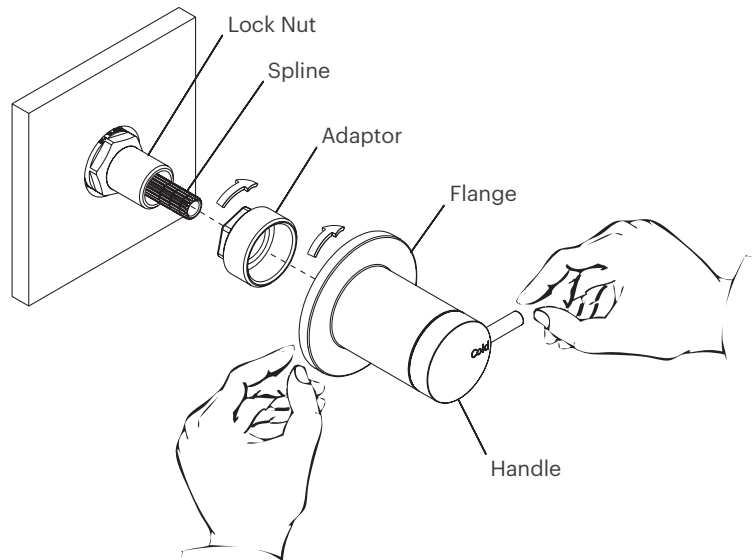

Specifications

It is a requirement of state plumbing codes that licensed plumbers carry out all tapware installations. All installations must comply with the relevant requirements of AS/NZS3500 and local plumbing codes.

Pressure

Maximum Hydrostatic Pressure - 1000kpa
Recommended Maximum Hydrostatic Pressure - 500 kpa. (AS/NZS 3500)
Recommended Minimum Hydrostatic Pressure - 150 kpa.
Maximum Hydrostatic Pressure may be exceeded under test conditions only in accordance with AS/NZS 3500. Where hydrostatic pressure exceeds the maximum stated above, pressure limiting valves must be installed or warranty will be void.

Temperature

Maximum Water Temperature - 80°C
For optimum performance, Hot and Cold inlet water pressure should be equal.

Care and Maintenance

[1] Product should be inspected for surface damage prior to installation. [2] Cleaning and handling of all finishes must be performed carefully. [3] Clean products using a soft cloth with warm soapy water only. [4] Never use harsh detergents or abrasive cleaners as these will damage the product. [5] Water marks can be removed from Matt Finishes with an application of a carnauba wax based non-abrasive polish on a microfibre cloth. [6] Do not use undue pressure when cleaning and wipe in one direction only. [7] Contact with harsh chemicals such as hair dye, hair bleach etc will result in damage to the finish. [8] Tapware should never be installed using acetone silicones. [9] Avoid the use of wax based furniture creams as this can result in a build up of deposits which will detract from the appearance. [10] Damage to finishes arising from improper installation or post installation use or failure to observe the above care and cleaning instructions will void all warranty agreements.

Warranty

Rogerseller tapware, bathroom fittings and sanitaryware are covered by a five (5) year warranty from date of purchase. For full terms and conditions please refer to rogerseller.com.au

Dimensions are approximate. Information in this installation instruction is representative of the product available at the time of printing. Due to our policy of continuous product development, the design and specifications depicted are subject to change without notice. Please confirm all particulars with your client advisor prior to purchase.

Rogerseller Showrooms —

Melbourne
173-177 Barkly Avenue
Burnley VIC 3121
P 03 9429 8888

Sydney
18 Danks Street
Waterloo NSW 2017
P 02 8396 8700

Brisbane
74-76 McLachlan Street
Fortitude Valley QLD 4006
P 07 3251 4333

Concept Stores —

**Routleys Plumbing
Innovations (Malvern SA)**
P 08 8291 3000

rogerseller

rogerseller.com.au