

说明书：ES-A814FL-W(澳洲夏普)

技术要求

- 1. 印刷字体、图案应鲜明、亮丽，无漏印、错印、倾斜等缺陷。
- 2. 尺寸规格: A5版,100 g/m²(长×宽=140mm×210mm) 误差为±5mm。
- 3. 纸张页数: 14张。
- 4. 印刷颜色: 单墨黑白。
- 5. 符合惠而浦中国关于RoHS指令的《保证书》要求。

销 售 地

个 / 台

1

原使用机型

ES-A814FL-W
(澳洲夏普)

④					说明书	惠而浦（中国）股份有限公司					
③						图 样 标 记			重 量	比 例	
②											
①											
标记	处数	更改理由		签 字	日期	双胶纸	共 1 张			第 1 张	
设 计				标准化			部件编号			301G13A008-	
审 核				审 批							
会 签				日 期							

SHARP

Front Load Washing Machine

ES-A814FL-W

SHARP

SHARP CORPORATION
OSAKA, JAPAN

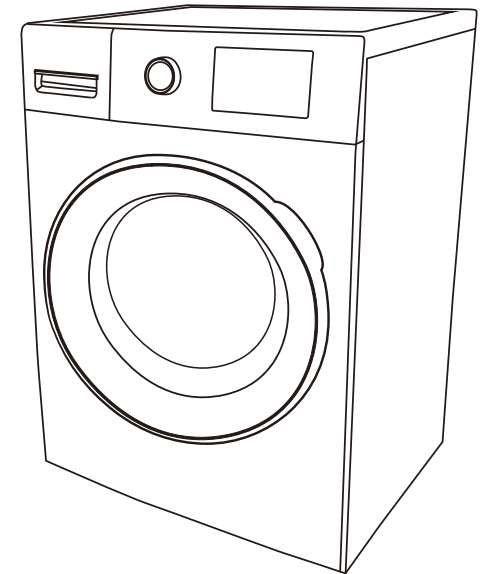

Operation manual

Thank you for purchasing our product.

Please read this manual carefully before use.

Please read 安全 Notice carefully before use.

Please keep this manual in a safe place.

Our product is specially designed for household use only.

CONTENTS

INSTRUCTION BEFORE WASHING

SAFETY NOTICE	2~3
INSTALLATION INSTRUCTIONS	4~8
NAME OF PARTS	9
ACCESSORIES	9

OPERATION INSTRUCTION

SPECIFICATION SHEET	10
LOCK AND UNLOCK METHOD	11
INTRODUCTION TO DETERGENT BOX	12
INTRODUCTION TO CONTROL PANEL	13~14
PROGRAM INTRODUCTION	15~17
EXTRA OPTIONS AND FUNCTIONS	18~20

CLEAN AND MAINTENANCE

CLEAN AND MAINTENANCE	21~22
NON-FAILURE CONDITION	23
TROUBLESHOOTING GUIDE	24



SAFETY NOTICE (be sure to observe)

- To protect the user and other people's health and property, be sure to observe the following safety notice.







⚠ WARNINGS

please read this part of substance carefully for proper operation before using your machine.

- The precautions stated here are classified as "Warning" and "Attention" according to the damage and the emergency caused by misoperation, and are described respectively in line with the marks below.

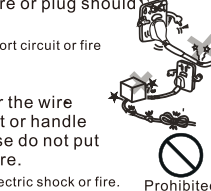
 Warning	With no respect to mark, the misoperation may cause death or GBH.
 Attention	With no respect to mark, the misoperation may cause body harm or object damage.

		
This mark indicates the content of warning or attention.	This mark indicates the prohibited action.	This mark indicates the compulsory action to be carried out.

⚠ Warning	
 <ul style="list-style-type: none"> ● Dismantling, repair or alterations should only be carried out by professional technician as otherwise you may be subject to electric shock, may cause fire or get injured. 	<ul style="list-style-type: none"> ● This washing machine is equipped with the electricity wire with bielectrode grounding socket. The creepage protector shall be used if possible.  <p>Grounding</p>
<ul style="list-style-type: none"> ● Electricity supply must be unplugged with dry hands. Otherwise, this may cause electric shock.  <p>Wet hands Prohibited</p>	<ul style="list-style-type: none"> ● Please use the single socket with special voltage and current matched with plug marked specification. <p>The share of the same socket with other electric appliances may cause fire due to excessive.</p>
<ul style="list-style-type: none"> ● Damaged or loosen wire or plug should not be used. Otherwise electric shock, short circuit or fire may take place. ● Do not damage wire. Do not damage or alter the wire forcibly bend, pull twist or handle the wire. Beside, please do not put weigh on or trap the wire.  <p>Prohibited</p>	<ul style="list-style-type: none"> ● Thoroughly wipe the power plug when dirt is adhering the prong or around the base of the prong. <p>Clear</p> <p>Failure to do so may cause a fire.</p>
<ul style="list-style-type: none"> ● Do not put water in direct contact with the unit during maintenance and repair. This may cause short circuit or electric shock.  <p>Prohibited</p>	<ul style="list-style-type: none"> ● Washing machine should not be installed in humid place or in places exposed to wind and rain. Otherwise, electricity leak causing electric shock or fire may occur.  <p>Prohibited</p>
<ul style="list-style-type: none"> ● Do not put gasoline, benzine, alcohol, thinner of fabrics with these stains into or near to the washing machine. To prevent fire or explosion which may cause injuries.  <p>Prohibited</p>	<ul style="list-style-type: none"> ● This washing machine is strictly prohibited to get close to the locations with candle, mosquito-repellent incense, dog-end or other kinds of open flame. To avoid injuries caused by the lock damage. ● Do not operate the machine when there is gas leak.  <p>Prohibited</p>

⚠ WARNINGS

- Keep child away from the washing spinning basket and do not place box or shelves next to the washing machine.

children may fall into the basket resulting in injuries.

This appliance is not intended for use by persons (including children) with reduced physical, sensory or mental capabilities, or lack of experience and knowledge, unless they have been given supervision or instruction concerning use of the appliance by a person responsible for their safety.



Prohibited

- The glass door becomes hot in process of high-temperature washing. Do not touch the door when the machine is on, especially children.
- If you need to open the door during high-temperature washing program, wait until the temperature drop to safe standard, and the door unlocked automatically.
- Packing material may be dangerous to kids, please keep all packing material (plastic bag foam etc) far away from the kids.



Prohibited

⚠ Attention

- Do not pull the wire from the socket when unplugging the unit.

To avoid electric shock or fire cause by short circuit may result.



Prohibited



- Electricity supply must be unplugged with dry hands during maintenance and repair.

Otherwise, electric leakage causing injuries may occur.

- If the power cord or supply cord is damaged, the manufacturer or its service agent or similarly qualified person must replace it in order to avoid a hazard.



- Please unplug the unit when not using the unit for a long period of time.

Electric shock or leakage may occur due to deformation of plastic parts of the unit.



- Water of above 50°C should not be used for washing.

Electric shock or leakage may occur due to deformation of plastic parts of the unit.



Prohibited

- Do not wash, rinse and spin the water proof fabric or cloth.

Sleeping bag, raincoat, cover of skiing, utilities, bicycles, cars and motors. Otherwise may lead to injury by abnormal vibration during spinning or damage the washing machine, wall, floor and clothes.



Prohibited

- Do not stand on or put weight on the top of the unit.

Otherwise, deformation and damage may result causing injuries.



Prohibited

- Two people are required in moving or transportation.

- Keep hands and feet away from the bottom of washing machine when it is working.

Parts in working under the product may cause injuries.



Prohibited



Water leakage

Water supply hose should be tightly screwed to the unit.

Failure to do so may result in water leakage. Used for a long period of time, the unit may result in water leakage caused by loosen union nut. So please check it in time and screw tightly again.

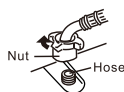

Water leakage

- Check water supply hose connection by turning on the water before washing. To prevent damages caused by possible water leakage due to loosen screw or not tightly.

- The new hose-sets supplied with the appliance are to be used and that old hose-sets should not be reused.
- Do not block the ventilation openings on the bottom of washer by carpeting when the washer is installed on a carpeted floor.

- Please turn off the water tap when not using the unit.

To prevent damages caused by water leakage.



INSTALLATION INSTRUCTIONS

Unpacking the washing machine

CAUTION: EXTREMELY HEAVY!

- A team lift or mechanical aid is required when moving this appliance.
- Keep the washing machine as upright as possible during transportation.

- This product has been packaged to protect it against transportation damage. Remove all packaging materials from inside the drum and around the appliance.
- Keep the original packaging carton and materials in a safe place. It will help prevent any damage if the product needs to be transported in the future, and you can use it to store the appliance when it is not in use. In the event that the carton is to be disposed of, please recycle all packaging materials where possible.
- Plastic wrapping can be a suffocation hazard for babies and young children, so ensure all packaging materials are out of their reach and disposed of safely.
- Carefully lift the washing machine and remove the base packing. Make sure the base protection device is removed together with the bottom piece. If not, lay the unit down on its side, then remove the small foam piece from the base of the unit manually.
- Remove any tapes securing the cord and drain hose.
- Remove all accessory parts from the drum.

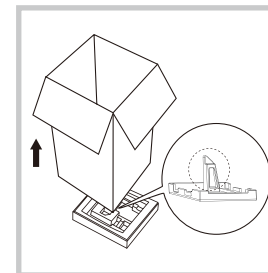

Checking the package contents

- Check all parts of the package against the scope of delivery list on the previous page and ensure you have received all items.
- Check the washing machine for any damage from transportation. Unwind the power cord to its full length and inspect it for damage. **Do not use the appliance if the appliance or its cord has been damaged or is not working properly.** In case of damage, or if anything is missing, contact our after sales support centre for advice on examination, repair or return of the damaged product.
- Read this manual to familiarise yourself with all the parts and operating principles of the wash. Pay particular attention to the safety instructions on the previous pages.

WORKING CONDITION

- Do not operate the washing machine in temperatures outside its normal working condition (0–40°C). Using it in temperatures below 0°C may damage the machine's inlet valve and draining systems.
- If the machine is stored in an area where the temperature drops to below 0°C, transfer it to an area with a warmer ambient temperature before use and ensure no residual water is frozen in hoses and pipes.

INSTALLATION INSTRUCTIONS

Selecting the location

Before installing the appliance, make sure the location meets the following requirements:

- The surface is rigid, dry and level – if it is not level, please adjust the levelling legs (see page 6).
- The position is protected from direct sunlight, water and weather.
- There is sufficient ventilation.
- There is 100mm space between any walls and the furthest protruding part of the machine.
- The room temperature is above 0°C.
- The position is at least 200mm from heat sources.
- The machine will not stand on the power cord.
- The area is not carpeted (if this cannot be avoided, place a plastic mat underneath the machine and make sure any ventilation openings in the base are not obstructed).

Do **NOT** install the appliance:

- Behind a lockable or sliding door, or a door with a hinge on the opposite side of the machine, in such a way that a full opening of the appliance door is restricted.
- In a tight-fitting cabinet.

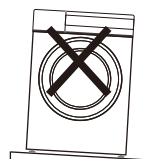
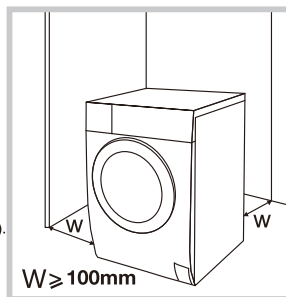

1. On the sloping ground

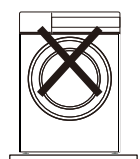

2. On the platform and the bracket



3. On the concavo - convex ground

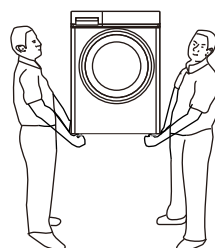

Transportation

Two people are needed to carry the machine. One person on one side carries the machine by holding the machine feet.

INSTALLATION INSTRUCTIONS

Remove the bolt used to fix the machine in transportation

To protect the machine in transportation, there are 4 bolts inserted into the inner part of the machine. Remove these bolts before use. (otherwise there will be strong shock, noise, and disfunction in spin process.)

1. Unscrew the bolts that are fixed before transportation by spanner (4 bolts)

2. Remove the bolts horizontally.

3. Fit the lid into the holes.

- Let the sales force or professional maintenance worker to install the machine.

- Keep the dismantled bolts carefully, you will need them in house moving.

- As the picture shows, please be sure to confirm that the base protection device is not stuck at the bottom of the washing machine before use, otherwise it will affect the normal use of washing machine.

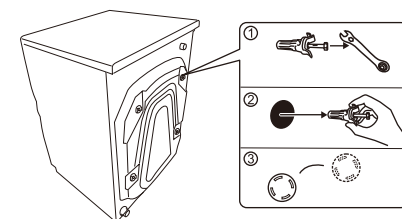

Base protection device

Adjust the machine horizontally

There will be strong shock, noise, and disfunction in operation if the washing machine is not steadily installed. Please adjust the front adjustable Leg.

Methods are as follows:

1. Check whether the washer is on a level surface using a plumb line as shown in the Beside figure.

• The washer is on level ground floor if the Frame line of washer is parallel with the plumb line.

2. Adjust the Adjustable Leg of washer if necessary to make the washer level as shown in the Beside figure.

3. Put your hands on the washer diagonally, press and shake the washer slightly to make sure that the washer is steady.

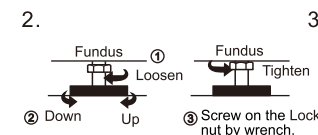
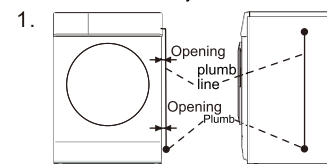

INSTALLATION INSTRUCTIONS

Connecting the Supply Hose

1. Check that sealing washers are firmly seated.
2. Attach the curved end of the hose to the inlet valve of the washing machine. Tighten the coupling nuts securely by hand.
3. Attach straight end of the hose to the tap. Tighten the coupling nuts securely by hand.
4. Turn on the taps and check for leaks. Tighten the coupling nuts firmly if there is any leakage. If water pressure is strong, close the water tap completely then open it slightly.

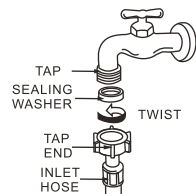

CAUTIONS:

- Do not use water which is hotter than 50°C.
- If your faucet is not suitable, please consult your dealer.

Installing Water Supply Hose to the Washer

Turn the nut clockwise till the nut turned tight while holding the hose.

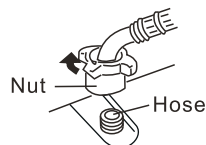

Turn the nut counterclockwise after turning the faucet off when you want to detach the water supply hose.

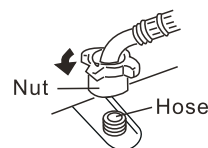

INSTALLATION INSTRUCTIONS

Installing the drain hose

WARNING!

- Do not kink or protract the drain hose.
- Position the drain hose properly in order to prevent water spillage onto the floor and potential damage.
- Never immerse the end of the drain hose in water.

The drain hose is installed at the back of the machine. For drainage of the washing water, you can install the other end of the hose three different ways, as illustrated:

- Lead the drain hose into a drain spout (1).
- Affix the drain hose into a branch drain pipe of the laundry sink (2).
- Lead the drain hose into a sink/basin, using the drain hose support at the back of the machine, and secure it with a rope or tie (3). To ensure proper drainage when the washing machine is in use, the height of the drain hose must not be higher than 100cm above ground.

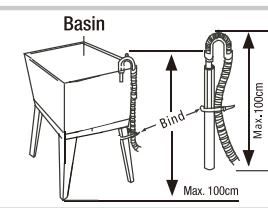
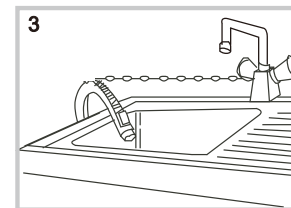
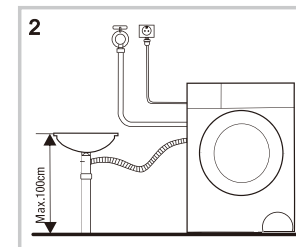
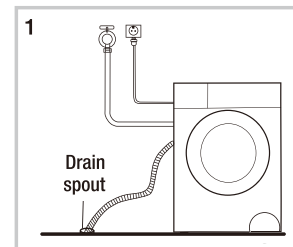

- When the washing machine is not in use, you may leave the drain hose at the back of the machine, using the hose clips to keep it in place.

WARNING!

- If the drain hose is too long, do not force it into the washing machine as it will cause abnormal noise.
- Never lay down the drain hose as water will be discharged.
- Be sure the drain hose is properly routed so it will not kink or lift off the sink.
- Leave the drain hose affixed to the back of the machine; do not remove the hose buckles.

NAME OF PARTS

ATTENTION

- We suggest the user to run the tub clean program before the 1st time washing.
- Don't forget to close the water tap and take down the power plug to avoid any flood and fire disaster.

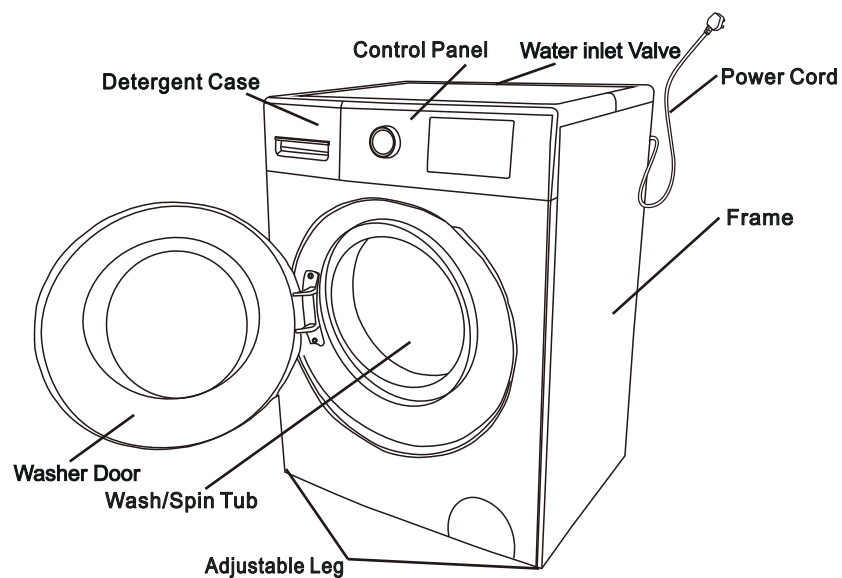

SPECIFICATION SHEET

Rated wash capacity	8.0kg
Rated spin capacity	8.0kg
Rated dry capacity	—
Rated dry power	—
Max current	10A
Rated voltage	220-240V-50Hz
Rated power	2000W
Energy efficiency	4 Stars
Water efficiency	4 Stars
Water consumption per wash	79L
Annual energy consumption	265kWh
Washing performance	0.8kWh
Water pressure	0.03 ~ 1.0MPa
Product dimension	600x595x850

ACCESSORIES

Instruction manual	Water Supply Hose	Lid (4Piece)	Spanner

LOCK AND UNLOCK METHOD

DOOR LOCK

When the machine is working, the door locks automatically. It can't be opened.

UNLOCK

When the machine is working, the user press the “START/STOP” button.
The door can be unlocked after inner tub stopping spin.

- If take down the power plug directly or power cut when the machine is running, the door can't be unlocked automatically.
- If open the door when the machine is working, the froth may exceed and please clean it with towel.
- The user can't open the door when the machine is running with a high working temperature.
- The user can't open the door when the water temperature is high.

INTRODUCTION TO EACH COMPARTMENT OF DETERGENT BOX

Powder synthetic detergents



- For the undissolved detergents, for example: powder state soap, dissolve it in advance, then pour into the case.

Liquid detergent and bleach



- Use low bubble liquid synthetic detergents.
- For the concentrated liquid detergents, diluted it double times with water, then pour into the case.

Softener



- Put into the same before washing, it will be poured into tub automatically at the last round of rinse.
- For the concentrated detergents, use corresponding proportion of water to dilute it, then pour it into the case.
- No exceed to the full mark line.

Liquid detergents



- Liquid detergents can be poured in this case to ensure the wash performance.

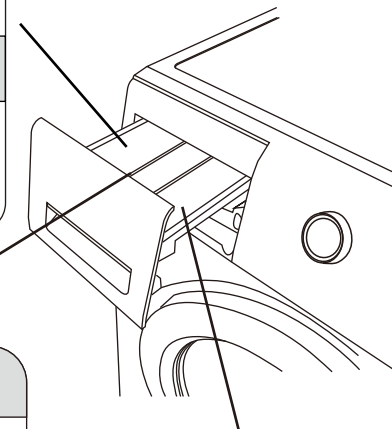

- High bubble washer powder or detergents is forbidden.
- Use the detergents in accordance with the instruction by its manufacturer.
- Excessive detergents will cause too much bubble and affect the rinse, also create function faults.
- Choose suitable detergents in accordance with the type and color of clothes, the water temperature and the stain.

INTRODUCTION TO THE CONTROL PANEL

The distribution

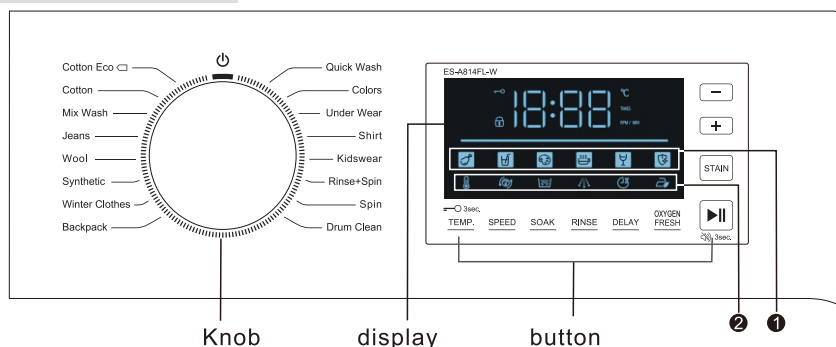

■ Program Knob

Turn the program knob to switch on the machine and select your desired wash program. The light will light up to indicate the selected programme.

■ Stand-by position

Turn the knob to the stand-by position to switch the machine to stand-by (it switches to stand-by automatically at the end of the program, but the dial remains on the selected program position).



■ Display window

The display shows the settings, estimated remaining time, options, and status messages. When the appliance is turned on, the default settings in the display will illuminate.

18:00: When a program is selected, the default time for that program is displayed. The default time can be changed according to the selected option.

°C: When set the temperature, this icon is illuminated.

TIMES: When set the rinse times, this icon is illuminated.

MIN: When set the wash/spin/soak and free wash time, and during program running, this icon is illuminated.

RPM: When set the spin speed, this icon is illuminated.

⛔: After set child lock function, this icon is illuminated.

🔒: When this icon is illuminated, the door cannot be opened.

①: When select stain type for stain wash function, the oil/juice/water color/coffe/red wine/ All stains icons is successively illuminated.

②: The icon is illuminated when press the button below to set extra options, and the corresponding icon is flashed during each working process when program is running.

INTRODUCTION TO THE CONTROL PANEL

■ TEMP. button

Press to adjust a programs default temperature. Press and hold this button for 3 seconds to set the child lock function.

■ SPEED button

Press to adjust a programs default spin speed.

■ SOAK button

Press to add and adjust the soak time.

■ RINSE button

Press to adjust the rinse time.

■ DELAY button

Press to set the delay function (up to a maximum of 24 hours).

■ QXYGEN FRESH button

Press to set the Qxygen fresh function.

■ Start/Stop

This **Start/Pause** button is used to start the wash cycle or pause the wash cycle.

If a temporary stop of the wash cycle is needed, press the **Start/Pause** button.

Press and hold this button for at least 3 seconds to mute the buzzer.



■ Stain button

Press to set the Stain wash function and select stain type.

■ Free wash buttons

Press to adjust the program running time depends on your desire.



Press to reduce the program running time.



Press to increase the program running time.

PROGRAM INTRODUCTION

Cotton Eco	A warm water eco program with an extra long washing time used for energy efficiency testing
Cotton	Normally soiled cottons, linens or cotton mix fabrics (e.g. table linen, towelling, underwear, T-shirts etc.)
Mix Wash	A warm water program for a mixed load of synthetic and cotton textiles
Jeans	A program for denim jeans or similar hard-wearing cotton clothing
Wool	A specially gentle program for machine-washable wool or wool-blend textiles. Designed to prevent shrinkage
Synthetic	A gentle program for synthetic or synthetic blend textiles
Winter Clothes	A program for winter clothes, machine-washable down jackets, vests and similar clothing.
Backpack	A program for canvans bag and other cloth bags washing, not suitable for coriaceous, plastic and waterproof bag.
Quick Wash	An extra short program for a few lightly soiled items
Colors	A cold program for brightly coloured items
Under Wear	A delicate program for under wears
Shirt	Cotton or mixed fibre shirts and blouses
Kidswear	A very hot water wash for kids clothes with particularly high levels of hygiene
Rinse + Spin	Separate rinse program with spin
Spin	Separate spin program with selectable speed. Drains water before spinning.
Drum Clean	A drum cleaning program designed for use without laundry items

PROGRAM INTRODUCTION

Program	Max. Load (kg)	Default Temperature (default + temp. range) (°C)	Default Time (hr:min)	Spin Speed (RPM) (default + extra)	Rinse (times) (default+extra)
Cotton Eco *	8	40 (cold-10-20-30-40-60)	5:39	1400 (400-600-800-1000-1200-1400)	3(0-6)
Cotton	8	30 (cold-10-20-30-40-60-80)	1:08	1000 (400-600-800-1000-1200-1400)	2(0-6)
Mix Wash	6	30 (cold-10-20-30-40-60)	1:03	1000 (400-600-800-1000-1200)	2(0-6)
Jeans	5	30 (cold-10-20-30-40)	1:08	1000 (400-600-800-1000-1200)	2(0-6)
Wool	2	Clod (cold-10-20-30-40)	1:04	600 (400-600-800)	2(0-6)
Synthetic	6	30 (cold-10-20-30-40)	1:07	800 (400-600-800-1000)	2(0-6)
Winter Clothes	2	30 (cold-10-20-30-40)	1:31	800 (400-600-800-1000)	3(0-6)
Backpack	3	40 (cold-10-20-30-40)	1:51	800 (400-600-800)	3(0-6)
Quick Wash	1	Clod (cold-10-20-30)	0:16	800 (400-600-800-1000-1200-1400)	1(0-6)
Colors	3	15°C	1:00	600 (400-600-800)	2(0-6)
Under Wear	3	30 (cold-10-20-30-40-60)	1:21	800 (400-600-800-1000)	3(0-6)
Shirt	3	30 (cold-10-20-30-40-60)	1:05	800 (400-600-800-1000)	2(0-6)
Kidswear	4	80°C	2:23	800 (400-600-800-1000-1200-1400)	3(0-6)
Rinse + Spin	6	—	0:21	1000 (400-600-800-1000-1200-1400)	1(0-6)
Spin	6	—	0:12	1000 (400-600-800-1000-1200-1400)	—
Drum Clean	—	80°C	2:19	800	1

*This program was used for energy efficiency testing to the standard. Rinse numbers cannot be adjusted when used on default settings.

PROGRAM INTRODUCTION

User instruction for the normal clothes

Method

1. Preparation
 - Put the clothes in and close the door.
 - Put the detergent or washing powder into the detergent box.
 - Switch on the water tap, put the drain-pipe, plug the power supply.
2. Open the power.
3. Choose the suitable program.
4. Choose the suitable button.
5. Press the "Start/Stop" button.
6. When finishing washing, the buzzer will sound.

Instruction to wool program

Method

- Open the power and choose the wool program.

Attention

- Please confirm the washing mark on the clothes before washing.
- When finishing wash, please take the clothes out immediately for airing in order to avoid clothes deformation.
- The temperature can't be setting more than 40 degree to avoid clothes broken.
- Using the wool detergent can improve the washing performance.
- Make separate washing for light colour clothes and dark colour clothes.

Introduction to backpack wash

Method

- Open the power and choose the backpack program

Attention

- It is only for washing backpack with water.
- Please take off the decoration before washing and bound the belt tightly.
- Please get the backpack for airing immediately after washing.
- Please pull up the zipper and wash the backpack separately with other clothes.

EXTRA OPTIONS AND FUNCTIONS

Program	SOAK	DELAY	QXYGEN FRESH	STAIN	FREE WASH
Cotton Eco	●	●	●		●
Cotton	●	●	●	●	●
Mix Wash	●	●	●	●	●
Jeans	●	●	●	●	●
Wool		●	●		●
Synthetic	●	●	●	●	●
Winter Clothes	●	●	●	●	●
Backpack		●			
Quick Wash		●	●		●
Colors		●	●		●
Under Wear	●	●	●	●	●
Shirt	●	●	●	●	●
Kidswear	●	●	●		●
Rinse + Spin		●	●		
Spin		●	●		●
Drum Clean		●			

Soak

The function is to recommended when washing heavy solied laundry.

Method

Open the power and choose the suitable program and buttons according to user's requirement.

Press SOAK button to select soak function.

Press the start/stop button to start the program.

EXTRA OPTIONS AND FUNCTIONS

Introduction to Delay wash

Method

- Open the power and choose the suitable program and buttons according to user's requirement.
Press the delay button to setting the finishing time.
Press the start/stop button to start-up the delay wash function.
(Delay time has every one hour interval and maximum is 24hours.)

Attention

If need to change the reservation, please press power button and set again.
After reservation, user can cancel it if press power button.
When confirm the delay wash, please press the delay button. The setting time will display for 5 seconds.
Reservation time is different in the different condition. It depends on water pressure, drain, clothes type, water temperature.

Oxygen fresh

This function will keep the laundry loose automatically, prevent wrinkles and odors for 4hrs after program, recommended to select when user can not take out laundry in time.

Method

Open the power and choose the suitable program and buttons according to user's requirement.
Press Oxygen fresh button to select oxygen fresh function.
Press the start/stop button to start the program.

Attention

User can rotate the knob to stand-by position to stop the function and take off the laundry at any time.

Stain

This function is recommend to wash oil, juice, water color, coffee, red wine and other stains, this washer can professional clean 25 kinds of stains.

Method

Open the power and choose the suitable program and buttons according to user's requirement.
Press Stain button to select this function and stain type.
Press the start/stop button to start the program.

Attention

Winter cloth program can not select Oil stain wash, Winter cloth/Jeans program can not select All stain wash, Underwear program can not select Red wine /Coffee stain wash.

Free Wash

This function allow user to adjust the program time as your desire.

Method

Open the power and choose the suitable program and buttons according to user's requirement.
Press Minus/Plus button to increase and reduce the program running time.
Press the start/stop button to start the program.

EXTRA OPTIONS AND FUNCTIONS

ADD-UP FUNCTION

Used this function to add washing when machine is running.

Method

Press "Start/Stop" button till the clock light off. Door lock is released and shows "Add". Please add washing and close the door, press the "Start/stop" button to continue to wash.

Please don't forcibly open the door, it will cause damage to parts and unsafe issue.

When there is a lot of foam or water in the drum, please use a dry towel to prevent foam and water from spilling out after opening the door.

CHILD PROTECTION FUNCTION

If the door is opened again before program running, the machine will start the child protection function automatically when working.

Firstly, the door will be opened and motor will be running for a while. And then, the door will be unlocked for a while till working again. If during the waiting time, the door is opened.

The machine will be stopped.

Cancel the buzzer

There is no buzzer when program finishing working.

Set/Cancel method

Open the power and press "Start/Stop" button till buzzer sound. When release the button, "Cancel the buzzer" function is finished setting. If repeat this action, the setting will be cancelled.

CHILD LOCK FUNCTION

User can set child lock function in order to avoid child operate the machine when it is working. So the door can't be opened and the button except power button can't be handled. When cancel this function, door can be opened again.

Set/Cancel method

Open the power and press "temperature" button for 3 seconds till the buzzer sound. The child lock function is finished to set. If repeat this action, the child lock function will be cancelled.

CLEAN AND MAINTENANCE

- Please maintain the machine after long time using. It can enlarge the life time.
- Please take off the power supply when maintenance.

MACHINE BODY

- Please use soft cloth to clean the body after washing every time. If there is much dirty, please put some detergent or soap water on the cloth to clean the body.
- Please don't use water to flush the machine directly.
- Dirty powder, diluent, petrol and alcohol are forbidden to use to wash the machine.

DOOR GASKET

Please use cloth to clean the gasket after washing every time. If there are brooch or other sundries, please make sure to take them out.

DETERGENT BOX CLEAN

Please clean the detergent box termly. Take out the box and clean it with water.

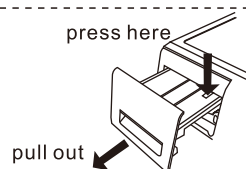

WATER INLET VALVE CLEAN (ONE TIME PER HALF OF YEAR SUGGESTION)

1. Take out the inlet pipe
2. Take out the filter screen
3. Use the toothbrush to clean the filter screen and then assemble it again
4. Connect the inlet pipe after cleaning.



DRUM CLEAN (ONE TIME MONTHLY SUGGESTION)

There may be dirty rest in the drum after long time using. The drum clean function can clean the inner and external drum. (Attention: please don't put in clothes and detergent when using drum clean function.)

CLEAN AND MAINTENANCE

Machine frozen

1. Using hot towel to envelop the water tap and connector
 2. Disassemble the inlet pipe and put it into hot 50 degree hot water.
 3. Put 2-3liter 50 degree hot water into tub.
 4. Assemble the inlet pipe again, open the water tap and start the machine.
- At last, please examine whether the inlet pipe and drain pipe can work normally.

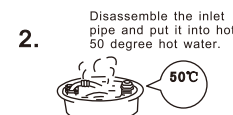
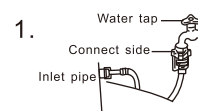

CLEAN FILTER OF PUMP (ONE TIME MONTHLY SUGGESTION)

1. Press the groove of pump. The cover of filter can be opened. (Attention: If there is hot water in the machine, please wait for cooling and then open the filter.)
2. Take out the filter anticlockwise.
3. Wash the filter with water.
4. Assemble the filter into the pump clockwise.

Attention: 1. The filter should be assembled tightly in order to avoid water leakage.
2. Please don't clean the filter when the machine is working.

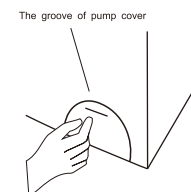

NON-FAILURE CONDITION

Condition	Reason
Door can't be opened	<ul style="list-style-type: none"> Water temperature is too high or power cut. Setting child lock function. The clothes is clamped between door and gasket.
Peculiar smell	<ul style="list-style-type: none"> Because using rubber components, it has rubber smell at the beginning.
Less water for washing and rinsing wash	<ul style="list-style-type: none"> Front load washer only need a little water to
No water	<ul style="list-style-type: none"> Ensure the tap is turning on or not Ensure the water pipe is froze or not Ensure the filter is blockage or not
Halfway inflow the water	<ul style="list-style-type: none"> If the water level drop, the system will automatic filling water
Drainage when the machine is washing	<ul style="list-style-type: none"> too much bubbly detergent
Residual time change	<ul style="list-style-type: none"> washing machine will automatic filling water to keep balance, if the cloths are misdistribution. The rest time is calculated based on 15L/min inflow. So according to different water pressure, time will be enlarged or shorten. washing machine will prolonged dehydration time, if the cloth appear tilt.
Dehydration process has abnormal sound	<ul style="list-style-type: none"> Is power line connect to cabinet? Is the carriage bolts have been removed? Is there a hairpin, coins or other foreign objects fall into drum?
Failure to work after power failure	<ul style="list-style-type: none"> When power cut off, the machine will not revolve. If recover the power, machine still not revolve, please press "power turn on/off" then reset program.
Emergency open door	<ul style="list-style-type: none"> When the power failure for a long time and you want to take out the clothes, unplug the power cord, waiting for the inner drum stop, pull down the emergency rope on the bottom right corner of cabinet, listening a slight noise then you can open the door. (Confirm the water level below the bucket and water temperature below 60℃ in advance.)

TROUBLESHOOTING GUIDE

Fault code	phenomenon	inspection point	solution
No display	out of operation	<ul style="list-style-type: none"> whether the outlet have electricity whether the outlet is plugged in power cut or not leakage protector switch off or not set up booking function or not 	
E11	No water	<ul style="list-style-type: none"> Tap turn on/off? Ensure the water pipe has been frozen or not Ensure the filter has been blockage or not water stopped or not 	Press the Start/ Pause button
E12	undrained	<ul style="list-style-type: none"> ensure the drain pipe in the right place drain height too high or not ensure the drain-pipe has been blockage or not ensure the drain-pipe length 	Press Start/Pause Button
H	Door can't be opened	<ul style="list-style-type: none"> make sure don't use hot water the water temperature is high when washing Suspension of dryiny 	automatic unlocking Until the temperature drops to safety
U3	No dehydration	<ul style="list-style-type: none"> ensure the washer in the right place and steady make sure don't have too much cloths and too big cloths Button,when there have fewer cloths. fewer dehydrated cloths don't rolled up the blanket into the machine. 	add 2 pieces of cloth and Press the Start/pause
U4	Door not closed		close the door, until the "locked" light on, confirm it then press "Start/Pause" to reoperation
Other code	Alarm		Press "Start/Pause" to reoperation. If still can't solve the problem, please contact the service center.