



# Operating Instructions

## Home Theater Audio System

Model No. SC-HTB170



Thank you for purchasing this product.  
Please read these instructions carefully before using this product,  
and save this manual for future use.

### Included Installation Instructions

**The installation work should be done by a qualified installation specialist. (⇒ 10 to 15)**

Before commencing work, carefully read these installation instructions and the operating instructions to ensure that installation is performed correctly.

(Please keep these instructions. You may need them when maintaining or moving this unit.)

Model number suffix “EB” denotes UK model.

EG EB GN

RQT9772-1B

# Safety precautions

## WARNING

### Unit

- To reduce the risk of fire, electric shock or product damage,
  - Do not expose this unit to rain, moisture, dripping or splashing.
  - Do not place objects filled with liquids, such as vases, on this unit.
  - Use only the recommended accessories.
  - Do not remove covers.
  - Do not repair this unit by yourself. Refer servicing to qualified service personnel.

### AC mains lead

- To reduce the risk of fire, electric shock or product damage,
  - Ensure that the power supply voltage corresponds to the voltage printed on this unit.
  - Insert the mains plug fully into the socket outlet.
  - Do not pull, bend, or place heavy items on the lead.
  - Do not handle the plug with wet hands.
  - Hold onto the mains plug body when disconnecting the plug.
  - Do not use a damaged mains plug or socket outlet.
- The mains plug is the disconnecting device. Install this unit so that the mains plug can be unplugged from the socket outlet immediately.

### Button-type battery (Lithium battery)

- Risk of fire, explosion and burns. Do not recharge, disassemble, heat above 60 °C or incinerate.
- Keep the Button-Type battery out of the reach of children. Never put Button-Type battery in mouth. If swallowed call your doctor.

## CAUTION

### Unit

- Do not place sources of naked flames, such as lighted candles, on this unit.
- This unit may receive radio interference caused by mobile telephones during use. If such interference occurs, please increase separation between this unit and the mobile telephone.
- This unit is intended for use in moderate climates.
- Product Identification Marking is located on the bottom of the unit.

### Placement

- Place this unit on an even surface.
- To reduce the risk of fire, electric shock or product damage,
  - Do not install or place this unit in a bookcase, built-in cabinet or in another confined space. Ensure this unit is well ventilated.
  - Do not obstruct this unit's ventilation openings with newspapers, tablecloths, curtains, and similar items.
  - Do not expose this unit to direct sunlight, high temperatures, high humidity, and excessive vibration.

### Button-type battery (Lithium battery)

- Danger of explosion if battery is incorrectly replaced. Replace only with the type recommended by the manufacturer.
- Insert with poles aligned.
- Mishandling of batteries can cause electrolyte leakage and may cause a fire.
  - Remove the battery if you do not intend to use the remote control for a long period of time. Store in a cool, dark place.
  - Do not heat or expose to flame.
  - Do not leave the battery(ies) in a car exposed to direct sunlight for a long period of time with doors and windows closed.
- When disposing the batteries, please contact your local authorities or dealer and ask for the correct method of disposal.

## Caution for AC Mains Lead



### (For the AC mains plug of three pins)

For your safety, please read the following text carefully.

This appliance is supplied with a moulded three pin mains plug for your safety and convenience.

A 5-ampere fuse is fitted in this plug.

Should the fuse need to be replaced please ensure that the replacement fuse has a rating of 5-ampere and that it is approved by ASTA or BSI to BS1362.

Check for the ASTA mark  or the BSI mark  on the body of the fuse.

If the plug contains a removable fuse cover you must ensure that it is refitted when the fuse is replaced.

If you lose the fuse cover the plug must not be used until a replacement cover is obtained.

A replacement fuse cover can be purchased from your local dealer.

#### Before use

Remove the connector cover.

#### How to replace the fuse

The location of the fuse differ according to the type of AC mains plug (figures A and B). Confirm the AC mains plug fitted and follow the instructions below. Illustrations may differ from actual AC mains plug.

1. Open the fuse cover with a screwdriver.

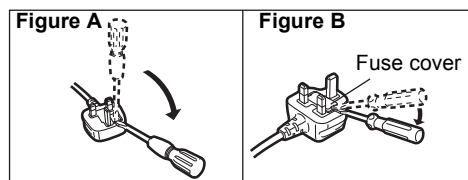

2. Replace the fuse and close or attach the fuse cover.

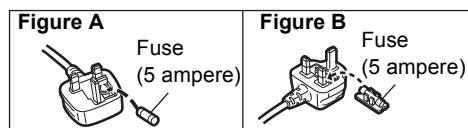

## About Bluetooth®

Panasonic bears no responsibility for data and/or information that is compromised during a wireless transmission.

### ■ Frequency band used

This system uses the 2.4 GHz frequency band.

### ■ Certification of this device

- This system conforms to frequency restrictions and has received certification based on frequency laws. Thus, a wireless permit is not necessary.
- The action below are punishable by law in some countries:
  - Taking apart or modifying the unit.
  - Removing specification indications.

### ■ Restrictions of use

- Wireless transmission and/or usage with all Bluetooth® equipped devices is not guaranteed.
- All devices must conform to standards set by Bluetooth SIG, Inc.
- Depending on the specifications and settings of a device, it can fail to connect or some operations can be different.
- This system supports Bluetooth® security features. But depending on the operating environment and/or settings, this security is possibly not sufficient. Transmit data wirelessly to this system with caution.
- This system cannot transmit data to a Bluetooth® device.

### ■ Range of use

Use this device at a maximum range of 10 m.

The range can decrease depending on the environment, obstacles or interference.

### ■ Interference from other devices

- This system may not function properly and troubles such as noise and sound jumps may arise due to radio wave interference if the main unit is located too close to other Bluetooth® devices or the devices that use the 2.4 GHz band.
- This system may not function properly if radio waves from a nearby broadcasting station, etc. are too strong.

### ■ Intended usage

- This system is for normal, general use only.
- Do not use this system near equipment or in an environment that is sensitive to radio frequency interference (example: airports, hospitals, laboratories, etc.).

# Table of contents

Safety precautions .....	2
Caution for AC Mains Lead .....	3
About Bluetooth® .....	3

## Before use

---

Supplied items .....	5
This system (SC-HTB170) .....	5
Accessories .....	5
Control reference guide .....	6
This system (Front) .....	6
This system (Rear) .....	7
Remote control .....	8

## Getting started

---

Step 1 Selecting the placement method .....	9
The main unit .....	9
Wireless interference .....	10
Step 2 Placement .....	11
When placing the main unit in a rack or on a table .....	11
When attaching the main unit to a wall .....	13
Step 3 Connections .....	16
Connection with the TV .....	16
Connection from an HDMI compatible device .....	17
Using the IR Blaster .....	18
AC mains lead connection .....	19
Bluetooth® connection .....	19

## Operations

---

Using this system .....	20
3D sound .....	21
Sound modes .....	21
Linked operations with the TV (VIERA Link “HDAVI Control™”) .....	22
Advanced operations .....	23

## Reference

---

Troubleshooting .....	26
Indicator illumination .....	29
Specifications .....	30
Unit care .....	31
Licenses .....	31
Limited Warranty (ONLY FOR AUSTRALIA) .....	35



- The illustrations shown may differ from your unit.
- These operation instructions are applicable to model SC-HTB170 for variety of regions. Unless otherwise indicated, illustrations in these operating instructions are of the model for the United Kingdom and Ireland.
- Operations in this operating instructions are described mainly with the remote control, but you can perform the operations on the main unit if the controls are the same.

## Supplied items





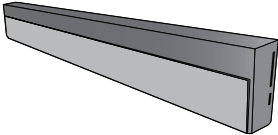



### This system (SC-HTB170)

☐
**1 Main unit (speaker)**  
 (SC-HTB170)

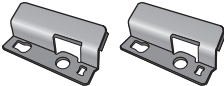

### Accessories

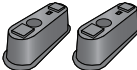
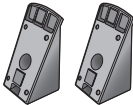
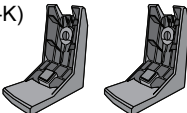
Check the supplied accessories before using this system.

<input type="checkbox"/> <b>1 Remote control (with a battery)</b> (N2QAYC000083) 	<input type="checkbox"/> <b>1 IR Blaster</b> (K2ZZ02C00007) 	
<input type="checkbox"/> <b>1 AC mains leads</b> For the United Kingdom and Ireland (K2CT2YY00097) 	For continental Europe (K2CQ2YY00119) 	For Australia and New Zealand (K2CJ2YY00093) 
<input type="checkbox"/> <b>2 Safety holders</b> (RXA0260) 	<input type="checkbox"/> <b>2 Wall mount brackets</b> (RMQX1082-K) 	<input type="checkbox"/> <b>2 Basic stands</b> (RYQ1165-K) 
<input type="checkbox"/> <b>2 30° stands</b> (RYQ1166-K) 	<input type="checkbox"/> <b>2 80° stands</b> (RYQ1167-K) 	<input type="checkbox"/> <b>4 Screws</b> (with washer×2: XYN5+J14FJK) (without washer×2: XSN4+8FJK) 



- Product numbers are correct as of December 2012. These may be subject to change.
- The supplied AC mains lead is for use with this system only. Do not use it with other equipment. Also, do not use cords from other equipment with this system.

# Control reference guide

## This system (Front)

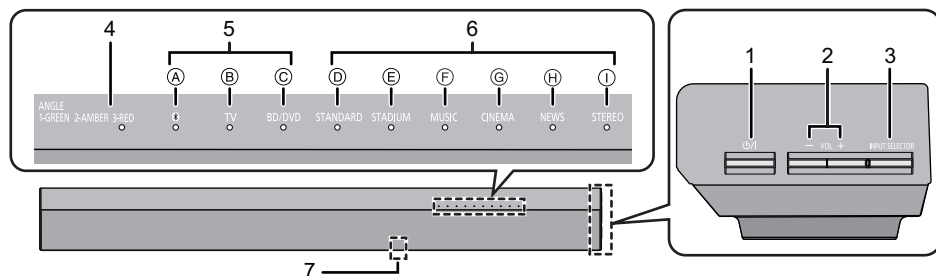

- 1 **Standby/on switch (⏻/⏻)**  
Press to switch the unit from on to standby mode or vice versa. In standby mode, the unit is still consuming a small amount of power.
- 2 Adjust the volume of this system
- 3 Select the input source  
"TV" → "BD/DVD"  
↑ " " ↓
- 4 Speaker angle indicator (⇒ 9)  
Angle 1: 0° tilt  
Speaker angle indicator lights green  
Angle 2: Tilted at 30°  
Speaker angle indicator lights amber  
Angle 3: Tilted at 80°/90°  
Speaker angle indicator lights red
- 5 Input selector indicators\*1
  - (A) Bluetooth® indicator  
Lights blue when the Bluetooth® device is the audio source
  - (B) TV indicator  
Lights green when the TV is the audio source
  - (C) BD/DVD indicator  
Lights amber when the device connected to the BD/DVD terminal is the audio source
- 6 Sound mode indicators\*1
  - (D) STANDARD indicator  
Lights when STANDARD is the current sound mode
  - (E) STADIUM indicator\*2  
Lights when STADIUM is the current sound mode
  - (F) MUSIC indicator\*2  
Lights when MUSIC is the current sound mode
  - (G) CINEMA indicator  
Lights when CINEMA is the current sound mode
  - (H) NEWS indicator  
Lights when NEWS is the current sound mode
  - (I) STEREO indicator  
Lights when STEREO is the current sound mode
- 7 Remote control signal sensor (⇒ 8)

## This system (Rear)

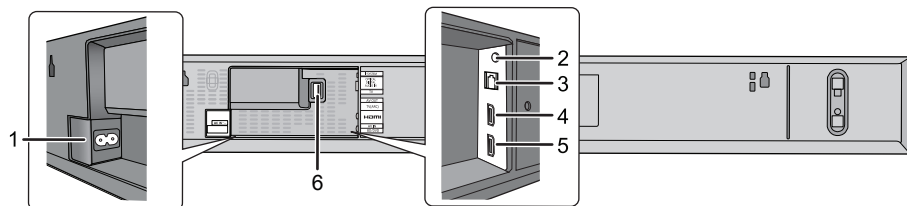

- |  |  |
|--|--|
| 1 AC IN terminal (⇒ 19)                            | 4 HDMI OUT terminal (ARC compatible)<br>(⇒ 16) |
| 2 Ir SYSTEM terminal (⇒ 18)                        | 5 HDMI IN terminal (⇒ 17)                      |
| 3 OPTICAL DIGITAL AUDIO IN (TV) terminal<br>(⇒ 16) | 6 USB port (for service use only)              |

\*1 The indicators will also blink in various conditions. (⇒ 29)

\*2 The indicator blinks for 5 sec when the main unit detects an audio format.

To manually verify the current audio format and the corresponding indicators, refer to page 23 (Audio format indicator).

## Remote control

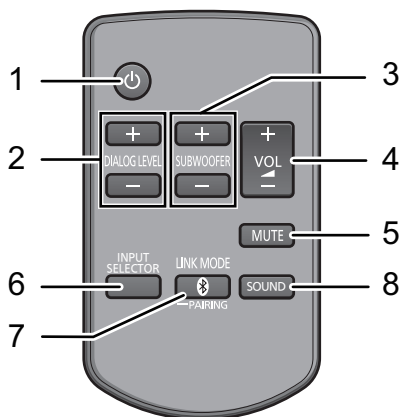

- 1 Turn the main unit on or off (⇒ 20)
- 2 Adjust the dialog effect level (⇒ 20)
- 3 Adjust the output level of the subwoofer (bass sound) (⇒ 20)
- 4 Adjust the volume of this system (⇒ 20)
- 5 Mute the sound (⇒ 20)
- 6 Select the input source (⇒ 20)  
 "TV" → "BD/DVD"  
 ↑ "Bluetooth" ↓
- 7 Select the Bluetooth® device as the source (⇒ 20)
- 8 Select the sound mode (⇒ 21)  
 "STANDARD" → "STADIUM" → "MUSIC"  
 ↑ "STEREO" ← "NEWS" ← "CINEMA" ↓

### Remote control operation range

The remote control signal sensor is located on the main unit.

- Use the remote control within the correct operation range.

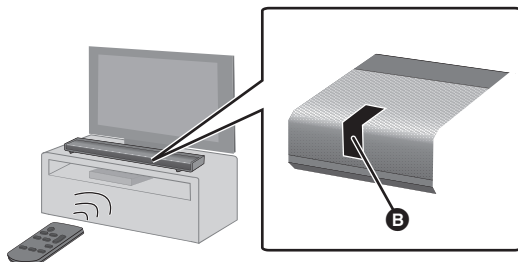

#### B Remote control signal sensor

##### • Operation range

Distance: Within approx. 7 m directly in front

Angle: Approx. 30° left and right

### Before using for the first time

Remove the insulation sheet **A**.

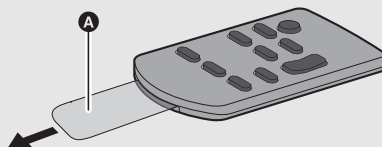

### To replace a button-type battery

Battery type: CR2025 (Lithium battery)

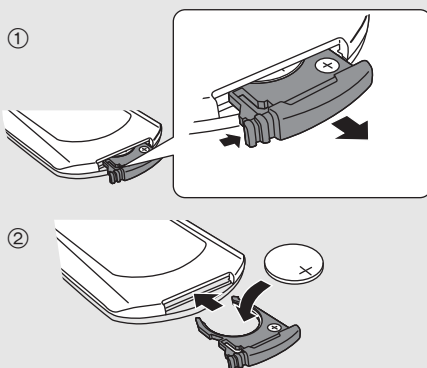

- Set the button-type battery with its (+) mark facing upward.
- Keep the button-type battery out of reach of children to prevent swallowing.

# Step 1 Selecting the placement method

- Choose a placement method that suits you best.

## The main unit

### When placing the main unit in a rack or on a table

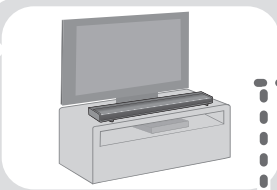

**Angle 1: 0° tilt**  
•Speaker angle indicator lights **green**.

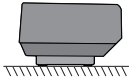

**A Raised by using the basic stands**



Page 11

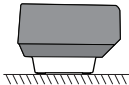

**Angle 2: Tilted at 30°**  
•Speaker angle indicator lights **amber**.

**B Tilted by using 30° stands**



Page 11

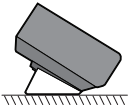

**Angle 3: Tilted at 80°**  
•Speaker angle indicator lights **red**.

**C Tilted by using 80° stands**



Page 11

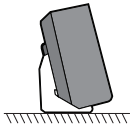

### When attaching the main unit to a wall

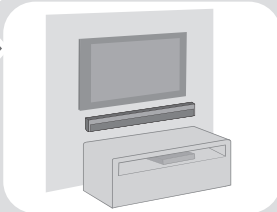

**Angle 3: Tilted at 90°**  
•Speaker angle indicator lights **red**.

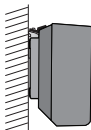

Page 13

Before use

Getting started

## Safety Precautions

### Professional installation is required.

**The installation should never be done by any other than a qualified installation specialist. PANASONIC DISCLAIMS ANY PROPERTY DAMAGE AND/OR SERIOUS INJURY, INCLUDING DEATH RESULTING FROM IMPROPER INSTALLATION OR INCORRECT HANDLING.**

- Be sure to install the main unit as indicated within this operating Instructions.
- Attach using techniques suited to the structure and materials of the installation location.

### Caution

- This system is to be used only as indicated in these instructions. Failure to do so may lead to damage to the amplifier and/or the speaker, and may result in the risk of fire. Consult a qualified service person if damage has occurred or if you experience a sudden change in performance.
- Do not attempt to attach the main unit to a wall using methods other than those described in this manual.



- Keep the safety holders, screws and wall mount brackets out of reach of children to prevent swallowing.
- The safety holder is to minimize the possibility of damage and harm, but it does not completely guarantee this effect.
- Do not hold the main unit in one hand to avoid injury, you may drop the main unit when carrying it.
- To prevent damage or scratches, lay down a soft cloth and perform the assembly on it.

### ■ When placing the main unit in front of the TV

The main unit may block or interfere with the TV's various sensors (C.A.T.S. (Contrast Automatic Tracking System) sensor, remote control sensor, etc.) and the 3D Eyewear transmitters on a 3D compatible TV.

- If interference occurs, use a lower angle stand or place the main unit without a stand or move the main unit further away from the TV. If the TV still does not function correctly, try using it in a rack or in the wall mount position.

### ■ If the TV's remote control sensor is blocked by the main unit

Try using the TV's remote control from a different angle. If the problem persists, you can use the supplied IR Blaster to relay the signal to the TV. (⇒ 18)

- Do not use the IR Blaster if the TV's remote control sensor is not blocked by the main unit.

## Wireless interference

**To avoid interference, maintain the following distances between the main unit and other electronic devices that use the same radio frequency (2.4 GHz band).**

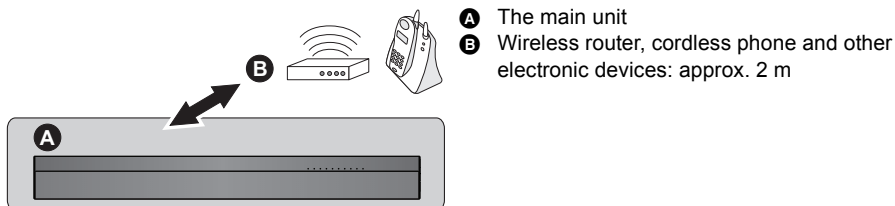

- Do not use the main unit in a metal cabinet.
- If irregular colouring occurs on your TV, turn the TV off for about 30 minutes. If it persists, move the main unit further away from the TV.
- Keep magnetised items away. Magnetised cards, watches, etc., can be damaged if placed too close to the main unit.

## Step 2 Placement



### When placing the main unit in a rack or on a table

- Place the main unit on a flat and horizontal surface.

### Supplied accessories

☐ 2 Basic stands

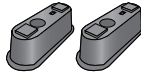

☐ 2 30° stands

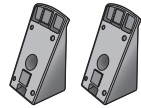

☐ 2 80° stands

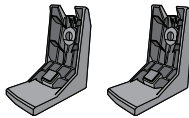

☐ 2 Screws with washer



### Additionally required accessories (commercially available)

- Fall prevention cord ..... × 2
- Screw eyes (to attach the fall prevention cord)..... × 2



- Use commercially available screws that are capable of supporting over 33 kg.
- Use a cord that is capable of supporting over 33 kg (with a diameter of about 1.5 mm).

### 1 Attach the cord to the main unit.

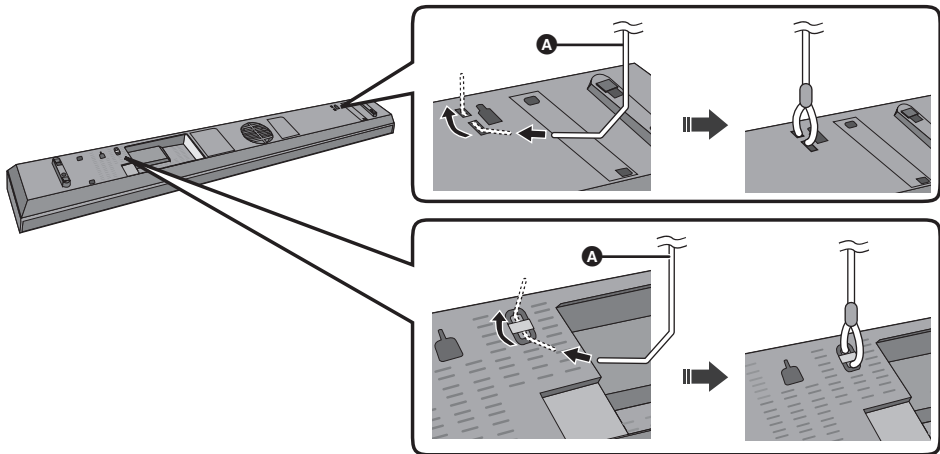

**A** Cord\*

\* If the cord cannot be threaded through the holes, try bending the cord in 2 locations, about 5 mm apart from the tip, at an angle of 45° (as illustrated above).

## 2 Attach the stands if necessary. If not, proceed to step 3.

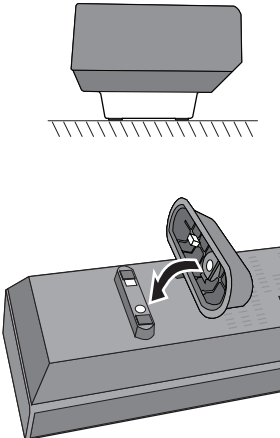
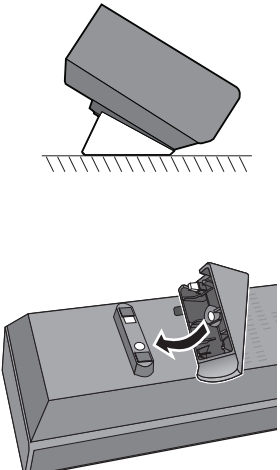
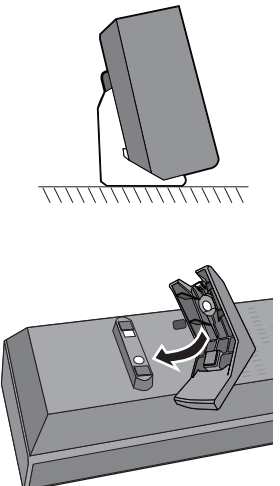
<b>A</b> : With basic stands	<b>B</b> : With 30° stands	<b>C</b> : With 80° stands
		

e.g., With basic stands

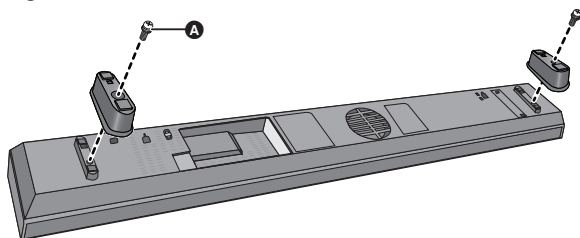

- A** Screw (supplied)
- Tighten securely.

## 3 Place the main unit in the desired position and attach each cord onto the rack or table.

- Make sure that the slack of the cord is minimal.

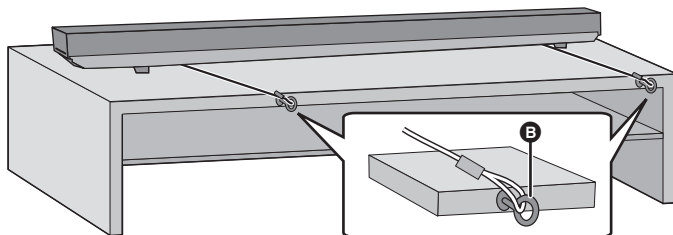

- B** Screw eye
- Attach at a position capable of supporting over 33 kg.
  - Depending on the placement of the main unit, the screwing position of the screw eye may differ.





## When attaching the main unit to a wall

- Place the main unit on a flat and vertical surface.

This unit can be wall mounted using the supplied wall mount brackets, etc. Make sure that the screw used and the wall are strong enough to support the weight of at least 33 kg.

The screws and other items are not supplied as the type and size will vary with each installation.

- Refer to step 2 for details about the required screws.
- Be sure to attach the fall prevention cord as a secondary safety measure.

## Supplied accessories

☐ 2 Safety holders

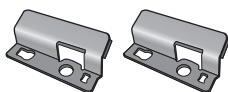

☐ 2 Wall mount brackets



☐ 2 Screws without washer



## Additionally required accessories (commercially available)

- Screws for wall mounting..... × 4
- Fall prevention cord..... × 2
- Screw eyes (to attach the fall prevention cord)..... × 2



- Use a cord that is capable of supporting over 33 kg (with a diameter of about 1.5 mm).

## 1 Locate the screwing positions on the wall.

- Use the measurements indicated below to identify the screwing positions on the wall.
- Leave at least 100 mm of space above of the main unit to allow enough space for fitting the main unit.
- Position the main unit with at least 50 mm of free space to its right. If not, it may not be possible to access the buttons.
- Be sure to use a level to ensure that both screwing positions are horizontal to each other.

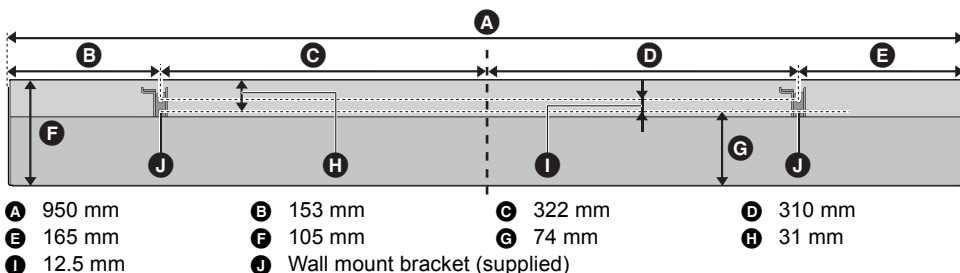

## 2 Attach the wall mount brackets to the wall.

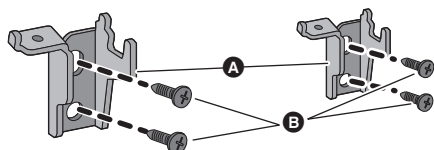

**A** Wall mount bracket (supplied)

**B** Screws

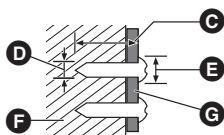

**C** At least 30 mm

**D**  $\varnothing 4.0$  mm

**E**  $\varnothing 7.5$  mm to  $\varnothing 9.4$  mm

**F** Wall

**G** Wall mount bracket (supplied)

## 3 Complete all the necessary connections to the main unit. (⇒ 16 to 19)

- Connect the AC mains lead cord to the main unit, but do not connect it to the household mains socket until the installation is completed.

## 4 Attach the cord to the main unit.

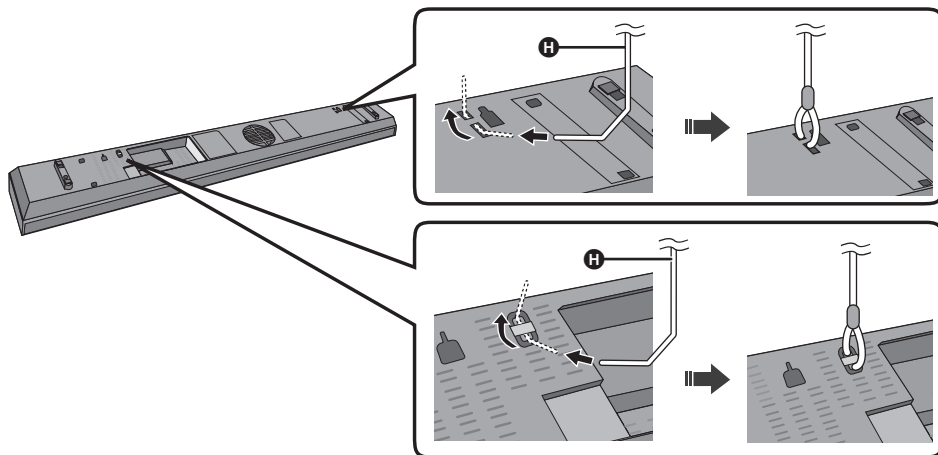

**H** Cord\*

- \* If the cord cannot be threaded through the holes, try bending the cord in 2 locations, about 5 mm apart from the tip, at an angle of  $45^\circ$  (as illustrated above).

## 5 Attach the main unit to the wall mount brackets.

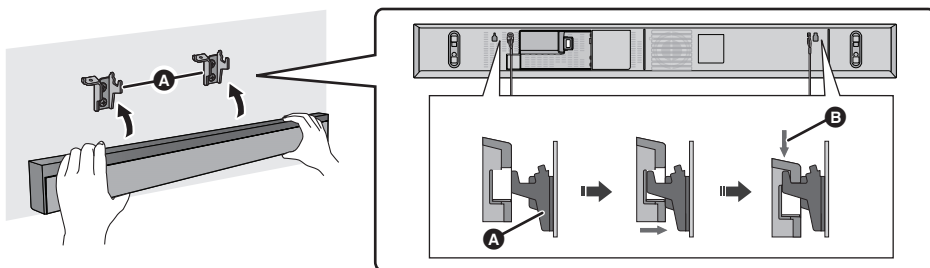

- A** Wall mount bracket (supplied)
- B** Gently move the main unit down onto the wall mount bracket.

## 6 Screw the safety holder onto the wall mount brackets.

- Screw tightening torque: 80 N•cm to 120 N•cm.
- The safety holders are designed to prevent the main unit from falling off the wall mount bracket.

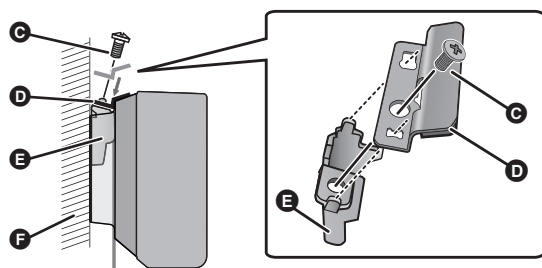

- C** Screw without washer (supplied)
- D** Safety holder (supplied)
- E** Wall mount bracket (supplied)

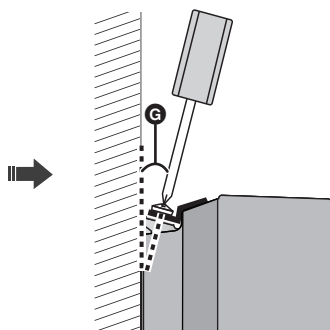

- F** Wall
- G** About 15°
- Tilt about 15° from the wall and tighten the screw.

## 7 Secure the cord to the wall.

- Make sure that the slack of the cord is minimal.

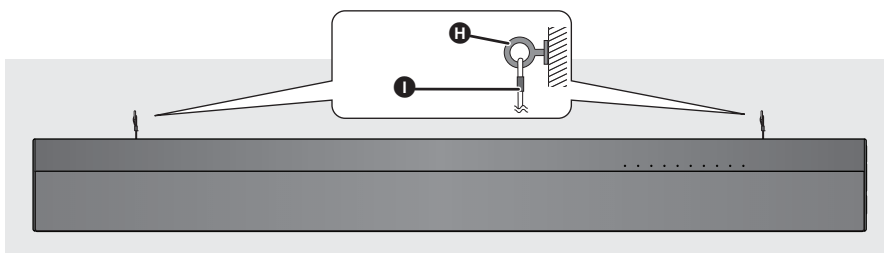

- H** Screw eye
- I** Cord

## Step 3 Connections

• Turn off all equipment before connection and read the appropriate operating instructions.

**Do not connect the AC mains lead until all other connections are completed.**

### ■ HDMI

- The HDMI connection supports VIERA Link "HDAVI Control" (⇒ 22) when used with a compatible Panasonic TV.
- Use the ARC compatible High Speed HDMI Cables. Non-HDMI-compliant cables cannot be utilised.
- It is recommended that you use Panasonic's HDMI cable.

### Connection with the TV

#### 1 Verify if the TV's HDMI terminal is labelled "HDMI (ARC)".

Connection differs depending on the label printed next to the HDMI terminal.

**Labelled "HDMI (ARC)": Connection A**

**Not Labelled "HDMI (ARC)": Connection B**

#### ■ What is ARC?

ARC is an abbreviation of Audio Return Channel, also known as HDMI ARC. It refers to one of the HDMI functions. When you connect the main unit to the terminal labelled "HDMI (ARC)" on the TV, the optical digital audio cable that is usually required in order to listen to sound from a TV is no longer required, and TV pictures and sound can be enjoyed with a single HDMI cable.

#### 2 Make the connection.

##### A Labelled "HDMI (ARC)"

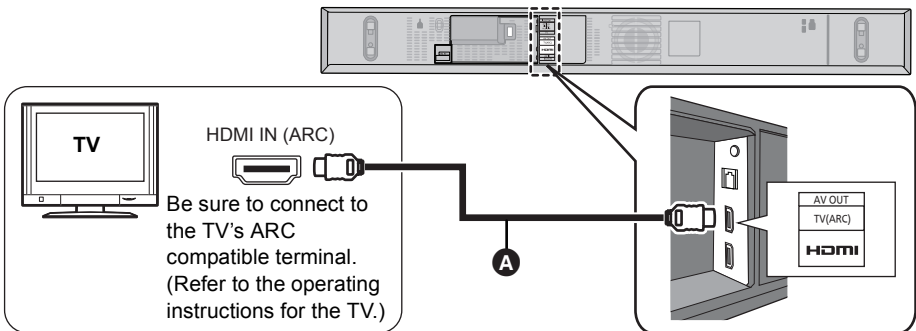

#### A HDMI cable

##### B Not labelled "HDMI (ARC)"

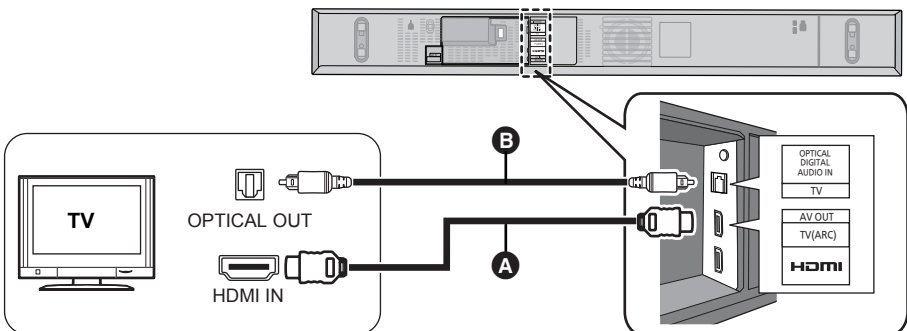

#### A HDMI cable

#### B Optical digital audio cable

- When you use the optical digital audio cable, insert the tip correctly into the terminal.

## Connection from an HDMI compatible device

You can direct the audio signal from the connected Blu-ray Disc player, DVD player, Set Top Box, etc. to this system.

### Preparation

- Connect the main unit to the TV. (⇒ 16)

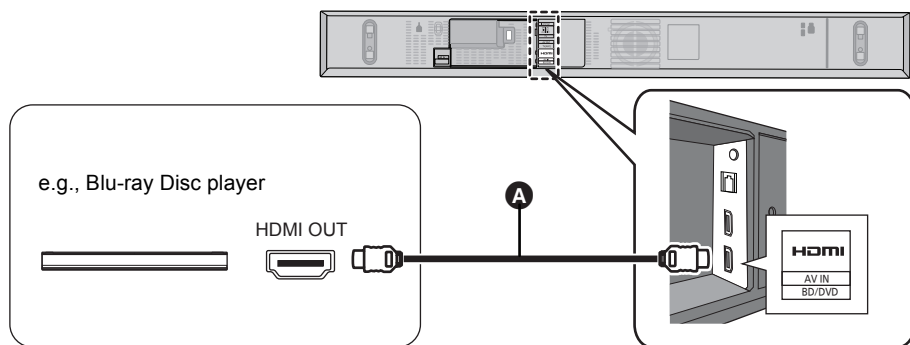

#### A HDMI cable

### ■ HDMI standby pass-through

Even if the main unit is in standby mode, the audio and/or video signal from the device connected to the HDMI IN terminal will be sent to the TV connected to the HDMI OUT terminal (the sound will not be output from this system).

### ■ 3D compatibility

Compatible with FULL HD 3D TV and Blu-ray Disc player.

- The main unit can pass-through the 3D video signal from a 3D compatible Blu-ray Disc player to a FULL HD 3D TV.



- Refer to the operating instructions of the connected HDMI compatible device for the necessary setting, to output the video and audio signals.

## Using the IR Blaster

With the IR Blaster connection, it is possible to send the IR signal received by this system's remote control signal sensor to the TV's sensor.

**Use the TV's remote control within the operation range of this system's remote control signal sensor.**

- For the operation range, refer to page 8.

### 1 Connect the jack plug to the main unit's Ir SYSTEM terminal.

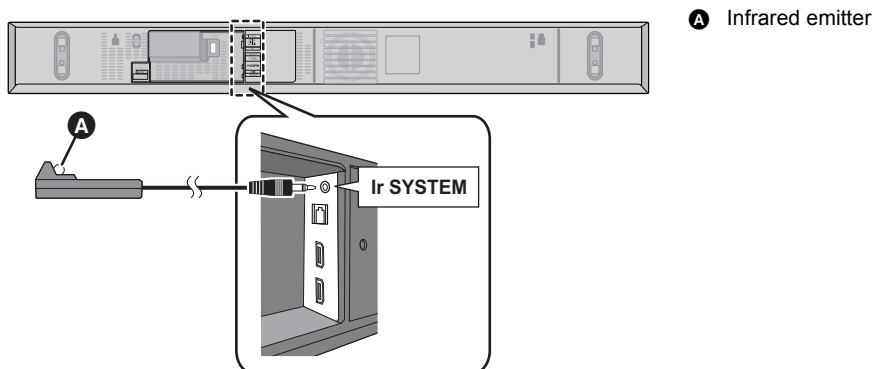

### 2 Place the infrared emitter in sight of the TV's remote control signal sensor.

- For the location of the TV's remote control signal sensor, refer to the operating instructions for the TV.

### 3 Aim the TV's remote control at this system's remote control sensor and operate the TV.

- For the location of this system's remote control signal sensor, refer to page 6.
- Make sure to clean the surface, where the adhesive tape is to be attached.
- If you peel off the adhesive tape, the surface may become damaged and exposed adhesive may remain. Once you have confirmed the TV is operating correctly, secure it by attaching the adhesive tape.



- The supplied IR Blaster is only compatible with Panasonic TVs.
- Keep the adhesive tape out of reach of children to prevent swallowing.

## ■ Placement example

On the rear of the main unit:

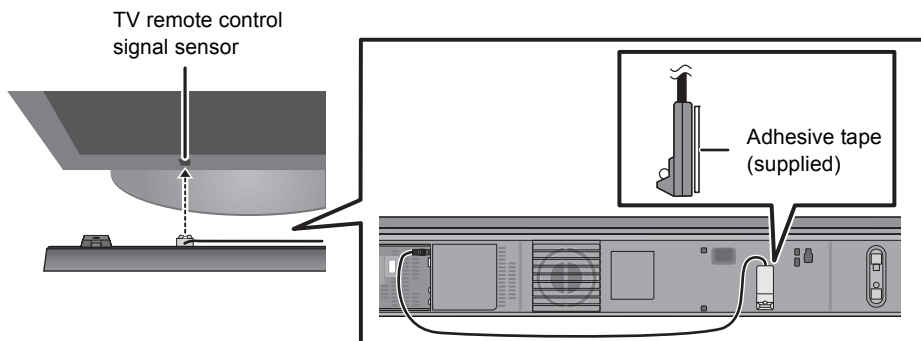

## AC mains lead connection

- Connect only after all other connections are completed.

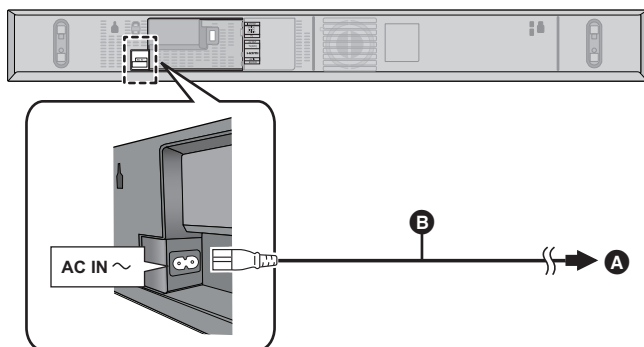

- A** To a household mains socket
- B** AC mains lead (supplied)

- This system consumes a small amount of AC power (⇒ 30) even when it is turned off. In the interest of power conservation, if you will not be using this system for a long time, unplug it from the household mains socket.

### For customers in United Kingdom and Ireland

BE SURE TO READ THE CAUTION FOR THE AC MAINS LEAD ON PAGE 3 BEFORE CONNECTION.

#### Saving energy

The main unit is designed to conserve its power consumption and save energy.

- The main unit will automatically switch to standby mode when no signal is input and no operation is performed for approx. 2 hours. Refer to page 24, “Auto standby function” to turn this function off.

## Bluetooth® connection

By using the Bluetooth® connection, you can listen to the sound from the Bluetooth® audio device from this system wirelessly.

### Preparation

- Turn on the Bluetooth® feature of the device and place the device near the main unit.

### Bluetooth® pairing

#### 1 Press [⌂] to select “⌂”.

- If the “⌂” indicator flashes quickly, go to step 3.

#### 2 Press and hold [⌂] until the “⌂” indicator flashes quickly.

- If the “⌂” indicator flashes slowly, repeat step 2.

#### 3 Select “SC-HTB170” from the Bluetooth® device’s Bluetooth® menu.

- If prompted for the passkey on the Bluetooth® device, enter “0000”.
- Once the Bluetooth® device is connected, the “⌂” indicator stops flashing and lights up.



- You can register up to 8 devices with this system. If a 9th device is paired, the device that has not been used for the longest time will be replaced.

## Connecting a Bluetooth® device

#### 1 Press [⌂] to select “⌂”.

- If the “⌂” indicator lights, a Bluetooth® device is already connected with this system. Disconnect it. (⇒ below)

#### 2 Select “SC-HTB170” from the Bluetooth® device’s Bluetooth® menu.

### ■ Disconnecting a Bluetooth® device

Press and hold [⌂] until the “⌂” indicator flashes slowly.



- When “⌂” is selected as the source, this system will automatically try and connect to the last connected Bluetooth® device.
- The Bluetooth® device will be disconnected if a different audio source (e.g. “TV”) is selected.
- Refer to the operating instructions of the Bluetooth® device for further instruction on how to connect a Bluetooth® device.
- This system can only be connected to one device at a time.
- To change the sound quality, refer to “Bluetooth® communication mode” on page 23.

# Using this system

## Preparation

- Turn on the TV and/or connected device.

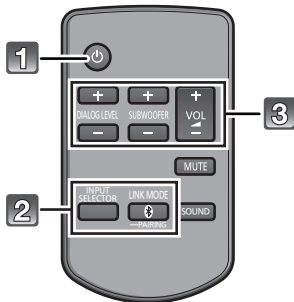

**1** Press [⏻] to turn on the main unit.

**2** Select the source.

Press	To select
[INPUT SELECTOR]	<div> <div>TV</div> <div>BD/DVD</div> </div>
[⌵]	<div> <div>Bluetooth</div> </div>

- This remote control cannot be used to control the operations of the connected devices.

### ■ When “Bluetooth” is selected as the source

On the Bluetooth® device:

Select this system as the output source of the connected Bluetooth® device and start the playback.

### ■ When “BD/DVD” is selected as the source

On the TV and the connected device:

Select the TV's input for this system and start the playback on the connected device.

## 3 Adjust the volume and sound effect level.

### ■ To adjust the volume of this system

Press [+ VOL -].

- Volume range: 0 to 100\*

### ■ To adjust the dialog effect level

This setting will change the level of the Clear-mode dialog effect. (⇒ 21)

- 1 Press [+ DIALOG LEVEL -] to display the current level.
- 2 While the level is displayed:  
Press [+ DIALOG LEVEL -] to adjust the level.

Indication	Effect level
<div> <div>STADIUM</div> <div>MUSIC</div> <div>CINEMA</div> <div>NEWS</div> </div>	4 Highest
<div> <div>STADIUM</div> <div>MUSIC</div> <div>CINEMA</div> <div>NEWS</div> </div>	3
<div> <div>STADIUM</div> <div>MUSIC</div> <div>CINEMA</div> <div>NEWS</div> </div>	2
<div> <div>STADIUM</div> <div>MUSIC</div> <div>CINEMA</div> <div>NEWS</div> </div>	1 Lowest

### ■ To adjust the subwoofer level

- 1 Press [+ SUBWOOFER -] to display the current level.
- 2 While the level is displayed:  
Press [+ SUBWOOFER -] to adjust the level.

- The level indication pattern is the same as dialog effect level.

### ■ To mute the sound

Press [MUTE].

- While muting, the sound mode indicators blink simultaneously.
- To cancel, press the button again or adjust the volume.
- Muting is cancelled if the main unit is turned off.



**If this system does not operate as expected or sound is unusual, returning the settings to the factory preset may solve the problem. (⇒ 26)**

- \* The sound mode indicators blink from left to right (+) or from right to left (-) while adjusting. The indicators will not blink when it has reached the maximum or minimum.
- If there is sound coming out of the TV's speakers, reduce the volume of the TV to its minimum.
- If the main unit is turned off with the volume setting in the greater half (above 50), the main unit will automatically lower the volume to the middle (50) when the main unit is turned on (Volume limitation).  
To turn this function off, refer to page 25.



# 3D sound

This system provides a feeling that the sound and the image are as one.

- To change the applied effect, refer to "Sound modes". (⇒ right)

e.g., Image of 3D sound field

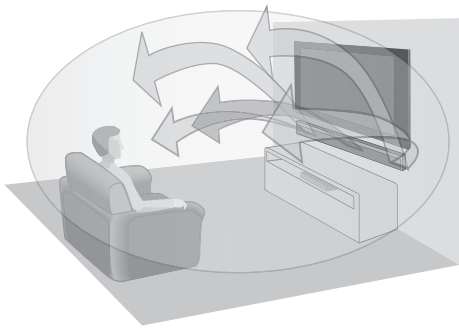

3D sound	
Dolby®Virtual Speaker	With this effect you can enjoy a surround sound effect similar to 5.1ch.
3D surround effect	Adding to the Dolby Virtual Speaker effect, Panasonic has applied its own sound field controlling technology to expand the sound field forwards, backwards, upwards, and downwards, providing a sound with depth and force that better matches 3D images.
Clear-mode dialog	Sports commentary and dialogs from TV dramas are heard as if the sound is coming from the TV, giving the feeling that the sound and the image are one. Also, the dialog will stand out from the other sounds during normal volume playback and when the volume is lowered for night time viewing.



- To turn off Dolby Virtual Speaker and the 3D surround effects, select "STEREO" as the sound mode. (⇒ right)
- To turn off the 3D surround and the Clear-mode dialog effects, refer to "Using the Dolby Virtual Speaker effect". (⇒ 24)

## Sound modes

By changing the sound mode, it is possible to enjoy the sound that is suitable to the TV program or image from the connected device.

### To select the sound mode

Press [SOUND].

"STANDARD" → "STADIUM" → "MUSIC"  
↑ "STEREO" ← "NEWS" ← "CINEMA" ←

- The indicator for the selected sound mode lights.

e.g., "STEREO"

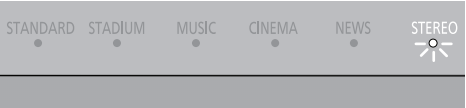

Sound mode	
"STANDARD"	Produces a sound best suited for dramas and comedy shows.
"STADIUM"	Produces a highly realistic sound for live broadcasts of sports.
"MUSIC"	Re-creates the sound of musical instruments and songs with an expansive sound.
"CINEMA"	Produces a powerful, three-dimensional sound unique to movies.
"NEWS"	Enhances the voices of news and sports commentaries for clearer hearing.
"STEREO" (Factory preset)	You can play any source in stereo. Dolby Virtual Speaker and 3D surround effects are turned off.



The setting is maintained until it is changed again.

# Linked operations with the TV (VIERA Link “HDAVI Control™”)

## What is VIERA Link “HDAVI Control”?

VIERA Link “HDAVI Control” is a convenient function that offers linked operations of this system, and a Panasonic TV (VIERA) under “HDAVI Control”.

You can use this function by connecting the equipment with an HDMI cable. See the operating instructions for connected equipment for operational details.

## Preparation

- ① Confirm that the HDMI connection has been made. (⇒ 16, 17)
- ② Set the “HDAVI Control” operations on the connected equipment (e.g., TV).
- ③ For the optimal “HDAVI Control” operations change the following settings on the connected TV\*<sup>1</sup>.
  - Set the default speaker settings to this system.\*<sup>2</sup>
  - Set the speaker selection settings to this system.
- ④ Turn on all “HDAVI Control” compatible equipment and select the TV’s input for this system so that the “HDAVI Control” function works properly.
- ⑤ If a device is connected to the HDMI IN terminal, start play to check that the picture is displayed on the TV correctly.

**When the connection or settings are changed, repeat this procedure.**

\*<sup>1</sup> The availability and function of the settings may vary depending on the TV. Refer to the operating instructions for the TV for details.

\*<sup>2</sup> If the TV has a default speaker setting within the VIERA Link setting items, choosing this system as the default speaker will automatically change the speaker selection to this system.



- VIERA Link “HDAVI Control”, based on the control functions provided by HDMI which is an industry standard known as HDMI CEC (Consumer Electronics Control), is a unique function that we have developed and added. As such, its operation with other manufacturers’ equipment that supports HDMI CEC cannot be guaranteed.
- This unit supports “HDAVI Control 5” function. “HDAVI Control 5” is the standard for Panasonic’s HDAVI Control compatible equipment. This standard is compatible with Panasonic’s conventional HDAVI equipment.
- Please refer to individual manuals for other manufacturers’ equipment supporting VIERA Link function.

## What you can do with VIERA Link “HDAVI Control”

To make sure that the audio is output from this system, turn the main unit on by using the TV’s remote control and selecting home cinema from the speaker menu of VIERA Link menu. The availability and function of the settings may vary depending on the TV. Refer to the operating instructions for the TV for details.

### ■ Speaker control

You can select whether audio output is from this system or the TV speakers by using the TV menu settings.

#### Home cinema

This system is active.

- When the main unit is in standby mode, changing the TV speakers to this system in the VIERA Link menu will automatically turn the main unit on.
- You can control the volume setting of this system using the volume or mute button on the TV remote control.
- If you turn off the main unit, TV speakers will be automatically activated.
- Audio will automatically be output from this system if the TV is compatible to VIERA Link “HDAVI Control 4” or later.

#### TV

TV speakers are active.

- The volume of this system is set to its minimum.

### ■ Automatic input switching

When the following operations are performed, the main unit will automatically change the input to the corresponding source.

- When play starts on an HDMI connected device.\*<sup>3</sup>
- When the TV input or the TV channel is changed.

\*<sup>3</sup> If the speaker output setting on the TV is set to this system, the TV and the main unit turn on automatically (Power on link).

### ■ Power off link

When the TV is turned off, the main unit also turns off automatically. (This function does not work when Bluetooth® is the source.)

### ■ Automatic lip-sync function

(for HDAVI Control 3 or later)

Delay between audio and video is automatically adjusted by adding time-lag to the audio output, enabling you to enjoy smooth audio for the picture.



The delay information is automatically set if the TV is compatible to VIERA Link “HDAVI Control 3” or later and the VIERA Link is set to on.

# Advanced operations

## Audio format indicator

To display the current audio format.

**Press and hold [SOUND] for more than 4 sec.**

- The current audio format is indicated for 5 sec.



“STADIUM” indicator blinks:  
**Dolby Digital** is the audio format.



“MUSIC” indicator blinks:  
**DTS** is the audio format.



“CINEMA” indicator blinks:  
**PCM** is the audio format.



Audio format is not indicated when “” is selected as the source.

## Changing the dual audio

Change the dual audio from main to secondary.

- This setting will only work if the audio output setting on the connected TV or player, etc. is set to “Bitstream” and dual audio is available in the audio source.

**1 Press and hold [MUTE] for more than 4 sec.**



“STANDARD” indicator blinks (A):  
**Main** (Factory preset)



“STEREO” indicator blinks (B):  
**Secondary**  
(SAP: Secondary Audio Program)

When A and B both blink: Main and secondary

**2 While the setting is displayed, press [MUTE] to change the setting.**

- The setting changes each time [MUTE] is pressed.
- The indicator for the selected setting blinks for 20 sec and then exits the setting mode.
- The setting is maintained until it is changed again.

## Auto gain control

With this function, you can prevent sudden loud sounds. The output will be reduced automatically when the input exceeds a certain level.

**1 Press and hold [INPUT SELECTOR] on the remote control for more than 4 sec.**



“STANDARD” indicator blinks:  
**Auto gain control is on.**



“STEREO” indicator blinks:  
**Auto gain control is off.**  
(Factory preset)

**2 While the setting is displayed, press [INPUT SELECTOR] on the remote control to change the setting.**

- The setting changes each time [INPUT SELECTOR] is pressed.
- The indicator for the selected setting blinks for 20 sec and then exits the setting mode.
- The setting is maintained until it is changed again.

## Bluetooth® communication mode

You can select different modes to suit the type of connections with emphasis on connectivity or high quality audio.

- Make sure that a Bluetooth® device is already paired with this system. (→ 19)

**1 Press [] to select “”.**

- “” indicator will blink slowly. If the indicator lights, a Bluetooth® device is already connected with this system. Disconnect it. (→ 19)

**2 Press [] to display the current mode.**



“STANDARD” indicator blinks:  
**MODE1** (Factory preset)  
Emphasis on connectivity



“STEREO” indicator blinks:  
**MODE2**  
Emphasis on audio quality

**3 While the mode is displayed, press [] to select the mode.**

- The setting changes each time [] is pressed.
- The indicator for the selected setting blinks for 10 sec and then exits the setting mode.
- The setting is maintained until it is changed again.

## Using the Dolby Virtual Speaker effect

Depending on your preference, It is possible to turn off the 3D surround effect and the clear-mode dialog effect.

- 1 While pressing and holding [SOUND] on the remote control, press and hold [VOL +] on the main unit for more than 4 sec.



"STANDARD" indicator blinks:  
**3D surround effect and clear-mode dialog effect is on.**



"STEREO" indicator blinks:  
**3D surround effect and clear-mode dialog effect is off.**

- 2 While the setting is displayed, press [SOUND] to change the setting.

- The setting changes each time [SOUND] is pressed.
- The indicator for the selected setting blinks for 20 sec and then exits the setting mode.
- This setting will be reset to on when the main unit is turned off.
- When off is selected, the dialog effect level cannot be adjusted.

## Dimmer mode

You can turn off dimmer mode and keep the LED indicators bright.

**While pressing and holding [INPUT SELECTOR] on the remote control, press and hold [– VOL] on the main unit for more than 4 sec to turn off Dimmer mode.**

- The indicator for the current condition will turn brighter.
- The setting is maintained until it is changed again.
- Default setting of this function is on.



To turn on dimmer mode, repeat the operation above. After performing the operation, the indicator for the current condition will be dim.

## Auto standby function

With this function turned on, this unit can be set to automatically switch to standby mode if there is no signal input and no operation is performed for 2 hours.

- 1 While pressing and holding [DIALOG LEVEL –] on the remote control, press and hold [INPUT SELECTOR] on the main unit for more than 4 sec.

- The indicator for the current setting blinks for 20 sec.



"STANDARD" indicator blinks:  
**Auto standby function is on.**



"STEREO" indicator blinks:  
**Auto standby function is off.**

- 2 While the indicator is blinking, press [DIALOG LEVEL –] to change the setting.

- The setting changes each time [DIALOG LEVEL –] is pressed.
- The setting is maintained until it is changed again.

## Others

### ■ Remote control code

When other Panasonic devices respond to this system's remote control, change the remote control code on this system and the remote control.

#### Preparation

- Turn off all other Panasonic products.
- Turn on the main unit.

#### Change the remote control code to code 2:

- 1 Aim the remote control at the main unit's remote control sensor.
- 2 Press and hold [MUTE] and [8] on the remote control for more than 4 sec.

- All the indicators will blink for 10 sec when the code of this system is changed.

### ■ To turn off VIERA Link "HDAVI Control"

When "HDAVI Control" compatible equipment does not work well with this system, for example, it is possible to turn off this function as follows:

- When VIERA Link is turned off, the ARC function is not available. Be sure to connect the optical digital audio cable. (⇒ 16)
- 1 While pressing and holding [MUTE] on the remote control, press and hold [– VOL] on the main unit for more than 4 sec.
  - 2 After the setting has changed, turn off all the connected devices and then turn them on again.
- All the indicators will blink once when VIERA Link "HDAVI Control" is turned off.



To reset the setting, return to the factory preset. (⇒ 26)

### ■ To turn off the volume limitation

If a state of the lowered volume disturbs you every time the main unit turns on, for example, it is possible to turn off this function as follows:

While pressing and holding [MUTE] on the remote control, press and hold [VOL +] on the main unit for more than 4 sec.

- All the indicators will blink once when the volume limitation is turned off.



To reset the setting, return to the factory preset. (⇒ 26)

### ■ To reduce the clear-mode dialog effect

When the dialog does not sound natural while the volume is set low, it is possible to reduce the dialog enhancing effect as follows:

While pressing and holding [SOUND] on the remote control, press and hold [– VOL] on the main unit for more than 4 sec.

- All the indicators will blink once when the clear-mode dialog effect is reduced.



- Even if clear-mode dialog effect is reduced, dialog effect level is still adjustable.



To reset the setting, return to the factory preset. (⇒ 26)

# Troubleshooting

Before requesting service, make the following checks. If you are in doubt about some of the check points, or if the solutions indicated in the following guide do not solve the problem, consult your dealer for instructions.

## To return to the factory preset.

While the main unit is on, press [⏻/I] on the main unit for more than 4 sec.  
(All the indicators will blink twice when this system is reset.)

## If this system does not operate as expected, returning the settings to the factory preset may solve the problem.

- The remote control code will return to “1” when this system is returned to the factory preset. To change the remote control code, refer to page 25.

## General operation

### No power.

- Insert the AC mains lead securely. (⇒ 19)
- After turning the main unit on, if the indicators blink and the main unit immediately turns off, unplug the AC mains lead and consult your dealer.

### The remote control does not work properly.

- The battery is depleted. Replace it with a new one. (⇒ 8)
- It is possible that the insulation sheet has not been removed. Remove the insulation sheet. (⇒ 8)
- It may be necessary to set the code of the remote control again after changing the battery of the remote control. (⇒ 25)
- Use the remote control within the correct operation range. (⇒ 8)

### The “TV” indicator blinks.

Remove the AC mains lead and consult your dealer. If there are any other indicators blinking, be sure to inform your dealer about the blinking indicators.

### The main unit is automatically switched to standby mode.

The auto standby function is on.

The main unit will automatically switch to standby mode when no signal is input and no operation is performed for approx. 2 hours. Refer to page 24 to turn this function off.

### The colour of the speaker angle indicator does not match the tilt of the main unit.

Change the speaker angle settings manually so that the indicator colour matches the tilt.

- ① Press and hold [INPUT SELECTOR] on the main unit for more than 4 sec.
    - The speaker angle indicator blinks.
  - ② While the indicator is blinking, press [INPUT SELECTOR] on the main unit repeatedly to match the indicator color with the placement method.
- Refer to “Step 1 Selecting the placement method” (⇒ 9) for the relation between colour and tilt.

### The main unit is turned off when the TV's speakers are selected in the speaker control.

This is a normal feature when using VIERA Link (HDAVI Control 4 or later). Please read the operating instructions for the TV for details about its power save feature. (⇒ 22)

## HDMI

### **This system does not operate correctly.**

If the HDMI cable is connected to the wrong terminal (HDMI IN or HDMI OUT), this system will not operate correctly. Turn the main unit off, disconnect the AC mains lead and reconnect the HDMI cable(s). (⇒ 16, 17)

### **VIERA Link related operations no longer function properly.**

- Check the VIERA Link setting on the connected devices.
- Have you turned the VIERA Link settings off? (⇒ 25)
- When the HDMI connections are changed, after a power failure or after the AC mains lead has been removed, VIERA Link operations may not function properly.
  - Turn on all the devices that are connected to the TV with an HDMI cable and then turn the TV on.
  - Turn off the VIERA Link settings of the TV and turn it on again. For details refer to the operating instructions for the TV.
  - While the main unit and the TV are connected with the HDMI cable, turn on the TV and then remove the main unit's AC mains lead and reconnect it again.

### **The first few seconds of audio cannot be heard when using the HDMI connection.**

This may occur during DVD-Video chapter playback. Change the digital audio output setting on the connected device from "Bitstream" to "PCM".

### **When operating an HDMI compatible device of a different brand, the main unit reacts in an unwanted manner.**

HDAVI Control commands may use a different signal depending on the brand of the device. In this case, turn VIERA Link off. (⇒ 25)

## Bluetooth®

### **Pairing cannot be done.**

Check the Bluetooth® device condition.

### **The device cannot be connected.**

- The pairing of the device was unsuccessful or the registration has been replaced. Try pairing the device again. (⇒ 19)
- This system might be connected to a different device. Disconnect the other device and try pairing the device again.

### **The device is connected but audio cannot be heard through this system.**

For some built-in Bluetooth® devices, you have to set the audio output to "SC-HTB170" manually. Read the operating instructions for the device for details.

### **The sound is interrupted.**

- The device is out of the 10 m communication range. Bring the Bluetooth® device closer to the main unit.
- Remove any obstacle between the main unit and the device.
- Other devices that use the 2.4 GHz frequency band (wireless router, microwaves, cordless phones, etc.) are interfering. Bring the Bluetooth® device closer to the main unit and distance it from the other devices.
- Select "MODE1" for stable communication. (⇒ 23)

## Sound

### No sound (or image).

- Turn muting off. (⇒ 20)
- Check the connections to the other devices. (⇒ 16, 17)
- Make sure that the received audio signal is compatible with this system. (⇒ 30)
- Turn this system off and then on again.
- If the main unit is connected to the TV with only an HDMI cable, make sure that the TV's HDMI terminal is labelled "HDMI (ARC)". If not, connect using the optical digital audio cable. (⇒ 16)
- If the main unit is connected to a Panasonic TV and turned on using the button on the main unit or the remote control, sound might not be output from this system. In this case, turn the main unit on using the TV's remote control. (⇒ 22)
- If the connections are correct, there might be a problem with the cables. Redo the connections with different cables.
- Check the audio output settings on the connected device.
- If the BD/DVD indicator flashes and there is no audio output, try the following.
  - ① Turn the connected device off and then on.
  - ② Turn off the main unit, remove the HDMI cable, then reconnect the HDMI cable and turn the main unit back on.

### The dual audio cannot be changed from main to secondary.

If the audio received from the connected device is not "Dolby Dual Mono" or the output setting is not "Bitstream", the setting cannot be changed from this system. Change the setting on the connected device.

### The volume is lowered when the main unit is turned on.

If the main unit is turned off with the volume setting in the greater half (above 50), the main unit will automatically lower the volume to the middle (50) when the main unit is turned on. (⇒ 25)

### The dialog is too persistent or the dialog does not sound natural.

This system has a function to make the dialog stand out when the volume is low. (⇒ 25)

### There is no audio.

#### The power of the main unit turns off automatically.

(When the main unit detects a problem, a safety measure is activated and the main unit automatically switches to standby mode.)









- There is a problem with the amplifier.
- Is the volume extremely high?  
If so, lower the volume.
- Is this system placed in an extremely hot place?  
If so, move this system to a cooler place and wait a few moments and then try to turn it on again.

If the problem persists, confirm the TV indicator and BD/DVD indicator blink, turn this system off, remove the AC mains lead cord and consult your dealer. Please be sure to remember the indicators that were blinking and inform the dealer.

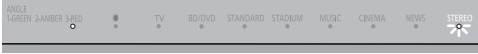

# Indicator illumination

The indicators display the condition of this system by flashing. The indicator patterns illustrated below are displayed during normal operational conditions. They do not refer to the indications of a problem.

Indicator	Description
	<b>The indicator blinks for 10 sec.</b> <ul style="list-style-type: none"><li>When the Bluetooth® communication is mode 1 (⇒ 23)</li></ul> <b>The indicator blinks for 20 sec.</b> <ul style="list-style-type: none"><li>When 3D surround effect and clear-mode dialog effect are on (⇒ 24)</li><li>When the dual audio setting is Main (⇒ 23)</li><li>When the auto gain control is on (⇒ 23)</li><li>When the auto standby function is on (⇒ 24)</li></ul>
	<b>The indicator blinks for 5 sec.</b> <ul style="list-style-type: none"><li>When the audio format is Dolby Digital (⇒ 23)</li></ul>
	<b>The indicator blinks for 5 sec.</b> <ul style="list-style-type: none"><li>When the audio format is DTS (⇒ 23)</li></ul>
	<b>The indicator blinks for 5 sec.</b> <ul style="list-style-type: none"><li>When the audio format is PCM*2 (⇒ 23)</li></ul>
	<b>The indicator blinks for 10 sec.</b> <ul style="list-style-type: none"><li>When the Bluetooth® communication is mode 2 (⇒ 23)</li></ul> <b>The indicator blinks for 20 sec.</b> <ul style="list-style-type: none"><li>When 3D surround effect and clear-mode dialog effect are off (⇒ 24)</li><li>When the dual audio setting is Secondary (SAP: Secondary Audio Program) (⇒ 23)</li><li>When the auto gain control is off (⇒ 23)</li><li>When the auto standby function is off (⇒ 24)</li></ul>
	<b>The indicators blink for 20 sec.</b> <ul style="list-style-type: none"><li>When the dual audio setting is Main and Secondary (⇒ 23)</li></ul>
	<b>The indicators blink for 10 sec.</b> <ul style="list-style-type: none"><li>When the remote control code is changed (⇒ 25)</li></ul> <b>The indicators blink once.</b> <ul style="list-style-type: none"><li>When changing the setting ("To reduce the clear-mode dialog effect", "To turn off VIERA Link "HDAVI Control"", and "To turn off the volume limitation") (⇒ 25)</li></ul> <b>The indicators blink twice.</b> <ul style="list-style-type: none"><li>When the main unit is reset (⇒ 26)</li></ul>
	<b>Bluetooth® indicator blinks quickly.</b> <ul style="list-style-type: none"><li>When the main unit is ready for pairing</li></ul> <b>Bluetooth® indicator blinks slowly.</b> <ul style="list-style-type: none"><li>When the main unit is waiting to connect</li></ul> <b>Bluetooth® indicator turns on.</b> <ul style="list-style-type: none"><li>When the main unit is connected with a Bluetooth® device</li></ul>

\*1 The indicator for the current status remains lit.  
\*2 The indicator blinks only when [SOUND] is pressed for more than 4 sec and the audio format is PCM.

# Specifications

## AMPLIFIER SECTION

<b>RMS output power: Dolby Digital Mode</b>	
Front ch	30 W per channel (6 Ω), 1 kHz, 10 % THD
Subwoofer ch	60 W per channel (3 Ω), 100 Hz, 10 % THD
<b>Total RMS Dolby Digital mode power</b>	120 W

## TERMINAL SECTION

<b>HDAVI Control</b>	
This unit supports “HDAVI Control 5” function.	
<b>HDMI AV input</b>	
(BD/DVD)	1
Input connector	Type A (19 pin)
<b>HDMI AV output</b>	
(TV (ARC))	1
Output connector	Type A (19 pin)
<b>Digital audio input</b>	
Optical digital input	Optical terminal
<b>Sampling frequency</b>	
32 kHz, 44.1 kHz, 48 kHz	
88.2 kHz, 96 kHz (only LPCM)	
<b>Audio Format</b>	
LPCM, Dolby Digital, DTS Digital Surround	
<b>IR Blaster</b>	
Terminal Type	3.5 mm jack
<b>USB Port</b>	
For service use only.	

## SPEAKER SECTION

<b>Front speakers (Built-in)</b>	
Type	2 way, 2 speaker system (Bass Reflex)
<b>Woofers</b>	
5.7 cm Cone type	
<b>Tweeter</b>	
2.5 cm Semi-dome type	
<b>Subwoofer (Built-in)</b>	
Type	1 way, 2 speaker system (Bass Reflex)
<b>Woofers</b>	
8 cm Cone type×2	

## GENERAL

<b>Power consumption</b>	22 W
<b>Power consumption in standby mode</b>	
(When the other connected devices are turned off)	
Approx. 0.4 W	

<b>Power supply</b>	AC 220 V to 240 V, 50 Hz
<b>Dimensions (W×H×D)</b>	
950 mm×66 mm×105 mm	
<b>Mass</b>	Approx. 3.4 kg
<b>For wall mounting</b>	
<b>Dimensions (W×H×D)</b>	
950 mm×105 mm×66 mm	
<b>Mass</b>	Approx. 3.4 kg
<b>With basic stands</b>	
<b>Dimensions (W×H×D)</b>	
950 mm×79 mm×105 mm	
<b>Mass</b>	3.45 kg
<b>With 30° stands</b>	
<b>Dimensions (W×H×D)</b>	
950 mm×99 mm×113 mm	
<b>Mass</b>	3.45 kg
<b>With 80° stands</b>	
<b>Dimensions (W×H×D)</b>	
950 mm×118 mm×80 mm	
<b>Mass</b>	3.47 kg
<b>Operating temperature range</b>	
0 °C to +40 °C	
<b>Operating humidity range</b>	
20 % to 80 % RH (no condensation)	

## Bluetooth® SECTION

<b>Bluetooth® system specification</b>	
Version 3.0	
<b>Wireless equipment classification</b>	
Class 2	
<b>Supported profiles</b>	
A2DP	
<b>Frequency band</b>	
2400 MHz to 2483.5 MHz	
(Adaptive Frequency Hopping)	
<b>Operating distance</b>	
10 m Line of Sight	



- Specifications are subject to change without notice.
- Weight and dimensions are approximate.
- Total harmonic distortion is measured by a digital spectrum analyzer.

# Unit care

■ **Clean this system with a soft, dry cloth**

- When dirt is heavy, wring a cloth moistened in water tightly to wipe the dirt, and then wipe it with a dry cloth.
- Never use alcohol, paint thinner or benzine to clean this system.
- Before using chemically-treated cloth, carefully read the instructions that came with the cloth.

■ **To dispose or transfer this system**

This system may keep the user settings information in the main unit. If you discard the main unit either by disposal or transfer, then follow the procedure to return all the settings to the factory presets to delete the user settings. (⇒ 26, "To return to the factory preset.")

- The operation history may be recorded in the memory of the main unit.

# Licenses

Manufactured under license from Dolby Laboratories. Dolby, Pro Logic, and the double-D symbol are trademarks of Dolby Laboratories.
Manufactured under license under U.S. Patent Nos: 5,956,674; 5,974,380; 6,487,535 & other U.S. and worldwide patents issued & pending. DTS, the Symbol, & DTS and the Symbol together are registered trademarks & DTS Digital Surround and the DTS logos are trademarks of DTS, Inc. Product includes software. © DTS, Inc. All Rights Reserved.
HDMI, the HDMI Logo, and High-Definition Multimedia Interface are trademarks or registered trademarks of HDMI Licensing LLC in the United States and other countries.
HDAVI Control™ is a trademark of Panasonic Corporation.
The Bluetooth® word mark and logos are owned by the Bluetooth SIG, Inc. and any use of such marks by Panasonic Corporation is under license. Other trademarks and trade names are those of their respective owners.



These symbols on the products, packaging, and/or accompanying documents mean that used electrical and electronic products and batteries should not be mixed with general household waste.

For proper treatment, recovery and recycling of old products and used batteries, please take them to applicable collection points, in accordance with your national legislation and the Directives 2002/96/EC and 2006/66/EC.

By disposing of these products and batteries correctly, you will help to save valuable resources and prevent any potential negative effects on human health and the environment which could otherwise arise from inappropriate waste handling.

For more information about collection and recycling of old products and batteries, please contact your local municipality, your waste disposal service or the point of sale where you purchased the items.

Penalties may be applicable for incorrect disposal of this waste, in accordance with national legislation.



### For business users in the European Union

If you wish to discard electrical and electronic equipment, please contact your dealer or supplier for further information.

### [Information on Disposal in other Countries outside the European Union]

These symbols are only valid in the European Union. If you wish to discard these items, please contact your local authorities or dealer and ask for the correct method of disposal.



Cd

### Note for the battery symbol (bottom two symbol examples):

This symbol might be used in combination with a chemical symbol. In this case it complies with the requirement set by the Directive for the chemical involved.

## Safety information for customers in Norway

### NORSK

#### ADVARSEL

##### Produkt

- For å redusere faren for brann, elektrisk støt eller skade på apparatet:
  - Utsett ikke produktet for regn, fukt, drypping eller sprut.
  - Ikke plasser objekter som er fylt med væske, som vaser, på apparatet.
  - Bruk kun anbefalt tilbehør.
  - Fjern ikke deksler.
  - Reparer ikke denne enheten selv, overlat service til kvalifisert servicepersonell.

##### Vekselstrømnett

- Nettstøpselet er trukket ut fra denne enheten. Installer denne enheten slik at nettstøpselet umiddelbart kan trekkes fra stikkkontakten.

#### FORSIKTIG

##### Produkt

- Plasser ikke åpen ild, slik som levende lys, oppå apparatet.
- Dette apparatet er beregnet for bruk under moderate klimaforhold.

##### Plassering

- For å redusere faren for brann, elektrisk støt eller skade på apparatet:
  - Ikke plasser apparatet i en bokhylle, et innebygget kabinett eller et annet lukket sted. Pass på at produktet er godt ventilert.
  - Apparatets ventilasjonsåpninger må ikke dekkes til med aviser, duker, gardiner eller lignende.

CE1177

### Declaration of Conformity (DoC)

Hereby, "*Panasonic Corporation*" declares that this product is in compliance with the essential requirements and other relevant provisions of Directive 1999/5/EC.

Customers can download a copy of the original DoC to our R&TTE products from our DoC server:

<http://www.doc.panasonic.de>

Contact to Authorised Representative: Panasonic Marketing Europe GmbH,

Panasonic Testing Centre, Winsbergring 15, 22525 Hamburg, Germany

This product is intended for general consumer. (Category 3)

### Ελληνικά

#### Δήλωση συμμόρφωσης (DoC)

Με την παρούσα, η "*Panasonic Corporation*" δηλώνει ότι το προϊόν αυτό είναι σύμφωνο με τις βασικές απαιτήσεις και άλλες σχετικές διατάξεις της οδηγίας 1999/5/EC.

Οι πελάτες μπορούν να κατεβάσουν ένα αντίγραφο του πρωτοτύπου DoC για τα R&TTE προϊόντα μας από τον DoC server μας:

<http://www.doc.panasonic.de>

Στοιχεία επικοινωνίας Εξουσιοδοτημένου Αντιπροσώπου:

Panasonic Marketing Europe GmbH,  
Panasonic Testing Centre, Winsbergring 15, 22525 Hamburg,  
Γερμανία

Αυτό το προϊόν προορίζεται για καταναλωτές. (Κατηγορία 3)

### Português

#### Declaração de Conformidade (DoC)

Com o presente documento, a "*Panasonic Corporation*" declara que este produto é conforme os requisitos específicos e demais especificações referentes à Diretriz 1999/5/EC.

Os clientes podem baixar uma cópia da declaração de conformidade (DoC) para nossos produtos R&TTE do Server DoC:

<http://www.doc.panasonic.de>

Contacte o representante autorizado: Panasonic Marketing Europe GmbH,

Panasonic Testing Centre, Winsbergring 15, 22525 Hamburg, Alemanha

Este produto destina-se ao consumidor geral. (Categoria 3)

### Lietuviškai

#### Atitikties deklaracija (AD)

Bendrovė "*Panasonic Corporation*" patvirtina, kad šis gaminys tenkina direktyvos 1999/5/EB esminius reikalavimus ir kitas taikytinas nuostatas.

Mūsų R&TTE gaminių originalios atitikties deklaracijos kopiją klientai gali atsisiųsti iš mūsų AD serverio:

<http://www.doc.panasonic.de>

Igaliojoto atstovo adresas: "Panasonic Marketing Europe GmbH",  
Panasonic Testing Centre, Winsbergring 15, 22525 Hamburg,  
Vokietija.

Šis gaminys skirtas bendrajam vartojimui. (3 kategorija.)

### Slovensko

#### Izjava o skladnosti (DoC)

S pričujočo izjavo podjetje "*Panasonic Corporation*" izjavlja, da so svoji izdelki skladni s pglavitnimi zahtevami in drugimi odgovarjajočimi predpisi direktive 1999/5/ES.

Stranka lahko naloži izvod izvirnega DoC o naših izdelkih R&TTE s strežnika DoC:

<http://www.doc.panasonic.de>

Pooblaščen zastopnik: Panasonic Marketing Europe GmbH,  
Panasonic Testing Centre, Winsbergring 15, 22525 Hamburg,  
Nemčija

Izdelek je namenjen splošni uporabi. (Razred 3)

### Slovensky

#### Vyhľadanie o zhode (DoC)

"*Panasonic Corporation*" týmto prehlasuje, že tento výrobok je v zhode so základnými požiadavkami a ďalšími príslušnými ustanoveniami smernice 1999/5/ES.

Zákazníci si môžu stiahnuť kópiu pôvodného DoC na naše R&TTE výrobky z nášho servera DoC:

<http://www.doc.panasonic.de>

Kontakt na splnomocneného zástupcu: Panasonic Marketing Europe GmbH,

Panasonic Testing Centre, Winsbergring 15, 22525 Hamburg, Nemecko

Tento produkt je určený pre všeobecného spotrebiteľa. (Kategória 3)

## Norsk

### Samsvarserklæring (DoC)

"Panasonic Corporation" erklærer at utstyret er i samsvar med de grunnleggende krav og øvrige relevante krav i direktiv 1999/5/EF. Kundene kan laste ned en kopi av den originale samsvarserklæringen (DoC) for vårt R&TTE utstyr fra vår DoC server:

<http://www.doc.panasonic.de>

Kontakt vår autoriserte representant: Panasonic Marketing

Europe GmbH,

Panasonic Testing Centre, Winsbergring 15, 22525 Hamburg, Tyskland

Utstyret er beregnet på den vanlige forbruker (klasse 3).

## Eesti keel

### Vastavusdeklaratsioon (DoC)

"Panasonic Corporation" kinnitab käesolevaga, et see toode on vastavuses põhiliste nõuete ja muude direktiivi 1999/5/EÜ asjakohaste sätetega.

Kliendid saavad koopia meie R&TTE toodetele kehtiva originaalvastavusdeklaratsiooni koopia alla laadida meie DoC-serverist:

<http://www.doc.panasonic.de>

Võtke ühendust volitatud esindajaga: Panasonic Marketing

Europe GmbH,

Panasonic Testing Centre, Winsbergring 15, 22525 Hamburg, Germany

See toode on mõeldud tavakasutajale. (III kategooria)

## Latviski

### Atbilstības deklarācija (DoC)

Kompānija "Panasonic Corporation" ar šo paziņo, ka šis izstrādājums atbilst būtiskām prasībām un citām saistošām Direktīvas 1999/5/EK prasībām.

Pircēji var lejupielādēt oriģinālo DoC kopiju mūsu R&TTE izstrādājuma no mūsu DoC servera:

<http://www.doc.panasonic.de>

Lūdzam sazināties ar pilnvaroto parstāvi Panasonic

Marketing Europe GmbH,

Panasonic Testing Centre, Winsbergring 15, 22525 Hamburg, Germany

Šis izstrādājums ir paredzēts parastam patērētājam. (3. kategorija)

## Български

### Декларация за съответствие (DoC)

"Panasonic Corporation" декларира, че този продукт съответства на съществените изисквания и другите приложими разпоредби на Директива 1999/5/EC.

Потребителите могат да свалят копие от оригиналните DoC към нашите продукти от типа R&TTE от сървъра, на който се съхраняват DoC:

<http://www.doc.panasonic.de>

За контакт с оторизиран представител: Panasonic Marketing

Europe GmbH,

Panasonic Testing Centre, Winsbergring 15, 22525 Hamburg, Германия

Този продукт е предназначен за обща употреба. (Категория 3)

## Român

### Declarație de Conformitate (DoC)

Prin prezenta, societatea "Panasonic Corporation" declară că produsul este conform cu cerințele esențiale și cu alte norme corespunzătoare Directivei 1999/5/EC.

Clienții pot descărca o copie a DoC-ului original al produselor noastre R&TTE de la adresa noastră DoC din Internet:

<http://www.doc.panasonic.de>

Contact la Reprezența autorizată: Panasonic Marketing

Europe GmbH,

Panasonic Testing Centre, Winsbergring 15, 22525 Hamburg, Germania

Acest produs a fost proiectat pentru clientela generală. (Categorie 3)

## Magyar

### Megfelelőségi Nyilatkozat (DoC)

Ezennel a, "Panasonic Corporation" kijelenti, hogy a jelen termék kielégíti az 1999/5/EK Irányelv létfontosságú követelményeit és más vonatkozó rendelkezéseit.

A vásárlók letölthetik az R&TTE termékek eredeti DoC másolatát a DoC szerverünkről:

<http://www.doc.panasonic.de>

Forduljon a hivatalos márkaképviselethez: Panasonic Marketing

Europe GmbH,

Panasonic Testing Centre, Winsbergring 15, 22525 Hamburg, Németország

A terméket általános fogyasztóknak szánták. (3-as kategória)

# Limited Warranty (ONLY FOR AUSTRALIA)

## Panasonic Warranty

1. The product is warranted for 12 months from the date of purchase. Subject to the conditions of this warranty Panasonic or its Authorised Service Centre will perform necessary service on the product without charge for parts or labour, if in the opinion of Panasonic, the product is found to be faulty within the warranty period.
2. This warranty only applies to Panasonic products purchased in Australia and sold by Panasonic Australia or its Authorised Distributors or Dealers and only where the products are used and serviced within Australia or its territories. Warranty cover only applies to service carried out by a Panasonic Authorised Service Centre and only if valid proof of purchase is presented when warranty service is requested.
3. This warranty only applies if the product has been installed and used in accordance with the manufacturer's recommendations (as noted in the operating instructions) under normal use and reasonable care (in the opinion of Panasonic). The warranty covers normal domestic use only and does not cover damage, malfunction or failure resulting from use of incorrect voltages, incorrect installation, accident, misuse, neglect, build-up of dirt or dust, abuse, maladjustment of customer controls, mains supply problems, thunderstorm activity, infestation by insects or vermin, tampering or repair by unauthorised persons (including unauthorised alterations), introduction of sand, humidity or liquids, commercial use such as hotel, office, restaurant, or other business or rental use of the product, exposure to abnormally corrosive conditions or any foreign object or matter having entered the product.
4. This warranty does not cover the following items unless the fault or defect existed at the time of purchase:
  - (a) Cabinet Part(s)
  - (b) Video or Audio Tapes
  - (c) SD cards or USB devices
  - (d) User replaceable Batteries  
etc
  - (e) DVD, Blu-ray or Recordable Discs
  - (f) Video / Audio Heads from wear and tear in normal use
  - (g) Information stored on Hard Disk Drive, USB stick or SD card
  - (h) DTV reception issues caused by TV Aerial / Cabling / Wall socket(s)
5. Some products may be supplied with Ethernet connection hardware. The warranty is limited on such products and will not cover
  - (a) Internet and or DLNA connection / setup related problems
  - (b) Access fees and or charges incurred for internet connection
  - (c) The use of incompatible software or software not specifically stipulated in the product operations manual;  
and
  - (d) Any indirect or consequential costs associated with the incorrect use or misuse of the hardware, its connection to the internet or any other device.
6. To claim warranty service, when required, you should:
  - Telephone Panasonic's Customer Care Centre on 132600 or visit our website referred to below and use the Service Centre Locator for the name/address of the nearest Authorised Service Centre.
  - Send or take the product to a Panasonic Authorised Service Centre together with your proof of purchase receipt as a proof of purchase date. Please note that freight and insurance to and / or from your nearest Authorised Service Centre must be arranged by you.
  - Note that home or pick-up/delivery service is available for the following products in the major metropolitan areas of Australia or the normal operating areas of the nearest Authorised Service Centres:
    - Plasma/LCD televisions / displays (screen size greater than 103 cm)
7. The warranties hereby conferred do not extend to, and exclude, any costs associated with the installation, de-installation or re-installation of a product, including costs related to the mounting, de-mounting or remounting of any screen, (and any other ancillary activities), delivery, handling, freighting, transportation or insurance of the product or any part thereof or replacement of and do not extend to, and exclude, any damage or loss occurring by reason of, during, associated with, or related to such installation, de-installation, re-installation or transit.

Panasonic Authorised Service Centres are located in major metropolitan areas and most regional centres of Australia, however, coverage will vary dependant on product. For advice on exact Authorised Service Centre locations for your product, please telephone our Customer Care Centre on 132600 or visit our website and use the Service Centre Locator.

In addition to your rights under this warranty, Panasonic products come with consumer guarantees that cannot be excluded under the Australian Consumer Law. If there is a major failure with the product, you can reject the product and elect to have a refund or to have the product replaced or if you wish you may elect to keep the goods and be compensated for the drop in value of the goods. You are also entitled to have the product repaired or replaced if the product fails to be of acceptable quality and the failure does not amount to a major failure.

If there is a major failure in regard to the product which cannot be remedied then you must notify us within a reasonable period by contacting the Panasonic Customer Care Centre. If the failure in the product is not a major failure then Panasonic may choose to repair or replace the product and will do so in a reasonable period of time from receiving notice from you.

**THIS WARRANTY CARD AND THE PURCHASE DOCKET (OR SIMILAR PROOF OF PURCHASE)  
SHOULD BE RETAINED BY THE CUSTOMER AT ALL TIMES**

If you require assistance regarding warranty conditions or any other enquiries, please visit the **Panasonic Australia** website **[www.panasonic.com.au](http://www.panasonic.com.au)** or contact by phone on **132 600**  
*If phoning in, please ensure you have your operating instructions available.*

**Panasonic Australia Pty. Limited**

ACN 001 592 187 ABN 83 001 592 187

1 Innovation Road, Macquarie Park NSW 2113

PRO-031-F11 Issue: 4.0

01-01-2011

RQT9772

**35**

## **Sales and Support Information**

### Customer Communications Centre

- For customers within the UK: 0844 844 3899
- For customers within Ireland: 01 289 8333
- Monday–Friday 9:00 am – 5:00 pm (Excluding public holidays).
- For further support on your product, please visit our website:  
[www.panasonic.co.uk](http://www.panasonic.co.uk)

### Direct Sales at Panasonic UK

- Order accessory and consumable items for your product with ease and confidence by phoning our Customer Communications Centre Monday–Friday 9:00 am – 5:00 pm (Excluding public holidays).
- Or go on line through our Internet Accessory ordering application at [www.pas-europe.com](http://www.pas-europe.com).
- Most major credit and debit cards accepted.
- All enquiries transactions and distribution facilities are provided directly by Panasonic UK.
- It couldn't be simpler!
- Also available through our Internet is direct shopping for a wide range of finished products. Take a browse on our website for further details.

### **EU**

Pursuant to the applicable EU legislation  
**Panasonic Marketing Europe GmbH**  
**Panasonic Testing Centre**  
Winsbergring 15, 22525 Hamburg, Germany

EU



**Panasonic Corporation**  
**Web Site:** <http://panasonic.net>

En