

E402B, E442B, E522B

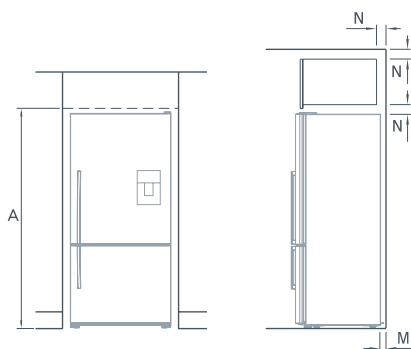

Flush with refrigerator chassis – full door rotation

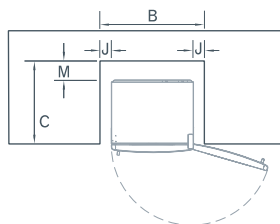

Flush with refrigerator door – 90° door rotation

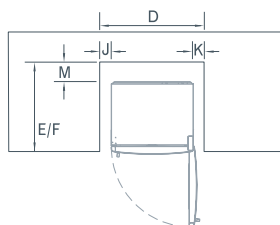

Flush with refrigerator door – full door rotation

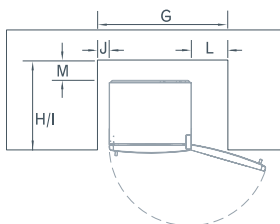

RF610A/RF540A/RF201A

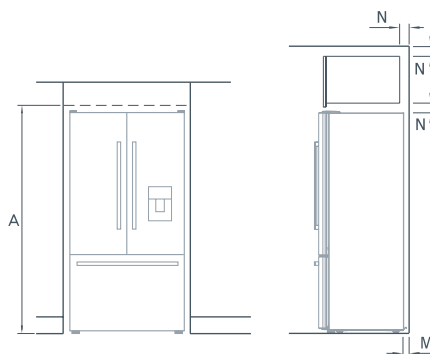

Flush with refrigerator chassis – full door rotation

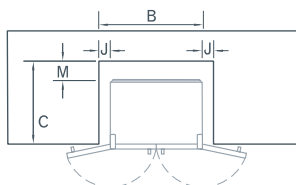

Flush with refrigerator door – 90° door rotation

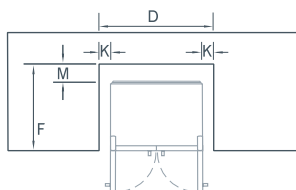

Flush with refrigerator door – full door rotation

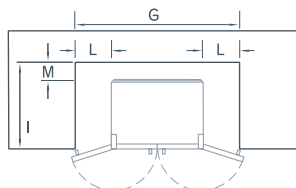

3. Ventilation and installation

- To ensure adequate ventilation for your refrigerator see recommended cabinetry dimensions below.
- The appliance is intended to be placed against a wall with a free distance not exceeding 75 mm.

Cabinetry dimensions (mm) (including minimum air clearances)	E402B	E442B	E522B	RF610A RF540A RF201A
A inside height	1745	1745	1745	1810
Flush with refrigerator chassis – full door rotation				
B inside width	675	720	830	940
C inside depth	620	620	620	620
Flush with refrigerator door – 90° door rotation				
D inside width	680	725	835	950
E inside depth flush to curved door	–	675	675	–
F inside depth flush to flat door	690	690	690	690
Flush with refrigerator door – full door rotation				
G inside width	795	840	950	1180
H inside depth flush to curved door	675	675	675	–
I inside depth flush to flat door	690	690	690	690
Minimum clearances				
J side clearance	20	20	20	20
K side clearance – hinge side flush with door – 90° rotation	25	25	25	25
L side clearance – hinge side flush with door – full rotation	140	140	140	140
M rear clearance (incl. evaporator tray)	30	30	30	30
N vent	50	50	50	50