

Tonic

by Rogerseller

Gooseneck Basin Mixer

Installation
Instructions

Specification

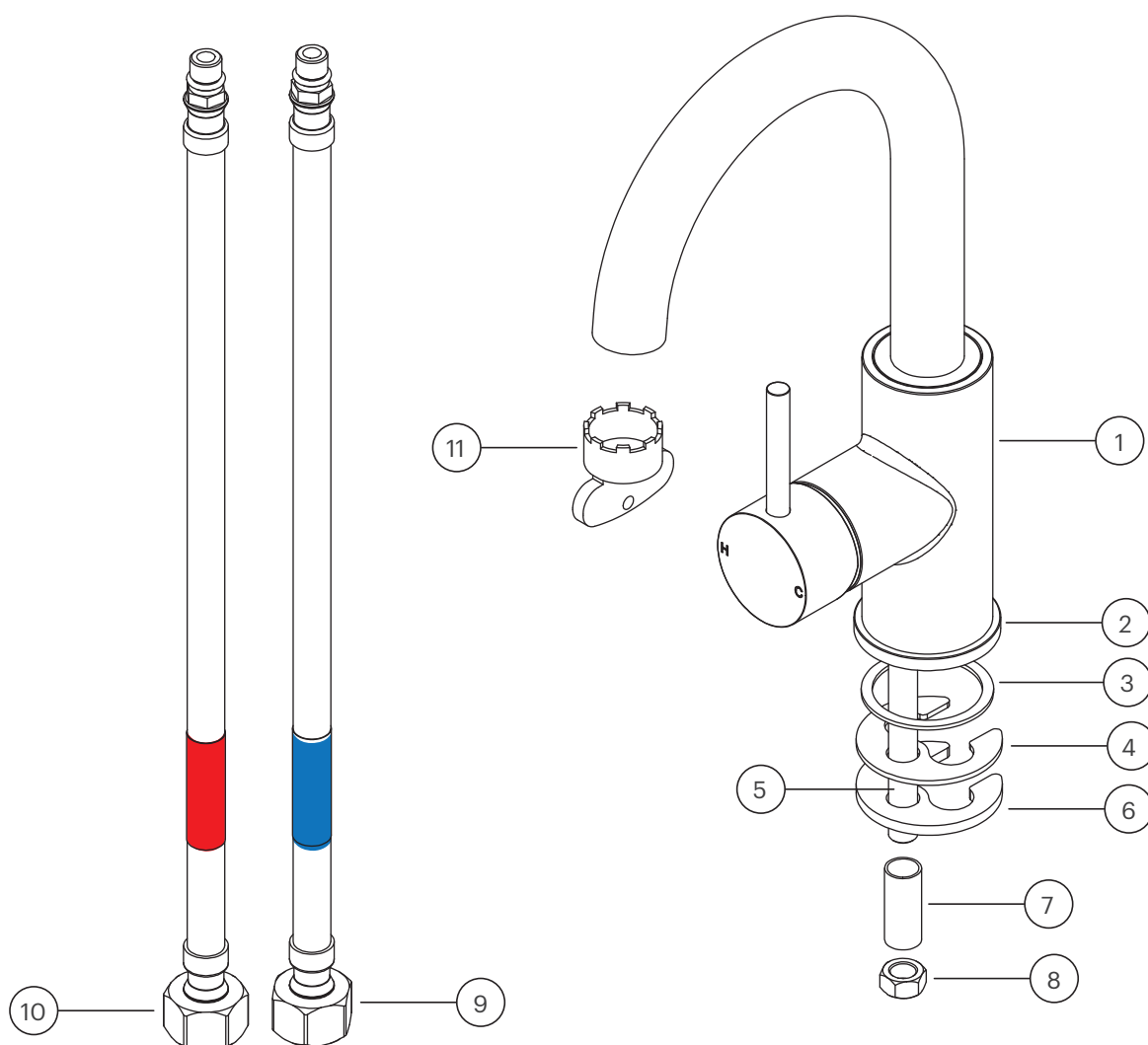

Tonic by Rogerseller Gooseneck Basin Mixer

3606013601 — Chrome

i Other finishes available

Parts List

1. Mixer Tap
2. Base Ring
3. Base Washer
4. Rubber Horseshoe Washer
5. Fixing Rod
6. Metal Horseshoe Washer
7. Spacer
8. Nut
9. Cold Ramflex Flexi Hose
10. Hot Ramflex Flexi Hose
11. Aerator Key

Installation

Step 1

If not already done so, separate the fixing components from the mixer tap leaving the fixing rod in place.

Take the base ring, base washer and place these over and into the basin hole as shown in the illustration.

Ensure the base washer locates inside the base ring and evenly around the basin hole as this seals and prevents water from entering cabinetry through the basin hole.

Bench Hole Requirements:
Minimum Hole Size - Ø32mm
Maximum Hole Size - Ø40mm

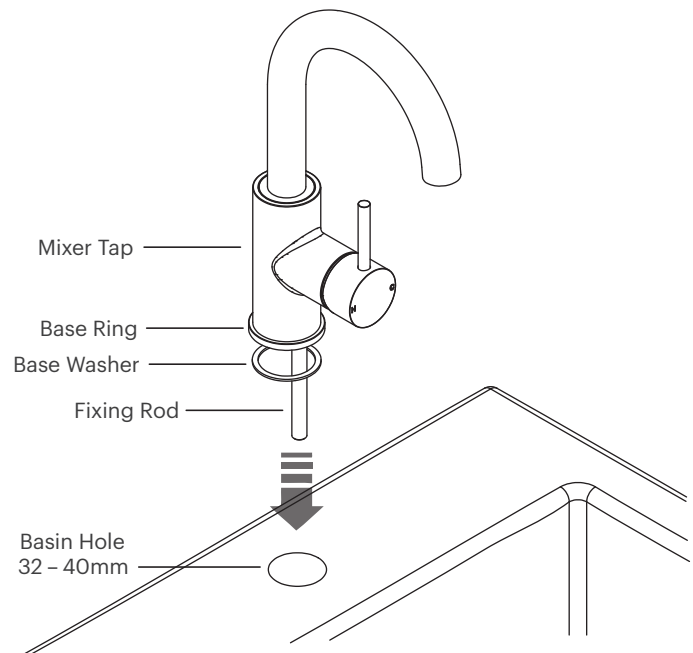

Step 2

From the underside, apply the rubber horseshoe washer, metal horseshoe washer, spacer and nut to the fixing rod and hand tighten the nut.

Ensure mixer tap, base washer and horseshoe washers are positioned evenly around the basin hole and tighten nut securely using an appropriate spanner.

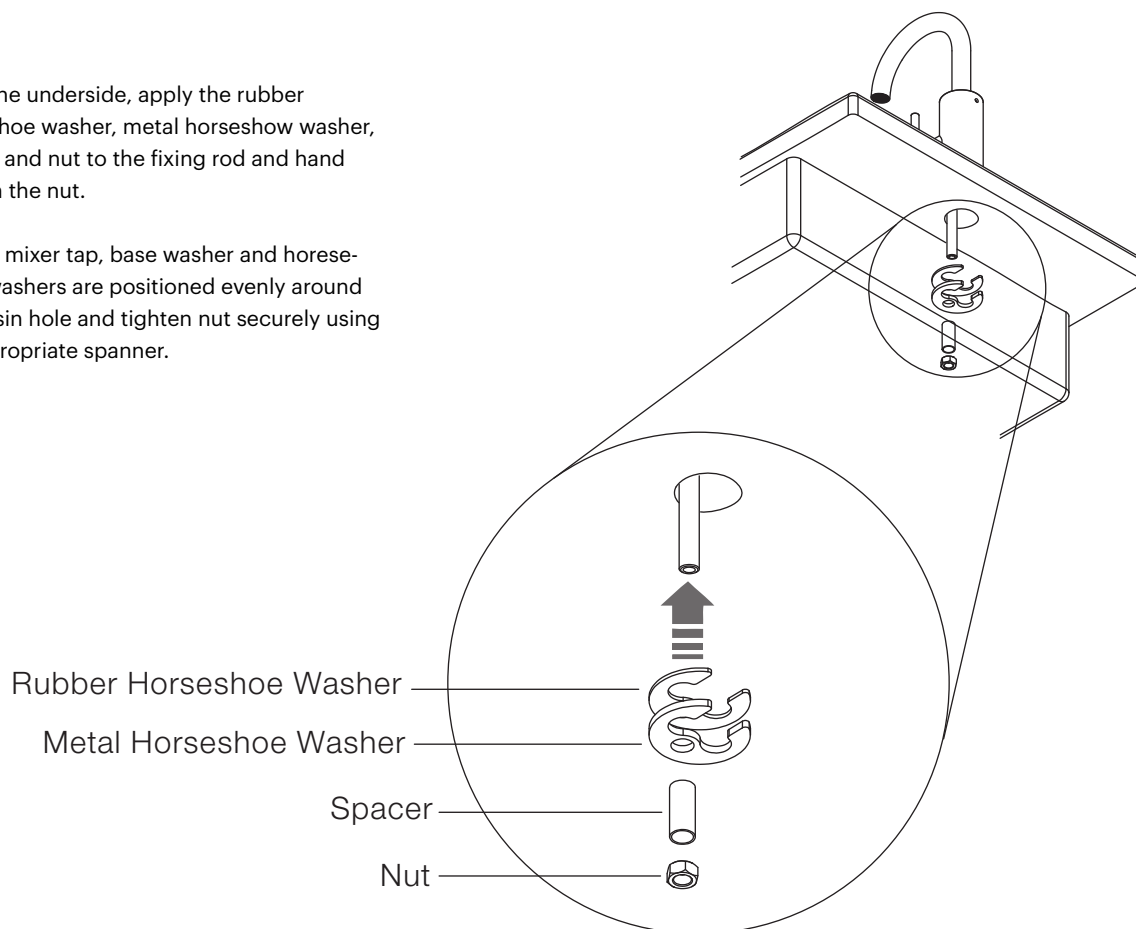

Installation

Step 3

Connect the hot & cold ramflex anti-corrosion hoses to the appropriate hot and cold mixer tap inlet. If positioned correctly the hot inlet on the mixer body is marked with a "h" and located on the left hand side.

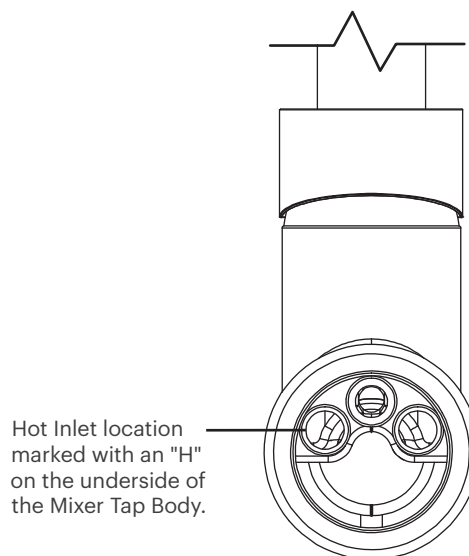

Step 4

Connect the hot and cold hoses to the mains water supply. Remove the aerator and introduce mains water supply to flush the mixer of any debris, check for leaks and remedy as required. Replace the aerator.

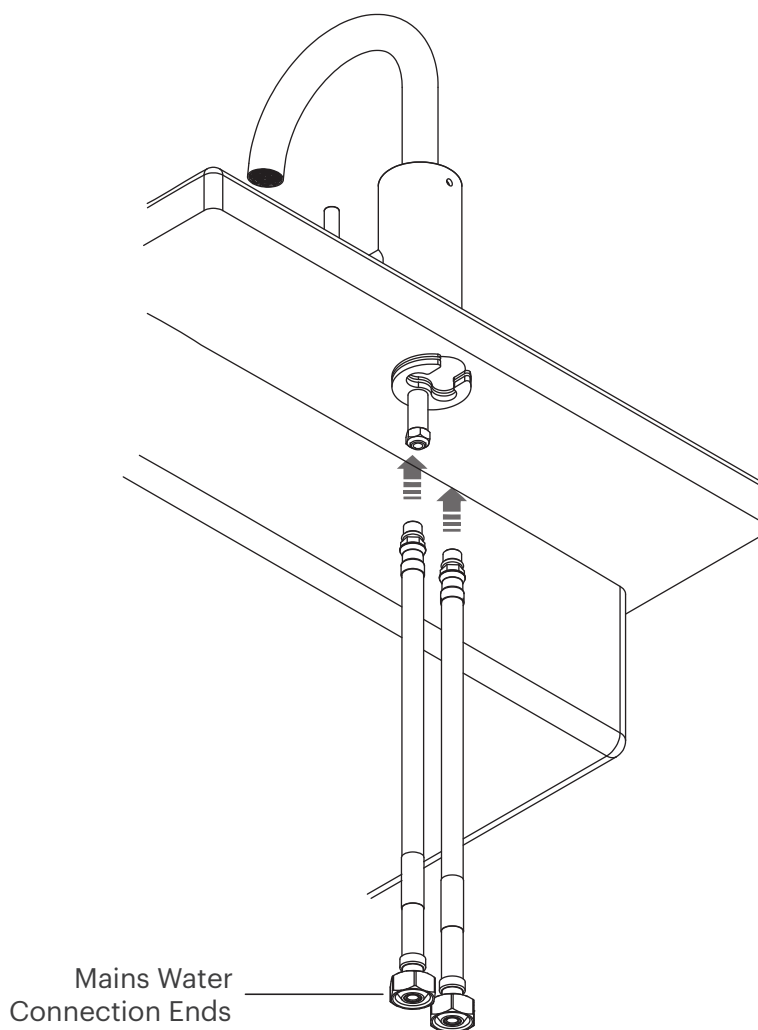

Specifications

It is a requirement of state plumbing codes that licensed plumbers carry out all tapware installations. All installations must comply with the relevant requirements of AS/NZS3500 and local plumbing codes.

Pressure

Maximum Hydrostatic Pressure - 1000kpa

Recommended Maximum Hydrostatic Pressure - 500 kpa. (AS/NZS 3500)

Recommended Minimum Hydrostatic Pressure - 150 kpa.

Maximum Hydrostatic Pressure may be exceeded under test conditions only in accordance with AS/NZS 3500. Where hydrostatic pressure exceeds the maximum stated above, pressure limiting valves must be installed or warranty will be void.

Temperature

Maximum Water Temperature - 80°C

For optimum performance, Hot and Cold inlet water pressure should be equal.

Care and Maintenance

[1] Product should be inspected for surface damage prior to installation. [2] Cleaning and handling of all finishes must be performed carefully. [3] Clean products using a soft cloth with warm soapy water only. [4] Never use harsh detergents or abrasive cleaners as these will damage the product. [5] Water marks can be removed from Matt Finishes with an application of a carnauba wax based non-abrasive polish on a microfibre cloth. [6] Do not use undue pressure when cleaning and wipe in one direction only. [7] Contact with harsh chemicals such as hair dye, hair bleach etc will result in damage to the finish. [8] Tapware should never be installed using acetone silicones. [9] Avoid the use of wax based furniture creams as this can result in a build up of deposits which will detract from the appearance. [10] Damage to finishes arising from improper installation or post installation use or failure to observe the above care and cleaning instructions will void all warranty agreements.

Warranty

Rogerseller tapware, bathroom fittings and sanitaryware are covered by a five (5) year warranty from date of purchase. For full terms and conditions please refer to rogerseller.com.au

Please note —

Dimensions are approximate. Information provided in these installation instructions is representative of the actual products available at the time of printing. Due to our policy of continuous product development, the designs and specifications depicted are subject to change without notice. Please confirm all particulars with your product expert prior to purchase. Each product is covered by a limited warranty. Full terms and conditions are available from your product expert.

rogerseller

f p @ in

rogerseller.com.au