

**Sopotop**

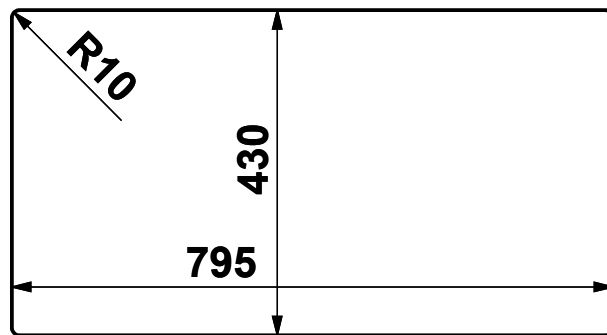

**Foro Sopotop**

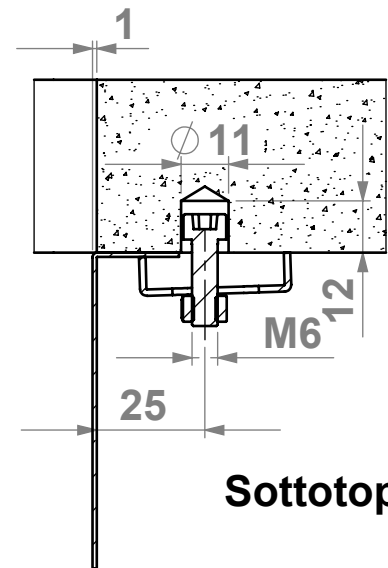

**Sottotop**

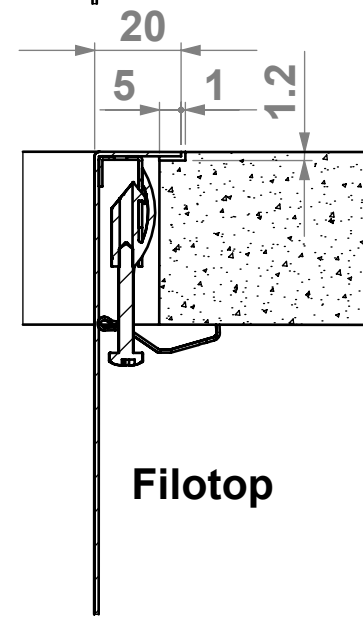

**Filotop**

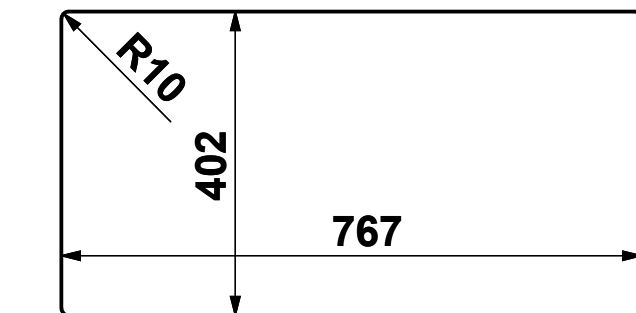

**Foro Sottotop**

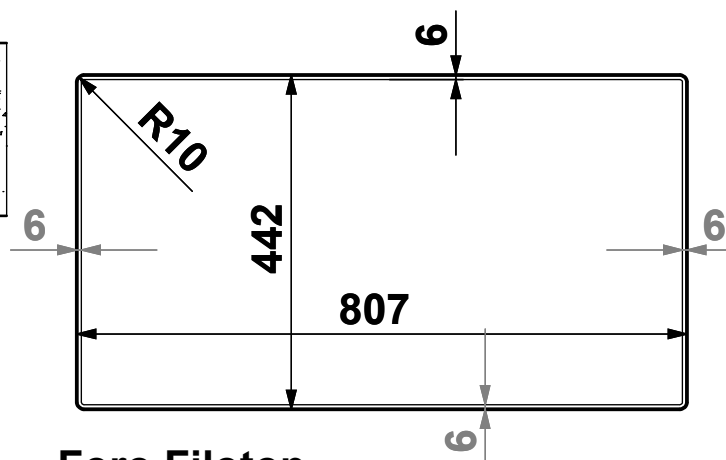

**Foro Filotop**

## Radius 2V90

Materiale	Aisi 304
Spessore	1 mm
Vasca	340 x 400 x 200 mm
Bowl	400 x 400 x 200 mm
Profondità Max	200 mm
Dimensione est.	805 x 440 x 200 mm
Dimensions	795x 430 mm
Foro incasso	(*) 807 x 442 mm
Foro Filotop	767 x 402 mm
Foro Sottotop	767 x 402 mm
Piletta	Ø 3.5"
Base sottotop	90 Cm
Cabinet	
Imballo	915 x 520 x 295 mm 12 Kg
Packaging	

\* Foro con fresata 6x1