

## iQ700, Built-in compact oven with microwave function, 60 x 45 cm, Black CM836GPB6



Shorten your cooking time thanks to varioSpeed and fast preheat. And remote your oven from anywhere with Home Connect.

- ✓ varioSpeed: reduce cooking times by up to 50%.
- ✓ fast preheat: reach the required baking temperature sooner; coolStart: no need to preheat the oven for deep frozen food.
- ✓ TFT Touchdisplay: user-friendly menu navigation with good display features.
- ✓ ecoClean: effortless cleaning thanks to a special coating of the rear wall that automatically disintegrates dirt and reduces odours significantly.
- ✓ Meals (automatic programs): guaranteed success for numerous dishes.

### Features

#### Technical Data

Type of micro-wave oven : MW-Combi  
Type of control : Electronic  
Color / Material Front : Black  
Dimensions : 455 x 594 x 548  
Cavity dimensions (mm) : 237.0 x 480 x 392.0  
Length electrical supply cord (cm) : 150  
Net weight (kg) : 36.033  
Gross weight (kg) : 38.3  
EAN code : 4242003789599  
Maximum micro-wave power (W) : 900  
Connection Rating (W) : 3600  
Current (A) : 16  
Voltage (V) : 220-240  
Frequency (Hz) : 60; 50  
Plug type : GARDY plug w/ earthing

### Included accessories

- 1 x combination grid
- 1 x universal pan

### Optional accessories

- HZ636000
- HZ632070
- HZ631070
- HZ625071
- HZ617000
- HZ327000



4 242003 789599

## iQ700, Built-in compact oven with microwave function, 60 x 45 cm, Black CM836GPB6

### Features

#### Heating Functions

- Compact oven with microwave with 13 heating methods:
- 4D HotAir
- Full width grill
- 4D HotAir Eco
- Half width grill
- Top/ bottom heating
- Top/bottom heating Eco
- Pizza setting
- Low temperature cooking
- coolStart (deep-frozen food special)
- Bottom heating
- Hot air grilling
- Plate warming setting
- Keep Warm
- 
- Additional heating methods with microwave: Pure microwave, Combination microwave and conventional oven
- Intelligent inverter technology: maximum output power will be regulated to 600 W when used in longer operation
- Temperature range 30 °C - 300 °C
- Cavity volume: 45 net usable litres
- Max. Power: 900 W; 5 Microwave power settings (90 W, 180 W, 360 W, 600 W, 900 W) with Inverter (MW)
- Number of shelf levels: 3 PC
- Temperature proposal
- Residual heat indicator
- Actual temperature display
- Sabbath setting
- 
- Drop down oven door, SoftMove oven door with soft open and soft close, SoftOpen
- coolStart

#### Design

- Black Steel Design
- Anthracite enamel cavity with 3 shelf levels
- Rotary Control

#### Cleaning

- EcoClean Direct : back panel

#### Convenience

- 3.7" TFT TouchDisplay
- Meals (automatic programs)
- roastingSensor with three measuring points
- 
- Electronic clock and timer
- Rapid heating-up: automatic
- LED lighting
- Integrated cooling fan

#### Hook-in racks / rails

- Telescopic rails: 1 level telescopic shelf

#### Accessories

- 1 x combination grid, 1 x universal pan

#### Safety and Environment

- Child lock for settings

- Automatic safety switch-off function
- Residual heat indicator
- Start button
- Door contact switch
- 
- Door temperature 40 degrees

#### Technical Info

- HomeConnect ready
- Length of mains cable: 150 cm
- Total connected load electric: 3.6 KW
- Nominal voltage: 220 - 240 V

#### Dimensions

- Appliance dimensions (HxWxD): 455 mm x 594 mm x 548 mm
- Installation dimensions (HxWxD): 450 mm - 455 mm x 560 mm - 568 mm x 550 mm
- Please reference the built-in dimensions provided in the installation drawing

iQ700, Built-in compact oven with microwave function, 60 x 45 cm, Black CM836GPB6

Dimensioned drawings

Installation with a hob.

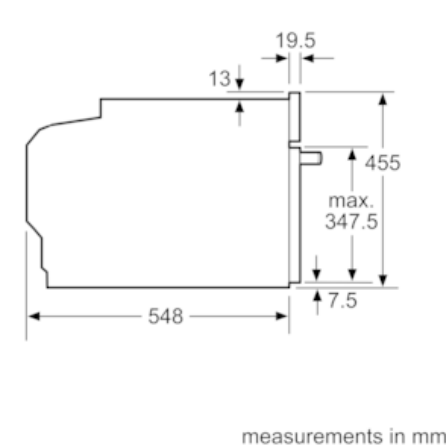
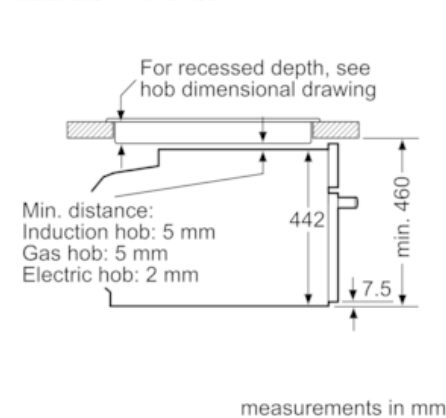

If the compact appliance will be installed underneath a hob, the following worktop thicknesses (including substructure if necessary) must be taken into account.

Hob type	min. worktop thickness	
	fitted	flush
Induction hob	42 mm	43 mm
Full surface Induction hob	52 mm	53 mm
Gas hob	32 mm	43 mm
Electric hob	32 mm	35 mm

