

## STH950X

### 90CM TELESCOPIC RANGEHOOD



EAN 9345025002303

|                  |  |
|------------------|--|
| FINISH           | Stainless steel  |
| INSTALLATION     | Built into cabinetry   |
| Motor            | 250W   |
| Air Capacity     | 770m <sup>3</sup> /hr net  |
| Air Extraction   | Direct to atmosphere or recirculate<br>150mm diameter (6") ducting required  |
| Speed            | 3 + Boost  |
| Noise Rating     | 51–70 dBA  |
| Illumination     | 2 x LED  |
| Filtration       | 2 x Aluminium filters  |
| Delay Stop       | 5-minute delay stop  |
| Cleaning Prompts | Automatic, LED, visual <ul style="list-style-type: none"> <li>• 30 hours for grease filters — wash</li> <li>• 120 hours for charcoal filters — change</li> </ul> |
| Charcoal Filters | Optional, purchasable accessory when recirculating, code for pair 08999801   |
| Warranty         | Two years parts and labour   |

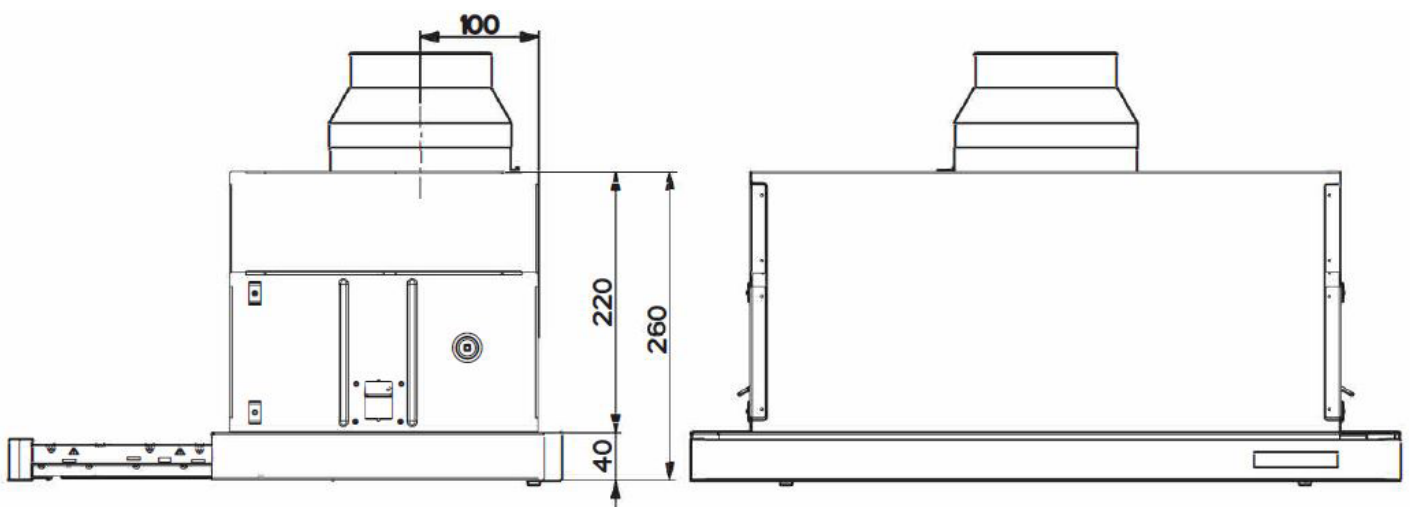

ID210714