

Everdure KILN

INSTRUCTION MANUAL

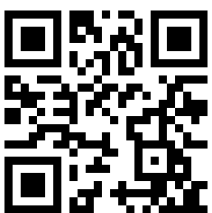

Scan for
further support

CONTENTS

Important Safety Instructions	3
Appliance Details	5
Outdoor Installation Guide	6
Battery Installation	7
Pizza Stone Fitting	8
Gas Connections	9
Operating Instructions	12
Cooking Hints & Tips - KILN P Series	13
Use of the Screen Guide - KILN P Series	14
Care & Maintenance	15
Troubleshooting	16
Specifications	18
Warranty	21

Note; In this instruction manual, the Everdure Kiln will be referred to as an appliance.



**KILN P
BLACK**

EKILNPB



**KILN P
STONE**

EKILNPS



**KILN P
TERRACOTTA**

EKILNPT



**KILN P
GREEN**

EKILNPGR

IMPORTANT SAFETY INSTRUCTIONS:



- DO NOT** operate this appliance before reading the instruction booklet.
- DO NOT** place articles on or against this appliance.
- DO NOT** store chemical or flammable materials or spray aerosols near this appliance.
- DO NOT** operate this appliance indoors.

Remove all packaging materials and dispose of thoughtfully before first use.

IMPORTANT SAFETY INSTRUCTIONS

IMPORTANT: Read the safety precautions of this booklet carefully before removing the appliance from its carton or connecting the appliance to its gas supply. If you are unsure about anything regarding your appliance, please contact Worldwide Appliances in Australia on 1300 694 583 or in New Zealand, please contact Monaco Corporation on (09) 415 6000 before operating your appliance.

1. This gas appliance is intended for OUTDOOR USE ONLY. This appliance must NOT be used indoors.
2. For your safety and enjoyment, read all operating instructions before lighting.
3. Ensure that all gas connections are tight before operating this appliance (refer to leak testing procedure in this manual). Always check for leaks when a gas cylinder / bottle is replaced or reconnected.
4. Unsupervised children or pets should not be near an appliance while cooking or during warm up or cool down. Ensure children or pets are kept a distance well away from the appliance whilst it is in use. Ensure that young children do not play with the appliance. This appliance is not intended for use by young children or infirm persons.
5. Turn gas valve/control knob and gas cylinder valve off after use/remove bottle after use. Do not allow build-up of unburned gas.
6. Never leave the burners on high for more than 30 minutes unless cooking.
7. Do not move this appliance while in use or directly after use, as accessible parts may be very hot. The appliance. Take care that undue pressure will not be placed on the gas hose, or turn off the gas supply & remove the hose from the cylinder or gas source (not at the appliance).
8. People with flammable clothing such as nylon etc. should keep well away from the appliance when it is operating.
9. Do not use this appliance for any purpose other than what it is intended for.
10. Ensure that the product has adequate clearance from combustible materials. The appliance is designed so that heat will not affect the stand. All combustible materials must be kept more than 510mm from the sides and rear of the appliance and more than 900mm above the cooking surface of the appliance.
11. If a burner makes a hissing sound when lit, it may be burning inside. Turn the burner off, allow to cool, and try ignition again. Keep your appliance protected against strong wind – if this cannot be avoided, always check that the burners remain alight if operating the appliance in windy conditions.
12. Do not carry out any servicing on the gas manifold of the appliance yourself – this must only be done by authorised technicians.
13. We recommend that you regularly maintain your appliance and keep it in good condition. This can be achieved by following the cleaning and maintenance suggestions in this booklet.
14. The appliance is designed to be used with either 4kg or 9kg gas cylinders / or approved 500g gas bottle. Keep the cylinder as far away as the hose will allow without undue tension on the hose, in a protected spot (so it cannot be accidentally knocked over).
15. Do not use or store this appliance in areas of high salt content (a marine environment) or an area with caustic fumes or liquids (such as a domestic pool), as these chemicals can cause the appliance materials to deteriorate (and void the warranty). Regular cleaning and covering with a cover can help to reduce this.
16. The appliance is not to be used by persons (including children) with reduced physical, sensory, or mental capabilities, or lack of experience and knowledge, unless they have been given supervision or instruction.
17. The appliance is only to be used with the adaptor provided with the appliance.
18. DO NOT MODIFY THIS APPLIANCE.
19. This appliance shall ONLY be used with a propane cartridge certified to DOT-39 NRC 232/290 M1110, OR a ULPG refillable cylinder certified to AS 2469. IT MAY BE HAZARDOUS TO ATTEMPT TO FIT OTHER TYPES OF GAS CONTAINERS.

WHEN USING AND COOKING IN YOUR EVERDURE KILN OVEN

Do **NOT** leave the burner on HIGH setting for over 30 minutes after ignition. Please refer to COOKING HINTS and TIPS KILN P SERIES page in the instruction manual before use, on preheating, cooking, and after cooking instructions.

FOR GAS SUPPLY CONNECTION:

SAFETY WARNING



Please read these instructions before using your appliance.

- Keep the gas supply hose away from any heated surfaces.
- Ensure the hose shall not be installed in a manner that will allow it to come into contact with the hot surface of the appliance while in use or in storage.
- Only use the gas hose and regulator supplied in this kit.
- For gas hose replacement or spare, contact Everdure (see Page 16).
- Do NOT store a spare LPG cylinder / canister under or near this appliance.
- Do NOT connect a gas cylinder / bottle to an appliance that is not secured on a stable raised surface.

Using a Propane Canister (500g)

- The regulator must be first connected to the appliance inlet.
- Do NOT connect a gas bottle to the appliance that is not secured on a stable raised surface.
- Before connecting gas supply, take care that all gas control knobs are in the OFF position.
- Align the gas cylinder with the gas regulator input and screw the cylinder onto the gas regulator until hand tight.
- Allow the cylinder to rest on the same supporting surface as the appliance.

Using an LPG Re-fillable Cylinder (4kg or 9kg) Hose and Regulator Kit

- Unscrew the propane regulator from the gas inlet of your appliance if installed, and connect the supplied LPG hose and regulator assembly and screw onto the gas cylinder.
- Place the appliance on a stable surface with the gas cylinder positioned as per the below diagram.
- Connect the cylinder to the appliance, via the hose and regulator. Firmly tighten joints, but do not overtighten and do not twist. Take care not to damage the regulator fitting. Check that ALL appliance valves are in the Off position before opening the gas cylinder.
- When changing cylinders, ensure the gas is turned off before disconnecting the hose & regulator assembly from the cylinder only (not from the appliance manifold).
- To achieve the optimum performance from your appliance, an approved gas cylinder (Type 27 fitting) of 4kg or 9kg capacity must be used.
- The Length of the hose must not exceed 1.5m.
- Regulator hose must be kept away from sharp objects and heat sources.

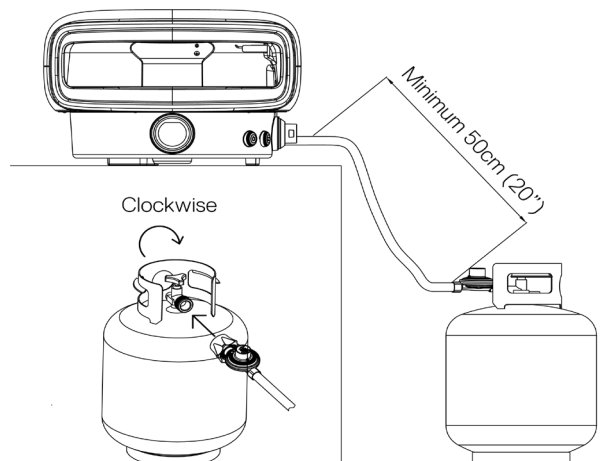

LEAK TESTING

- Make sure the gas control knob is Off and turn the cylinder valve On.
- Check for leaking joints by brushing with solution of half-liquid detergent and half water. If a leak is present, bubbles will appear (or you may hear a hissing sound). Retightening connections can generally repair a leaking joint. You must also check the gas hose and connection at the gas cylinder. If a leak cannot be resolved, do not proceed.

NOTE: Make sure the gas cylinder/bottle is fully protected from the elements. Do not fully enclose the cylinder.

APPLIANCE DETAILS:

Note: the size of the injector diameter is stamped on the hexagon faces (109 = Ø1.09mm injector).

Appliance inlet connection: 9/16"-18 UNF thread.

APPLIANCE	EKILNP
GAS TYPE	ULPG
BURNER PRESSURE	2.75KPA
INJECTOR DIAMETER	1.09mm
HEAT INPUT	14.8MJ

PRODUCT DETAILS	EKILNP
Dimensions (mm)	570 x 510 x 370
Weight NW/GW (kg)	13.1 / 17.5

OUTDOOR INSTALLATION GUIDE:

This appliance shall only be used in an above ground open-air situation with natural ventilation, without stagnant areas, where gas leakage and products of combustion are rapidly dispersed by wind and natural convection. Please note in windy conditions, the pizza oven should be carefully placed so the wind hits the back of the oven to assist with the cooking performance and minimise any possibility of the burner being extinguished.

This appliance must not be used indoors. Do not use your appliance in garages, porches, sheds, or other enclosed areas. The appliance is not intended to be installed in or used on recreational vehicles (e.g., boats, camping vans) and should not be placed close to or under any surfaces that will burn or are sensitive to heat. Do not block/obstruct the flow of air and combustion around the appliance housing while in use.

Any enclosure in which the appliance is used shall comply with one of the following:

- An enclosure with walls on all sides, but at least one permanent opening at ground level and no overhead cover.
- Within a partial enclosure that includes an overhead cover and no more than two walls
- Within a partial enclosure that includes an overhead cover and more than two walls, the following shall apply:
 - a. at least 25% of the total wall area is completely open: and
 - b. at least 30% of the remaining wall area is open and unrestricted.

In the case of balconies, at least 20% of the total of the side, back and front wall areas shall be and remain open and unrestricted.

Minimum clearance from combustible materials:

- Horizontal: 510mm
- Vertical: 900mm

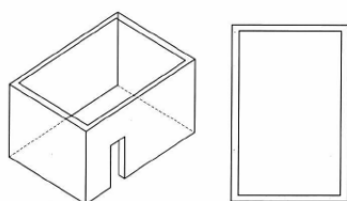

Figure F1 - Outdoor Area - Example 1

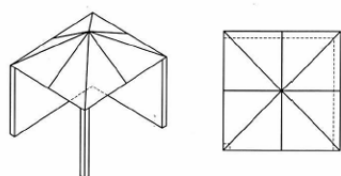

Figure F2 - Outdoor Area - Example 2

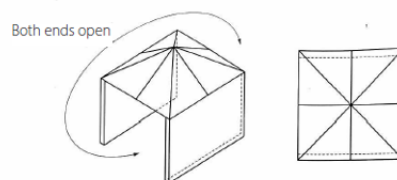

Figure F3 - Outdoor Area - Example 3

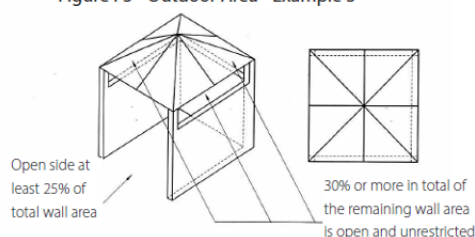
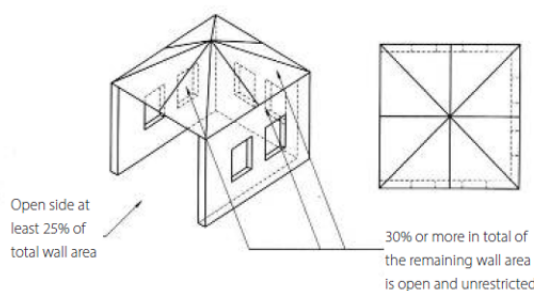
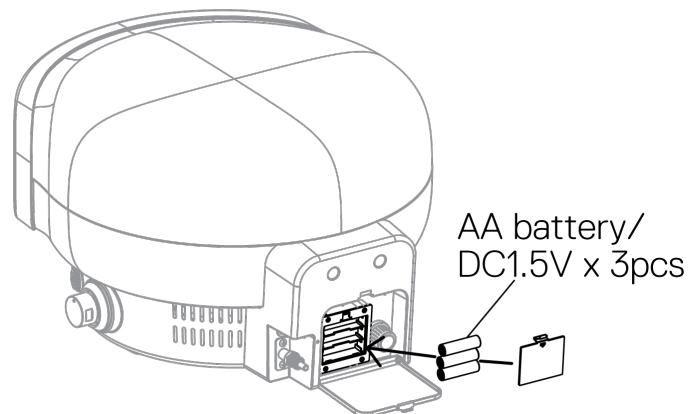
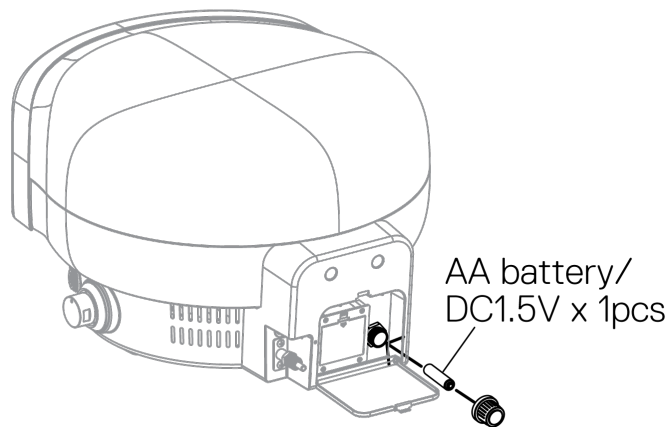
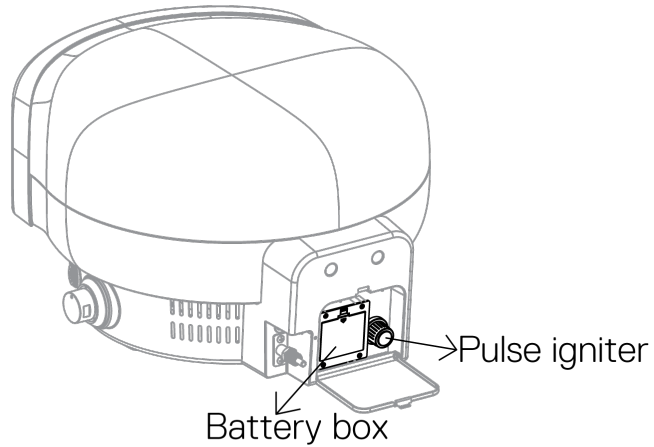

Figure F4 - Outdoor Area - Example 4



BATTERY INSTALLATION

1. Unscrew pulse igniter cap and fit one new AA battery note the (+) and (-) marking refit the cap.
2. Remove the battery compartment cover. Load a set of three new "AA" type batteries so that their plus (+) and minus (-) ends are facing as indicated by the markings. Refit battery compartment cover.
3. Do not short circuit the supply terminals.



PIZZA STONE FITTING

ASSEMBLY

Remove pizza stone from the packaging and fit to the turntable. Included are 3 silicon pizza stone protectors. Please keep these for future use when transporting the stone in the oven.

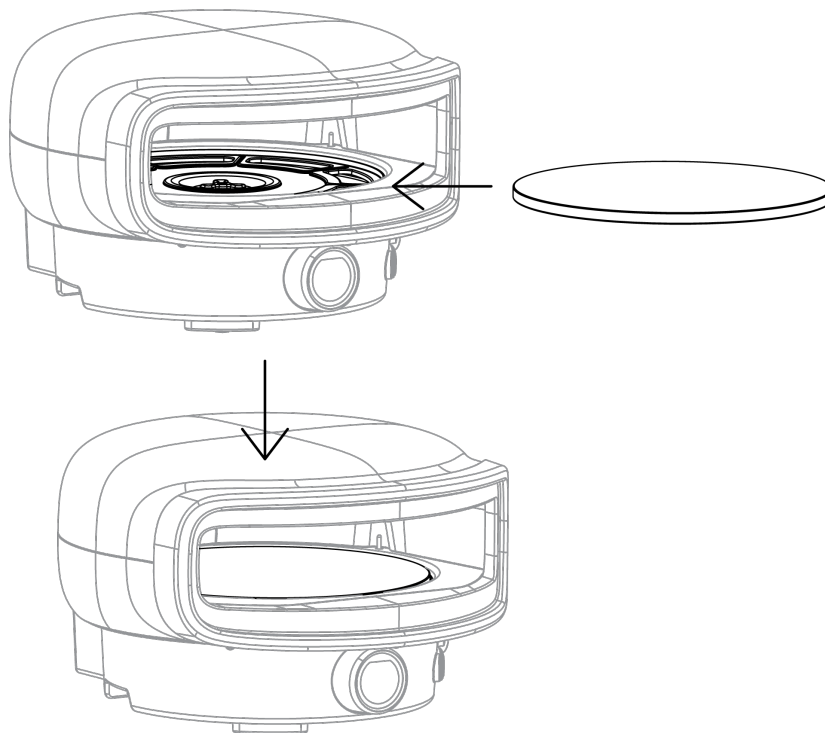

RELEASE MECHANISM

Hold the button located underneath the pizza oven housing to lift the pizza stone, before removing from the housing. (Please note the turntable tray for the stone could impede the lifting of the stone. If so, please turn on the rotating stone for 3 seconds and try again).

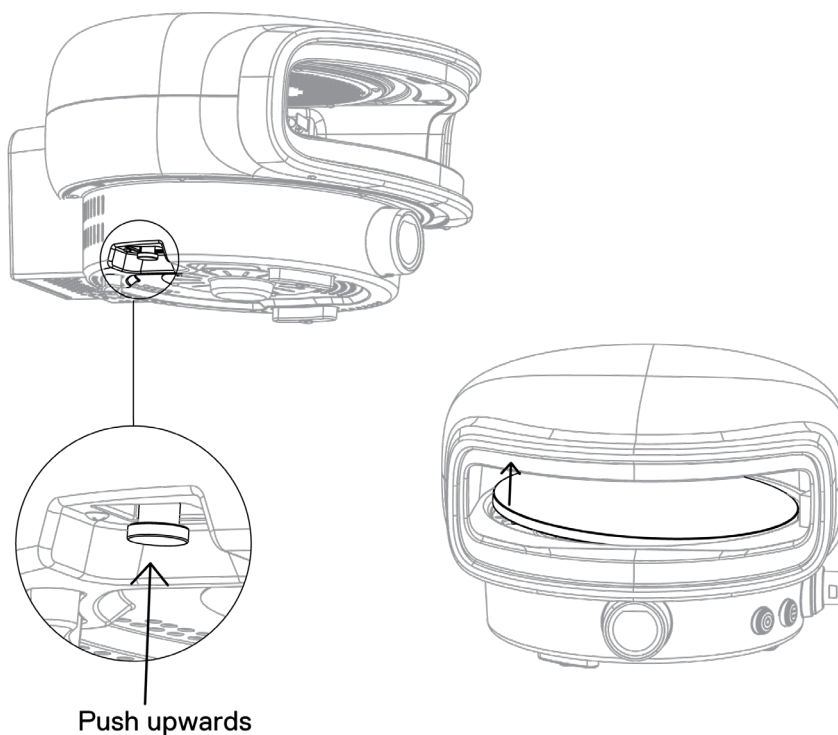

GAS CONNECTIONS

FOR GAS HOSE / CYLINDER CONNECTION

- Only use the hose assembly as supplied for connection to the cylinder - DO NOT USE ADAPTORS.

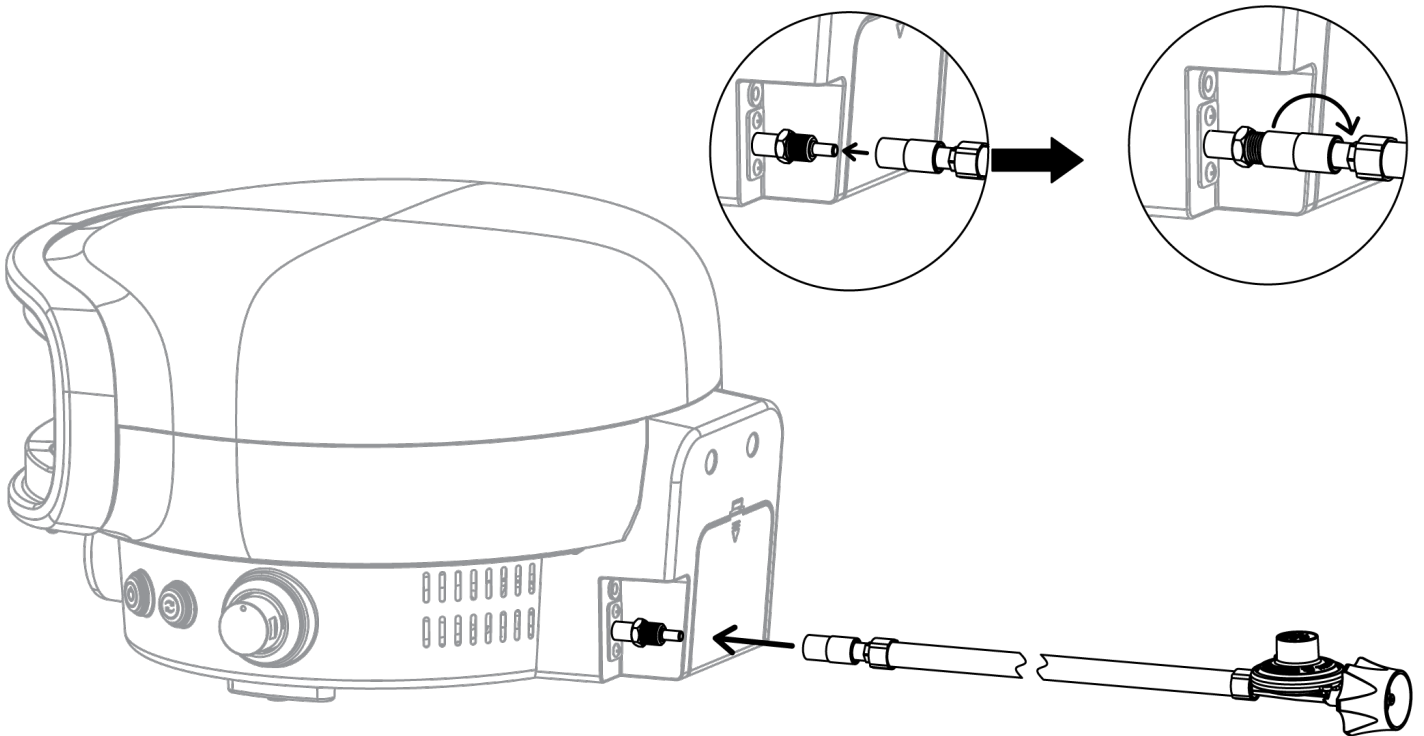

FOR GAS CANISTER CONNECTION

- Before connecting gas supply, take care that the gas control knob is in the OFF position.
- Connect the supplied regulator before screwing on an approved gas canister.

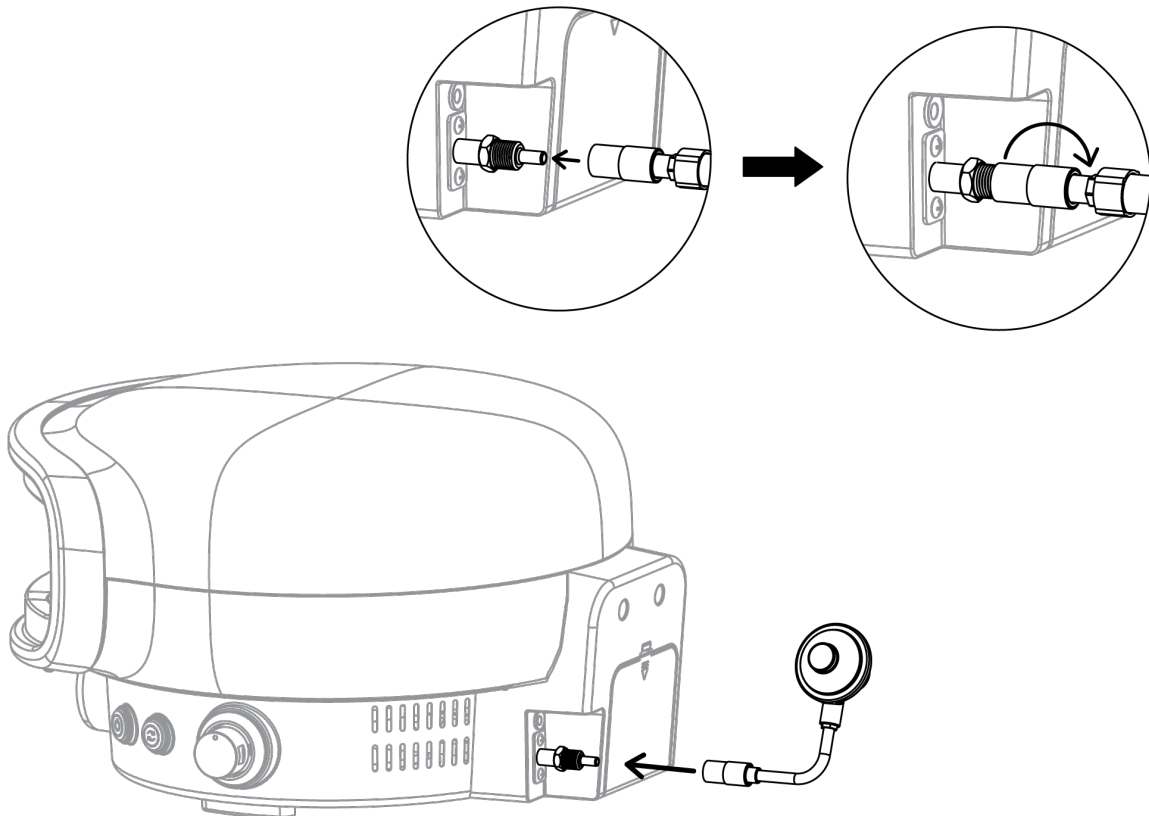

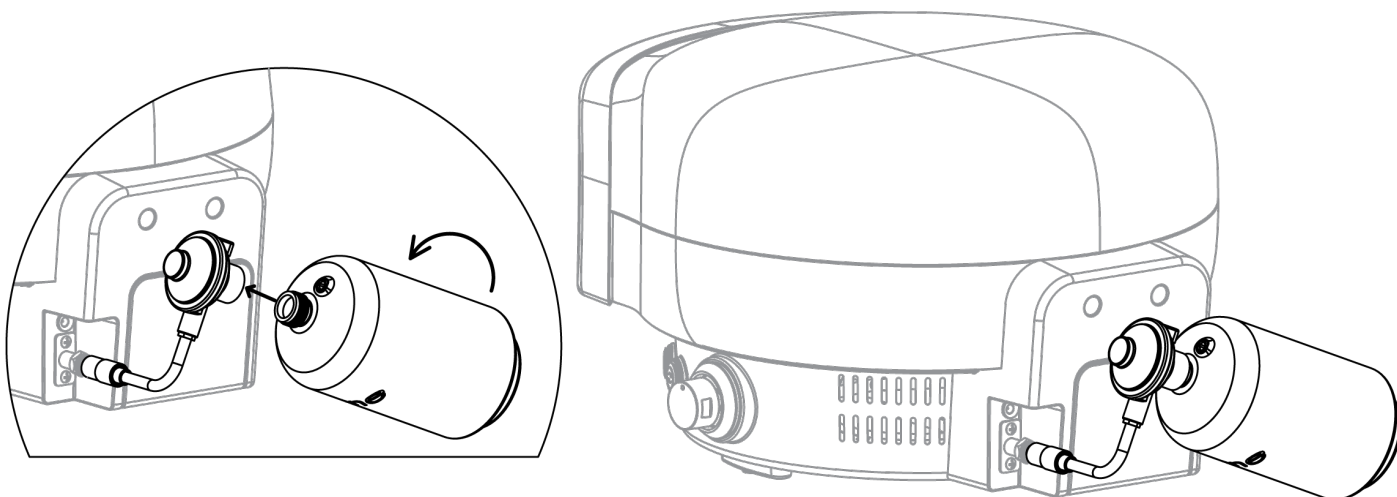
**SAFETY WARNING**

Please read these instructions before using your appliance.

- The configuration of the small gas canister shown (as per below diagram) is the **ONLY** position in which it is to be used.
- The cylinder **MUST** be supported by a flat surface and cannot be suspended in the air, as per below diagram.

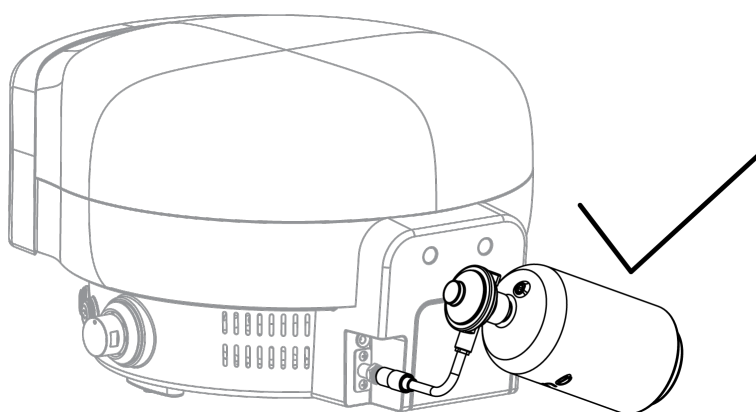
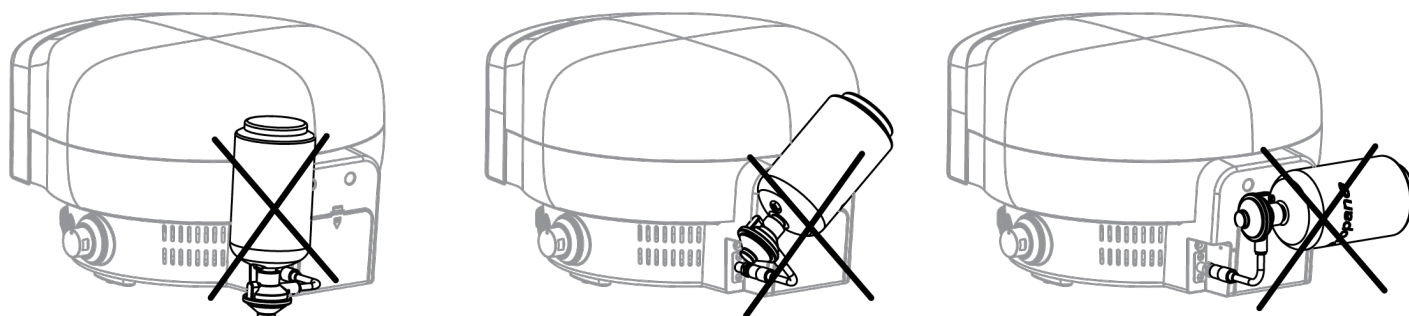
CORRECT USAGE**INCORRECT USAGE**

SAFETY WARNING



Please read these instructions before using your appliance.

This appliance has been fitted with the latest design safety device: a Flow Limiting Gas Regulator. This regulator helps protect the user by reducing the gas flow into the appliance in the case of a gas leak.

For optimum ease of use, please follow the following instructions:

1. Before turning the gas cylinder on, ensure that the burner control knob is at the OFF position.
2. Slowly turn the gas cylinder on until the valve is fully open, and then ignite the appliance as directed in the appliance instruction booklet.
3. If using a gas bottle, ensure the supplied regulator is securely attached to the appliance and that the burner control knob is at the OFF position, before attaching the gas bottle to the regulator.

Failure to observe these instructions may result in the flow limiting device to lock up at a reduced gas flow rate. This is generally observed as a reduced flame from the burners or an increase in the cooking time.

If the appliance is found to be operating at a reduced rate, check the following items:

1. Check that there are no gas leaks (follow the instructions in the appliance instruction booklet).
2. Check that the gas cylinder is turned on.
3. Check that the gas cylinder is not empty.

If all three points are ok, these are the following instructions to reset the flow limiting device:

1. Turn the appliance control to OFF.
2. Turn the gas cylinder fully off.
3. Wait 30 seconds for the flow limiting device inside the regulator to reset.
4. Slowly turn the gas cylinder back on until fully open, and then ignite the appliance as directed in your appliance instruction booklet.

If after following these instructions, you are still having problems with the appliance running at a reduced capacity, please contact Everdure in Australia on 1300 694 583 or in New Zealand on (09) 415 6000 before operating your appliance.

OPERATING INSTRUCTIONS:

Once your regulator is connected, open the gas from your gas cylinder. If using a canister attach to the supplied fitting.

First-time use

It is highly recommended prior to cooking on your appliance for the first time that you conduct a burn-off. Turn the burner on high for 30 minutes. You may notice smoke coming from the oven, this is normal and part of the burn-off process. Afterwards, turn off the burner and let the oven cool down naturally. Once the appliance has cooled, use a paper towel to wipe the inside of the appliance to remove any soot from the burn-off.

Be careful the oven may still be hot in some places.

KILN P Series

To ignite the burner, push the knob in and slowly turn it anti-clockwise until you hear a clicking of the ignition. This should take at least 8-10 seconds as you allow the gas to flow into the burner inside the appliance. Hold in for another 10 seconds after ignition, then release. Set the burner to your desired requirement. Press the button for the turntable to begin rotating inside the appliance. If the burner does not light, leave the knob at OFF and wait 5 minutes before retrying. **WARNING:** Do not leave the burner activated for an extended period of time without the turntable running, as this may cause damage to the stone.

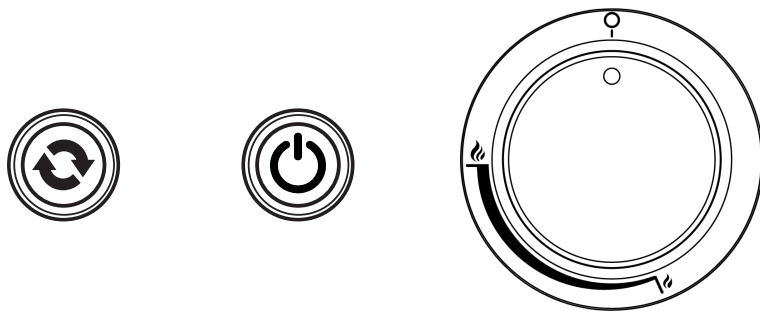

Symbol	Description
	OFF Position
	Turntable Rotation
	Power Button

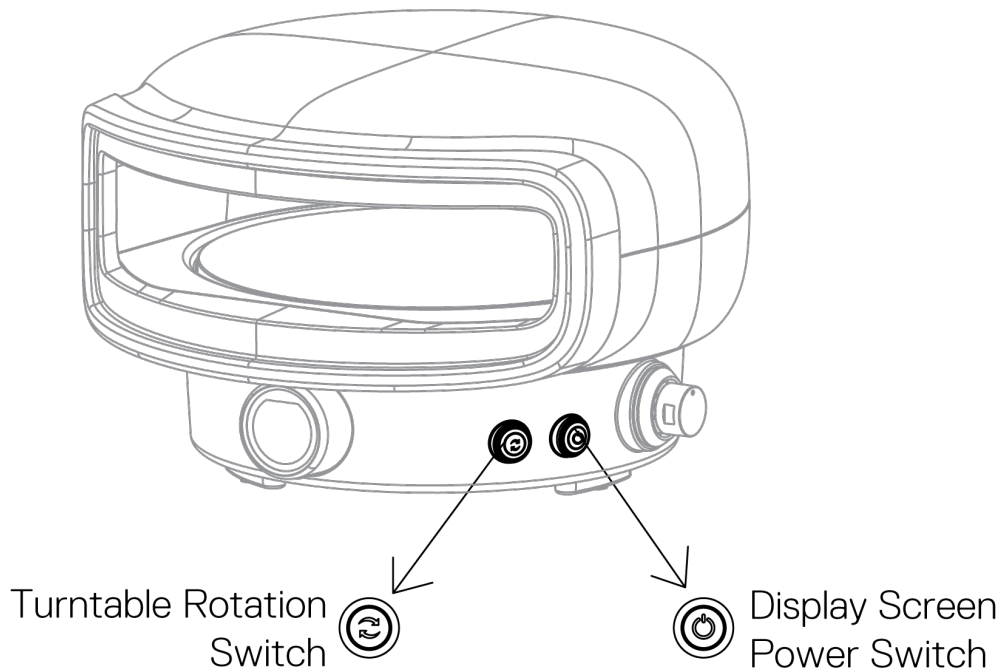

COOKING HINTS AND TIPS - KILN P SERIES

Preheating

Press the turntable switch and ignite the burner. It is recommended to leave the burner on high for a minimum of 10 minutes to allow your oven and stone to heat up. To determine if the stone has reached the desired temperature, refer to the information shown on the appliance display. Do not leave the burner on without the turntable rotating.

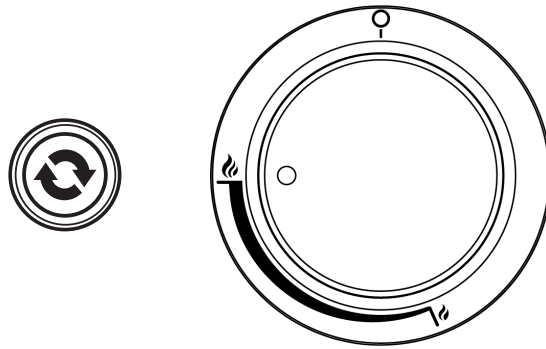

Cooking

When the appliance has reached your desired cooking temperature, turn the burner knob to halfway.

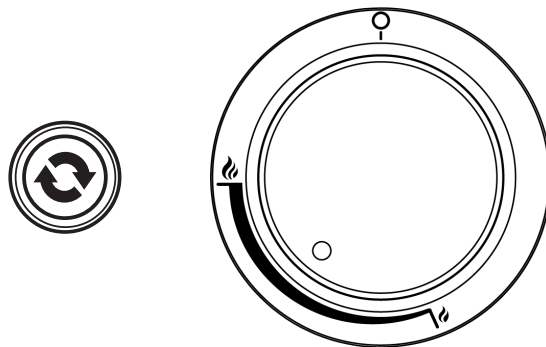

After Cooking

Once you have cooked on the appliance, just before you go to eat and if you are continuing to cook more, turn the burner down to the low setting. If you have finished cooking on the appliance, turn the burner off. Running the appliance for an extended period of time with the burner on high setting could result in damage to your appliance.

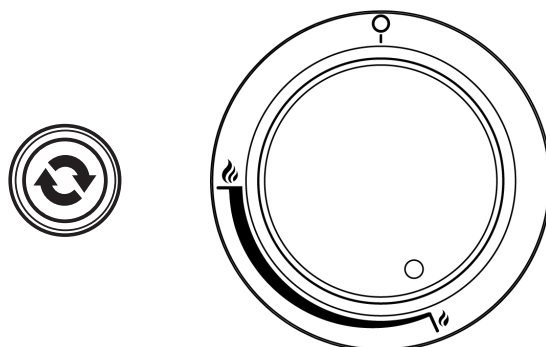

USE OF THE SCREEN GUIDE - KILN P SERIES

Once your screen power is on, the screen operates accordingly:

Screen Layout

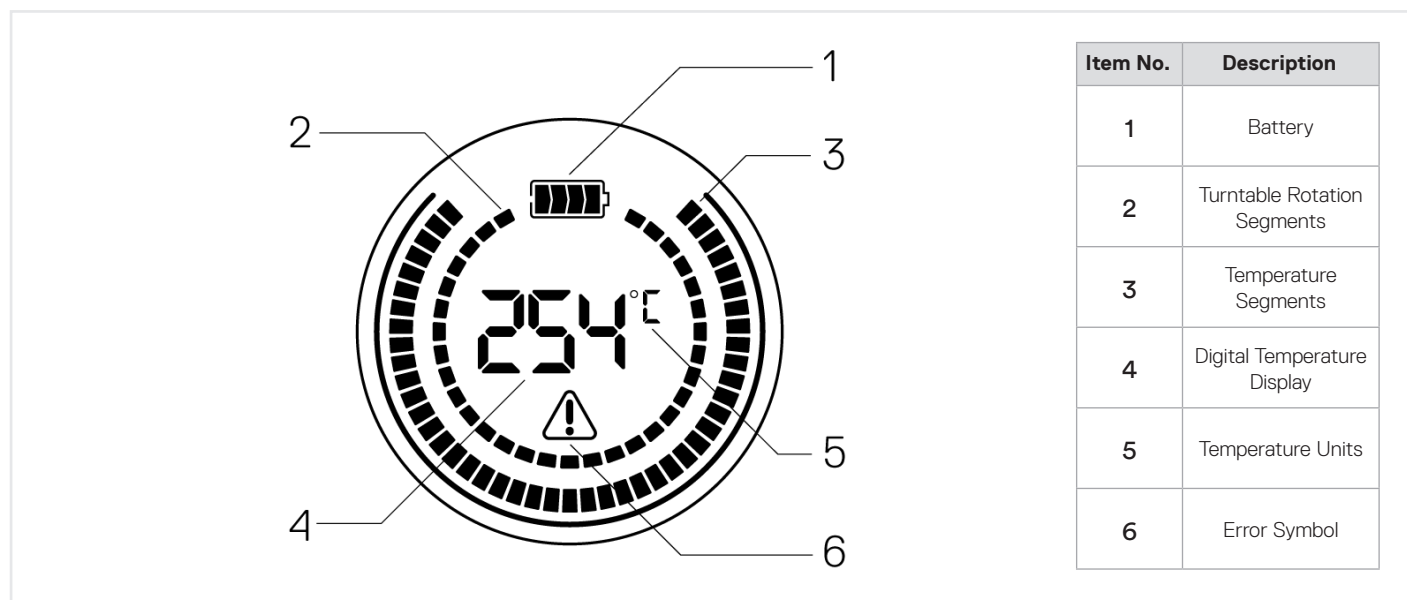

Temperature Display

- To change between degrees **CELSIUS** and **FAHRENHEIT**, press the button situated underneath the LCD screen housing.

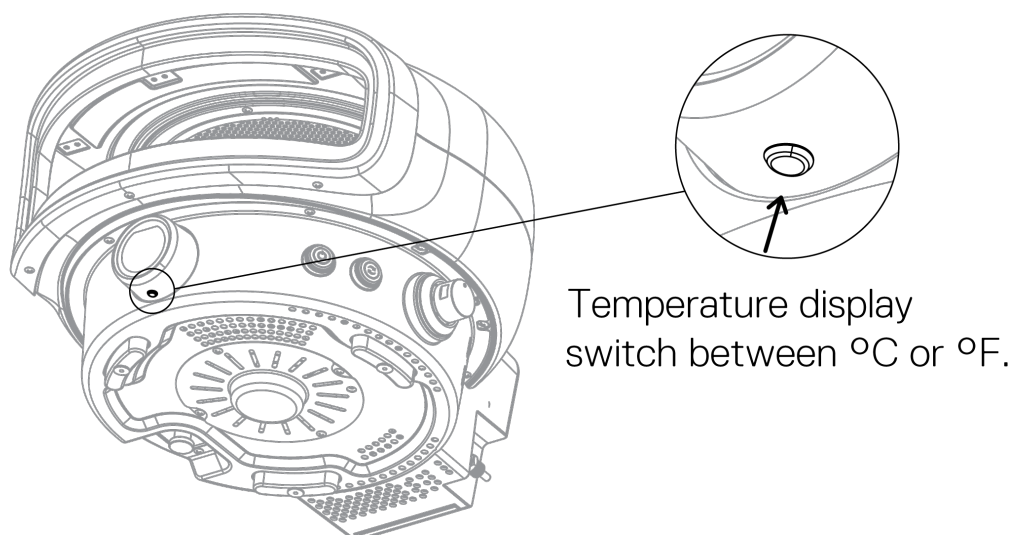

Battery Status Icon



- Battery indicator represents the battery level status and will flash the last segment when batteries need to be changed. (Function may be reduced when batteries are low)

CARE & MAINTENANCE:

EXTERNAL CLEANING

- Before cleaning the exterior, ensure the appliance has cooled and is safe to touch.
- Painted and plastic surfaces can be cleaned using a mild household detergent or cleaner and a clean cloth (do not use scourers or harsh detergents).
- It is advisable to test cleaners on a small section of the appliance first. **NEVER** use paint thinners or similar solvents for cleaning, and **NEVER** pour cold water over hot surfaces.
- Dry the surface afterwards.

INTERNAL CLEANING

- Before cleaning the internal parts, ensure the appliance has cooled and is safe to touch.
- The inside of the appliance can be cleaned by using some water, mild detergent and a sponge or mild scouring pad.
- For hard-to-clean areas, use a little baking soda on a wet sponge. **DO NOT** use abrasive cleaners.

CORDIERITE PIZZA STONE CARE

- This pizza stone is designed to be used in the Everdure Kiln only.
- Only use water to clean the pizza stone. **DO NOT** submerge in water, using soap will leave residue in the pores of the stone.
- Take care of the pizza stone as it is fragile and could break if bumped or dropped.
- Be careful handling the pizza stone as it can retain heat for many hours after cooking.
- **DO NOT** cool the stone with water when the stone is hot; this could crack and damage the pizza stone.
- After cleaning the pizza stone with water, thoroughly dry the stone before use.
- When transporting your appliance, please use the 3 silicon pizza stone protectors to ensure the stone is safe and secure. (Please ensure the stone has cooled down before fitting these protectors).

LCD DISPLAY CARE

- **DO NOT** use soapy liquids to clean the contacts or screen.
- Wipe screen glass with a clean cloth or gentle rag **DO NOT** use abrasive materials or cleaning solvents.

MAINTENANCE

- Regularly check all gas hose and line connections for damage, cuts or cracks each time before use of the appliance.
- Leak test with soapy water before first use and at least annually. Always check when replacing the gas cylinder/bottle.
- Check the burners regularly for insect mess from spiders, ants etc, if any signs clean before operation.

BATTERIES DO'S & DO NOT'S

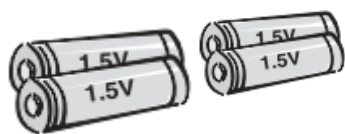

- Dispose of used batteries carefully to ensure that a small child does not consume them.
Please seek medical attention immediately if batteries are consumed.
- **DO NOT** mix new batteries with old batteries. This may cause the batteries to overheat and leak.
- **DO NOT** place non-rechargeable batteries in a charging device.
- **DO NOT** disassemble, crush, puncture, or otherwise damage batteries. This can result in leakage or rupture.
- **DO** preserve battery life by switching off a device and removing the batteries when it's not being used and is not expected to be used for extended periods of time.
- **DO** use the specified type of battery (AA Batteries).
- **DO** insert the batteries properly. Follow the symbols showing the correct way to position the positive (+) and negative (-) ends of the batteries.
- **DO** immediately remove exhausted batteries from your device and dispose of them properly.

TROUBLESHOOTING:

Burner will not ignite when using the igniter:

Cylinder valve is not on	Turn cylinder valve on
Cylinder is empty	Replace with a full cylinder
Igniter button is not working	Check battery
Igniter is not sparking	Contact the Service Centre

Burner flame is erratic:

Flame is burning inside burner (hissing sound)	Turn off burner, allow to cool and re-ignite
Regulator is faulty	Contact the Service Centre
Injector is partially blocked	Clean injector with a toothbrush. Do not drill out or use wire. Do not remove the injector. Contact the Service Centre

Gas is leaking from connections:

Connections are loose	Tighten loose connections (do not over-tighten) and leak test under pressure with a soapy water solution (page 2)
Hose has deteriorated	Replace hose (Contact the Service Centre)
Gas valve is faulty	Contact the Service Centre
Threads are damaged	Contact the Service Centre

Turntable not working:

Turntable not turning	Check if batteries are fitted and are properly installed in the battery compartment. Check if batteries are full of charge and replace if needed.
Turntable is broken	Contact the Service Centre
Switch or wiring damaged	Contact the Service Centre

TROUBLESHOOTING:

The screen has no display:

The screen is not on	Turn on the screen at the power button.
The screen does not turn on	Make sure that the batteries are inserted correctly into the battery compartment. Check that the batteries are fully charged and replace if necessary.
Screen is damaged	Contact Everdure.
The screen is faulty	Check that the batteries are fully charged and replace if necessary.

Error codes indicated on LCD display:

<p>Error symbol, indicated on temperature display as:</p> 	<p>Temperature sensor (located in main oven enclosure) may be faulty.</p> <p>Contact Everdure.</p>
--	--

SPECIFICATIONS:

PRODUCT	KILN P
Dimensions (mm)	570 x 510 x 370 (mm)
Weight NW / GW	13.1 / 17.5 (kg)

Power supply KILN P Series

MODEL	SPECIFICATION	REMARK
	Battery Power – Main Power: 4.5VDC (3x AA), 300mA Ignition: 1.5VDC (1x AA)	

KILN P SERIES - AU

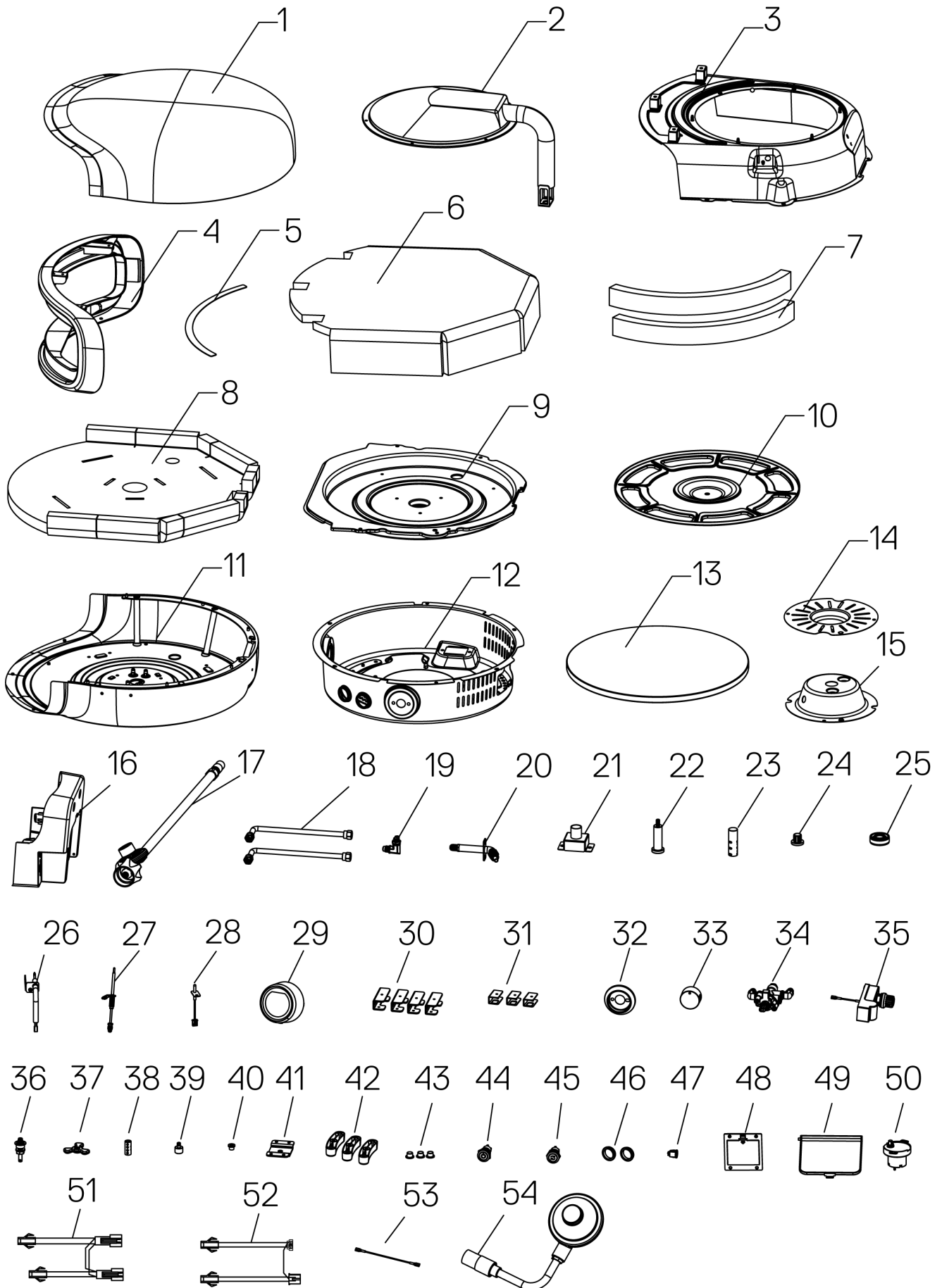

KILN P SERIES - AU

NO.	PART NAME	NO.	PART NAME
1	Upper housing	28	Temperature probe
2	Burner assembly	29	Digital display
3	Upper firebox	30	Lower firebox bracket
4	Fascia	31	Inner firebox bracket
5	Upper fascia insulation	32	Bezel
6	Upper housing insulation	33	Knob
7	Lower firebox insulation	34	Valve body assembly
8	Lower housing insulation	35	Pulse igniter
9	Lower firebox	36	Support shaft
10	Turntable	37	Locking nut
11	Lower housing	38	Shaft
12	Base cover	39	Coupling
13	Pizza stone	40	Bearing Housing
14	Inspection cover	41	Slide bracket
15	Motor mounting plate	42	Foot
16	Rear housing	43	Foot grommet
17	Gas hose & regulator (Type 27)	44	Power switch
18	Gas pipe	45	Turntable switch
19	Gas jet	46	Power cable grommet
20	Connection assembly	47	Power socket
21	Control box bracket assembly	48	Battery box
22	Stone ejection extension	49	Rear cover
23	Support tube	50	Motor
24	Stone ejection button	51	Wire harness display & motor
25	Bearing	52	Switch harness power & turntable
26	Ignition electrode	53	Ignition wire
27	Thermocouple	54	Gas regulator (BOM Fitting)

PRIVACY POLICY

Privacy policy: Everdure is committed to protecting your personal privacy. Your personal information that you have provided in this form (e.g., name, street address, e-mail address and telephone/mobile number) is used solely by Everdure for the express purpose for which it was collected (e.g., to respond to your enquiry regarding your product). Your personal information will be processed by Everdure in accordance with the guidelines and requirements of the Privacy Laws of Australia (Privacy Act 1998).

For a full copy of Everdure's Privacy Policy, please e-mail marketing@worldwideappliances.com.au in Australia or customercare@monacocorp.co.nz in New Zealand or call **1300 694 583** in Australia or **(09) 415 6000** in New Zealand.

WARRANTY

AUSTRALIAN CUSTOMERS

Our goods come with guarantees that cannot be excluded under the Australian Consumer Law.

You are entitled to a replacement or refund for a major failure and compensation for any other reasonably foreseeable loss or damage.

You are also entitled to have the goods repaired or replaced if the goods fail to be of acceptable quality and the failure does not amount to a major failure.

NEW ZEALAND CUSTOMERS

Nothing herein contained shall be construed in any way as excluding or limiting your rights under the Consumer Guarantee Act 1993.

OUR WARRANTY

Subject to the following conditions, this product is also covered by the manufacturer's warranty from the date of purchase, covering all parts and labour for the period listed below (Our Warranty). Our Warranty (which is subject to the conditions below) covers rectification free of charge of any fault arising from defected materials or components, or faulty workmanship. The product will be repaired or replaced at the option of Everdure, but all costs of installation, removal, cartage, freight, travel expenses and insurance are to be paid by the claimant. Our Warranty is subject to products being used for domestic household use. Our warranty operates in addition to (and does not exclude, restrict, or modify) any rights or remedies to which you may already be entitled to under the Australian Consumer Law or any consumer guarantee law relating to this product.

WHAT IS COVERED: By Our Warranty

During the warranty period your appliance will be repaired free of charge by Everdure, or its authorised service centre provided your appliance is delivered to and picked up from Everdure or its authorised service centre, subject to terms and conditions below.

It is recommended that exposure of the appliance to the elements should be minimised. After your appliance has cooled and has been cleaned, store it under cover with a weatherproof cover over it.

APPLIANCE COMPONENT	WARRANTY PERIOD
Stainless Steel Parts	2 years
Enameled Parts Powder Coated Panels Cooking Stone & All Other Assemblies / Parts	2 years

WHAT IS NOT COVERED: BY OUR WARRANTY

- Any defect or failure caused by the product not being assembled or used in accordance with the instruction/installation manual provided with the product.
- Normal fair wear and tear (e.g., surface rust, stone chipping, heat discolouration)
- Insect or vermin infestation.
- Unauthorised repairs or use of non-genuine Everdure parts.
- Products scratches & damage as a result of delivery, installation, or assembly
- Claims to product surface coatings due to accidental damage, improper or lack of maintenance, damage from cleaning products not recommended by Everdure.

HOW TO CLAIM WARRANTY

You will need to contact Everdure in Australia or New Zealand using the enclosed contact details. Please make sure you have the following information on hand:

- Product Name/Model Number
- Serial Number
- Purchase Date (as per invoice, or proof of purchase)
- Place of Purchase

IN AUSTRALIA

Worldwide Appliances Pty Limited
ABN 45 868 077 422
Customer care: 1300 694 583
Web: <https://wwa.com.au/#asr>

IN NEW ZEALAND

Monaco Corporation Ltd
Phone: (09) 415 6000
Email: customercare@monacocorp.co.nz

Everdure KILN

www.everdure.au

IM REF: EKILN P AU REV2.0