

PR1102

Professional Series

Oliveri®

RIGHT HAND BOWL SINK

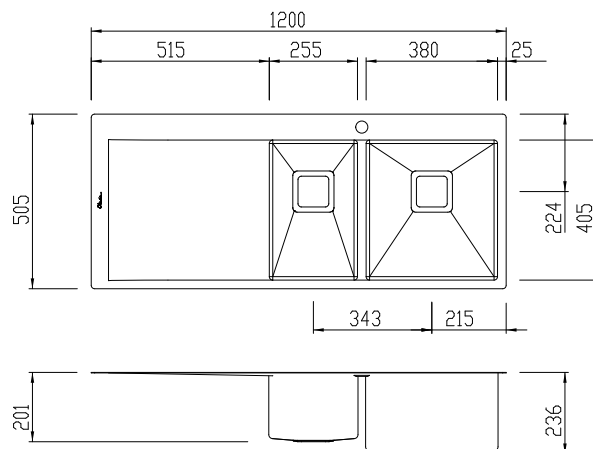

INCLUDED ACCESSORIES

AC175Q



ACP141



ACPSQ3



ACPSQ6



RECOMMENDED TAPWARE

TN2010



KE2030



OPTIONAL ACCESSORIES

ACP105

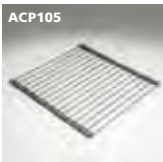

ACP126



ACP136



ACSWDK



AC29



International collection™

Designed and engineered to our specifications and quality standards. Sourced from our international supplier.

SPECIFICATIONS

Description

1 & 1/2 bowl inset sink with drainer

Sink Size

1200W x 505H

3/4 Bowl

380W x 405H x 225D / 35L

1/2 Bowl

255W x 405H x 190D / 20L

Construction

Fabricated with 10mm radius corners, Softtone™ and soundproofing.

Material

304 grade, 18/10 brushed stainless steel (1.5mm thick)

Installation

Inset recommended.

Fixings

Topmount clips supplied

Cut Out Template

1180 x 485 x 10mm radius

Min Cabinet Size

800mm

Tap holes

Available 1 tap hole only

Waste fittings

2 x 90mm square basket wastes included

Overflow

Not available

Carton Size

1300 x 595 x 290mm

Weight

20.0kg

Warranty

Lifetime manufacturer's warranty (refer to oliverisinks.com)

For more information call **1300 13 7465** or visit **www.oliverisinks.com**



facebook.com/
OliveriAU



twitter.com/
OliveriAU



pinterest.com/
OliveriAU

© Registered trademark of Tasman Sinkware. Under its policy of ongoing product development Tasman Sinkware may from time to time change product specification without notice. All dimensions given are approximate and should be checked prior to installation. See Oliveri installation instructions for installation details.