

**Serie | 8, Washing machine, front loader, 9 kg, 1400 rpm
WAW28620AU**



Optional accessories

WMZ20490 : Platform with pull-out

Know exactly how much energy a selected program will use with EcoProjection and let the intelligent i-DOS dosing system dispense the precise amount of detergent for every wash.

- i-DOS automatic dosing system dispenses the precise amount of liquid detergent for a perfect wash
- **EcoSilence Drive™**: extremely energy-efficient and quiet in operation with an especially long life.
- **VarioPerfect™**: high performance programmes which allow you to clean your laundry with up to 50% less energy or reduce cleaning time by up to 65%
- 4.5 Energy Stars and 4.5 Star water rating reduces environmental impact, and cuts down on running costs.

Technical Data

Built-in / Free-standing :	Free-standing
Height of removable worktop (mm) :	850
Dimensions of the product (mm) :	848 x 598 x 590
Net weight (kg) :	82.033
Connection Rating (W) :	2300
Current (A) :	10
Voltage (V) :	220-240
Frequency (Hz) :	50
Approval certificates :	Australia Standards, CE, VDE
Length electrical supply cord (cm) :	160
Capacity cotton (kg) :	9.0
Energy efficiency class :	"blank"
Total annual energy consumption (kWh) :	269.0
Water consumption (l) :	77
Door hinge :	Left
Wheels :	No
EAN code :	4242005035304
Capacity cotton (kg) - NEW (2010/30/EC) :	9.0
Energy consumption (kWh) :	0.74
Spin drying performance class :	B
Maximum spin speed (rpm) :	1400
Noise level washing (dB(A) re 1 pW) :	47
Noise level spinning (dB(A) re 1 pW) :	71
Installation typology :	Freestanding



Serie | 8, Washing machine, front loader, 9 kg, 1400 rpm WAW28620AU

Know exactly how much energy a selected program will use with EcoProjection and let the intelligent i-DOS dosing system dispense the precise amount of detergent for every wash.

Capacity

- Capacity: 9 kg

Consumption rates

- 4.5 Energy Stars
- 4.5 Water Stars (WELS)
- 77 l water consumption per wash and 269 kwh Energy Consumption p.a. on Cotton 60C, Eco Perfect, RinsePlus, 1400 r/min wash program

Programmes

- iDos - Program for automatic dosing whereby a sensor measures the level of soiling of the wash load and dispenses the exact amount of detergent
- Special programmes: Cottons, Easy Care, Mix, Delicates, Wool, Quilt, Rinse/Spin, Drain, Drum Clean with reminder, Super 15'/30', Sportswear, Night Wash, Shirts
- Night wash program with lower noise suitable for washing during the night or when an extra silent wash is required
- Touch control buttons: On/Off, Prewash, Rinse Plus, Easy Iron, Spin speed adjust, Ready in, Temperature Selection, SpeedPerfect, EcoPerfect, Start/Pause with Reload function, i-Dos 1: Liquid detergent, i-Dos 2: Fabric Softener
- DrumClean with reminder function

Performance

- i-DOS automatic dosing system dispenses the precise amount of liquid detergent for a perfect wash
- EcoSilence Drive™ friction-free motor minimises heat and wear for long-lasting performance, quiet operation and perfect wash results.
- VarioPerfect™: high performance programmes which allows you to clean your laundry with up to 50% less energy or reduce cleaning time by up to 65%
- EcoProjection provides information on how much energy/water will be used for a selected program
- VarioDrum's breakthrough wave-droplet design provides a thorough yet gentle clean for fine textiles
- AntiVibration Side Panels reduce vibrations and noise levels, making it extremely quiet during the spin cycle
- Unbalanced load detection to minimise unnecessary vibration, noise and friction
- Maximum spin speed: 1400 (rpm)

Design

- Large LED display screen to indicate: Programme status, Temperature and Spin Speed Selection, Remaining Time and 24 h End Time Delay, Load Recommendation and Energy & Water Consumption Indicator for program selected
- Control dial with integrated On / Off mode

Convenience

- Reload function to pause machine operation for adding forgotten laundry items
- Turbidity sensor measures degree of soiling for clothes and prescribes an extra rinse for a thorough clean
- Self-cleaning detergent drawer to remove detergent residue
- 32 cm porthole, 171° swing door for easy loading and unloading of laundry
- End of cycle indicator

Safety

- Advanced AquaSecure™ self-sealing hose to minimise risk of flooding
- Child-proof lock

Technical Information

- Dimensions (H x W x D): 84.8 cm x 59.8 cm x 59.0 cm (63.2 cm with door frame)

**Serie | 8, Washing machine, front loader, 9
kg, 1400 rpm
WAW28620AU**

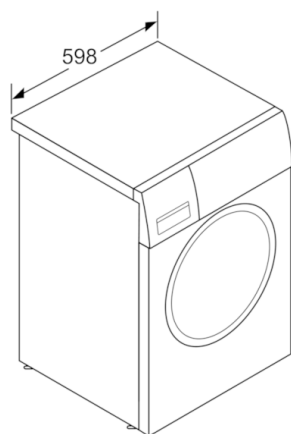

measurements in mm

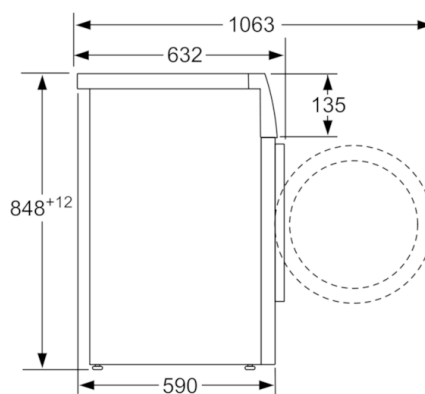

measurements in mm