

Foro Sopratop

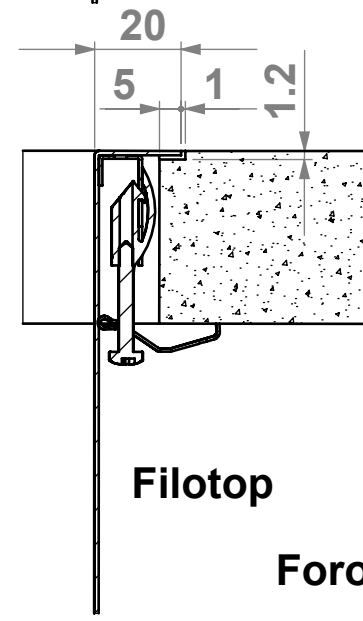
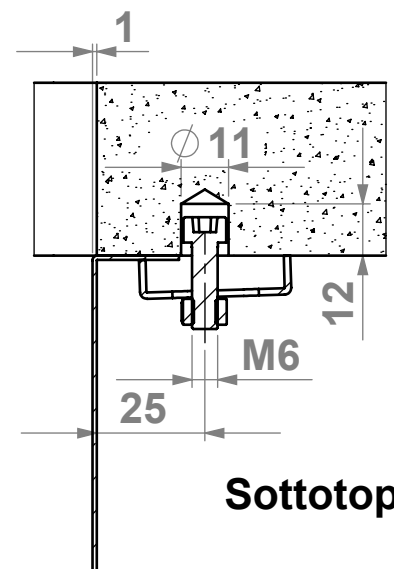

Foro Filotop

Radius 34

Materiale	Aisi 304
Material	
Spessore	1 mm
Thickness	
Vasca	340 x 400 x 200 mm
Bowl	
Vasca	340 x 400 x 200 mm
Bowl	
Profondità Max	200 mm
Depth	
Dimensione est.	380 x 440 x 200 mm
Dimensions	
Foro incasso	370 x 430 mm
Cut-out	
Foro Filotop	(*) 382 x 442 mm
Cut-Filotop	
Foro Sottotop	342 x 402 mm
Cut-Undertop	
Piletta	Ø 3.5"
Drain	
Base sottotop	60 Cm
Cabinet	
Imballo	515 x 455 x 295 mm 6,3 Kg
Packaging	

* Foro con fresata 6x1

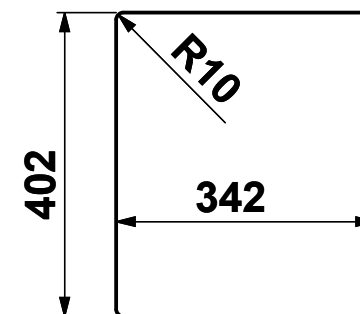

Foro Sottotop

