



ECONOVA DATA SHEET

- ✓ High quality, efficient and energy saving
- ✓ Industry leading technology and innovation

ECON-300FREC-W



Model Specifications	ECON-300FREC-W
Wi-Fi	Yes
1st Hour Delivery	>300 Litres
Tank Volume	290 Litres
Compressor Input Power	750 Watts
Suitable for Rooms	3 to 5
Recovery Rate	89 Litres/Hour
Set Hot Water Temperature	68°C
Heat Pump Heating Capacity	3750 W
COP *	5.0 W/W
Booster Element Heating Capacity	3600 W
Fittings (Inlet & Outlet)	20mm / G ¾
Return Inlet	N.A
Height	1823 mm
Width	570 mm
Heat Pump Height	545 mm
Heat Pump Width	780 mm
Heat Pump Depth	260 mm
Circuit Breaker Amps	20
Power Supply	220-240V/50Hz
Operating Temperature Range	-7°C ~+43°C
Refrigerant Type	R290
Protection Ranking Class	IPX4
Max. AMPS	20



* All listed specifications are measured at inlet water temperature +14°C; Dry Bulb Temperature +19°C, wet bulb temperature 15°C, and hot water set point 55°C. Recovery rates vary with environmental conditions.

This water heater features fully welded enamel tank meeting the design requirements: AS/NZS 2712 and AS/NZS 60335.2.40. This water heater complies with AS 3498 and AS/NZS 1677.2

* Hot water temperature is limited to 68°C

Drawings

ECON-300FREC-W

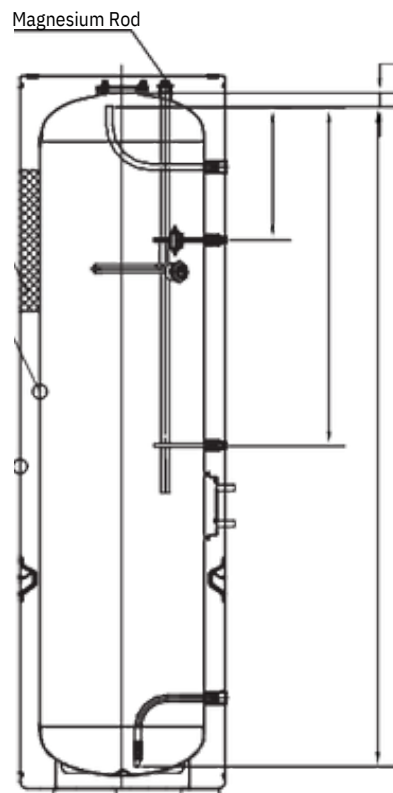
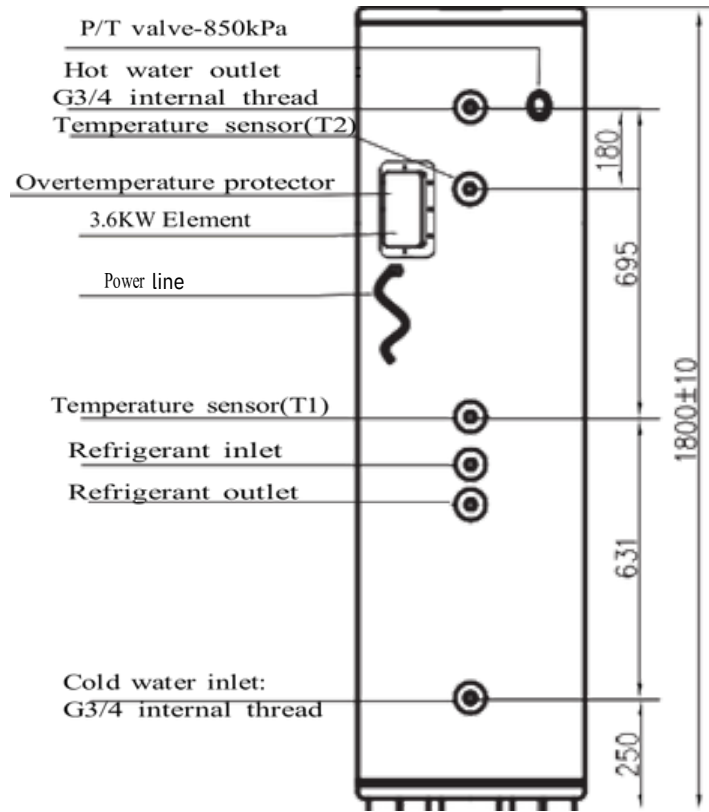

Drawings

ECON-300FREC-W Exploded View

WARNING DO NOT OPEN
Only ECONOVA® or licensed tradesperson can open this unit.

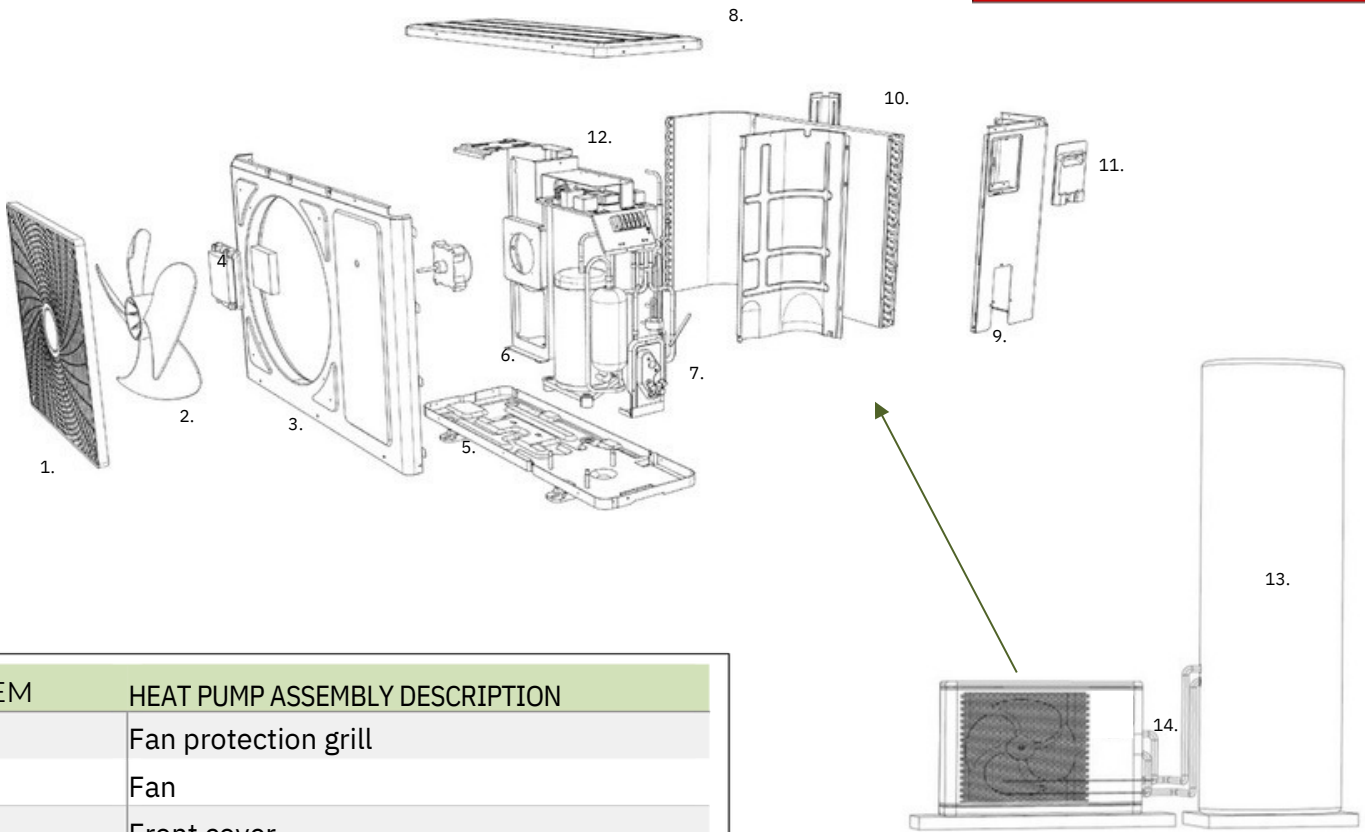

ITEM	HEAT PUMP ASSEMBLY DESCRIPTION
1	Fan protection grill
2	Fan
3	Front cover
4	Controller
5	Condensation drain
6	Compressor assembly
7	Schrader valve & Quick condenser connection
8	Top cover
9	Rear casing assembly
10	Evaporator
11	Power cable cover
12	Circuit board
13	Condenser tank
14	Condenser pipe (pair coil)

