

dyson ball

DC
25

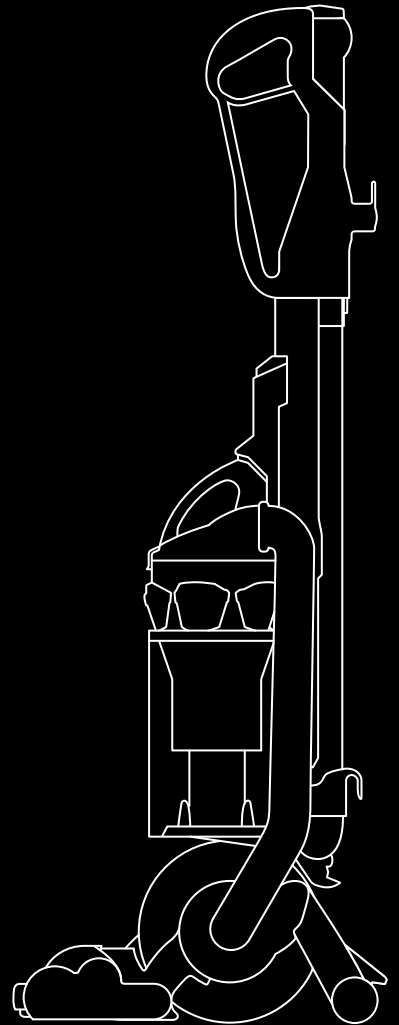

Register for your 2 year guarantee



www.dyson.com.au
www.dyson.co.nz



AU 1800 239 766
NZ 0800 397 667
SG 7000 453 7546
ID 021 707 39766



Complete and return the
registration form.

After registering for your 2 year guarantee, your Dyson vacuum cleaner will be covered for parts and labour for 2 years from the date of purchase, subject to the terms of the guarantee. If you have any queries about your Dyson vacuum cleaner, call the Dyson Customer Care Helpline with your serial number and details of where/when you bought the vacuum cleaner. Your serial number can be found on the rating plate which is behind the clear bin™.



Note your serial number for future reference

This illustration is for example purposes only.

See back page for full contact details

appliancesonline
Australia's largest online appliance retailer
[.com.au](http://appliancesonline.com.au)

GENERAL SAFETY PRECAUTIONS



READ ALL INSTRUCTIONS BEFORE USING THIS VACUUM CLEANER

When using an electrical vacuum cleaner, basic precautions should always be followed, including the following:

1. This vacuum cleaner is for domestic use only. Do not use outdoors or on wet surfaces.
2. Do not handle plug or vacuum cleaner with wet hands.
3. Do not allow to be used as a toy. Close attention is necessary when used by or near children.
4. Do not use with damaged cable or plug. If the supply cable is damaged, it must be replaced by Dyson's authorized Service centres.
5. If the vacuum cleaner is not functioning properly, has been dropped, damaged, left outdoors, or immersed in liquid, do not use, contact the Dyson Helpline.
6. Do not use the vacuum cleaner if any parts appear to be faulty, missing or damaged.
7. Ensure all parts including the clear bin™ are securely attached before using or carrying the vacuum cleaner.
8. This vacuum cleaner is not intended for use by persons (including children) with reduced physical, sensory or mental capabilities, or lack of experience and knowledge, unless they have been given supervision or instruction concerning use of the vacuum cleaner by a person responsible for their safety. Children should be supervised to ensure that they do not play with the vacuum cleaner.
9. Do not leave vacuum cleaner when plugged in. Unplug from outlet when not in use, and before performing user maintenance, connecting or disconnecting the hose or changing accessories.
10. Store the vacuum cleaner indoors. Put the vacuum cleaner away after use with the cable stored safely, to prevent tripping hazards.
11. If the vacuum cleaner overheats it will cut-out. It must be switched off, unplugged and allowed to cool down before attempting to check filters or for blockages.
12. Turn off all controls before unplugging.
13. Do not unplug by pulling on cable. To unplug, grasp the plug, not the cable.
14. Do not pull or carry by cable, use cable as a handle, close a door on cable, or pull cable around sharp edges or corners. Do not run vacuum cleaner over cable. Keep cord away from heated surfaces.
15. The use of an extension cable is not recommended.
16. Keep hair, loose clothing, fingers, and all parts of body away from openings and moving parts, such as the brushbar.
17. Do not put any object into openings. Do not use with any opening blocked.
18. Take extra care when vacuuming on stairs. Do not work with the vacuum cleaner above you on the stairs.
19. Keep the vacuum cleaner on the floor. Do not put the vacuum cleaner on chairs, tables etc.
20. Do not shake the vacuum cleaner or press the cyclone release button while carrying the vacuum cleaner, or it could fall and cause injury.
21. Do not use to pick up flammable or combustible liquids, such as petrol, or use in areas where they may be present.
22. Do not pick up anything that is burning or smoking, such as cigarettes, matches, or hot ashes.
23. Check to ensure your electricity supply matches that shown on the rating plate. The vacuum cleaner must only be used as rated.
24. Use only as described in this manual. Use only Dyson recommended attachments.
25. Do not use without clear bin™ and filters in place.
26. Do not lubricate any parts, or carry out any maintenance or repair work other than that shown in this manual, or as advised by the Dyson Helpline.

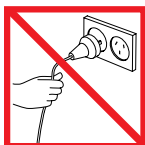

Do not pull on the cable.

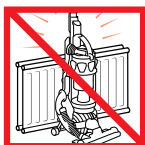

Do not store near heat sources.



Do not use near naked flame.



Do not run over the cable.



Do not pick up water or liquids.



Do not pick up burning objects.



Do not use above you on the stairs.



Do not put hands near the brushbar when the vacuum cleaner is in use.

Using your Dyson vacuum cleaner

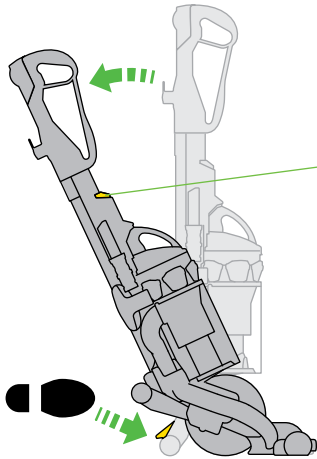
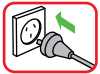

ON/OFF

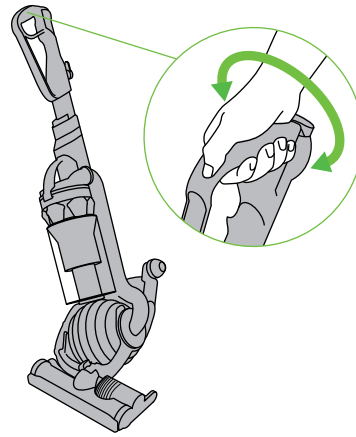

Clear bin™ emptying

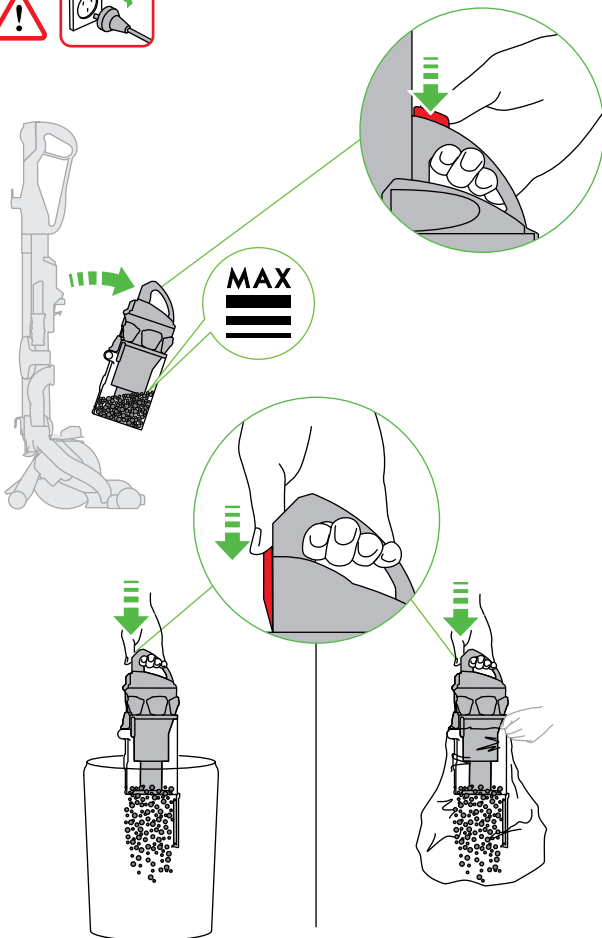

MAX

2

clik

clik

clik

1

Blockages

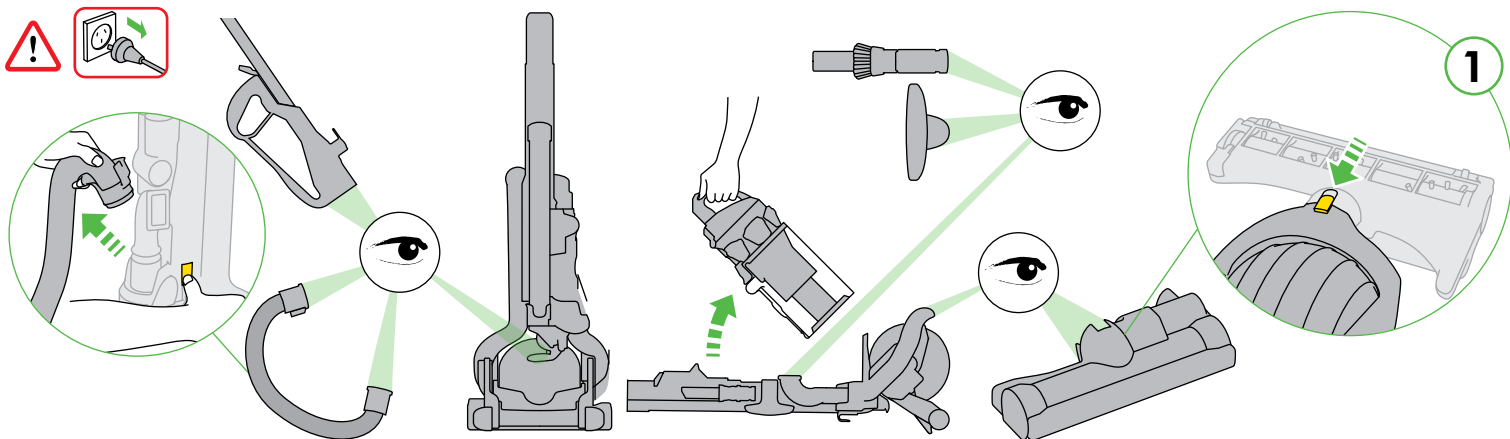

1

Carpets/hard floors

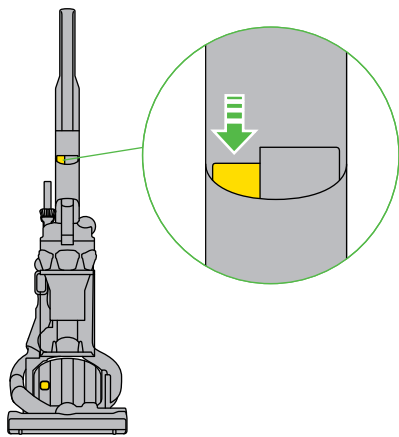
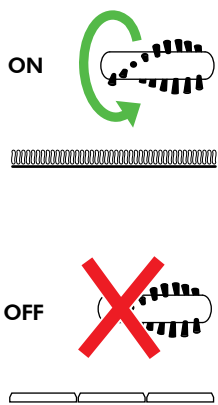

3

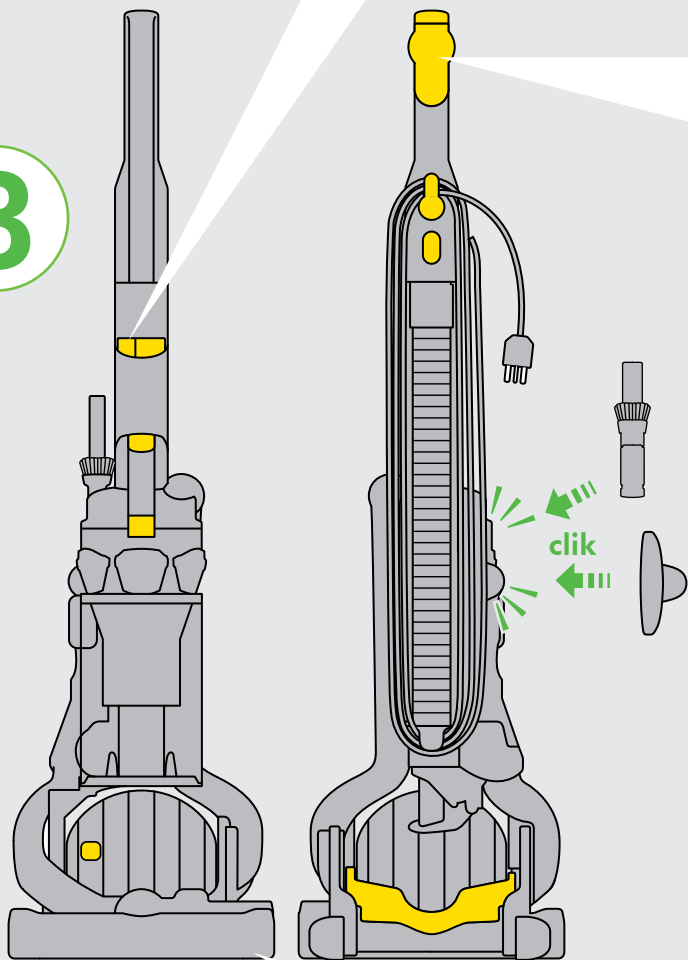

High-reach cleaning

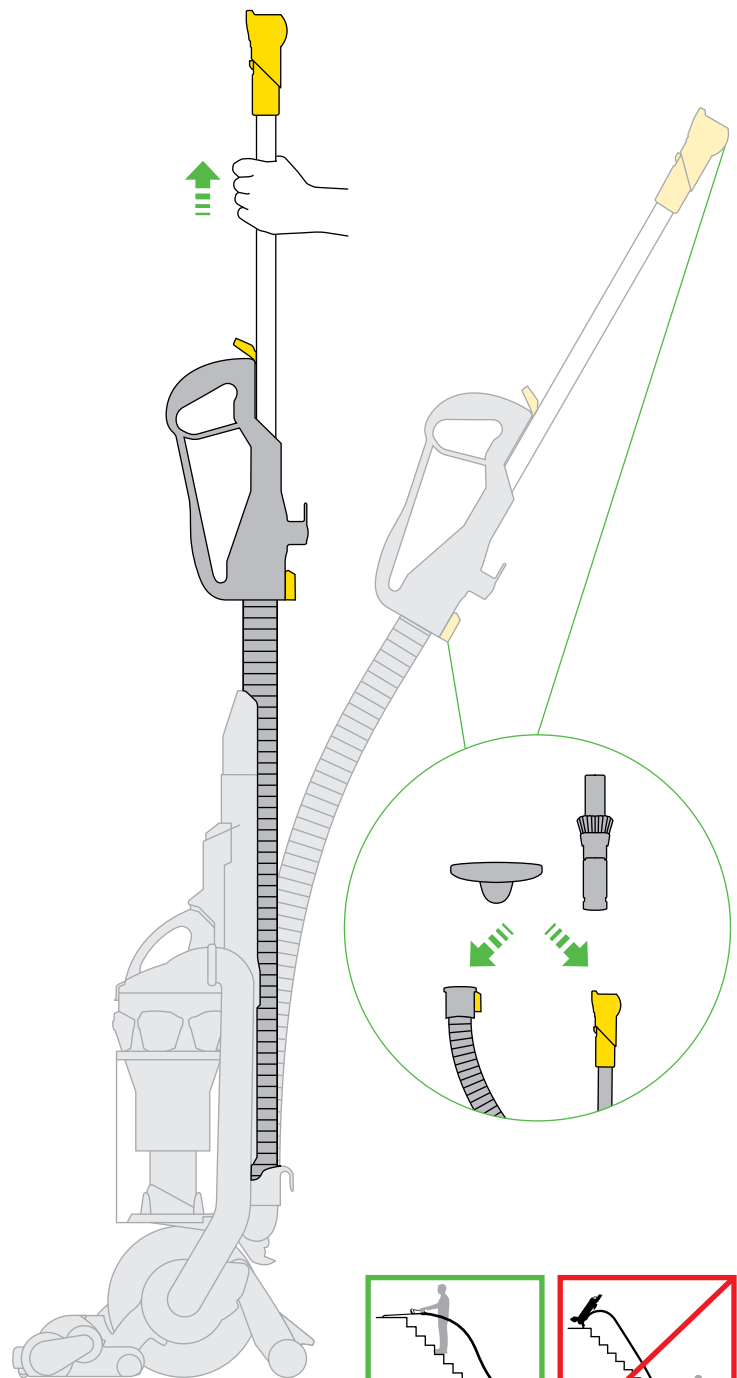

Clearing obstructions

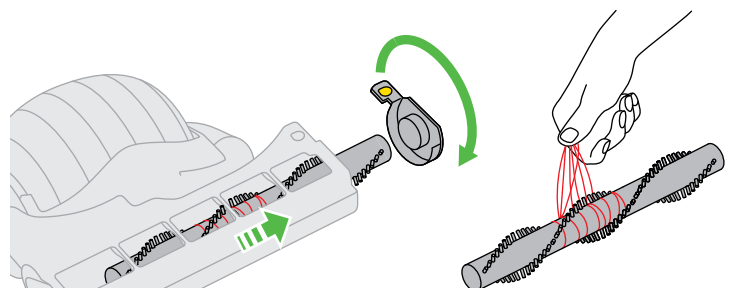
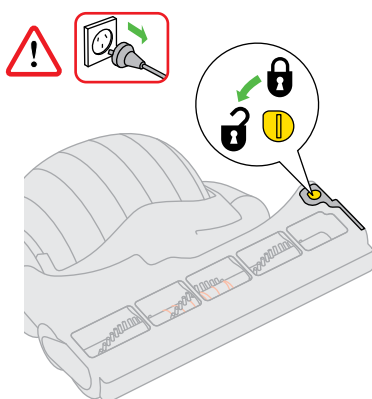
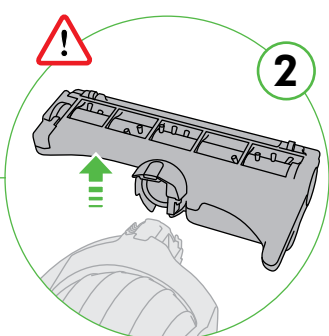

IMPORTANT!

WASH FILTERS

4 **3**
months

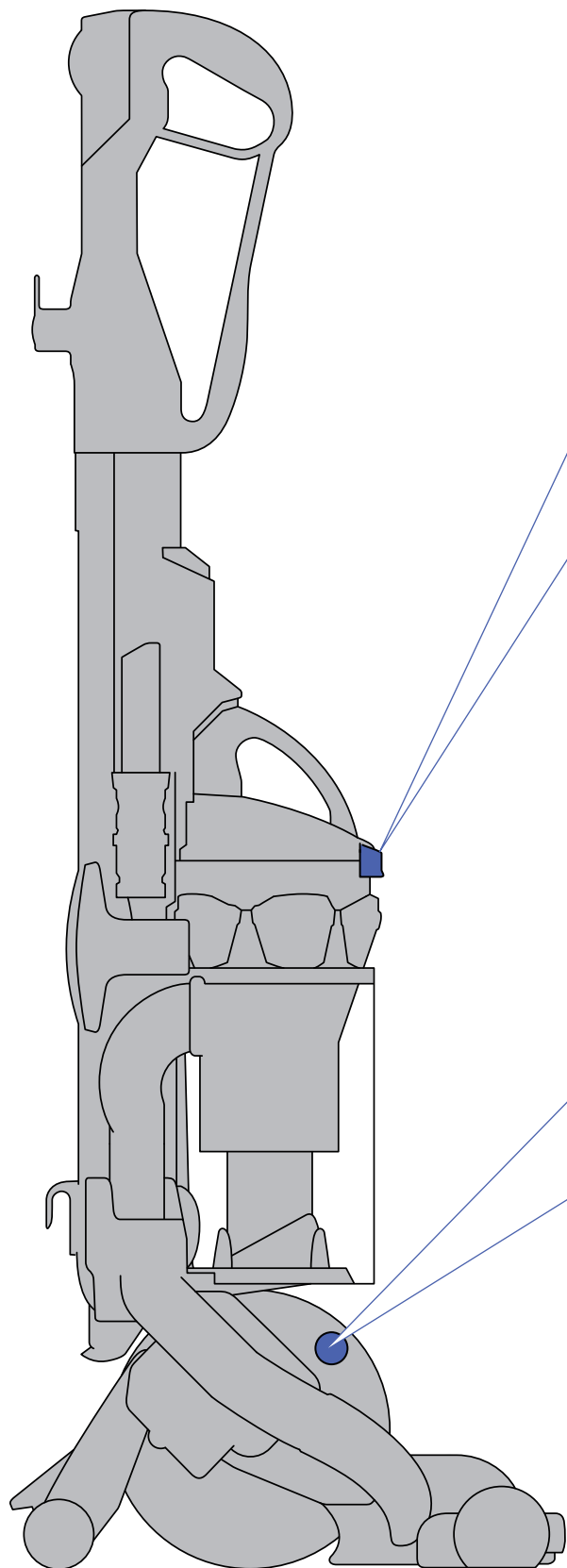

Filter A

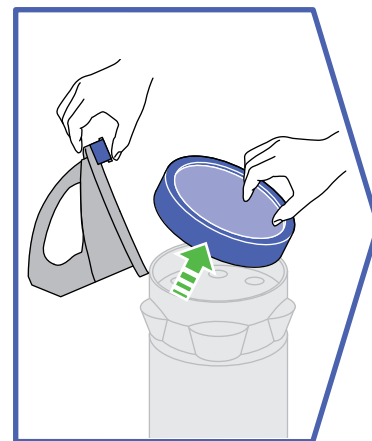
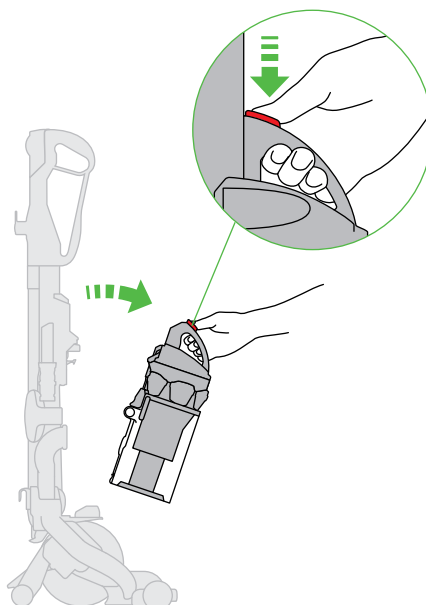

Filter B

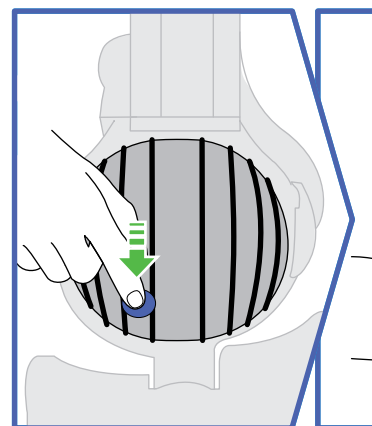
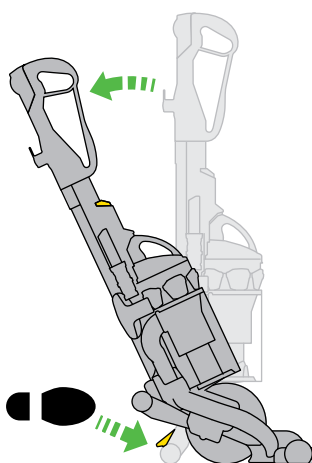

Wash filters with cold water at least every 3 months or as required.

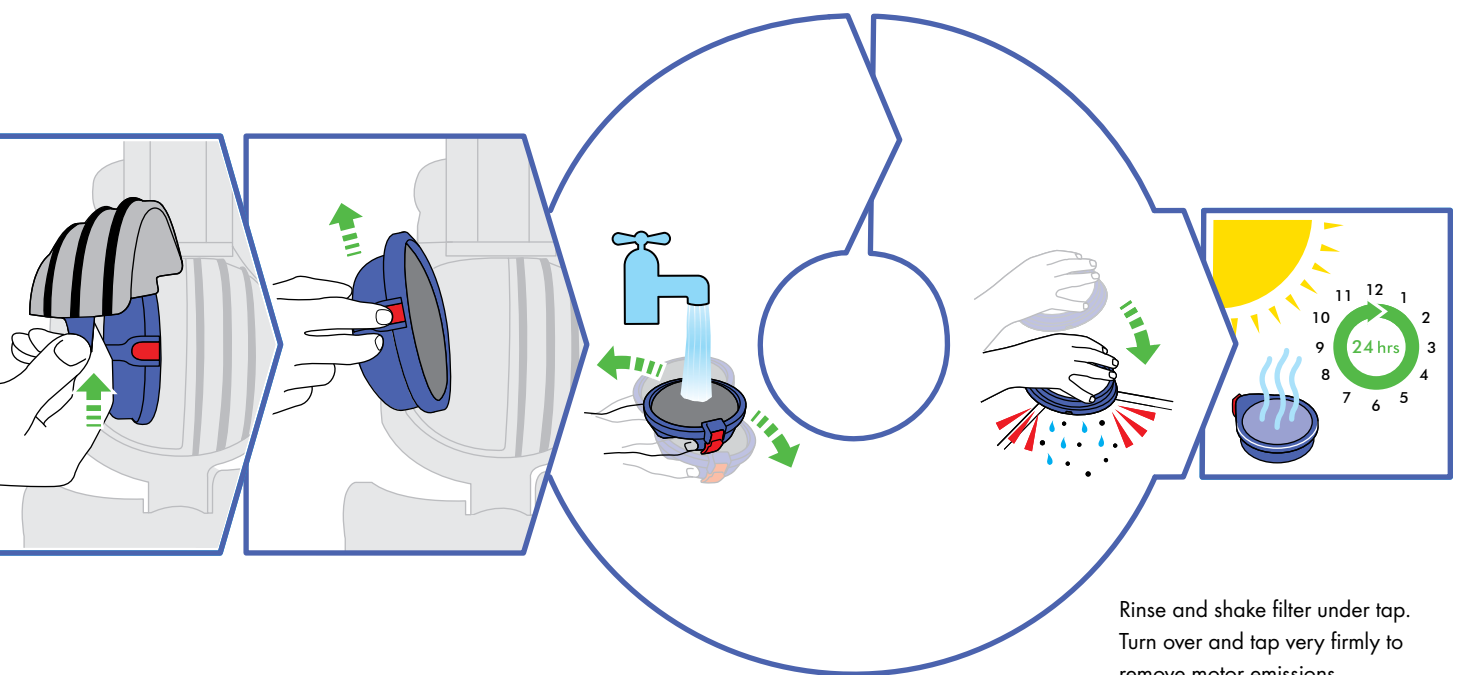
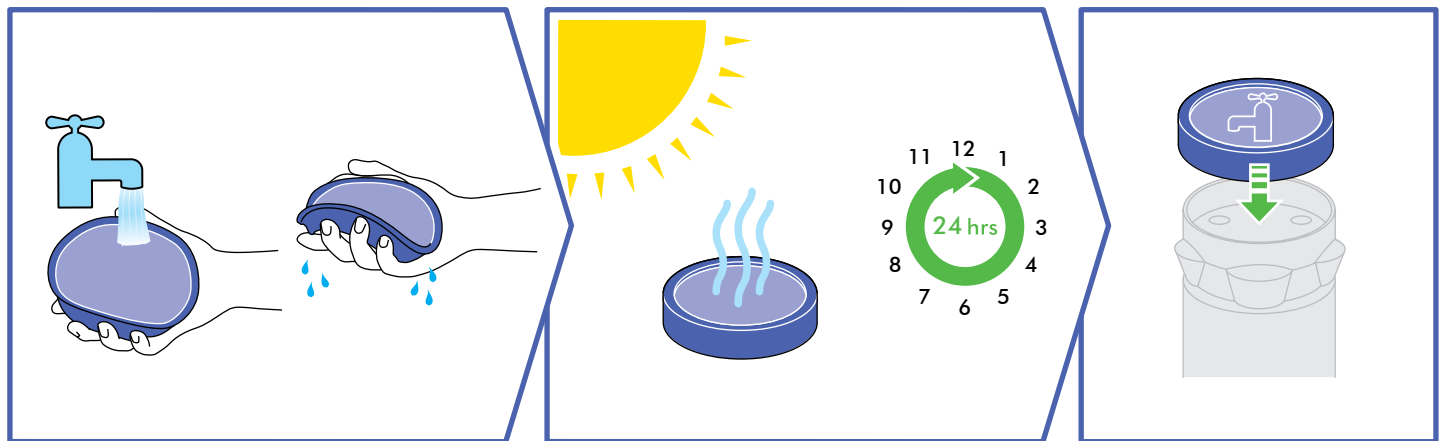

Rinse and shake filter under tap.
Turn over and tap very firmly to
remove motor emissions.
Repeat until water runs clear.



Lie the vacuum cleaner flat and attach the vacuum cleaner head by sliding it on until it clicks. Stand vacuum cleaner up straight, attach wand to hose and push into place until it clicks. Push wand down into hose and attach tools to the side of the vacuum cleaner.

Press foot pedal and recline handle to use. The stabiliser stand will automatically lift up. To switch 'ON', depress power button in front of handle. After cleaning, push the vacuum cleaner into an upright position and stabiliser wheels will automatically drop. Use the carrying handle located above the clear bin™ to carry the vacuum cleaner.

- When returning to the upright position, ensure that the stabiliser wheels are fully engaged before releasing the vacuum cleaner.
- Do not press the cyclone release button while carrying the vacuum cleaner.

- Fine dust such as plaster or flour should only be vacuumed in very small amounts.
- Consult your flooring manufacturer's recommended instructions before vacuuming and caring for your flooring, rugs and carpets. Some carpets will fuzz if a rotating brushbar is used when vacuuming. If this is the case, we recommend vacuuming in hard floors mode and consulting with your flooring manufacturer. (Refer to carpets/hard floors section.)
- If used in a garage when car cleaning, care should be taken to wipe the soleplate and wheels with a dry cloth after vacuuming to clean off any sand, dirt, or pebbles which could damage delicate floors.

The brushbar will always default to 'ON' (spinning) each time you switch on the vacuum cleaner and recline it for cleaning. The brushbar will automatically stop if it becomes obstructed. If the brushbar stops during use, please refer to the 'Clearing brushbar obstructions' section. To switch the brushbar 'OFF' (e.g. for hard floors), recline the vacuum cleaner and turn it 'ON', then press the brushbar 'ON/OFF' button - the brushbar will stop spinning.

- Powerful suction can cause the hose to 'pull back' - please take care.
- To avoid personal injury and to prevent the vacuum cleaner from falling when cleaning stairs, do not work with the vacuum cleaner above you on the stairs.
- To release the wand, open the wand cap. Extend the red tube until the handle slides off the vacuum cleaner. Tools can be attached to either the hose or wand. Ensure wand cap is closed when wand is not in use.

- Switch 'OFF' and unplug the vacuum cleaner before emptying the clear bin™. Empty as soon as the dirt reaches the level of the MAX mark – do not overfill. To remove the clear bin™ from the vacuum cleaner press the button at rear of carrying handle. To release the dirt, press the red clear bin™ release button.

The British Allergy Foundation is a UK national charity with the aim of improving awareness, prevention and treatment of allergies. The British Allergy Foundation Seal of Approval is a UK registered trademark.

- Do not use the vacuum cleaner without the clear bin™ in place.

- Do not immerse the whole cyclone in water or pour water into the cyclones.
- Ensure the clear bin™ is completely dry before replacing.

- Do not use detergents, polishes or air fresheners to clean the clear bin™.
- Do not put the clear bin™ in a dishwasher.
- When vacuuming, certain carpets may generate small static charges in the clear bin™. These are entirely harmless and are not associated with the mains supply.

To minimize any effect from this, do not put your hand or insert any object into the clear bin™ unless you have first emptied it and rinsed it out with cold water.

- Switch 'OFF' and unplug the vacuum cleaner before removing the filters.
- Ensure filters are completely dry before refitting into the vacuum cleaner.

- This machine has two filters, located as shown. It is important to check your filters regularly and wash with cold water at least every 3 months or as required.
- The filter in the ball should be rinsed and tapped out until the water runs clean, then tapped out again to ensure all excess water is removed. Please leave to dry completely for 24 hours.
- It is normal for the filter in the ball to turn grey in colour. The filters may require more frequent washing if vacuuming fine dust.
- Do not use detergents to clean the filters.
- Do not put the filters in a dishwasher, washing machine, tumble dryer, oven, microwave or near an open flame.

- Switch 'OFF' and unplug the vacuum cleaner before checking for blockages.
- Please ensure vacuum cleaner is upright before removing hose or airway inspection parts.
- Beware of sharp objects when clearing blockages.
- Refit all parts of the vacuum cleaner securely before using.

- Clearing blockages is not covered by your vacuum cleaner's 2 year guarantee. If any part of your vacuum cleaner becomes blocked, it may overheat and then automatically shut off. Unplug the vacuum cleaner and leave to cool down. Clear blockage before restarting.

- Switch 'OFF' and unplug the vacuum cleaner before clearing brushbar obstructions. Failure to do so could result in personal injury.
- If your brushbar is obstructed, it may shut off. If this happens you will need to remove brushbar as shown and clear any obstructing debris. Failure to do so could result in personal injury.

A sample of this product has been tested and found to be in conformity with the following European Directives: 2006/95/EC Low voltage Directive, 2004/108/EC EMC Directive, 93/68/EEC CE Marking Directive.

Please note: Small details may vary from those shown.

This product is protected by the following intellectual property rights:

JP 2004-537336; EP 1361812; AU 744408; EP 1119282; JP 2002-527132;
US 6,519,807; AU 744362; EP 1121043; JP 2002-527131; US 6,572,078;
GB 0326102.1; AU 2002-226556; EP 1370172; JP 2004.528876; US 6,991,666;
US 2002-225207; EP 1361814; JP 2004-528876; AU 2002-2240894;
EP 1268076; JP 2003-528704; US 6,835,212; JP 2002-525232; EP 1361815;
JP 3940082; US 6,974,488; AU 2003-283157; EP 1526798; JP 2006-503607;
US 2005-0235454; AU 2003-283159; EP 1526798; JP 2005-394941;
AU 2003-283161; EP 1526798; JP 2006-503608; AU 2004-294771; EP 1680232;
JP 2007-508934; US 2007-0079579; AU 2005-263889; EP 1768536.
Equivalent patents, registered designs and applications exist in other countries.

IMPORTANT!

WASH FILTERS



Wash filters with cold water at least every 3 months or as required.



AU Dyson Customer Care
customercare@dyson.com.au
1800 239 766

Dyson Appliances (Aust) Pty Ltd., PO Box 2175, Taren Point,
Australia, NSW 2229
www.dyson.com.au

NZ Dyson Customer Care
dyson@averyrobinson.co.nz
0800 397 667

Avery Robinson Ltd., Unit F, 151D Marua Road,
Ellerslie, Auckland
www.dyson.co.nz

SG Dyson Service Centre
singapore@dyson.com
7000 453 7546

Service @ Home Pte. Ltd.,
2 Leng Kee Road, #04-09A Thye Hong Centre,
Singapore 159086

ID Indonesia Service Centre
021 707 39766

PT. Higienis Indonesia, Permata Plaza Top floor TF-04
Jl. M. H. Thamrin Kav. 57, Jakarta 10350

Dyson Customer Care

If you have a question about your Dyson vacuum cleaner, call Dyson Customer Care with your serial number and details of where and when you bought the vacuum cleaner, or contact us via the Dyson website. The serial number can be found on the main body of the vacuum cleaner behind the clear bin™.