

Serie | 6

**HBA5570S0A**  
**60cm Built-in Stainless Steel**  
**Oven**

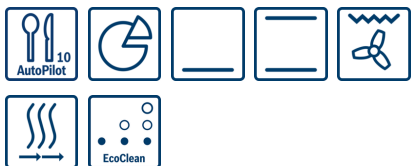

**Included accessories**

1 x grill tray  
 suit. pyrol. clean.  
 2 x combination grid  
 1 x universal pan

**Optional accessories**

HEZ317000 Pizza pan, grey enamelled, HEZ327000 Pizza stone, HEZ531010 Baking tray, non-stick ceramic coated, HEZ532010 Universal pan, non-stick ceramic coated, HEZ538000 1fold telescopic rail, level independent, HEZ538200 2 level telescopic shelf rails, HEZ633070 Professional pan, anthracite enamelled, HEZ634000 Baking and roasting grid (standard), HEZ638300 3 level telescopic rails, full ext, HEZ660050 Cover Strip, HEZ660060 Strip, HEZ864000 Glass tray, HEZ915003 Glass roasting dish, 5,4 L

**The built-in oven with AutoPilot:  
 automatically prepares perfect dishes.**

- **3D Hotair:** perfect results thanks to optimal distribution of heat on up to 3 levels simultaneously.
- **Level independent telescopic rail (clip-on rail):** can be placed in any cooking level.
- **White LCD display control:** easy-to-use thanks to direct access to additional functions.
- **EcoClean Direct:** almost no cleaning is necessary thanks to a special coating of the rear- and side wall and the ceiling that automatically absorbs grime and has a regeneration programme.
- **AutoPilot 10:** every dish is a perfect success thanks to 10 pre-set automatic programmes.

**Technical Data**

Color / Material Front :	Stainless steel
Built-in / Free-standing :	Built-in
Integrated Cleaning system :	catalytic all sides
Required niche size for installation (HxWxD) :	585-595 x 560-568 x 550
Dimensions of the product (mm) :	595 x 594 x 548
Dimensions of the packed product (HxWxD) (mm) :	675 x 690 x 660
Control Panel Material :	Stainless steel
Door Material :	Glass
Net weight (kg) :	33.810
Usable volume of cavity (l) :	71
Cooking method :	Bottom heat, Conventional heat, Full width grill, Heißluft sanft, Hot Air, Hot air grilling, Pizza setting
First cavity material :	Other
Temperature control :	No control of the temperature
Number of interior lights :	1
Approval certificates :	CE, VDE
Length electrical supply cord (cm) :	120
EAN code :	4242005132782
Number of cavities (2010/30/EC) :	1
Energy efficiency class (2010/30/EC) :	A
Energy consumption per cycle conventional (2010/30/EC) :	0.97
Energy consumption per cycle forced air convection (2010/30/EC) :	0.81
Energy efficiency index (2010/30/EC) :	95.3
Electrical connection rating (W) :	3400
Current (A) :	16
Voltage (V) :	220-240
Frequency (Hz) :	50; 60
Plug type :	no plug



## Serie | 6 Ovens

### HBA5570S0A

#### 60cm Built-in Stainless Steel Oven

**The built-in oven with AutoPilot:  
automatically prepares perfect dishes.**

#### Dimensions

- Appliance dimensions (HxWxD): 595 mm x 594 mm x 548 mm
- Installation dimensions (HxWxD): 585 mm - 595 mm x 560 mm - 568 mm x 550 mm
- Please reference the built-in dimensions provided in the installation drawing

#### Heating Functions

- Oven with 7 heating methods:
  - 3D Hotair
  - Top/bottom heating
  - Hot air grilling
  - Full width grill
  - Pizza setting
  - Bottom heating
  - Hotair gentle
- Temperature range 50 °C - 275 °C

#### Design

- Cavity volume: 71 net usable litres
- Extra large capacity oven with grey enamel

#### Convenience

- Halogen lighting
- Cooling fan
- Rotary control knobs, Retractable control knobs
- Child lock function
  - Residual heat indicator
- safety stop function, 1 set of level independent telescopic rails (Clip-on rail)
- Full glass inner door
- Drop down door
- Electronic clock/timer with end time programming
- EcoClean Direct : back panel, ceiling, side liners
- AutoPilot10
- Rapid heating-up
- Bar handle

#### Accessories

- 1 x grill tray, suit. pyrol. clean., 2 x combination grid, 1 x universal pan
- Safety and Environment
- Maximum door temperature 40° C

#### Technical Info

- Length of mains cable: 120 cm
- Nominal voltage: 220 - 240 V
- Total connected load electric: 3.4 KW

## Serie | 6 Ovens

**HBA5570S0A**

**60cm Built-in Stainless Steel Oven**

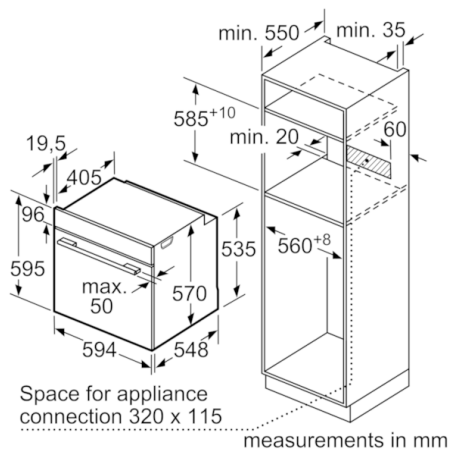
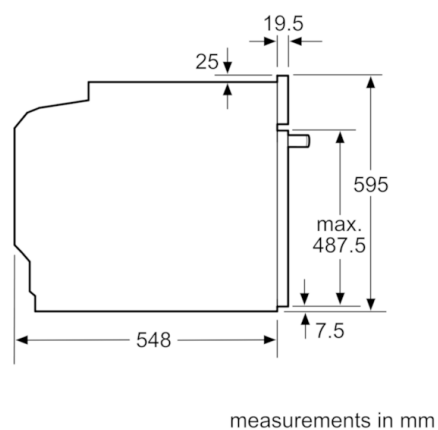
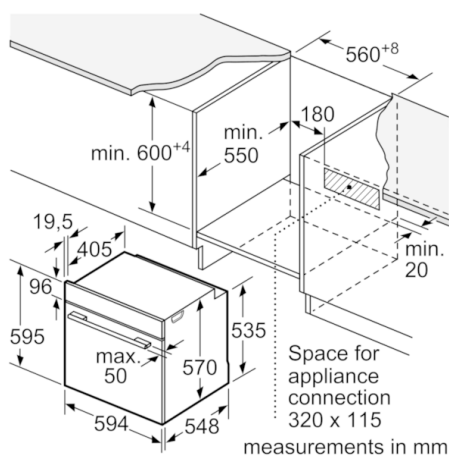

Installation with a hob.

