



we  clean

# User Guide

Vax Careline AU: 1300 361 505

NZ: 0800 800 900

## Car Kit

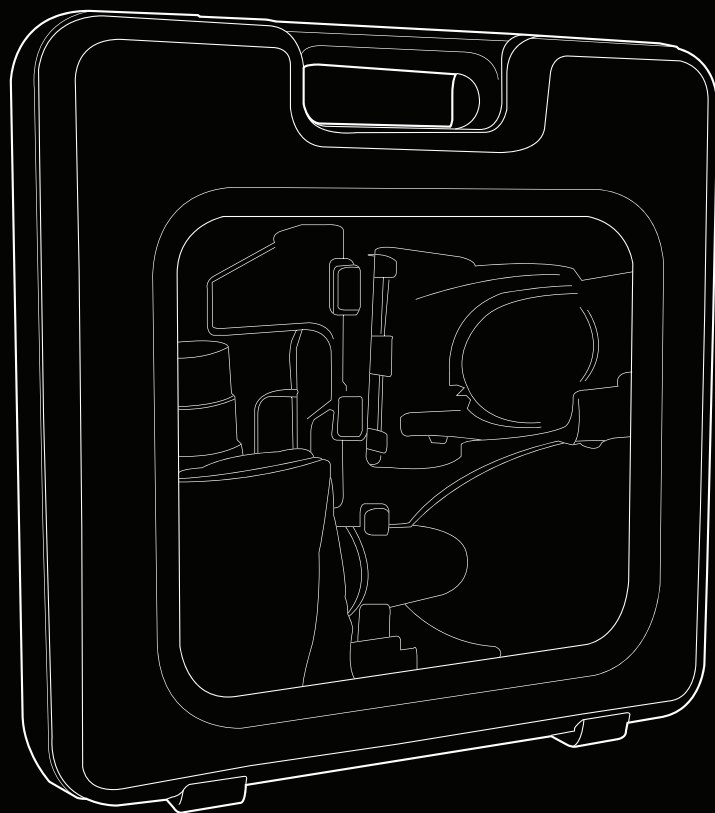

# Get cleaning your car...

[www.vax.com.au](http://www.vax.com.au)

Car kit

# Machine Overview

- 1 Flexi crevice tool with upholstery attachment
- 2 Micro-fibre gloves
- 3 Adaptor A
- 4 Adaptor B
- 5 Flat upholstery nozzle
- 6 TurboTool
- 7 Dusting brush attachment

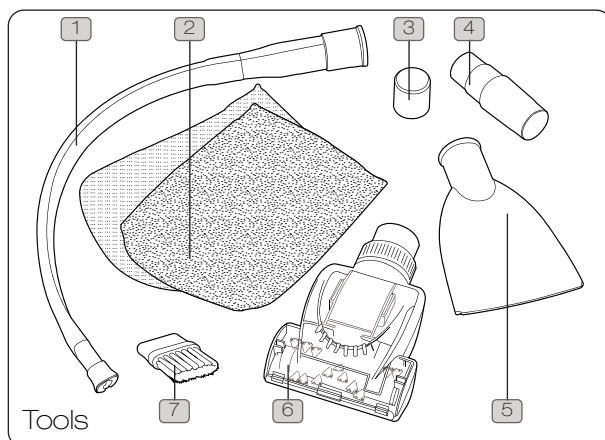

## General Safety Information

### FOR HOUSEHOLD USE ONLY.

When using the attachments with your vacuum cleaner, basic safety precautions should always be observed, including the following:

1. Turn off the vacuum cleaner controls before disconnecting or connecting from the mains supply.
2. Always unplug the vacuum cleaner before connecting or disconnecting the vacuum hose and accessories.
3. Children should be supervised to ensure that they do not play with the appliance and accessories.
4. This appliance and accessories is not intended for use by persons (including children) with reduced physical, sensory or mental capabilities, or lack of experience and knowledge, unless they have been given supervision or instruction concerning use of the appliance or accessories by a person responsible for their safety.
6. Use only as described in this manual. Use only Vax recommended attachments.
7. Do not put any objects into openings. Do not use with any openings blocked and do not restrict air-flow. Keep all openings free of dust, lint, hair or anything that might reduce airflow.
8. Keep hair, loose clothing, fingers and all parts of the body away from openings and moving parts.
9. Do not pick up hot coals, cigarette butts, matches or any hot, smoking or burning objects.
10. Do not pick up flammable or combustible materials (lighter fluid, petrol, kerosene etc.) or use in the presence of explosive liquids or vapours.
11. Do not vacuum up harmful or toxic materials (chlorine, bleach, ammonia, drain cleaner etc.).
12. Do not vacuum up hard or sharp objects such as glass, nails, screws, coins, etc.
13. Take extra care when vacuuming on stairs.
14. Keep vacuuming area well lit.
15. Store the vacuum cleaner and accessories in a cool, dry area.



**WARNING:** Always switch off and unplug the vacuum cleaner from the electrical outlet before connecting/disconnecting the attachments.



**IMPORTANT:** If the inlet, hose or telescopic tube is blocked, switch off the vacuum cleaner and remove the blockage(s) before re-starting the vacuum cleaner. See Maintenance: Clearing blockages.

**PLEASE KEEP INSTRUCTIONS FOR FURTHER USE.**

# Operation

## Choosing your attachment...

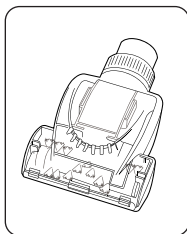

**TurboTool:** ideal for car seats and removing pet hair.

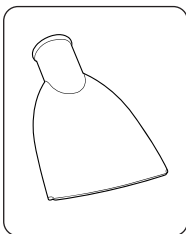

**Flat upholstery tool:** for larger areas.

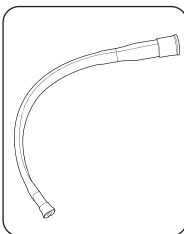

**Flexi crevice tool and upholstery attachment:** perfect for the those hard to reach areas.

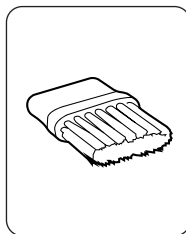

**Dusting attachment:** suitable for delicate areas such as your car radio.

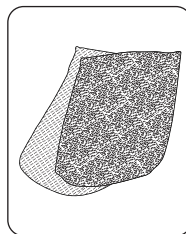

**Micro-fibre gloves:** helps to remove dust from areas such as the dash board or window.

## Attaching to your hose/extension tube

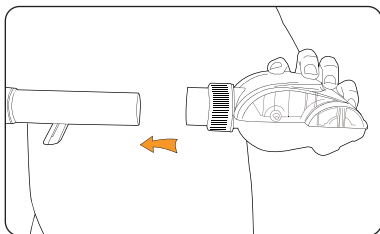

**NOTE:** if the chosen attachment does not fit, please see below.

## Using an adaptor

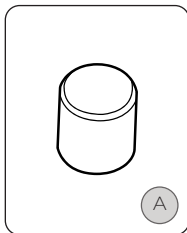

A

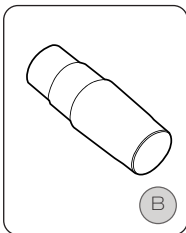

B

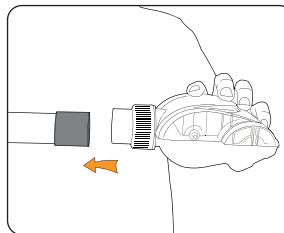
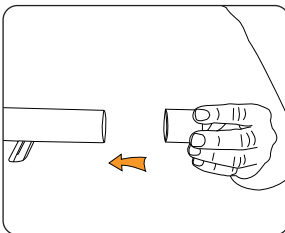

Please select which adaptor best fits your hose/extension tube

# Maintenance (Keep your Vax as good as new)

## Removing blockages from your TurboTool

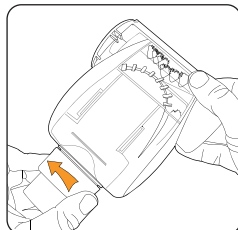

Unlock turbo tool locking ring.

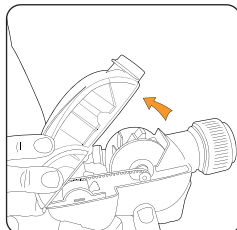

Lift off cover.

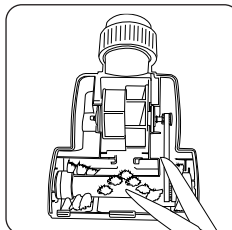

Carefully cut through threads & hairs that may be blocking the tool.

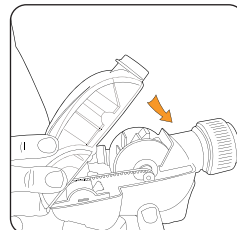

Align catches on top cover with TurboTool base before closing shut.

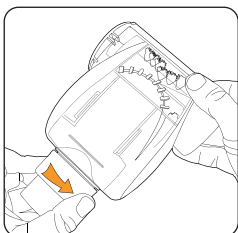

Lock turbo tool locking ring.

## Washing your micro-fibre gloves



When washing the micro-fibre gloves make sure you observe the following:

Wash the micro-fibre gloves by hand or at no more than 60° C.

Use a mild washing liquid **without** softener.

**Do not** bleach the micro-fibre gloves, iron them or dry them in a dryer.

Instead, leave the micro-fibre gloves to dry for 24 hours at room temperature.

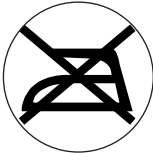
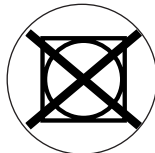

# FAQs



**WARNING:** to reduce the risk of personal injury, unplug the vacuum cleaner before performing maintenance/troubleshooting checks.

## Is there an accessory missing?

- Check the 'Tools Overview' page in this guide to make sure the part is definitely included in your unit.
- If it is missing, we're here to help. Simply call us on **Australia: 1300 361 505**  
**NZ: 0800 800 900**

## What do I do if the unit/an accessory becomes damaged or broken?

- We're here to help. Simply call **Australia: 1300 361 505**  
**NZ: 0800 800 900**  
or visit **[www.vax.com.au](http://www.vax.com.au)**

## Why won't the accessories pick up properly?

**Accessory blockages:** remove accessory from handle/tube. Carefully remove blockage and re-attach to the vacuum cleaner.



Don't take me back to the shop, simply call us

AU: 1300 361 505  
NZ: 0800 800 900 [www.vax.com.au](http://www.vax.com.au)

This does not affect your statutory rights

# Other Information

## Service & Help

Vax Careline:

Australia: 1300 361 505

New Zealand: 0800 800 900

Monday-Friday 8.30am to 5.00pm

Any queries or concerns about using your Vax car kit, call the Vax Careline. Calls are charged at the standard local rate.

## Technical Specification

Dimensions: 37 x 37.5 x 9.5cm (approx)

Weight: 1.9kg (approx)

Subject to technical change without notice.

**Made in China.**

# Notes



we  clean

Distributed by Techtronic Industries Pty. Ltd.  
Level 1, 660 Doncaster Rd, Doncaster, Australia 3108.  
[www.vax.com.au](http://www.vax.com.au). Service Line: AU: 1300 361 505 / NZ: 0800 800 900