

Specifications

It is a requirement of State Plumbing Codes that licensed plumbers carry out all tapware installations. All installations should comply with the relevant requirements of AS/NZS 3500 and local plumbing codes.

Pressure:

[1] Maximum Hydrostatic Pressure: 1000kpa. This pressure may be exceeded only under test conditions as per AS/NZS 3500. Where hydrostatic pressure exceeds the maximum stated above, pressure-limiting valves should be installed. [2] Recommended Maximum Hydrostatic Pressure: 500kpa (AS/NZS 3500). [3] Recommended Minimum Hydrostatic Pressure: 150kpa

Temperature:

Maximum Water Temperature: 80° C. For optimum performance, hot and cold inlet water pressure should be equal.

Care and Maintenance

[1] Product should be inspected for surface damage prior to installation. [2] Cleaning and handling of all finishes must be performed carefully. [3] Clean products using a soft cloth with warm soapy water only. [4] Never use harsh detergents or abrasive cleaners as these will damage the product. [5] Water marks can be removed from Matt Finishes with an application of a carnauba wax based non-abrasive polish on a microfibre cloth. [6] Do not use undue pressure when cleaning and wipe in one direction only. [7] Contact with harsh chemicals such as hair dye, hair bleach etc with result in damage to the finish. [8] Tapware should never be installed using acetone silicones. [9] Avoid the use of wax based furniture creams as this can result in a build up of deposits which will detract from the appearance. [10] Rose Copper: A protective lacquer has been applied to this finish. This is required to maintain the stability of this finish and will be damaged if the above care and cleaning instructions are not followed. [11] Damage to finishes arising from improper installation or post installation use or failure to observe the above care and cleaning instructions will void all warranty agreements.

Arq
by Rogerseller

Sink Mixer

Installation
Instructions

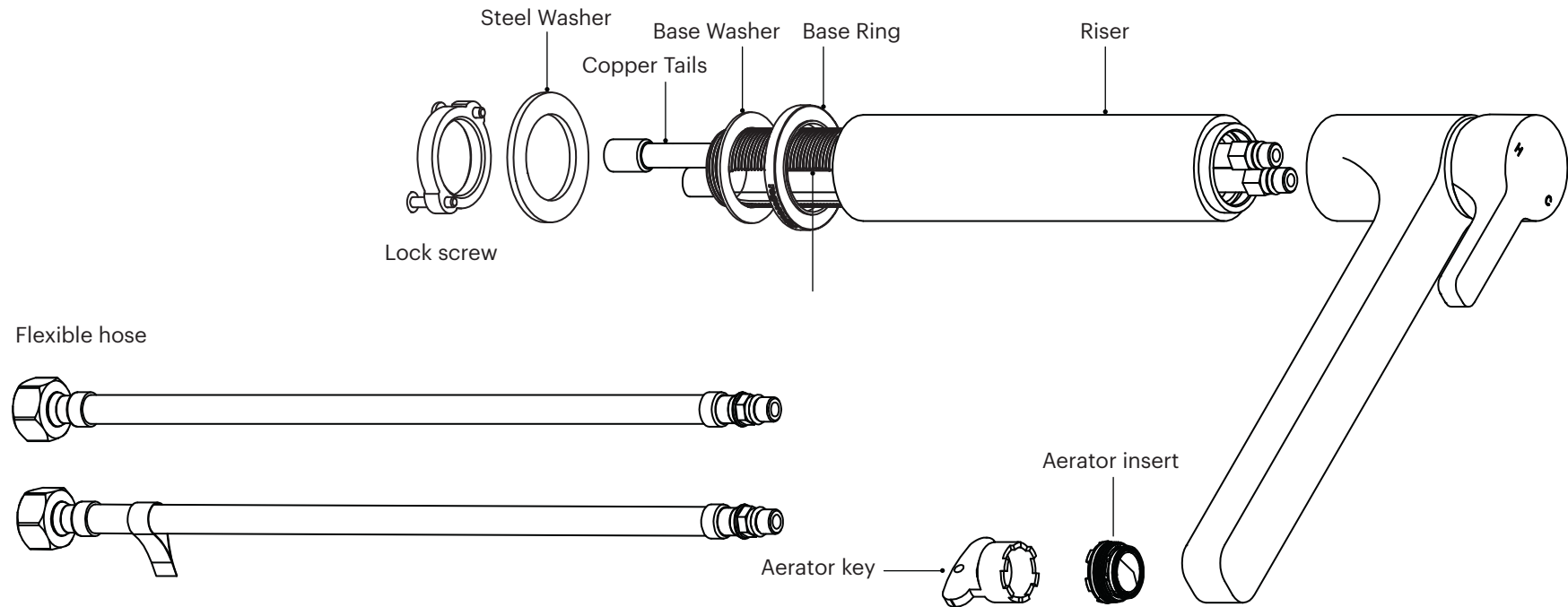

**Arq by Rogerseller Sink
Mixer**

3606003601 — Chrome

5 finishes available

Installation

1. (Under the basin/bench) Position the steel washer onto the threaded sleeve. The copper tails should be towards the front so that the lever handle points toward the user. Lock the mixer onto the sink by tightening the lock screw onto the threaded sleeve.
2. Connect the flexible hoses to the copper tails and tighten. Connect the flexible hoses to the main water supply lines, making sure the hot water is connected to the hot water hose.
3. The installation of stop taps recommended to ensure a cleaner flow of water to the mixer.
4. Prior to introducing the mains water supply, open the lever handle in the mixed position, midway between full hot and full cold. Using the tools provided remove the aerator from the end of the spout. Then introduce the mains water to flush the supply lines.
5. Reinstall the aerator. See notes below.