

OPERATION, MAINTENANCE AND SAFETY INSTRUCTIONS

FOR OMEGA ALTISE ELITE DESK FAN



OALITEC

omega
altise
elite

IMPORTANT SAFETY INSTRUCTIONS

IMPORTANT: Read the safety precautions of this booklet carefully before attempting to assemble, install, operate or maintain the product described. Protect yourself and others by observing all safety information. Failure to comply with instructions could result in personal injury and/or property damage. If you are unsure about anything regarding your fan or these instructions, please contact Omega Altise on 1300 795 572 in Australia or (09) 415 6000 in New Zealand before operating your appliance.

1. Read all instructions carefully before using the desk fan.
2. Use this desk fan only as described in this manual. Any other use not recommended by the manufacturer may cause fire, electrical shock, or injury to persons. Do not modify this appliance. Do not try to repair this appliance – there are no user serviceable parts within.
3. Remove the packaging and ensure that the appliance is undamaged (keep packaging for later storage). In case of doubt do not use the appliance and contact Omega Altise Service. Do not let children play with any parts of the packaging.
4. This appliance is not intended for use by persons (including children) with reduced physical, sensory or mental capabilities, or lack of experience or knowledge, unless they have been given supervision or instruction concerning the use of the appliance by a person responsible for their safety. Children should be supervised to ensure that they do not play with the appliance. Extreme caution is necessary when the desk fan is used by or near children or individuals with decreased mental and physical capacity and whenever the desk fan is left operating unattended.
5. Before you use the appliance, check if the voltage marked on the rating label corresponds to the mains in your home. The appliance must be connected to a grounded power supply.
6. Do not use this appliance with a programmer, timer or any other device that switches the appliance on automatically, since a fire risk exists if the appliance is covered or positioned incorrectly.
7. Do not pull the power cord to disconnect with the power source. Always grasp the plug to pull it out.
8. Do not run power cords under rugs or other combustible materials. Do not place power cords in areas where they can be a tripping hazard. Do not operate directly below a power outlet.
9. Do not insert any objects into the appliance as it may cause an electric shock or fire or damage to the appliance. Do not block or tamper with the appliance in any manner while it is in operation. To prevent a possible fire, do not cover the appliance in any manner. Do not place on soft surfaces, like a bed, where openings may become blocked.
10. Do not leave the appliance unattended. Always unplug the appliance when not in use. Take care that it is not obstructed when rotating.

WARNING:  The Function Switch should not be used as the sole means of disconnecting power. Always unplug the power cord before servicing or moving the appliance.

11. Keep materials such as hair, net curtains, tablecloths & clothes away from the openings of the desk fan, as material may be sucked into the appliance causing injury, damage to property or the appliance.
12. The appliance has hot and arcing or sparking parts inside. It must NOT be used in potentially dangerous locations such as flammable, explosive, chemical-laden, corrosive, salty or wet atmospheres. This appliance is intended for general indoor domestic use ONLY.
13. This appliance is not intended for use in wet or damp locations. Never locate it where it may fall into a bathtub or other water container.
14. Do not use the desk fan outdoors. Do not use close to windows or in direct sunlight.
15. Always place the appliance on flat, stable surfaces before use. Always place the appliance vertically on its base.
16. NOTE that over time, the grills at the front and rear will build up dust & dirt. This should be cleaned regularly to maintain optimum efficiency. Follow the cleaning procedure within this instruction.
17. Don't use in environments where the ambient temperature is above 40°C.

WARNING:  To avoid danger of electric shock, unplug from outlet when not in use and before cleaning. If the supply cord is damaged, it must be replaced by the manufacturer, its Service Agent or similarly qualified persons in order to avoid a hazard. In order to avoid overheating, do not cover the appliance. Do not use the appliance in the immediate surrounding of a bath, shower or swimming pool.

TECHNICAL DETAILS

Model: OALITEC Desk fan.

Power: 220-240V 50Hz, 50W.

Weight: 3.3kg.

Dimensions (HxWxD): 50x35x35cm.

GENERAL DESK FAN PARTS

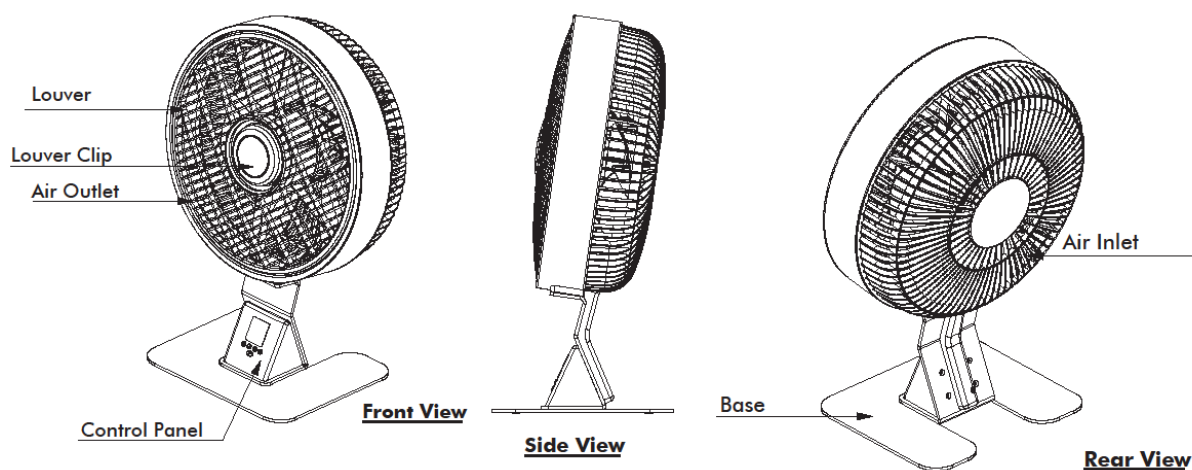

GETTING STARTED

1. Carefully remove the appliance from the plastic bag and the carton, and unwind the cord to its full length.
2. Fix the base to the bottom of the fan using the 4 screws provided.
3. Place the appliance onto a stable, flat and dry surface.
4. Plug the cord set into a 220-240V~A.C. 50Hz earthed electrical outlet. Turn the power on at the electrical outlet.

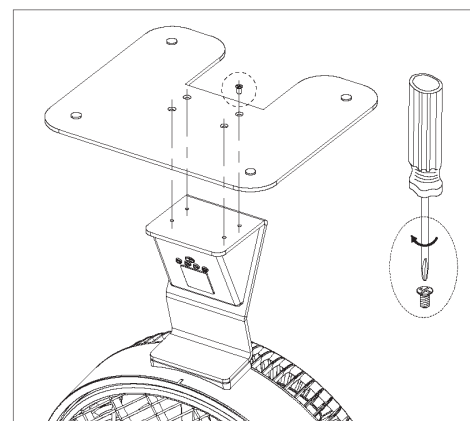

CONTROLS

CONTROL BUTTONS:

There are 5 control buttons on both the control panel and remote control. The function displays are on the control panel only. To use the remote control, point at the control panel (D1) and press a button (D4 will flash to show it has been received).

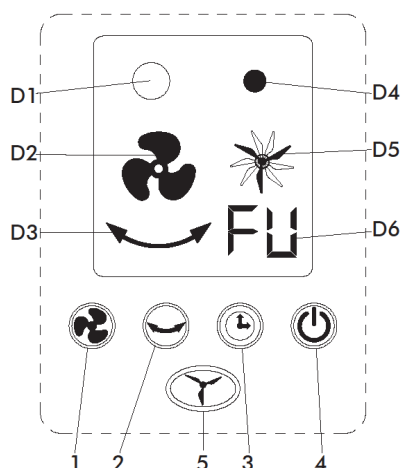

1. Fan Speed Control button (3 speeds).
2. Oscillation On/Off button.
3. Timer On/Off button.
4. Power On/Off button.
5. Turbo Fan Speed button.

- D1. Remote Control Sensor.
D2. Speed indicator.
D3. Oscillation indicator.
D4. Signal Received indicator.
D5. Turbo Fan indicator.
D6. Timer display.

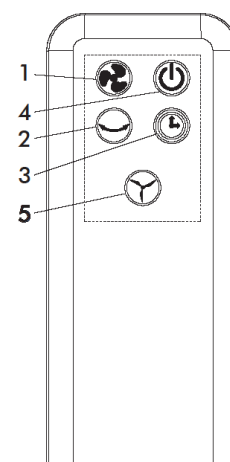

OPERATING THE DESK FAN:

- A) Press the Power On/Off button once to turn on the fan (default setting is high). Press again to turn the fan off.
- B) Press the Oscillation On/Off button once to start the front louvers rotating (indicator D3 will turn on). Press a second time to stop the louvers from rotating.
- C) Press the Fan Speed Control button to adjust the fan speed. There are 3 fan speeds available (high, medium and low). When turned on, the default setting is high (indicator D2 shows all 3 fan blades). Pressing once will decrease the speed to medium (D2 will show 2 fan blades). Pressing again will reduce the speed to the low setting (D2 will show 1 fan blade). Pressing once more will return the setting to high.
- D) Press the Turbo Fan Speed button to get an even higher air flow (indicator D2 will show all 3 blades and indicator D5 will show a rotating fan). Press again to reduce the fan speed back down to normal.
- E) The default setting for the timer is continuous (indicator D6 shows FU). To set up a timer (to turn the fan off after a pre-set time), start the fan running and press the Timer On/Off button. Each press of the button will increase the time by one hour (shown on the Timer display as 1-10). Pressing the button again after reaching 10 hours will return the fan to continuous operation. To turn the timer off, either press the Power button (turning the fan off), or adjust the time to FU. Adjustments to the settings can be made to all settings while the timer is on.

CLEANING & MAINTENANCE

WARNING:



ALWAYS UNPLUG THE CORD BEFORE MOVING OR SERVICING, DO NOT IMMERSE APPLIANCE IN WATER!

The fan should be cleaned periodically (at least once a month depending on the build-up of dust).

Clean the body of the desk fan with a soft damp cloth. Always make sure that the appliance is completely dry before connecting back to the mains supply.

CAUTION: Do not use gasoline, benzene, thinner, harsh cleaners, etc. as they will damage the fan. NEVER use ALCOHOL OR SOLVENTS.

Do not disassemble the fan in any manner.

STORAGE: Store the desk fan with these instructions in the original packaging, in a cool, dry place.

To replace the remote control batteries, remove the screw and then remove the rear cover. Remove the old batteries and replace with new ones (take note of the + and - alignment). Put the cover back in place and replace screw.

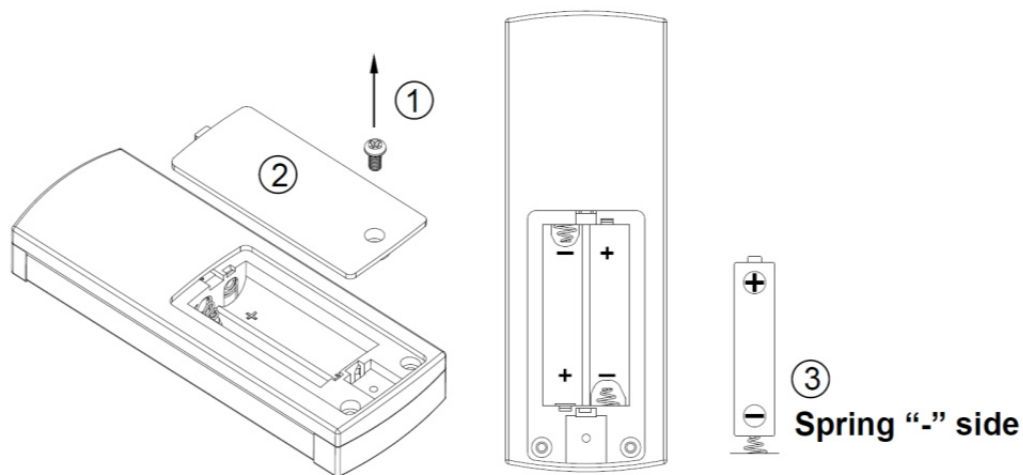

It is important that you retain these instructions, proof of purchase as well as other important documents about this product for future reference. Due to continual product development,

Omega Altise reserves the right to alter specifications or appearances without notice.

Dispose of packaging responsibly – recycle where facilities are available.