

morphy richards®

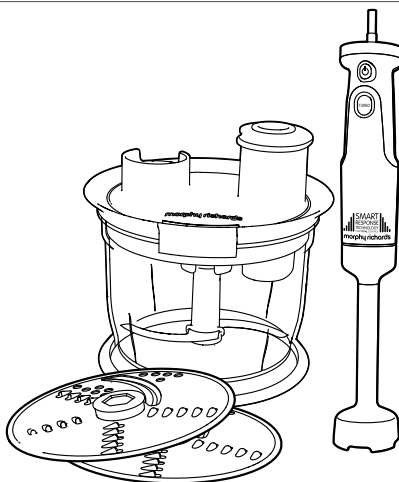

TOTAL CONTROL



Hand Blender Workcentre

Please read and keep these instructions

AUS





Health And Safety

The use of any electrical appliance requires the following common sense safety rules.
Please read these instructions carefully before using the product.

- This appliance can be used by persons with reduced physical, sensory or mental capabilities, or lack of experience and knowledge, if they have been given supervision or instruction concerning the use of the appliance in a safe way and understand the hazards involved.
- Children shall not play with the appliance.
- This appliance shall not be used by children.
- Keep the appliance and cord out of reach of children.
- Do not blend for longer than the time periods recommended in the 'Usage' section.
- Always disconnect from the supply if left unattended and before assembling, disassembling or cleaning.
- For care and cleaning refer to the relevant section.
- Avoid touching moving parts. Keep hands, hair and clothing, and utensils away from the attachment blades during operation, to prevent personal injury and/or damage to the appliance.
- If the supply cord is damaged, it must be replaced by the manufacturer, its service agent or similarly qualified persons in order to avoid a hazard.

In addition, we offer the following safety advice.

Location

- Do not use outdoors or in a bathroom.
- Always locate your appliance away from the edge of the worktop.
- Do not place the beaker used with the appliance on a highly polished wooden surface as damage may occur to the surface.

Mains cable

- Do not let the mains cable hang over the edge of the worktop where a child could reach it.
- Do not let the lead run across an open space e.g. between a low socket and a table.
- Do not let the cable run across a cooker or other hot area which might damage the cable.
- The mains cable should reach from the socket to the base unit without straining the connections.

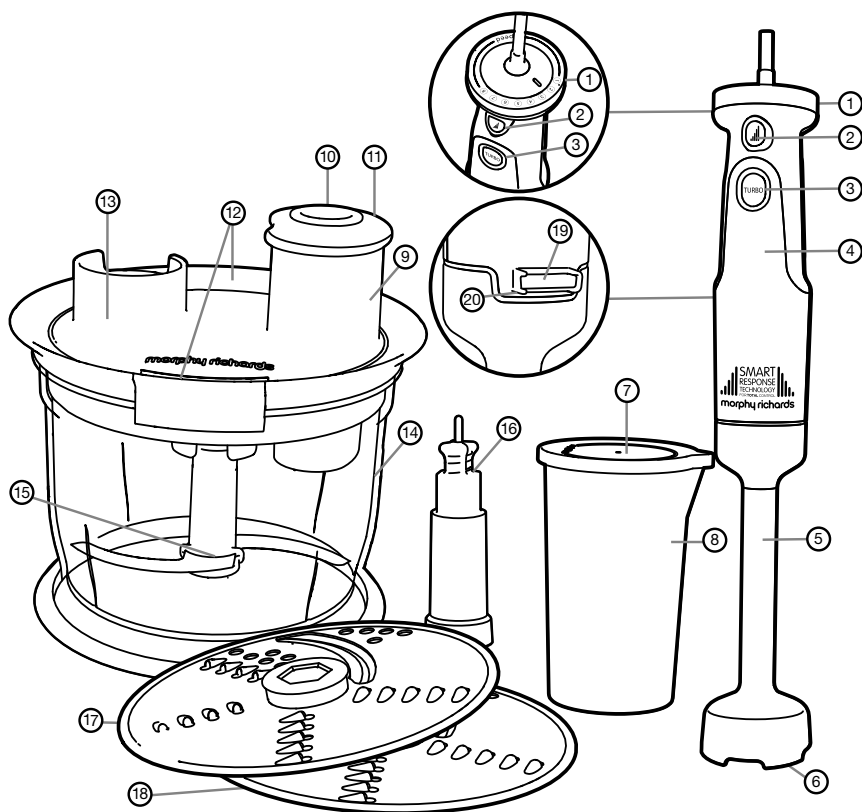

Personal safety

- Care shall be taken when handling the sharp cutting blades, emptying the beaker and during cleaning.

Other safety considerations

- Do not use the appliance for anything other than its intended purpose.

Product specific safety

- **WARNING: The blender blades are very sharp. Handle with care when using and cleaning.**
- Do not clean the attachments under running water while they are in position.
- **IMPORTANT:** Allow hot liquids to cool before adding to the blender.
- Be careful whilst hot liquid is blending or poured into the blender as it can be ejected due to sudden steaming.
- Switch off the appliance and disconnect from supply before changing accessories or approaching parts that move in use.

Electrical requirements

Check that the voltage on the rating plate of your appliance corresponds with your house electricity supply which must be A.C. (Alternating Current).

Should the fuse in the mains plug require changing, a 3 amp BS1362 fuse must be fitted.

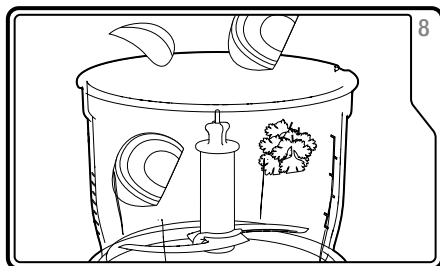
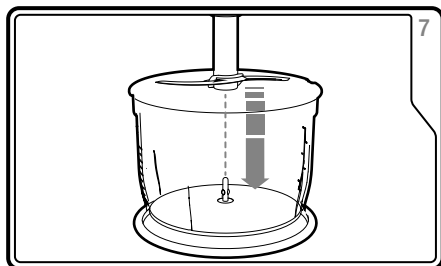
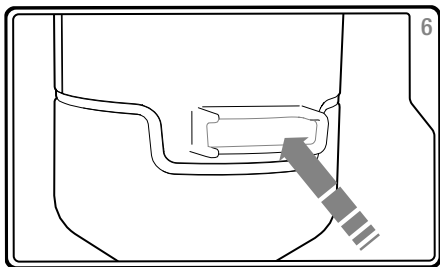
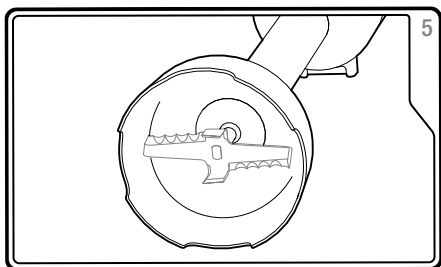
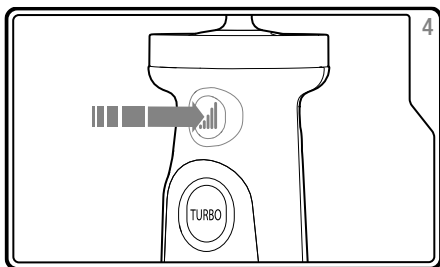
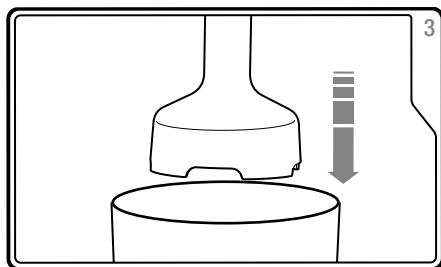
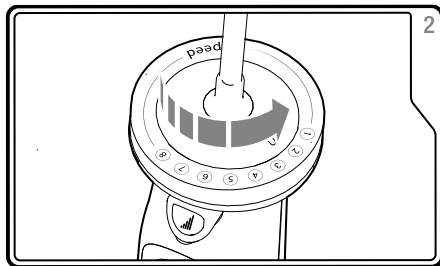
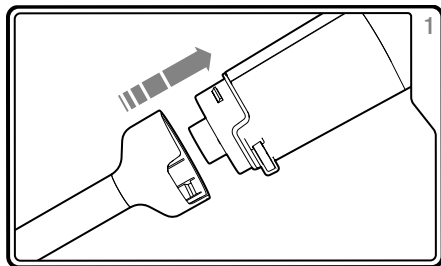

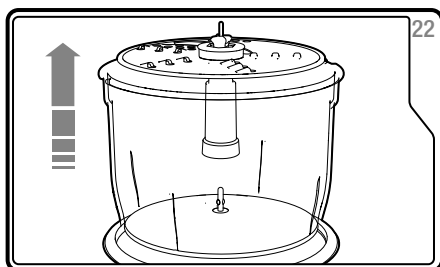
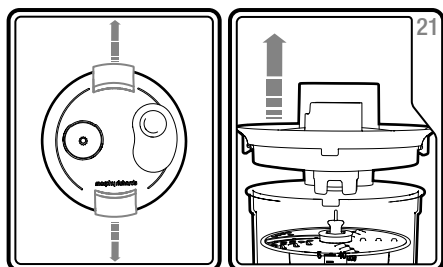
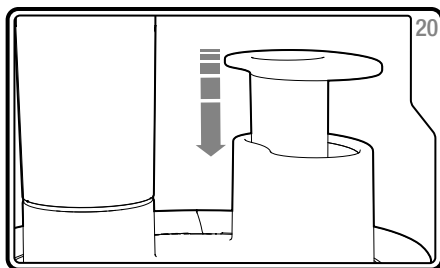
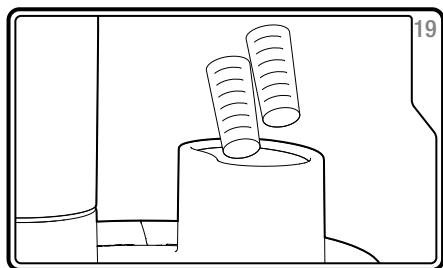
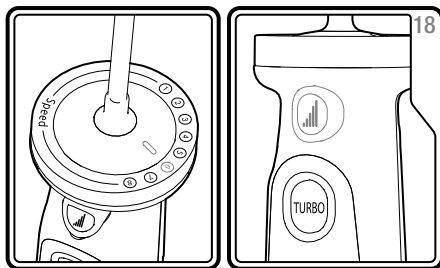
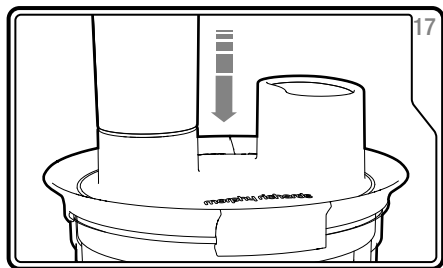

TOTAL CONTROL



AUS

Giving you the power to create with confidence.

Introducing the Total Control Hand Blender – the simple way to bring confidence to your cooking.

The Total Control Hand Blender allows you to create delicious smoothies and shakes, blend soups and sauces with the confidence and reassurance that Smart Response Technology delivers.

Smart Response Technology allows you to have Total Control of the blending process with the simple squeeze of a button. The Smart Response Technology gently feeds power into the blender as you need it, so there are no sudden jerks or splatters, giving you complete confidence in the kitchen.

Choose the speed that best suits the job at hand using the simple twist motion Variable Speed Control, there are 8 to choose from. Even when using a higher speed you can feel assured that the Smart Response Technology feeds power in gradually building to your chosen speed for the job at hand.

When you have blended to your desired consistency simply release the button and the Total Control Hand Blender will steadily slow down and stop, ensuring no splashing and no suction.

Total Control Hand Blender, giving you the power to create with confidence.

- 1 Variable Speed Control
- 2 Precision Control Trigger
- 3 Ergonomic Soft Grip Handle
- 4 650 Watt Motor



Introduction

Thank you for your recent purchase of this Morphy Richards Total Control Workcentre Your Hand Blender has a locking connection for safety. Please read the instructions for information on how to use your Hand Blender thoroughly before use.

Remember to visit www.morphyrichards.co.uk to register your product's two year guarantee.

Contents

Health And Safety	2
Introduction	8
Total Control	7
Product Overview	8
Before First Use	8
Using Your Hand Blender	8
Using Your Workcentre Blade	8
Using Your Grating/Slicing Discs	9
Suitable Foods	9
Note	9
Turbo Button	9
Usage	9
Blending In A Saucepan	9
Attachments	9
Hints And Tips	9
Care And Cleaning	10
Contact Us	10
Recipes	11
Guarantee	20

Features

- (1) Speed Control
- (2) Precise Control Trigger
- (3) Turbo Button
- (4) Main Unit
- (5) Blending Leg
- (6) Serrator Blade
- (7) Beaker Lid
- (8) Beaker
- (9) Feed Tube
- (10) Small Pusher
- (11) Pusher
- (12) Lid Release Handles (x2)
- (13) Lid
- (14) Bowl
- (15) Workcentre Blade
- (16) Spindle
- (17) Grating/Slicing Disc Coarse
- (18) Grating/Slicing Disc Fine
- (19) Attachment Release Button
- (20) Heel Rest

Before First Use

- **WARNING: Carefully unpack your Total Control Hand Blender Workcentre as the blades are very sharp.**
- Wash all parts except the Main Unit (4) and Lid (13) in hot soapy water before use. Dry all parts thoroughly before use.
- Do not fully submerge the Blending Leg in water. Wash only the Serrator Blade head (6).
- Wipe the Lid with a hot damp cloth to clean. Do not immerse in water.
- Do not immerse the Main Unit in water.

Using Your Hand Blender

- 1** Attach the Main Unit (4) to the Blending Leg (5) and push to lock into place.
- 2** Select the speed on the Speed Control (1). The Hand Blender will not start unless the Precise Control Trigger (2) or Turbo Button (3) is pressed.
- 3** Place the Blending Leg into the food to be blended. We recommend using the Beaker (8) for the best results.
- 4** Press the Precise Control Trigger to begin blending. The speed will increase the harder you press the button.
- 5** Release the Precise Control Trigger to stop. Allow the blades to stop BEFORE removing the Hand Blender from the food.
- 6** Unplug the Main Unit from the mains. Press the Attachment Release Button (19), and remove the Blending Leg from the Main Unit for cleaning.

Using Your Workcentre Blade

- 7** Place the Workcentre Blade (15) on the shaft in the Bowl (14).
WARNING: Blades are sharp.
- 8** Place the food into the Bowl. Do not exceed the maximum level.
- 9** Align the tabs on the Lid (13) with the slots on the Bowl. Place the