

Dimensions and installation guide

Top mount fridges

Models

KTM5200, KTM4400, KTM4200,
KTM3900, KTM3600

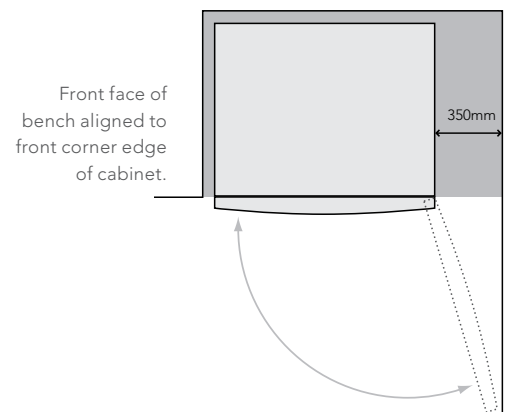
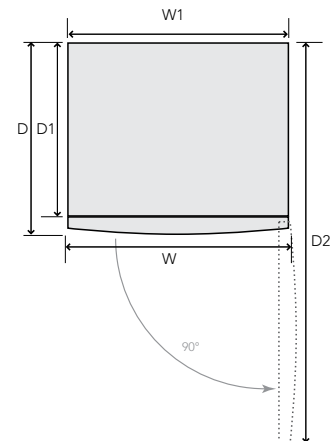
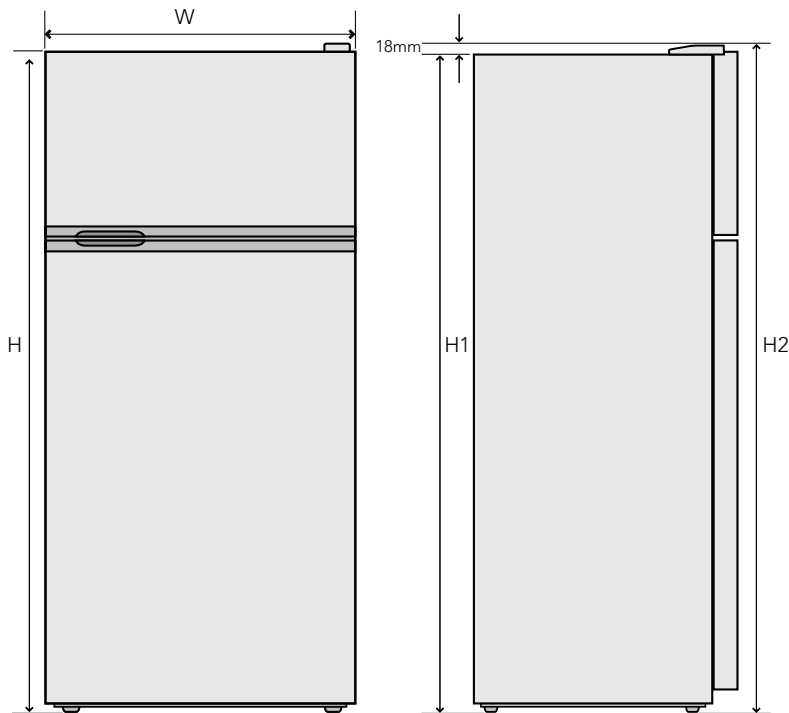

Recommended airspaces

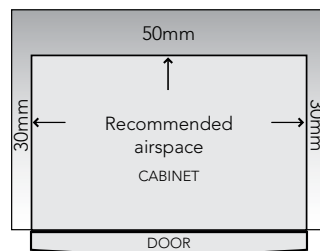
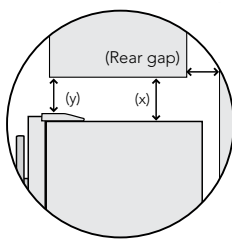

Please note:
Doors are designed to sit proud of cabinetry (not flush).

When positioned in a corner area, spacing of at least 350mm on the fridge side and 250mm on the freezer side, will allow the doors to open enough to enable the removal of the bins and glass shelves.

If you do not have a cupboard with a rear gap, the recommended clearance on top increases from 50mm to 90mm (x) and 32mm to 72mm (y).

model	max. door height (H)	cabinet height (H1)	total height (H2)	door width (W)	cabinet width (W1)	total depth (D)	cabinet depth (D1)	depth door open (D2)
KTM5200	1714	1702	1720	803	790	703	612	1450
KTM4400	1714	1702	1720	703	690	703	612	1350
KTM4200	1634	1622	1640	703	690	709	612	1350
KTM3900	1714	1702	1720	703	690	641	550	1288
KTM3600	1634	1622	1640	703	690	641	550	1288

All measurements in mm.