

omega  
*altise*

**OPAL MINI**



Personal Room  
Air Purifier

**Instruction  
Manual**

## **Important Safety Instructions**

1. Read all instructions.
2. Disconnect the power plug before dismantling, assembling or before cleaning.
3. Avoid touching mobile parts of the unit.
4. Make sure the air purifier is on a dry and even surface.
5. Never insert fingers, pencils or any other objects through the guards whenever the power plug is connected, especially while running.
6. The appliance is not intended for use by persons (including children) with reduced physical, sensory or mental capabilities, or lack of experience and knowledge, unless they have been given supervised or instruction concerning use of the appliance by a responsible person for their safety.
7. Young children or infirm persons should be supervised to ensure that they do not play with the appliance.
8. Do not use the appliance for any other purpose than its intended use.
9. The air purifier must not be used if the guards are not fastened according to instructions.
10. When the power cord is damaged, it must be replaced by the manufacturer or its service agent or a similarly qualified person in order to avoid a hazard.
11. Do not use your appliance with an extension cord unless it has been checked and tested by a qualified electrician or electrical supplier.
12. Use indoors and in dry locations only. It is not intended to use outdoors or in wet environments.
13. Except for filter replacement, the Air Purifier is not intended to be services and does not contain any serviceable replacement parts or adjustments.

***Read all instructions before using this unit. Keep them for future reference.***



**CAUTION! Do not immerse the unit in water or allow water to drip into the interior of the housing as this could create a fire or electric shock hazard.**



**WARNING! Do not attempt to open or repair the unit yourself. Doing so could void the warranty and cause damage or personal injury.**

## Specifications

<b>Model</b>	OPAL MINI
<b>Rated Voltage</b>	220-240V / 50Hz
<b>Watts</b>	17W
<b>Dimensions (h x w x d) mm</b>	213 x 155 x 166

<b>Weight</b>	1.5kg
<b>Control</b>	One touch
<b>Purifying air per hour</b>	22.1 cubic m/hr
<b>Warranty</b>	2 year replacement

## Parts List

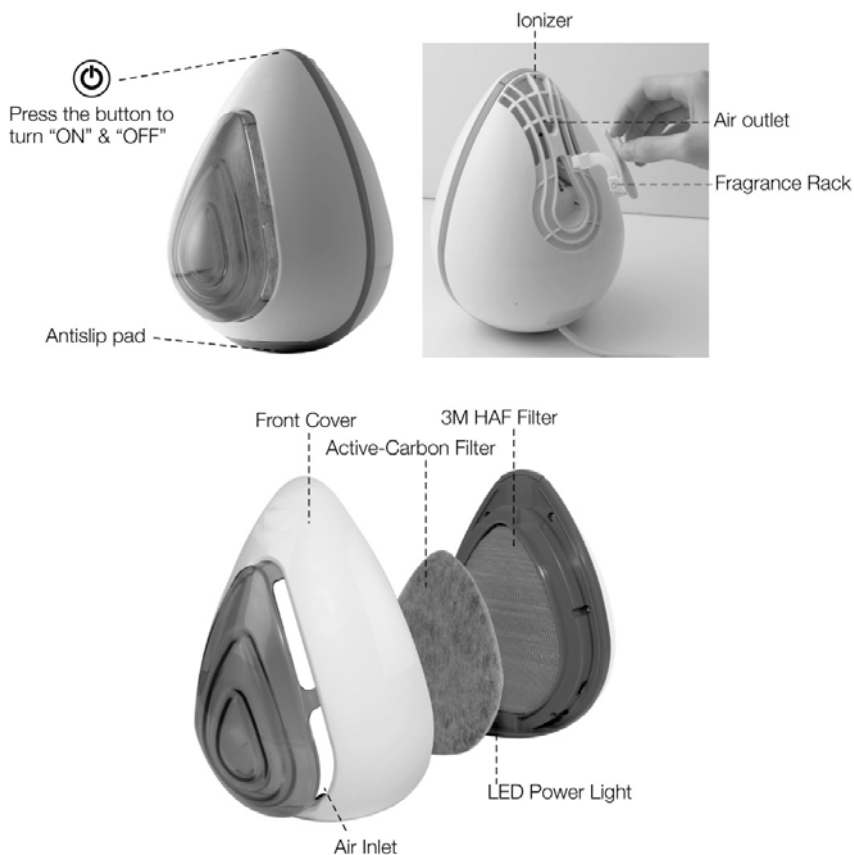

## **Operating Instructions**

1. Remove the air purifier from its packaging.
2. Ensure that the system of supplied filters (active carbon and 3M HAF filters) is properly in place.
3. Plug the power cord correctly into an electrical outlet.
4. Lightly press the One-Touch control at the top to turn on the Air Purifier.
5. This Air Purifier is installed with an ionizer. Once the Air Purifier is turned on, the ionizer operates automatically to neutralise many airborne pollutants, such as cigarette smoke, dust, pollen and fungus, etc. making the air more clean and fresh.
6. When the Air Purifier is switched on, a blue LED power light at the bottom front of the unit will be on. Ideal as a soft night-light.
7. Gently press the one-touch control to turn the Air Purifier off.
8. When not in use always unplug the power cord from the outlet

## **Fragrance Rack**

1. At the back of the unit, near the filtered air outlet, is a fragrance rack.
2. While the Air Purifier is switched off, pull out the fragrance rack and drip a few drops of fragrance or essential oil onto the rack. The sponge will soak the oil up. Reassemble the rack to its original position.
3. When you re-start the Air Purifier, the fragrance will diffuse into the filter air.

## **Filter System**

The filter system that this Air Purifier uses is comprised of 2 types:

- Active carbon filter – removes odours, organic vapour and larger dust particles and hair.
- 3M HAF filter – removes airborne particles (down to 0.1 micron size) and airborne allergens such as fine dust, dust mite debris or bacteria etc.

Typically the filter should be changed after every 2160hrs of use. However, this may vary depending on the surrounding conditions of actual use.

## Care and Maintenance

### Filter Replacement

1. Turn off and unplug the unit.
2. Hold the Air Purifier main body with one hand. Open the front cover from the top with the other hand until feeling a click. Detach the cover from the main body.
3. Remove the used filters (including both the active-carbon filter and 3M HAF filter).
4. Fit the replacement filters to the Air Purifier with the 3M HAF filter facing the body of the unit. Press the edges of the filters slightly to ensure untreated air cannot pass through the edge of the filters during operation.
5. Replace the cover.
6. Plug into a power socket. The unit is ready to continue operation.

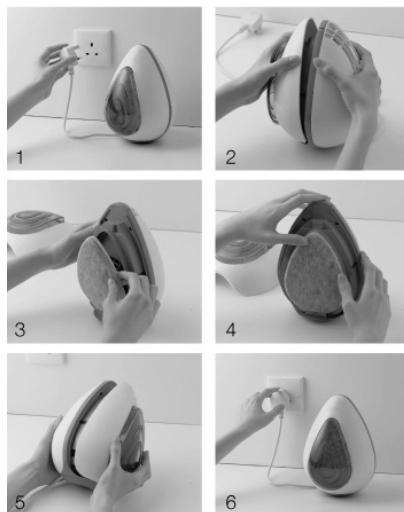

### Cleaning

This Air Purifier requires regular cleaning and removal of dirt to maintain proper operation. To clean:

1. Always disconnect the cord from the electrical outlet.
2. Use a soft and clean cloth to wipe the outside of the machine. Never use excessive water, strong or corrosive detergent to clean the machine. Gently wipe the surface, particularly the front shell, air inlet and outlet vents.
3. If you wish to clean the inside of the Air Purifier, use only a clean, dry and soft cloth to wipe it down. Please do not attempt to clean the ionizer needle because it may be damaged and/or cause the ionizer to malfunction.
4. Store the fan in a clean dry place when not in use.

Omega Altise products are distributed in Australia by MEA,  
(A Division of Hagemeyer Brands Australia Pty Ltd)

ABN 28 001 375 686

Locked Bag 4013, Kingsgrove NSW 2208

Phone: 1300 739 033

Fax: 1800 838 899

Email: [customerservice@meaappliances.com.au](mailto:customerservice@meaappliances.com.au)

Web: [meaappliances.com.au](http://meaappliances.com.au)