

CONTROLS & OPERATION

CONTROL KNOB:

The control knob is at the top rear of the motor. It has four settings: 0 (Off), 1 (Low), 2 (medium) and 3 (High). Turn the knob to the appropriate setting to adjust speed or turn off.

OSCILLATION:

The fan can be set to oscillate by pushing down the oscillation lever (5) down. Lifting the lever up will lock the fan position again.

CLEANING & MAINTENANCE

WARNING:



ALWAYS UNPLUG THE CORD BEFORE MOVING OR SERVICING, DO NOT IMMERSE APPLIANCE IN WATER!

The fan should be cleaned periodically (at least once a month depending on the build-up of dust).

Clean the body of the fan with a soft damp cloth. Always make sure that the appliance is completely dry before connecting back to the mains supply. Remove the front grill, clean the fan blades with a soft damp cloth and replace the front grill.

CAUTION: Do not use gasoline, benzene, thinner, harsh cleaners, etc. as they will damage the fan. NEVER use ALCOHOL OR SOLVENTS.

Do not disassemble the fan in any manner.

STORAGE: Store the fan with these instructions in the original packaging, in a cool, dry place.

It is important that you retain these instructions, proof of purchase as well as other important documents about this product for future reference. Due to continual product development, Omega Altise reserves the right to alter specifications or appearances without notice.
Dispose of packaging responsibly – recycle where facilities are available.

OPERATION, MAINTENANCE AND SAFETY INSTRUCTIONS

FOR OMEGA ALTISE DESK FAN



A division of Shriro Australia Pty Ltd
104 Vanessa St Kingsgrove NSW 2208
In Australia: 1300 795 572
In New Zealand: (09) 415 6000
www.omegaltise.com
IM Ref: SATINDESK40 11/2015/06

MODELS INCLUDE:
SATINDESK40

IMPORTANT SAFETY INSTRUCTIONS

IMPORTANT: Read the safety precautions of this booklet carefully before attempting to assemble, install, operate or maintain the product described. Protect yourself and others by observing all safety information. Failure to comply with instructions could result in personal injury and/or property damage. If you are unsure about anything regarding your fan or these instructions, please contact Omega Altise on 1300 795 572 in Australia or (09) 415 6000 in New Zealand before operating your appliance.

1. Read all instructions carefully before using the desk fan.
2. Use this fan only as described in this manual. Any other use not recommended by the manufacturer may cause fire, electrical shock, or injury to persons. Do not modify this appliance. Do not try to repair this appliance – there are no user serviceable parts within.
3. Remove the packaging and ensure that the appliance is undamaged (keep packing box for later storage). In case of doubt do not use the appliance and contact Omega Altise Service. Do not let children play with any parts of the packaging.
4. This appliance is not intended for use by persons (including children) with reduced physical, sensory or mental capabilities, or lack of experience or knowledge, unless they have been given supervision or instruction concerning the use of the appliance by a person responsible for their safety. Children should be supervised to ensure that they do not play with the appliance. Extreme caution is necessary when the fan is used by or near children or individuals with decreased mental and physical capacity and whenever the fan is left operating unattended.
5. Before you use the appliance, check if the voltage marked on the rating label corresponds to the mains in your home. The appliance must be connected to a grounded power supply.
6. Do not use this appliance with a programmer, timer or any other device that switches the appliance on automatically, since a fire risk exists if the appliance is covered or positioned incorrectly.
7. Do not pull the power cord to disconnect with the power source. Always grasp the plug to pull it out.
8. Do not run power cords under rugs, curtains or other combustible materials. Do not place power cords in areas where they can be a tripping hazard. Do not operate directly below a power outlet.
9. Do not insert any objects into the appliance as it may cause an electric shock or fire or damage to the appliance. Do not block or tamper with the appliance in any manner while it is in operation. To prevent a possible fire, do not cover the appliance in any manner. Do not place on soft surfaces, like a bed, where openings may become blocked.
10. Do not leave the appliance unattended. Always unplug the appliance when not in use. Take care that it is not obstructed when rotating.

WARNING:  The Function Switch should not be used as the sole means of disconnecting power. Always unplug the power cord before servicing or moving the appliance.

11. Keep materials such as hair, net curtains, tablecloths & clothes away from the openings of the fan, as material may be sucked into the appliance causing injury, damage to property or the appliance.
12. The appliance has hot and arcing or sparking parts inside. It must NOT be used in potentially dangerous locations such as flammable, explosive, chemical-laden, corrosive, salty or wet atmospheres. This appliance is intended for general indoor domestic use ONLY.
13. This appliance is not intended for use in wet or damp locations. Never locate it where it may fall into a bathtub or other water container.
14. Do not use the fan outdoors. Do not use close to windows or in direct sunlight.
15. NOTE that over time, the grills at the front and rear will build up dust & dirt. This should be cleaned regularly to maintain optimum efficiency. Follow the cleaning procedure within this instruction.
16. Always place the appliance on flat, stable surfaces before use. Always place the appliance vertically on its base.

WARNING:  To avoid danger of electric shock, unplug from outlet when not in use and before cleaning. If the supply cord is damaged, it must be replaced by the manufacturer, its Service Agent or similarly qualified persons in order to avoid a hazard. In order to avoid overheating, do not cover the appliance. Do not use the appliance in the immediate surrounding of a bath, shower or swimming pool.

TECHNICAL DETAILS

Model: SATINDESK40 desk fan.
Power: 230-240V~50Hz, 60W.
Weight: 3.4kg.
Dimensions (HxWxD): 54x44x40cm.

PARTS

PART	DESCRIPTION
01	Front Guard
02	Fan Blade
03	Rear Guard
04	Motor
05	Oscillation Lever
06	Main Control
07	Power Plug & Lead
08	Support Screw
09	Support Tube
10	Base Cover
11	Base
12	Screw & Washer

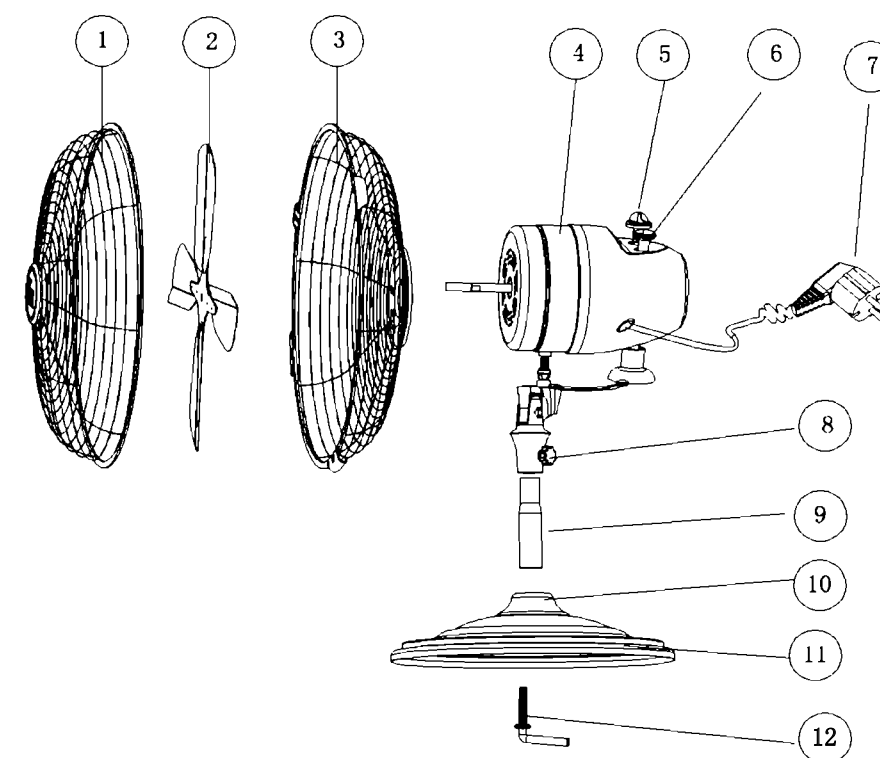

GETTING STARTED – ASSEMBLY

1. Carefully remove the appliance parts from the plastic bag and the carton, and unwind the cord to its full length.
2. Push the bottom of the support tube through the base cover and into the base. Turn everything upside down and place the base weight inside the base. Fix everything into place using the Screw & washer.
3. Push the support at the bottom of the motor over the support tube and tighten into place with the support screw.
4. Place the rear guard (handle to the top) over the front of the motor and fix in place with 2 screws.
5. Place the fan blade onto the motor impellor shaft, push until flush with the motor and tighten into place with the blade screw. Note: the screw should fix to the flattened area of the shaft.
6. Hang the front grill over the rear grill (small bracket to the bottom) and attach using the 4 clips around the outer edge. Use a small screwdriver to attach the bottom of the 2 grills together using the small screw and nut.
7. Adjust the speed control to 0 (off). Plug the cord set into a 230-240V~A.C. 50Hz earthed electrical outlet. Place on a level, smooth, stable surface. Turn the power on at the electrical outlet.