

Pioneer Dj

DJ Controller

DDJ-1000

[pioneerdj.com/support/
rekordbox.com](http://pioneerdj.com/support/rekordbox.com)

For FAQs and other support information for this product, visit the above site.

Operating Instructions (Quick Start Guide)

Thank you for buying this Pioneer product. Please read through these operating instructions so you will know how to operate your model properly. After you have finished reading the instructions, put them away in a safe place for future reference. In some countries or regions, the shape of the power plug and power outlet may sometimes differ from that shown in the explanatory drawings. However the method of connecting and operating the unit is the same.

IMPORTANT



The lightning flash with arrowhead symbol, within an equilateral triangle, is intended to alert the user to the presence of uninsulated "dangerous voltage" within the product's enclosure that may be of sufficient magnitude to constitute a risk of electric shock to persons.

CAUTION

**RISK OF ELECTRIC SHOCK
DO NOT OPEN**

CAUTION:

TO PREVENT THE RISK OF ELECTRIC SHOCK, DO NOT REMOVE COVER (OR BACK). NO USER-SERVICEABLE PARTS INSIDE. REFER SERVICING TO QUALIFIED SERVICE PERSONNEL.



The exclamation point within an equilateral triangle is intended to alert the user to the presence of important operating and maintenance (servicing) instructions in the literature accompanying the appliance.

D3-4-2-1-1b_A1_En

IMPORTANT SAFETY INSTRUCTIONS

- 1) Read these instructions.
- 2) Keep these instructions.
- 3) Heed all warnings.
- 4) Follow all instructions.
- 5) Do not use this apparatus near water.
- 6) Clean only with dry cloth.
- 7) Do not block any ventilation openings. Install in accordance with the manufacturer's instructions.
- 8) Do not install near any heat sources such as radiators, heat registers, stoves, or other apparatus (including amplifiers) that produce heat.
- 9) Do not defeat the safety purpose of the polarized or grounding-type plug. A polarized plug has two blades with one wider than the other. A grounding type plug has two blades and a third grounding prong. The wide blade or the third prong are provided for your safety. If the provided plug does not fit into your outlet, consult an electrician for replacement of the obsolete outlet.
- 10) Protect the power cord from being walked on or pinched particularly at plugs, convenience receptacles, and the point where they exit from the apparatus.
- 11) Only use attachments/accessories specified by the manufacturer.
- 12) Use only with the cart, stand, tripod, bracket, or table specified by the manufacturer, or sold with the apparatus. When a cart is used, use caution when moving the cart/apparatus combination to avoid injury from tip-over.
- 13) Unplug this apparatus during lightning storms or when unused for long periods of time.
- 14) Refer all servicing to qualified service personnel. Servicing is required when the apparatus has been damaged in any way, such as power-supply cord or plug is damaged, liquid has been spilled or objects have fallen into the apparatus, the apparatus has been exposed to rain or moisture, does not operate normally, or has been dropped.



D3-7-13-69_En

WARNING

This equipment is not waterproof. To prevent a fire or shock hazard, do not place any container filled with liquid near this equipment (such as a vase or flower pot) or expose it to dripping, splashing, rain or moisture.

D3-4-2-1-3_A1_En

WARNING

To prevent a fire hazard, do not place any naked flame sources (such as a lighted candle) on the equipment.

D3-4-2-1-7a_A1_En

The graphical symbol  placed on the product means alternating current.

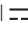
The graphical symbol  placed on the product means direct current.

The graphical symbol  placed on the product means Class II equipment.

D3-8-2-4_A1_En

CAUTION

The  switch on this unit will not completely shut off all power from the AC outlet. Since the power cord serves as the main disconnect device for the unit, you will need to unplug it from the AC outlet to shut down all power. Therefore, make sure the unit has been installed so that the power cord can be easily unplugged from the AC outlet in case of an accident. To avoid fire hazard, the power cord should also be unplugged from the AC outlet when left unused for a long period of time (for example, when on vacation).

D3-4-2-2-2a*_A1_En

Operating Environment

Operating environment temperature and humidity: +5 °C to +35 °C (+41 °F to +95 °F); less than 85 %RH (cooling vents not blocked)

Do not install this unit in a poorly ventilated area, or in locations exposed to high humidity or direct sunlight (or strong artificial light).

D3-4-2-1-7c*_A2_En

When using this product, confirm the safety information shown on the bottom of the unit.
D3-4-2-2-4_B1_En

IMPORTANT NOTICE
THE MODEL NUMBER AND SERIAL NUMBER OF THIS EQUIPMENT ARE ON THE REAR OR BOTTOM. RECORD THESE NUMBERS ON PAGE 19 FOR FUTURE REFERENCE.
D36-AP9-3*_A1_En

The Safety of Your Ears is in Your Hands

Get the most out of your equipment by playing it at a safe level – a level that lets the sound come through clearly without annoying blaring or distortion and, most importantly, without affecting your sensitive hearing. Sound can be deceiving. Over time, your hearing “comfort level” adapts to higher volumes of sound, so what sounds “normal” can actually be loud and harmful to your hearing. Guard against this by setting your equipment at a safe level BEFORE your hearing adapts.

ESTABLISH A SAFE LEVEL:

- Set your volume control at a low setting.
- Slowly increase the sound until you can hear it comfortably and clearly, without distortion.
- Once you have established a comfortable sound level, set the dial and leave it there.

BE SURE TO OBSERVE THE FOLLOWING GUIDELINES:

- Do not turn up the volume so high that you can't hear what's around you.
- Use caution or temporarily discontinue use in potentially hazardous situations.
- Do not use headphones while operating a motorized vehicle; the use of headphones may create a traffic hazard and is illegal in many areas.

S001a_A1_En

Information to User

Alterations or modifications carried out without appropriate authorization may invalidate the user's right to operate the equipment.

D8-10-2_A1_En

WARNING

Store small parts out of the reach of children and infants. If accidentally swallowed, contact a doctor immediately.

D41-6-4_A1_En

NOTE:

This equipment has been tested and found to comply with the limits for a Class B digital device, pursuant to Part 15 of the FCC Rules. These limits are designed to provide reasonable protection against harmful interference in a residential installation. This equipment generates, uses, and can radiate radio frequency energy and, if not installed and used in accordance with the instructions, may cause harmful interference to radio communications. However, there is no guarantee that interference will not occur in a particular installation. If this equipment does cause harmful interference to radio or television reception, which can be determined by turning the equipment off and on, the user is encouraged to try to correct the interference by one or more of the following measures:

- Reorient or relocate the receiving antenna.
- Increase the separation between the equipment and receiver.
- Connect the equipment into an outlet on a circuit different from that to which the receiver is connected.
- Consult the dealer or an experienced radio/TV technician for help.

D8-10-1-2_A1_En

FEDERAL COMMUNICATIONS COMMISSION DECLARATION OF CONFORMITY

This device complies with part 15 of the FCC Rules. Operation is subject to the following two conditions: (1) This device may not cause harmful interference, and (2) this device must accept any interference received, including interference that may cause undesired operation.

Product Name: DJ Controller
Model Number: DDJ-1000
Responsible Party Name: PIONEER ELECTRONICS (USA) INC.
SERVICE SUPPORT DIVISION
Address: 1925 E. DOMINGUEZ ST. LONG BEACH, CA 90810-1003, U.S.A.
Phone: 1-800-421-1404
URL: <http://www.pioneerelectronics.com>

D8-10-4*_C1_En

[Supplied power cord]

The supplied power cord is designed specifically for 120 V. Do not use it with a voltage other than 120 V. Doing so may cause a fire or electric shock.

D3-7-14_PDJ_A1_En

CAUTION

This product is evaluated in moderate climate condition.

D3-8-2-1-7b_A1_En

VENTILATION CAUTION

When installing this unit, make sure to leave space around the unit for ventilation to improve heat radiation (at least 5 cm at rear, and 5 cm at each side).

D3-4-2-1-7d*_A1_En

Before start

How to read this manual

- Thank you for purchasing this Pioneer DJ product.
This manual provides brief descriptions of the connection between the unit and your computer, and the audio output. For more instructions on how to use this product, refer to the Operating Instructions for this product.
Read this manual and the Operating Instructions before using the product. Both contain important information that you should understand to properly use the product.
- In this manual, names of buttons and terminals, menus of this product and your computer, etc., are enclosed in square brackets ([]) (e.g. **[File]**, **[CUE]** button, **[PHONES]** output terminal).
- Screens, external appearance, and software and hardware specifications described in this manual are based on the product that is still under development and may differ from the final specifications.
- Depending on your operating system, the web browser settings, etc., the procedures described in this manual may differ from actual operations.

Features

This unit is an all-in-one DJ controller designed specifically for rekordbox dj. Its interfaces incorporating various controls such as "BIG JOG", "PERFORMANCE PADS", and "4-CHANNEL MIXER" are positioned with room to spare to allow for more individualistic DJ performances using rekordbox dj. Also, numerous input and output terminals support a variety of DJ styles, and the design makes the unit look high quality, which is appropriate in a variety of scenes such as nightclubs and home parties.

Accessories

- AC adapter
- Power cord
- USB cable^[1]
- Operating Instructions (Quick Start Guide) (this document)
- rekordbox dj license key card

[1] One USB cable is included with this unit.

To connect two units, separately prepare a cable that conforms to the USB 2.0 standard.

Cautions

The license key cannot be reissued. Be careful not to lose it.

Viewing the manuals

Viewing the Operating Instructions for this unit

1 Launch a web browser on a computer and access the following Pioneer DJ site.

pioneerdj.com

2 Click [Support].

3 Click [Tutorials, manuals & documentation].

4 Click [DDJ-1000] in the [DJ CONTROLLER] category.

5 Click the desired language from the Operating Instructions list.

Download the manual as necessary.

Viewing the rekordbox introduction

1 Launch a web browser on the computer and access the site below.

rekordbox.com/manual

2 Click the required language of the rekordbox introduction.

rekordbox

- rekordbox rekordbox is music management software for DJs to prepare tracks and perform DJ play.
- rekordbox dj The DJ performance functions of rekordbox are called rekordbox dj. Enter the license key on the rekordbox dj license key card included with this product to use rekordbox dj.

Operating environment

Supported operating systems	CPU and required memory
Mac: macOS High Sierra 10.13/Sierra 10.12 (latest update), OS X 10.11/10.10 (latest update)	Intel® processor Core™ i7, i5, i3 Intel® processor Core™ 2 Duo 2.0 GHz or better 4 GB or more of RAM
Windows: 32-bit version or 64-bit version of Windows 10, Windows 8.1, or Windows 7 (latest service pack)	Intel® processor Core™ i7, i5, i3 Intel® processor Core™ 2 Duo 2.0 GHz or better 4 GB or more of RAM
Others	
USB port	A USB 2.0 port is required to connect a computer to this unit.
Display resolution	1 280 x 768 or greater
Internet connection	An Internet connection is required for registering the rekordbox user account and downloading the software.

- For information on the latest system requirements, compatibility, and supported operating systems of rekordbox, see the site below.
rekordbox.com/system
- Operation on all computers is not guaranteed, even if the computers meet the required operating environment.
- The CPU and hard disc may not provide sufficient processing capabilities depending on the power-saving setting, etc. on the computer. Confirm that the computer meets the conditions to provide constant high-performance (for example, connecting the computer to a power outlet to maintain a stable power supply) especially when using rekordbox on a laptop.
- A separate contract with an Internet service provider and payment of the utilization fee are required to access the Internet.
- Use the latest version/service pack of the operating system.

Preparing rekordbox

Install the software by following the procedure below when you use rekordbox for the first time or if you are using rekordbox 4.x or an earlier version.

If you have already installed rekordbox Ver. 5.x, update it to the latest version from **rekordbox Update Manager**. In this case, the following installation procedure is not required. For details on the update procedure, access the site below and see "rekordbox Introduction".
rekordbox.com/manual

Installing rekordbox

1 Launch a web browser on the computer and download rekordbox from the site below.

rekordbox.com/download

When downloading a Windows version, select either the 32-bit version or 64-bit version to match your computer.

2 Double-click the downloaded file to unzip it.

3 Double-click the unzipped file to launch the installer.

4 Carefully read the Software End User License Agreement, and proceed with the installation by following the instructions on the screen if you agree to the terms.

- If you do not agree to the license agreement, cancel the installation.

5 When the installation completion screen appears, close the installer by following the instructions on the screen.

The installation is completed.

Part names

For details on the buttons and controls, see *Part names and functions* in the Operating Instructions.

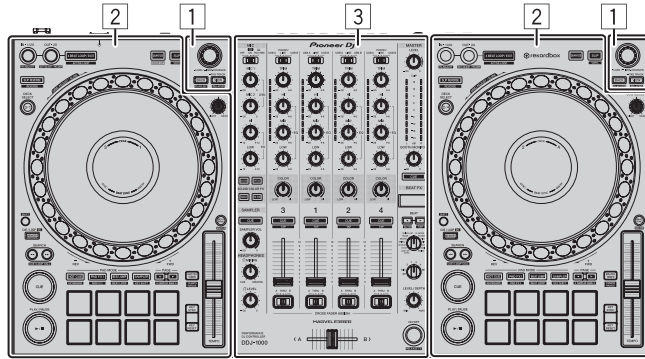

1 Browser section

3 Mixer section

2 Deck sections

Browser section

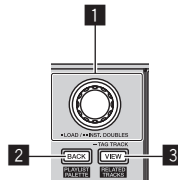

1 Rotary selector

2 BACK button

3 VIEW button

Deck sections

The deck sections are used to control the four decks. The buttons and controls for operating decks 1 and 3 are located on the left side of the controller, and those for operating decks 2 and 4 are located on the right side of the controller.

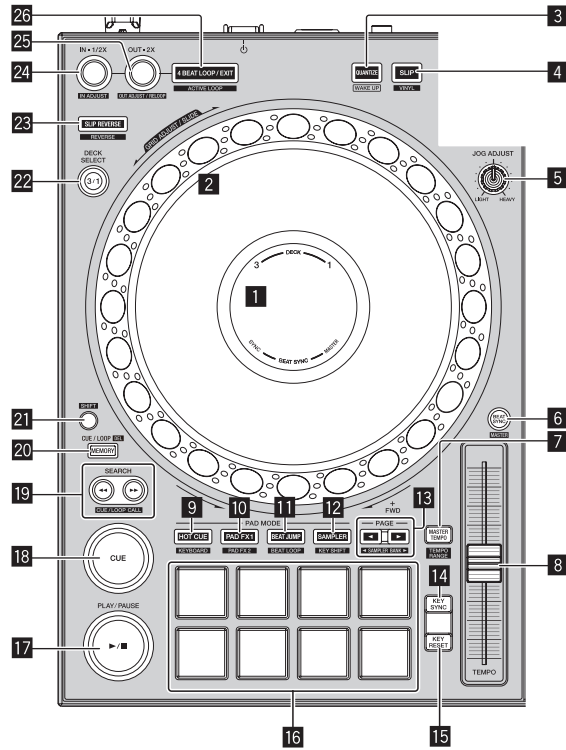

- | | |
|-------------------------------------|-------------------------------------|
| 1 Jog dial display section | 22 DECK selector button |
| 2 Jog dial | 23 SLIP REVERSE button |
| 3 QUANTIZE button | 24 LOOP IN, LOOP 1/2X button |
| 4 SLIP button | 25 LOOP OUT, LOOP 2X button |
| 5 JOG FEELING ADJUST control | 26 4 BEAT LOOP/EXIT button |
| 6 BEAT SYNC button | |
| 7 MASTER TEMPO button | |
| 8 TEMPO slider | |
| 9 HOT CUE mode button | |
| 10 PAD FX1 mode button | |
| 11 BEAT JUMP mode button | |
| 12 SAMPLER mode button | |
| 13 PAGE ◀, ▶ button | |
| 14 KEY SYNC button | |
| 15 KEY RESET button | |
| 16 Performance pads | |
| 17 PLAY/PAUSE ▶/ button | |
| 18 CUE button | |
| 19 SEARCH ◀◀, ▶▶ buttons | |
| 20 MEMORY button | |
| 21 SHIFT button | |

Mixer section

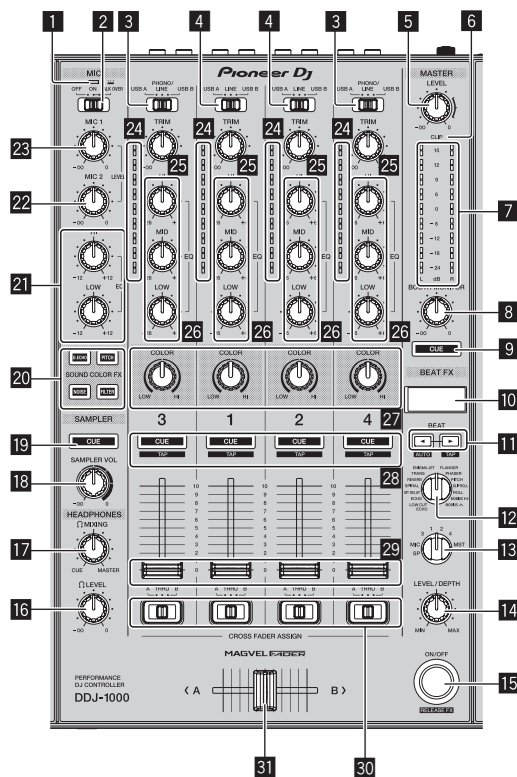

- | | |
|---|---|
| 1 Microphone indicator | 23 MIC1 LEVEL control |
| 2 OFF, ON, TALK OVER selector switch | 24 Channel level indicator |
| 3 USB A, PHONO/LINE, USB B selector switch | 25 TRIM control |
| 4 USB A, LINE, USB B selector switch | 26 EQ (HI, MID, LOW) control |
| 5 MASTER LEVEL control | 27 COLOR control |
| 6 CLIP indicator | 28 Headphones CUE button |
| 7 Master level indicator | 29 Channel fader |
| 8 BOOTH MONITOR LEVEL control | 30 Crossfader assign selector switch |
| 9 MASTER CUE button | 31 Crossfader |
| 10 Effect section display | |
| 11 BEAT ◀, ▶ buttons | |
| 12 BEAT FX SELECT control | |
| 13 BEAT FX CH SELECT control | |
| 14 BEAT FX LEVEL/DEPTH control | |
| 15 BEAT FX ON/OFF button | |
| 16 HEADPHONES LEVEL control | |
| 17 HEADPHONES MIXING control | |
| 18 SAMPLER VOL control | |
| 19 SAMPLER CUE button | |
| 20 SOUND COLOR FX SELECT buttons | |
| 21 MIC EQ (HI, LOW) controls | |
| 22 MIC2 LEVEL control | |

Rear panel

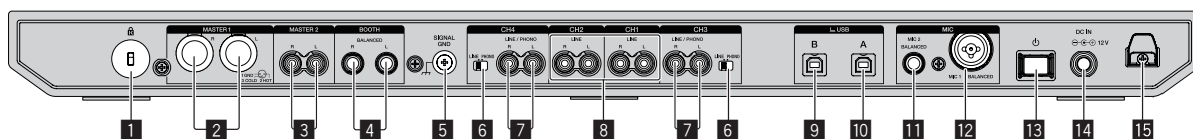

1 Kensington security slot

2 MASTER 1 output terminal

3 MASTER 2 output terminal

4 BOOTH output terminals

5 SIGNAL GND terminal

6 LINE/PHONO switch

7 LINE/PHONO input terminals

8 LINE input terminals

9 USB terminals (USB B)

10 USB terminals (USB A)

11 MIC2 input terminals

12 MIC1 input terminals

13 ⏻ switch

This switch is used to switch between standby and on.

14 DC IN terminal

15 DC cord hook

Front panel

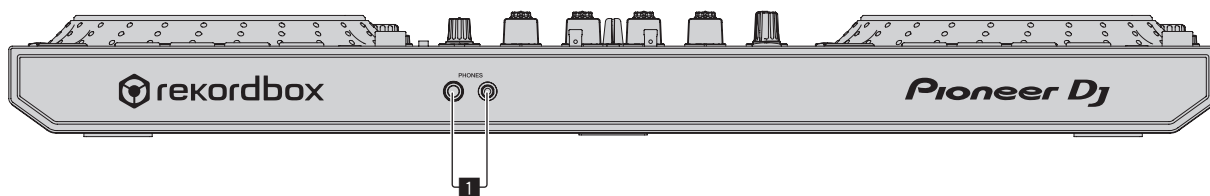

1 PHONES output terminals

Operation

- Connect the power cord to a power outlet after all the connections are completed.
Turn off this unit and disconnect the power cord from the power outlet before connecting components or changing the connections.
Refer to the operating instructions for the components to be connected.
- Be sure to use the included power cord and AC adapter.
- Be sure to use the USB cable included with this product or one that conforms to USB 2.0.
- Do not use a USB hub.

Example of connections

Connecting input terminals

Rear panel

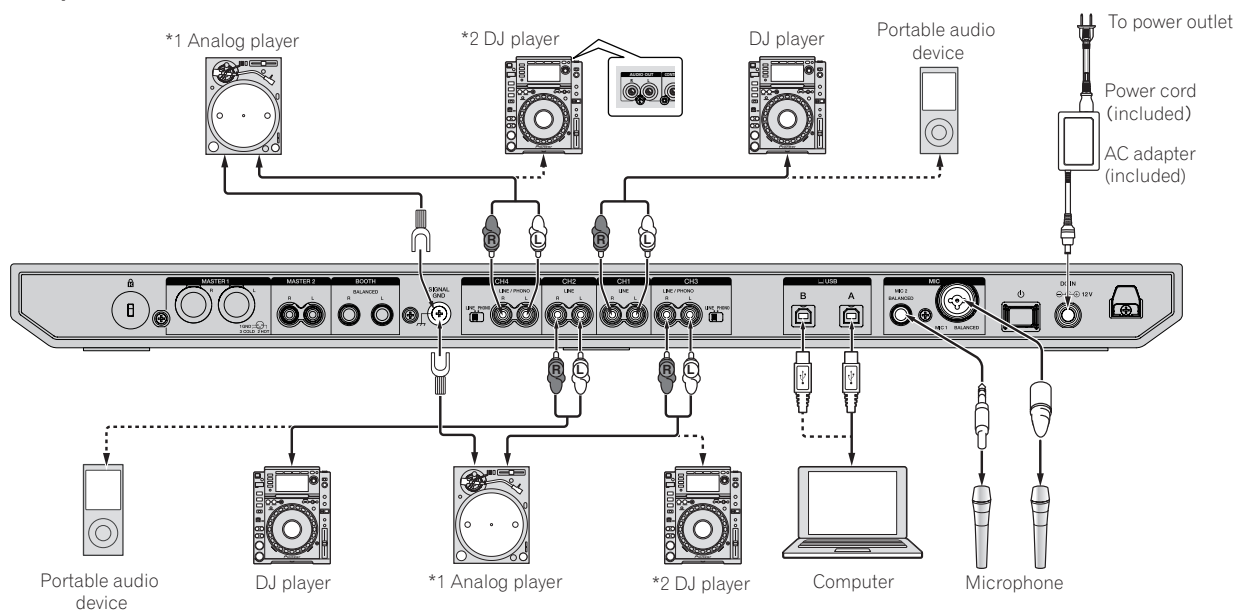

- *1 When connecting an analog player, switch the **[LINE/PHONO]** switch beside the terminals to **[PHONO]**.
- *2 When connecting a DJ player, switch the **[LINE/PHONO]** switch beside the terminals to **[LINE]**.

Connecting output terminals

Rear panel

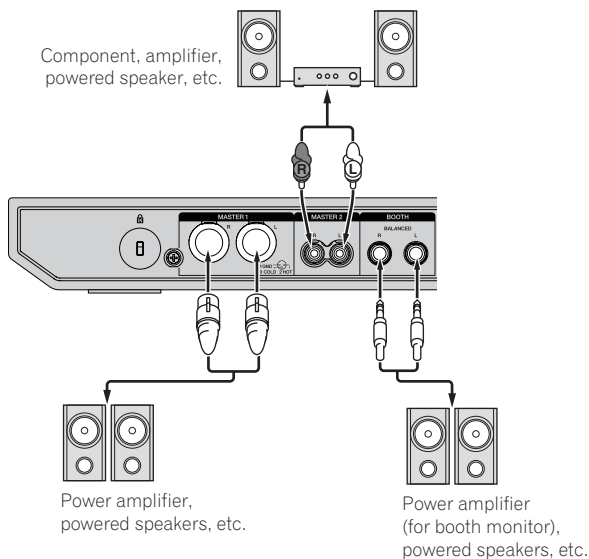

Front panel

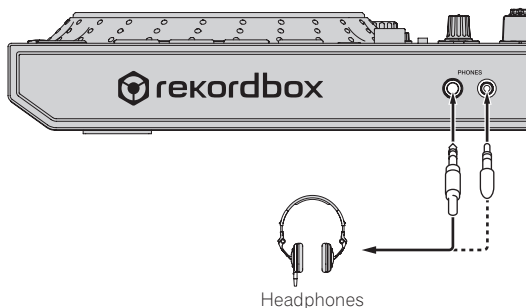

- 1 Be sure to use the **[MASTER 1]** output terminals for a balanced output. If they are connected to an unbalanced input (such as RCA) using an XLR to RCA converter cable (or converter adapter), etc., the sound quality may be lowered or noise may occur. For connection with an unbalanced input (such as RCA), use the **[MASTER 2]** output terminals.
- 2 **Be careful not to accidentally insert the power cord plug of another unit into a [MASTER 1] output terminals. Do not connect terminals capable of supplying phantom power to the [MASTER 1] output terminals.**
- 3 Be sure to use the **[BOOTH]** output terminals for a balanced output. If they are connected to an unbalanced input (such as an RCA or TS terminal) with an TRS to RCA converter cable (or converter adapter), TS cable, etc., the sound quality may be lowered or noise may occur.

Connections

For more information on how to use this product with rekordbox dj, refer to this product's Operating Instructions that is available on the Pioneer DJ site.

1 Connect headphones to the [PHONES] output terminals.

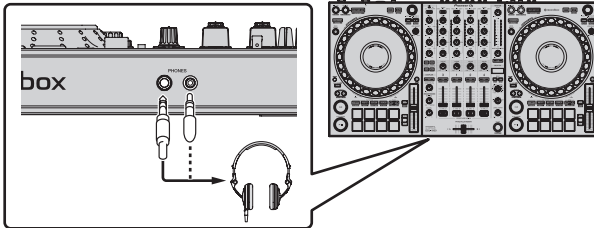

2 Connect devices such as powered speakers, a power amplifier, and components to the [MASTER 1] or [MASTER 2] output terminals.

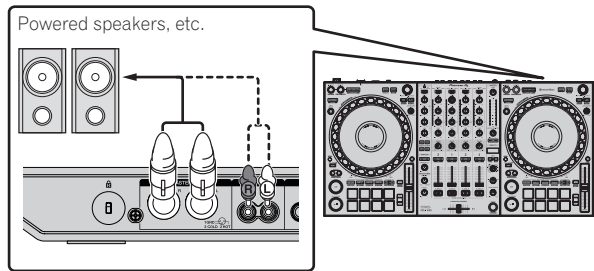

- To output the sound from the [BOOTH] output terminals, connect devices such as speakers to the [BOOTH] output terminals.

3 Connect this unit to your computer using a USB cable.

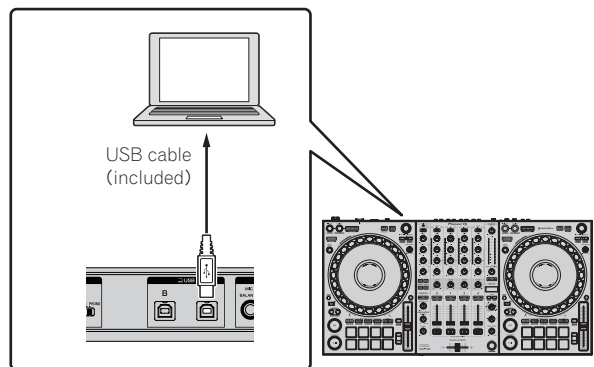

4 Turn the computer on.

5 Connect the AC adapter.

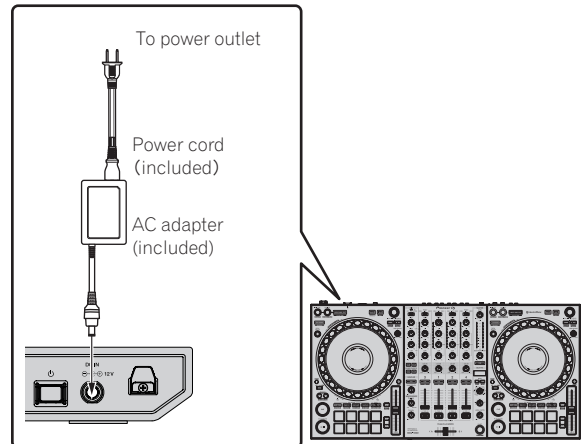

6 Press the [⏻] switch on the rear panel of this unit to turn this unit on.

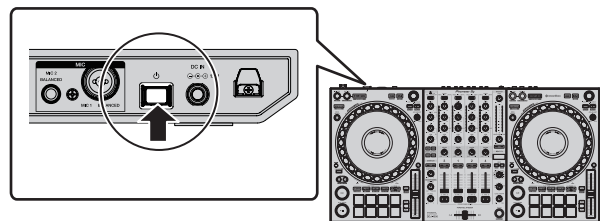

This unit turns on.

- For Windows [Installing device driver software] may appear when this unit is connected to the computer for the first time or connected to a different USB port on the computer. Wait for a while until [Your devices are ready for use] appears.

7 Turn on the devices connected to the output terminals (powered speakers, power amplifier, components, etc.).

- If a microphone, DJ player or other external device is connected to the input terminals, turn on the connected device.

Starting the system

Launching rekordbox

Account registration and activation work for rekordbox dj are required at first startup. For details on each work procedure, access the site below and see "rekordbox Introduction".
rekordbox.com/manual

For Mac

Open the [Applications] folder in Finder, and double-click the [rekordbox] icon.

For Windows 10

From the [Start] menu, click [Pioneer] > [rekordbox] icon.

For Windows 8.1

Click the [rekordbox] icon in [Apps view].

For Windows 7

Click the [Start] menu > [All Programs] > [Pioneer] > [rekordbox X.X.X] > the [rekordbox] icon in order.

Checking audio settings

Check that the [Audio] settings in [Preferences] of rekordbox are set as follows.

For Mac

[Audio]: [DDJ-1000]

[Output channels]:

[Master Output]: [DDJ-1000: MASTER]

[Headphones Output]: [DDJ-1000: HEADPHONE]

For Windows

[Audio]: [DDJ-1000 ASIO]

[Output channels]:

[Master Output]: [DDJ-1000 ASIO: MASTER]

[Headphones Output]: [DDJ-1000 ASIO: HEADPHONE]

- If PC MASTER OUT is enabled, the "+ Name of audio device in computer" information will also be displayed after [MASTER] of the [Master Output] item in the [Audio] settings.
-

Adding music files to [Collection]

A list of track files managed by rekordbox is displayed on the [Collection] screen.

Register the track files on the computer as the collection of music for rekordbox and analyze them to enable those tracks to be used with rekordbox.

1 Click [Collection] in the tree view.

A list of the tracks registered in [Collection] is displayed.

2 Open Finder or Windows Explorer, and drag and drop track files or folders containing track files to the track list.

The track files are added to [Collection], and the waveform analysis of the track files starts. Wait until the analysis of all the track files is finished.

Loading tracks into a deck

The following describes the procedure for loading tracks into deck 1 (left side) as an example.

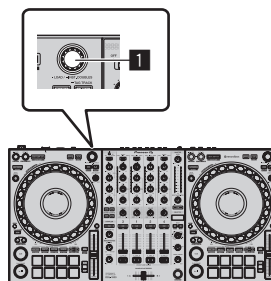

1 Rotary selector

- Turn the rotary selector of deck 1 (left side) to select a track in [Collection] and then press the rotary selector.

The track is loaded into deck 1.

Playing a music file

The following describes the procedure for outputting the sound of deck 1 (left side) as an example.

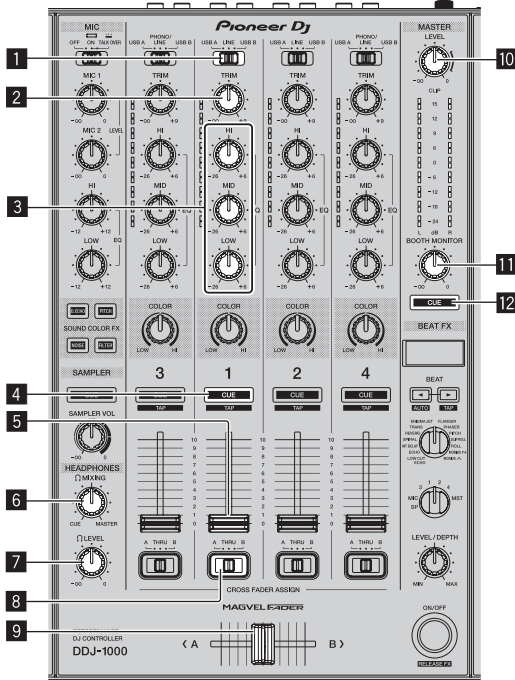

- 1 USB A, LINE, USB B selector switch
- 2 TRIM control
- 3 EQ (HI, MID, LOW) control
- 4 Headphones CUE button
- 5 Channel fader
- 6 HEADPHONES MIXING control
- 7 HEADPHONES LEVEL control
- 8 Crossfader assign selector switch
- 9 Crossfader
- 10 MASTER LEVEL control
- 11 BOOTH MONITOR LEVEL control
- 12 MASTER CUE button

1 Set the following as specified.

Part	Operation
USB A, LINE, USB B selector switch	USB A
TRIM control	Rotate it clockwise until it stops.
EQ (HI, MID, LOW) control	Center position
COLOR control	Center position
Channel fader	Move it forward.
MASTER LEVEL control	Rotate it clockwise until it stops.
Crossfader	Center position
Crossfader assign selector switch	[THRU] position

2 Press the [PLAY/PAUSE ▶/II] button to play the track.

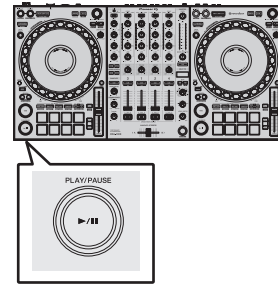

3 Rotate the [TRIM] control.

Adjust the [TRIM] control to confirm that the channel level indicator lights up in orange at the highest volume.

4 Move the channel fader forward.

5 Rotate the [MASTER LEVEL] control to adjust the sound level of the speakers.

Adjust the level of the sound output from the [MASTER 1] and [MASTER 2] output terminals to an appropriate level.

- To output sound from the computer's speaker, adjust the volume of the computer's speaker instead of the [MASTER LEVEL] control.

Monitoring sound with headphones

Set the following as specified.

Part	Operation
HEADPHONES MIXING control	Center position
HEADPHONES LEVEL control	Rotate it clockwise until it stops.

1 Press the headphones [CUE] button for channel 1.

2 Rotate the [HEADPHONES LEVEL] control.

Adjust the level of sound output from the headphones to an appropriate level.

Note

This unit and rekordbox dj include many functions to allow for more individualistic DJ performances. For details on each function, access the site below and see the "rekordbox Manual".
rekordbox.com/manual

Turning off the system

1 Close rekordbox.

2 Press the [⏻] switch on the rear panel of this unit to set the unit to standby.

3 Disconnect the USB cable from the computer.

Additional information

Changing the settings

- For details on changing the settings of this unit, see *Changing the settings* in the Operating Instructions.

Troubleshooting

- If you think that there is something wrong with this unit, check the items in the "Troubleshooting" section of this unit's operating instructions and access the Pioneer DJ support site and check **[FAQ]**.
pioneerdj.com/support/
Some problems occur due to the connected components. If the problem cannot be resolved after checking the connected components, contact the service center or your dealer for repairs.
- This unit may not operate properly due to static electricity or other external influences. In such cases, disconnect the power cord, wait for approximately one minute, and connect it again to restore normal operation.

Trademarks and registered trademarks

- Pioneer DJ is a trademark of the PIONEER CORPORATION and is used under license. rekordbox and KUVU are trademarks or registered trademarks of the Pioneer DJ Corporation.
- rekordbox is a trademark or registered trademark of the Pioneer DJ Corporation.
- Windows is a registered trademark of Microsoft Corporation in the United States and other countries.
- Mac, macOS, OS X, and Finder are trademarks of Apple Inc., registered in the U.S. and other countries.
- Intel and Intel Core are trademarks of Intel Corporation in the U.S. and/or other countries.

The names of companies and products mentioned herein are trademarks or registered trademarks of their respective owners.

Cautions on copyrights

rekordbox restricts playback and duplication of copyright-protected music contents.

- When coded data, etc., for protecting the copyright is embedded in the music contents, it may not be possible to operate the program normally.
- When rekordbox detects that coded data, etc., for protecting the copyright is embedded in the music contents, processing (playback, reading, etc.) may stop.

Recordings you have made are for your personal enjoyment and according to copyright laws may not be used without the consent of the copyright holder.

- Music recorded from CDs, etc., is protected by the copyright laws of individual countries and by international treaties. It is the full responsibility of the person who has recorded the music to ensure that it is used legally.
- When handling music downloaded from the Internet, etc., it is the full responsibility of the person who has downloaded the music to ensure that it is used in accordance with the contract concluded with the download site.

Specifications

— The specifications and design of this product are subject to change without notice.

AC adapter

Power requirements	AC 120 V, 60 Hz
Rated current	0.9 A
Rated output.....	DC 12 V, 3 A
Power consumption (standby)	0.4 W

General – Main Unit

Power consumption.....	DC 12 V, 2 000 mA
Main unit weight	6.0 kg (13.4 lb)
Max. external dimensions	708 mm (W) × 73.4 mm (H) × 361.4 mm (D) (27.9 in. (W) × 2.9 in. (H) × 14.2 in. (D))
Tolerable operating temperature	+5 °C to +35 °C (+41 °F to +95 °F)
Tolerable operating humidity	5 % to 85 % (no condensation)

Audio Section

Sampling rate.....	44.1 kHz
D/A converter	32-bit
A/D converter	24-bit
Frequency characteristic	
USB, LINE, MIC1, MIC2	20 Hz to 20 kHz
S/N ratio (rated output, A-WEIGHTED)	
USB	112 dB
LINE	96 dB
PHONO	85 dB
MIC1	80 dB
MIC2	80 dB
Total harmonic distortion (20 Hz to 20 kHzBW)	
USB	0.002 %
LINE	0.005 %
Standard input level / Input impedance	
LINE	-12 dBu/47 k Ω
PHONO	-52 dBu/47 k Ω
MIC1	-57 dBu/3.3 k Ω
MIC2	-57 dBu/3.3 k Ω
Standard output level / Load impedance / Output impedance	
MASTER 1	+6 dBu/10 k Ω /330 Ω or less
MASTER 2	+2 dBu/10 k Ω /680 Ω or less
BOOTH	+6 dBu/10 k Ω /330 Ω or less
PHONES	+8 dBu/32 Ω /10 Ω or less
Rated output level / Load impedance	
MASTER 1	25 dBu/10 k Ω
MASTER 2	21 dBu/10 k Ω
BOOTH	25 dBu/10 k Ω
Crosstalk	
LINE	82 dB
Channel equalizer characteristic	
HI	-26 dB to +6 dB (20 kHz)
MID	-26 dB to +6 dB (1 kHz)
LOW	-26 dB to +6 dB (20 Hz)
Microphone equalizer characteristic	
HI	-12 dB to +12 dB (10 kHz)
LOW	-12 dB to +12 dB (100 Hz)

Input / Output terminals

LINE input terminals	
RCA pin jacks.....	2 sets
LINE/PHONO input terminals	
RCA pin jacks.....	2 sets
MIC input terminals	
XLR connector & 1/4" TRS jack	1 set
1/4" TRS jack	1 set
MASTER output terminals	
XLR connector.....	1 set
RCA pin jacks.....	1 set
BOOTH output terminal	
1/4" TRS jack	1 set
PHONES output terminal	
1/4" stereo jack	1 set
3.5 mm stereo mini jack.....	1 set
USB terminals	
B type.....	2 sets

Pioneer Dj

Pioneer DJ Americas, Inc.
LIMITED WARRANTY
WARRANTY VALID ONLY IN THE U.S.A. AND CANADA

WARRANTY

Pioneer DJ Americas, Inc. (PDJA) warrants that products distributed by PDJA in the U.S.A. and Canada that fail to function properly under normal use due to a manufacturing defect when installed and operated according to the owner's manual enclosed with the unit will be repaired or replaced with a unit of comparable value, at the option of PDJA, without charge to you for parts or actual repair work. Parts supplied under this warranty may be new or rebuilt at the option of PDJA.

THIS LIMITED WARRANTY APPLIES TO THE ORIGINAL OR ANY SUBSEQUENT OWNER OF THIS PIONEER DJ PRODUCT DURING THE WARRANTY PERIOD PROVIDED THE PRODUCT WAS PURCHASED FROM AN AUTHORIZED PIONEER DJ DISTRIBUTOR/DEALER IN THE U.S.A. OR CANADA. YOU WILL BE REQUIRED TO PROVIDE A SALES RECEIPT OR OTHER VALID PROOF OF PURCHASE SHOWING THE DATE OF ORIGINAL PURCHASE OR, IF RENTED, YOUR RENTAL CONTRACT SHOWING THE PLACE AND DATE OF FIRST RENTAL. IN THE EVENT SERVICE IS REQUIRED, THE PRODUCT MUST BE DELIVERED WITHIN THE WARRANTY PERIOD, TRANSPORTATION PREPAID, ONLY FROM WITHIN THE U.S.A. AS EXPLAINED IN THIS DOCUMENT. YOU WILL BE RESPONSIBLE FOR REMOVAL AND INSTALLATION OF THE PRODUCT. PDJA WILL PAY TO RETURN THE REPAIRED OR REPLACEMENT PRODUCT TO YOU WITHIN THE U.S.A.

PRODUCT WARRANTY PERIOD

	Parts	Labor
Audio and Video	1 Year	1 Year

The warranty period for retail customers who rent the product commences upon the date product is first put into use (a) during the rental period or (b) retail sale, whichever occurs first.

WHAT IS NOT COVERED

IF THIS PRODUCT WAS PURCHASED FROM AN UNAUTHORIZED DISTRIBUTOR, THERE ARE NO WARRANTIES, EXPRESS OR IMPLIED, INCLUDING THE IMPLIED WARRANTY OF MERCHANTABILITY AND THE IMPLIED WARRANTY OF FITNESS FOR A PARTICULAR PURPOSE AND THIS PRODUCT IS SOLD STRICTLY "AS IS" AND "WITH ALL FAULTS". PIONEER DJ SHALL NOT BE LIABLE FOR ANY CONSEQUENTIAL AND/OR INCIDENTAL DAMAGES.

THIS WARRANTY DOES NOT APPLY IF THE PRODUCT HAS BEEN SUBJECTED TO POWER IN EXCESS OF ITS PUBLISHED POWER RATING.

THIS WARRANTY DOES NOT COVER THE CABINET OR ANY APPEARANCE ITEM, USER ATTACHED ANTENNA, ANY DAMAGE TO RECORDS OR RECORDING TAPES OR DISCS, ANY DAMAGE TO THE PRODUCT RESULTING FROM ALTERATIONS, MODIFICATIONS NOT AUTHORIZED IN WRITING BY PIONEER DJ, ACCIDENT, MISUSE OR ABUSE, DAMAGE DUE TO LIGHTNING OR TO POWER SURGES, SUBSEQUENT DAMAGE FROM LEAKING, DAMAGE FROM INOPERATIVE BATTERIES, OR THE USE OF BATTERIES NOT CONFORMING TO THOSE SPECIFIED IN THE OWNER'S MANUAL.

THIS WARRANTY DOES NOT COVER THE COST OF PARTS OR LABOR WHICH WOULD BE OTHERWISE PROVIDED WITHOUT CHARGE UNDER THIS WARRANTY OBTAINED FROM ANY SOURCE OTHER THAN A PIONEER DJ AUTHORIZED SERVICE COMPANY OR OTHER DESIGNATED LOCATION. THIS WARRANTY DOES NOT COVER DEFECTS OR DAMAGE CAUSED BY THE USE OF UNAUTHORIZED PARTS OR LABOR OR FROM IMPROPER MAINTENANCE.

ALTERED, DEFACED, OR REMOVED SERIAL NUMBERS VOID THIS ENTIRE WARRANTY

NO OTHER WARRANTIES

PIONEER DJ LIMITS ITS OBLIGATIONS UNDER ANY IMPLIED WARRANTIES INCLUDING, BUT NOT LIMITED TO, THE IMPLIED WARRANTIES OF MERCHANTABILITY AND FITNESS FOR A PARTICULAR PURPOSE, TO A PERIOD NOT TO EXCEED THE WARRANTY PERIOD. NO WARRANTIES SHALL APPLY AFTER THE WARRANTY PERIOD. SOME STATES DO NOT ALLOW LIMITATIONS ON HOW LONG AN IMPLIED WARRANTY LASTS AND SOME STATES DO NOT ALLOW THE EXCLUSIONS OR LIMITATIONS OF INCIDENTAL OR CONSEQUENTIAL DAMAGES, SO THE ABOVE LIMITATIONS OR EXCLUSIONS MAY NOT APPLY TO YOU. THIS WARRANTY GIVES YOU SPECIFIC LEGAL RIGHTS AND YOU MAY HAVE OTHER RIGHTS WHICH MAY VARY FROM STATE TO STATE.

TO OBTAIN SERVICE

PDJA has appointed a number of Authorized Service Companies throughout the U.S.A. and Canada should your product require service. To receive warranty service you need to present your sales receipt or, if rented, your rental contract showing place and date of original owner's transaction. If shipping the unit you will need to package it carefully and send it, transportation prepaid by a traceable, insured method, to an Authorized Service Company. Package the product using adequate padding material to prevent damage in transit. The original container is ideal for this purpose. Include your name, address and telephone number where you can be reached during business hours.

On all complaints and concerns in the U.S.A. and Canada call Customer Support at 1-800-872-4159.

For hook-up and operation of your unit or to locate an
Authorized Service Company, please call or write:
CUSTOMER SUPPORT
PIONEER ELECTRONICS (USA) INC.
P.O. BOX 1720
LONG BEACH, CALIFORNIA 90801
1-800-872-4159
<http://www.pioneerelectronics.com>

DISPUTE RESOLUTION

Following our response to any initial request to Customer Support, should a dispute arise between you and Pioneer DJ, Pioneer DJ makes available its Complaint Resolution Program to resolve the dispute. The Complaint Resolution Program is available to you without charge. You are required to use the Complaint Resolution Program before you exercise any rights under, or seek any remedies, created by Title I of the Magnuson-Moss Warranty-Federal Trade Commission Improvement Act, 15 U.S.C. 2301 *et seq.*

To use the Complaint Resolution Program call 1-800-872-4159 and explain to the customer service representative the problem you are experiencing, steps you have taken to have the product repaired during the warranty period and the name of the authorized Distributor/Dealer from whom the Pioneer DJ product was purchased. After the complaint has been explained to the representative, a resolution number will be issued. Within 40 days of receiving your complaint, Pioneer DJ will investigate the dispute and will either: (1) respond to your complaint in writing informing you what action Pioneer DJ will take, and in what time period, to resolve the dispute; or (2) respond to your complaint in writing informing you why it will not take any action.

RECORD THE PLACE AND DATE OF PURCHASE FOR FUTURE REFERENCE

Model No. _____ Serial No. _____ Purchase Date _____

Purchased From _____

KEEP THIS INFORMATION AND YOUR SALES RECEIPT IN A SAFE PLACE

UCP0516

To register your product, find the nearest authorized service location, to purchase replacement parts, operating instructions, or accessories, please go to one of following URLs :

Pour enregistrer votre produit, trouver le service après-vente agréé le plus proche et pour acheter des pièces de rechange, des modes d'emploi ou des accessoires, reportez-vous aux URL suivantes :

In the USA/Aux Etats-Unis or In Canada/Aux Canada
<http://www.pioneerelectronics.com>

S018_C1_EnFr_PSV

© 2017 Pioneer DJ Corporation.
All rights reserved.

Pioneer DJ Corporation

6F, Yokohama i-Mark Place, 4-4-5 Minatomirai, Nishi-ku, Yokohama, Kanagawa 220-0012 JAPAN

Pioneer DJ 株式会社

〒220-0012 神奈川県横浜市西区みなとみらい4丁目4番5号 横浜アイマークプレイス6階

Корпорация Пайонир Диджей

6F, Йокогама i-Mark Place, 4-4-5 Минатомирай, Ниси-ку, Йокогама, Канагава 220-0012 ЯПОНИЯ

Pioneer DJ Europe Limited

Anteros Building, Odyssey Business Park, West End Road, South Ruislip, Middlesex, HA4 6QQ, U.K. TEL: +44-203-7617-220

Pioneer DJ Americas, Inc.

2050 W. 190th Street, Suite 109, Torrance, CA 90504, U.S.A. TEL: +1 (424) 488-0480

PIONEER ELECTRONICS ASIACENTRE PTE. LTD.

2 Jalan Kilang Barat, #07-01, Singapore 159346 TEL: +65-6378-7888

PIONEER ELECTRONICS AUSTRALIA PTY. LTD.

5 Arco Lane, Heatherton, Victoria, 3202, Australia, TEL: +61-3-9586-6300

PIONEER ELECTRONICS (THAILAND) CO., LTD.

17th Fl., KPN Tower, 719 Rama 9 Road, Bangkapi, Huaykwang, Bangkok 10310
TEL: +66-2-717-0777

PIONEER TECHNOLOGY (MALAYSIA) SDN. BHD

16th Floor, Menara Uni. Asia 1008 Jalan Sultan Ismail 50250 Kuala Lumpur
TEL: +60-3-2697-2920

先鋒股份有限公司

台灣台北市內湖區瑞光路 407 號 8 樓 TEL: +886-(0)2-2657-3588

先鋒電子(香港)有限公司

香港九龍長沙灣道 909 號 5 樓 TEL: +852-2848-6488

PIONEER ELECTRONICS DE MEXICO S.A. DE C.V.

Blvd.Manuel Avila Camacho 138 10 piso Col.Lomas de Chapultepec, Mexico, D.F. 11000 TEL: +52-55-9178-4270

PIONEER INDIA ELECTRONICS PRIVATE LTD.

216, Second Floor, Time Tower, M.G. Road, Sector 28, Gurgaon 122001, Haryana, India TEL: +91-124-463-6100

PDJ_001_all

Printed in Malaysia

<DRH1468-A>

