

Personal Audio System

GB Operating Instructions



©2014 Sony Corporation Printed in China

CMT-X5CD/CMT-X5CDB

http://www.sony.net/



WARNING

To reduce the risk of fire, do not cover the ventilation opening of the appliance with newspapers, tablecloths, curtains, etc. Do not expose the appliance to naked flame sources (for example, lighted candles).

To reduce the risk of fire or electric shock, do not expose this appliance to dripping or splashing, and do not place objects filled with liquids, such as vases, on the appliance.

As the main plug is used to disconnect the unit from the mains, connect the unit to an easily accessible AC outlet. Should you notice an abnormality in the unit, disconnect the main plug from the AC outlet immediately.

Do not install the appliance in a confined space, such as a bookcase or built-in cabinet.

Do not expose batteries or appliances with battery-installed to excessive heat, such as sunshine and fire.

The unit is not disconnected from the mains as long as it is connected to the AC outlet, even if the unit itself has been turned off.

This equipment has been tested and found to comply with the limits set out in the EMC Directive using a connection cable shorter than 3 meters.

The nameplate is located on the bottom exterior.

CAUTION

The use of optical instruments with this product will increase eye hazard.

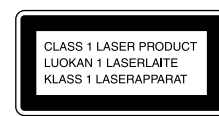

This appliance is classified as a CLASS 1 LASER product. This marking is located on the bottom exterior.

CAUTION

Danger of explosion if battery is incorrectly replaced. Replace only with the same or equivalent type.

For customers in Australia and New Zealand

This equipment should be installed and operated with at least 20 cm and more between the radiator and person's body (excluding extremities: hands, wrists, feet and ankles).

Before operating

Malfunctions that occur during the normal use of the system will be repaired by Sony in accordance with the conditions defined in the limited warranty for this system. However, Sony will not be liable for any consequences arising from a failure to play caused by a damaged or malfunctioning system.

Musical discs encoded with copyright protection technologies

This product is designed to playback discs that conform to the Compact Disc (CD) standard. Recently, various music discs encoded with copyright protection technologies are marketed by some record companies. Please be aware that among those discs, there are some that do not conform to the CD standard and may not be playable by this product.

Note on DualDiscs

A DualDisc is a two sided disc product which mates DVD recorded material on one side with digital audio material on the other side. However, since the audio material side does not conform to the Compact Disc (CD) standard, playback on this product is not guaranteed.

License and Trademark Notice

•Windows Media is either a registered trademark or trademark of Microsoft Corporation in the United States and/or other countries.

•This product is protected by certain intellectual property rights of Microsoft Corporation. Use or distribution of such technology outside of this product is prohibited without a license from Microsoft or an authorized Microsoft subsidiary.

•MPEG Layer-3 audio coding technology and patents licensed from Fraunhofer IIS and Thomson.

•“WALKMAN” and “WALKMAN” logo are registered trademarks of Sony Corporation.

•© 2013 CSR plc and its group companies. The aptX® mark and the aptX logo are trademarks of CSR plc or one of its group companies and may be registered in one or more jurisdictions.

•The BLUETOOTH® word mark and logos are registered trademarks owned by BLUETOOTH SIG, Inc. and any use of such marks by Sony Corporation is under license.

•The N Mark is a trademark or registered trademark of NFC Forum, Inc. in the United States and in other countries.

•Android and Google Play are trademarks of Google Inc.

•The system names and product names indicated in this manual are generally the trademarks or registered trademarks of the manufacturer. ™ and ® marks are omitted in this manual.

•Apple, the Apple logo, iPad, iPhone, iPod, iPod classic, iPod nano and iPod touch are trademarks of Apple Inc., registered in the U.S. and other countries. App Store is a service mark of Apple Inc.

•“Made for iPod” and “Made for iPhone” mean that an electronic accessory has been designed to connect specifically to iPod and iPhone, respectively, and has been certified by the developer to meet Apple performance standards. Apple is not responsible for the operation of this device or its compliance with safety and regulatory standards. Please note that the use of this accessory with iPod or iPhone may affect wireless performance.

•“Xperia” and “Xperia Tablet” are trademarks of Sony Mobile Communications AB.

Getting Started

Location of Controls

Note

This manual mainly explains operations using the remote, but the same operations can also be performed using the buttons on the unit having the same or similar names.

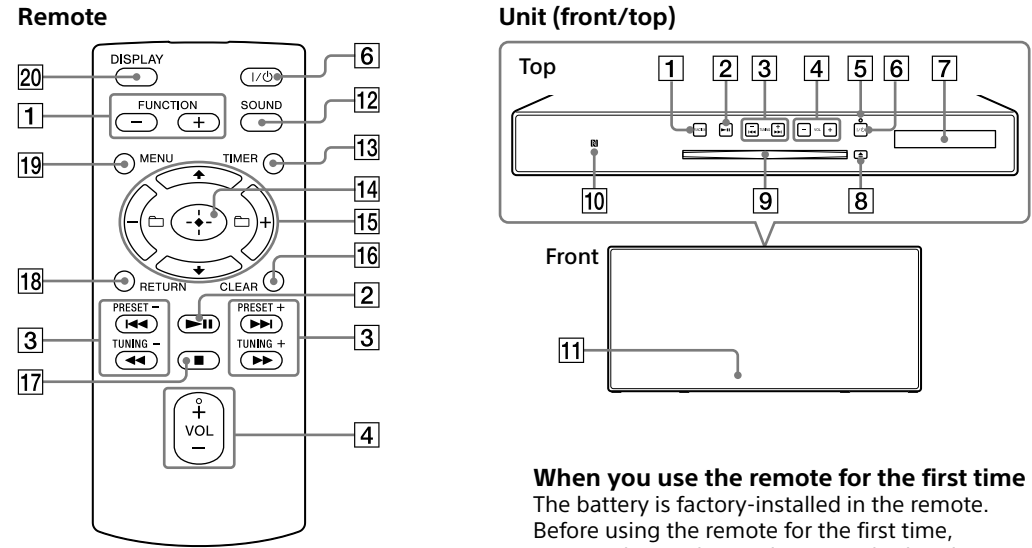

When you use the remote for the first time

The battery is factory-installed in the remote. Before using the remote for the first time, remove the insulation sheet attached to the battery holder. For details, see “Changing the battery”.

Unit (back)

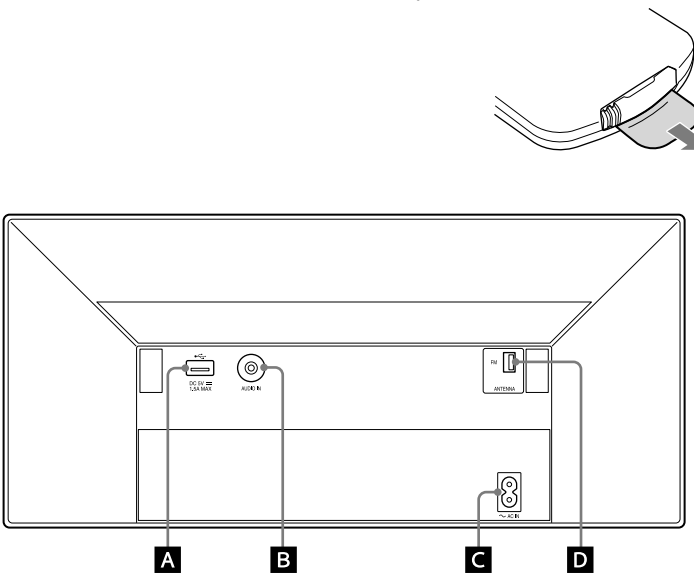

A ~ (USB) port

Connect a USB device.

Note

•You can use your iPhone/iPod with this system via Bluetooth or connection only.

B AUDIO IN (external input) jack

Connect optional external equipment with an audio connecting cable (not supplied).

C ~ AC IN (220-240V AC) input

Connect the power cord (supplied) to the wall outlet.

D FM ANTENNA (for CMT-X5CD only) DAB/FM ANTENNA (for CMT-X5CDB only)

Connect the FM or DAB/FM antenna.

* The illustration above is for CMT-X5CD.

Note

•Find a location and an orientation that provide good reception, and then fix the antennas to a stable surface (window, wall, etc.).

•Secure the end of the FM lead antenna with adhesive tape.

Reception of DAB/DAB+ radio station (CMT-X5CDB only)

When you turn on the system for the first time after you purchase the system, DAB Automatic Scan starts automatically and creates a list of available services. During the DAB Automatic Scan, “*****” appears. Do not press any button on the unit or the remote during DAB Automatic Scan. Scanning is interrupted and service list may not be created properly. To run the DAB Automatic Scan manually, perform the procedure of “Running the DAB Automatic Scan manually.” If you have moved to another area, perform the DAB Automatic Scan manually and re-register the contents of broadcasts.

Listening to a CD

Playing a CD-DA/MP3 disc

1 Press FUNCTION [1] to select “CD.”

2 Insert a CD to the disc slot [9] at the top of the unit.

Load a CD with the label side (printed side) toward you.

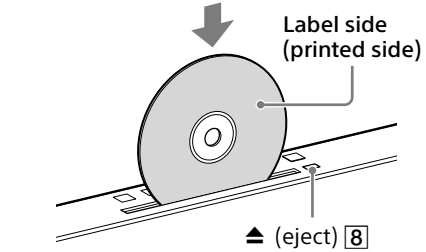

Plays back automatically. If you switch the function to “CD” from another function when a CD is already inserted in the slot, press ►II [2] after “READING” has disappeared from the display window [7].

The button of the remote or the unit enables you to fast-rewind/fast forward, select a track, file or folder (for MP3 disc), etc.

To eject the CD

Press ▲(eject) [8] on the unit.

Note

•8 cm CD cannot be used with this system.
•Do not load a CD with non-standard shapes (e.g., heart, square, star). Doing this may cause irreparable damage to the system.
•Do not use a CD with tape, stickers or paste on it as this may cause malfunction.
•When you remove a CD, do not touch the surface of the disc.

To change the play mode

Play mode enables you to playback the same music repeatedly or shuffle-play.

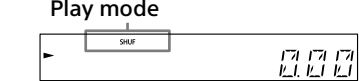

1 Press ■ [7] to stop playback.

If you select “REPEAT” in step 4, you do not have to stop playback.

2 Press MENU [9].

3 Press ◀/▶ [15] to select “CD MENU,” then press ⊕ [14].

4 Press ◀/▶ [15] to select “PLAYMODE” or “REPEAT,” then press ⊕ [14].

5 Press ◀/▶ [15] to select the play mode, then press ⊕ [14].

You can select the following play modes.

PLAYMODE	
Play mode	Effect
NORMAL	Plays a track or file.
FOLDER*	Plays all tracks in the selected folder. “FLDR” lights up in the display window [7].
SHUFFLE	Plays all tracks or files in random order. “SHUF” lights up in the display window [7].
FLDR.SHUF*	Plays all tracks or files in the selected folder in random order. “FLDR. SHUF” lights up in the display window [7].
PROGRAM	Plays the programmed tracks or files. “PGM” lights up in the display window [7]. For details, see “Creating your own program (Program Play).”

* This play mode is applicable only for playing an MP3 disc.

REPEAT

Play mode	Effect
ALL (Repeat plays all tracks)	The system plays all tracks in a disc or folder repeatedly. “◀” lights up in the display window [7].
ONE (Repeat plays one track)	The system plays the selected track repeatedly. “◀1” lights up in the display window [7].
OFF	Cancels repeat playback.

Note on playing MP3 discs

•Do not save unnecessary folders or files on a disc that has MP3 files.
•Folders that have no MP3 files are not recognized on the system.
•The system can only play MP3 files that have a file extension of “.mp3.” Even when file name has the “.mp3” file extension, if it is not an audio MP3 file, playing this file may generate a loud noise, which could cause damage of the system.
•The maximum number of MP3 folders and files compatible with this system is:
—999* folders (including the root folder)
—999 files
—250 files in a single folder
—8 folder levels (in the tree structure of files)
* This includes folders that have no playable audio file and empty folders. The number of folders that the system can recognize may be less than actual number of folders, depending on the folder structure.
•This include folders that have no MP3 or other files. The number of folders that the system can recognize may be less than actual number of folders, depending on the folder structure.
•Compatibility with all MP3 encoding/writing software, CD-R/RW drive and recording media cannot be guaranteed. Incompatible MP3 discs may produce noise or interrupted audio or may not play at all.

Creating your own program (Program Play)

Plays the programmed track or file in a CD.

1 Select “PROGRAM” in step 5 of “To change the play mode,” then press ⊕ [14].

2 When using an MP3 disc, press ◀/▶ [15] to select the folder containing the tracks or files that you want to program.

If you want to play all tracks or files in the folder, press ⊕ [14].

3 Press ◀◀/▶▶ [3] to select a desired track or file, then select ⊕ [14].

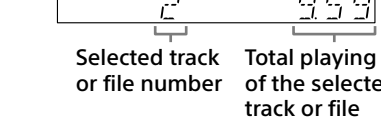

Repeat the steps above to program additional tracks or files.

4 Press ►II [2].
Your program of tracks or files starts playback.

To cancel program play

In step 1, select “NORMAL” for “PROGRAM,” then press ⊕ [14].

To delete a programmed track or file

Press CLEAR [10] while the play is stopped. Each time you press the button, the last programmed track or file will be deleted. When all the programmed tracks or files are deleted, “NO STEP” appears.

Tip

•Up to 25 tracks or files can be programmed. If you attempt to program more than 25 tracks or files, “FULL” will be displayed. In this case, delete unnecessary tracks.
•To play the same program again, press ►II [2].

Note

•When the disc is ejected or the power cord is disconnected after programming, all the programmed tracks and files are deleted.

Listening to the radio

Tuning in a radio station

1 Press FUNCTION [1] to select “FM” or “DAB” (CMT-X5CDB).

2 Press and hold PRESET +/- [3] until the frequency indication in the display window [7] starts changing, then release the button.

Tuning stops automatically when a FM stereo broadcast is received (Automatic Scanning). “ST” lights up in the display window [7].

* DAB is for CMT-X5CDB only.

Manual tuning

Press PRESET +/- [3] repeatedly to tune-in the desired station.

Note on DAB/DAB+ stations (CMT-X5CDB only)

•When you tune in a station that provides RDS services, information such as the service name and station name is provided by broadcasts.
•If the USB device cannot be charged, disconnect and reconnect it. For details on the charging status of the USB device, see the operating manual of the USB device.
•Primary service is automatically received when secondary service ends.
•This tuner does not support data services.

Tip

•If reception of an FM stereo broadcast is noisy, press MENU [9] and select “TUNE.MENU,” “FM MODE” and “MONO” in turn, to select monaural reception. This reduces noise.

Presetting radio stations

You can preset your desired radio stations.

1 Tune in the desired station, then press MENU [9].

2 Press ◀/▶ [15] to select “TUNE.MENU,” then press ⊕ [14].

3 Press ◀/▶ [15] to select “MEMORY,” then press ⊕ [14].

4 Press ◀/▶ [15] to select “OK,” then press ⊕ [14].

5 Press ◀/▶ [15] to select the preset number, then press ⊕ [14].

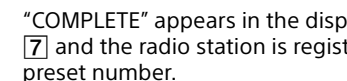

“COMPLETE” appears in the display window [7] and the radio station is registered with the preset number.

Repeat the steps above to register further radio stations.

6 Press I/O [6] to turn off the power, then press I/O [6] again to turn on the power.

Tip

•You can preset up to 20 FM, 20 DAB/DAB+ and 20 FM stations (CMT-X5CDB).
•If you select an already-registered preset number in step 5, the preset radio station is replaced by the currently tuned-in radio station.

To tune in to a preset radio station

Press PRESET +/- [3] to select the preset number to which the desired station is registered.

Running the DAB Automatic Scan manually (CMT-X5CDB only)

Before you can tune in DAB/DAB+ stations, you must perform a DAB Initial Scan. When you have moved to another area, also perform the DAB Initial Scan manually to update the DAB/DAB+ service information.

1 Press MENU [9].

2 Press ◀/▶ [15] to select “TUNE.MENU,” then press ⊕ [14].

3 Press ◀/▶ [15] to select “INIT:SCAN,” then press ⊕ [14].

4 Press ◀/▶ [15] to select “OK,” then press ⊕ [14].
Scanning begins. The scanning progress is indicated by asterisks (*****). Depending on the DAB/DAB+ services available in your area, scanning may take a few minutes.

Note

•If your country or region does not support DAB/DAB+ broadcast, “NO SERV” appears.
•This procedure clears all previously stored presets.
•Before unplugging the DAB/FM lead antenna, make sure the system is turned off to preserve your own DAB/DAB+ settings.

Listening to a file on a USB device

You can play audio files stored on a USB device such as WALKMAN® or digital media player, on this system by connecting a USB device to the system.

For details on compatible USB devices, see “Compatible devices and versions.”
1 Press FUNCTION [1] to select “USB.”
2 Press MENU [9].
Connect the USB device to the ~ (USB) port [A] on the rear of the unit.
Connect the USB device directly, or via the USB cable supplied with the USB device, to the ~ (USB) port [A].
Wait until “READING” disappears.

3 Press ►II [2].
Starts playback.

You can operate fast-rewind/fast-forward, selecting a track or file or selecting folder with the remote or the button of the unit.

To change the play mode

When playing the USB device, the play mode can be selected. Press MENU [9], then select “USB MENU.” Select “PLAYMODE” or “REPEAT.” For details, see “To change the play mode” of “Listening to a CD.” When a file on a USB device is playing, programmed playback cannot be played.

Tip

•If a USB device is connected to the unit, battery charging starts automatically. Even when the system is off, the USB device can be charged.

•If the USB device cannot be charged, disconnect and reconnect it. For details on the charging status of the USB device, see the operating manual of the USB device.

Note

•The playback order for the system may differ from the playback order of the connected digital music player.
•Be sure to turn off the system before removing the USB device. Removing the USB device while the system is turned on may corrupt the data on the USB device.
•When USB cable connection is necessary, connect the USB cable supplied with the USB device to be connected. For details on connection, refer to the operation manual supplied with the USB device to be connected.
•It may take time before “READING” appears after connecting, depending on the type of USB device connected.
•Do not connect the USB device through a USB hub.
•When the USB device is connected, the system reads all the files on the USB device. If there are many folders or files on the USB device, it may take a long time to finish reading the USB device.
•With some connected USB devices, it may take a long time to transmit signals from the system or to finish reading the USB device.
•Compatibility with all encoding/writing software cannot be guaranteed. If audio files on the USB device were originally encoded with incompatible software, those files may produce noise or, may malfunction.
•The maximum number of folders and files on the USB device compatible with this system is:
—3,000 folders (including the root folder)
—3,000 files
—250 files in a single folder
—8 folder levels (in the tree structure of files)
* This includes folders that have no playable audio file and empty folders. The number of folders that the system can recognize may be less than actual number of folders, depending on the folder structure.

•The system does not necessarily support all the functions provided in a connected USB device.
•Folders that have no audio files are not recognized.
•The audio formats that you can listen to with this system are as follows:
—MP3: file extension “.mp3”
—WMA*: file extension “.wma”
—AAC*: file extension “.m4a,” “.mp4” or “.3gp”

Note that even when file name has the correct file extension, if the actual file differs, the system may produce noise or may malfunction.

* Files with DRM (Digital Rights Management) copyright protection or files downloaded from an online music store cannot be played on this system. If you try to play one of these files, the system plays the next unprotected audio file.

Listening to music with optional audio components

Playing back the music of optional audio components

You can play a track of optional audio components connected to the unit.

Note

•Beforehand, press the VOL - [4] to turn down the volume.

1 Press FUNCTION [1] to select “AUDIO IN.”

2 Connect its audio connecting cord to the AUDIO IN jack [B] on the rear of the unit and the output terminal of the optional external equipment.

3 Start playback of the connected component. Adjust the volume on the connected component during playback.

4 Press VOL +/- [4] on the remote to adjust the volume.

Note

•The system may enter Standby mode automatically if the volume level of the connected component is too low. For details, see “Setting the Automatic Standby function.”

Listening to music through a BLUETOOTH connection

Pairing the system with a BLUETOOTH device and listening to music

You can listen to music from BLUETOOTH device over a wireless connection. Before using the BLUETOOTH function, perform pairing to register your BLUETOOTH device.

Note

•Place the BLUETOOTH device to be connected within one meter of the system.
•If your BLUETOOTH device is compliant with touch (NFC), skip the next procedure. See “Listening to music by one-touch action (NFC).”

1 Press FUNCTION [1] to select “BT AUDIO.”

2 Press MENU [9].

3 Press ◀/▶ [15] to select “BT MENU,” then press ⊕ [14].

4 Press ◀/▶ [15] to select “PAIRING,” then press ⊕ [14].

5 Press ◀/▶ [15] to select “OK” then press ⊕ [14].
When “PAIRING” starts flashing in the display window [7], the system changes to pairing mode.

6 Search for this system with the BLUETOOTH device.

A list of the devices found may appear on the BLUETOOTH device display.

7 Select [SONY:CMT-X5CD] or [SONY:CMT-X5CDB] (this system).

If prompted to enter a passkey on the BLUETOOTH device, enter “0000.”

If this system is not shown in the display of the device, proceed from step 1 again.

When pairing is completed, the display changes to the connected BLUETOOTH device name from “PAIRING” and the BLUETOOTH indicator lights up.

8 Press ►II [2].

Starts playback.
Depending on the BLUETOOTH device, press ►II [2] again. Also, you may have to start up a music player on the BLUETOOTH device.

9 Press VOL +/- [4] to adjust the volume.
If the volume cannot be changed on the system, adjust it on your BLUETOOTH device. Operation such as fast-rewind/fast-forward, selecting music and selecting a folder can be operated with the remote or buttons of the unit.

Tip</

Playing with high quality sound codec (AAC/aptX)

You can receive the data in AAC or aptX codec format from a BLUETOOTH device. It provides the playback with a higher quality sound. The factory settings of "BT AAC" and "BT APTX" are "ON."

- Press MENU ⏏.
- Press ⏏/⏏ ⏏ to select "BT MENU," then press ⏏ ⏏.
- Press ⏏/⏏ ⏏ to select "BT AAC" (AAC codec) or "BT APTX" (aptX codec), then press ⏏ ⏏.
- Press ⏏/⏏ ⏏ to select "ON," then press ⏏ ⏏.

Note

- If you initiate setup during BLUETOOTH connection, the connection is cut.
- If sound is interrupted during reception in AAC codec format, set to "OFF" in step 4 to cancel the settings. In this case, the system receives SBC codec.

Additional information

Setting the Automatic Standby function

The system enters Standby mode automatically in about 15 minutes when there is no operation or audio signal output (**Automatic Standby function**). By default, the Automatic Standby function is turned on.

- Press MENU ⏏.
- Press ⏏/⏏ ⏏ to select "STBY:MODE," then press ⏏ ⏏.
- Press ⏏/⏏ ⏏ to select "AUTO:STBY," then press ⏏ ⏏.
- Press ⏏/⏏ ⏏ to select "ON" or "OFF," then press ⏏ ⏏.

Tip

- 2 minutes before entering standby mode, "AUTO:STBY" displays in the display window ⏏.

Note

- The Automatic Standby function is invalid for the tuner function (FM/DAB*), even when you have enabled it.
- The system may not enter Standby mode automatically in the following cases:
 - while using the FM or DAB* function
 - while an audio signal is being detected
 - during playback of audio tracks or files
 - while the Play Timer or Sleep Timer is being used
- The system counts down the time (about 15 minutes) again until it enters Standby mode, even when Automatic Standby function is enabled in the following cases:
 - when a USB device is connected while "USB" function
 - when a button on the remote or unit is pressed

* DAB is for CMT-XSCDB only.

Setting the BLUETOOTH Standby mode

When BLUETOOTH Standby mode is enabled, the system enters Wait mode for BLUETOOTH connection even when the system is turned off. This mode is disabled by default.

- Press MENU ⏏.
- Press ⏏/⏏ ⏏ to select "STBY:MODE," then press ⏏ ⏏.
- Press ⏏/⏏ ⏏ to select "BT STBY," then press ⏏ ⏏.
- Press ⏏/⏏ ⏏ to select "ON" or "OFF," then press ⏏ ⏏.
- Press I/⏏ ⏏ to turn off the system.

Tip

- When this system is set to "ON," the system turns on automatically and you can listen to music by activating BLUETOOTH on the connected component.

Setting the wireless BLUETOOTH signal ON/OFF

When the unit is turned on, you can control a BLUETOOTH signal. The default setting is ON.

- Turn on the unit.
- Press and hold ⏏ ⏏ ⏏ and I/⏏ ⏏ of the unit.
- After "RF OFF" (wireless BLUETOOTH signal is off) or "RF ON" (wireless BLUETOOTH signal is on) appears, release the button.

Tip

- When this setting is set to OFF, the BLUETOOTH function is not available.
- When this setting is off, the unit is turned on by the smartphone/tablet by one-touch action (NFC) on the unit.
- When this setting is off, the BLUETOOTH Standby mode cannot be set.
- When the BLUETOOTH Standby mode is on and the unit is turned off, the BLUETOOTH Standby mode turns off.
- When this setting is off, the unit and BLUETOOTH device cannot be paired.
- Even when this setting is off, a wired connection can still be used.

Adjusting the sound

You can set the bass and treble or adjust the tone to your preferences.

- Press SOUND ⏏.
- Press ⏏/⏏ ⏏ to select "CA+," "P-EQ" (sound effect), or "WIDE ST" (stereo effect), then press ⏏ ⏏.

CA+: Set to the recommended sound quality of Sony.
P-EQ (EQUALIZER): Select the desired sound from the following styles: "R AND B/HIP HOP," "ROCK," "POPS," "CLASSIC," "JAZZ," "FLAT," "CUSTOM"
WIDE ST (WIDE STEREO): Select "HIGH" or "NORMAL," then press ⏏ ⏏. If you want to adjust to a more natural stereo sound, select "NORMAL."

Using the timers

The system offers Sleep Timer and Play Timer.

Note

- The Sleep Timer has priority over the Play Timer.

Setting the Sleep Timer

At the specified time, the system is turned off automatically.

- Press MENU ⏏.
- Press ⏏/⏏ ⏏ to select "SLEEP," then press ⏏ ⏏.
- Press ⏏/⏏ ⏏ to select the specified time, then press ⏏ ⏏.

You can select from "10MIN" (10 minutes) to "90MIN" (90 minutes) in 10 minute increments.

Tip

- To check the remaining time of Sleep Timer, perform steps 1 and 2 above.
- The Sleep Timer works even if the clock is not set.

To cancel the Sleep Timer

Select "OFF" in step 3 above.

Setting the Play Timer

- Note**
 - Make sure you have set the clock before setting the timer.
 - See "Setting the clock."

Play timer

You can listen to a CD or MP3 disc, USB device or radio every day at a preset time. The Play Timer setting remains as long as the setting is not canceled.

- Prepare the sound source.
- Press TIMER ⏏.
- Press ⏏/⏏ ⏏ to select "PLAY SET," then press ⏏ ⏏.

The start time flashes in the display window ⏏.
- Press ⏏/⏏ ⏏ to select time, then press ⏏ ⏏.

Follow the same procedure to set "MINUTE" of the time to start operation, then "HOUR" and "MINUTE" of the time to stop the operation.
- Press ⏏/⏏ ⏏ to select the desired sound source, then press ⏏ ⏏.

The confirmation display for the Play Timer appears.
- Press I/⏏ ⏏ to turn off the system.

Tip

- Before the preset time, the system automatically turns on.
 - for FM or DAB*: about 15 seconds before the preset time
 - for a CD or USB device: about 90 seconds before the preset time
- When the sound source is a CD, you can preprogram the Play Timer. See "Creating your own program (Program Play)".
- When the sound source is radio, make sure to tune-in the radio station in advance.
- To change the timer setting, perform the procedures from the beginning again.

* DAB is for CMT-XSCDB only.

Note

- The Play Timer does not work if the system is already on at the preset time. Be careful not to operate the system until it is turned on and starts play with the timer.
- When the sound source for a Play Timer is set to a radio station that you set using Automatic Scanning (AUTO) or Manual Tuning (MANUAL), and you change the radio frequency or band after setting the timer, the radio station setting for the timer will also be changed.
- When the sound source for a Play Timer is set to a radio station tuned from a preset radio station, and you change the frequency of the radio station or band after setting the timer, the radio station setting for the timer will not change. The radio station tuning for the timer is fixed at the frequency you set.

To check the setting

- Press TIMER ⏏.
- Press ⏏/⏏ ⏏ to select "SELECT," then press ⏏ ⏏.
- Press ⏏/⏏ ⏏ to select "TIMER SEL," and then press ⏏ ⏏.
- Press ⏏/⏏ ⏏ to select "PLAY SEL," and then press ⏏ ⏏.

The timer setting appears in the display window ⏏.

To cancel the timer

After step 3 on "To check the setting," select "OFF," then press ⏏ ⏏.

Changing the battery

The working distance of the remote shortens as the battery becomes exhausted. When the remote no longer operates the unit, replace the battery with a new CR2025 lithium battery (not supplied).

- Push and hold ⏏ at the rear of the remote, then pull out the battery holder in the direction of the arrow.

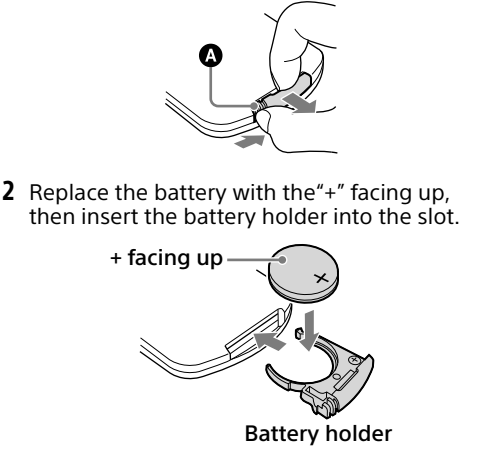

Note

- Wipe the battery with a dry cloth to assure a good contact.
- Do not hold the battery with metallic tweezers, otherwise a short-circuit may occur.
- Use of batteries other than the CR2025 may cause a fire or explosion.

About "SongPal"

A dedicated App for this model is available on both Google Play™ and the App Store.

Sound settings

You can easily customize your sound, or use Sony's recommended settings "CA+."

Controlling a device connected via USB

You can play music in a device connected to the USB connector.

What you can control with "SongPal" varies depending on the connected device.

The specification and design of the app may change without notice.

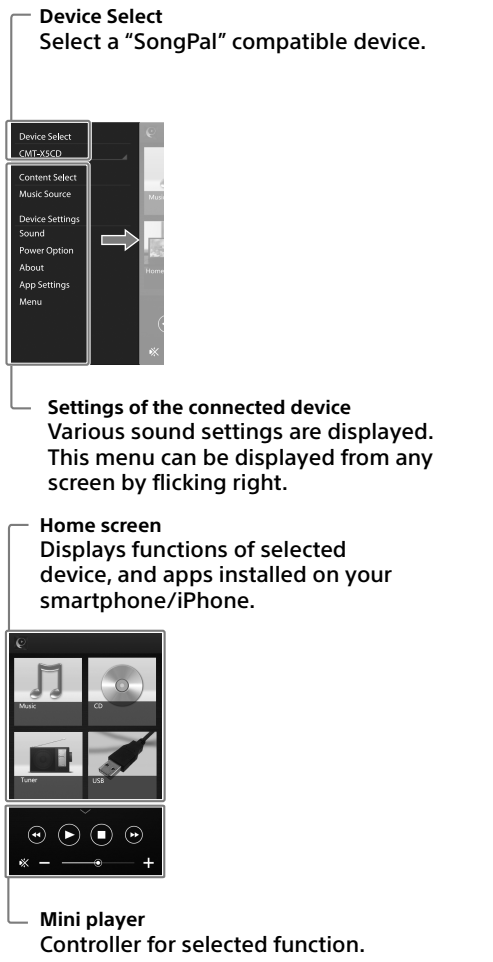

Troubleshooting

Troubleshooting

- Make sure the power cord is firmly connected.
- Find your problem in the checklist below, and take the indicated corrective action.

If the issue persists, contact your nearest Sony dealer.

If the standby indicator ⏏ flashes

Immediately unplug the power cord, and make sure the power cord is not connected to a wall outlet other than AC 220 V.

- After the standby indicator ⏏ stops flashing, plug the power cord again, and turn on the system. If the issue persists, contact your nearest Sony dealer.

General

The system does not turn on.

- Make sure you have connected the power cord to a wall outlet correctly.

The system has entered Standby mode unexpectedly.

- This is not a malfunction. The system enters Standby mode automatically in about 15 minutes when there is no operation or audio signal output. See "Setting the Automatic Standby function."

The clock setting or the Play Timer operation has been canceled unexpectedly.

- If about a minute elapses with no operation, the clock setting or Play Timer setting is canceled automatically. Perform the operation again from the beginning.

There is no sound.

- Turn up the volume on the unit.
- Make sure an external component is connected correctly to the AUDIO IN jack ⏏ and set the function to AUDIO IN.
- The specified station may have temporarily stopped broadcast.

Severe hum or noise occurs.

- Move the system away from sources of noise.
- Connect the system to a different wall outlet.
- Use of an AC power tap with a noise filter (not supplied) is recommended.

The remote does not function.

- Remove any obstacles between the remote and the remote sensor ⏏ on the unit, and position the unit away from fluorescent lights.
- Point the remote at the remote sensor ⏏ on the unit.
- Move the remote closer to the system.
- Replace the batteries.

CD-DA/MP3 disc

"**LOCKED**" appears in the display window ⏏ and the disc cannot be removed from the disc slot ⏏.

- Consult your nearest Sony dealer or local authorized Sony service facility.

The disc or file will not play.

- The disc that has not been finalized (a CD-R or CD-RW disc to which data can be added).

The sound skips, or the disc will not play.

- The disc may be dirty or scratched. When the disc is dirty, wipe it clean.
- Move the system to a location away from vibration (for example, on top of a stable stand).

Play does not start from the first track or file.

- Make sure the current play mode is correct. If the play mode is "SHUFFLE" or "PROGRAM," change the setting.

Starting playback takes more time than usual.

- The following discs can increase the time it takes to start playback:
 - a disc recorded with a complicated tree structure.
 - a disc recorded in multi-session format.
 - a disc that has many folders.

USB device

For details on compatible USB devices, see "Compatible devices and versions."

An unsupported USB device is connected.

- The following problems may occur.
 - The USB device is not recognized.
 - File or folder names are not displayed on this system.
 - Playback is not possible.
 - The sound skips.
 - There is noise.
 - A distorted sound is output.

There is no sound.

- The USB device is not connected correctly. Turn off the system, and then reconnect the USB device.

There is noise, skipping, or distorted sound.

- An unsupported USB device is connected. Connect a supported USB device.
- Turn off the system, then reconnect the USB device and turn on the system.

- The music data itself contains noise, or the sound is distorted. Noise may have been entered when creating music data due to the conditions of the computer. In this case, delete the file and send the music data again.
- The bit rate used when encoding the files was low. Send files encoded with higher bit rates to the USB device.

"READING" is displayed for an extended time, or it takes a long time before playback starts.

- The reading process may take a long time in the following cases.
 - There are many folders or files on the USB device.
 - The file structure is extremely complex.

- Not enough space in the memory.
- The internal memory is fragmented.

The file or folder name (album name) is not displayed correctly.

- Send the music data to the USB device again, as the data stored in the USB device may have been corrupted.
- The character code that can be displayed by this system are as follows:
 - Upper cases (A to Z).
 - Numbers (0 to 9).
 - Symbols (< > * +, [] @ _ \).
 - Other characters appear as "_."

The USB device is not recognized.

- Turn off the system and reconnect the USB device, then turn on the system.
- An incompatible USB device may be connected.
- The USB device does not work properly. Refer to the operating manual supplied with the USB device for how to deal with this problem.

Play does not start.

- Turn off the system and reconnect the USB device, then turn on the system.
- An incompatible USB device may be connected.

Play does not start from the first track.

- Set the play mode to "NORMAL" play mode.

The USB device cannot be charged.

- Make sure the USB device is connected securely to the ⏏ (USB) port ⏏.
- The USB device may not be supported by this system.
- Disconnect the USB device and then reconnect it. For details on the charging status of the USB device, see the operating manual of the USB device.

Tuner

Severe hum or noise occurs ("STEREO" flashes in the display window ⏏), or broadcasts cannot be received.

- Connect the antenna properly.
- Find a location and an orientation that provide good reception, and then set up the antenna again.
- Keep the antennas away from the unit, speaker cord or other AV components to avoid picking up noise.
- Turn off nearby electrical equipment.

Several radio stations can be heard at the same time.

- Find a location and an orientation that provide good reception, and then set up the antenna again.
- Bundle the antenna cables using commercially available cord clips and adjust the cable lengths.

DAB/DAB+ radio station is not received properly.

- Check all antenna connections, then perform the DAB Automatic Scan procedure. See "Running the DAB Automatic Scan manually (CMT-XSCDB only)."
- The current DAB/DAB+ service may not be available. Press TUNING +/- ⏏ to select a different service.
- If you have moved to another area, some services/frequencies may have changed and you may not be able to tune into your usual broadcast. Perform the DAB Automatic Scan procedure to re-register the contents of broadcasts. (Performing this procedure clears all previously stored presets.)

The DAB/DAB+ broadcast has been interrupted.

- Check the location of the system or adjust the orientation of the antenna to increase the indicated value of the signal quality.

- If you have moved to another area, some services/frequencies may have changed and you may not be able to tune into your usual broadcast. Perform the DAB Automatic Scan procedure to re-register the contents of broadcasts. (Performing this procedure clears all previously stored presets.)

To reset the system to factory settings

If the system still does not operate properly, reset the system to factory settings.

Use buttons on the unit to reset the system to its factory default settings.

- Disconnect the power cord and confirm that the standby indicator ⏏ is not lit. Then reconnect the power cord and turn on the system.

- Press and hold FUNCTION ⏏ and I/⏏ ⏏ on the unit until "RESET" appears in the display. All user-configured settings, such as preset radio stations, timer, and the clock, are deleted.

If the problem persists after doing all of the above, consult your nearest Sony dealer.

Note

- If you dispose of the unit or give it to another person, reset the unit for security.

Messages

The following messages may appear or flash during operation.

CAN'T PLAY: You have set a disc that cannot be played back on this system, such as CD-ROM and DVD disc.

COMPLETE: The station preset operation ended normally.

DATA ERROR:

You tried to play an unplayable file.

ERROR: You operated the system during initialization. Wait for a while until the initialization is completed.

FULL: You tried to program more than 25 tracks or files.

LOCKED: The disc slot ⏏ is locked and you cannot remove the disc. Contact your nearest Sony dealer.

NO DEVICE: No USB device is connected or the connected USB device has been removed.

NO DISC: There is no disc in the player, or you have loaded a disc that cannot be played.

NO MEMORY: The memory media is not inserted in the USB device, or the system does not identify the memory media.

NO STEP: All of the programmed tracks have been erased.

NO SUPPORT: The system does not support the connected USB device.

NO TRACK: There are not playable files on the USB device or disc.

NOT IN USE: You pressed an unplayable button.

OVER CURRENT: Remove the USB device from the port and turn off the system then turn on the system.

PUSH STOP: You attempted to change the play mode during playback in the CD or USB function.

READING: The system is reading the information on the CD or USB device. Some buttons do not work during reading.

TIME NG: The Play Timer start and end times are set to the same time.

Precautions/Specifications

Precautions

Discs that this system CAN play

- Audio CD-DA discs
- CD-R/CD-RW (audio data of CD-DA tracks and MP3 files)

Do not use a CD-R/CD-RW disc with no data stored. Doing so may damage the disc.

Discs that this system CANNOT play

- CD-ROM
- CD-R/CD-RW other than those recorded in music CD format or MP3 format conforming to ISO9660 Level 1/Level 2, Joliet
- CD-R/CD-RW recorded in multi-session format and not closed the session
- CD-R/CD-RW of poor recording quality, CD-R/CD-RW that have scratches or are dirty, or CD-R/CD-RW recorded with an incompatible recording device
- CD-R/CD-RW which is finalized incorrectly
- CD-R/CD-RW containing files other than MPEG 1 Audio Layer-3 (MP3) files
- 8 cm disc
- Discs of non-standard shape (for example, heart, square, star)
- Discs that have adhesive tape, paper, or sticker attached to them
- Rental or used discs with attached seals where the glue extends beyond the seal
- Discs that have labels printed using ink that feels tacky when touched

Notes on CD-DA discs

- Before playing, wipe the disc with a cleaning cloth from the center out to the edge.
- Do not clean discs with solvents, such as benzine, thinner, or commercially available cleaners or anti-static spray intended for vinyl LPs.
- Do not expose discs to direct sunlight or heat sources such as hot air ducts, nor leave it in a car parked in direct sunlight.

On safety

- Completely disconnect the power cord (mains lead) from the wall outlet (mains) if it is not going to be used for an extended period of time. When unplugging the system, always grip the plug. Never pull the cord itself.
- Should any solid object or liquid get into the system, unplug the system, and have it checked by qualified personnel before operating it again.
- The AC power cord can be changed only by a qualified service facility.

On placement

- Do not place the system in an inclined position or in locations that are extremely hot, cold, dusty, dirty, or humid or lacking adequate ventilation, or subject to vibration, direct sunlight or a bright light.
- Be careful when placing the system on surfaces that have been specially treated (for example, with wax, oil, polish) as staining or discoloration of the surface may result.

If the system is brought directly from a cold to a warm location or is placed in a very damp room, moisture may condense on the lens inside the CD player, and cause the system to malfunction. In this situation, remove the disc, and leave the system turned on for about an hour until the moisture evaporates. If the system still does not operate, even after an extended period, consult your nearest Sony dealer.

On heat build-up

- Heat build-up on the unit during charging or operation over a long period of time is normal and not cause for alarm.
- Do not touch the cabinet if it has been used continuously at a high volume because the cabinet may have become hot.
- Do not obstruct the ventilation holes.

Cleaning the cabinet

Clean this system with a soft cloth slightly moistened with a mild detergent solution. Do not use any type of abrasive pads, scouring powder, or solvents, such as thinner, benzine, or alcohol.

Compatible devices and versions

iPhone/iPad/iPod touch

Check the websites below for details on the latest supported versions of the compatible devices: