

SEC. WORK	가	나	다	PRINTING DEGREE	MATERIAL AND PRINTING DESCRIPTION	LG MODEL 명	SUFFIX	LANGUAGE	PAGE	REMARK
	BRAND	MODEL	P/NO.							
62	LG	WDC1215HSVE	MFL69306262	1	SNOW WHITE 80g OFFSET 인쇄	F2K2CHK2T	ASSREAP	ENGLISH	48	VICTOR,WD 양산 업체 : 국제인쇄 수정 업체 : 인쇄물 개발파트

<< 주기 >>

1. 재질, 인쇄방법, 인쇄도수, 외곽치수등은 작업표에 준한다.
2. 인쇄내용, 문자크기 및 형상, 선의 굵기 등은 설계에서 제시된 FILM에 준함.
3. 외곽치수는 절단후 치수임.
4. 양산전에 설계 한도를 득할 것.
5. 본 부품에 금지물질이 포함되지 않도록 하고, 상세내용은 LG(63)-A-5501-34를 만족할 것

<< NOTES >>

1. Material, printing and exterior size are refer to work tables.
2. Printing, text size and line are based on LG design film.
3. Exterior size on the drawing is cutting line.
4. Before product controlled by criteria sample.
5. The part should not contain prohibited substances(Pb,Cd,Hg,Cr+6,PBB,PBDE)and details should comply with LG standard of LG(63)-A-5501-34

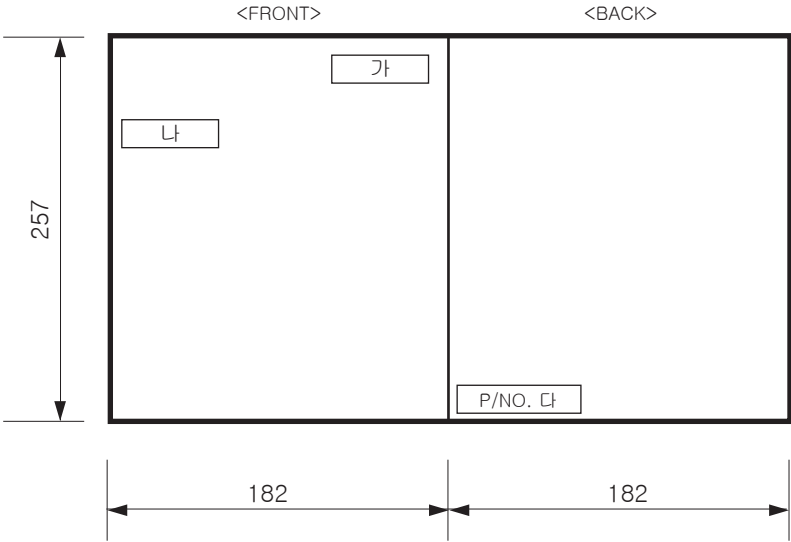

△					
△					
△					
△					
△					
△					
REV. NO. 기호	REVISION DESCRIPTION 변경 사항	REF. NO. 사양 번호	DATE 년/월/일	PREPARED 시행자	APPROVED 승인자

PDF
ILLUSTRATOR

DR COMPLETED
도면 DR 완료
완료일 : 14.11.03

TRIG.		UNIT	mm	SCALE	N	S	T I T L E	MANUAL, OWNER'S	
MODELING	DESIGNED	REVIEWED	CHECKED	APPROVED				VICTOR_HYBRID	1/1
	이 다 정 17.06.08	강 석 경 17.06.08	이 갑 선 17.06.08	김 현 석 17.06.09					
LG 전자 (주) LG Electronics Inc.			RELATED DWG.				DWG. No.	MFL69306262	

OWNER'S MANUAL

WASHING MACHINE



Before beginning installation, read these instructions carefully. This will simplify installation and ensure that the product is installed correctly and safely. Leave these instructions near the product after installation for future reference.

WDC1215HSVE



MFL69306262

www.lg.com

Copyright © 2017 LG Electronics Inc. All rights reserved

TABLE OF CONTENTS

This manual is produced for a group of products and may contain images or content different from the model you purchased.

This manual is subject to revision by the manufacturer.

SAFETY INSTRUCTIONS03

Important Safety Instructions.....04

INSTALLATION.....08

Parts08

Accessories08

Specifications09

Installation Place Requirements10

Unpacking and Removing Transit Bolts.....11

Using Anti-Slip Sheets (Optional)12

Wooden Floors (Suspended Floors).....12

Leveling the Appliance.....13

Connecting Supply Hose13

Installing the Drain Hose16

OPERATION17

Using the Washing Machine17

Sorting Laundry18

Adding Cleaning Products19

Control Panel.....21

Programme Table22

Option Programme26

Dry30

SMART FUNCTIONS.....31

Using SmartThinQ Application.....31

Using Smart Diagnosis™33

MAINTENANCE34

Cleaning Your Washing Machine.....34

Cleaning the Water Inlet Filter34

Cleaning the Drain Pump Filter35

Cleaning the Dispenser Drawer.....36

Tub Clean36

Caution on Freezing During Winter37

TROUBLESHOOTING39

Diagnosing Problems39

Error Messages42

SAFETY INSTRUCTIONS

The following safety guidelines are intended to prevent unforeseen risks or damage from unsafe or incorrect operation of the product.

The guidelines are separated into 'WARNING' and 'CAUTION' as described below.

 This symbol is displayed to indicate matters and operations that can cause risk. Read the part with this symbol carefully and follow the instructions in order to avoid risk.

 **WARNING** - This indicates that the failure to follow the instructions can cause serious injury or death.

 **CAUTION** - This indicates that the failure to follow the instructions can cause the minor injury or damage the product.

WARNING

To reduce the risk of fire, electric shock, or injury to persons when using your product, basic safety precautions should be followed, including the following:

Children in the Household

This appliance is not intended for use by persons (including children) with reduced physical, sensory or mental capabilities, or lack of experience and knowledge, unless they have been given supervision or instruction concerning use of the appliance by a person responsible for their safety. Children should be supervised to ensure that they do not play with the appliance.



WARNING - To avoid a fire

Do not wash clothes or items that have any contaminants of flammable solvents or substances. Do not clean the product or expose it to flammable substances.

Important Safety Instructions

WARNING

To reduce the risk of fire, electric shock, or injury to persons when using your product, basic safety precautions should be followed, including the following:

Installation

- Never attempt to operate this appliance if it is damaged, malfunctioning, partially disassembled, or has missing or broken parts, including a damaged cord or plug.
- This appliance should only be transported by two or more people holding the appliance securely.
- Do not install the appliance in a damp and dusty place. Do not install or store the appliance in any outdoor area, or any area that is subject to weathering conditions such as direct sunlight, wind, rain, or temperatures below freezing.
- Tighten the drain hose to avoid separation.
- If the power cord is damaged or the hole of the outlet socket is loose, do not use the power cord and contact an authorized service centre.
- This appliance must not be installed behind a lockable door, a sliding door or a door with a hinge on the opposite side to that of the appliance, in such a way that a full opening of the appliance door is restricted.
- Do not plug multiple outlets socket, an extension power cable or adapter with this appliance.
- This appliance must be grounded. In the event of malfunction or breakdown, grounding will reduce the risk of electric shock by providing a path of least resistance for electric current.
- This appliance is equipped with a power cord having an equipment-grounding conductor and a grounding power plug. The power plug must be plugged into an appropriate socket outlet that is installed and grounded in accordance with all local codes and ordinances.
- Improper connection of the equipment-grounding conductor can result in risk of electric shock. Check with a qualified electrician or service personnel if you are in doubt as to whether the appliance is properly grounded.
- Do not modify the power cord provided with the appliance. If it does not fit the outlet, have a proper outlet installed by a qualified electrician.

Operation

- Do not attempt to separate any panels or disassemble the appliance. Do not apply any sharp objects to the control panel in order to operate the appliance.
- Do not repair or replace any part of the appliance. All repairs and servicing must be performed by qualified service personnel unless specifically recommended in this Owner's Manual. Use only authorized factory parts.
- Keep the area underneath and around your appliances free of combustible materials such as lint, paper, rags, chemicals, etc.
- Do not put animals, such as pets into the appliance or allow children to play with the appliance.
- Do not leave this appliance door open. Children may hang on the door or crawl inside the appliance, causing damage or injury.
- Use new hoses or hose-set supplied with the appliance. Reusing old hoses can cause a water leak and subsequent property damage.
- Never reach into this appliance while it is operating. Wait until the drum has completely stopped.
- Do not put in, wash or dry clothing articles that have been cleaned in, washed in, soaked in, or spotted with combustible or explosive substances (such as wax, oil, paint, gasoline, degreasers, drycleaning solvents, kerosene, vegetable oil, cooking oil, etc.). Improper use can cause fire or an explosion.
- In case of flood, disconnect the power plug and contact the LG Electronics customer information centre.
- Do not lean or push down on the door excessively, when the appliance door is open.
- Do not touch the door during steam or drying programmes.
- Do not use flammable gas and combustible substances (benzene, gasoline, thinner, petroleum, alcohol, etc.) near the appliance.
- If the drain hose or supply hose is frozen during winter, use it only after thawing.
- Keep all washing detergents, softener and bleach away from children.
- Do not touch the power plug or the appliance controls with wet hands.
- When pulling out the power plug from an outlet, hold the power plug, not the cable.
- Do not bend the power cable excessively or place a heavy object on it.
- Do not wash rugs, mats, shoes or pet blankets, or any other items other than clothes or sheets, in this machine.
- This appliance must only be used for domestic household purposes and should not be used in mobile applications.
- If there is a gas leakage (isobutane, propane, natural gas, etc.), do not touch the appliance or power plug and ventilate the area immediately.

Maintenance

- Securely plug the power plug in the socket outlet after completely removing any moisture and dust.
- Disconnect the power cord before cleaning the appliance. Turning the unit off into stand by mode from the front panel will not isolate the mains supply from the appliance.
- Never unplug the appliance by pulling on the power cable. Always grip the power plug firmly and pull straight out from the socket outlet.
- Do not spray the water inside or outside the appliance to clean it.

Technical Safety for Using the Dryer

- Do not dry unwashed items in the appliance.
- Items that have been soiled with substances such as cooking oil, vegetable oil, acetone, alcohol, petroleum, kerosene, spot removers, turpentine, waxes and wax removers should be washed in hot water with an extra amount of detergent before being dried in the appliance.
- Fabric softeners, or similar products, should be used as specified by the fabric softener instructions.
- Remove all objects from pockets such as lighters and matches.
- Never stop this appliance before the end of the drying cycle unless all items are quickly removed and spread out so that the heat is dissipated.
- This appliance is not to be used if industrial chemicals have been used for cleaning.
- Items such as foam rubber (latex foam), shower caps, waterproof textiles, rubber backed articles and clothes or pillows fitted with foam rubber pads should not be dried in this appliance.
- Oil-affected items can ignite spontaneously, especially when exposed to heat sources such as in a tumble dryer. The items become warm, causing an oxidation reaction in the oil. Oxidation creates heat. If the heat cannot escape, the items can become hot enough to catch fire. Piling, stacking or storing oil-affected items can prevent heat from escaping and so create a fire hazard.
- If it is unavoidable that fabrics that contain vegetable or cooking oil or have been contaminated by hair care products be placed in a tumble dryer they should first be washed in hot water with extra detergent – this will reduce, but not eliminate, the hazard.

Disposal

- Before discarding an old appliance, unplug it. Cut off the cable directly behind the appliance to prevent misuse.
- Dispose of all packaging materials (such as plastic bags and styrofoam) away from children. The packaging material can cause suffocation.
- Remove the door before disposing of or discarding this appliance to avoid the danger of children or small animals getting trapped inside.
- Before the washing machine is removed from service or discarded, remove the lid to prevent children from climbing inside.

INSTALLATION

Parts

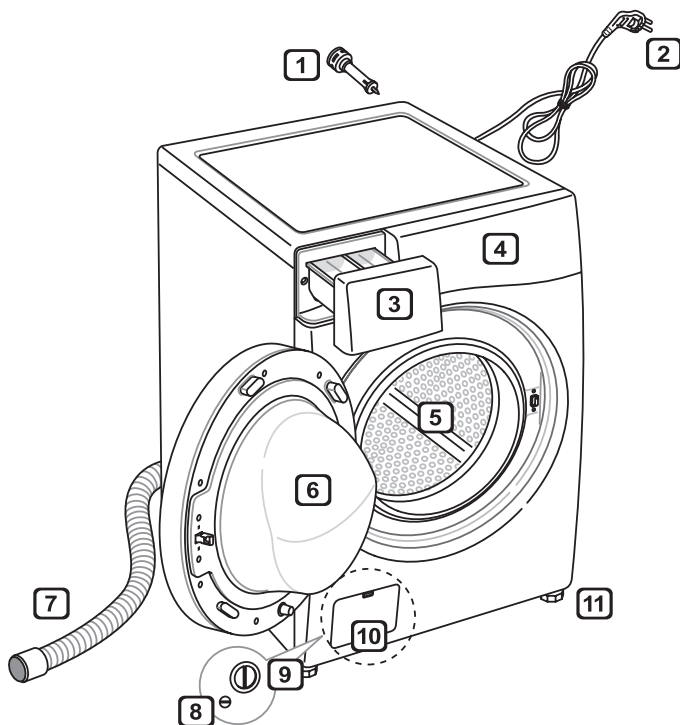

- 1 Transit bolts
- 2 Power plug
- 3 Drawer
- 4 Control panel
- 5 Drum
- 6 Door
- 7 Drain hose
- 8 Drain plug
- 9 Drain pump filter
- 10 Cover cap
(Location may vary depending on products)
- 11 Adjustable feet

Accessories

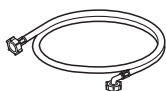

Cold supply hose (1EA)
(Option: Hot (1EA))



Spanner

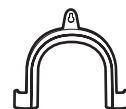

Elbow bracket
(for securing drain hose)



Anti-slip sheets (2EA)
(Optional)



Caps for covering transit bolt holes



Tie strap
(Optional)

Specifications

Model	WDC1215HSVE
Wash Capacity	15 kg (Wash) / 8 kg (Dry)
Power Supply	220 - 240 V~, 50 Hz
Size	700 mm (W) x 770 mm (D) x 990 mm (H)
Product Weight	100 kg
Permissible Water pressure	0.1 - 0.8 MPa (1.0 - 8.0 kgf / cm ²)

- Appearance and specifications may change without notice to improve the quality of the product.
- The external hot water supply MUST NOT exceed 65°C.
- No further backflow protection required for connection to the water supply.
- Permissible cold water temperature : 4 - 25°C

Installation Place Requirements

Location

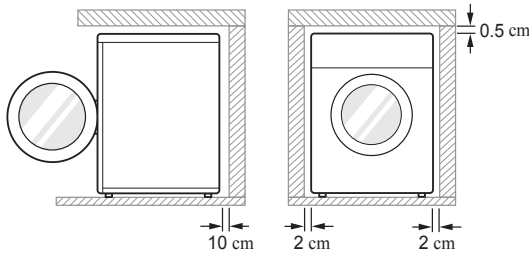

Level Floor : Allowable slope under the entire appliance is 1°.

Power Outlet : Must be within 1.5 meters of either side of the location of the appliance.

- Do not overload the outlet with more than one appliance.

Additional Clearance : For the wall, 10 cm: rear
/2.5 cm: right & left side

- Do not place or store laundry products on top of the appliance at any time.
- These products may damage the finish or controls.

WARNING

- The plug must be plugged into an appropriate outlet that is properly installed and grounded in accordance with all local codes and ordinances.

Positioning

- Install the appliance on a flat hard floor. Do not install the appliance on an elevated surface or stand unless it is supplied by LG electronics for this model.
- Make sure that air circulation around the appliance is not impeded by carpets, rugs, etc.
- Never try to correct any unevenness in the floor with pieces of wood, cardboard or similar materials under the appliance.
- If it is impossible to avoid positioning the appliance next to a gas cooker or coal burning stove, an insulation (85x60 cm) covered with aluminum foil on the side facing the cooker or stove must be inserted between the two appliances.

- Do not install your appliance in rooms where freezing temperatures may occur. Frozen hoses may burst under pressure. The reliability of the electronic control unit may be impaired at temperatures below freezing point.
- Ensure that when the appliance is installed, it is easily accessible for an engineer in the event of a breakdown.
- With the appliance installed, adjust all four feet using the transit bolt spanner provided to ensure the appliance is stable, and a clearance of approximately 5 mm is left between the top of the appliance and the underside of any work-top.
- If the appliance is delivered in winter and temperatures are below freezing, place the appliance at room temperature for a few hours before putting it into operation.

WARNING

- This equipment is not designed for maritime use or for use in mobile installations such as caravans, aircraft etc.

Electrical Connection

- Do not use an extension cord or double adapter.
- Always unplug the appliance and turn off the water supply after use.
- Connect the appliance to an earthed socket in accordance with the current wiring regulations.
- The appliance must be positioned so that the plug is easily accessible.
- Repairs to the appliance must only be carried out by qualified personnel. Repairs carried out by inexperienced persons may cause injury or serious malfunctioning. Contact your local service centre.

Unpacking and Removing Transit Bolts

1 Lift the appliance off the foam base.

- After removing the carton and shipping material, lift the appliance off the foam base. Make sure the tub support comes off with the base and is not stuck to the bottom of the appliance.
- If you must lay the appliance down to remove the carton base, always protect the side of the appliance and lay it carefully on its side. Do not lay the appliance on its front or back.

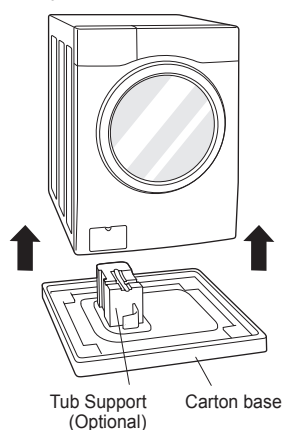

2 Remove the bolt assemblies.

- Starting with the bottom two transit bolts, use the spanner (included) to fully loosen all transit bolts by turning them counterclockwise. Remove the bolt assemblies by wiggling them slightly while pulling them out.

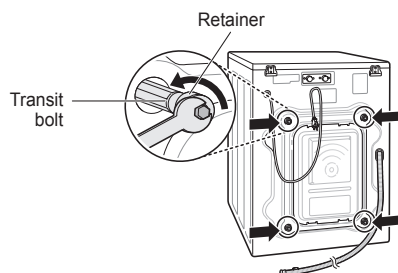

3 Install the hole caps.

- Locate the hole caps included in the accessory pack and install them in the shipping bolt holes.

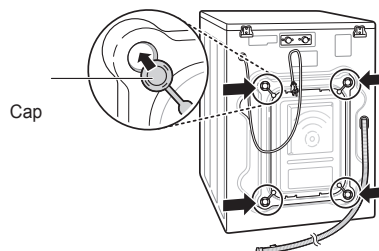

NOTE

- Save the bolt assemblies for future use. To prevent damage to internal components, Do not transport the washing machine without reinstalling the transit bolts.
- Failure to remove transit bolts and retainers may cause severe vibration and noise, which can lead to permanent damage to the washing machine. The cord is secured to the back of the washing machine with a shipping bolt to help prevent operation with transit bolts in place.

Using Anti-Slip Sheets (Optional)

If you install the appliance on a slippery surface, it may move because of excessive vibration. Incorrect leveling may cause malfunction through noise and vibration. If this occurs, install the anti-slip sheets under the leveling feet and adjust the level.

- 1 Clean the floor to attach the anti-slip sheets.
 - Use a dry rag to remove and clean foreign objects and moisture. If moisture remains, the anti-slip sheets may slip.
- 2 Adjust the level after placing the appliance in the installation area.
- 3 Place the adhesive side of the anti-slip sheets on the floor.
 - It is most effective to install the anti-slip sheets under the front legs. If it is difficult to place the pads under the front legs, place them under the back legs.

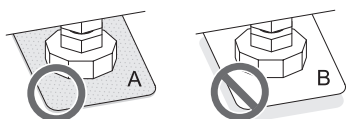
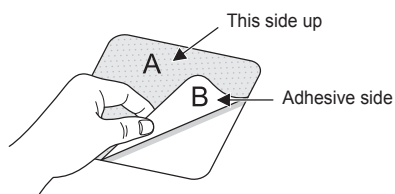

- 4 Ensure the appliance is level.
 - Push or rock the top edges of the appliance gently to make sure that the appliance does not rock. If the appliance rocks, level the appliance again.

NOTE

- You can obtain anti-slip sheets from the LG Service Centre.

Wooden Floors (Suspended Floors)

- Wooden floors are particularly susceptible to vibration.
- To reduce vibration we recommend you place rubber cups at least 15 mm thick under each foot of the appliance, secured to at least two floor beams with screws.

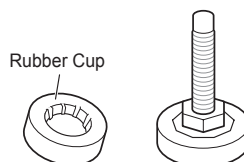

- If possible install the appliance in one of the corners of the room, where the floor is more stable.
- Fit the rubber cups to reduce vibration.

NOTE

- Proper placement and leveling of the washing machine will ensure long, regular, and reliable operation.
- The washing machine must be 100% horizontal and stand firmly in position.
- It must not 'Seesaw' across corners under the load.
- The installation surface must be clean, free from floor wax and other lubricant coatings.
- Do not let the feet of the washing machine get wet. Failure to do so may cause vibration or noise.
- You can obtain rubber cups (p/no.4620ER4002B) from the LG Service Centre.
- Do not place the washer on an elevated surface, plinth or stand, unless the stand is manufactured by LG and is intended for use with this model.

Leveling the Appliance

If the floor is uneven, turn the adjustable feet as required (Do not insert pieces of wood etc. under the feet). Make sure that all four feet are stable and resting on the floor and then check that the appliance is perfectly level (Use a spirit level).

- Once the appliance is level, tighten the lock nuts up towards the base of the appliance. All lock nuts must be tightened.

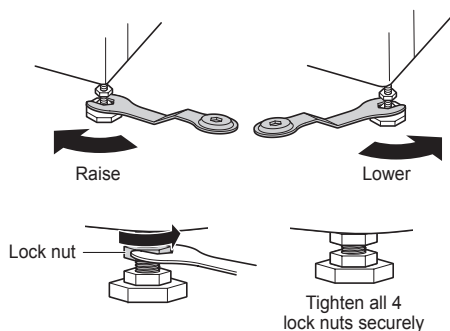

Diagonal Check

- When pushing down the edges of the top plate diagonally, the appliance should not move up and down at all (Check both directions). If the appliance rocks when pushing the machine top plate diagonally, adjust the feet again.

NOTE

- Timber or suspended type flooring may contribute to excessive vibration and unbalance errors and malfunctions.

Connecting Supply Hose

- Water supply pressure must be between 0.1 MPa and 0.8 MPa (1.0–8.0 kgf/cm²).
- Do not strip or crosstread when connecting supply hose to the valve.
- If the water supply pressure is more than 0.8 MPa, a decompression device should be installed.
- Periodically check the condition of the hose and replace the hose if necessary.

Checking the Rubber Seal on the Supply Hose

Two rubber seals are supplied with the water supply hoses.

They are used for preventing water leaks. Make sure the connection to taps is sufficiently tight. Do not over tighten the hoses with any mechanical device.

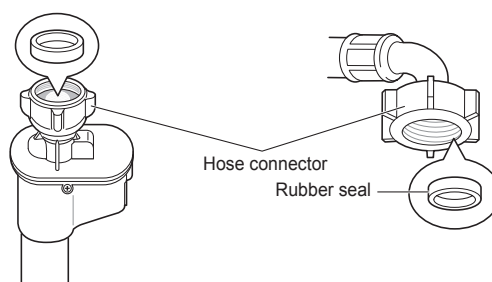
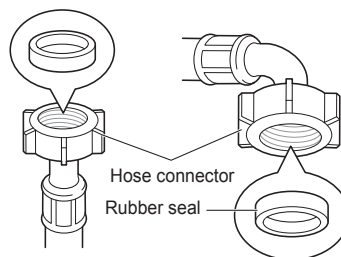

Connecting Hose to Water Tap

Connecting Screw-Type Hose to Tap with Thread

Screw the hose connector onto the water supply tap.

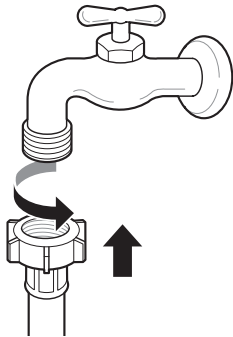

Connecting Screw-Type Hose to Tap Without Thread

- 1 Loosen the four fixing screws.

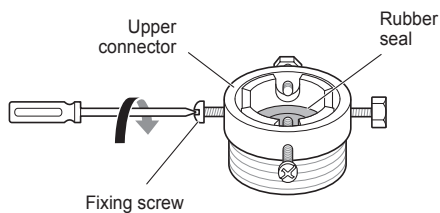

- 2 Remove the guide plate if the tap is too large to fit the adapter.

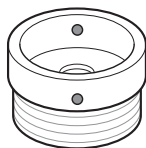
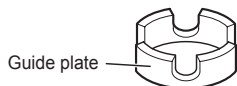

- 3 Push the adapter onto the end of the tap so that the rubber seal forms a watertight connection. Tighten the four fixing screws.

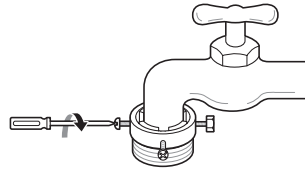

- 4 Push the supply hose vertically upwards so that the rubber seal within the hose can adhere completely to the tap and then tighten it by screwing it to the right.

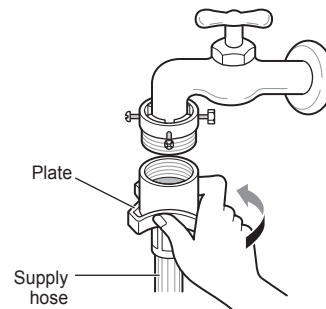

Connecting One Touch Type Hose to Tap Without Thread

- 1 Unscrew the adapter ring plate and loosen the four fixing screws.

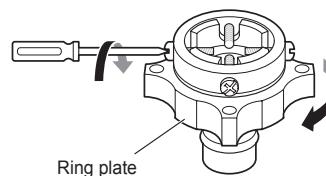

- 2 Remove the guide plate if the tap is too large to fit the adapter.

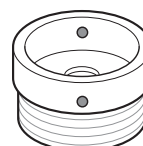
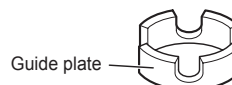

- 3** Push the adapter onto the end of the tap so that the rubber seal forms a watertight connection. Tighten the four fixing screws and the adapter ring plate .

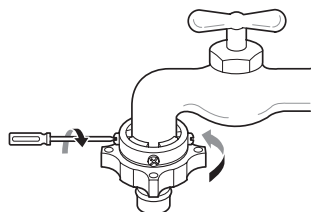

- 4** Pull the connector latch plate down, push the supply hose onto the adapter, and release the connector latch plate. Make sure the adapter locks into place.

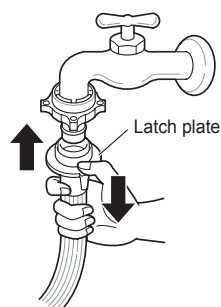

NOTE

- After connecting the supply hose to the water tap, turn on the water tap to flush out foreign substances (dirt, sand, sawdust, and etc.) in the water lines. Let the water drain into a bucket, and check the water temperature.

Connecting Hose to Appliance

Attach the hot water line to the hot water supply on the back of the washer. Attach the cold water line to the cold water supply on the back of the washer.

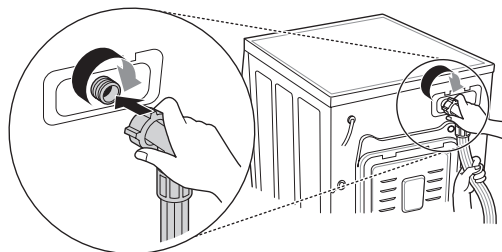

NOTE

- After completing connection, if water leaks from the hose, repeat the same steps. Use the most conventional type of tap for the water supply. In case the tap is square or too big, remove the guide plate before inserting the tap into the adaptor.

Using the Horizontal Tap

Horizontal tap



Extension tap

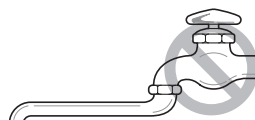

Square tap



Installing the Drain Hose

- The drain hose should not be placed higher than 100 cm above the floor. Water in the appliance may not drain or may drain slowly.
- Securing the drain hose correctly will protect the floor from damage due to water leakage.
- If the drain hose is too long, do not force it back into the appliance. This will cause abnormal noise.

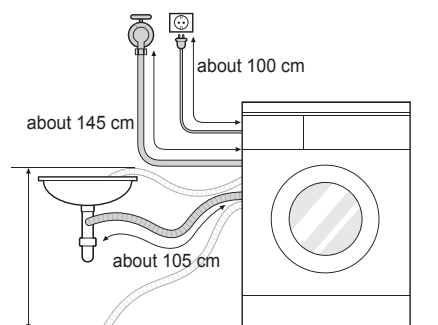

- When installing the drain hose to a sink, secure it tightly with string or chain to prevent the hose from lifting itself off the sink when the water flows from it.
- Securing the drain hose correctly will protect the floor from damage due to water leakage.

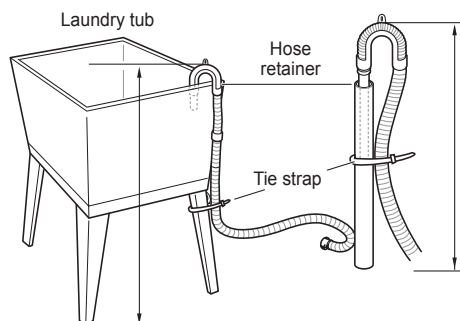
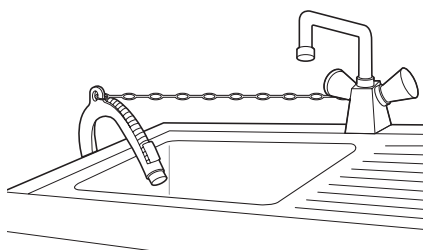

OPERATION

Using the Washing Machine

Before the first wash, select a washing programme, allow the washing machine to wash without clothing. This will remove residue and water from the drum that may have been left during manufacturing.

1 Sort laundry and load items.

- Sort laundry by fabric type, soil level, colour and load size as needed. Open the door and load items into the washing machine.

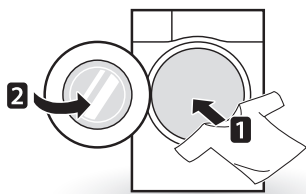

2 Add cleaning products and/or detergent and softener.

- Add the proper amount of detergent to the detergent dispenser drawer. If desired, add bleach or fabric softener to the appropriate areas of the dispenser.

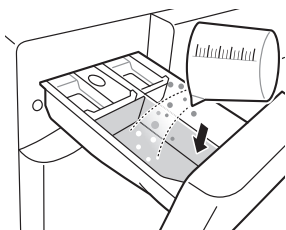

3 Turn on the washing machine.

- Press the **Power** button to turn on the washing machine.

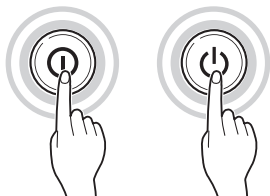

4 Choose the desired washing cycle.

- Press the programme button repeatedly or turn the cycle selector knob until the desired cycle is selected.

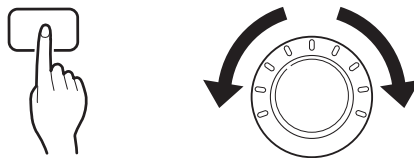

5 Begin cycle.

- Press the **Start/Pause** button to begin the cycle. The washing machine will agitate briefly without water to measure the weight of the load. If the **Start/Pause** button is not pressed within 60 minutes, the washing machine will shut off and all settings will be lost.



6 End of cycle.

- When the cycle is finished, a melody will sound. Immediately remove your clothing from the washing machine to reduce wrinkling. Check around the door seal when removing the load for small items that may be caught in the seal.

Sorting Laundry

1 Look for a care label on your clothes.

- This will tell you about the fabric content of your garment and how it should be washed.
- Symbols on the care labels.

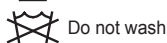
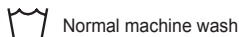

2 Sorting laundry.

- To get the best results, sort clothes into loads that can be washed with the same wash cycle.
- Different fabrics need to be washed at varying temperatures and spin speeds.
- Always sort dark colours from pale colours and whites. Wash separately as dye and lint transfer can occur causing discolouration of white and pale garments. If possible, do not wash heavily soiled items with lightly soiled ones.
 - Soil (Heavy, Normal, Light) :
Separate clothes according to amount of soil.
 - Colour (White, Lights, Darks):
Separate white fabrics from coloured fabrics.
 - Lint (Lint producers, Collectors):
Wash lint producers and lint collectors separately.

3 Caring before loading.

- Combine large and small items in a load. Load large items first.
- Large items should not be more than half the total wash load. Do not wash single items. This may cause an unbalanced load. Add one or two similar items.
- Check all pockets to make sure that they are empty. Items such as nails, hair clips, matches, pens, coins and keys can damage both your washing machine and your clothes.

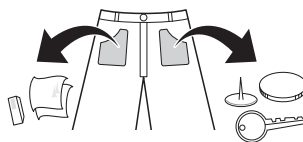

- Close zippers, hooks and strings to make sure that these items don't snag on other clothes.
- Pre-treat dirt and stains by brushing a small amount of detergent dissolved water onto stains to help lift dirt.
- Check the folds of the flexible gasket (gray) and remove any small articles.

⚠ CAUTION

- Check inside the drum and remove any items from a previous wash.

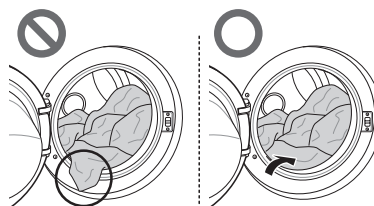

- Remove any clothing or items from the flexible gasket to prevent clothing and gasket damage.

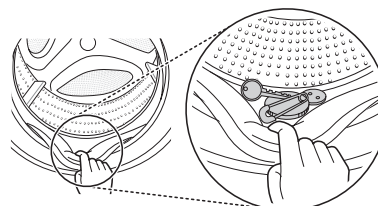

Adding Cleaning Products

Detergent Dosage



- Detergent should be used according to the instruction of the detergent manufacturer and selected according to type, colour, soiling of the fabric and washing temperature.
- If too much detergent is used, too many suds can occur and this will result in poor washing results or cause heavy load to the motor and cause a malfunction.
- If you wish to use liquid detergent, follow the guidelines provided by the detergent manufacturer.
- You can pour liquid detergent directly into the main detergent drawer if you are starting the cycle immediately.
- Do not use liquid detergent if you are using Delay End, or if you have selected Pre Wash, as the liquid may harden.
- If too many suds occur, reduce the detergent amount. Drum type detergent must only be used in Front loaders. excessive suds can be caused by using the wrong type of detergent.
- Detergent usage may need to be adjusted for water temperature, water hardness, size and soil level of the load. For best results, avoid oversudsing.
- Refer to the label of the clothes, before choosing the detergent and water temperature.
- When using the washing machine, use designated detergent for each type of clothing only:
 - General powdered detergents for all types of fabric
 - Powdered detergents for delicate fabric
 - Liquid detergents for all types of fabric or designated detergents only for wool
- For better washing performance and whitening, use detergent with the general powdered bleach.
- Detergent is flushed from the dispenser at the beginning of the cycle.

NOTE

- Do not let the detergent harden. Doing so may lead to blockages, poor rinse performance or bad odours.
- Full load : According to manufacturer's recommendation.
- Part load : 3/4 of the normal amount
- Minimum load : 1/2 of full load

Adding Detergent and Fabric Softener

Adding Detergent

- Main wash only → 
- Pre wash+Main wash → 

NOTE

- Too much detergent, bleach or softener may cause an overflow of that liquid and cause damage or staining to the clothes.
- Be sure to use the appropriate amount of detergent.

Adding Fabric Softener

- Do not exceed the maximum fill line. Overfilling can cause early dispensing of the fabric softener, which may stain clothes. Close the dispenser drawer slowly.

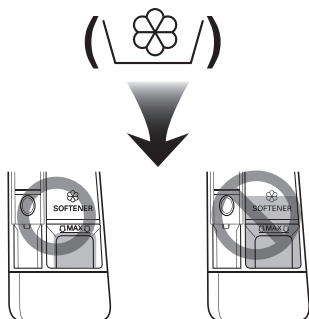

- Do not leave the fabric softener in the detergent drawer for more than 2 days (Fabric softener may harden).
- Softener will automatically be added during the last rinse cycle.
- Do not open the drawer when water is being supplied.
- Solvents (benzene, etc.) must not be used.

NOTE

- Do not pour fabric softener directly on the clothes.

Adding Water Softener

- A water softener, such as anti-limescale (e.g. Calgon) can be used to cut down on the use of detergent in extremely hard water areas. Dispense according to the amount specified on the packaging. First add detergent and then the water softener.
- Use the quantity of detergent required for soft water.

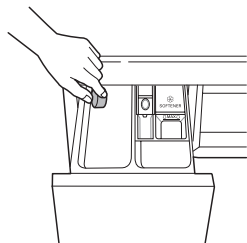

Using tablet

- 1 Open the door and put tablets into the drum.

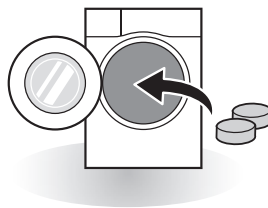

- 2 Load the laundry into the drum and close the door.

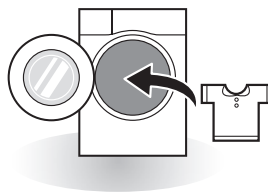

Control Panel

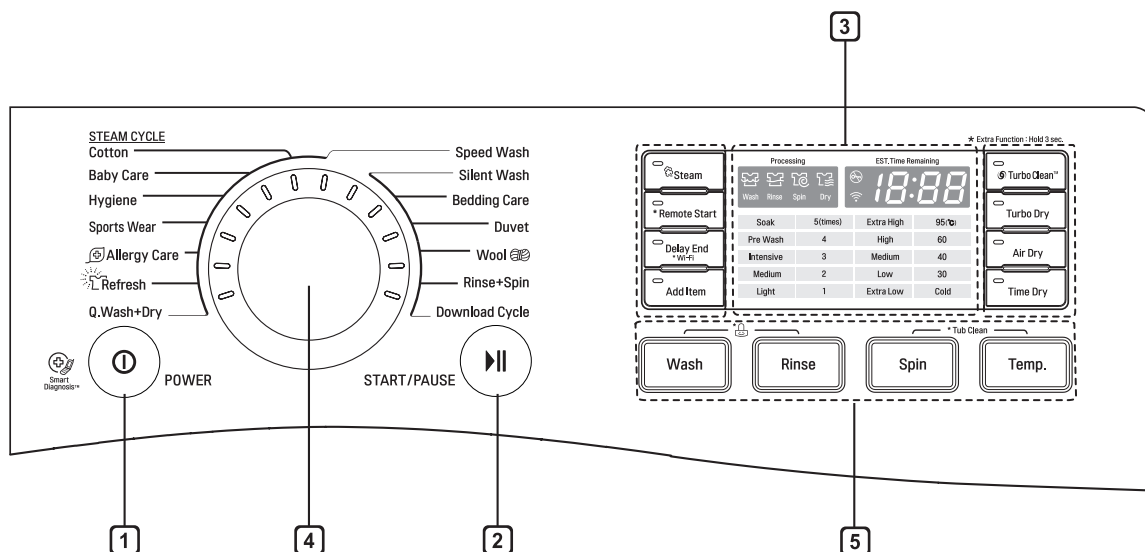

1 Power button

- Press the **Power** button to turn the washing machine on.
- To cancel the **Delay End** function, the **Power** button should be pressed.

2 Start/Pause button

- This **Start/Pause** button is used to start the wash cycle or pause the wash cycle.
- If a temporary stop of the wash cycle is needed, press the **Start/Pause** button.

3 Display

- The display shows the settings, estimated time remaining, options, and status messages. When the product is turned on, the default settings in the display will illuminate.
- The display shows estimate time remaining. While the size of the load is being calculated automatically, blinking '18:88' or 'Detecting' appears.

4 Programme dial

- Programmes are available according to laundry type.
- Lamp will light up to indicate the selected programme.

5 Options

- This allows you to select an additional programme and will light when selected.
- Use these buttons to select the desired programme options for the selected cycle.

Programme Table

Washing Programme

Programme	Description	Fabric Type	Proper Temp.	Maximum Load Weight
Cotton	Provides better performance by combining various drum motions.	Coloured fast garments (shirts, nightdresses, pajamas, etc) and normally soiled cotton load (underwear).	40 °C (Cold to 60 °C)	Rated Capacity
Allergy Care	Removes pet hair and allergens such as house mite and pollen.	Cotton, underwear, pillow covers, bed sheets, baby wear.	No choice	3.0 kg
Hygiene	Washes laundry in a hot cycle	Cotton, underwear, pillow covers, bed sheets, baby wear.	95 °C	3.0 kg
Refresh	Helps to remove wrinkles within 25 mins with steam.	Cotton mixed, Polyester mixed Dress shirts, blouses.	No choice	3 items
Baby Care	Removes solid and protein stains, provides better rinse performance.	Lightly soiled baby wear.	No choice	5.0 kg
Duvet	This cycle is for large items such as bed cover, pillows, sofa covers, etc.	Cotton bedding except special garments (delicates, wool, silk, etc.) with filling: duvets, pillows, blankets, sofa covers with light filling.	Cold (Cold to 40 °C)	1 king size
Sports Wear	This cycle is suitable for sports wear such as jogging clothes and sports wear.	Coolmax, Gore-tex, Fleece and Sympatex.	*30 °C (Cold to 30 °C)	3.0 kg
Wool	Enables to wash wool fabrics. (Please use detergent for machinewashable woolens).	Machine washable woolens with pure wool and new wool only.	40 °C (Cold to 40 °C)	3.0 kg
Silent Wash	Provides less noise and vibration and saves money by using overnight electricity.	Coloured fast garments (shirts, nightdresses, pajamas, etc) and normally soiled cotton load (underwear).	40 °C (Cold to 60°C)	3.0 kg
Speed Wash	This cycle provides a fast washing time for small loads and lightly soiled clothes.	Coloured laundry which is lightly soiled for fast wash. CAUTION : Use less than 20 g of detergent (for 2.0 kg load) otherwise detergent may remain on the clothes.	*40 °C (Cold to 40 °C)	3.0 kg

Programme	Description	Fabric Type	Proper Temp.	Maximum Load Weight
Q.Wash+Dry	Speed Wash and Dry	A small amount of laundry which can be dried in an hour.	40 °C	1.0 kg
Rinse+Spin	Use for laundry that need rinsing only of to add rinse-added fabric softener to laundry	Normal fabrics which can be washable.	No choice	Rating
Bedding Care	Removes damp and odors from bedding without washing.	Duvets, blankets, pillowcases, shams, and other bedding. CAUTION : Check fabric care labels on blankets or duvets before using the Bedding care programme. The heated air of the programme may shrink or damage some items.	No choice	1 item
Download Cycle	For downloadable cycles. If you did not download any cycles, the default is Cold Wash .			

- * : Proper temperature can be selected after deleting the steam option, automatically-included in the cycle.
- Water Temperature: Select the appropriate water temperature for chosen wash programme. Always follow garment manufacturer's care label or instructions when washing.
- If you select the **Hygiene** cycle and change the spin mode to No Spin, the drum may still spin very slowly. This is normal and will not affect performance.
- Set program at "Cotton, Intensive Wash, Rinse 3, Extra High Spin, 40 °C, Turbo Clean" option for a normally soiled cotton load and test in accordance or in conformity with AS/NZS 2040.1.
- Set program at "Air Dry, Extra High Spin" option for test in accordance or in conformity with AS/NZS 2442.1.

NOTE

- Neutral detergent is recommended.

Drying Programme

Programme	Description	Fabric Type
Turbo Dry	Select this cycle to reduce the cycle time during the drying cycle.	Cotton or linen fabrics such as cotton towels, t-shirts, and linen garments.
Air Dry	Select this cycle to reduce water and energy usage during the drying cycle.	
Time 30 min.	You can change the drying time according to the maximum load.	Cotton, towel
Time 60 min.		
Time 90 min.		
Time 120 min.		
Time 150 min.		

NOTE

- Select maximum selectable spin speed of washing programme to improve the drying results.
- Where the amount of laundry to be washed and dried in one programme does not exceed the maximum weight permitted for the drying programme, washing and drying in one continuous sequence is recommended.

Extra Options

Programme	Delay End	Steam	Add Item	Turbo Clean™	Turbo Dry	Air Dry	Time Dry
Cotton	●	●	●	●**	●	●	●
Allergy Care	●	●*	●	●	●	●	●
Hygiene	●	●	●	●	●	●	●
Refresh	●	●*					
Baby Care	●	●*	●	●	●	●	●
Duvet	●		●	●			
Sports Wear	●	●**	●	●			
Wool	●		●				
Silent Wash	●		●		●	●	●
Speed Wash	●	●**	●	●**	●	●	●
Q.Wash+Dry	●	●*	●	●*		●*	
Rinse+Spin	●		●		●	●	●
Bedding Care	●		●				
Download Cycle	●		●	●	●	●	●

* : This option is automatically included in the cycle and can not be deleted.

** : This option is automatically included in the cycle and can be deleted.

Option Programme

Delay End

You can set a time delay so that the washing machine will start automatically and finish after a specified time interval.

- 1 Press the **Power** button.
- 2 Select a washing programme.
- 3 Press the **Delay End** button and set time required.
- 4 Press the **Start/Pause** button.

NOTE

- The delay time is the time to the end of the programme, not the start. The actual running time may vary due to water temperature, wash load and other factors. Do not use Liquid detergent for this operation.

Turbo Clean™

Adding the Turbo Clean™ option reduces cycle time and provides good performance in normal cycle. Using Turbo Clean™ saves time without sacrificing performance.

- 1 Press the **Power** button.
- 2 Select a washing programme.
- 3 Press the **Turbo Clean™** button..
- 4 Press the **Start/Pause** button.

NOTE

- Turbo Clean™ function of Some courses is selected automatically.

Add Item

Use this function to add loads or remove the foreign material.

- 1 Press the **Add Item** button.
 - 2 Close the door after add loads or remove the foreign material (e.g. coin or pin etc.)
 - 3 Press the **Start/Pause** button.
- Results when choosing **Add Item** during cycles.
 - When the tub is spinning : Tub stops and **Door Lock** is off.
 - When water temperature in the tub is higher than 45°C : **Add Item** is not available with short warning sound for safety.
 - When lots of water is in the tub : **Door Lock** is off after draining by safe water level.

NOTE

- Open the door when **Door Lock** is off after checking the safety.
- **Add Item** doesn't work when Tub Cleaning course is in progress for safety.
- Put the laundry into the tub completely. Laundry caught in between door closing part can damage door packing (rubber part) and might cause failure.

Steam

Steam Wash features enhance washing performance with low energy consumption.

- 1 Press the **Power** button.
- 2 Select steam course.
- 3 Press the **Steam** button.
- 4 Press the **Start/Pause** button.

Steam Wash

- For heavily stained clothes, underwear, or baby clothes.
- Do not use Steam Wash for delicates such as wool, silk, and easily discoloured clothes.

Wash

Soak

Use this mode to wash normal clothes or thick and heavy clothes which are excessively dirty.

Pre Wash

If the laundry is heavily soiled, the Pre Wash cycle is recommended.

Intensive

If the load is normal and heavily soiled, the **Intensive** option is effective.

Medium

This option is automatically selected in every course except for **Rinse+Spin**, **Baby Care**.

Light

This cycle is suitable for lightly soiled clothing.

NOTE

- Selectable options will differ depending on selected course.

Rinse

By pressing the Rinse button the Rinse times can be selected.

- 1 / 2 / 3 / 4 / 5 (times)

Spin

- Spin speed level can be selected by pressing the **Spin** button repeatedly.
 - Extra High / High / Medium / Low / Extra Low

- Spin Only

- 1 Press the **Power** button.
- 2 Press the **Spin** button to select spin speed.
- 3 Press the **Start/Pause** button.

Temp.

The **Temp.** button selects the wash temperature for the selected cycle. Press this button until the desired setting is lit. All rinses use the water from the cold water hose connection.

- Select the water temperature suitable for the type of load you are washing. Follow the garment fabric care labels for best results.

Child Lock ()

Select this function to lock the buttons on the control assembly to prevent tampering.

Locking the control panel

- 1 Press and hold the **Wash** and **Rinse** button for 3 seconds.
- 2 A beep will sound, and 'LL' will appear on the display.
When the child lock is set, all buttons are locked except the **Power** button.

NOTE

- Turning off the power will not reset the child lock function. You must deactivate child lock before you can access any other functions.

Unlocking the control panel

Press and hold the **Wash** and **Rinse** button for 3 seconds.

- A beep will sound and the remaining time for the current programme will reappear on the display.

Wi-Fi()

Press and hold the **Wi-Fi** button for 3 seconds. When **Wi-Fi** is turned on, the Wi-Fi icon () on the control panel is lit.

Remote Start

Use a smart phone to control your appliance remotely. You can also monitor your cycle operation so you know how much time is left in the cycle.

NOTE

- You must first connect to a gateway and register your appliance in order to use the Remote Start function.

To use Remote Start:

- 1 Press the **Power** button.
- 2 Put the laundry in the drum.
- 3 Press and hold **Remote Start** button for 3 seconds to enable Remote Start function.
- 4 Start a cycle from the LG SmartThinQ application on your smart phone.

NOTE

- The appliance cannot be used manually if the Remote Start function is turned on. The Remote Start function must be turned off from the app or by disabling it directly from the unit itself before using the machine manually.
- When Remote Start is turned on, the door is automatically locked.

To disable Remote Start:

When the Remote Start is activated, press and hold **Remote Start** button for 3 seconds.

Download Cycle

The Download Cycle features of this appliance allow you to download new and special cycles that are not included in the appliance's basic cycles.

Appliances that have been successfully registered can download a variety of specialty cycles specific to the appliance. Only one cycle can be stored on the appliance at a time.

Once Cycle Download is completed in the washer, the product keeps the downloaded cycle until you change it to a new downloaded cycle.

NOTE

- You can download cycles after registering the product and configuring the Wi-Fi connection.
- You can download a desired cycle through the 'LG SmartThinQ' app. For more information on each cycle, refer to the 'LG SmartThinQ' app.
- Depending on the type of washer purchased, different cycles will be available.
- The downloaded cycles may be different depending on the updated version of the 'LG SmartThinQ' app.

Dry

Use the Automatic cycles to dry most loads. Electronic sensors measure the temperature of the exhaust to increase or decrease drying temperatures for faster reaction time and tighter temperature control.

- Cold water tap must be left on during drying cycles.
- This washing machine's automatic process from washing to drying can be selected easily.
- For most even drying, make sure all articles in the clothes load are similar in material and thickness.
- Do not overload the washing machine by stuffing too many articles into the drum. Items must be able to tumble freely.
- If you open the door and remove the load before the washing machine has finished its cycle, remember to press the **Start/Pause** button.
- After the end of the dry cycle, 'LD' is displayed. 'LD' means crease reduction. The drying cycle is already done. Press any button to terminate the 'LD' function and unlock the door. If you do not press any button, the 'LD' function will end after about 4 hours.

NOTE

- When you turn the washing machine off of the drying cycle, the drying fan motor can be operated to save itself for 1 minute.
- Be careful when removing your clothing from the washing machine, as the clothing or washing machine may be hot.

Woolen Articles

- Do not tumble dry woolen articles. Pull them to their original shape and dry them flat.

Woven and Loopknit Materials

- Some woven and loopknit materials may shrink, by varying amounts, depending on their quality.
- Always stretch these materials out immediately after drying.

Permanent Press and Synthetics

- Do not overload your washing machine
- Take out permanent press articles as soon as the washing machine stops to reduce wrinkles.

Baby clothes and Night Gowns

- Always check the manufacturer's instructions.

Rubber and Plastics

- Do not dry any items made from or containing rubber or plastics, such as:
 - aprons, bibs, chair covers
 - curtains and table cloths
 - bathmats

Fiber glass

- Do not dry fiberglass articles in your washing machine. Glass particles left in the washing machine may be picked up by your clothes the next time you use the washing machine and cause skin irritation.

Drying Time Guide

- The drying time can be selected by pressing the **Time Dry** button.
- These drying times are given as a guide to help you set your washing machine for manual drying.

NOTE

- The estimated drying time varies from the actual drying time during the Automatic cycle. The type of fabric, size of the load, and the dryness selected affect drying time.
- When you select drying only, spinning runs automatically for energy efficiency.

SMART FUNCTIONS

Using SmartThinQ Application

Things to check before using LG SmartThinQ

- For appliances with the  or  logo

1 Check the distance between the appliance and the wireless router (Wi-Fi network).

- If the distance between the appliance and the wireless router is too far, the signal strength becomes weak. It may take a long time to register or installation may fail.

2 Turn off the **Mobile data** or **Cellular Data** on your smartphone.

- For iPhones, turn data off by going to **Settings → Cellular → Cellular Data**.

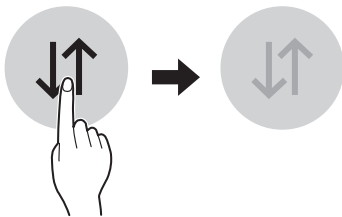

3 Connect your smartphone to the wireless router.

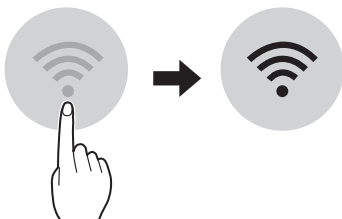

NOTE

- To verify the Wi-Fi connection, check the **Wi-Fi**  icon on the control panel is lit.
- The appliance supports 2.4 GHz Wi-Fi networks only. To check your network frequency, contact your Internet service provider or refer to your wireless router manual.
- LG SmartThinQ is not responsible for any network connection problems or any faults, malfunctions, or errors caused by network connection.
- If the appliance is having trouble connecting to the Wi-Fi network, it may be too far from the router. Purchase a Wi-Fi repeater (range extender) to improve the Wi-Fi signal strength.
- The Wi-Fi connection may not connect or may be interrupted because of the home network environment.
- The network connection may not work properly depending on the Internet service provider.
- The surrounding wireless environment can make the wireless network service run slowly.
- The appliance cannot be registered due to problems with the wireless signal transmission. Unplug the appliance and wait about a minute before trying again.
- If the firewall on your wireless router is enabled, disable the firewall or add an exception to it.
- The wireless network name (SSID) should be a combination of English letters and numbers. (Do not use special characters.)

Installing SmartThinQ

Search for the LG SmartThinQ application from the Google Play Store or Apple App Store on a smart phone. Follow instructions to download and install the application.

NOTE

- If you choose the simple login to access the LG SmartThinQ application, you must go through the appliance registration process each time you change your smartphone or reinstall the application.

Wi-Fi Function

- For appliances with the  or  logo

Communicate with the appliance from a smart phone using the convenient smart features.

Washer Cycle

Set or download any preferred cycle and operate by remote control.

Tub Clean Coach

Check the appropriate Tub Clean period based on the washing frequency.

Energy Monitoring

Check the energy consumption of the recently used cycles and monthly average.

Smart Diagnosis

If you use the Smart Diagnosis function, you will be provided with the useful information such as a correct way of using the appliance based on the pattern of use.

Settings

Allows you to set various options on the appliance and in the application.

Push Alert

Turn on the Push Alerts to receive appliance status notifications. The notifications are triggered even if the LG SmartThinQ application is off.

NOTE

- If you change your wireless router, your Internet service provider or your password after registering the appliance, please delete it from the LG SmartThinQ **Settings** → **Edit Product** and register again.
- The application is subject to change for appliance improvement purposes without notice to users.
- Functions may vary by model.

Open Source Software Notice Information

To obtain the source code under GPL, LGPL, MPL, and other open source licenses, that is contained in this product, please visit <http://opensource.lge.com>.

In addition to the source code, all referred license terms, warranty disclaimers and copyright notices are available for download.

LG Electronics will also provide open source code to you on CD-ROM for a charge covering the cost of performing such distribution (such as the cost of media, shipping, and handling) upon email request to opensource@lge.com. This offer is valid for three (3) years from the date on which you purchased the product.

RF Radiation Exposure Statement

This equipment should be installed and operated with minimum distance of 20 cm between the radiator and your body.

Smart Diagnosis™ Using a Smart Phone

- For appliances with the  or  logo

Use this function if you need an accurate diagnosis by an LG Electronics customer information centre when the appliance malfunctions or fails.

Smart Diagnosis™ can not be activated unless the appliance is connected to power. If the appliance is unable to turn on, then troubleshooting must be done without using Smart Diagnosis™.

Using Smart Diagnosis™

Smart Diagnosis™ Through the Customer Information Centre

Use this function if you need an accurate diagnosis by an LG Electronics customer information center when the appliance malfunctions or fails. Use this function only to contact the service representative, not during normal operation.

- 1 Press the **Power** button to turn on the washing machine. Do not press any other buttons or turn the cycle selector knob.
- 2 When instructed to do so by the call centre, place the mouthpiece of your phone close to the **Power** button.

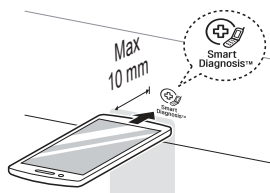

- 3 Press and hold the **Temp.** button for 3 seconds, while holding the phone mouthpiece to the icon or **Power** button.

- 4 Keep the phone in place until the tone transmission has finished. Time remaining for data transfer is displayed.
 - For best results, do not move the phone while the tones are being transmitted.
 - If the call centre agent is not able to get an accurate recording of the data, you may be asked to try again.
- 5 Once the countdown is over and the tones have stopped, resume your conversation with the call centre agent, who will then be able to assist you using the information transmitted for analysis.

NOTE

- The Smart Diagnosis™ function depends on the local call quality.
- The communication performance will improve and you can receive better service if you use the home phone.
- If the Smart Diagnosis™ data transfer is poor due to poor call quality, you may not receive the best Smart Diagnosis™ service.

MAINTENANCE

WARNING

- Unplug the washing machine before cleaning to avoid the risk of electric shock. Failure to follow this warning may result in serious injury, fire, electric shock, or death.
- Never use harsh chemicals, abrasive cleaners, or solvents to clean the washing machine. They may damage the finish.

Cleaning Your Washing Machine

Care After Wash

- After the cycle is finished, wipe the door and the inside of the door seal to remove any moisture.
- Leave the door open if it is safe to do so to dry the drum interior.
- Wipe the body of the washing machine with a dry cloth to remove any moisture.

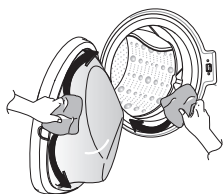

Cleaning the Exterior

Proper care of your washing machine can extend its life.

Door:

- Wash with a damp cloth on the outside and inside and then dry with a soft cloth.

Exterior:

- Immediately wipe off any spills.
- Wipe with a damp cloth.
- Do not press the surface or the display with sharp objects.

Cleaning the Interior

- Use a towel or soft cloth to wipe around the washing machine door opening and door glass.
- Always remove items from the washing machine as soon as the cycle is complete. Leaving damp items in the washing machine can cause wrinkling, colour transfer, and odour.
- Run the Tub Clean programme once a month (or more often if needed) to remove detergent buildup and other residue.

Cleaning the Water Inlet Filter

- Turn off the supply taps to the machine if the washing machine is to be left for any length of time (e.g. holiday), especially if there is no floor drain (gully) in the immediate vicinity.
- 'E' icon will be displayed on the control panel when water is not entering the detergent drawer.
- If water is very hard or contains traces of lime deposit, the water inlet filter may become clogged. It is therefore a good idea to clean it occasionally.

- 1 Turn off the water tap and unscrew the water supply hose.

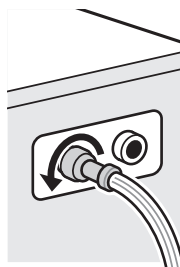

- 2 Remove the filter with pincers or long nose pliers. Clean the filter using a hard bristle brush.

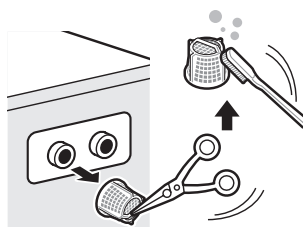

Cleaning the Drain Pump Filter

- The drain filter collects threads and small objects left in the laundry. Check regularly that the filter is clean to ensure smooth running of your washing machine.
- Allow the water to cool down before cleaning the drain pump, carrying out emergency emptying, or opening the door in an emergency.

- 1** Open the cover cap and pull out the hose.

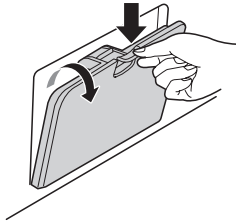

- 2** Unplug the drain plug and allow all the excess water to drain into a vessel before opening the filter by turning it to the left.

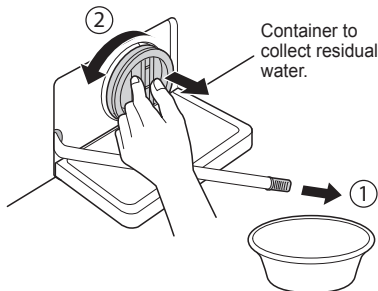

- 3** Remove any extraneous matter, foreign debris and lint from the pump filter trap.

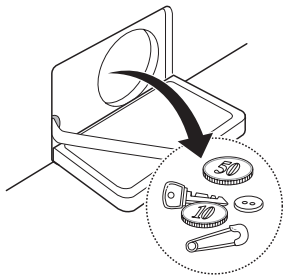

- 4** After cleaning, refit the pump filter cap by turning it to the right and insert the drain plug back onto the drain tube.

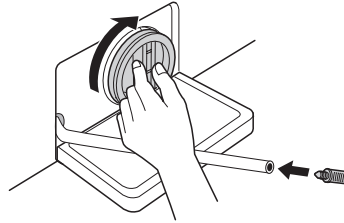

- 5** Close the cover cap.

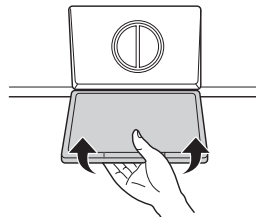

CAUTION

- First drain using the drain tube and then open the pump filter cap to remove any threads or objects.
- Be careful when draining, as the water may be hot.

Cleaning the Dispenser Drawer

Detergent and fabric softener may build up in the dispenser drawer. Remove the drawer and inserts and check for buildup once or twice a month.

- 1 Remove the detergent dispenser drawer by pulling it straight out until it stops.
 - Press down hard on the disengage button and remove the drawer.

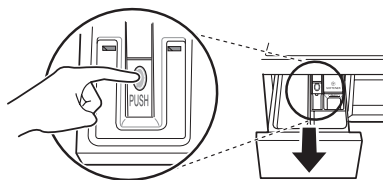

- 2 Remove the inserts from the drawer.
 - Rinse the inserts and the drawer with warm water to remove buildup from laundry products. Use only water to clean the dispenser drawer. Dry the inserts and drawer with a soft cloth or towel.
- 3 To clean the drawer opening, use a cloth or small, non-metal brush to clean the recess.
 - Remove all residue from the upper and lower parts of the recess.
- 4 Wipe any moisture off the recess with a soft cloth or towel.
- 5 Return the inserts to the proper compartments and replace the drawer.

Tub Clean

Tub Clean is a special cycle to clean the inside of the washing machine.

A higher water level is used in this cycle at higher spin speed. Perform this cycle regularly.

- 1 Remove any clothing or items from the washing machine and close the door.
- 2 Open the dispenser drawer and add Anti limescale (e.g. Calgon) to the main wash compartment.
 - Cleaning tablets can be placed directly into the drum.
- 3 Close the dispenser drawer slowly.
- 4 Power On and then press and hold the **Spin** and **Temp.** button for 3 seconds. Then 't c t' will be displayed on the display.
- 5 Press the **Start/Pause** button to start.
- 6 After the cycle is complete, leave the door open to allow the washing machine and the flexible door gasket and door glass to dry.



CAUTION

- If there is a child present, be careful not to leave the door open unless it is supervised by an adult

NOTE

- Do not add any detergent to the detergent compartments. Excessive suds may generate and leak from the washing machine.

Caution on Freezing During Winter

- When frozen, the product does not operate normally. Install the product where it will not freeze during winter.
- Do not install the washer in any outdoor or sheltered outdoor location as this will contribute water freezing within the unit.

How to Keep the Product from Freezing

- After washing, remove any water remaining inside the pump by opening the drain tube plug that's used for removal of residual water. When the water is removed completely, refit the drain tube and filter cap and then close the filter cover cap.

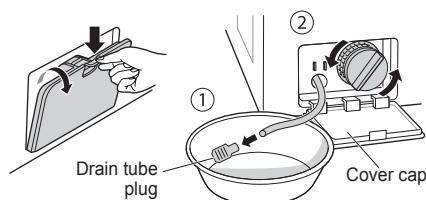

- Lower the Drain tube so that any residual water remaining in the tub can be drained into a low profile vessel.

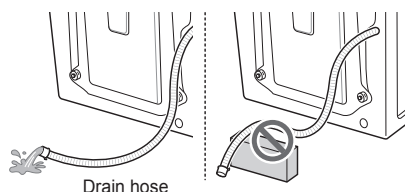

⚠ CAUTION

- When the drain hose is installed in a curved shape, the water within the curve of the hose may freeze.

- After closing the tap, disconnect the cold supply hose from the tap, and remove water while keeping the hose facing downwards.

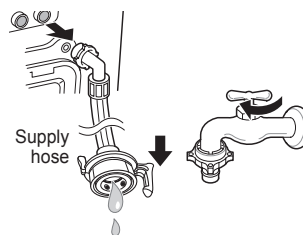

Check for Freezing

- If water does not drain when opening the drain tube plug, check the drain pump body for ice by removing the drain filter cap.



- Turn the power on, choose a washing programme, and press the **Start/Pause** button.

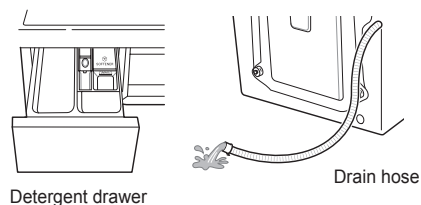

- If **FF** is shown in the display window while the product is in operation, check water supply taps, and all hoses for ice build up (Some models do not have an **FF** alarm function that indicates freezing).

NOTE

- Check that water is coming into the detergent drawer while rinsing, and water is draining through the drain hose while spinning.

How to Handle Freezing

- Make sure to empty the drum, pour warm water of 50–60 °C up to the rubber part inside the drum, close the door, and wait for 1–2 hours.

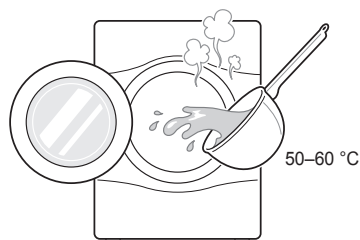

! CAUTION

- When the drain hose is installed in a curved shape, the inner hose may freeze.
- Open the cover cap and drain tube plug used for removal of residual water to extract water completely.

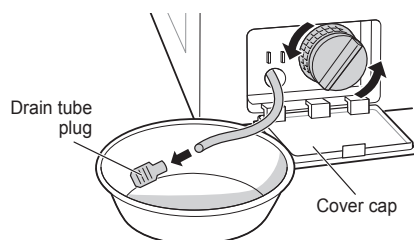

NOTE

- If water does not drain, this means the ice is not melted completely, or lint may be trapped inside.

- When water is removed completely from the drum, close the drain tube plug used for removal of residual water, choose a washing programme, and press the **Start/Pause** button.

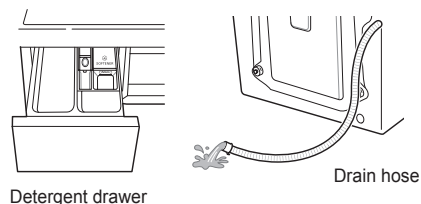

NOTE

- Check that water is coming into the detergent drawer while rinsing, and water is draining through the drain hose while spinning.
- When water supply problems occur, take the following measures.
 - Turn off the tap, and thaw out the tap and both connection areas of supply hose of the product using a hot water cloth.
 - Take out supply hose and immerse in warm water below 50–60 °C.

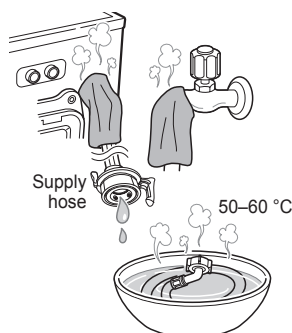

TROUBLESHOOTING

The appliance is equipped with an automatic error-monitoring system to detect and diagnose problems at an early stage. If the appliance does not function properly or does not function at all, check the following before you call for service:

Diagnosing Problems





Symptoms	Reason	Solution
Rattling and clanking noise	Foreign objects such as coins or safety pins may be in drum or pump.	<ul style="list-style-type: none"> • Check all pockets to make sure that they are empty. Items such as clips, matches, pens, coins, and keys can damage both your washer and your clothes. • Close zippers, hooks, and drawstrings to prevent these items from snagging or tangling on other clothes.
Thumping sound	Heavy wash loads may produce a thumping sound. This is usually normal.	<ul style="list-style-type: none"> • If sound continues, washing machine is probably out of balance. Stop and redistribute wash load.
Vibrating noise	Have all the transit bolts and tub support been removed?	<ul style="list-style-type: none"> • If not removed during installation, refer to Installation guide for removing transit bolts.
	Are all the feet resting firmly on the ground?	<ul style="list-style-type: none"> • Make sure the washing machine is level and tighten the lock nuts up towards the base of the appliance.
Water leaks	Supply hoses or drain hose are loose at tap or washing machine.	<ul style="list-style-type: none"> • Check and tighten hose connections.
	House drain pipes are clogged.	<ul style="list-style-type: none"> • Unclog drain pipe. Contact plumber if necessary.
Oversudsing		<ul style="list-style-type: none"> • Too much detergent or unsuitable detergent may cause excessive foaming which may result in water leaks.
Water does not enter washing machine or it enters slowly	Water supply is not adequate in that location.	<ul style="list-style-type: none"> • Check another tap in the house.
	Water supply tap is not completely open.	<ul style="list-style-type: none"> • Fully open tap.
	Water supply hose(s) are kinked.	<ul style="list-style-type: none"> • Straighten hose.
	The filter of the supply hose(s) clogged.	<ul style="list-style-type: none"> • Check the filter of the supply hose.





















Symptoms	Reason	Solution
Water in the washing machine does not drain or drains slowly	Drain hose is kinked or clogged.	<ul style="list-style-type: none"> • Clean and straighten the drain hose.
	The drain filter is clogged.	<ul style="list-style-type: none"> • Clean the drain filter.
Washing machine does not start	Electrical power cord may not be plugged in or connection may be loose.	<ul style="list-style-type: none"> • Make sure plug fits tightly in wall outlet.
	House fuse blown, circuit breaker tripped, or a power outage has occurred.	<ul style="list-style-type: none"> • Reset circuit breaker or replace fuse. Do not increase fuse capacity. If problem is a circuit overload, have it corrected by a qualified electrician.
	Water supply tap is not turned on.	<ul style="list-style-type: none"> • Turn on water supply tap.
Washing machine will not spin	Check that the door is firmly shut.	<ul style="list-style-type: none"> • Close the door and press the Start/Pause button. After pressing the Start/Pause button, it may take a few moments before the washing machine begins to spin. The door must be locked before spin can be achieved. Add 1 or 2 similar items to help balance the load. Rearrange load to allow proper spinning.
Door does not open		<ul style="list-style-type: none"> • Once washing machine has started, the door cannot be opened for safety reasons. Check if the 'Door Lock' icon is illuminated. You can safely open the door after the 'Door Lock' icon turns off.
Wash cycle time delayed		<ul style="list-style-type: none"> • The washing time may vary by the amount of laundry, water pressure, water temperature and other usage conditions. If an imbalance is detected or if the suds removing programme is on, the wash time will increase.
Fabric softener overflow	Too much softener may cause an overflow.	<ul style="list-style-type: none"> • Follow softener guidelines to ensure appropriate amount is used. Do not exceed the maximum fill line.
Softeners dispensed too early	Too much softener may cause an premature dispensing.	<ul style="list-style-type: none"> • Follow the guidelines provided by the detergent manufacturer. • Close the dispenser drawer slowly. Do not open the drawer during the wash cycle.

Symptoms	Reason	Solution
Dry problem	Check water supply.	<ul style="list-style-type: none"> Do not overload. Check that the washing machine is draining properly to extract adequate water from the load. Clothes load is too small to tumble properly. Add a few towels. Turn off water supply tap.
Odor	This odor is caused by the rubber attached to the washing machine.	<ul style="list-style-type: none"> It is the normal odor of new rubber and will disappear after the machine has been run a few times.
	If the rubber door gasket and door seal area are not cleaned regularly, odors can occur from mold or foreign substances.	<ul style="list-style-type: none"> Be sure to clean the gasket and door seal regularly and check under the door seal for small items when unloading the washer.
	Odors can occur if foreign substances are left in the drainage pump filter.	<ul style="list-style-type: none"> Be sure to clean the drainage pump filter regularly.
	Odors can occur if the drainage hose is not properly installed, causing siphoning (water flowing back inside the washing machine).	<ul style="list-style-type: none"> When installing the drainage hose, be sure that it doesn't become kinked or blocked.
	Using the dry function, odors can occur from lint and other laundry matter sticking to the heater. (Dryer model only)	<ul style="list-style-type: none"> This is not a malfunction.
	A particular odor can occur from drying wet clothes with hot air. (Dryer model only)	<ul style="list-style-type: none"> The odor will disappear after a short while.

Symptoms	Reason	Solution
Your home appliance and smartphone is not connected to the Wi-Fi network.	The password for the Wi-Fi that you are trying to connect to is incorrect.	<ul style="list-style-type: none"> Find the Wi-Fi network connected to your smartphone and remove it, then register your appliance on LG SmartThinQ.
	Mobile data for your smartphone is turned on.	<ul style="list-style-type: none"> Turn off the Mobile data of your smartphone and register the appliance using the Wi-Fi network.
	The wireless network name (SSID) is set incorrectly.	<ul style="list-style-type: none"> The wireless network name (SSID) should be a combination of English letters and numbers. (Do not use special characters.)
	The router frequency is not 2.4 GHz.	<ul style="list-style-type: none"> Only a 2.4 GHz router frequency is supported. Set the wireless router to 2.4 GHz and connect the appliance to the wireless router. To check the router frequency, check with your Internet service provider or the router manufacturer.
	The distance between the appliance and the router is too far.	<ul style="list-style-type: none"> If the distance between the appliance and the router is too far, the signal may be weak and the connection may not be configured correctly. Move the location of the router so that it is close to the appliance.

Error Messages

Symptoms	Reason	Solution
	1E	<p>Water supply pressure is not adequate in area.</p> <ul style="list-style-type: none"> • Check another tap in the house.
		<p>Water supply taps are not completely open.</p> <ul style="list-style-type: none"> • Fully open tap.
		<p>Water supply hose(s) are kinked.</p> <ul style="list-style-type: none"> • Straighten hose(s).
		<p>The filter of the supply hose(s) are clogged.</p> <ul style="list-style-type: none"> • Check the filter of the supply hose.
	<p>If water leakage occurred in the supply hose (aqua stop hose), indicator A will become red.</p>  <ul style="list-style-type: none"> • May vary depending on the model. 	
	0E	<p>Drain hose may not be installed as per installation instructions.</p> <ul style="list-style-type: none"> • Ensure that the drain hose is installed as per the installation instructions.
		<p>The drain filter is clogged.</p> <ul style="list-style-type: none"> • Clean the drain filter.
	UE	<p>Load is too small.</p> <ul style="list-style-type: none"> • Add 1 or 2 similar items to help balance the load.
		<p>Feet are not adjusted correctly.</p> <ul style="list-style-type: none"> • Adjust the front feet(or foot) so that there is no rocking from corner to corner.
		<p>The appliance has an imbalance detection and correction system. If individual heavy articles are loaded (e.g. bath mat, bath robe, etc.) this system may stop spinning or even interrupt the spin cycle altogether.</p> <ul style="list-style-type: none"> • Rearrange load to allow proper spinning.
		<p>If the laundry is still too wet at the end of the cycle, add smaller articles of laundry to balance the load and repeat the spin cycle.</p> <ul style="list-style-type: none"> • Rearrange load to allow proper spinning.

Symptoms		Reason	Solution
	  	Door is not closed properly.	<ul style="list-style-type: none"> Close the door completely. <p>If 'dE, dE 1, dE 2, dE 4' is not released, call for service.</p>
		Door sensor has malfunctioned.	
		Thermistor control error.	<ul style="list-style-type: none"> Unplug the power plug and call for service.
		Water overfills due to a malfunction or excessively high water pressures.	<ul style="list-style-type: none"> Close the water tap. Unplug the power plug. Call for service.
		Malfunction of water level sensor.	<ul style="list-style-type: none"> Close the water tap. Unplug the power plug. Call for service.
		Over load in motor.	<ul style="list-style-type: none"> Allow the washing machine to stand for 30 minutes to allow the motor to cool, then restart the cycle.
		Water leaks.	<ul style="list-style-type: none"> Call for service.
		The washer experienced a power failure.	<ul style="list-style-type: none"> Restart the cycle.
		Does not dry (only on combo dryer models)	<ul style="list-style-type: none"> Call for service.
		Is Inlet/outlet hose or drainage pump frozen?	<ul style="list-style-type: none"> Supply warm water into the tub and unfreeze outlet hose and drainage pump. Wet a towel in warm water and apply to inlet hose.

Memo

Memo

Memo

